



Class A



Class B

*Lighting Installation
Instruction Manual*

F236-BK

- 1.** Please read this user manual carefully before installing and using the product. If any problem or questions, please feel free to contact us immediately: support@linherhome.com.
- 2.** Ceiling fans must not be installed only on switch boxes or light keel ceilings, and must ensure that the hanging position can withstand a minimum weight of 25KG.
- 3.** This ceiling fan is lightweight and can be installed on a switch box or light keel ceiling.
- 4.** Before starting the installation process, please turn off the power in the installation area.
- 5.** Assemble the ceiling fan carefully and make sure to tighten all screws securely.
- 6.** The lamp should be installed at least 2 meters from the ground and 0.5 meters away from any walls. During installation and cleaning, please avoid bending the fan blades, and do not allow foreign objects to come into contact with the running fan.
- 7.** After the fan is powered on, the remote control starts to work (Two AAA batteries are required and need to be purchased separately)
- 8.** If you are experiencing any issues with the fan light, please contact customer service promptly to discuss the problem. After consulting with customer service, please hire a licensed professional electrician to make any necessary repairs to the fan light.

1.If the fan light is not turning on, please follow these steps:

- (1) Check the power line of the fan lamp to make sure there are no issues. When powering on, be sure to avoid any short-circuit operations.
- (2) Check the power supply voltage of the fan to ensure it is normal.
- (3) Test the remote control to see if it can turn on the fan.

If none of the above steps solve the problem, please contact customer service to replace the controller.

2.If the ceiling fan is making noise, please follow these steps:

- (1) Check to make sure all screws on the fan are securely tightened.
- (2) Inspect the fan to see if there is any friction with any other parts while the motor is running.

3.If the wall control switch can turn on the fan light, but the remote control is not working, please follow these steps:

Check to see if the indicator light on the remote control is on. If the indicator light is on, you need to perform code pairing to connect the remote control with the fan light.

Step of code: First, confirm that the product has been disconnected, and then quickly press "3" and "↻" after the product is powered; after the code is successful, your light bulb will flash once and open the fan.

For any other issues not covered in these instructions, please contact customer service and describe the situation. Our team will provide feedback within 12 hours to assist you with resolving the issue.



Prepare tools before installation

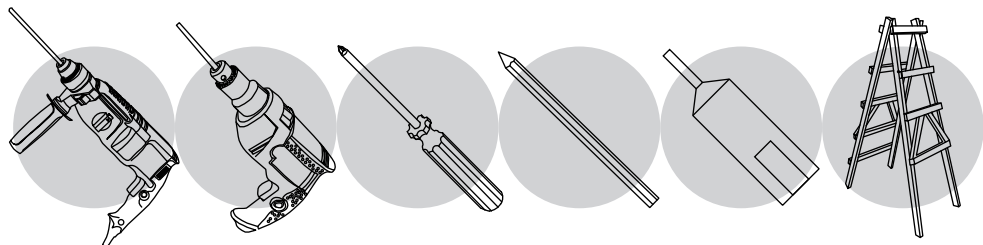

Impact drill 1 pcs

Electric drill 1 pcs

Phillips screwdriver 1 pcs

Marker pen 1 pcs

M14 electric drill nut head 1 pcs

Ladder 1 pcs

Lighting Parts

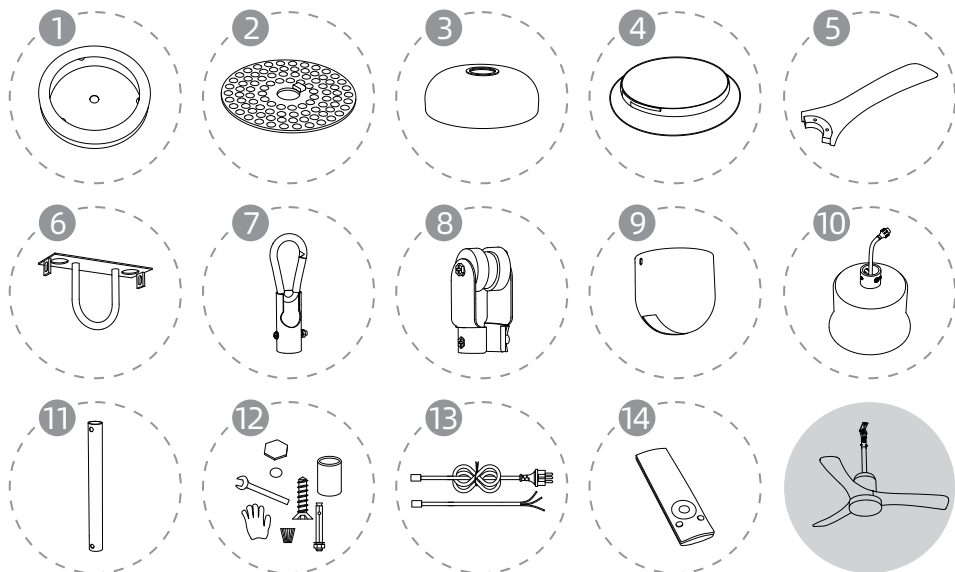

1.Lampshade metal disk 1 pcs

2.LED light plate 1 pcs

3.Hardware cover 1 pcs

4.Cover of lamp 1 pcs

5.Fan blade 3 pcs

6.Hanging board 1 pcs

7.Hanging head A 1 pcs

8.Hanging head B 1 pcs

9.Ceiling tray 1 pcs

10.Lamp body 1 pcs

11.Boom 1 pcs

12.Kit 1 pcs

13.Wire 1 pcs

14.Remote control 1 pcs

Installation steps

01 / Installation method of hanging board (Installation on plaster ceilings is not permitted)

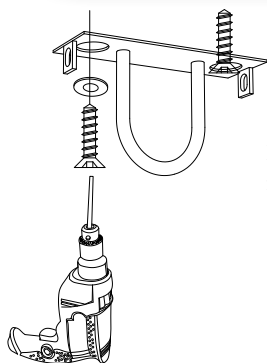
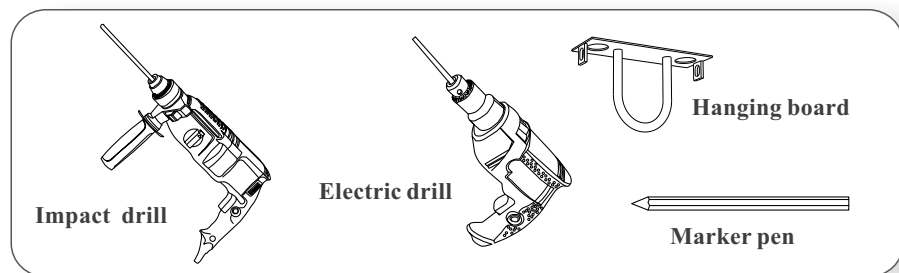

Install the pegboard to the wood ceiling: open the accessory kit, remove the gloves and put them on. Then take out 2 round shims and 2 pointed screws. Put the spacers into the screws first, and then use the drill to fix them after the screws are aligned with the holes of the wall plate.

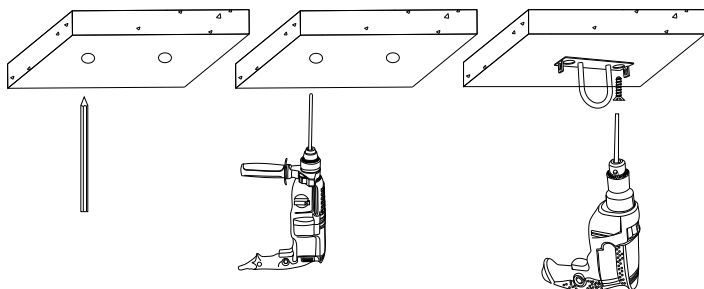

Scan to see the installation
process of the video version



<https://youtu.be/zPK1LUNBQhA>

1. Mark the hole spacing of the pegboard with a marker pen mark.
2. Use an impact drill to drill out the expansion bolt holes.
3. Then bury the expansion screws, and use the electric drill to fix the wall plate.

02 / Integral installation of lamps

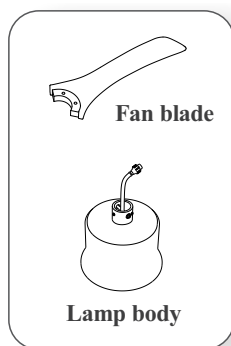
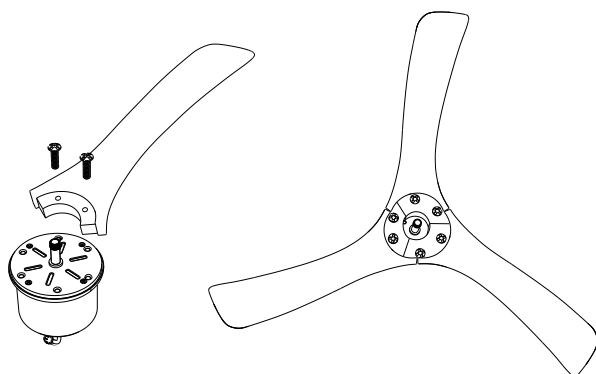

1.(As shown in the picture)take out the fan blade screws in the accessory kit,use the electric drill to fix the wooden blade to the lamp body,finish as shown in the picture.

Special Warning:



Be sure to lock the screws tightly or the fan blades may fall off at high speeds!

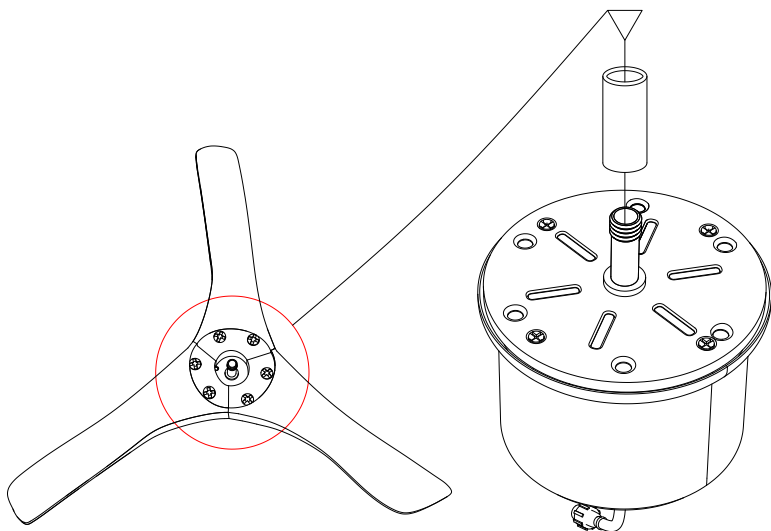

2. (As shown in the picture)Remove the silver round tube from the kit and place it into the shaft in the center of the lamp body.

Installation steps

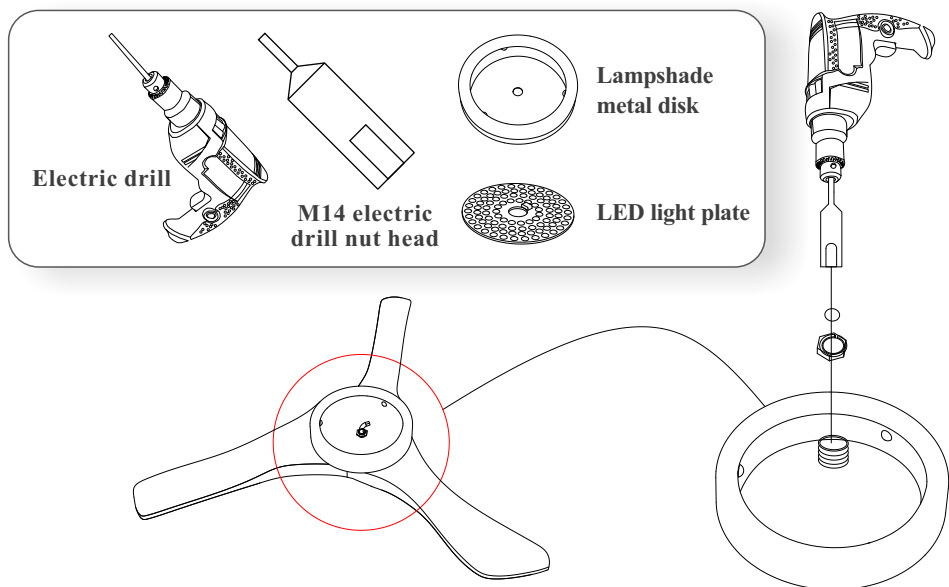

3. (As shown in the picture) Remove the hexagonal nut from the kit and use a drill with a M14 hexagonal nut head. Fix the metal disk of the lampshade to the lamp body and finish as shown in the picture.

Special Warning:



Be sure to lock the hex nuts tightly, otherwise the light disk will fall off when the fan blade is running at high speed!

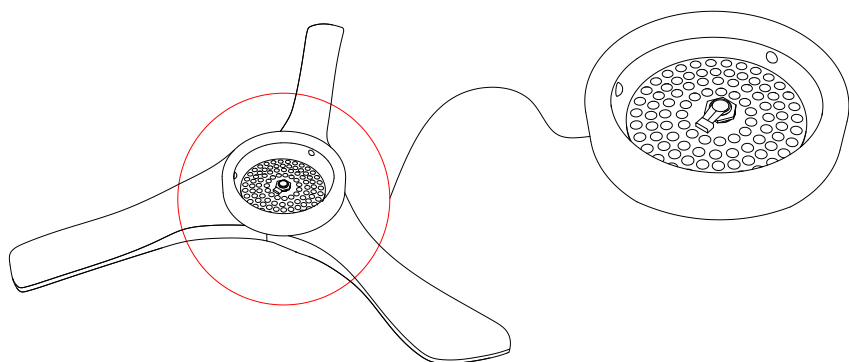

4. (As shown in the picture) Put the LED light board into the metal disk and insert the LED connection cable into the socket of the LED light piece.

Installation steps

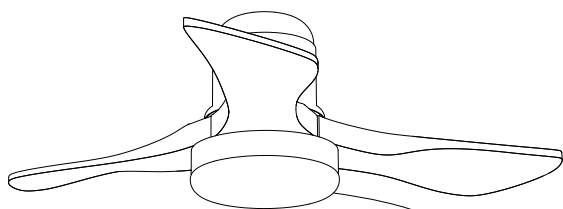

5. (As shown in the picture) Remove the lampshade, align the slot of the lampshade with the catch inside the lamp tray, and then twist the lampshade to complete the installation of the lamp body.

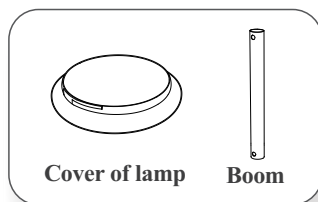
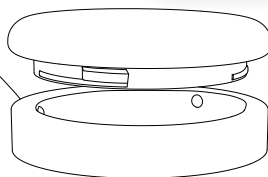

6. (As shown in the picture) Use a small wrench and an M4 screwdriver to remove the fasteners on the screws and screws to remove them.

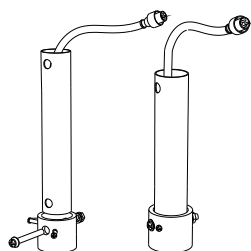
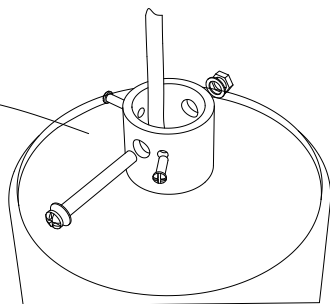
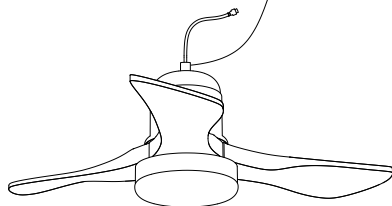

7. (As shown in the picture) Remove the boom, then route the power cord through the inside of the boom.

8. Put the screw rod that 1-1 removes with M4 hex wrench through the fixing piece and the boom, and then lock it with a plate hand. The remaining two screws are re-fixed with a drill fitted with an M4 Phillips head. The remaining two screws are re-fixed with an electric drill fitted with an M4 Phillips head.

Note:

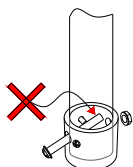

Passing the screw rod from the fixture to the screw rod may cause problems as shown below. You may encounter the problem shown in the figure below when passing the screw rod from the fixing member to the screw rod. Be sure to try several times.

Installation steps

A/ Installation Procedure for Class A Suspension

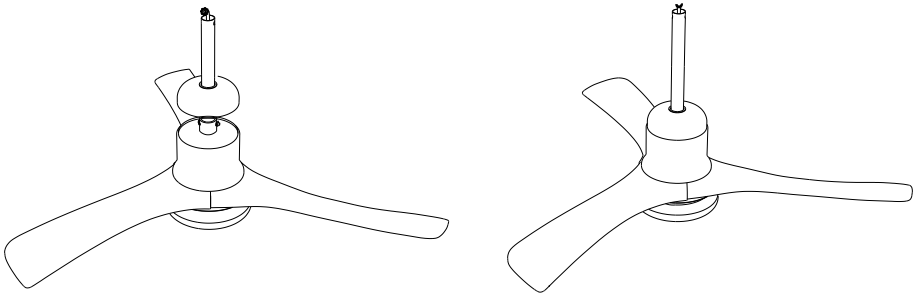

Remove the hardware cover from the kit, slip the cover over the center boom and slide it to the bottom until it cannot wiggle.

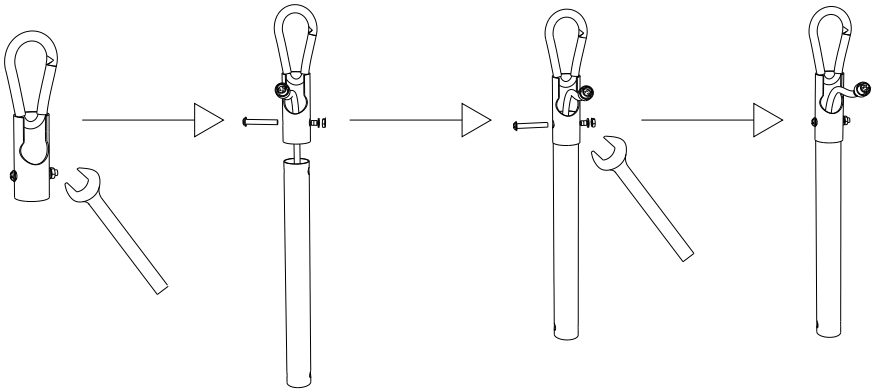

Use the small wrench included in the kit to remove the screws securing the head A to the boom, then insert the head A into the boom. Then put the screws through the holes aligned with the holes, and finally fix the screws with the small wrench.

Installation steps

B/ Installation Procedure for Class B Suspension

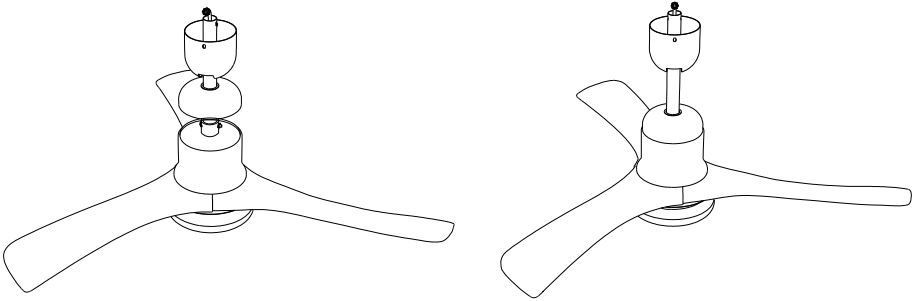
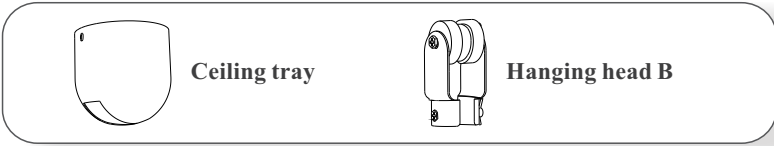

Remove the hardware cover and ceiling tray from the accessory kit, first slipping the cover over the center boom and sliding it to the bottom until it cannot wiggle. Then do the same and put in the ceiling tray.

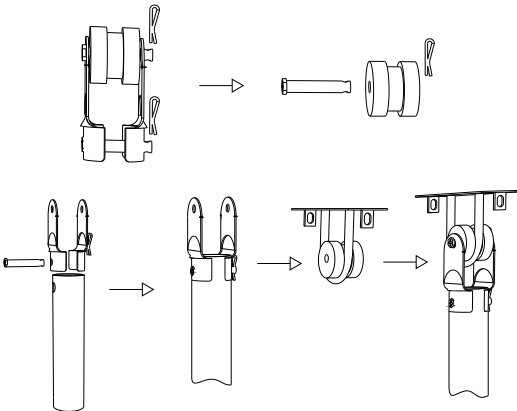

First remove the retaining pin from hitch head B. Then pull out the bolt and remove the rubber round wheel and the two metal brackets. Next use the bolt Align the holes in the metal bracket and the boom through and snap the stop pin back in. Snap the slot of the rubber wheel into the U-bracket of the hanger plate and hold the hanger bar. bracket of the hanger plate, then grab the boom and lift the whole light up, bolt the metal bracket to the rubber wheel and re-insert the the stopper pin.

Note:

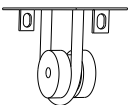

For safety design criteria, the pulley outer dimensions are smaller than those of the rings. Therefore the pulley must be pressed into the rings with a little force.

03 / Wiring method

Connection type A: (As shown in the picture) take out the two wires and replace them according to different usage scenarios.

{Note that the plug wire can not be connected to the Class B head if the ceiling tray is used}

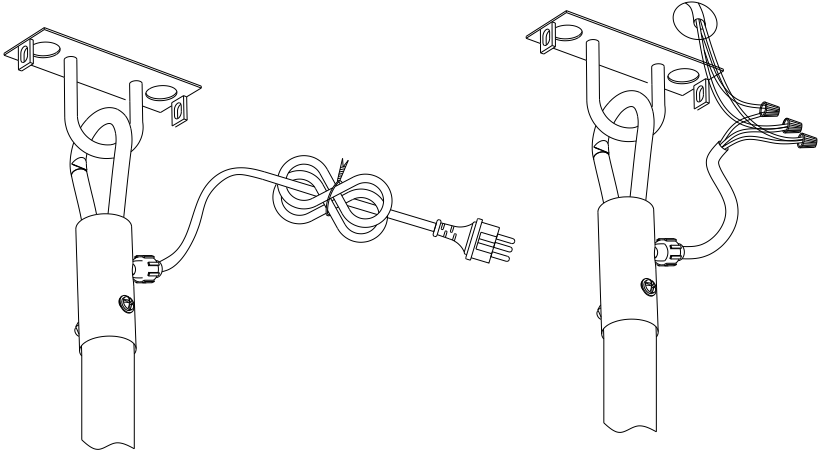

Note:

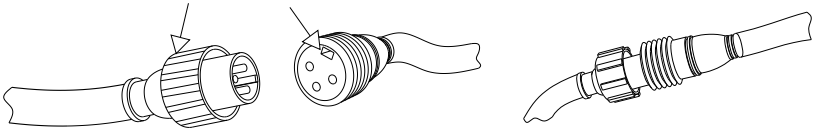

The two wires have slots, as shown by arrows, to be aligned before inserting, inserting After the light body on the power supply on the stripe twisted cover (as shown by the arrow) twisted tightly to the interface, pulling After inserting, twist the stripe cover (as shown by arrow) on the power supply of the lamp body tightly to the interface, and pull it out.

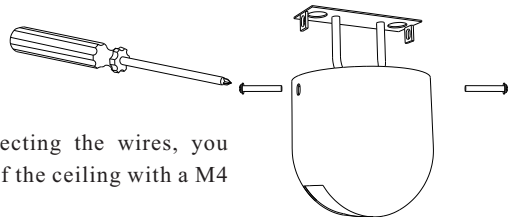

Connection type B: After connecting the wires, you have to fix the ceiling tray to the top of the ceiling with a M4 Phillips screwdriver.

Note: Class B pendants cannot be wired with plug wires if ceiling mounted tray is used.

04 / Complete display of lamps

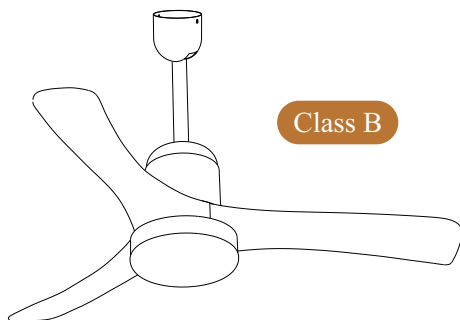
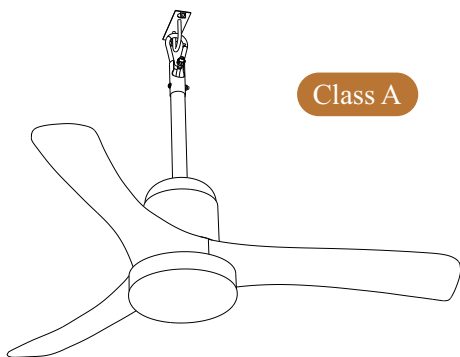

Use and fault investigation:

If the motor start-up current is not enough to rotate the fan, the fan cannot rotate or rotates abnormal problems. To avoid this, the easiest way is to use the B structure. If you use the A structure, you need to reach the following points:

1. First ensure that the fan blades are not reversed.
 2. Make sure to keep the environmental protection at the bottom and not move at will. (You can use a fixed ring with a tie)
 3. Make sure to tighten the screws on the fan.
 4. After the power is restarted many times, you need to press the wind speed first, and then press the six-speed wind speed after the fan is started normally.
- According to these methods, fan lights can return to normal.

Explanation of lamp function

This lamp includes fan timing function, fan gear and light brightness memory function, bulb stepless dimming, speed adjustment, night light mode, fan forward and reverse. For other details, please refer to the remote control manual to check the function of the lamp. (Note: Delete the bee singer from the remote control. Therefore, a timely sound will be made in a timely 10 seconds of code pairing. After the code paired is successful, the light source will flash once and open the fan.)



Disposal: Dispose of at local disposal point, do not store household waste!