

Violent installation is prohibited

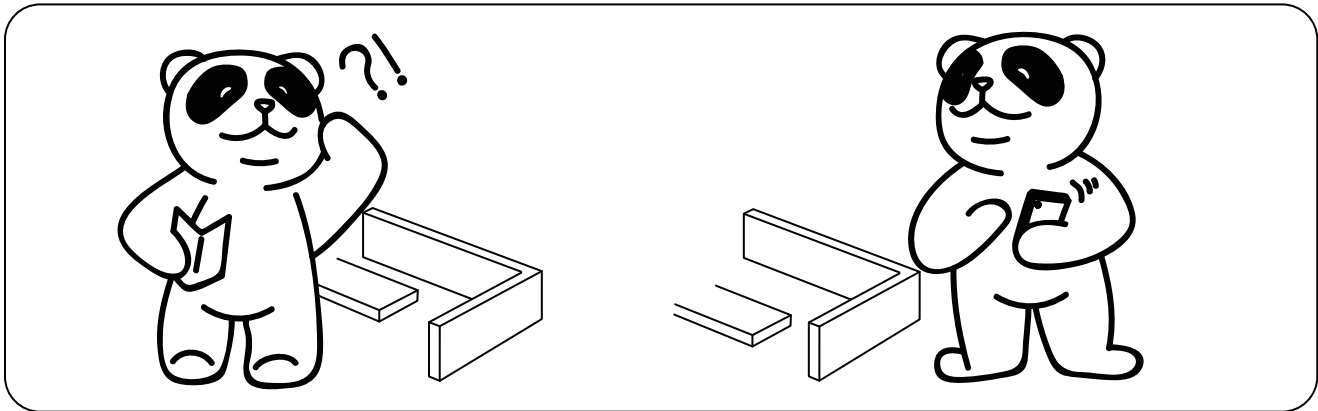

Please call if you need help

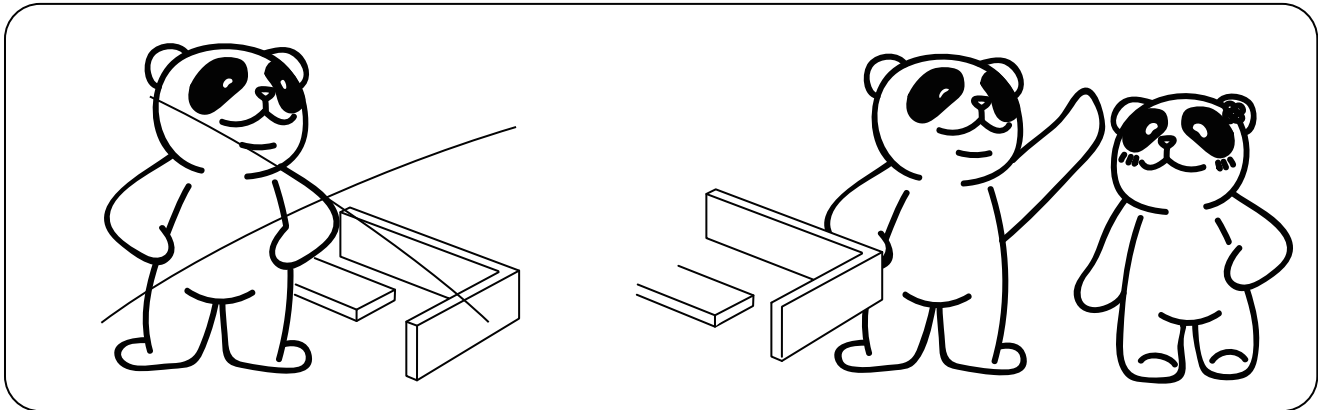

Multi-person cooperation is recommended

# Assembly Instruction

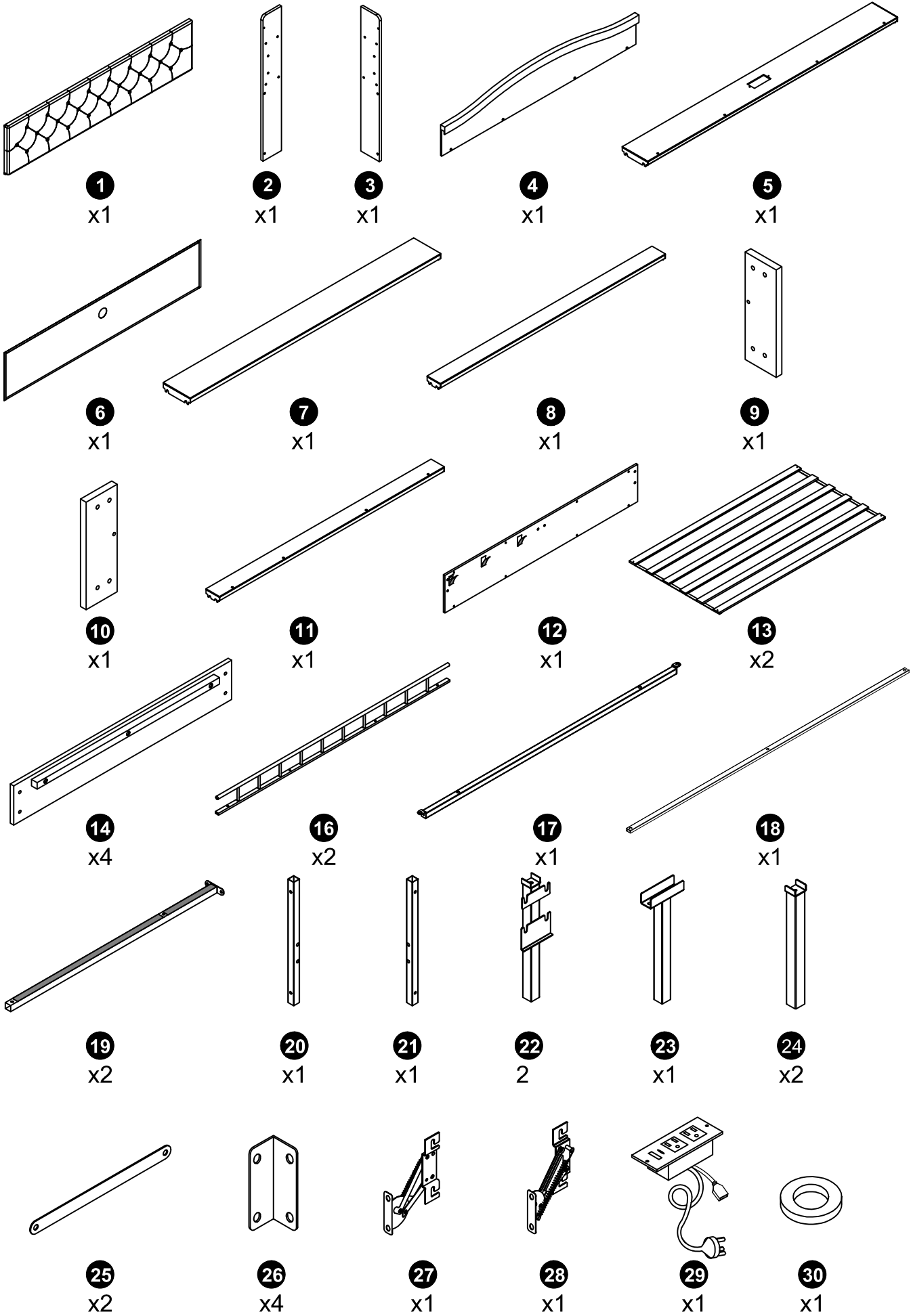

# Assembly Instruction



**A**

M6\*20  
x9

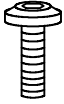

**B**

M6\*25  
x13

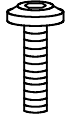

**C**

M6\*30  
x9

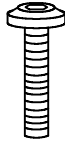

**D**

M6\*45  
x5

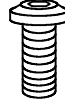

**E**

M8\*15  
x12

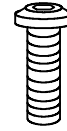

**F**

M8\*20  
x52

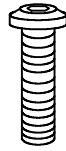

**G**

M8\*35  
x7

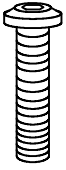

**H**

M8\*45  
x5

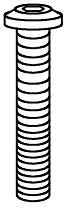

**I**

M8\*50  
x2

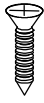

**J**

M3\*12  
x3

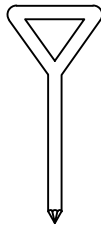

**K**

x1



**L**

M6  
x1

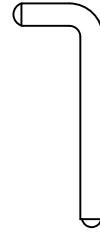

**M**

M8  
x1

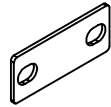

**N**

x2

# Assembly Instruction

## LED light strip electronic accessories list

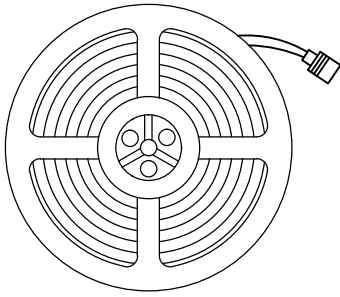

x2

Light strip

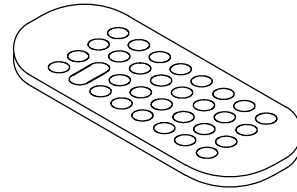

x1

Remote control

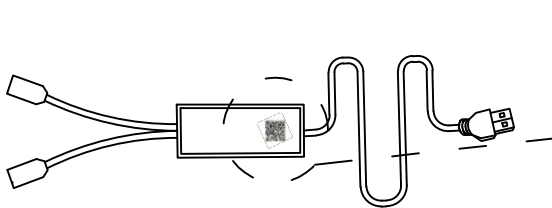

x1

Power cord

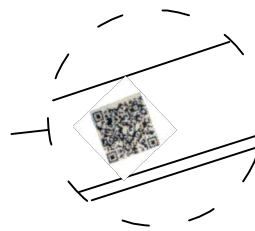

There is a two-dimensional code at the position of the power line. Scanning can download the APP for the control light

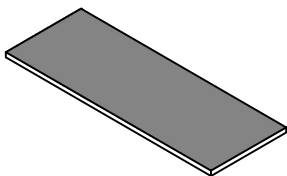

x8

Magic tape

**Note:**

1. Should be assembled on flat ground to keep balance.
2. Before completing the installation, do not tighten the screws.

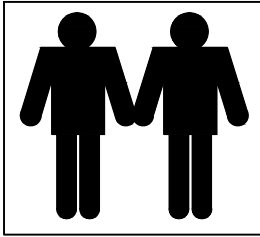

**It needs at least two people to install !!**



**Before starting the assembly, you must read the whole manual and follow the instructions**

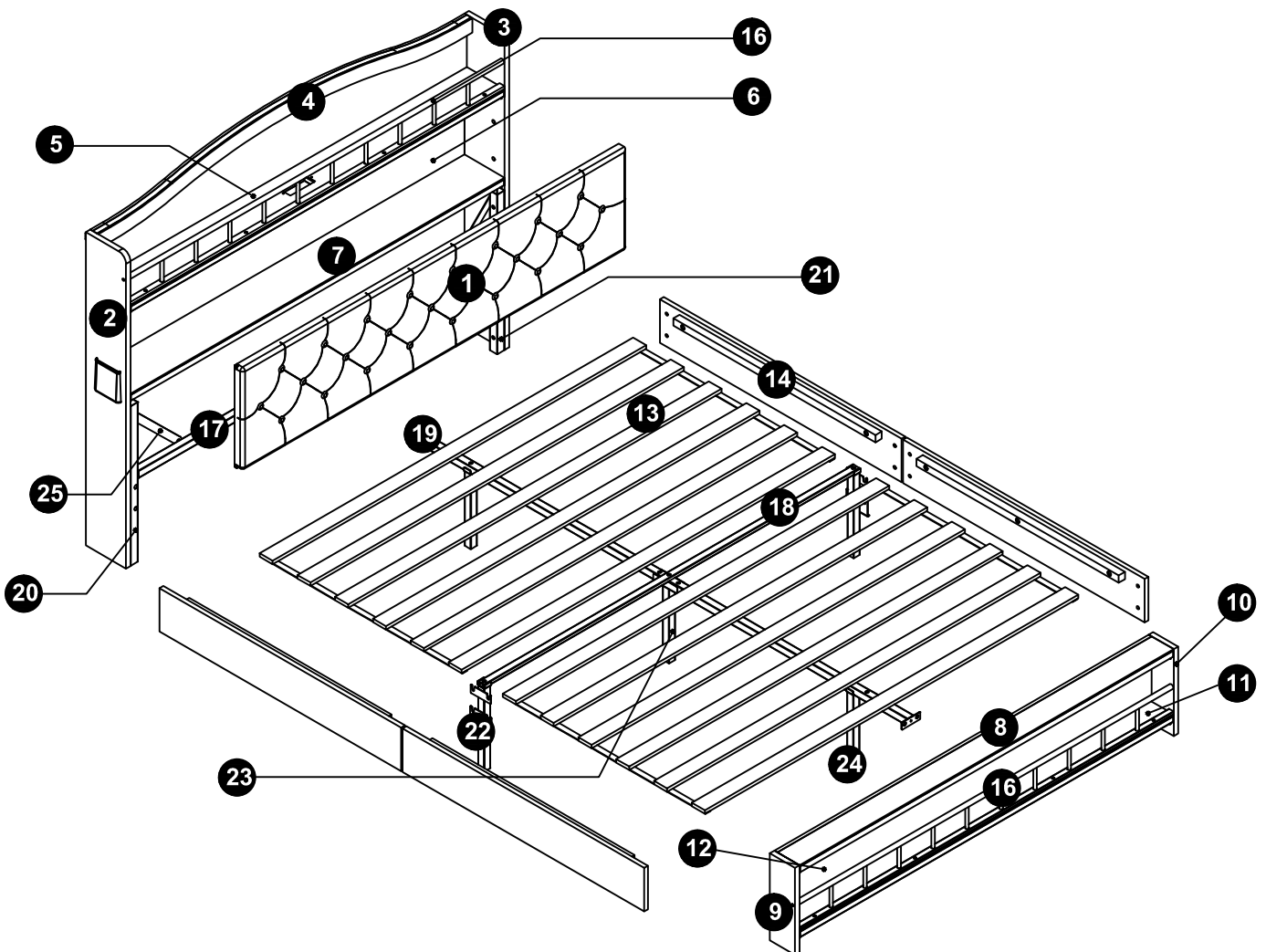

1

H M8\*45  
 x4

Do not tighten the screws

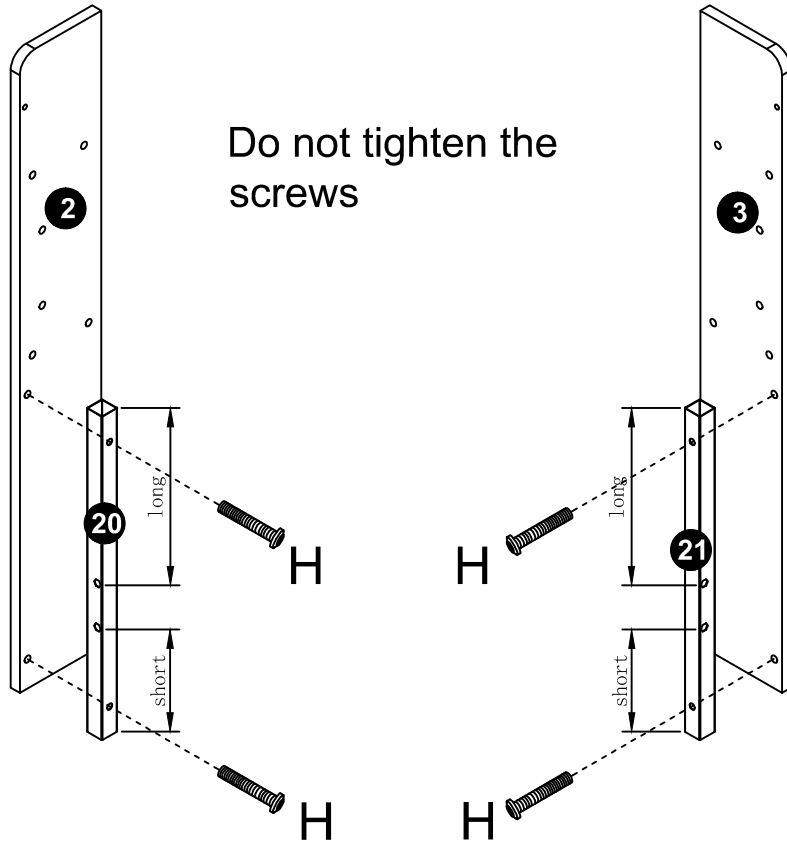

2

F M8\*20  
 x2

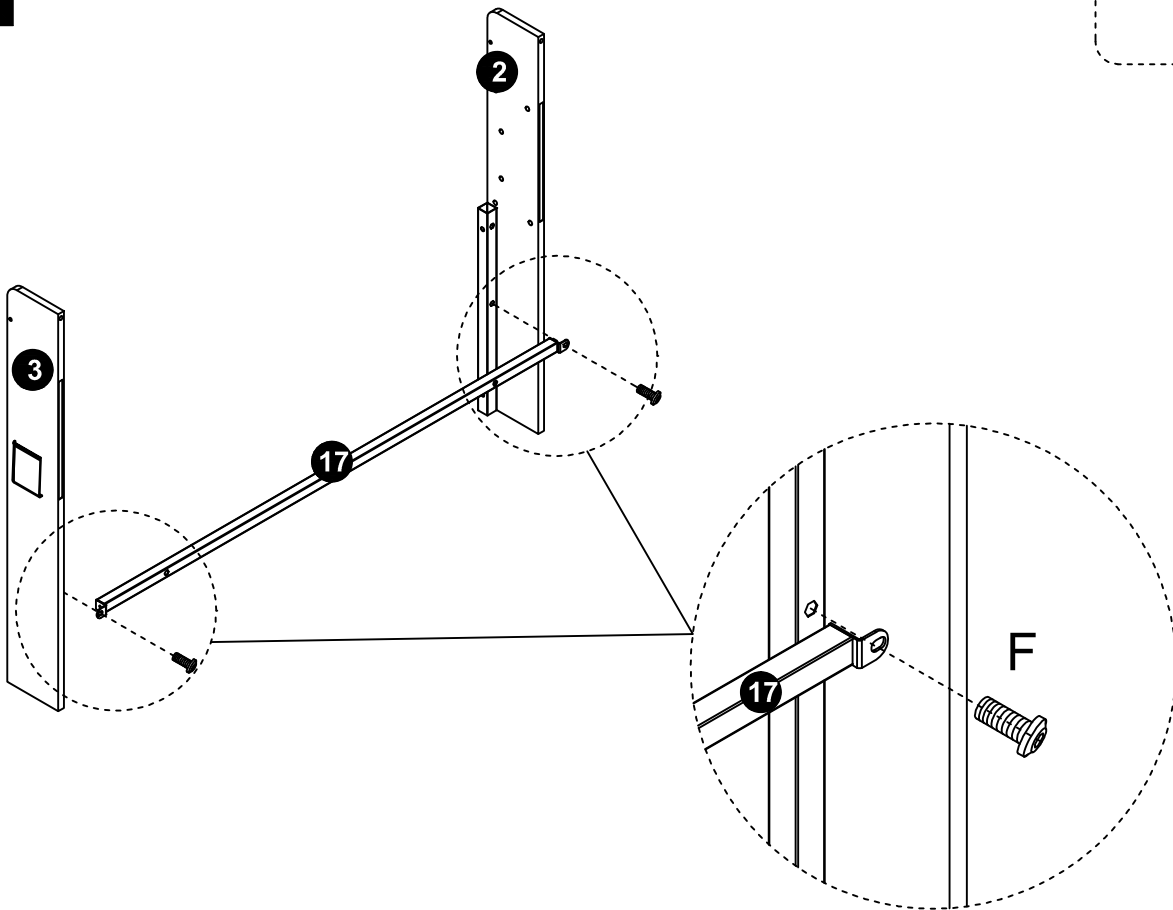

3

F M8\*20  
x4

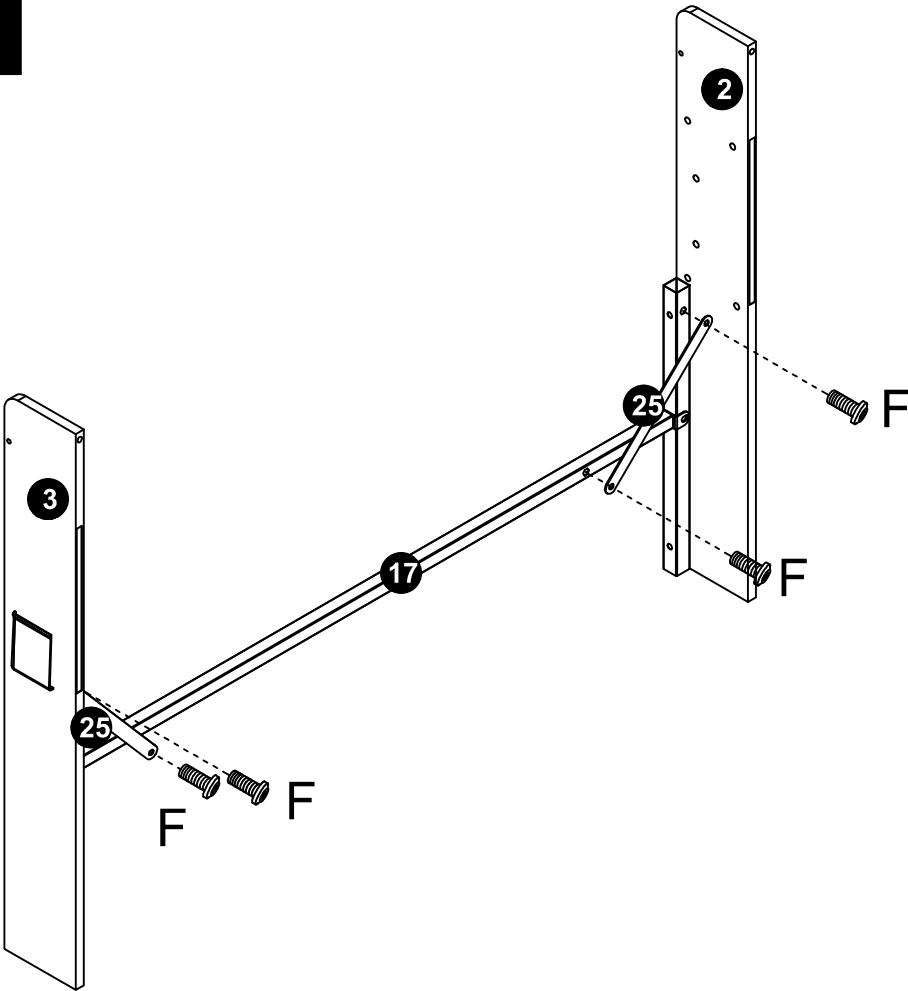

4

F M8\*20  
x12

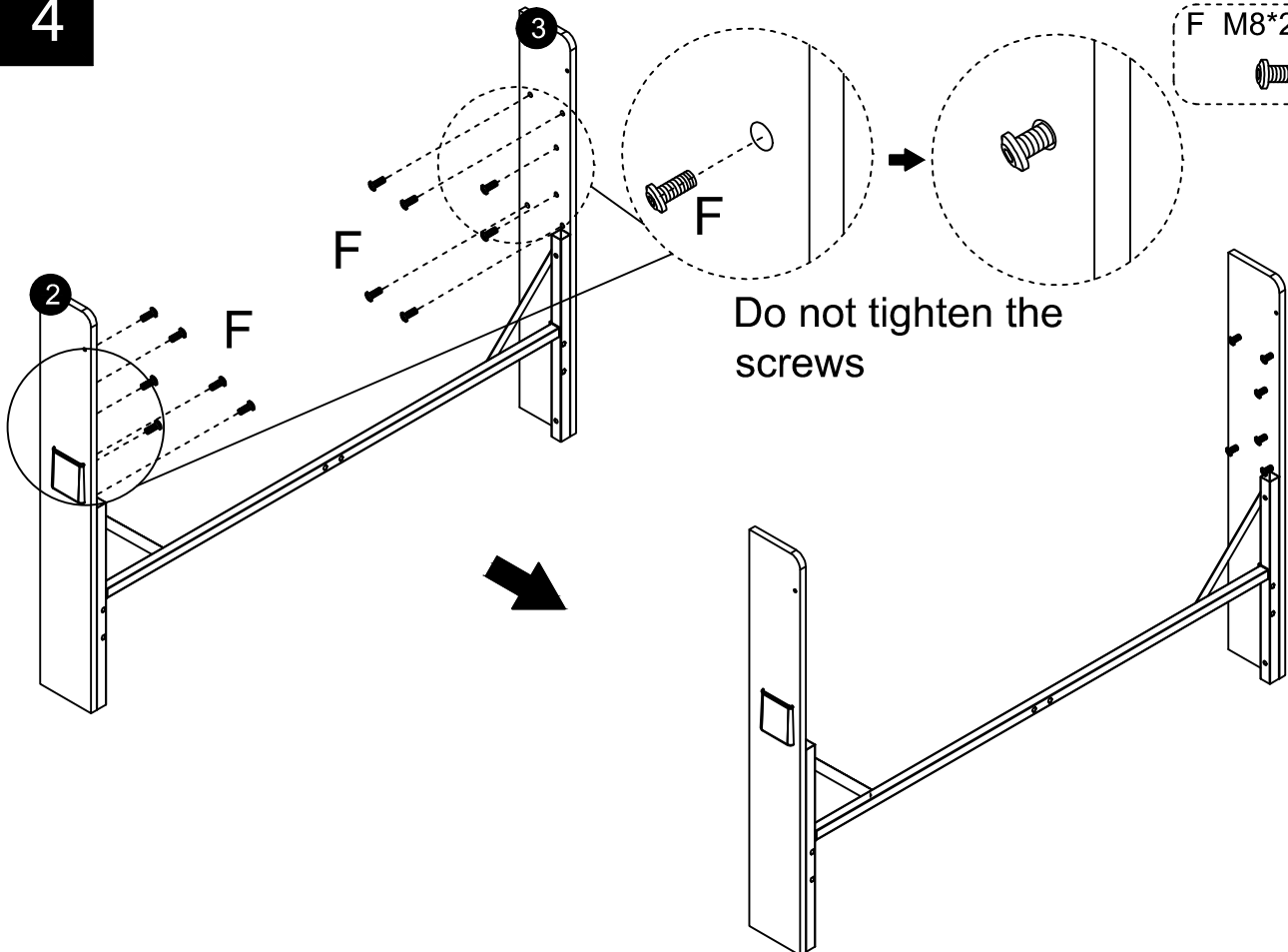

5

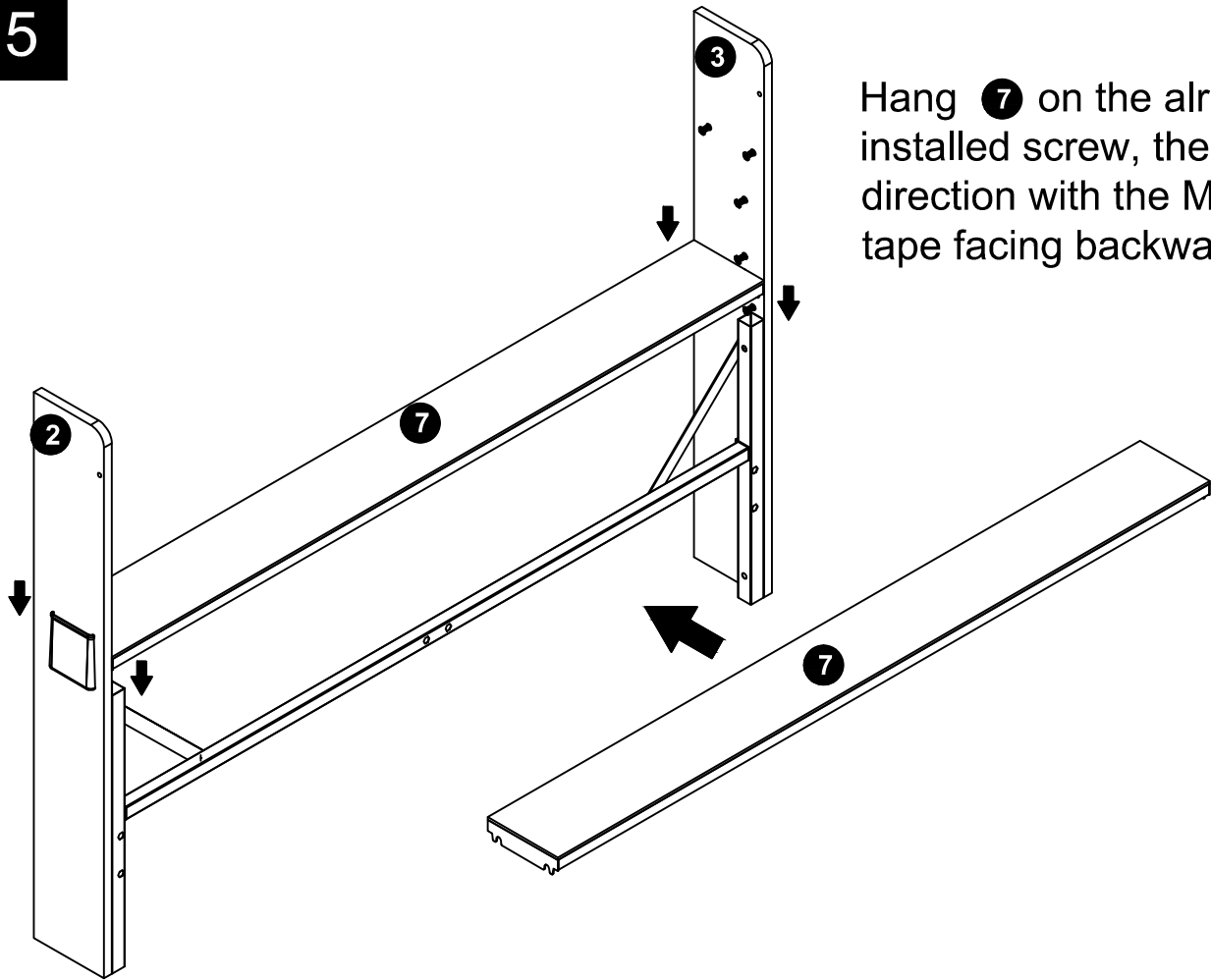

Hang 7 on the already installed screw, the direction with the Magic tape facing backwards

6

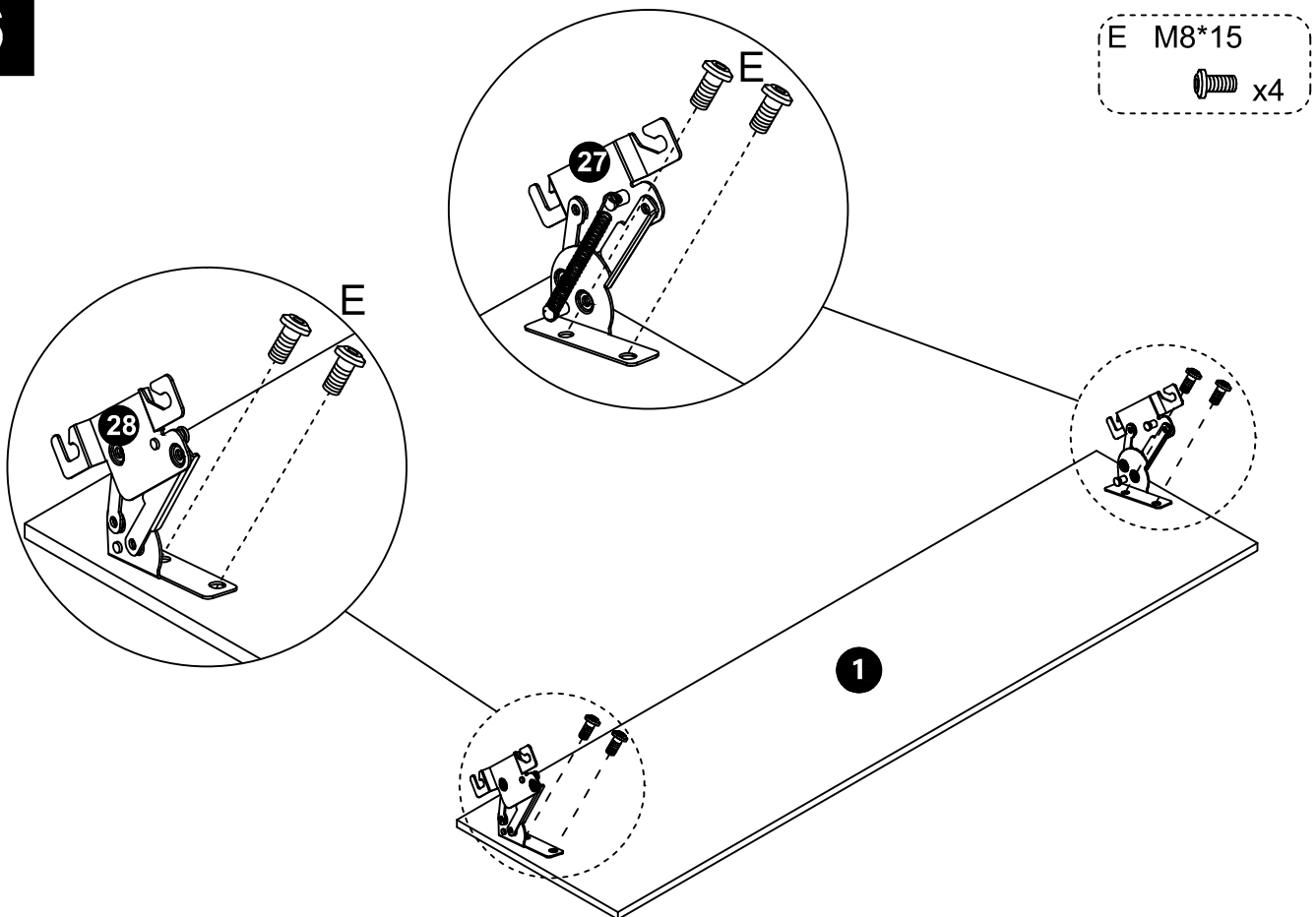

7

Hang **1** on the  
already installed  
screw

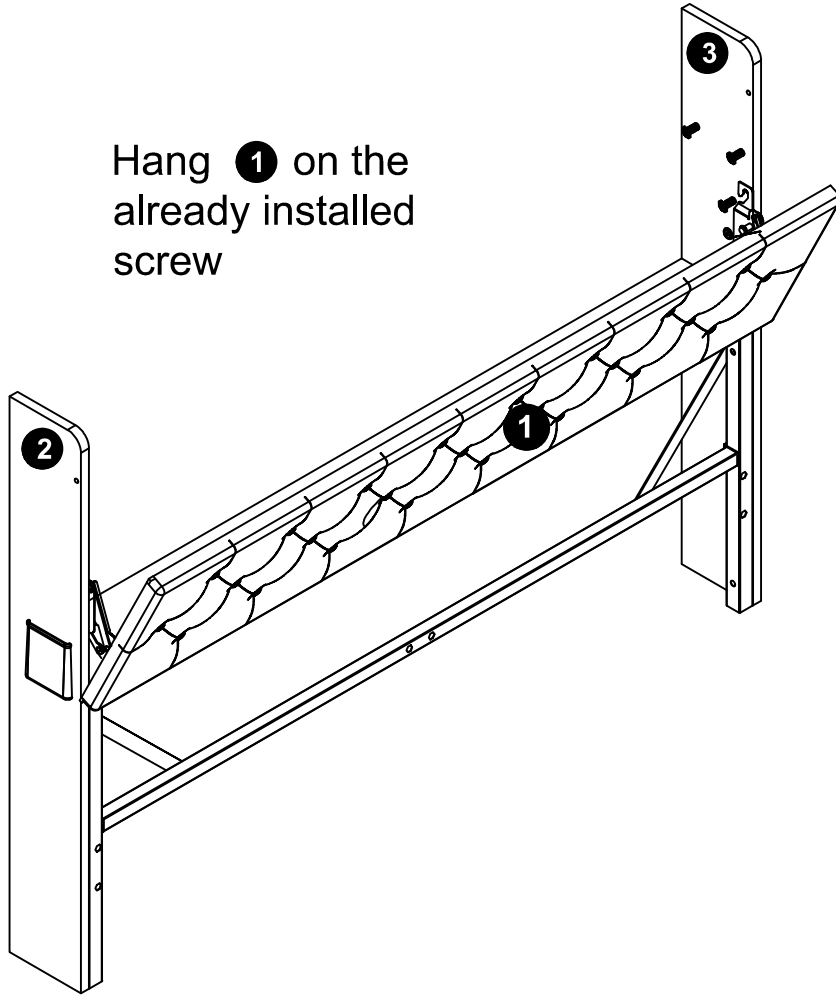

Hang it up first

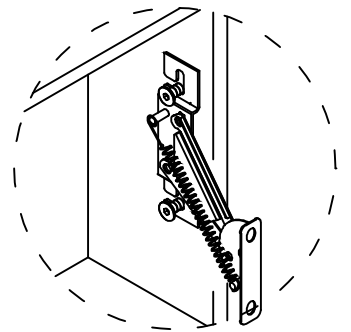
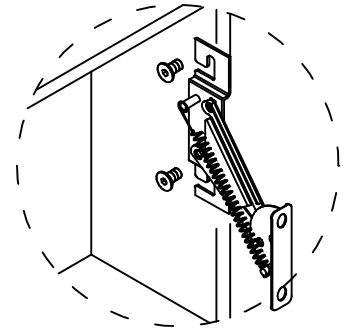

8

C M6\*30

x4

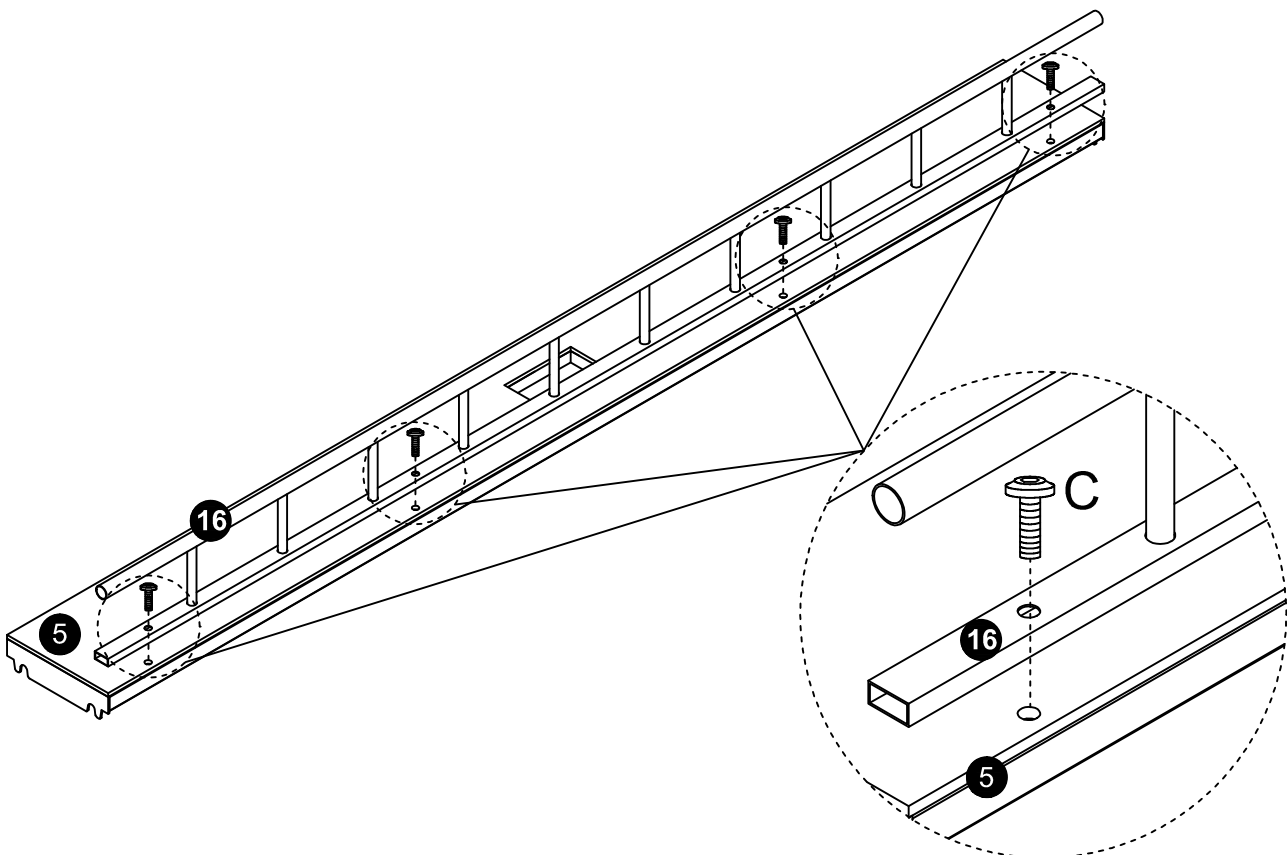

9

B M6\*25  
x4

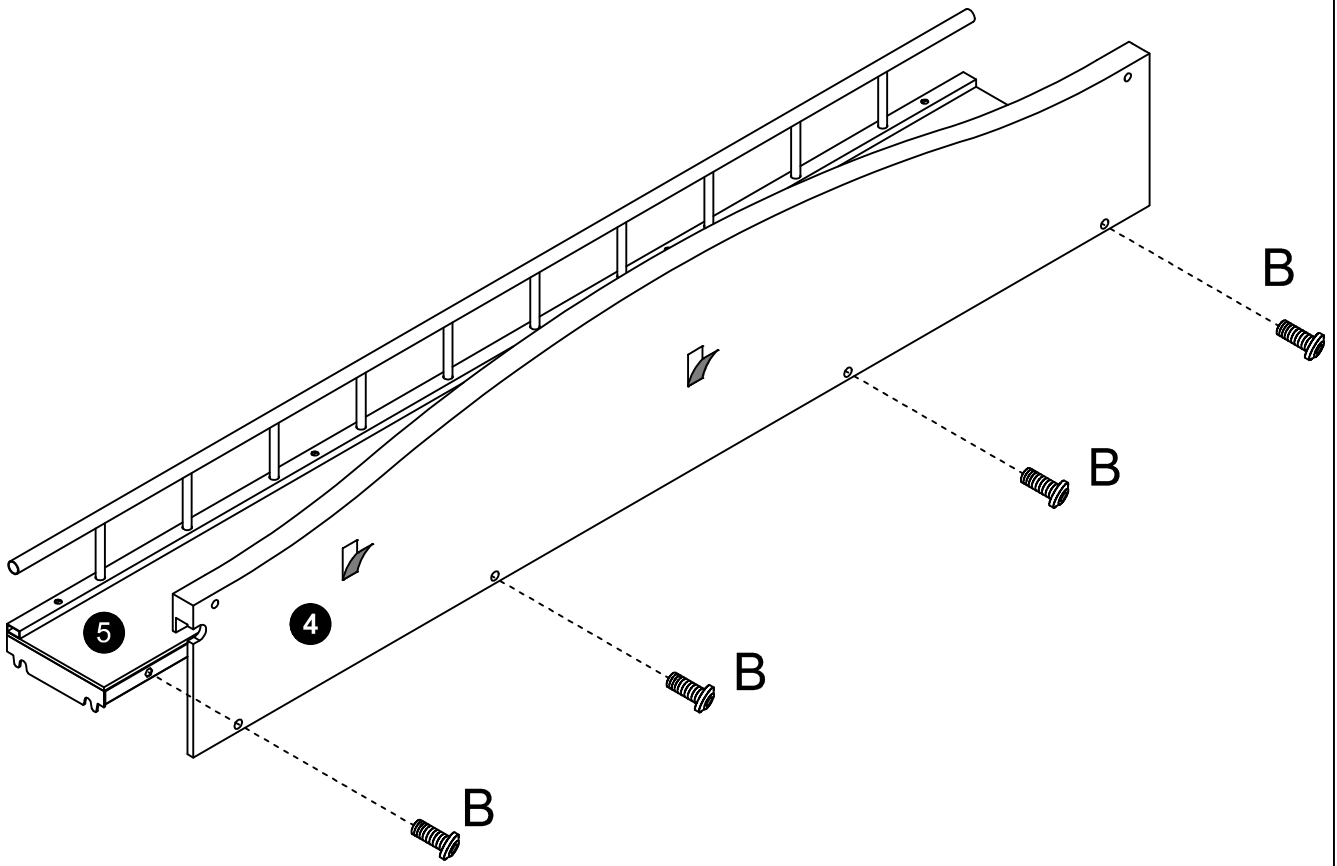

10

D M6\*45  
x2

Hang the components from step 3 onto the installed screws

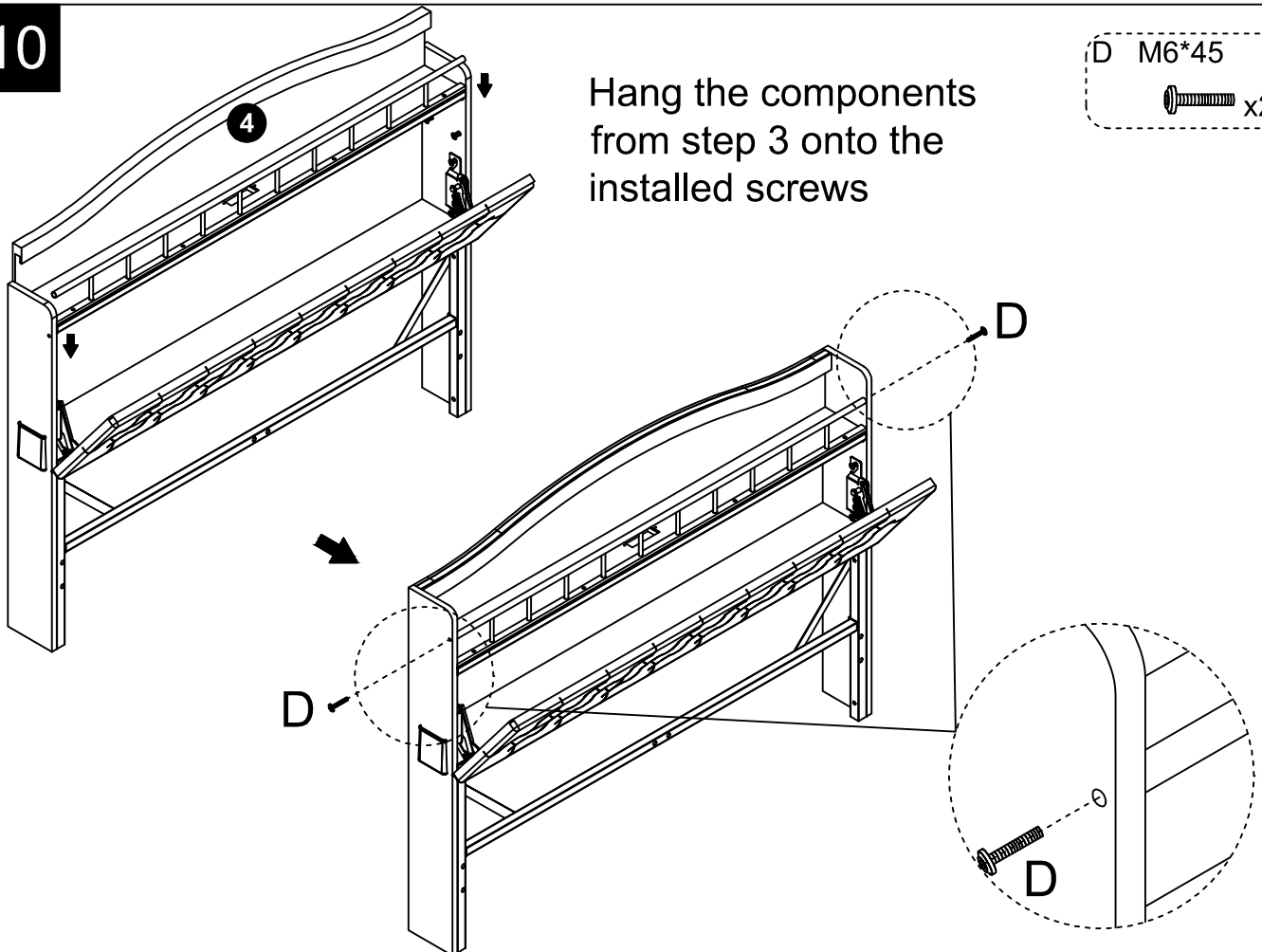

11

Tighten the screws of steps one and four before completing this step

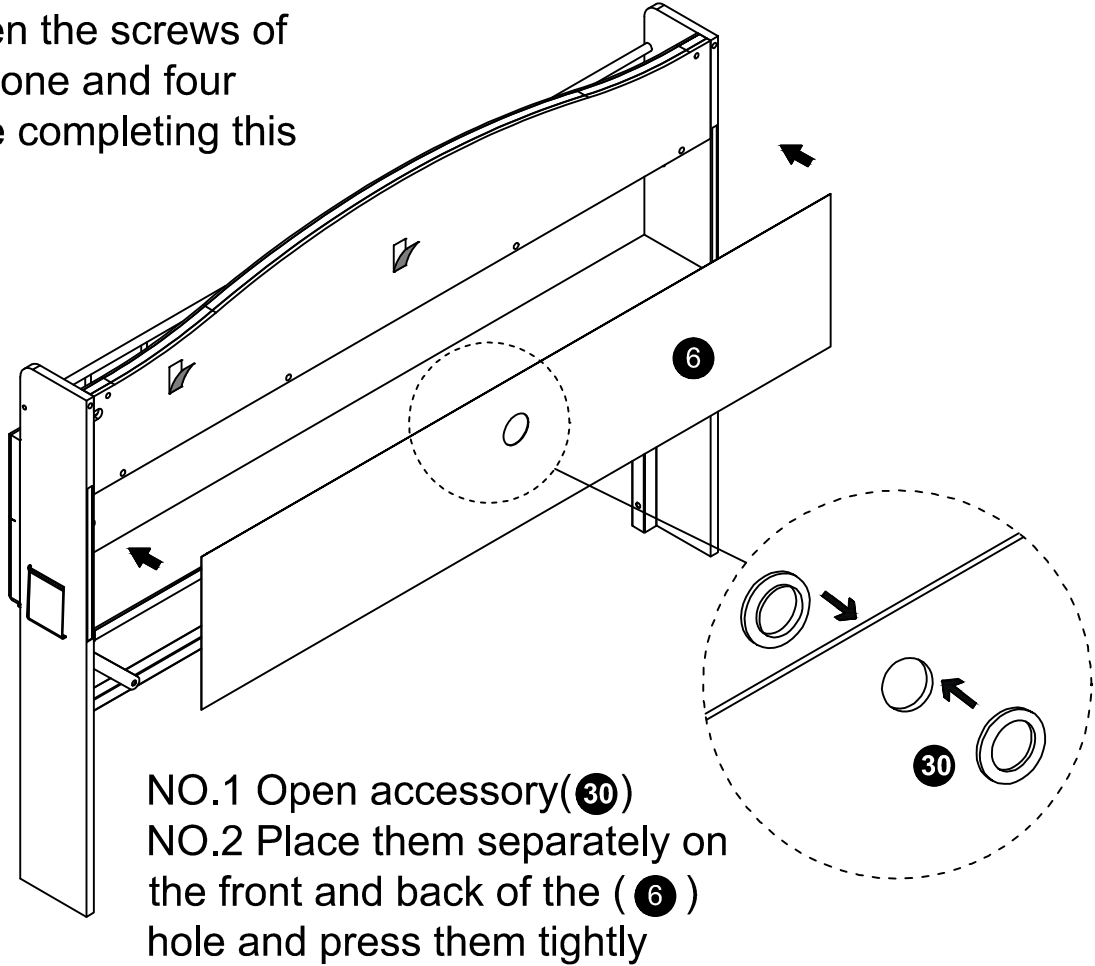

NO.1 Open accessory(30)  
NO.2 Place them separately on the front and back of the (6) hole and press them tightly

12

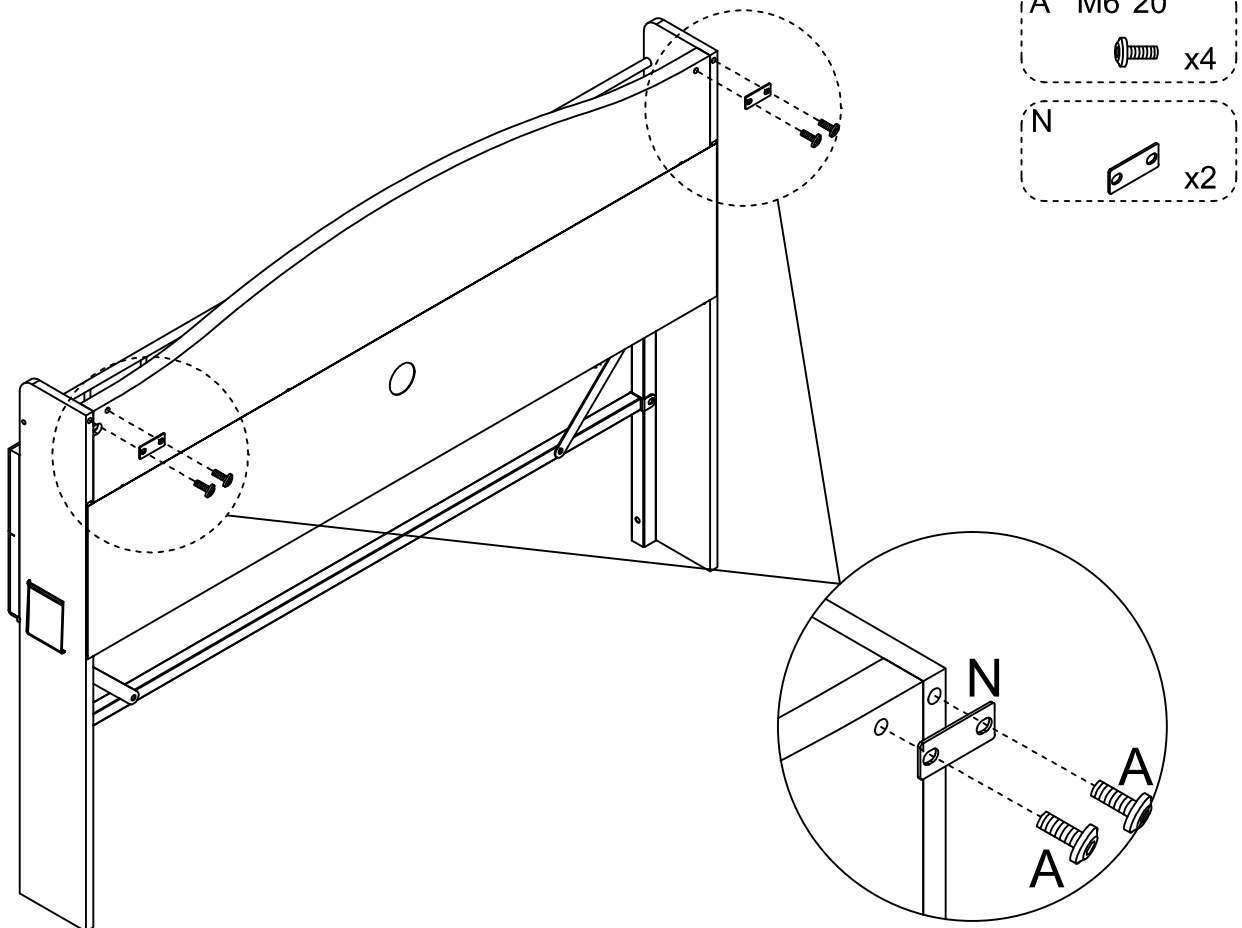

- A M6\*20 x4
- N x2

13

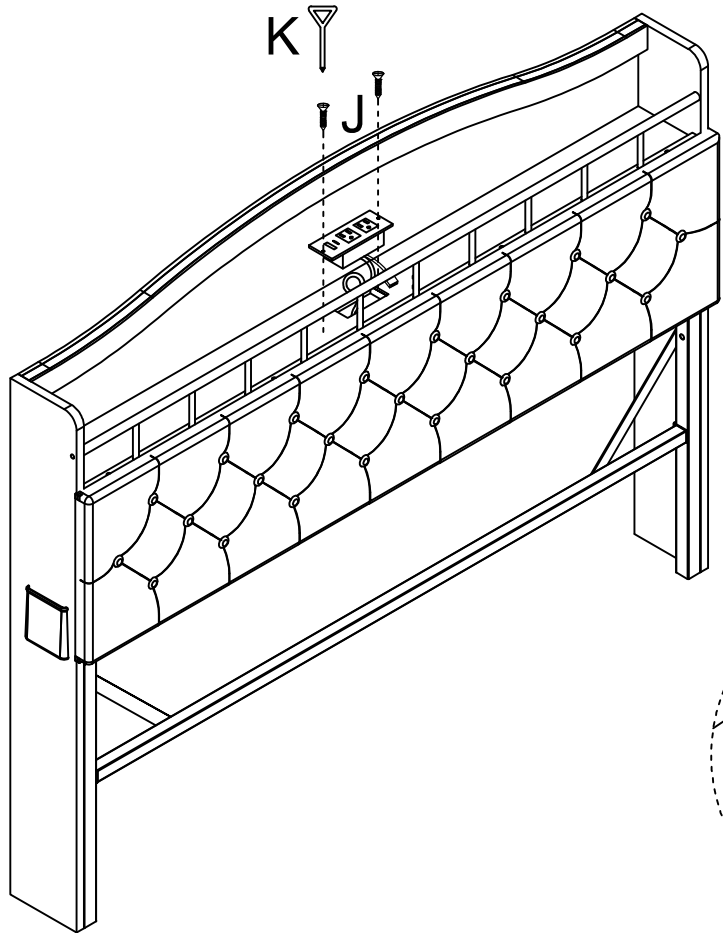

J M3\*12  
x2

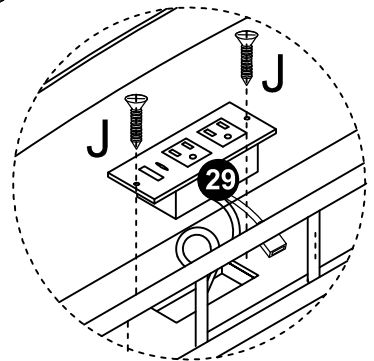

14

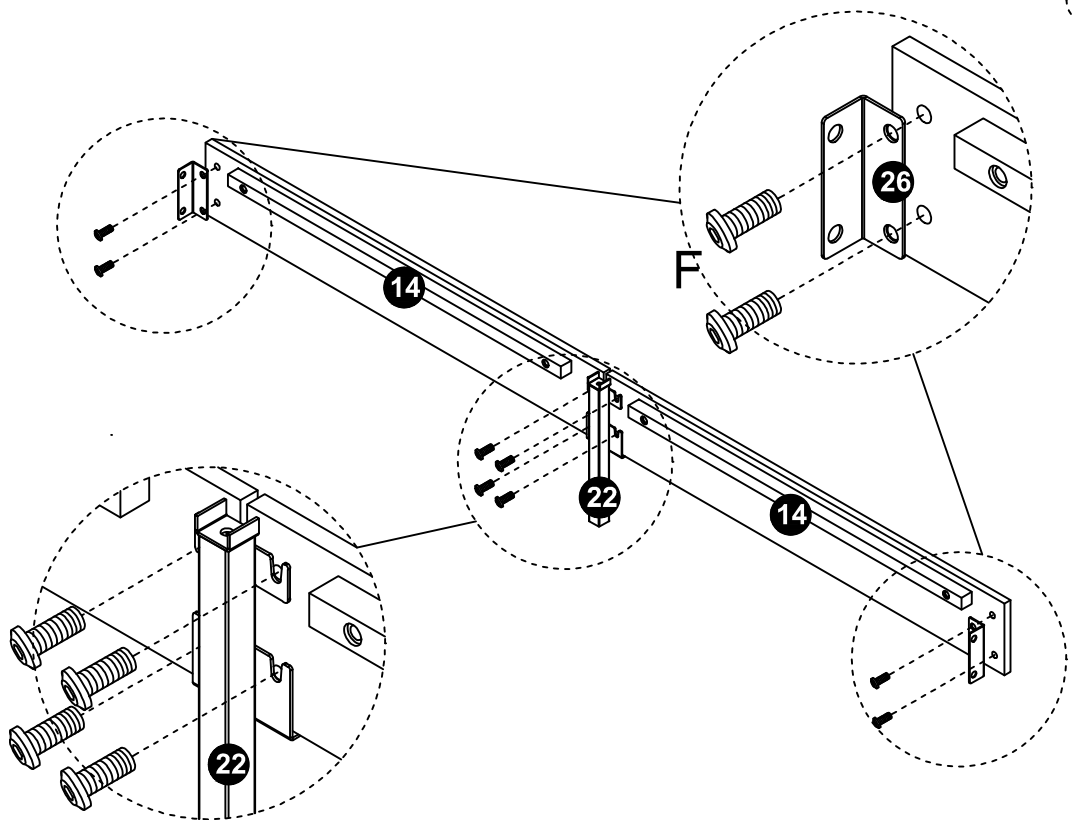

F M8\*20  
x16

X 2

15

F M8\*20  
x8

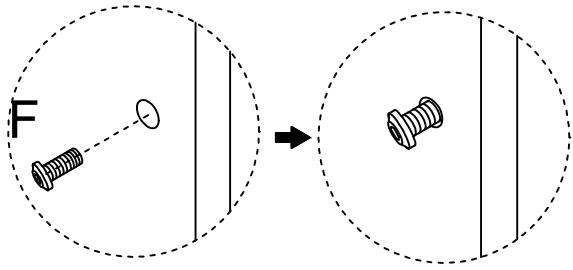

Do not tighten the screws

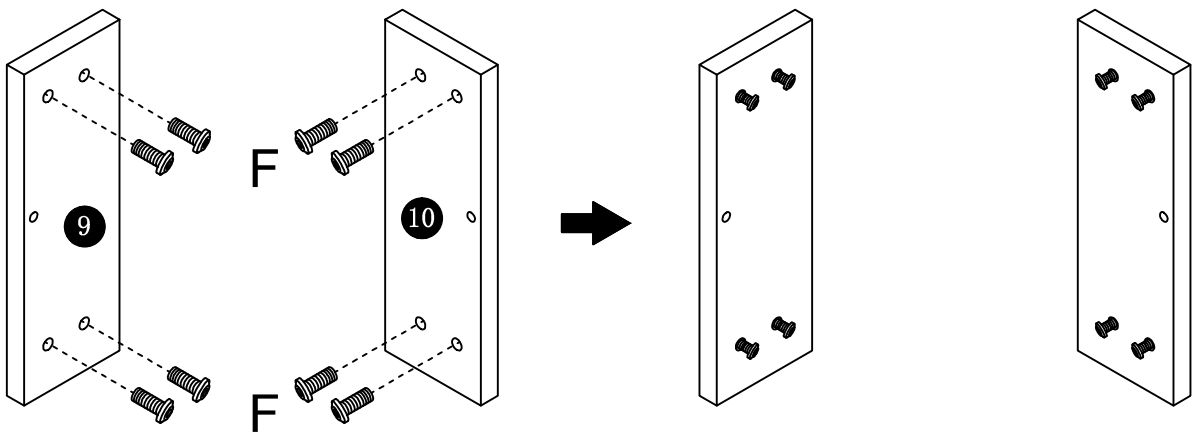

16

C M6\*30  
x4

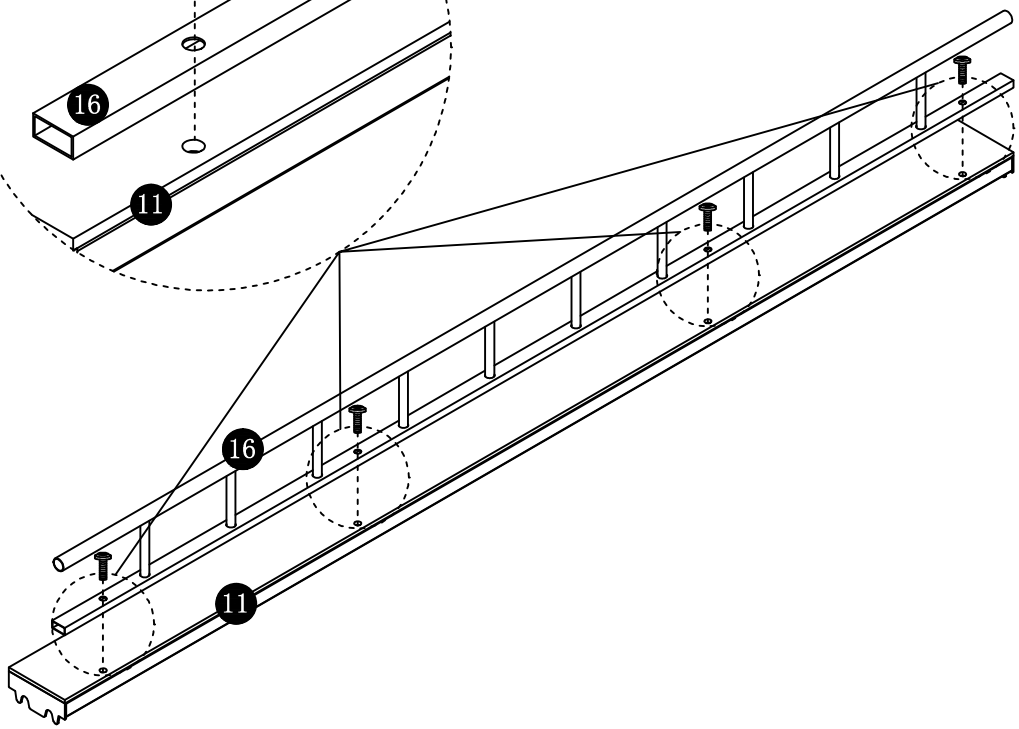
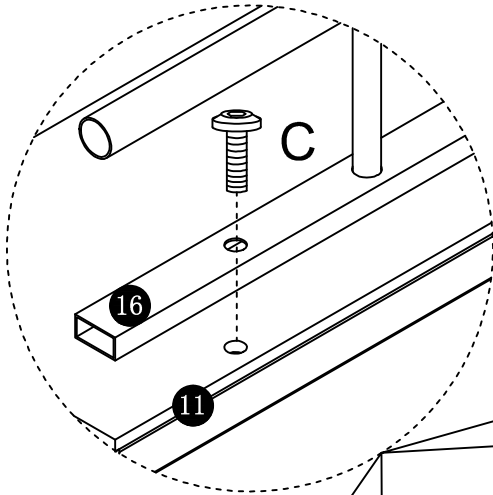

17

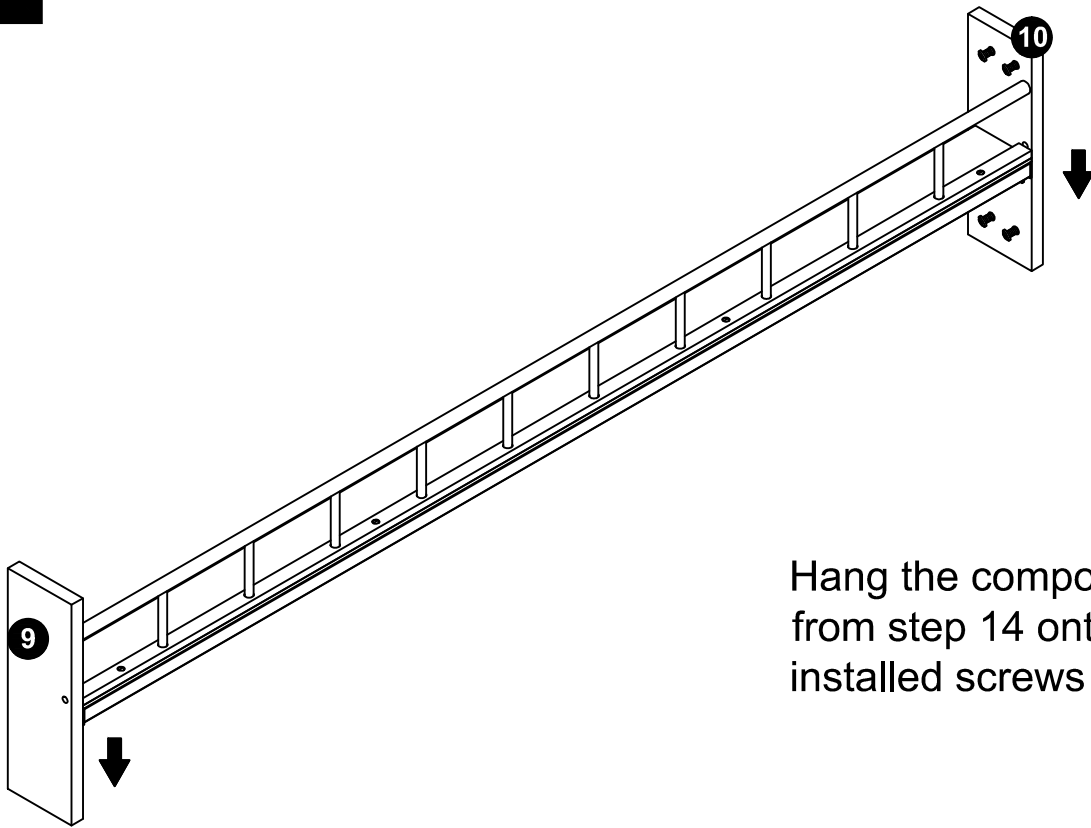

Hang the components from step 14 onto the installed screws

18

Pay attention to the direction of 8

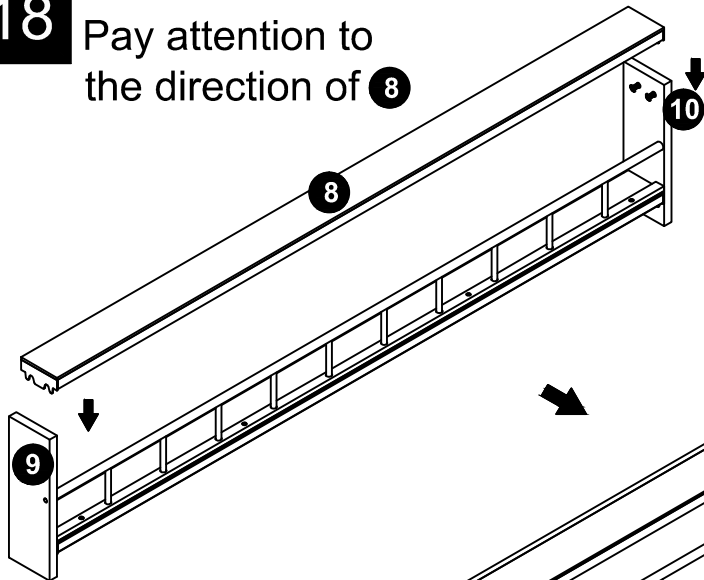

Hang 8 on the already installed screw

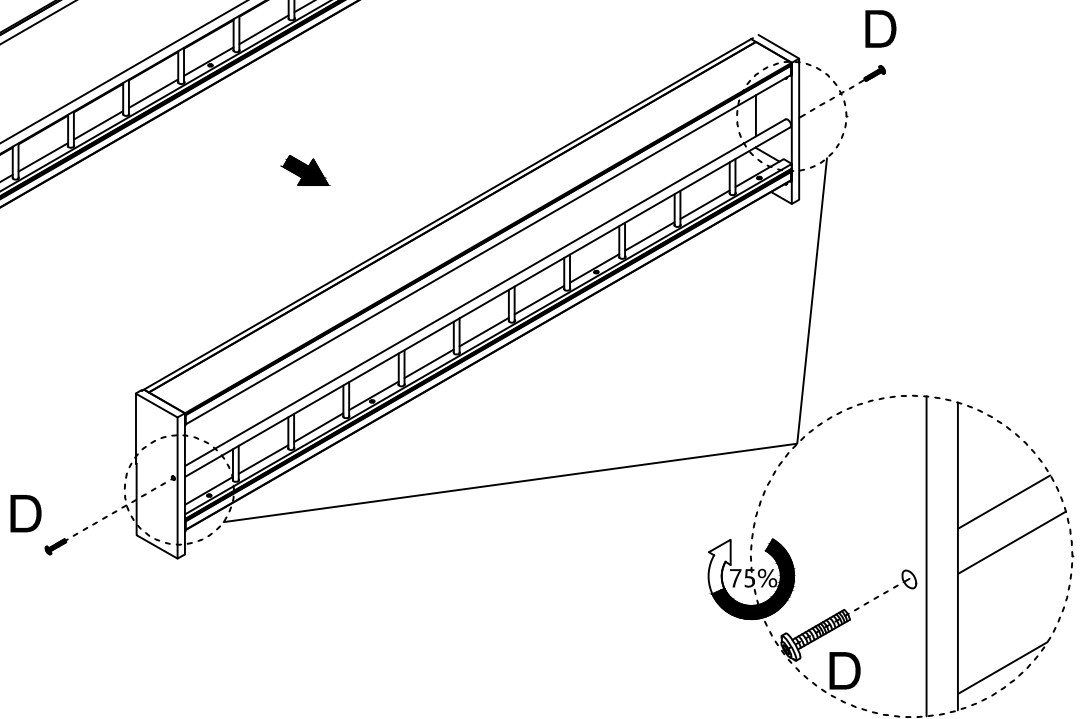

19

Step2

Tighten the D screw from the previous step

B M6\*25  
x8

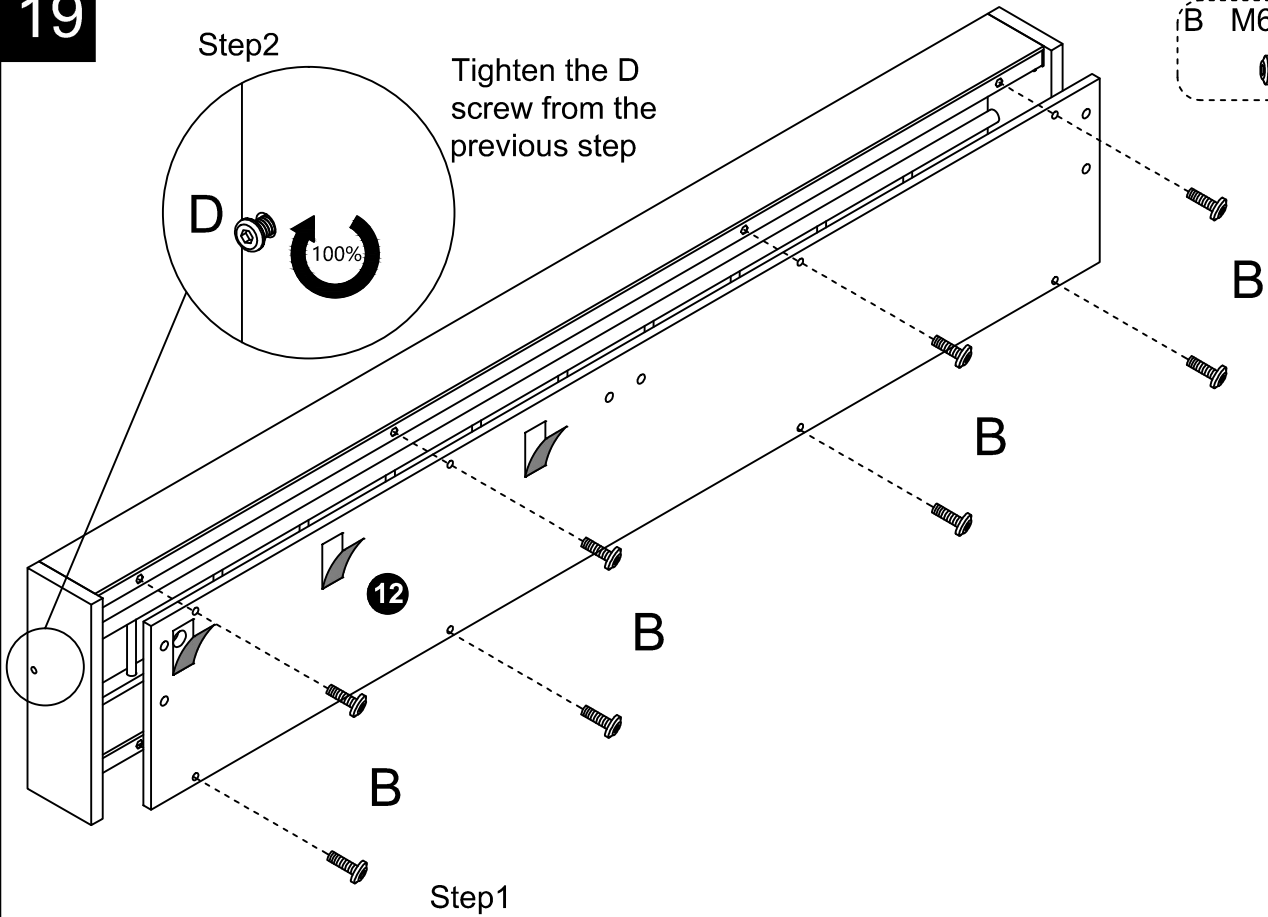

20



Please be sure to pay attention to the fact that there are mute stickers facing upwards during assembly, and the material feels soft to the touch

G M8\*35  
x4

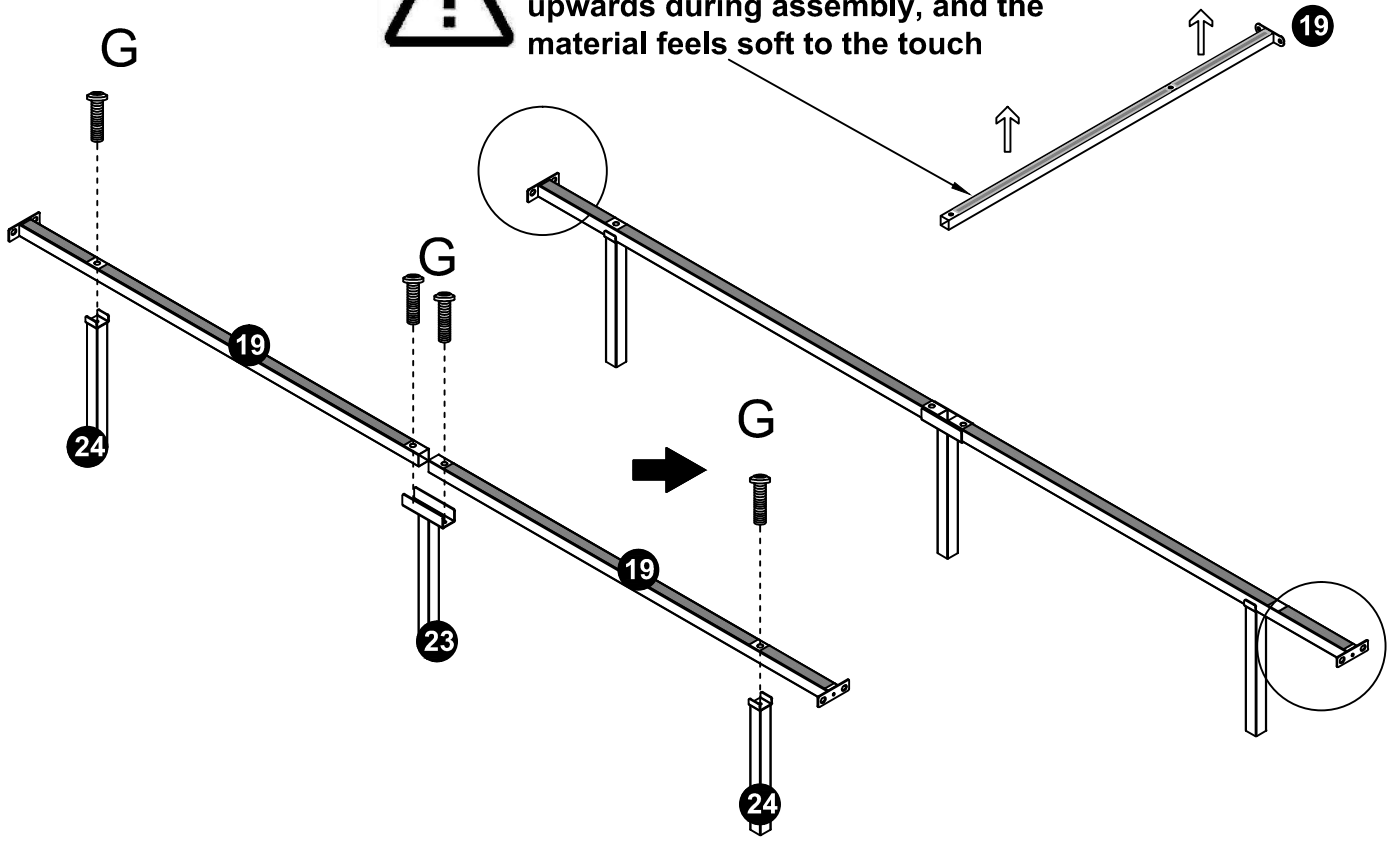

21

Please pay attention to the direction during installation

E M8\*15  
x6

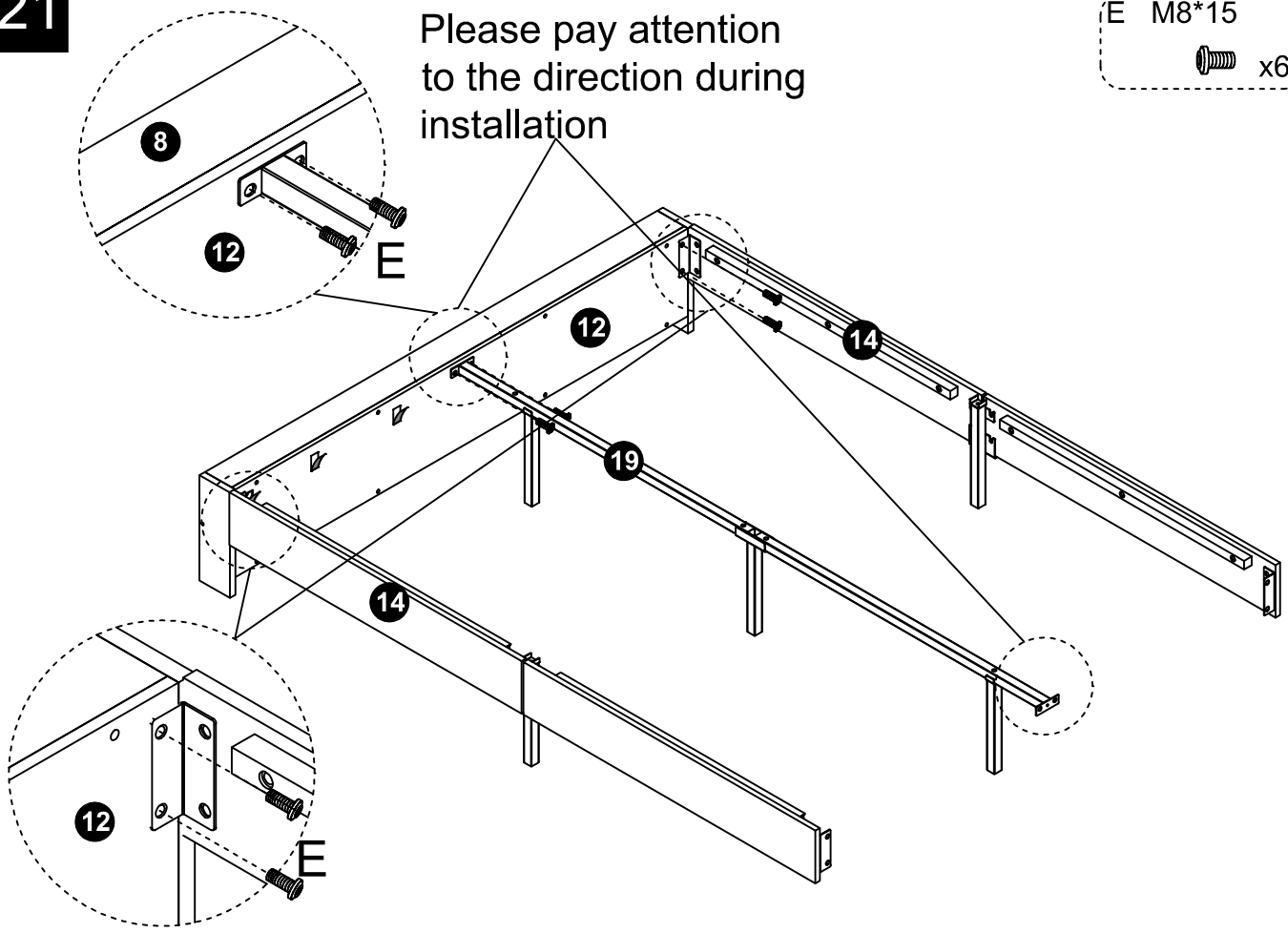

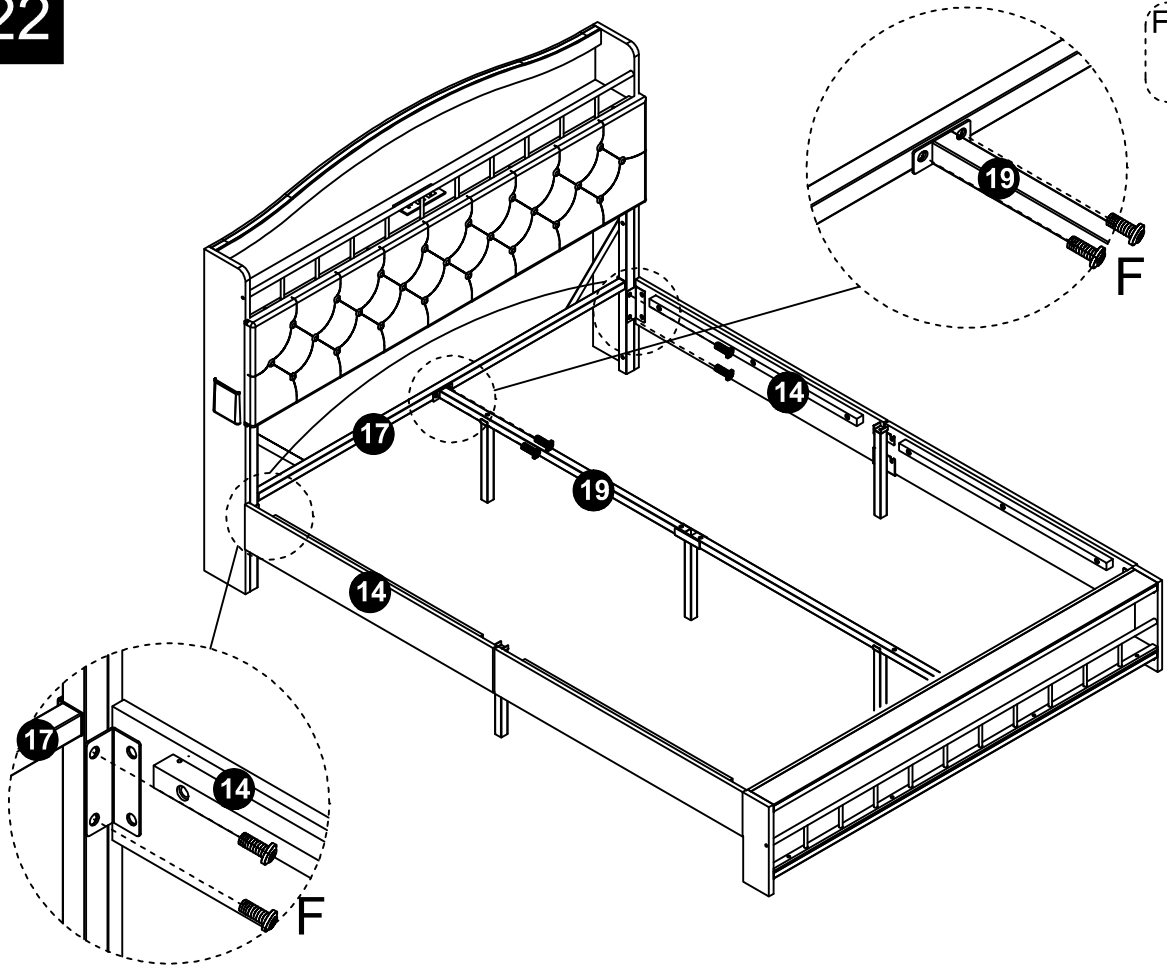

22

F M8\*20  
x6



23

G M8\*35  
 x2

I M8\*50  
 x1

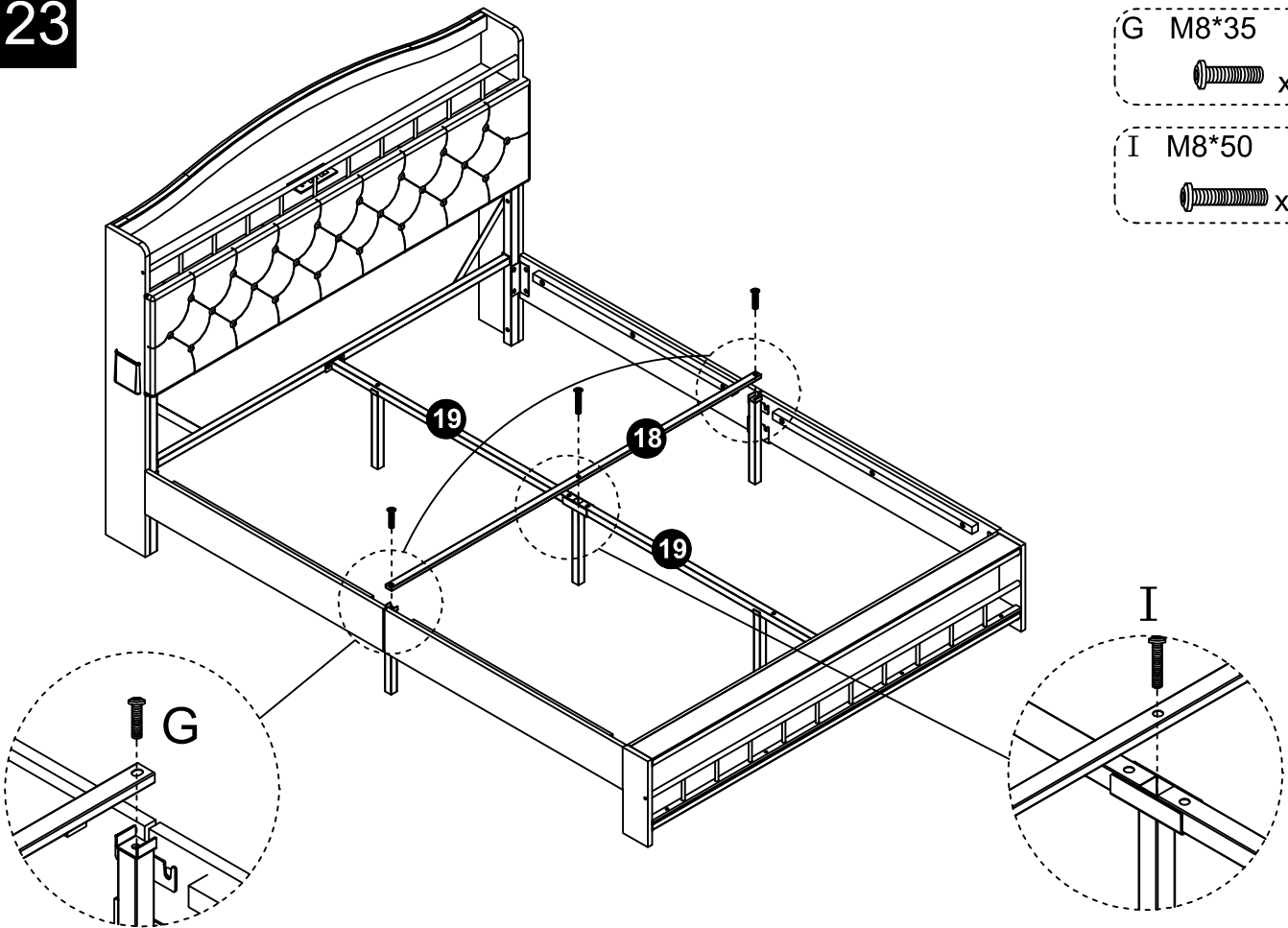

24

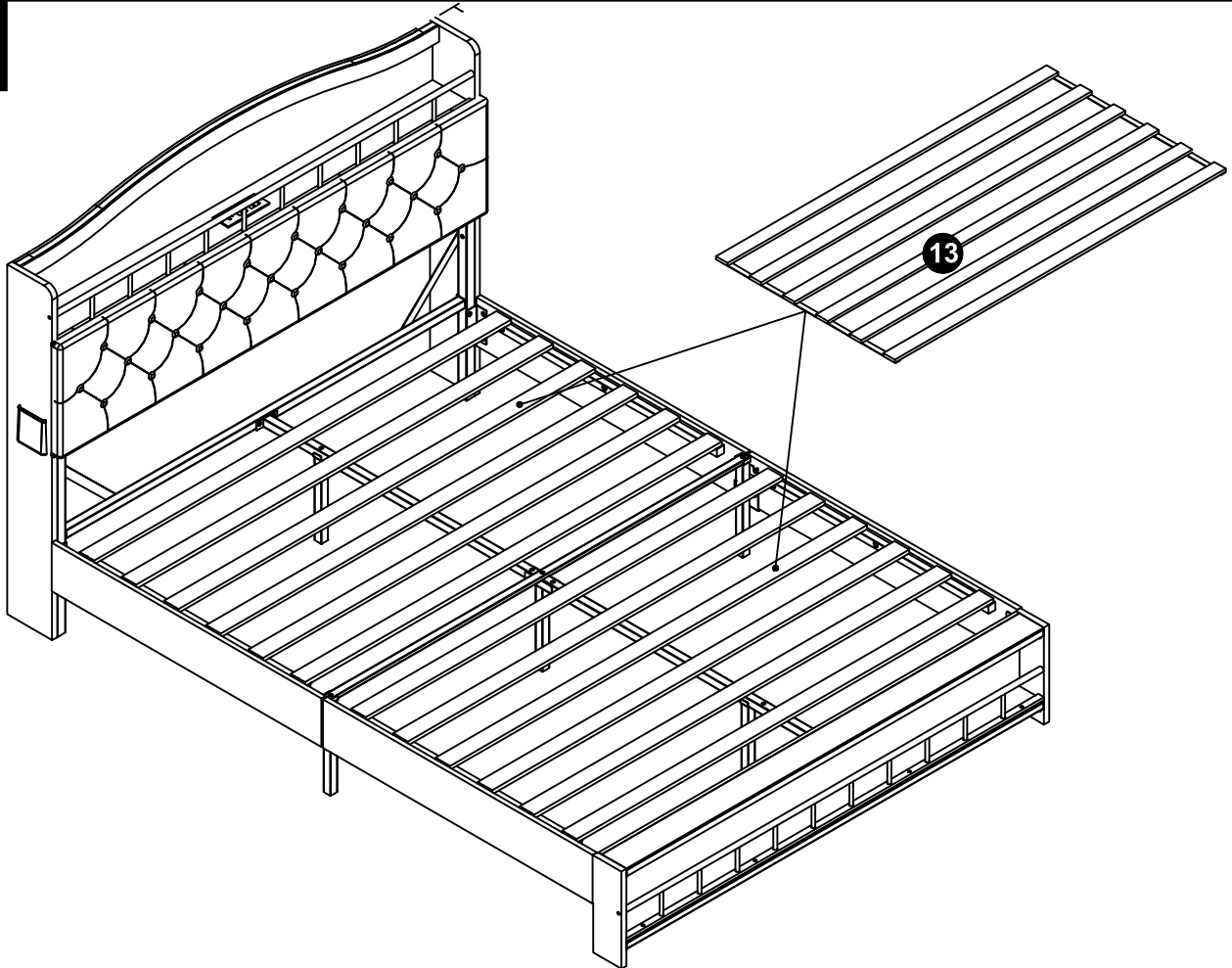

**LED related accessories**

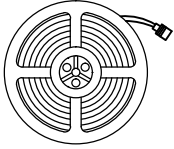

Light strip X2



Remote control X1

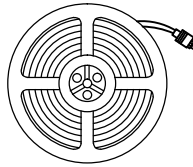

light strip  
2PCS



Pull out  
and unfold

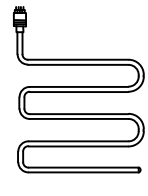

light strip

Stick the light strip on the  
inside of the groove

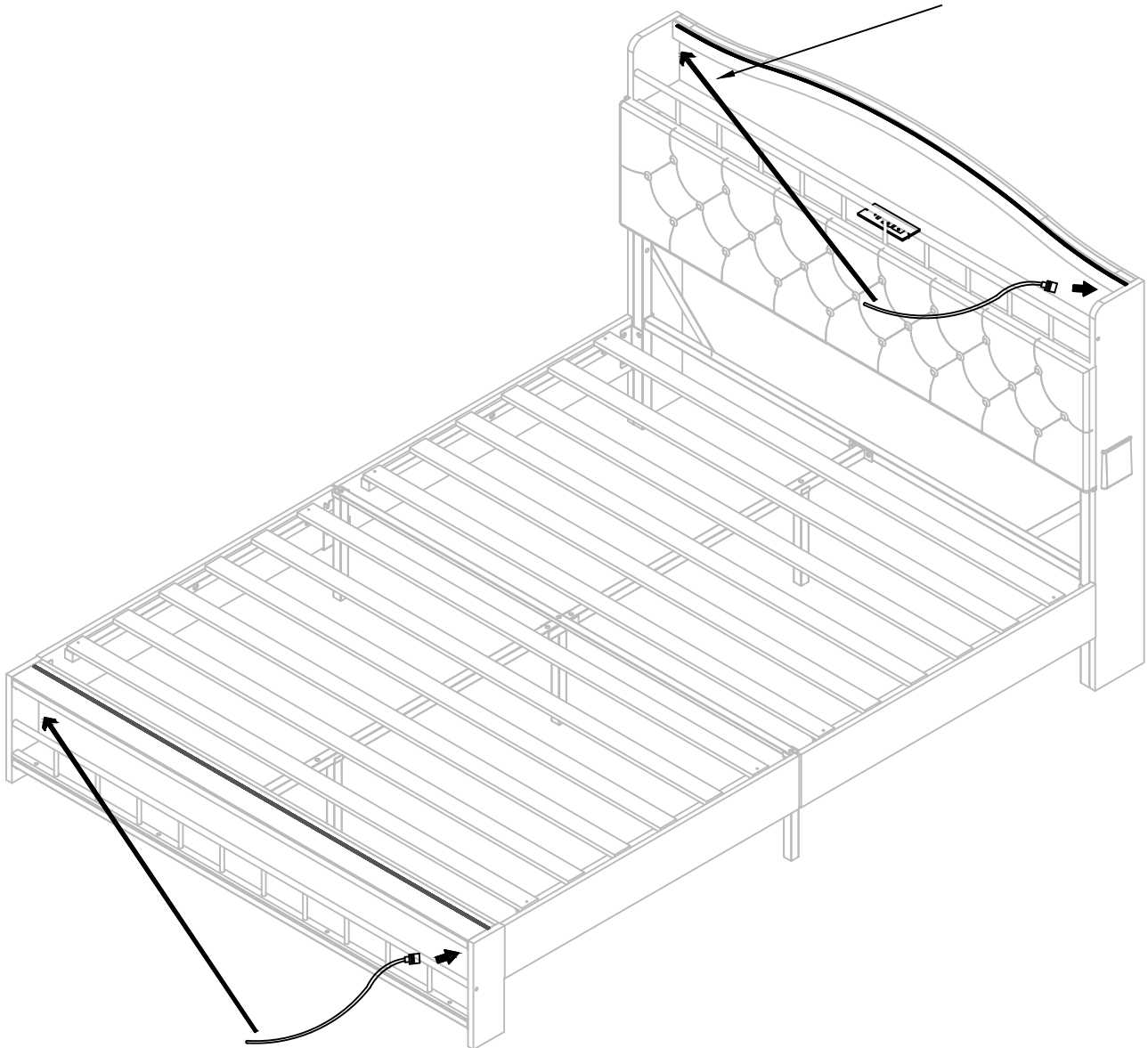

Stick the light strip on the  
inside of the groove

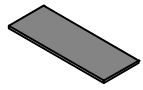

Magic tape  
8PC

You can use Magic tape to stick the connecting wire of the light strip anywhere

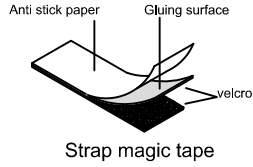

When the wires are disordered, tear off the anti stick paper, paste it on the place where the wires pass, and then bind the wires.

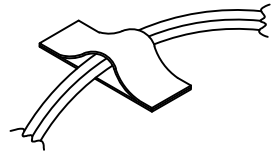

Use the Magic tape we provide to stick the connecting wire of the light strip onto the iron component

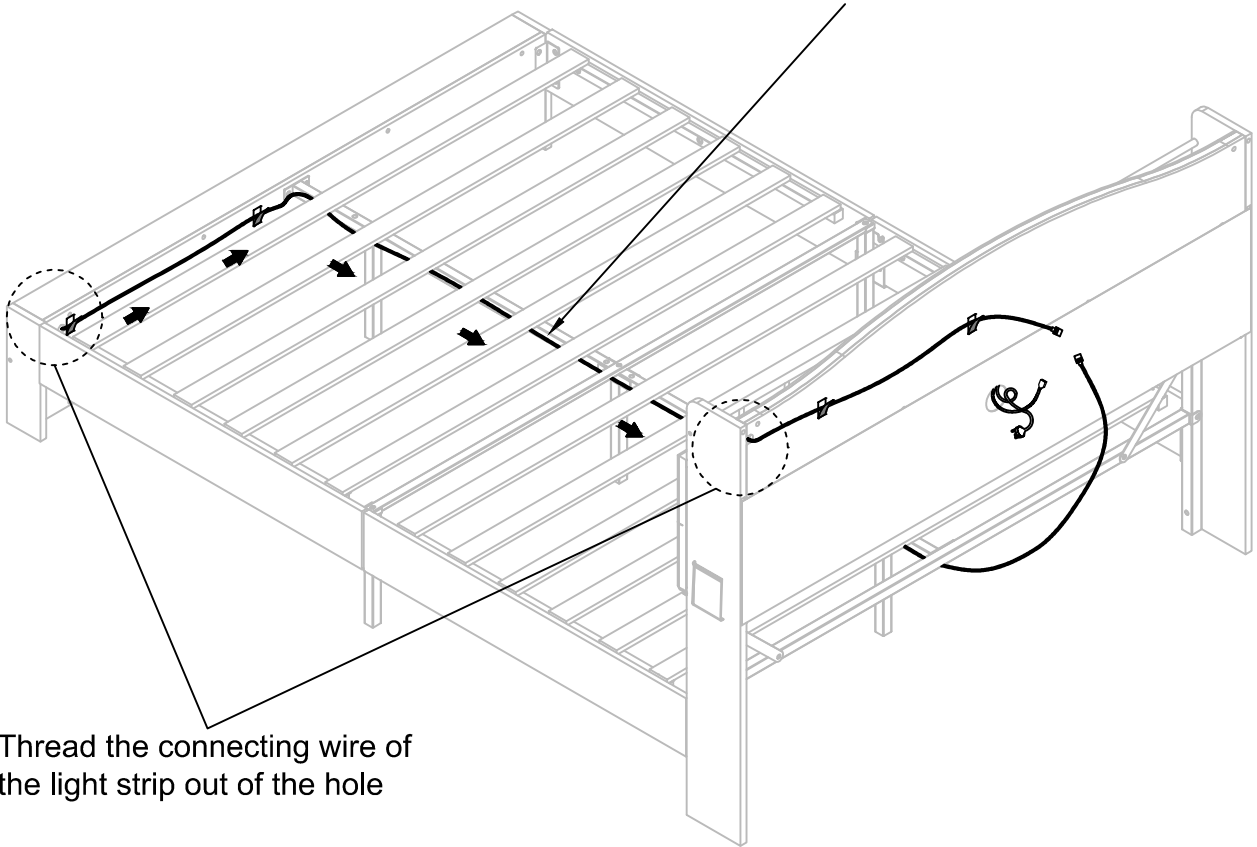

Thread the connecting wire of the light strip out of the hole

Clip in the harness  
Magic Band

Stick to

