

HOW TO Separate and Install Drawer Slides



Prior to installation, your drawer slides must first be separated. Follow these simple steps to separate and properly attach your slides.

1

Extract each runner from its mount and cage.

- Fully extend the slide and push up on the lock lever. (See picture A)
- Grab the runner and pull it out from the mount and cage.
- Set runner aside for now.
- Repeat for other runner.



2

Fasten the Mount and Cage pieces to the inner upright cabinet panels.

- Extend the slide and fasten the screws into the proper holes as indicated in your assembly instructions (See picture B)
- Fully open the slide and install the screw closest to the slide end.
- Adjust the slide position to insert the remaining screws. (See picture C)
- Repeat for other side.

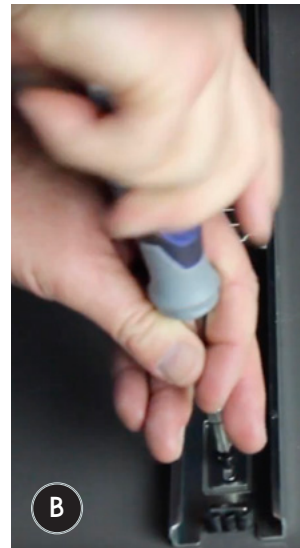

3

Complete drawer slide assembly.

- Fasten runners to the sides of your drawer as indicated in the assembly instructions.
- Slide the drawer into the mount and cage pieces attached to the inside of the cabinet. (See picture D)

