

# Full Bed

## Assembly Instructions

### 1 Assembled View

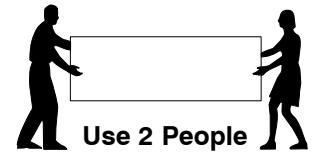
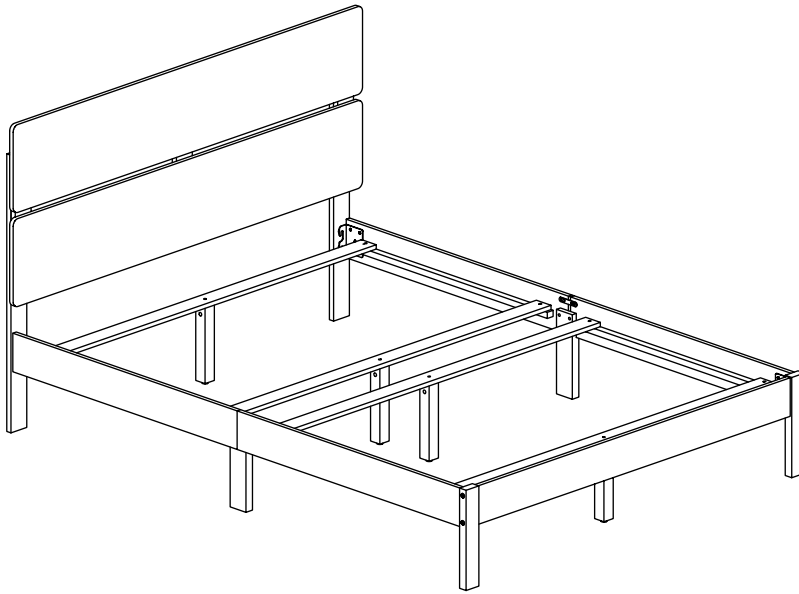

**Note:** Do not assemble using power tools. This can cause the bolts to be overtightened

### 2 Parts List

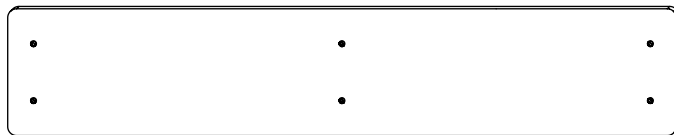

**A** Headboard Panel x 2

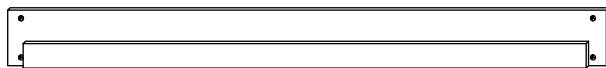

**B** Footboard Panel x 1

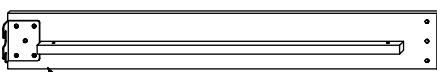

**C** Side Rail (Left Hand) x 2

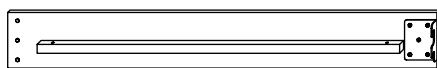

**D** Side Rail (Right Hand) x 2

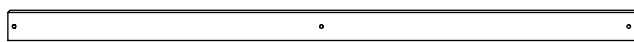

**E** Bed Slats x 4



**F** Headboard Support Bar x 3



**G** Center Support Leg x 2



**H** Support Leg x 4



**J** Headboard Post (Left Hand) x 1



**K** Headboard Post (Right Hand) x 1



**L** Footboard Post (Left Hand) x 1

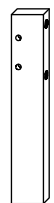

**M** Footboard Post (Right Hand) x 1

# Full Bed

## Assembly Instructions

### 3 Hardware List



1 M6 x 90mm JCB  
x 4

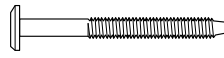

2 M6 x 60mm JCB  
x 4



3 M6 x 40mm JCB  
x 8

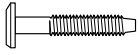

4 M6 x 35mm JCB  
x 4



5 M6 x 30mm JCB  
x 20



6 M6 x 20mm JCB  
x 8



7 M6 x 15mm JCB  
x 4



8 Barrel  
Nut x 8



9 Wood Dowel  
(M10 x 40mm) x 2



10 Spring  
Washer x 24



11 Flat Washer  
x 24



12 Allen Key  
x 1

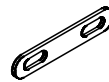

13 Bracket  
(2003) x 2

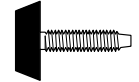

14 Adjustable  
Foot x 4

### 4 Assembled the Support Legs (H) to the Bed Slat (E).

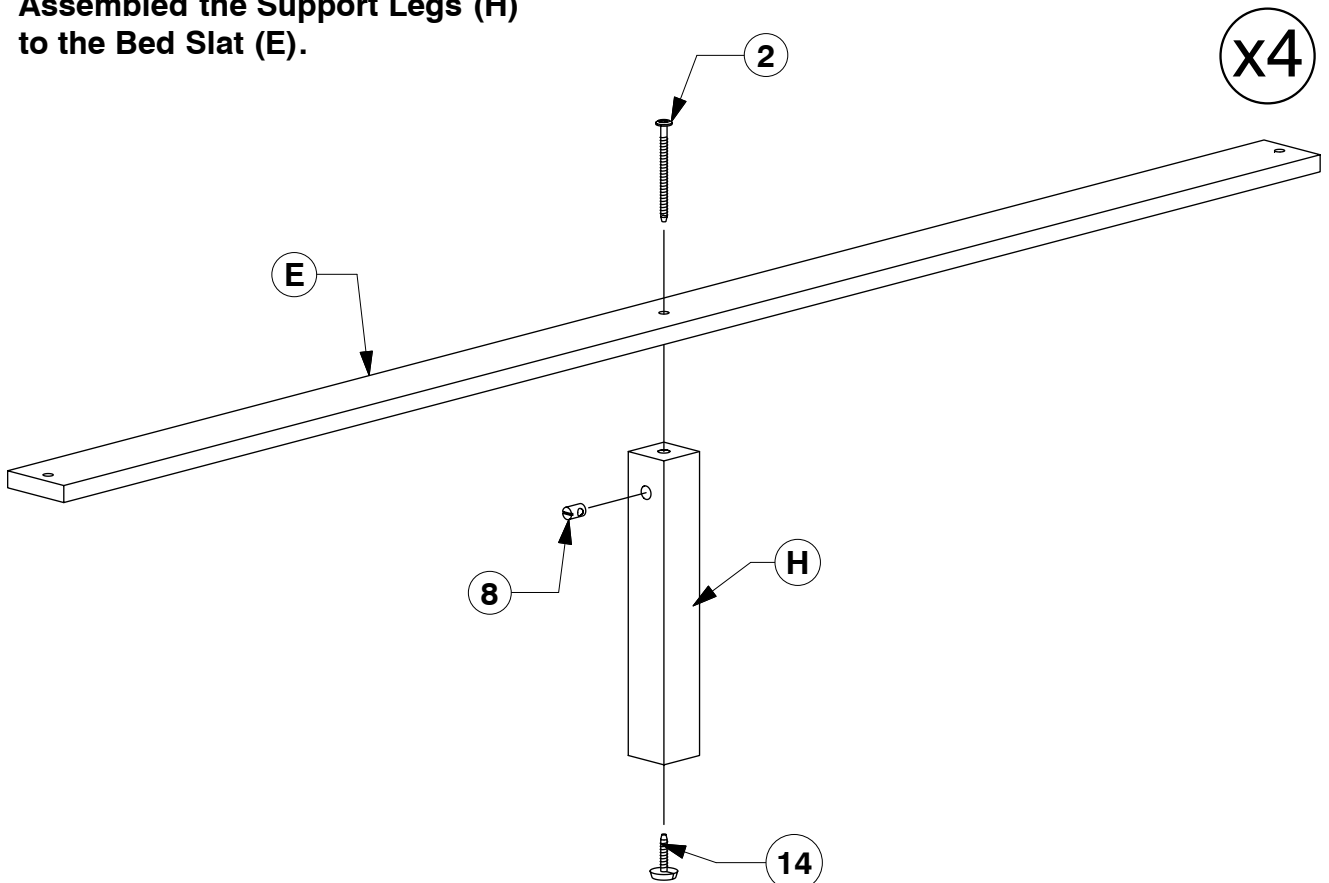

# Full Bed

## Assembly Instructions

- 5** Fit the Headboard Support Bar (F) to the Headboard Panel (A).

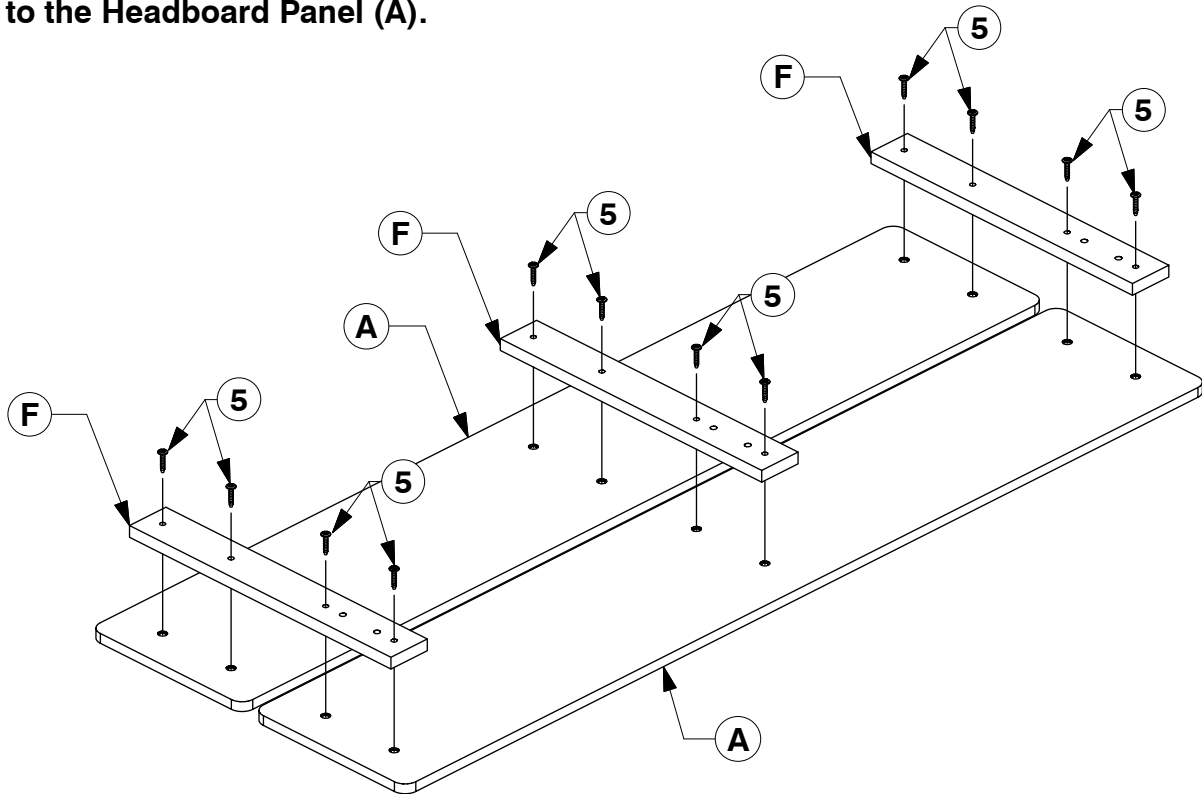

- 6** Fit the Headboard Post (J & K) to the Headboard Panel (A).

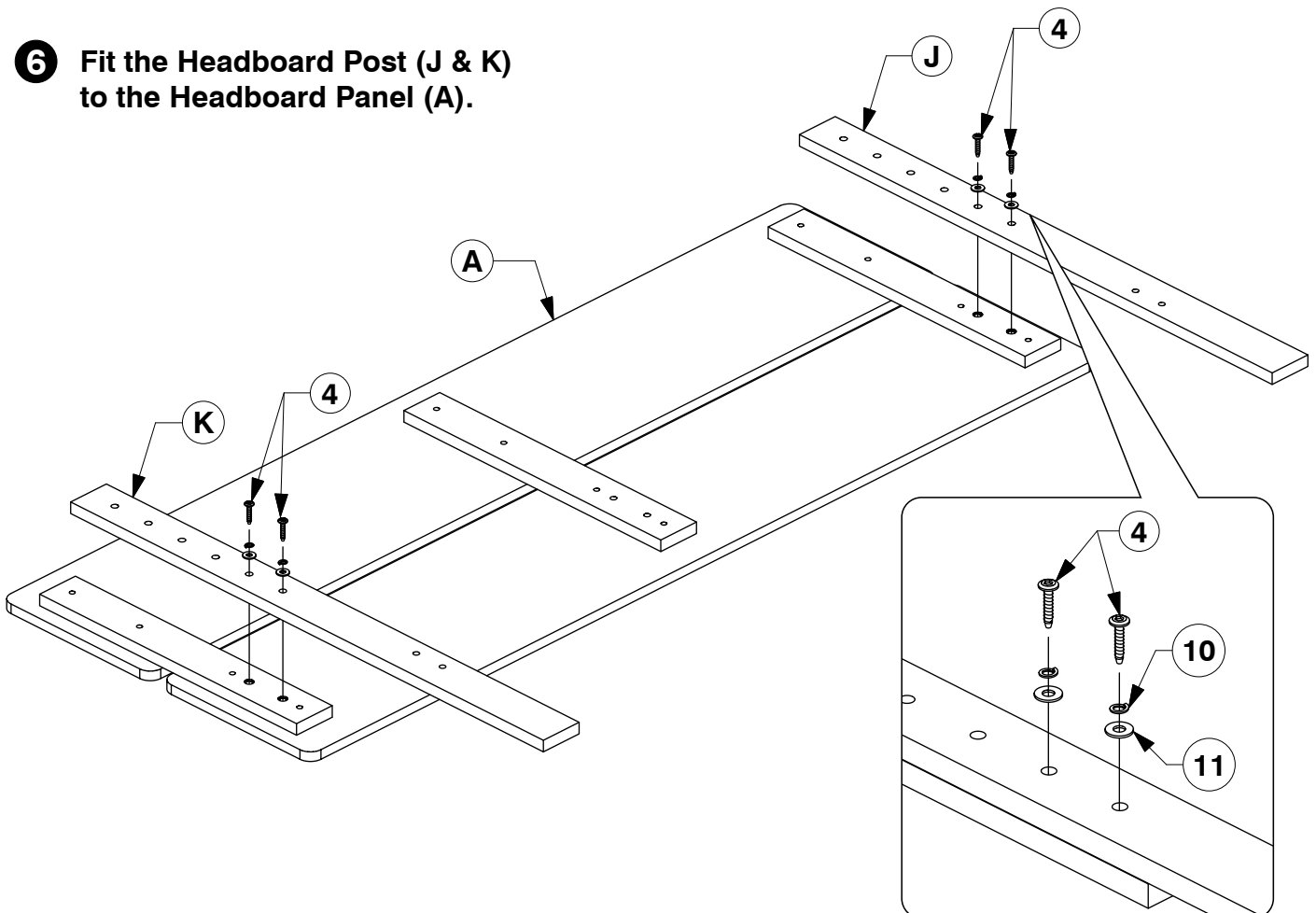

# Full Bed

## Assembly Instructions

- 7** Assemble the Footboard Post (L & M) to the Footboard Panel (B).

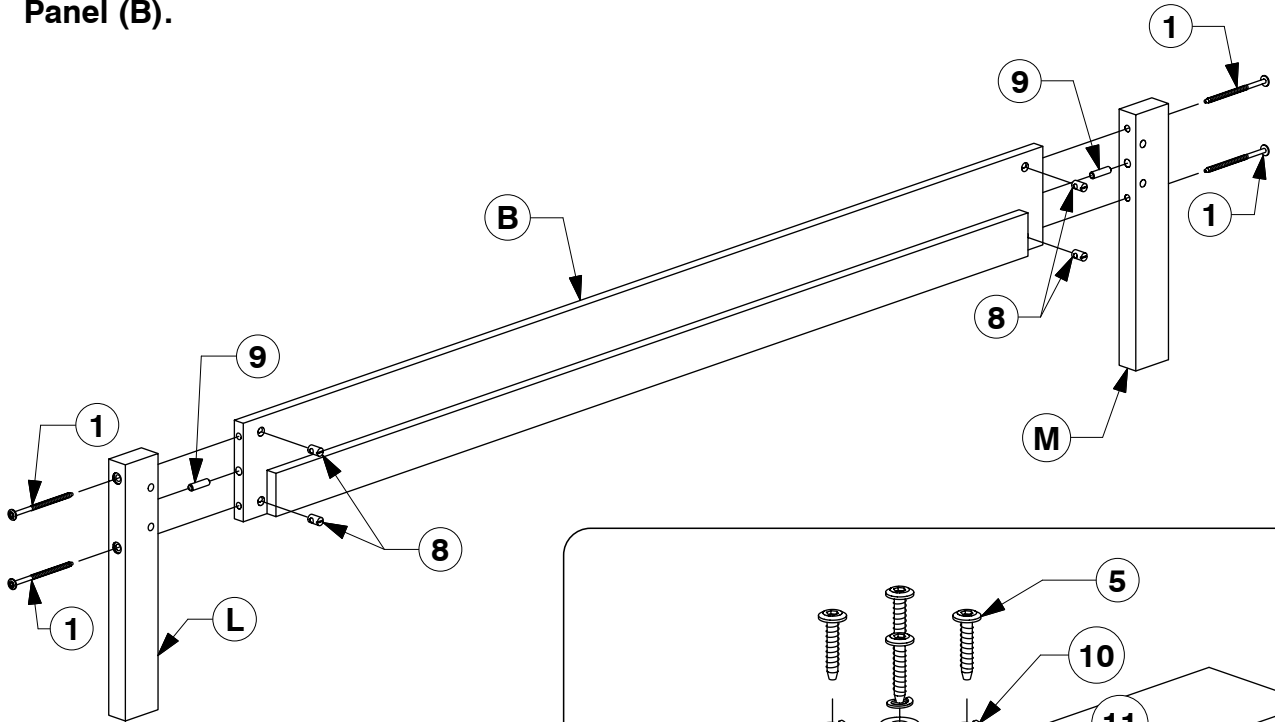

- 8** Fit the Center Support Leg (G).

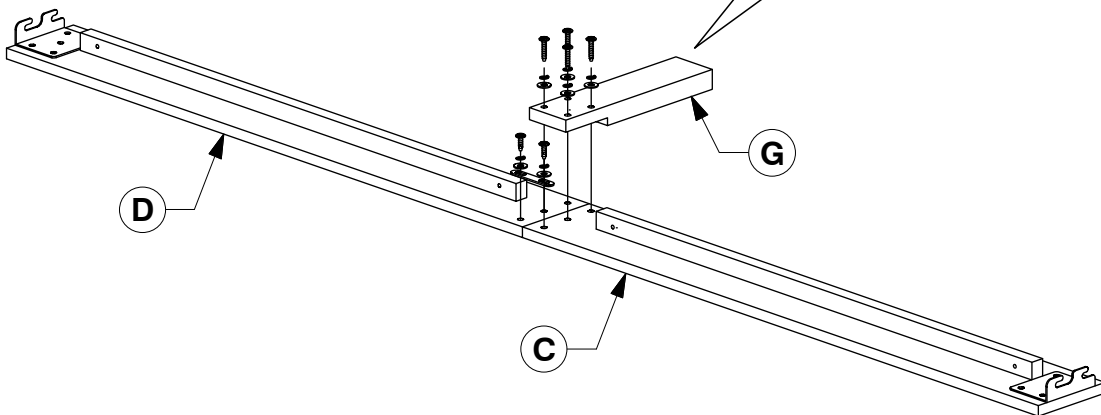
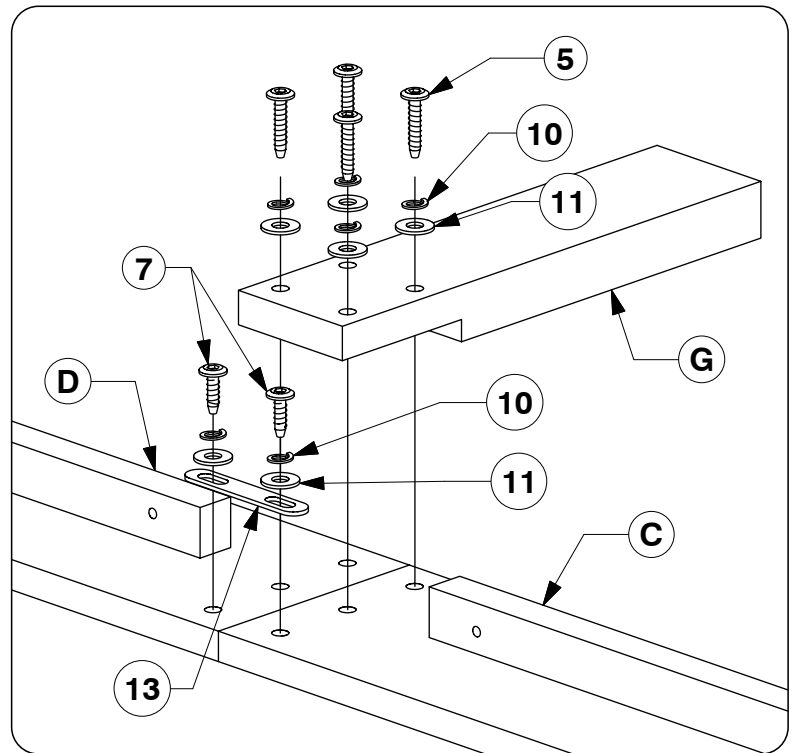

# Full Bed

Assembly Instructions

WII-1219

## 9 Assemble the Side Rail (C & D) to the Post.

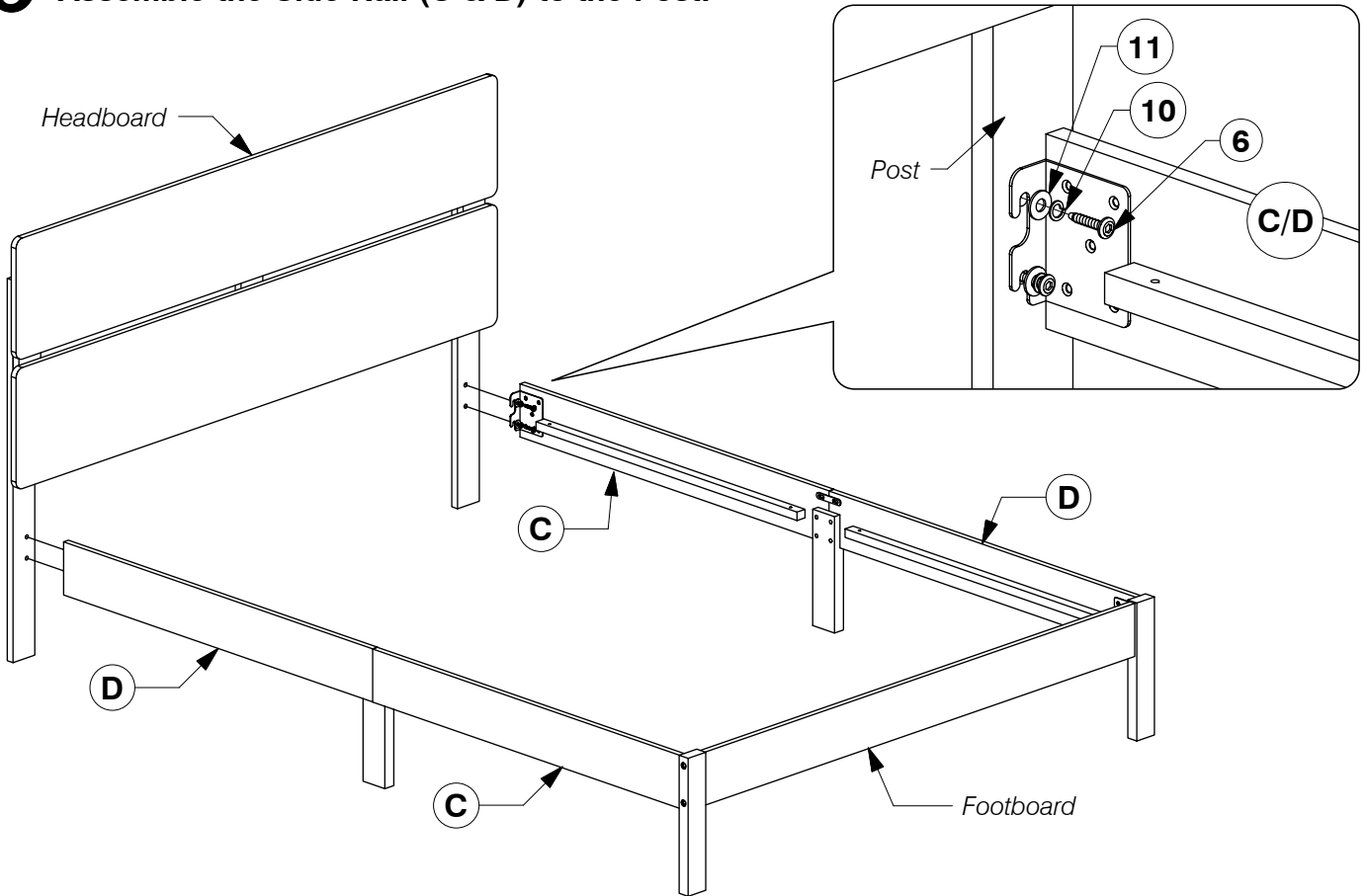

## 10 Bolt the Bed Slats (E) to the Side Rail (C & D).

