

Installation diagram

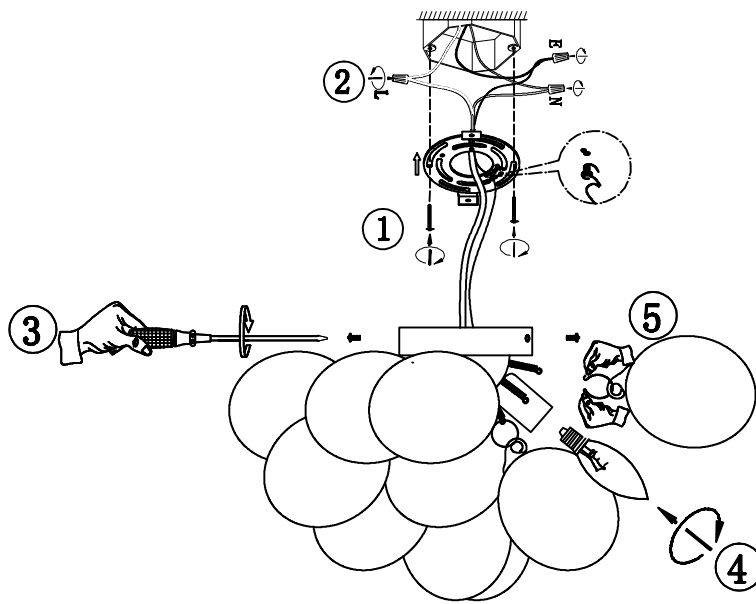

1: Attach the mounting plate to the junction box with the screws on the kit

2: Connect the main line on the top panel to the cable reserved on the ceiling using a wiring cap

3: Put the whole lamp on the hanging plate, and then twist the screw into the tooth on the side of the hanging plate (without a screwdriver).

4: Light bulb

5: The balloon glass is fixed on the lamp body with the attached small iron hook

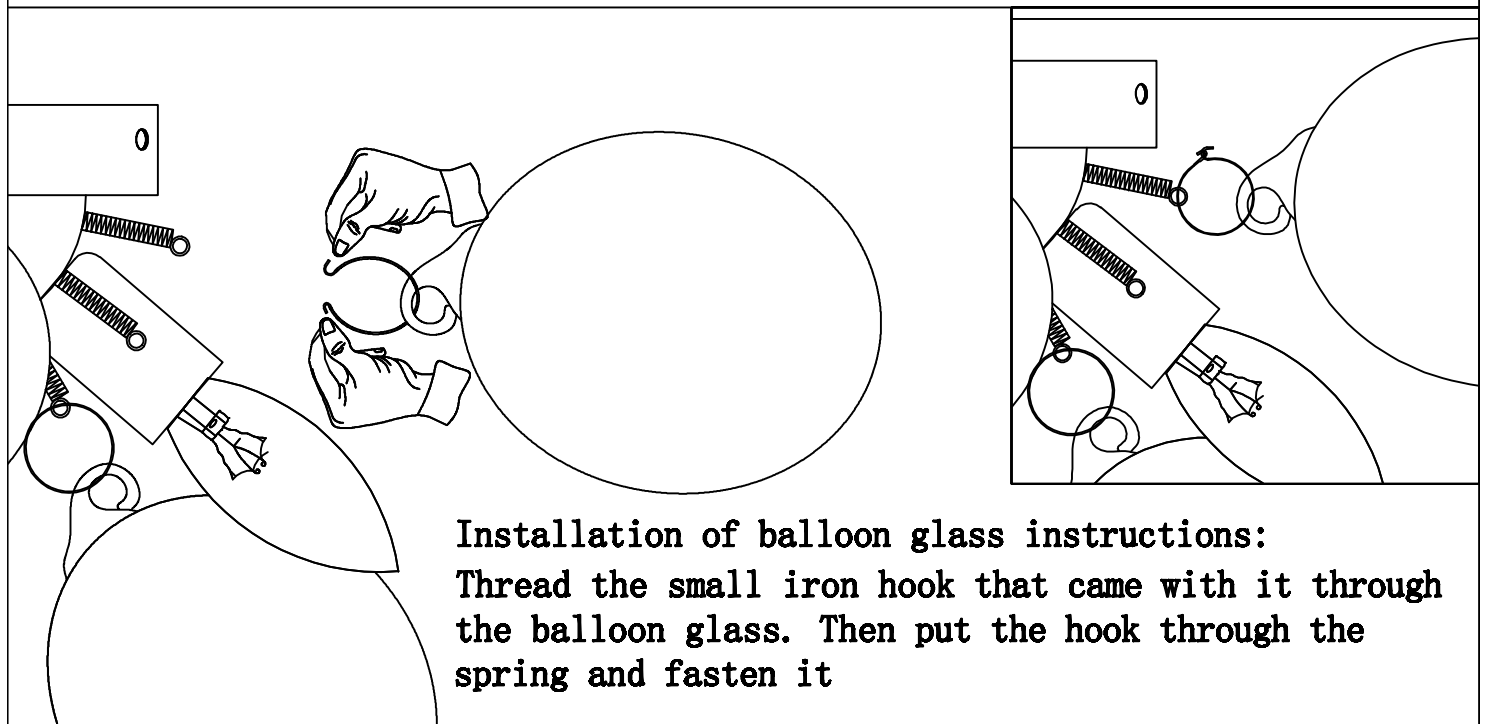

Installation of balloon glass instructions:

Thread the small iron hook that came with it through the balloon glass. Then put the hook through the spring and fasten it