

OWNER'S MANUAL

Installation & Operation

Apply to: ZREM-ADJTA-FQ



CONTENTS

Safety & Warranty Warnings	01
Parts List	03
Electronics Quick Reference Guide	04
Installation Guide	06
Remote Control Instructions	07
Remote Control Instructions- Setting Memory Position	08
Remote Control Instructions- Paring Remote	09
Remote Control Instructions- Program of Remote Learning	10
Definition and Instruction of Co-control Mode & Sub-Control Mode	11
Instruction of Voice Activation Device- Pairing to remote/base	12
Instruction of Voice Activation Device- Valid Voice Commands	13
Instruction of Voice Activation Device	14
Bluetooth Intructions	15
Emergency Battery Backup	17
Troubleshooting	18

Safety & Warranty Warnings

READ THE FOLLOWING INFORMATION CAREFULLY BEFORE USING THIS PRODUCT

If unable to understand warnings, cautions, and/or instructions, contact the dealer or technical personnel if applicable, before attempting to use the equipment. Otherwise, injury or damage may result.

SAFETY WARNINGS:

- Do not use bed outdoors.
- Do not use bed near explosives.
- Using bed with oxygen administering equipment other than the nasal masked type creates a possible fire hazard.
- When using nasal or masked type administering equipment, route and secure oxygen or air tubing properly to ensure that tubing does not become entangled or damaged during normal operation of the bed.
- Use caution when having liquids in or around the bed to ensure no spilling occurs. In case of spillage, stand in a dry, clean area of the floor and unplug the bed immediately. Clean up spill and allow the area around bed to dry thoroughly before using the electric controls again. Do not eat or drink hot liquids while operating the bed.
- This appliance is not intended for use by persons (including children) with reduced physical, sensory or mental capabilities, or lack of experience and knowledge, unless they have been given supervision or instructions concerning use of the appliance by a person responsible for their safety.
- Do not allow children or individuals with disabilities to operate the bed without adult supervision.
- Do not allow any person or pet under the bed at any time.
- During bed operation, make sure body is positioned within the confines of the bed. Do not place extremities over the sides of the bed when operating bed functions.

WARRANTY WARNINGS:

Do not open or tamper with control box, motors, or remote (with the exception of battery compartments). The warranty will be void if the internal workings of these components are tampered with.

Product Rating:

The motors are not designed to operate continuously for more than [2] minutes in an [18] minute time period or approximately 10% duty cycle. Attempting to circumvent or exceed this rating will shorten the life expectancy of the foundation and may void the warranty.

Operating Information:

- After power foundation assembly is completed, operate remote control to ensure proper functions.
- Keep moving parts free of obstruction during bed operation (including sheets, clothing, tubing, wiring, and products using electric power cords).
- Distribute body weight evenly over bed surface. Do not place entire weight on head or foot sections of the bed, during repositioning and entering or exiting bed.

Hospital Use Disclaimer:

This power foundation is designed for residential use only. It is not approved for hospital use and does not comply with hospital standards.

Weight Limits:

This product is not rated to support weights in excess of 750 pounds inclusive of the mattress and bedding. The bed will structurally support this weight, provided it is evenly distributed across the foundation. The power foundation is not designed to support or lift this amount in the head or foot sections alone. Exceeding this weight restriction could damage the bed and/or cause injury and will void the warranty.

⚠ WARNING

DO NOT USE THIS BED IF WEIGHT
LIMITATION IS EXCEEDED

RADIO FREQUENCY: 2.4 GHz**FCC COMPLIANCE:**

This device complies with Part 15 of the FCC Rules. Operation is subject to the following two conditions: (1) This device may not cause harmful interference, and (2) this device must accept any interference received, including interference that may cause undesired operation.

To comply with the FCC RF exposure requirements, no change to the antenna or the device is permitted. Any change to the antenna or the device could result in the device exceeding the RF exposure requirement and void user's right to operate the device.

Parts List

IMPORTANT!: For your safety, read the owner's manual carefully and completely before operating this product.
Electric shock may occur if electrical components are not installed or operated according to these guidelines.

A



Remote Control (2)
AAA Battery (6)

B



Bed leg & Bottom Cap (6)

C



Power Supply & Power Cord (1)

D



Retainer Bar (1)

E



Voice Activation (1)

Electronics Quick Reference Guide

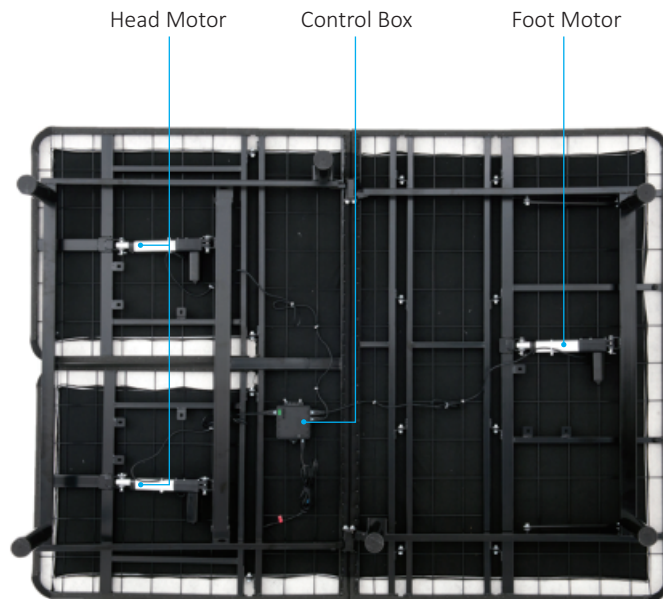

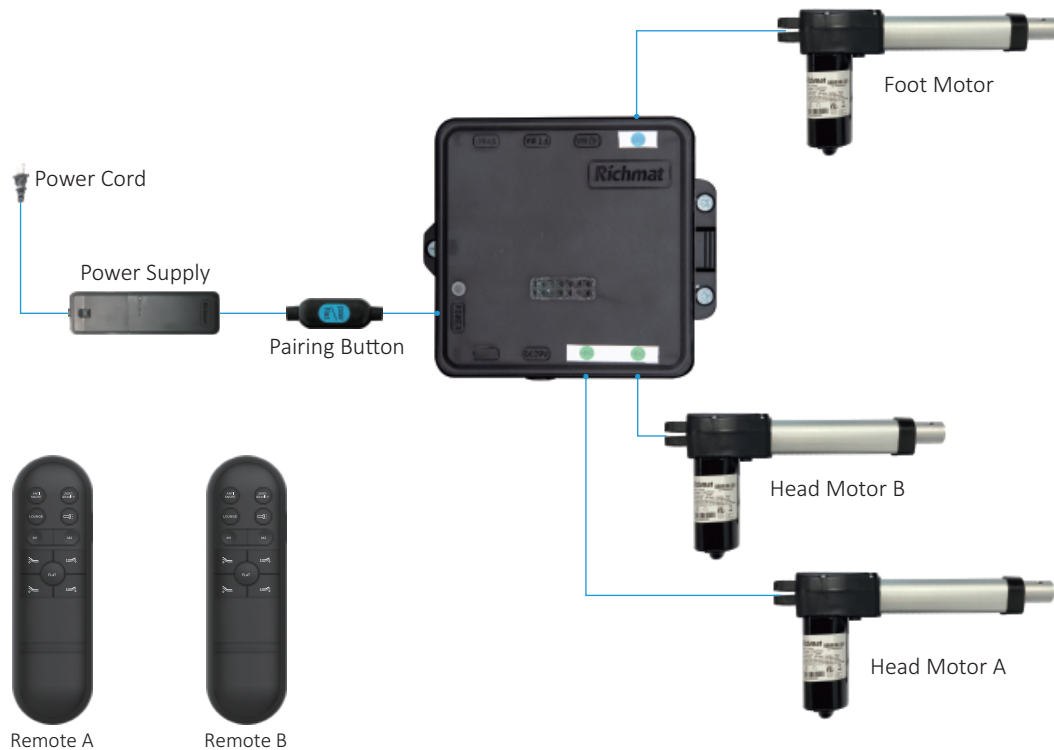

Installation Guide

NOTE: For safety reasons, lifting of the adjustable bed frame must be performed by two (2) people; and the unit should always be in a flat position before opening.

NOTE: To avoid damage to the foundation, always open the carton while the bed is in the flat position.

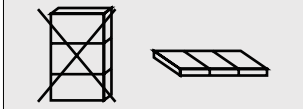

1. Lift the folded bed frame & put it on a flat floor



2. Thread the bolt of the leg to the nut on the foundation frame, and tighten by hand. **DO NOT OVERTIGHTEN.**



3. Carefully flip the foundation over onto its legs, and then Locate the mattress retainer bar brackets.

Important: Two people are required to move the foundation.

Do not drag across the floor. Do not rest frame on its side; excessive pressure may damage the legs.



4. Uncoil the input power cord (connected to the control box's power port) and plug it into the power supply.

Uncoil the power cord and connect it to the power supply.



Remote Control Instructions

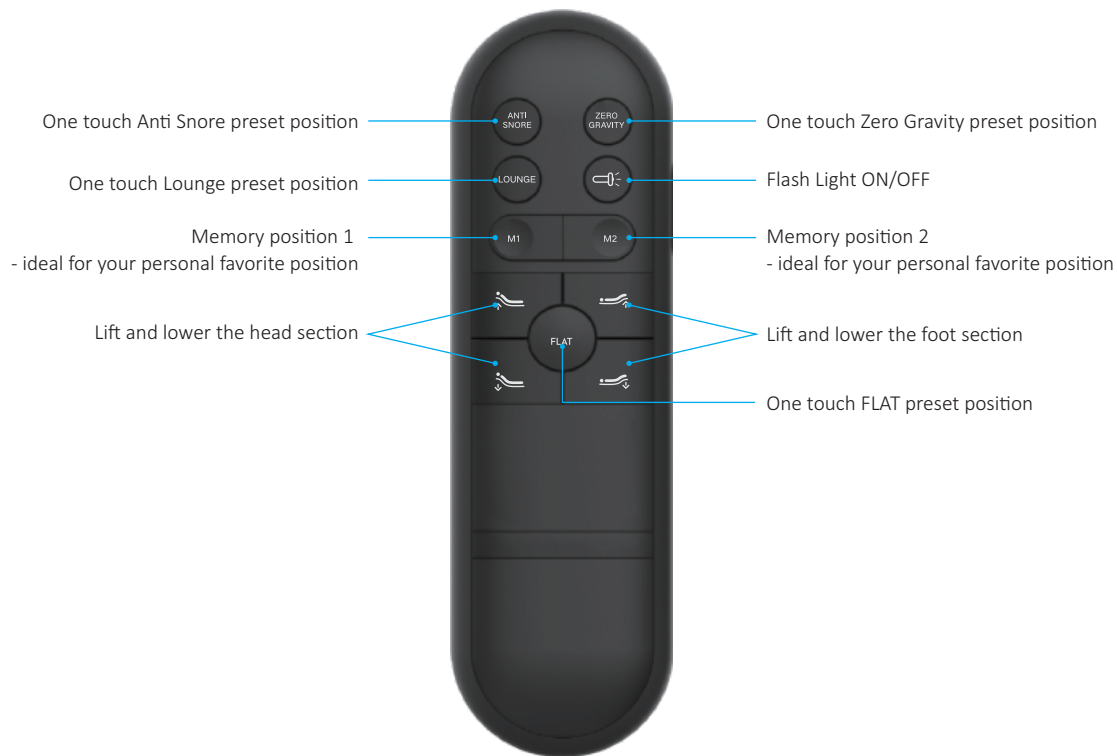

Remote Control Instructions - Setting Memory Position

The Memory Position is a programmable feature that allows you to save custom position. Please follow below instructions to set your personal favorite positions.

STEP 1

Adjust the head and foot section to your desired position.



STEP 2

Press and hold the flat button (FLAT) first, then press and hold memory button (M1) for 5 seconds until you hear 2 beeps sound.



STEP 3

To adjust the saved position, repeat steps 1 & 2, and the new position will be saved.

Remote Control Instructions - Pairing Remote

The original remote that comes in the box is already paired to the foundation. No further action is required. In the event that the remote is not paired with the foundation, follow the steps below.

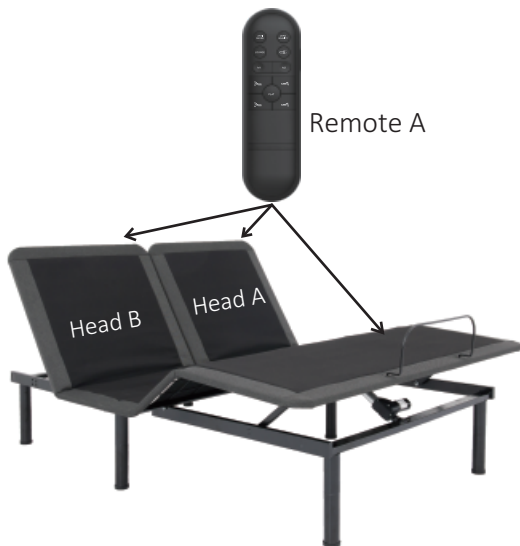

Now only remote A could operate your base.

As factory setting is Co-Control Mode, head A & head B will operate simultaneously.

Note: Please refer to page 11 for definition of Co-Control Mode & Sub-Control Mode, and how to switch mode.

STEP 1

Make sure the batteries in remote work fine. Replace them when necessary.



STEP 2

Plug the power cord to the power source.



STEP 3

Press & hold head up and foot up on remote A simultaneously, and then press & hold the blue button on the cord that connected to the power supply. Once you hear beeps, the remote A is paired.



Remote Control Instructions - Program of Remote Learning

Before programming of remote learning, please switch it from Co-Control Mode to Sub-Control Mode first.

Once remote A can only operate head A & foot section, while head B cannot be operated, remote B could be programmed as below to learn from remote A:

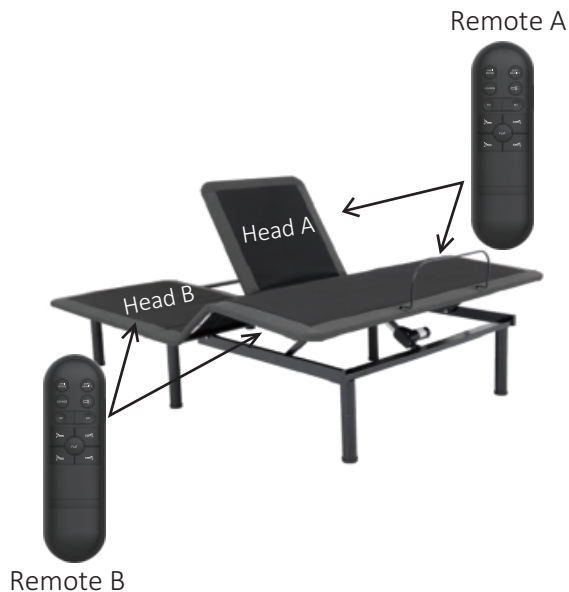

Press & hold **head down** and **foot down** on remote B simultaneously for about 5 seconds until flash light on remote B on, then within 10 seconds, press & hold **head up** and **foot up** on remote A simultaneously, when flash light on remote B blinks, the learning process is finished.

Now remote B could operate head B & foot section.



Definition and Instruction of Co-control Mode & Sub-Control Mode



Sub-Control Mode = Flex-Head Queen

Head A & head B always operate respectively

- Head A can only be operated by remote A

- Head B can only be operated by remote B

Foot section could be operated by both remote A & remote B.



Co-Control Mode = Standard Queen

Head A & head B always operate simultaneously;

- Both remote A & remote B could operate head/foot sections.

To switch the mode of Con-Control & Sub-Control, press & hold the buttons of **Anti Snore** & **Zero Gravity** simultaneously for about 5 seconds until hear beep from control box. If beep once, it's Sub-Control mode; If beep twice, it's Co-Control Mode.



Instruction of Voice Activation Device - Pairing to remote/base

The voice activation allows you to control your base by using preset voice commands.
This device works best when placed on your nightstand or nearby your bed.



1. Plug the voice activation to the power source.
2. Say the wake words “Genius Base” to activate your device, after hearing “hello”, give command as “Coding genius base” and press and hold the buttons of head up & foot up simultaneously until hear “pair successfully”.
3. Now you can control your base by using preset voice commands.

NOTE 1

The voice activation device will enter sleep mode if there no voice command within 15 seconds. Please re-wake it up with wake words.

NOTE 2

You may put your phone on top of voice activation device to charge. Once light blinks, the charge starts.

Instruction of Voice Activation Device - Valid Voice Commands

Once the device is activated, say the voice command as listed below to control your bed.
You can give multiple commands within the 15-seconds time frame without repeating the wake word.

Head Rise

Raise the head section of the base

Head Down

Lower the head section of the base

Foot Rise

Raise the foot section of the base

Foot Down

Lower the foot section of the base

NOTE: Make sure to stop your adjustable bed when you reach your desired height.

ZERO-GRAVITY

Adjust the base to ZERO-GRAVITY preset position

ANTI-SNORE

Adjust the base to ANTI-SNORE preset position

LOUNGE POSITION

Adjust the base to LOUNGE preset position

First Memory Position

Adjust the base to the custom position 1

Second Memory Position

Adjust the base to the custom position 2

All Stop/Stop

Stops all activities

All Flat

Adjusts the base into a flat position

Volume-Up/Voice-Up/Increase Volume/Speak Loudly

Increase the volume of the voice activation

Volume-Down/Voice-Down/Decrease Volume/Speak Lower

Decrease the volume of the voice activation

Highest-Volume/Voice-Biggest/Maximum-Volume

Increase the volume of the voice activation to the maximum level

Lowest-Volume/Voice-Smallest/Minus-Volume

Decrease the volume of the voice activation to the minimum level

Enable Voice Function/Set Speech Mode On/Start Please

Enable Voice

Disable Voice Function/Turn Off Speech Mode/Speech Mode Off:

Disable Voice

See you Later

Stop all activities, and set the voice activation to sleep mode

Instruction of Voice Activation Device

If operate in Co-Control Mode with Standard Queen mattress, you may wake it up with “Genius Base” . Refer to page 12.

If operate in Sub-Control Mode with Flex-Head Queen mattress, pls code the voice activation with “Base 1” & “Base 2” separately as below instructions.

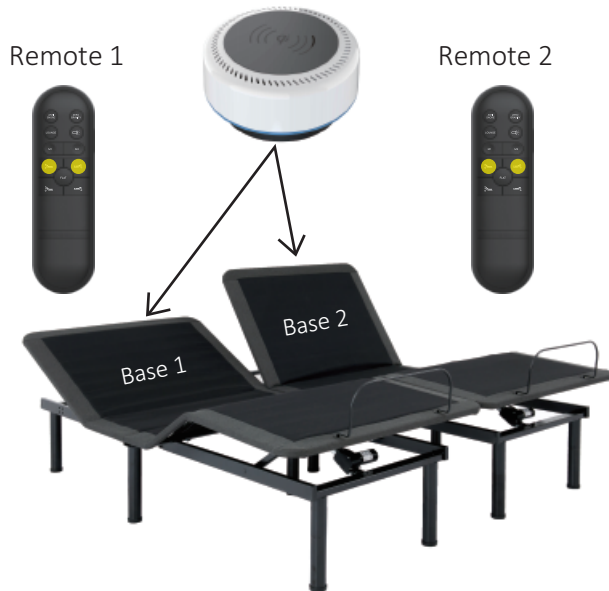

First, say the wake words “Base 1” to activate your device, after hearing “hello”, give command as “Coding Base 1” and press and hold the buttons of head up & foot up on remote 1 simultaneously until hear “pair sucessfully”.

Then, say the wake words “Base 2” to activate your device, after hearing “hello”, give command as “Coding Base 2” and press and hold the buttons of head up & foot up on remote 2 simultaneously until hear “pair sucessfully”.

Now you can control your bases by using preset voice commands.

Note:

Which base is waked up, which base will operate following your command. Under the Sub-Control Mode, head section of base 1 & base 2 cannot operate together. If need 2 head sections operate together, please swtich the Co-Control Mode.

Bluetooth Instructions

Step 1: Plug base into power source

Step 2: Turn Bluetooth on in cell phone

Step 3: Install the APP

Option 1)

- 1) Go to APP Store (IOS SYSTEM) /Google Store (ANDROID SYSTEM)
- 2) Type "Adjustable Bed Remote ZREM" into search field and select APP, install APP onto cell phone .

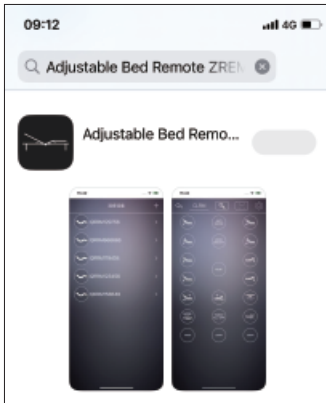

Option 2)

Scan this QR code to APP stores for download.



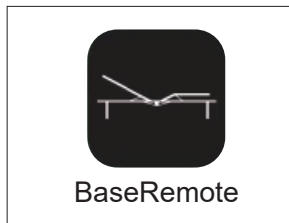

Step 4: Control your base via BaseRemote APP

- 1) Open BaseRemote APP that was previously installed on cell phone as shown in picture below.

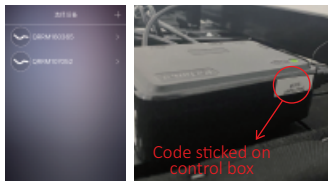

- 2) Refresh the list, then select your base by clicking the correct bluetooth code (code can be found on the control box underneath base).



- 3) After selecting your base, scan below QR code or type "ECRM" & click the , now you can see the operation center and control you base.



ECRM

(QR code can also be found on backside of remote)



Note:

There are 2 QR codes on backside of remote, please always scan the correct one, otherwise you may cannot operate your base successfully.



Emergency Battery Backup

Overview

Important: The backup battery is only to be used in case of a power outage. Batteries are not to be used for normal operation of the bed. The backup battery will not support repeated movement for an extended period of time.

Backup Battery Use:

Use two 9V batteries only (not included). If a power outage occurs, install the 9V batteries into the power supply to allow temporary power to the base (see image A).

Installing Batteries:

Unplug the power cord from the outlet and remove the cover from the compartment on the underside of the power supply (see image B). Place two 9V batteries inside, close the cover and plug the power cord back into the wall outlet. The backup battery will not support repeated movement for extended periods of time. After power is restored, unplug power cord, remove the batteries, then plug the power cord back into the wall for normal use.

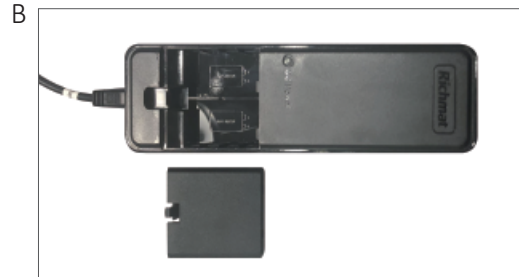

Troubleshooting

In the event that the power foundation fails to operate, assess the symptoms and possible solutions provided in the chart below.

SYMPTOMS	SOLUTIONS
Remote control illuminates and appears to be operable, but will not activate bed.	Verify that the power cord is plugged into a working, grounded electrical outlet. Test the outlet by plugging in another working appliance.
No features of the power foundation will activate.	<p>Program the remote control (see the Setting Programmable Positions and Pairing Remote section of this manual for programming procedures).</p> <p>Unplug the power cord, wait 30 seconds and plug back to reset electronic components.</p> <p>The surge protection device or the electrical outlet may be defective. Test the outlet by plugging in another working appliance.</p> <p>Verify that the connector on the wired remote control is securely attached to the control box.</p>
Wireless remote will not illuminate.	Replace the batteries in the wireless remote.
Head or foot section will elevate, but will not return to the horizontal (flat) position.	<p>Bed mechanism may be obstructed. Elevate bed and check for obstruction. Remove obstruction.</p> <p>Head section may be too close to the wall.</p> <p>Headboard may be too close to the edge of the mattress. Verify that there is enough distance between the headboard brackets and mattress. Adjust if required.</p>

Troubleshooting

SYMPTOMS	SOLUTIONS
Head & Foot lift function has minor interference during operation.	<p>Check batteries in wireless remote control, replace with two (2) new AAA batteries if necessary.</p> <p>Make sure that you are following the duty cycle of the motors (do not operate more than two minutes over a 18-minute period, or approximately 10% duty cycle).</p> <p>Press the lift buttons squarely and accurately.</p> <p>Wireless remote control may be experiencing common Radio Frequency Interference from other radio transmitting devices. Wait several seconds, and then try pressing appropriate button again, See FCC Compliance Statement on page 5 of this guide.</p>
Excessive massage motor noise.	<p>If the bed is located on hard surface flooring, place carpet pieces or rubber pieces (not included) under each leg.</p> <p>Using the wireless remote control, elevate the head, foot or neck section a short distance to realign the lift/lower mechanisms with the bed support platform.</p> <p>Verify that your Power Foundation is not positioned against a wall, nightstand, or other object that may cause the vibration or noise.</p> <p>If the Power Foundation is installed over a bed frame, verify that the massage motors are not causing the bed frame (or bed frame components) to vibrate.</p> <p>Verify that the headboard attachment hardware is properly tightened (if used).</p>
A clicking noise is heard under the bed when raising or lowering.	<p>This is normal. The lift motor relays “click” when they are engaged. No action is required.</p>
Massage motor overheats or stops.	<p>If the vibration motor overheats, the thermal protection will turn the motor off. Wait 30 minutes, turn the massage back on. If it does not come on, turn it off and report the situation to customer service.</p>

Customer Service: 1-855-430-8943

Serial No.

2-Year Warranty | Parts and Labor