

ASSEMBLY INSTRUCTION

Read this instruction carefully. See hardware and furniture part list
For guidance. Be sure all part is complete, before you start assembling.
Place all wooden part on a clean and flat soft surface to
prevent from being scratched. Follow the figure to start assembling.

CAUTION :

1. Do not FULLY TIGHTEN the nut or bolt untill all nut or bolt is ready assembled.
2. Do not OVER TIGHTEN the nut or bolt to avoid causing damages to the thread.
3. Keep all hardware part out of reach of children.

PART LIST

NO.	DESCRIPTION	QTY.
A	BACK REST	1 PC
B	CUSHION SEAT UPHOLSTRY	1 PC
C	FRONT LEG (LEFT)	1 PC
D	FRONT LEG (RIGHT)	1 PC
E	STRETCHER (LEFT)	1 PC
F	STRETCHER (RIGHT)	1 PC
G	FRONT STRETCHER	1 PC

HARDWARE LIST

NO.	DESCRIPTION	QTY.
H	JCBC M6 x 40mm	2 PCS
I	JCBC M6 x 50mm	4 PCS
J	JCBC M6 x 80mm	4 PCS
K	SPRING WASHER 1/4"	10 PCS
L	FLAT WASHER 1/4"	10 PCS
M	ALLEN KEY M4	1 PC
N	CSK M4 x 45mm	6 PCS

STEP 1

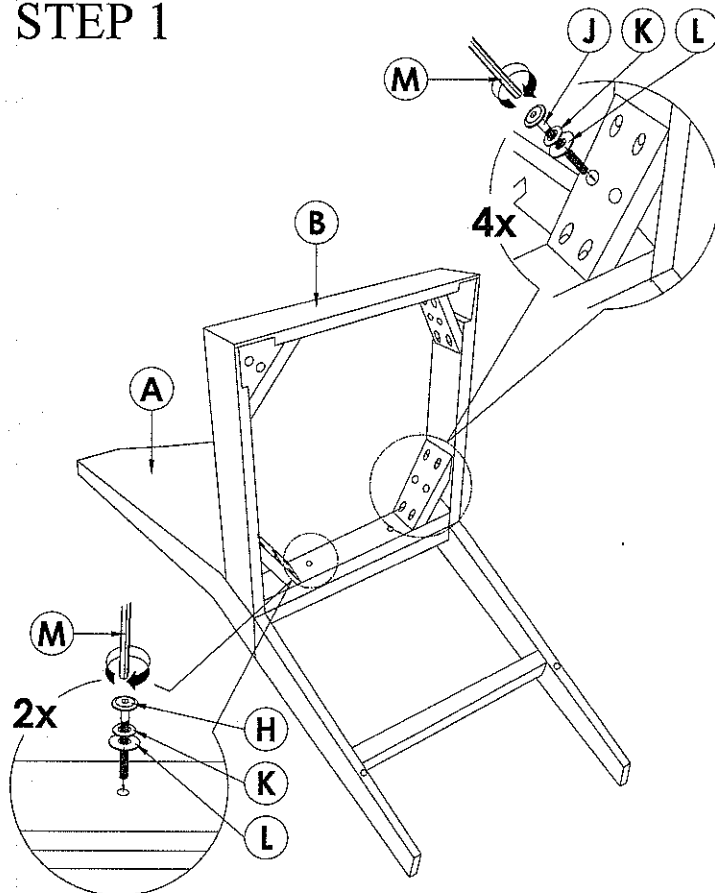

STEP 2

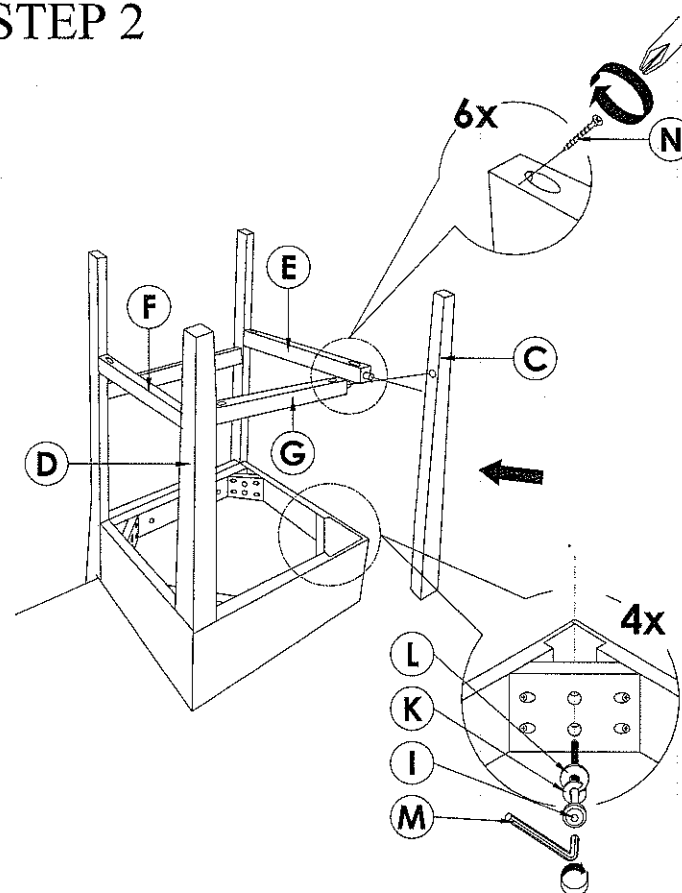

STEP 3

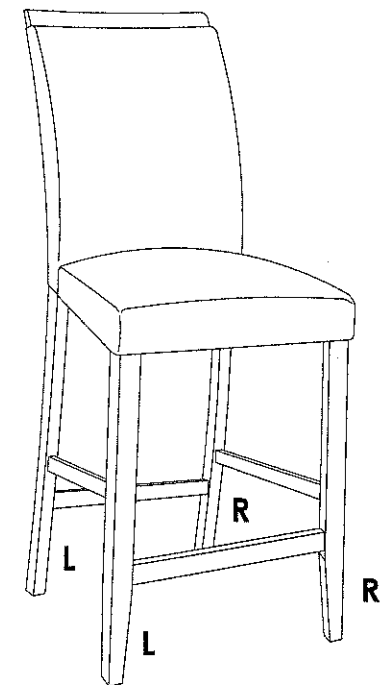

ASSEMBLY INSTRUCTION

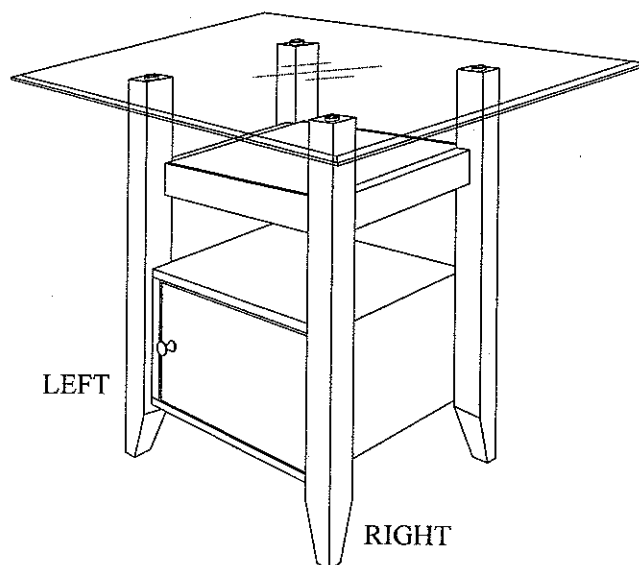

PART LIST		
NO.	DESCRIPTION	QTY.
A	GLASS TOP	1 PC
B	TABLE LEG FRAME (LEFT)	1 PC
C	TABLE LEG FRAME (RIGHT)	1 PC
D	TOP PANEL	1 PC
E	BOTTOM PANEL	1 PC
F	FRONT & REAR RAIL	2 PCS
G	BACK PANEL	1 PC
H	DOOR	1 PC
I	SHELF	1 PC

HARDWARE LIST		
NO.	DESCRIPTION	QTY.
J	JCBC M6 x 50MM	4 PCS
K	SPRING WASHER M6	4 PCS
L	ALLEN KEY (LONG)	1 PC
M	BOLT	8 PCS
N	MINIFIX	8 PCS
O	MAGNET	1 PC
P	HANDLE	1 PC
Q	PAN HEAD SCREW M4 x 22MM	1 PC
R	DOOR SPRING	2 PCS
S	GLASS SUPPORT Ø38 x 10MM	4 PCS
T	INSERT BOLT M6 x 20MM	4 PCS

STEP 1

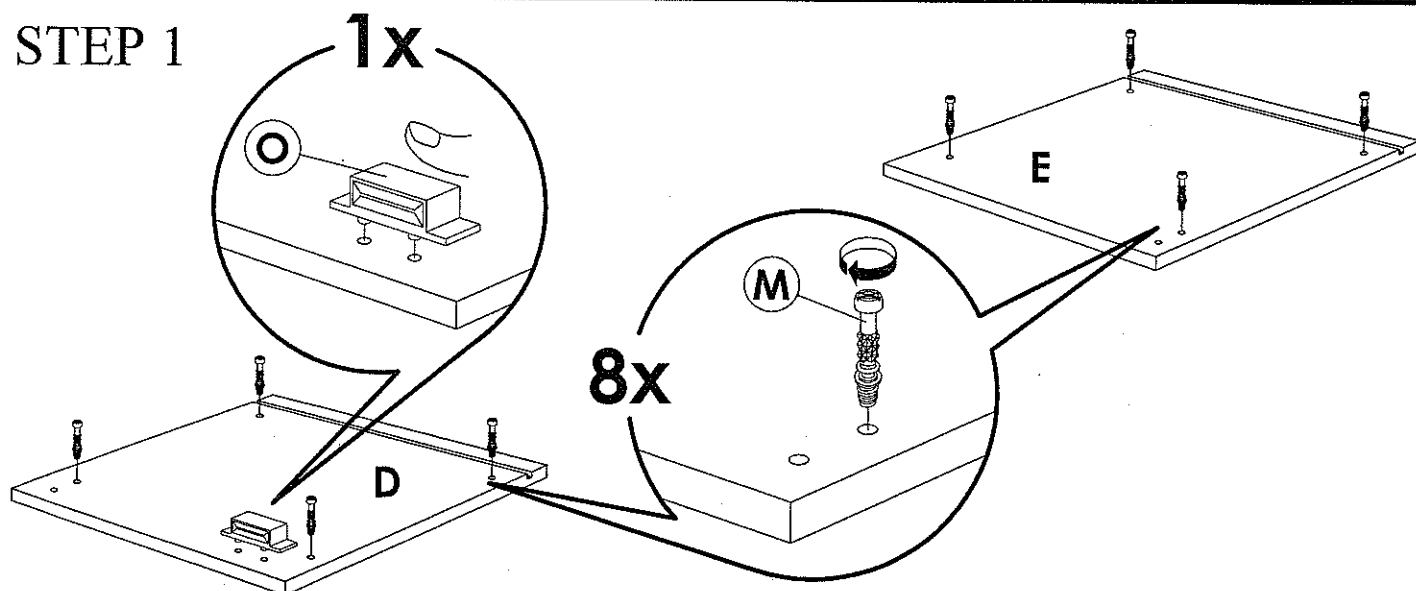

STEP 2

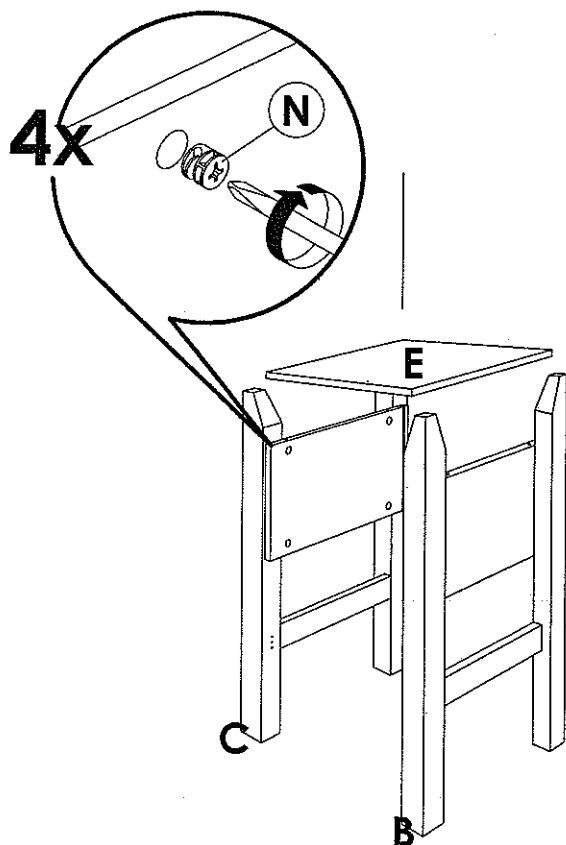

Upside down Table Leg Frame (B) & (C).
Attach the Bottom Panel (E) as shown.

STEP 3

IMPORTANT !!
DO NOT
TIGHTEN ALL
THE SCREWS
UNTIL STEP 5.

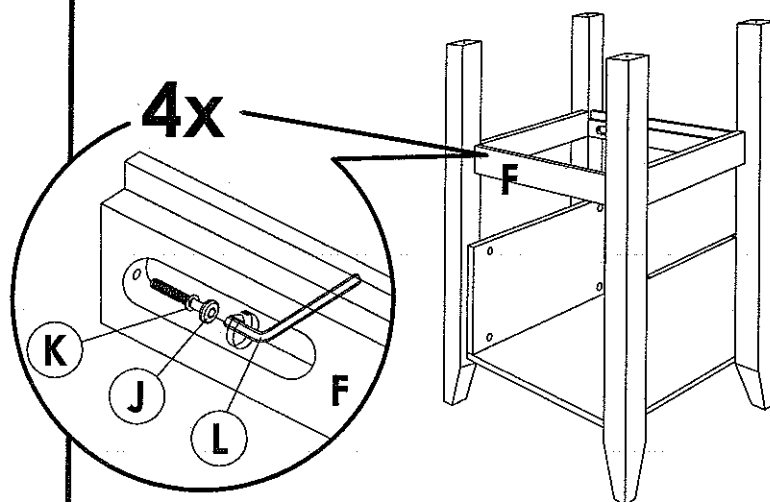

Turn over the Leg Frames with Bottom
Panel to the Upright Position. Insert Front
And Rear Rail (F).

STEP 4

BACK VIEW

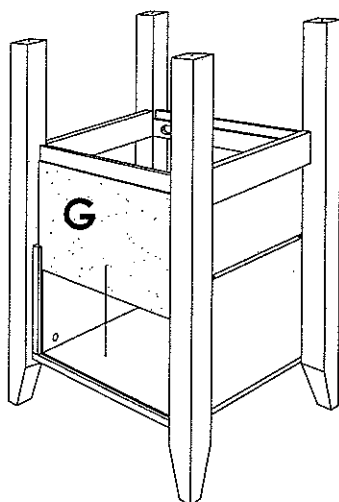

Insert Back Panel (G) to the grooves.

STEP 5

TIGHTEN ALL THE
SCREWS IN STEP 3,
AFTER ASSEMBLY
OF TOP PANEL (D).

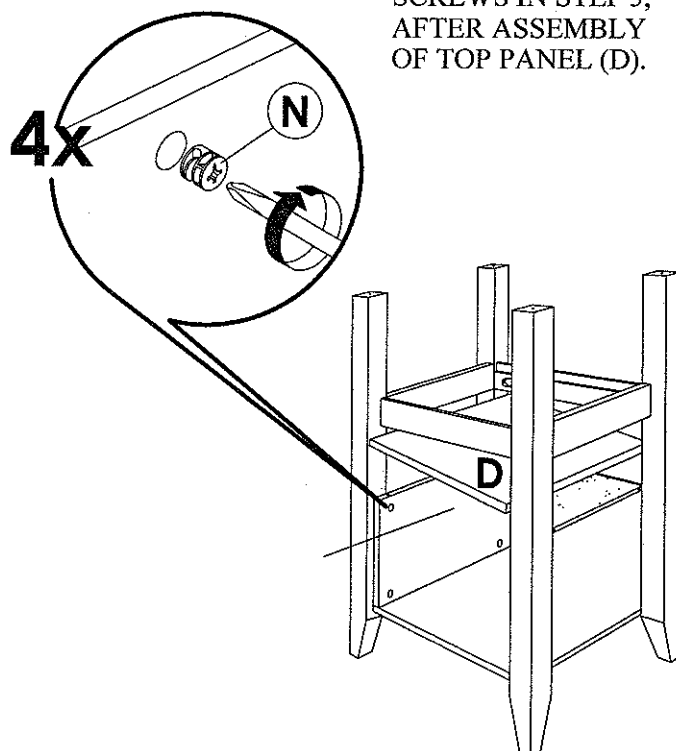

Insert Top Panel (D) as shown CAREFULLY !

STEP 6

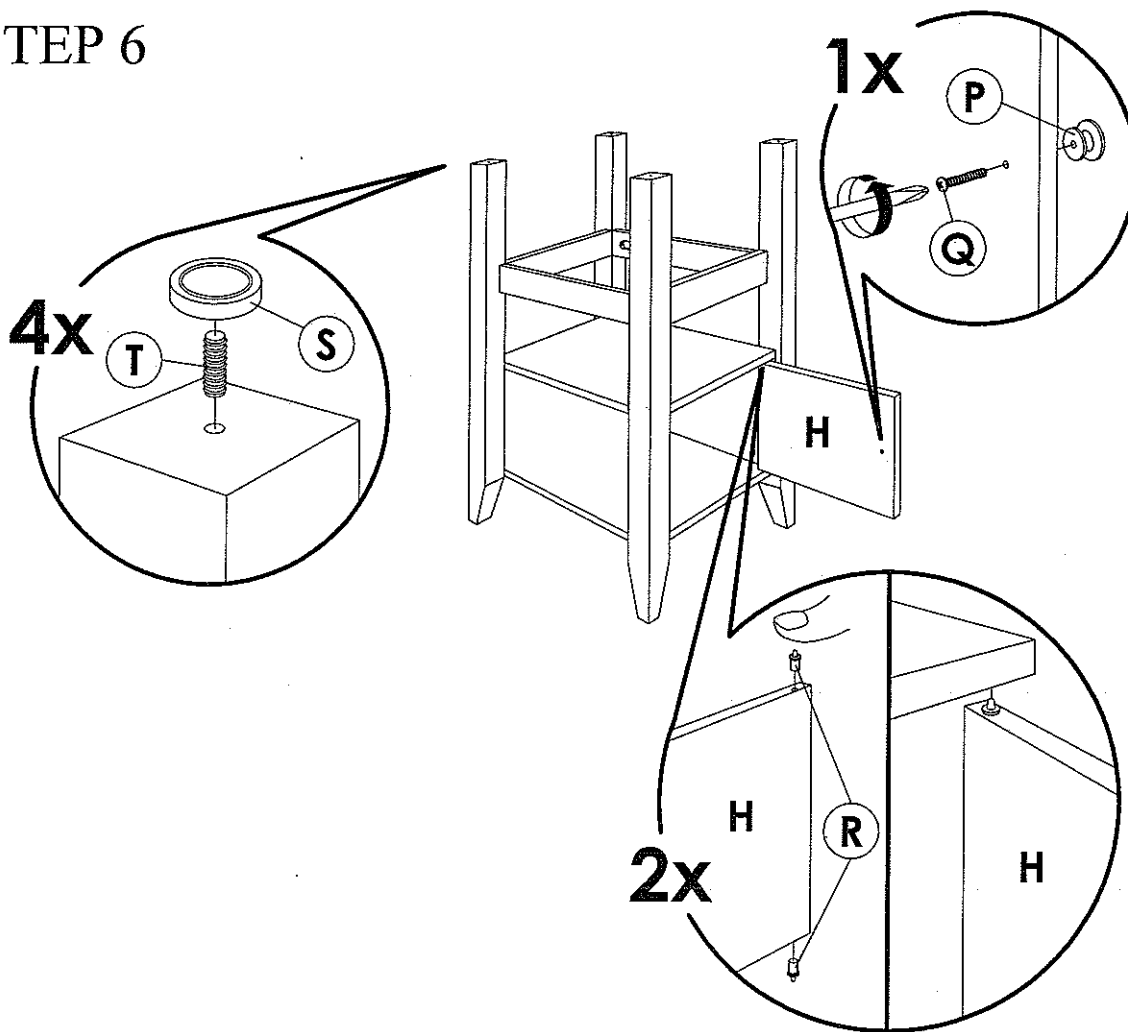

STEP 7

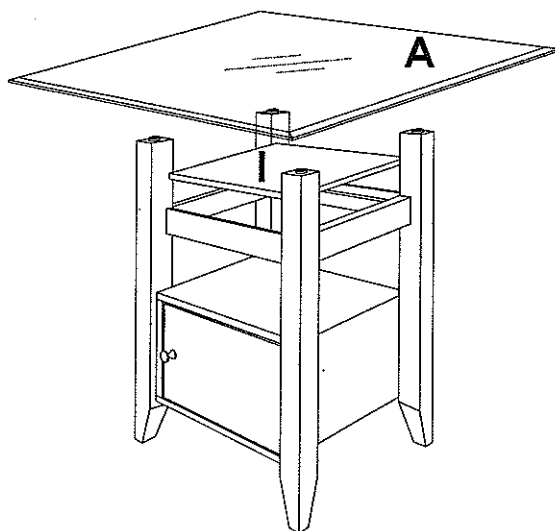

ASSEMBLY COMPLETED !!

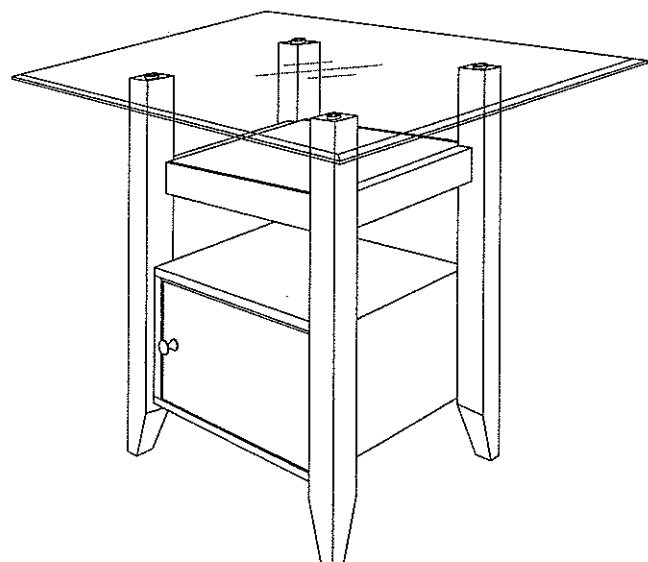

Insert Shelf (I) and place Glass Top (A) CAREFULLY !