

YH4025-Ice Maker

Solemnly declare:
Our company's products are constantly improving, and the design and specifications are subject to change without prior notice. All materials in this manual have been carefully proofread and strive for accuracy. If there are any printing errors or omissions, our company reserves the right to interpret.



Please recycle after use

Soft Nugget Ice maker

YH4025
User Manual



5.84"
148.5mm



Soft Ice Maker

Preface

Congratulations on purchasing a chewable ice maker that is a restaurant style for your home ,that does not require installation or connection of water pipes. The soft chewable ice is different to the hard ice cubes and shapes.

It is achieved by scraping ice from the inside of a frozen stainless steel cylinder and then compacting it into a lightweight material.It is not broken ice or Shaved ice, it is perfect small particle ice,can be used for food and chewing!

The soft ice maker is the ideal choice for soft ice enthusiasts.

This machine's ice making is fast and ready for guests and individuals to enjoy or entertain at any time.

The low-key stainless steel design complements any kitchen or bar area, making it suitable for most number standard sized cabinets. Just fill the water to reservoir, press the button, then it will make ice within ten minutes.

The ice always keep fresh and soft,even if there is no refrigerator or freezer. The soft ice cubes can enhance cocktails, soft drinks, iced coffee, and tea exquisite taste!



Please read all instructions before use
For your safety and continued enjoyment of this
product,Please read the instruction manual before use.

User Warranty Terms

Within one year from the date of purchase ("warranty period"), if there shall be no defects in materials and workmanship,and the product meets the requirements within the scope of this warranty, we will choose to use the same product as determined by the company at no cost repair or replacement of products ,or products with similar features and functions (excluding transportation, handling, delivery or installation).

In addition, our company is not responsible for any damage caused to this product due to the use or operation of non company products.

The warranty is limited to the correct use, maintenance, storage, installation, and intended use only according to the company's instructions product.

This warranty does not apply to products installed, operated, or maintained under abnormal circumstances.

This warranty is not applicable used for any product that has not been operated and /or installed in accordance with company regulations and/or industry practices and standards.

All warranties will be terminated immediately,for any product that is repaired, replaced, modified or modified without prior written permission from the company.

Ice Maker Sound

Your personal freezer soft block ice maker is not like a regular hard ice maker. Lightweight production Breathable and soft ice requires several processes. Therefore, this ice maker itself will produce a normal sound:

1.Whispering sound - When it first opens, you may notice the sound of the condenser fan rotating.

2.Buzzing sound - When the water pump is first turned on, it may be dry and produce a buzzing sound. When filled with water, the buzzing sound will dissipate.

3.Clucking sound - The flow of refrigerant may produce a creaking sound, once the system stabilizes,the gurgling sound will significantly subside.

4.Grunt sound - It may occur when the refrigerant system is shut down and the refrigerant stops flowing. a brief gurgling sound.

5.Buzz - The compressor is an electric motor. It emits a low buzzing sound while working.

6.Clucking sound - The first ice block produced produces the loudest sound when it is released to the bottom of the freezer. When the freezer is full, the sound of ice cubes falling will decrease.

Error prompts and solutions

Phenomenon	Possible reasons	Resolvent
"Lack of water" The indicator light is on	<ul style="list-style-type: none">Machine water shortage.	<ul style="list-style-type: none">Fill up with water, press the ice making button again to restart ice making.
"Ice full" The indicator light is on	<ul style="list-style-type: none">The ice storage basket is full of ice.The infrared detection module is blocked.	<ul style="list-style-type: none">Remove the ice cubes from the ice storage basket , and the machine will automatically continue making iceCheck if the infrared detection module is covered by objects, and clean the items in the blocked module.
The ice making speed is abnormally slow	<ul style="list-style-type: none">The hot air outlet is blocked by an object.Adding water for ice making, the water temperature is too highExcessive ambienttemperature.	<ul style="list-style-type: none">A certain amount of space should be reserved around the ice maker (it is recommended to leave a space of 10-30 centimeters).The water temperature is required to be between 7-32 C Celsius .Check if there is a heat source around the ice maker, and the ice maker should be used indoors.
leakage	<ul style="list-style-type: none">The drain plug is not properly plugged and the drain outlet is leaking water.The water level in the storage tank may be too high.The inlet of the water storage tank may be blocked.	<ul style="list-style-type: none">Fix the drain plug at the bottom of the ice maker.Drain some of the water from the storage tank to below the maximum limit.Check and clean the water inlet.

 **Important reminder:**
After receiving the machine, let it stand for 24 hours before using it again.

Safety precautions

**Only use grounded triangular sockets**

**Ensure that there is sufficient 4" clearance around the machine**

**Keep hands and items away from the ice outlet**

**Do not use sharp knives to open packaging**

**Indoor use only**

**Ensure that the machine is not in close proximity to high temperatures/sunlight**

**Suggest using distilled or purified water**

**Suggest at least 2 people to operate when moving the machine**

**Not recommended to use extension cords**

Product Specifications YH4025			
Product Name:	Soft ice maker	21 °C Ice Production/Day:	17kg
Model:	YH4025	Dimensions (W*L*H):	246*295*405mm
Current/frequency:	110V/60hz	Normal ice capacity of ice basket:	800g±10%
Maximum current/power:	1.6A/135W	Maximum ice capacity of ice basket:	1200g±10%
Colour:	Metallic Silver/Grey	Working environment temperature range:	10°C-32°C
		Cleaning mode:	Automatic cleaning, press and hold for 3 seconds before starting
		Machine net weight:	11.5kg ± 5%

Safety Tips

- Under no circumstances should the third (ground) pin on the power cord be changed or removed. For personal safety, this product must be properly grounded.
- Do not exceed the rated value of the power socket.
It is the best to connect to a separate circuit.
- Only 110V, 60Hz standard power supply can be used, and it should be properly grounded according to national electrical regulations and local norms and regulations.
- Don't use adapters or extension cords, because of potential safety hazards under certain conditions.
It is not allowed to disconnect or remove the third grounding pin on the power cord under no circumstances.

Circuit grounding conductor
Connected correctly

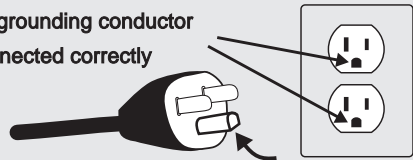

- Do not unplug electrical appliances by unplugging the power cord. Please tighten the grasp the plug tightly and unplug it directly from the wall socket to properly disconnect the power.
- Do not immerse electrical plugs or wires in water or other liquids to prevent electric shock.
- Before using this product, it is necessary to install and position it correctly according to the installation instructions. This product is for indoor use only. Please do not use outdoors.
- Do not store or use flammable vapors or liquids near this product.



Please pay attention! Some types of cabinet lights may be hot enough to damage the appearance of the top of your machine.

- This machine is not a toy. Please caution and supervision should be exercised when using this machine near children.
- Do not allow children to operate this device.
- Please ensure that your hands are clean and hygienic to avoid unhygienic conditions when operating.
- It is recommended to use purified water or distilled water for ice making, and try not to use other unhygienic and unsafe liquids for ice making.
- Place the power cord in an area where it will not be pulled by children or cause tripping hazards.
- Place the power cord away from hot surfaces.
- Do not operate any damaged components, including wires or plugs.
- Please unplug the product plug, before cleaning and when not in use.
- Do not immerse any part of the product in water.
- Do not insert or remove the power plug of this product when hands are wet.
- Do not attempt to disassemble, repair, modify or replace any part of the product.
- This product is only intended for the intended use as described in this user manual.
- Do not use any accessories not recommended by the manufacturer.

Care and Cleaning

Please unplug it and follow the cleaning instructions below, when using and maintaining the device for the first time.

- ① Wipe the outside of the ice maker and the inside of the ice bucket with a soft, damp cloth, and dry to avoid any sediment.
Do not use cleaning solvents or abrasive cleaners.
Do not store water in the reservoir.
Do not use soap in the pool.
- ② Prepare disinfectant solution with 1 cup of white vinegar and 1 cup of distilled or purified water.
Always use vinegar and water, and the ratio is 1:1.
Do not let the solution stay in the ice maker for more than 12 hours.
It is the best to be used during cleaning cycles.
- ③ When cleaning, please pour the disinfectant into the water reservoir carefully, until it is just below the maximum liquid level. Do not exceed the maximum height.
- ④ Plug in the power again, and press and hold for 3 seconds before starting.
- ⑤ The automatic cleaning will be completed in 3 minutes, then stop automatically, and the display button will also light off.
- ⑥ Place the end of the drainage pipe hanging above the back of the device on the sink or bucket.
- ⑦ And remove the drain plug from the end of the drain pipe, when preparing to pour water into the sink or bucket.
- ⑧ Rinse with clean water 3-4 times, unplug and drain after each rinse.
- ⑨ Please plug in and add clean water for ice making after completion.
- ⑩ If it will not be used for a long time in the future, please keep the water in the ice maker being drained and the interior dry before storing it.

In order to allow you to taste fresh and clean ice every day.

- Suggestion:**
- Keep draining and changing water every day.
 - Keep using automatic cleaning once a week.
 - Keep cleaning the machine with a 1:1 solution of vinegar/water every 3-4 weeks.
 - Do not use tap water or any other type of liquid.

Flushing device

Ice maker drainage steps:

- 1 Before flushing and draining, unplug the power plug
- 2 Place the end of the drainage pipe hanging above the back of the device on the sink or bucket.
- 3 Open the drain plug at the end of the drainage pipe and drain the water.
- 4 Drain the water completely, then reinstall the drain plug and check if it is tight, and plugged into the drain outlet tightly. Hang the drain pipe back in place.
- 5 Plug the power back in, then add the clean water (distilled water) for ice making after completion.

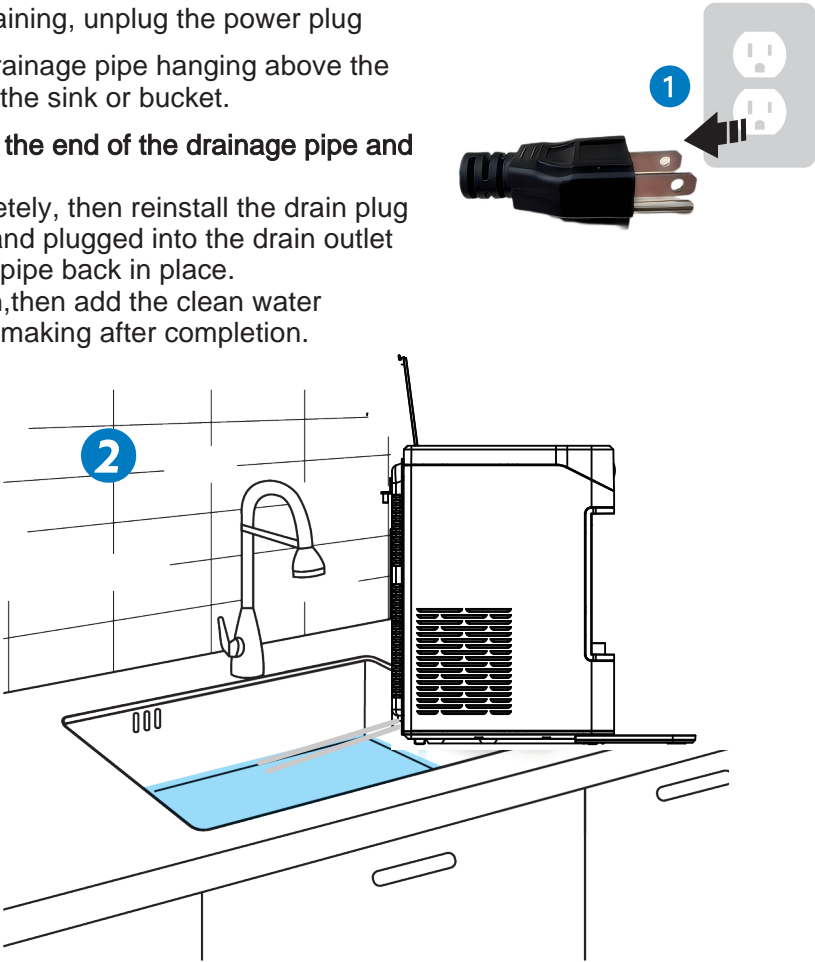

Warning

Please follow basic safety precautions, to reduce the risk of injury while using the machine :

- Do not remove any safety, warning, or product information labels from the ice maker.
- Lifting hazard: It is recommended that two people move and install the ice maker to prevent injury.
- Please unplug the electrical appliances, before performing any cleaning or maintenance.
- Do not use flammable liquids or solvent based cleaning agents to clean equipment.
- Do not use abrasive cleaners on internal or external surfaces, because they may damage or scratch the equipment.
- Special treatment is required when disposing of refrigeration equipment.
- Please check the latest relevant handling methods, before disposing of this product.
- Do not operate this device with wet hands or standing on wet surfaces or in accumulated water.
- Chemical hazards - It should be used in a well ventilated area and avoid mixing it with other household cleaning agents, when using bleach for cleaning.
- Please remove it from the ice maker and clean the inside and outside with a soft cloth, when cleaning the ice basket.
- Do not use mechanical equipment to thaw the ice maker.
- Do not puncture the refrigerant pipe.
- In order to minimize the repair and replacement of wind turbines that may be caused by incorrect components or incorrect services, authorized service personnel from the factory should be responsible.

Danger or Warning: This device belongs to household appliances and is not suitable for children or weak individuals to use without supervision. Young children should be supervised to ensure that they do not play with appliances.

Attention: The ice maker should be installed in accordance with relevant refrigeration system safety standards, and should not be installed in corridors or hallways of public buildings.

This device uses flammable refrigerants. There is a risk of fire or explosion caused by refrigerant pipe piercing in extreme cases; Please carefully follow the operating instructions when using.

Warning!

There is a cutting risk inside the machine, please do not reach into the ice outlet, when the equipment is running.

Instructions for ice maker related buttons and accessories

- ① Power button:
Press the button once to turn on/off the device
- ② Soft Ice / Ice Making button:
Press the button once to start ice making
- ③ Clean/Cleaning button:
Press and hold for 3 seconds for automatic cleaning
- ④ Indicator light
(Power - Add Water - Ice Full)
- ⑤ Cleaning auxiliary cover
- ⑥ Drainage pipe
(Located on the back of the machine)
- ⑦ Water storage tank
(Located inside the machine)
- ⑧ Drainage plug
- ⑨ Detachable ice basket
- ⑩ Ice shovel
- ⑪ Water injection funnel
- ⑫ Tray
- ⑬ Water inlet

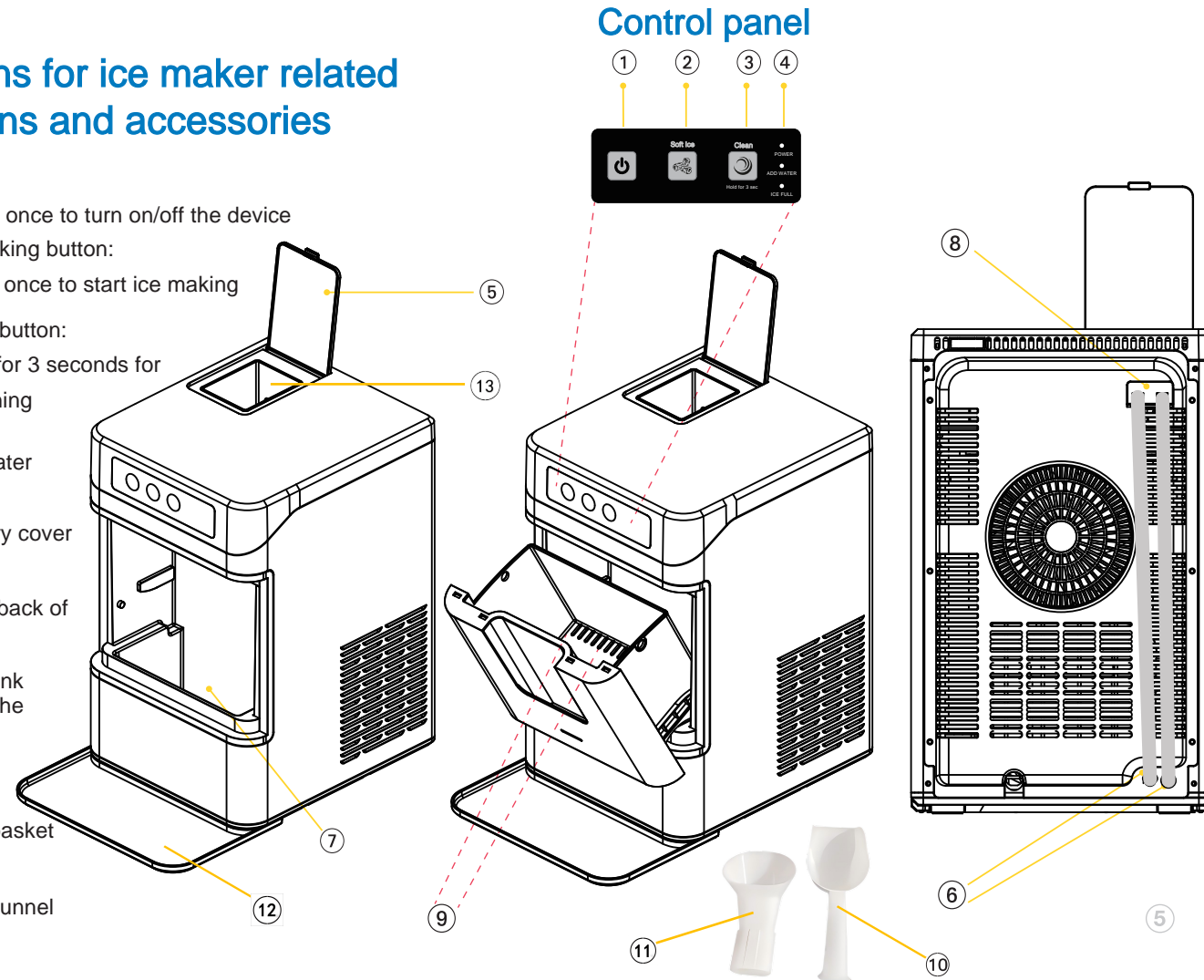

Control panel

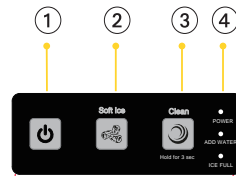

It is recommended to clean the machine before using it for the first time

First use The ice maker must stand upright for 24 hours before its first use to stabilize internal components.

- ① Add an appropriate amount of white vinegar and distilled water solution (1 cup of white vinegar+1 cup of distilled water) to the water equipment.



- ② Press and hold the automatic cleaning button for 3 seconds to turn on automatic cleaning. After 3 minutes, the automatic cleaning is completed and the LED light goes off.
- ③ Unplug the power plug of the device and locate the end of the drain pipe from the back of the device, then unplug the drain plug. Discharge the wastewater after cleaning.
- ④ After the drainage is completed, plug the drain plug back and hang the drain pipe.
- ⑤ Plug in the power and repeat steps 2-4 two to three times with clean water. During the drainage process after each automatic cleaning, always unplug the power plug and disconnect the power to avoid electric shock

Kind reminder: If you use the ice maker every day, we recommend that you clean the ice maker at least once a week. It is normal for the ice maker to make some small noise during ice making and automatic cleaning.

Operating instructions

- ① After cleaning and rinsing, place the device on a stable countertop or flat surface, leaving at least 30 centimeters of space around the device, including the left, right, and back sides, to ensure proper ventilation.
Connect the power plug to the power socket (110V~60Hz)
- ② Add an appropriate amount of clean water into the storage tank, and add the amount of water to reach the optimal bottom of the ice basket. Try not to exceed the bottom of the ice basket. Please do not use any liquids other than water. If using liquids other than water to make ice, the warranty of the machine will be invalidated. Due to the varying levels of cleanliness of tap water in different regions, it is recommended to use purified or distilled water for ice making.
- ③ Press the power button to start the ice maker.
- ④ Press the "Ice Making" button to start ice making. Ice cubes will be produced within 10 minutes and continue until the bucket is full or the machine indicates a shortage of water. In the first 3-5 minutes, it will produce crushed ice, followed by soft ice. It produces 600 grams of ice within the first hour, and when the ice production reaches 800 grams, the machine will detect full ice and then enter a paused ice making state.

Ice making pause sensor: If the ice basket is full and the ice has not been removed for use, or if there is no activity after scooping ice from the ice bucket for more than 1 minute, the ice maker will stop making ice.
Restore ice making: Press the ice making button twice to restore ice making.

Water level indicator: When there is insufficient water, the water shortage indicator light will start flashing. After adding water, press the ice making button and the ice maker will resume ice making.

Ice Full Indicator Light: When the ice basket is full of ice, the ice making button flashes for 60 seconds, and then the ice full indicator light comes on, and the ice maker stops making ice. To restart ice making, please press the power button twice to continue ice making. The first press of the ice making button turns off the ice full indicator light, and the second press of the ice making button starts ice making.