

# HARDY ISLAND ACCENT SPOT LIGHT

## 16571BSK-LL

### 12V SMALL LED 2.5W WALL WASH

Hinkley's low-voltage wall-wash floodlights are designed to enhance your home's architecture with a warm ambient glow. With optimized illumination, you can accentuate outdoor structures and extend alfresco living spaces. Named after the ruggedly beautiful island off the coast of British Columbia, our Hardy Island Collection is impeccably constructed with solid cast brass to defy the harshest environments.

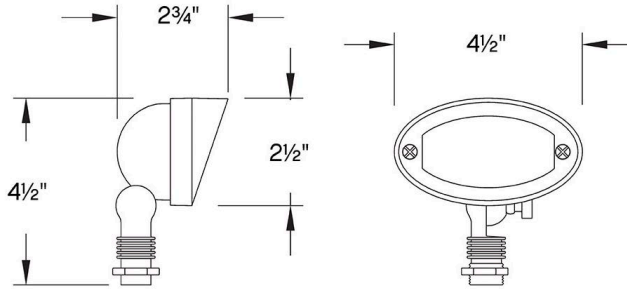

DETAILS	
FINISH:	Brass Satin Black
MATERIAL:	Cast Brass
GLASS:	Frosted Lens
DIMMABLE:	YES - WITH MLV ON TRANSFORMER PRIMARY

DIMENSIONS	
WIDTH:	2.8"
HEIGHT:	4.5"
DEPTH:	4.5
WEIGHT:	1.5lb

LIGHT SOURCE	
LIGHT SOURCE:	Socketed
WATTAGE:	1-2.50w Mini Wedge LED *Included
VOLTAGE:	12v
VOLT AMPS:	3.8
TRANSFORMER REQUIRED:	Yes

MOUNTING	
LEAD WIRE:	1 X 18"

SHIPPING	
CARTON LENGTH:	9.5
CARTON WIDTH:	6.5
CARTON HEIGHT:	3.3
CARTON WEIGHT:	2

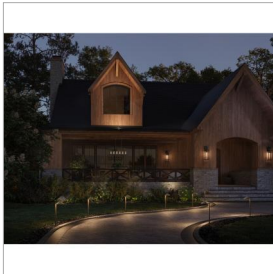

#### PRODUCT DETAILS:

- Fixture is oval in shape
- Hardy Island Series products carry a lifetime limited warranty
- Suitable for use in wet (outdoor direct rain) locations as defined by NEC and CEC. Meets United States UL Underwriters Laboratories & CSA Canadian Standards Association Product Safety Standards
- LED Bulbs carry a 3-year limited warranty
- Classic lines and heritage details complement traditional architecture
- For more information on how to control your landscape lighting via the Hinkley Home Automation App, click here.
- The Hardy Island Collection, named for the ruggedly beautiful island off the coast of British Columbia, defies the harshest environments in style with landscape lighting that features fully enclosed bulbs and a rich weathered brass finish that will mature naturally over time.
- A wiring kit and ground spike are supplied

# HINKLEY

HINKLEY  
33000 Pin Oak Parkway  
Avon Lake, OH 44012

PHONE: (440) 653-5500  
Toll Free: 1 (800) 446-5539

hinkley.com