

Installation & Assembly

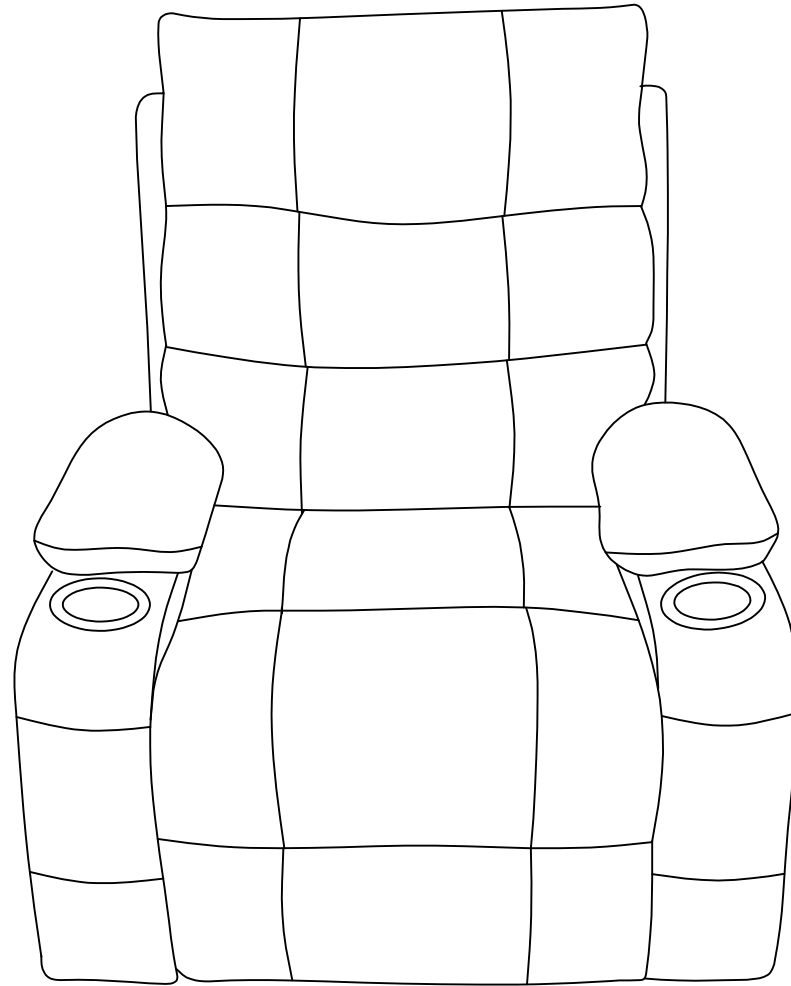

PART LIST

A

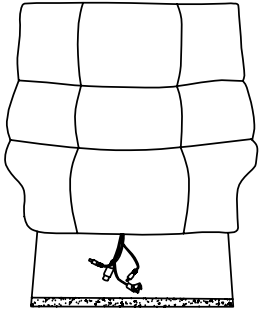

B

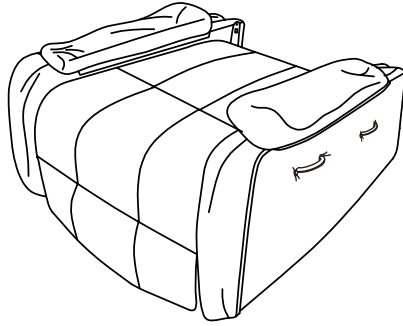

C

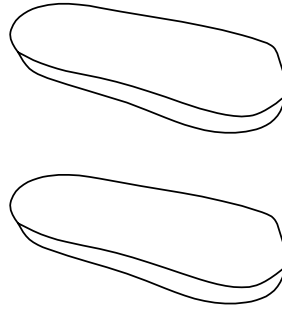

D

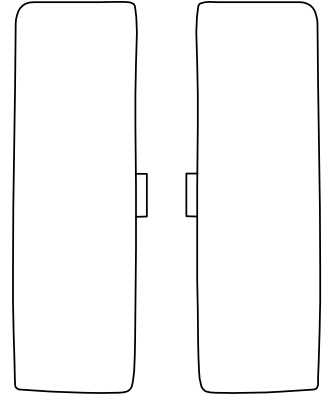

E

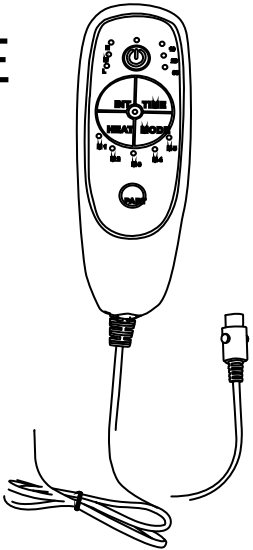

F

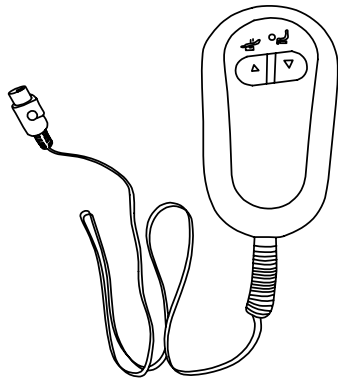

G

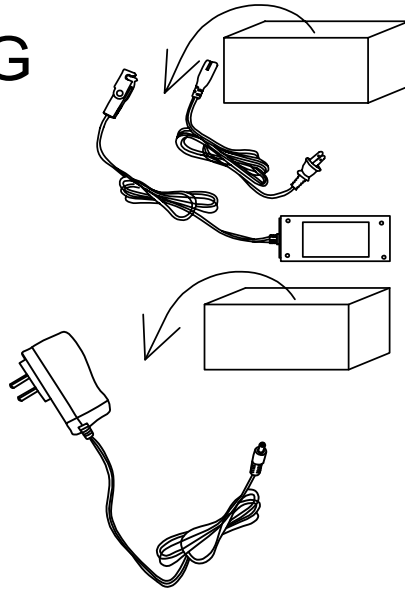

H

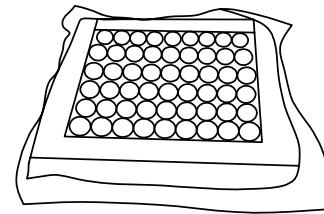

I

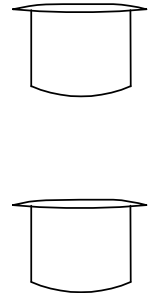

1

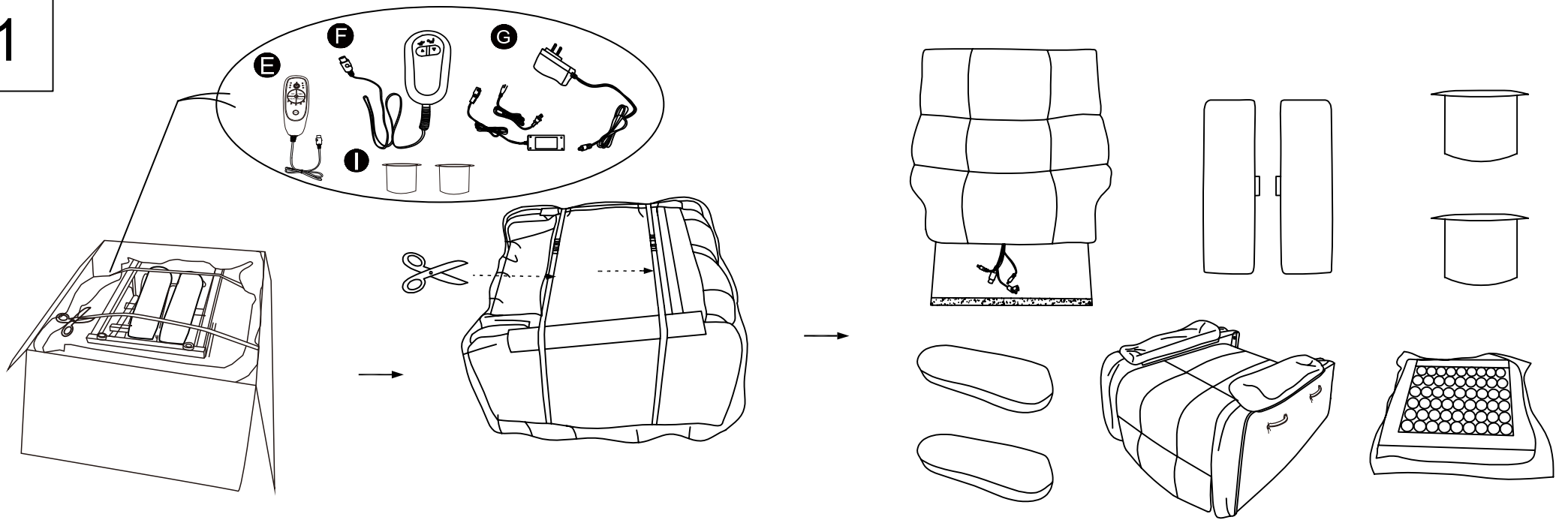

2

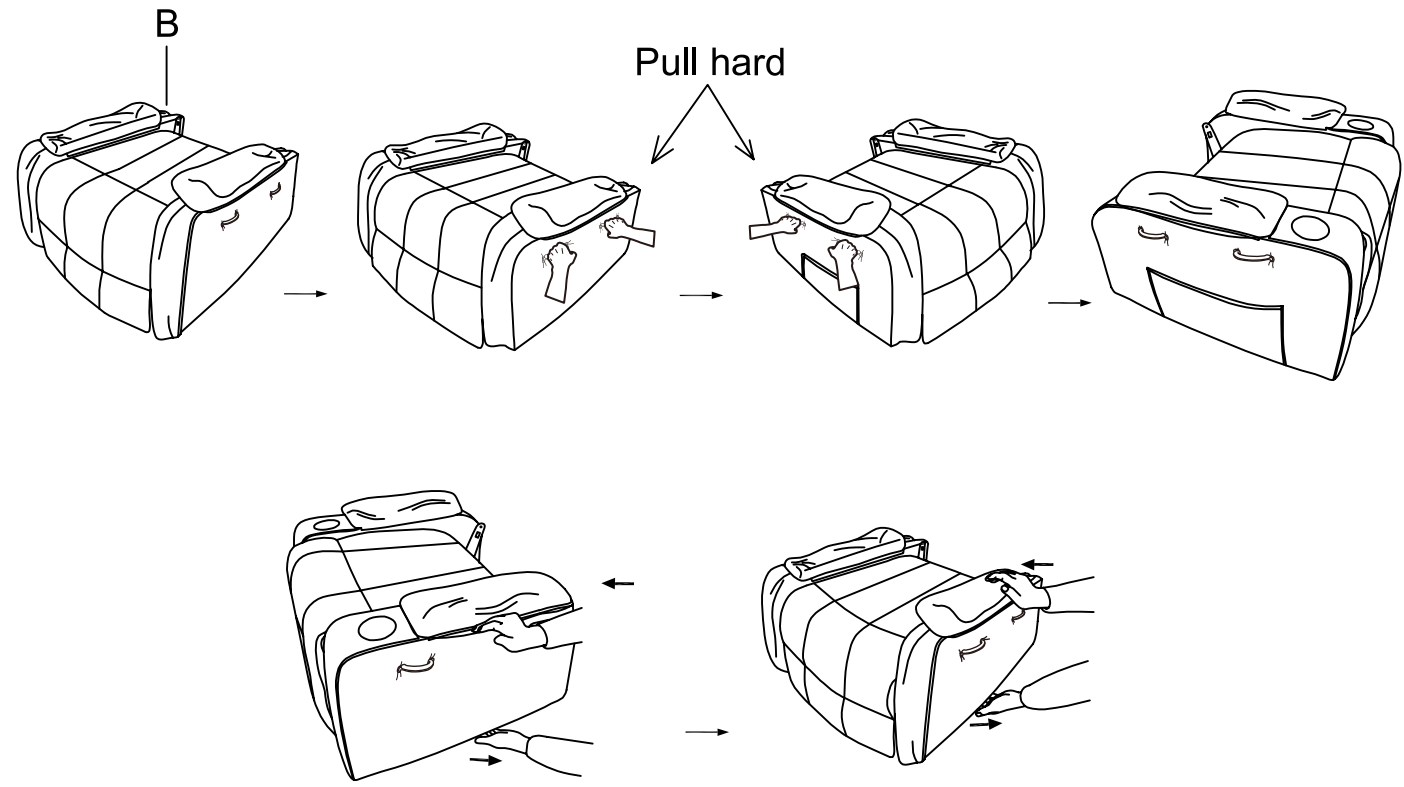

3

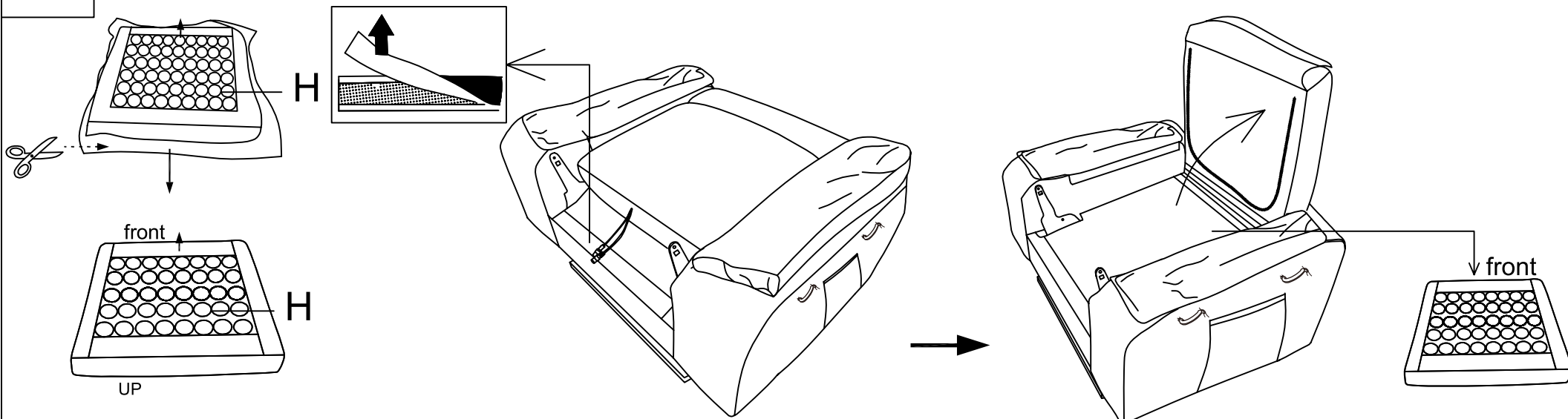

4

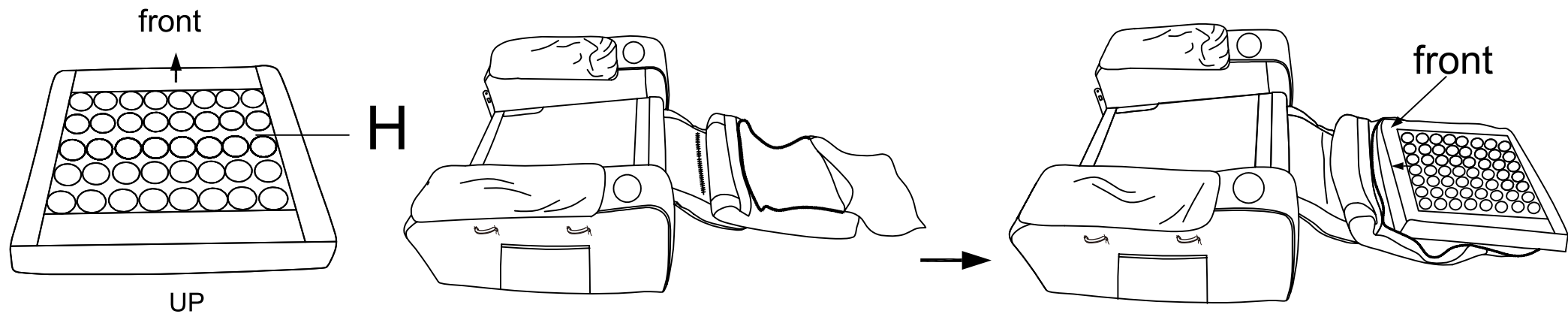

5

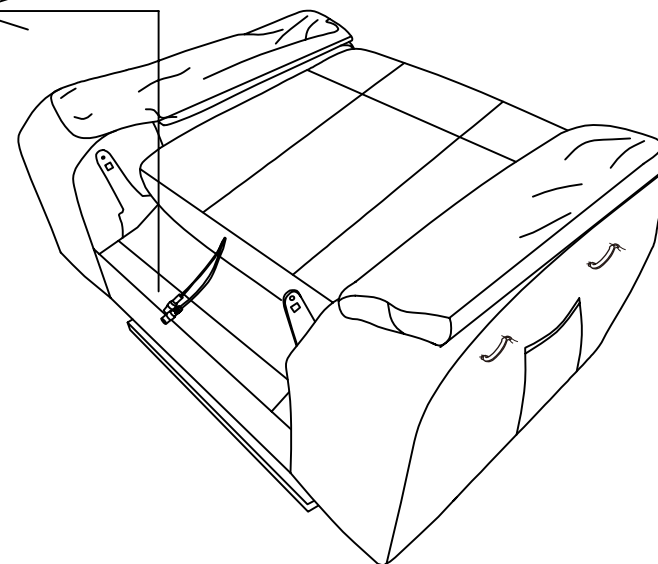
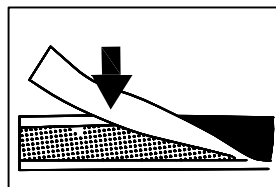
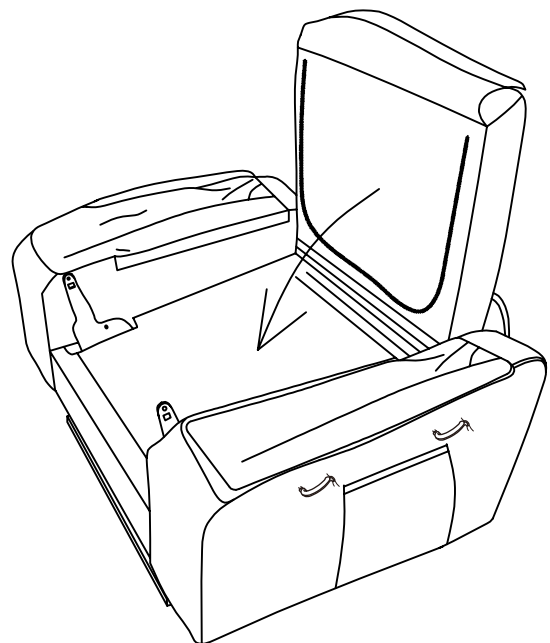

6

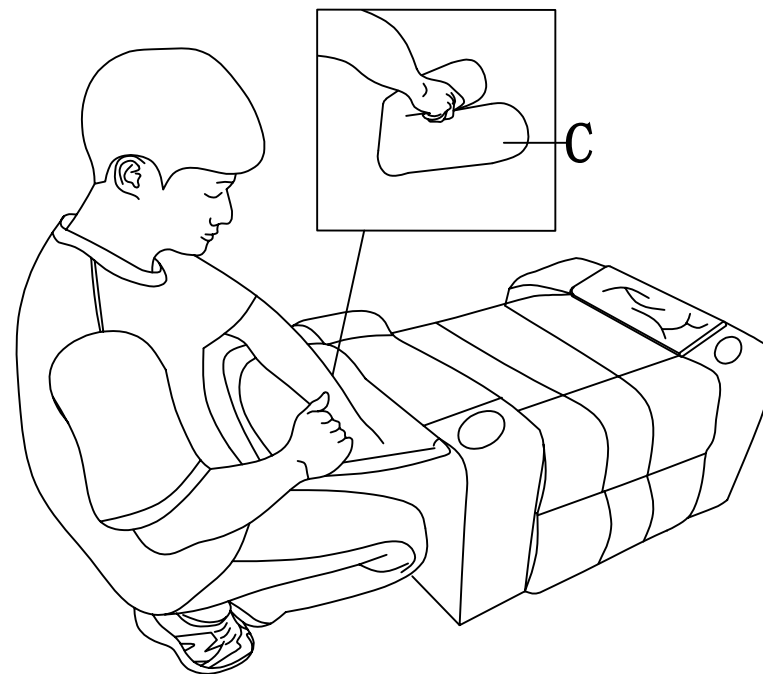
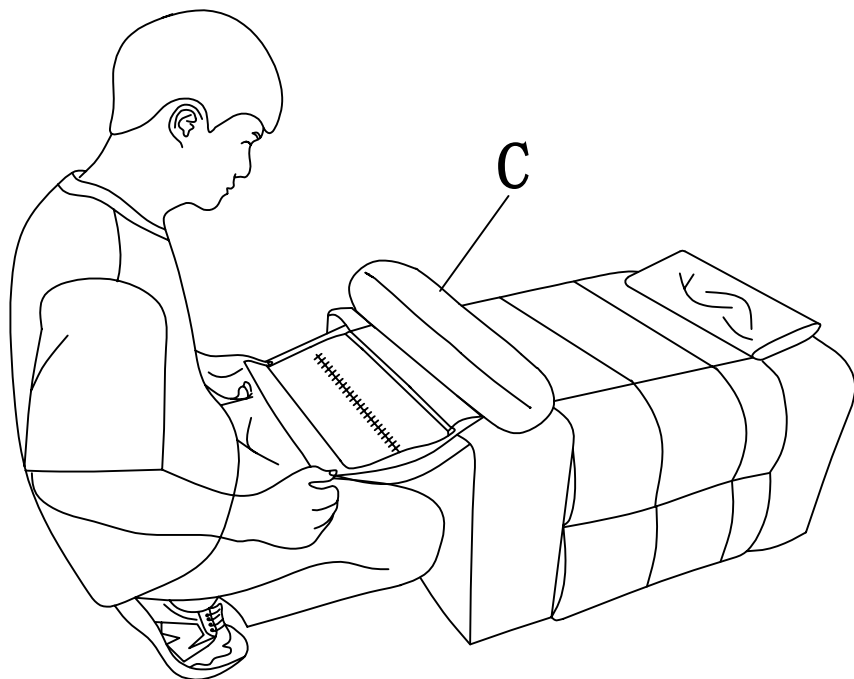

7

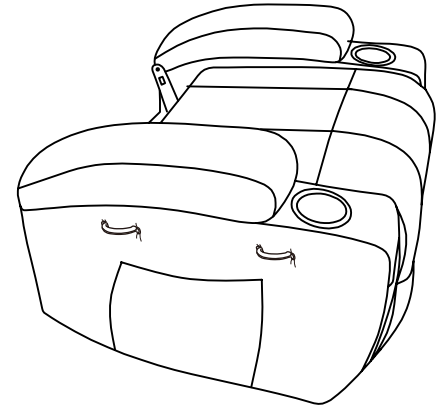
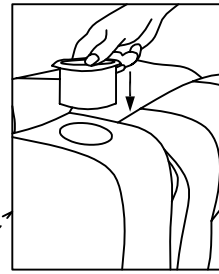
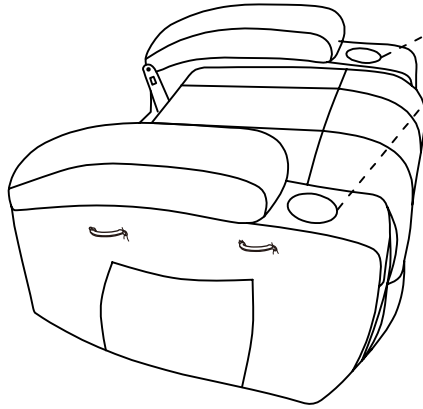
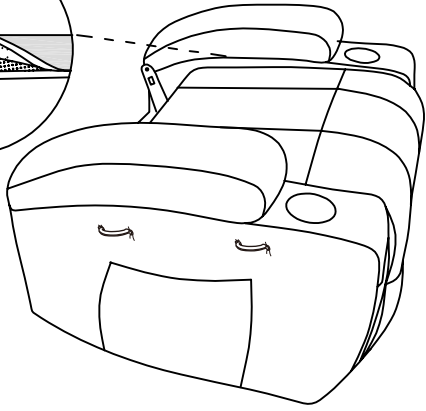
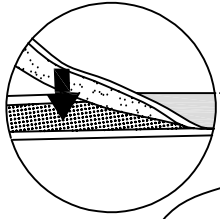

8

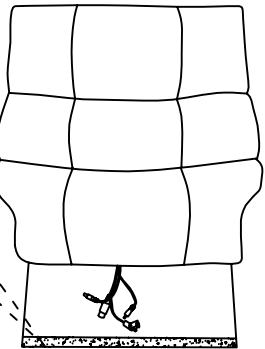
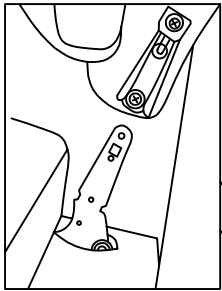

A

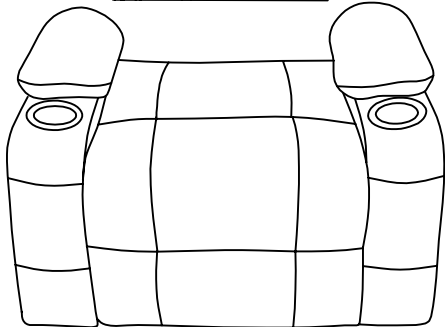

B

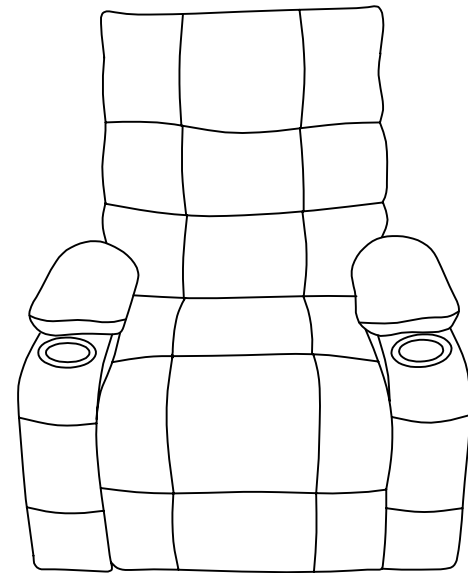

9

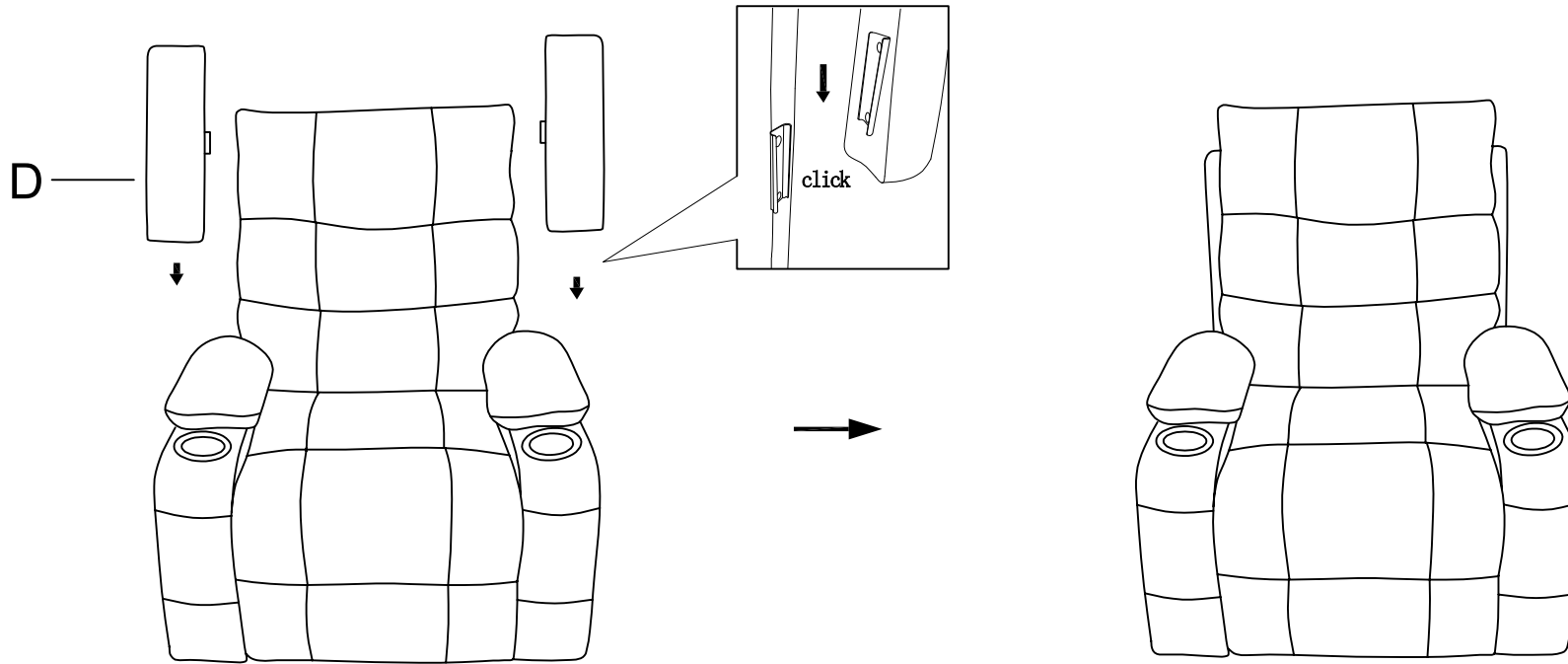

10

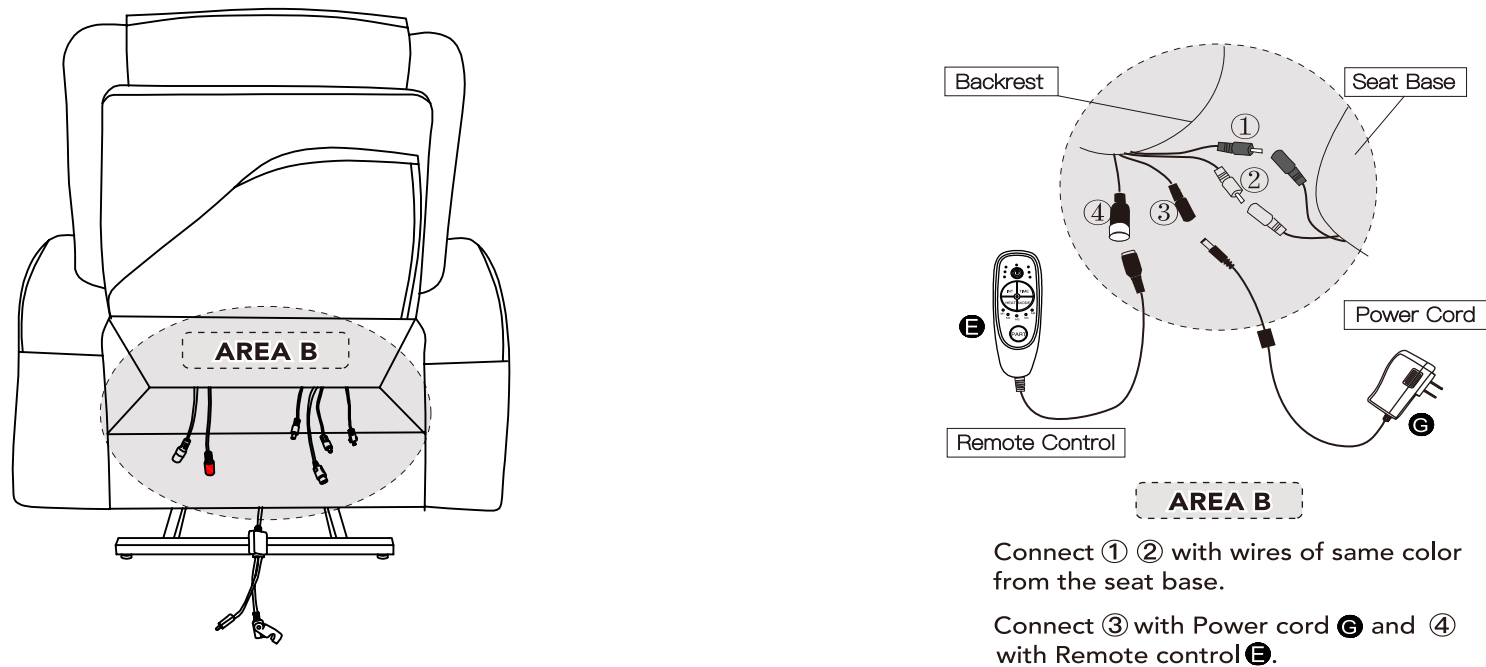

Connect ① ② with wires of same color from the seat base.

Connect ③ with Power cord **G** and ④ with Remote control **E**.

11

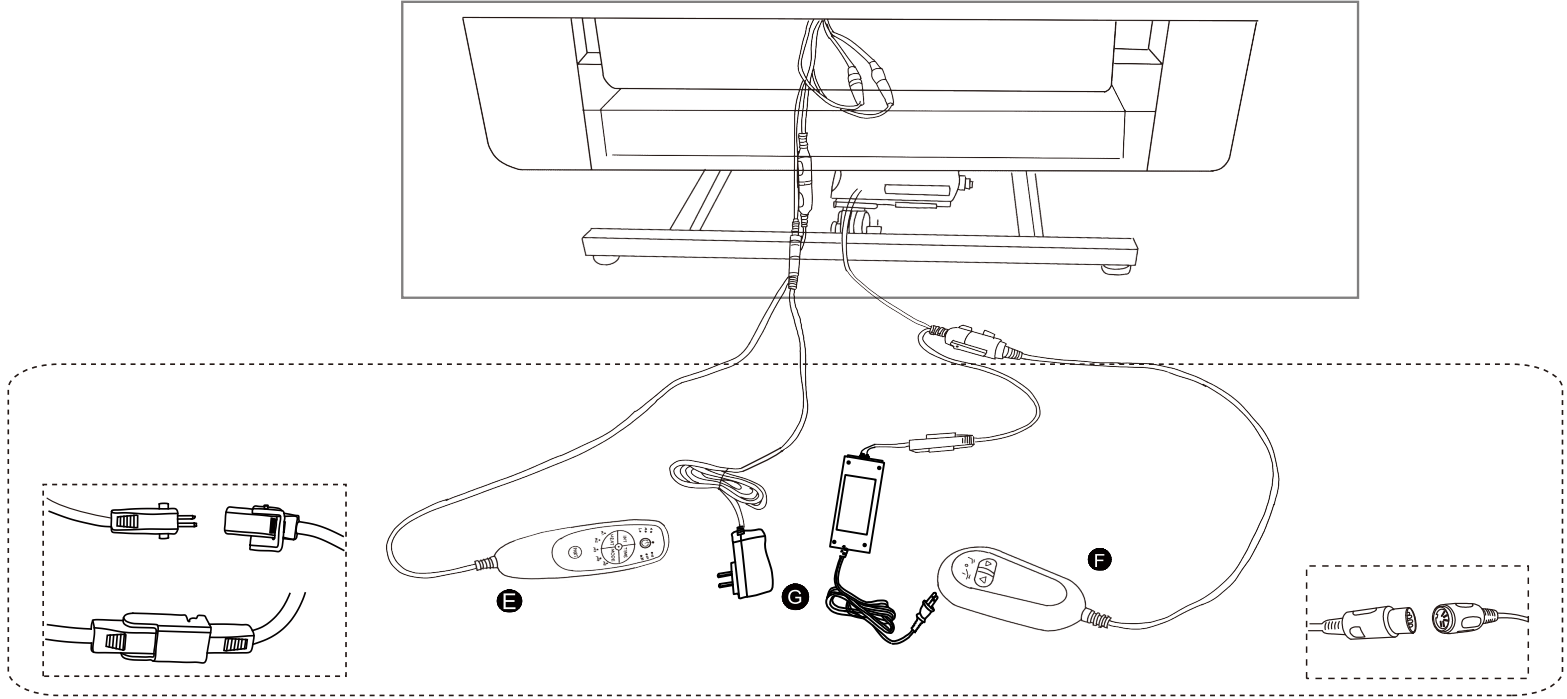

12

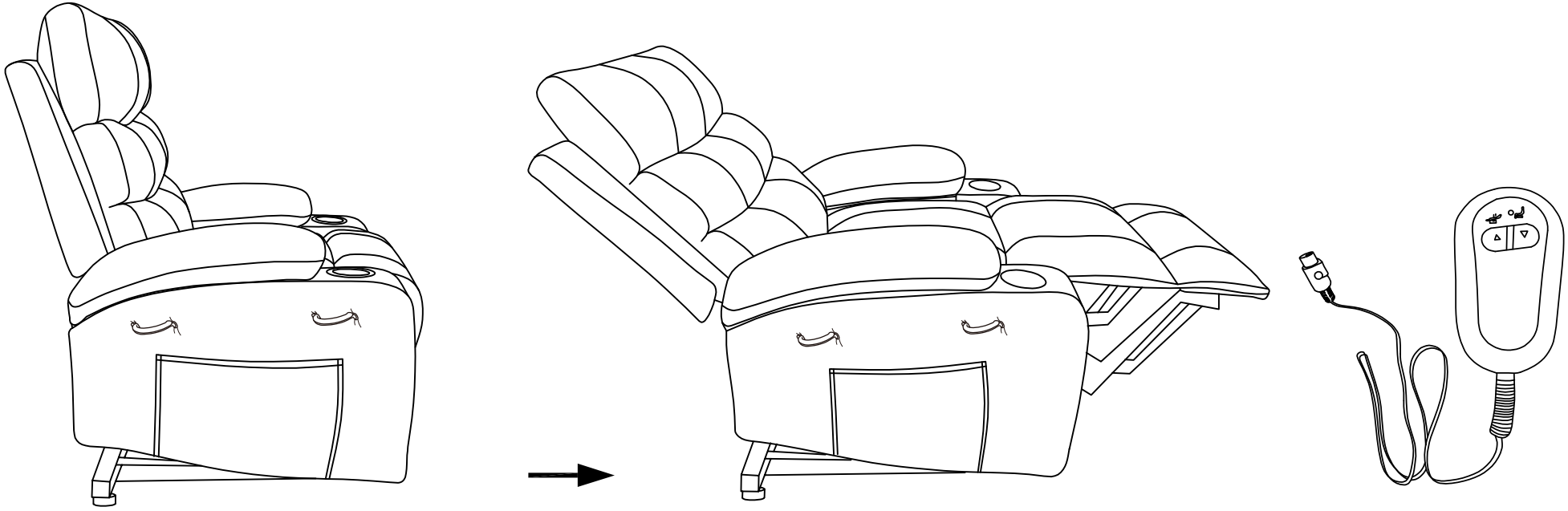

Manual controller function manual

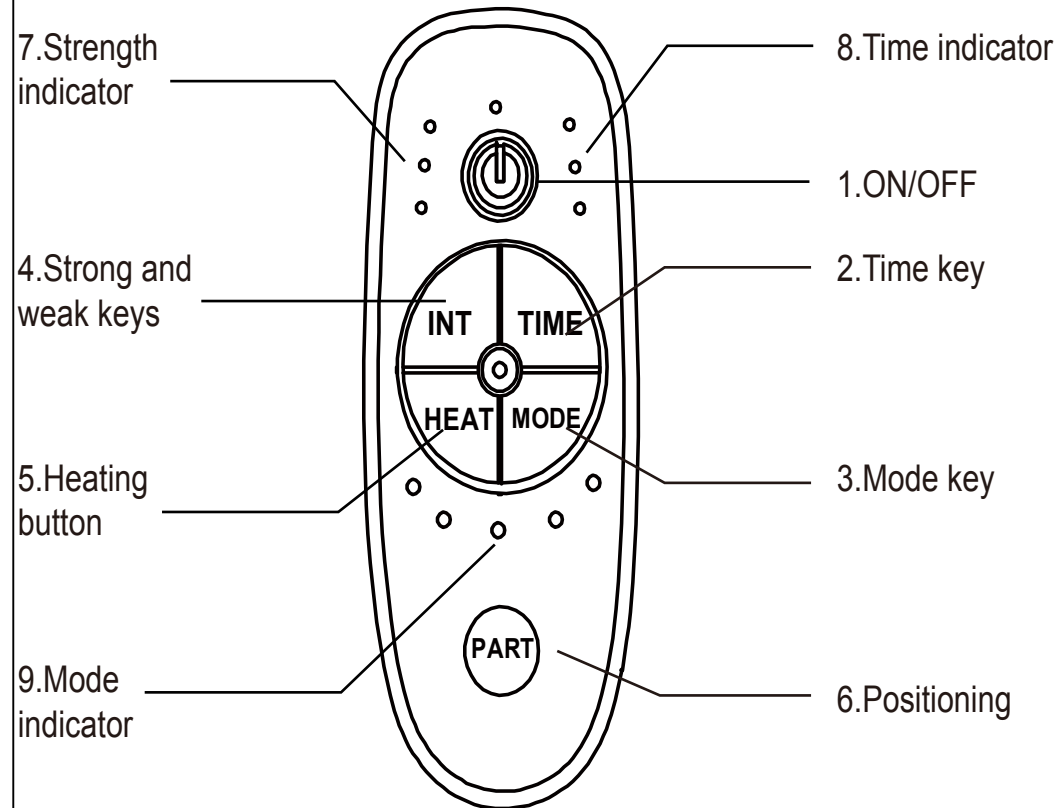

I 、 Specifications of power adapter

Power on in standby state. The user can realize the function through the hand controller control

Input :AC 100-240V, 50Hz/60HZ; Output: DC12V1A.

II 、 Product features

1. Motor vibration at position 8
2. 1-way heating plate
3. Three-segment timing, the default timing shutdown time is 10Min
4. 3rd gear vibration intensity
5. 5 vibration modes

III 、 Function details

1. ON/OFF: Switch on and of
2. TIME: Positioning cycle by massage time (10/20/30 min) , Boot default 10min
3. MODE: Tap the five vibration modes to switch (M1/M2/M3/M4/M5),The default startup mode is M4
4. INT: Switch point by vibration intensity (H/M/L) ,Boot the default M file (medium Files)
5. HEAT: Click heating switch circulation
6. PART: Vibration positioning key , Boot the default vibration is full on, tap to switch to a single part vibration
7. Strength indicator
8. Time indicator
9. Mode indicator