

ASSEMBLY INSTRUCTIONS

Pantry Cab

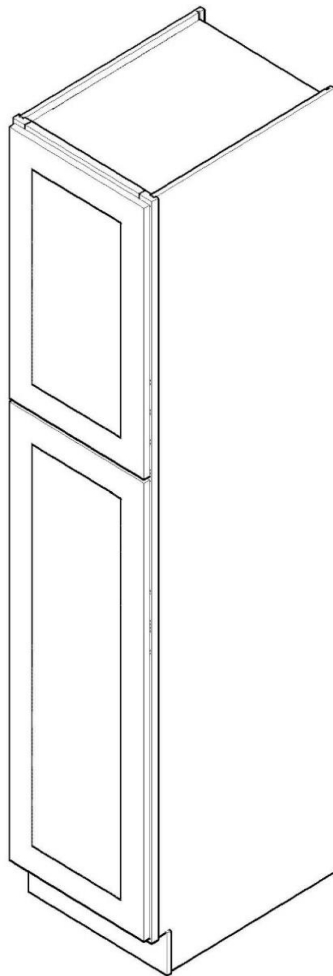

ASSEMBLY INSTRUCTIONS

Unpacking Precautions

If using a sharp object to unpack the cabinet components and the packing materials, be careful to avoid scratching or damaging the cabinet components. The various packing materials may be used to protect the cabinet components during assembly. During the unpacking process, place the various components away from and to the side of the work area so that they will not be inadvertently knocked over or otherwise damaged.

Hardware Considerations/Screw Size Clarification

(I) 1/2" (Small)

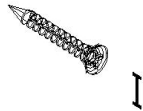

(K) 1 1/8" (Large)

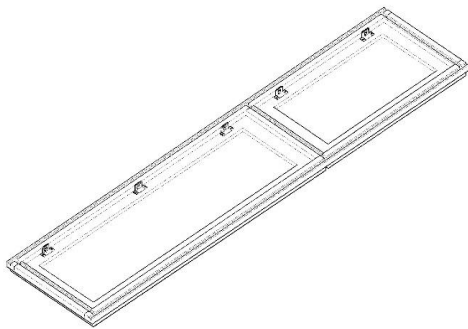

Step 1:

Lay the face frame with doors (A) on a soft surface, doors facing down.

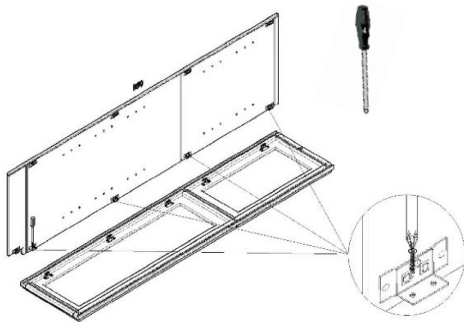

Step 2:

Using the wood glue, squeeze a small bead of glue in all grooves before assembling the cabinet sides, bottom, top and back panels. Be careful not to use too much glue, this could cause access glue to squeeze out and onto the panels. If this should happen, be sure to remove quickly.

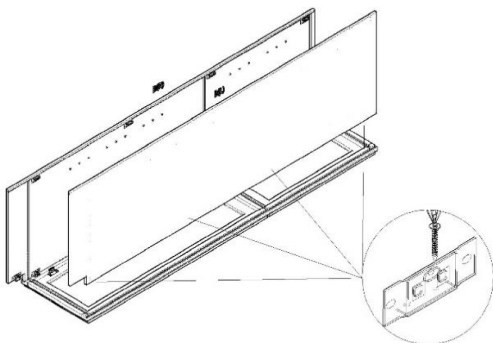

Slide the Right Side panel (R) in the **Step 3:**

Slide the left (L) & right side panel (R) in the groove of the face frame, and mount the male clip to the face frame with the screw driver. Each male clip

will need 2 Small screws(I). fig 1

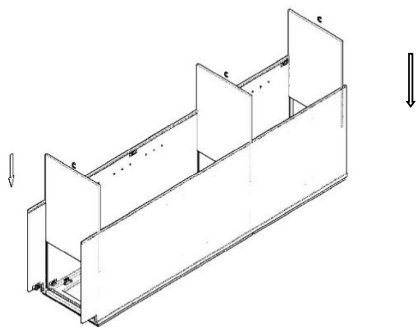

Step 4:

Slide the top, middle & bottom panels into the grooves of the right and left side panels, and then into the groove in the frame below until it is fully seated.

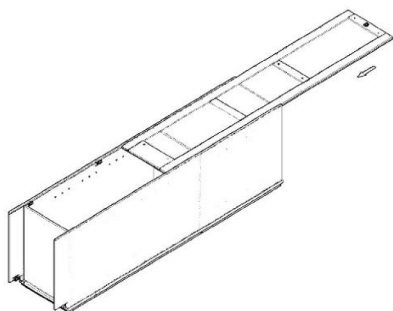

Step 5:

Insert the back panel(D) between the two side panels, align it to the two side panels.

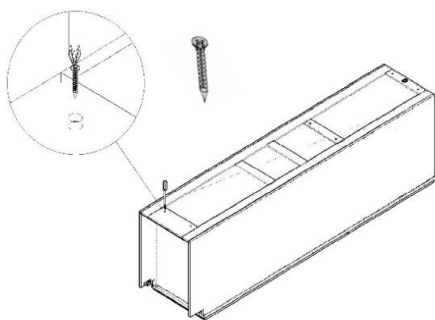

Step 6:

Using the long screws (K) and the pre-drilled holes , attach the back panel to the edges of the top/middle/bottom.

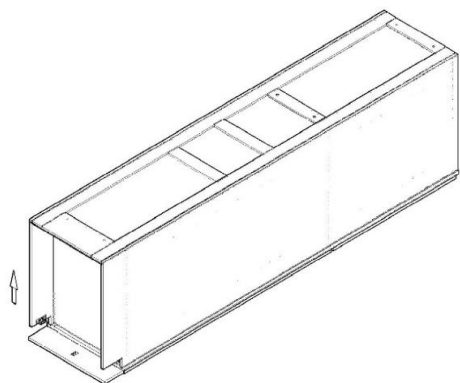

Step 7:

Secure the toe kick into the bottom of the cabinet (two small screws(I) in each side of the two clips)

-3-

Step 8:

1. Put the shelf pins on the left and right side panels using the holes provided. Be sure pegs on the left & right are in the same position to insure a level fit.

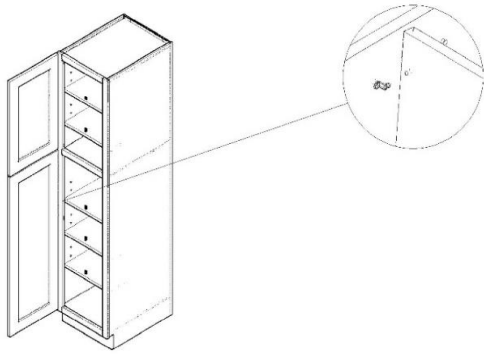

-4-