

OUTDOOR WALL LANTERN USE AND CARE GUIDE

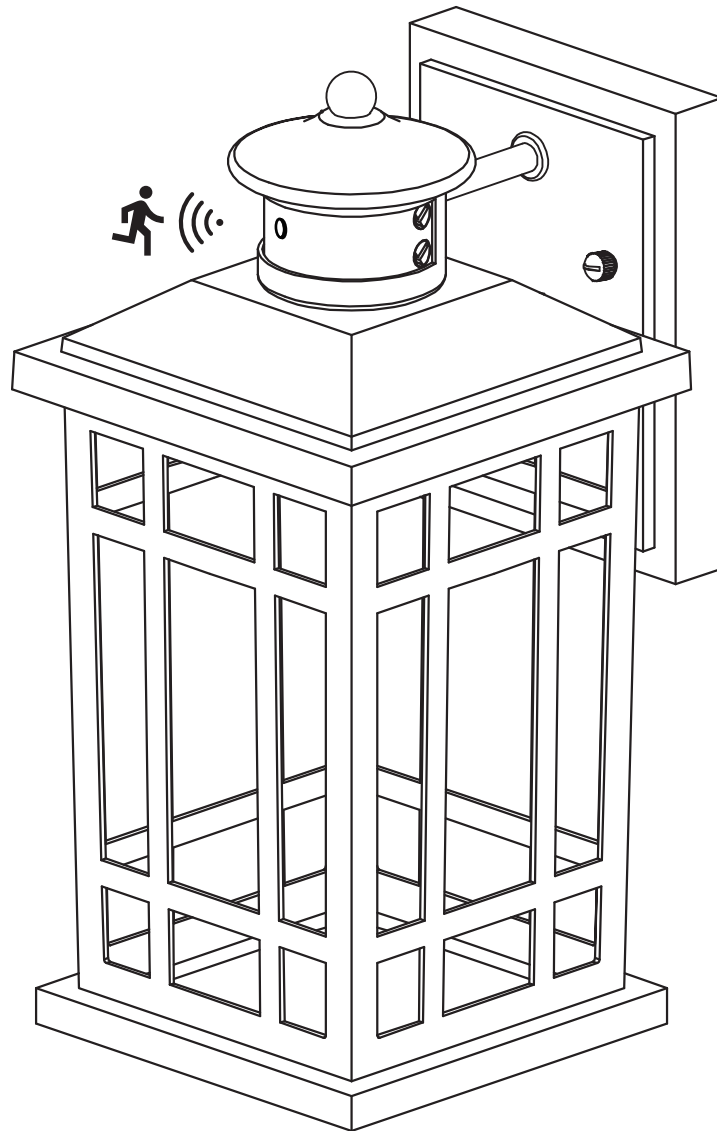

Installation Instructions For Outdoor Wall Light



INSTRUCTIONS PERTAINING TO RISK OF FIRE OR INJURY TO PERSONS
READ ALL INSTRUCTIONS

**IMPORTANT SAFETY
INSTRUCTIONS**
SAVE THESE INSTRUCTIONS

Before starting the installation, disconnect the Power by Turning Off the Circuit Breaker. Turning the Power Off using the LightSwitch is not sufficient to prevent electrical shock. All electrical connections and installation must be following local codes, ordinances, and/or National Electric Code and Must Be Done by an Electrician Only.

TYPE			
QTY	3pcs	2pcs	2pcs

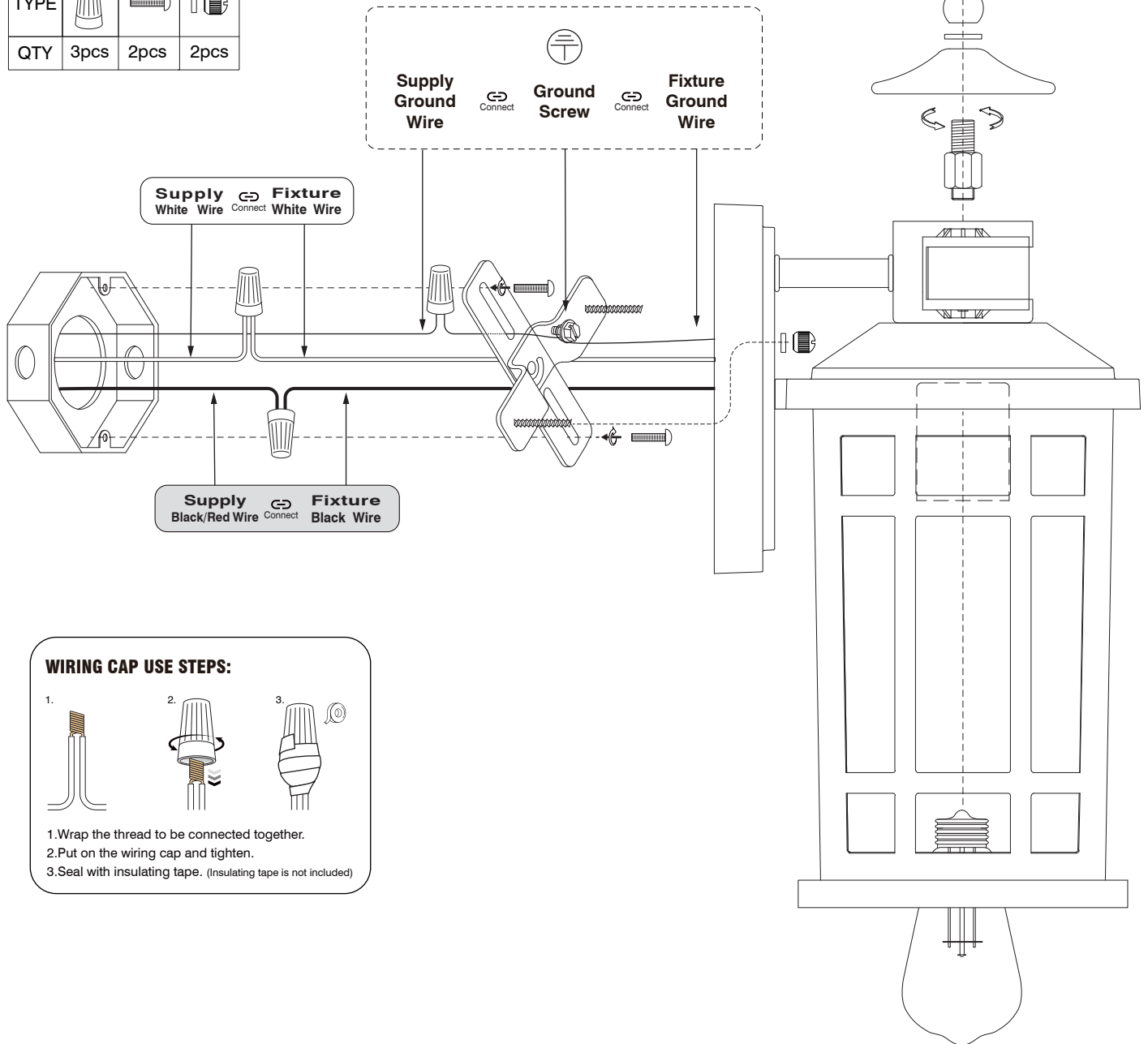

WIRING CAP USE STEPS:

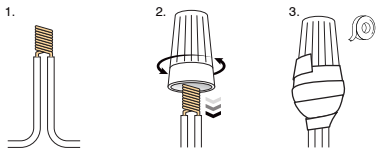

1. Wrap the thread to be connected together.
2. Put on the wiring cap and tighten.
3. Seal with insulating tape. (Insulating tape is not included)

INSTALLATION NOTES:

Please note: This lamp cannot be installed on any dimmer switch. Using a dimmer switch will damage the sensor circuit of this lamp.

When installed in dim or shaded areas, during winter, or in low-light conditions, the lamp might not switch off automatically. Please manually turn off the lamp when necessary.



E26 Max.100W

Please use LED bulbs or incandescent bulbs to be well compatible with the wall lantern and avoid flicker problems. (Bulbs not included)

Assembly Instructions

TOOLS AND MATERIALS REQUIRED:



Phillips
Screwdriver



Wire Cutters



Pliers



Ladder

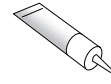

Mastic Silicone
Rubber



Safety Glasses

INSTALLATION:

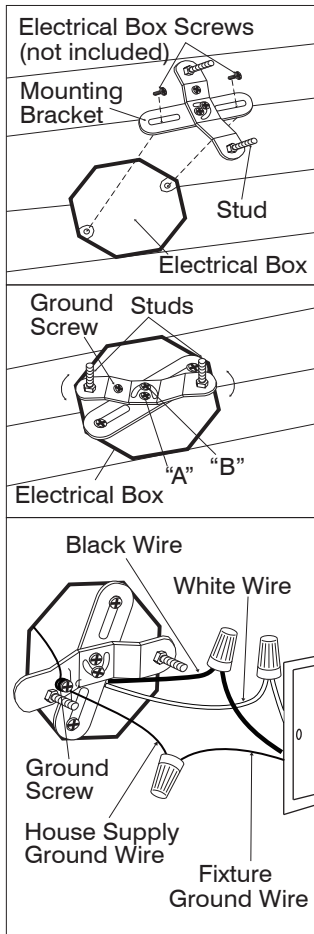

1. Mount the mounting bracket to the electrical box using electrical box screws (not included). Make sure the studs on the mounting bracket are facing out from the electrical box.

2. Position the mounting bracket so that the fixture will sit level once it is mounted to the wall. Tighten screws "A" and "B" to hold in place.

3. Firmly attach the fixture ground wire (bare copper) to the mounting bracket with the ground screw (by wrapping around the ground screw) and then connect it to the house supply ground wire with a wire nut. Connect black wire from fixture to black wire in the electrical box and connect the white wire from fixture to white wire in the electrical box.

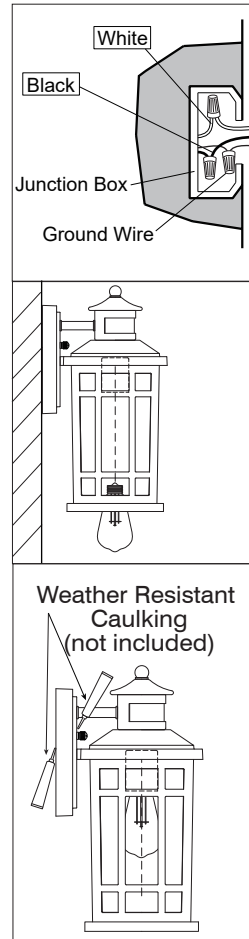

4. Once connections of wires are completed, carefully tuck wires and wire nuts into the electrical box making sure no bare wire (on the black and white) is visible at the wire nuts. Position fixture over studs on mounting bracket assembly. A secure fixture in place cap nut(s).

5. Install the proper bulb type and wattage (not included). Note: Please use dimmable led bulbs or incandescent bulbs to be compatible with wall lights and avoid flicker problems. Very few models of dimming bulbs may have compatibility issues. If flickering occurs, please consider replacing dimming bulbs of other brands.

6. After Installation, seal around the top and side perimeter between the fixture and the wall surface with weather-resistant caulking. The bottom should be left un-caulked to prevent moisture build-up. Apply a small amount of weather-resistant caulking around the side perimeter between the cap nut and mounting plate.

1 YEAR LIMITED WARRANTY*

This product is warranted against defects in material and quality for 1 year from the purchase date. This warranty does not cover acts of nature such as lightning damage or corrosion and discoloration of components. Nor does it cover damages caused through abuse, improper installation, surges in electric current, or acts of third parties.

This warranty does not cover the costs of removing and resealing the lighting fixture.

If this product falls for any reason covered by this warranty, feel free to contact us.

Motion Sensor Quick Guide

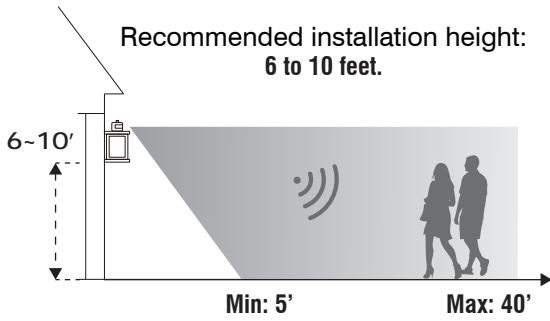

Please make sure the light is mounted straight on the wall the wall to avoid limiting the detection distance.

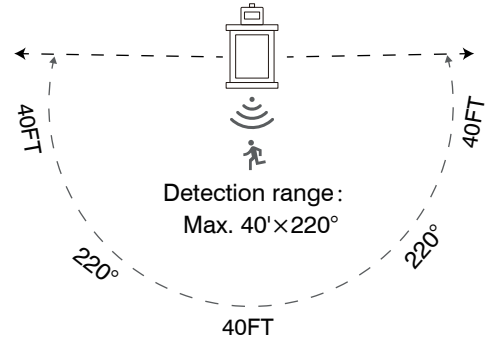

Motion Detection



Important

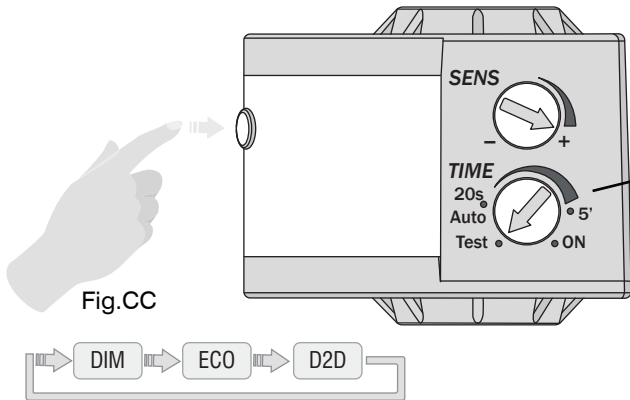

Fig.AA

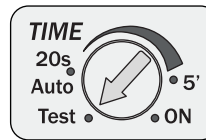
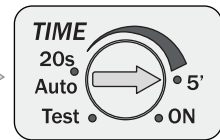
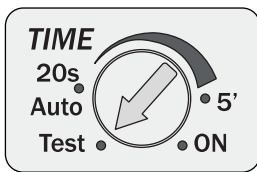

Fig.BB



After the lamps are installed, please adjust this knob from TEST to AUTO mode, otherwise the lamps will not automatically turn off during the day, and other functions cannot be realized.



TEST MODE: When the fixture is powered on, it will illuminate for 15 seconds regardless of day or night, continuously testing the functionality of the fixture and bulb. It will then switch to the motion sensor test mode, where the fixture's sensor will briefly light up in response to motion to assist in the installation test. (The test mode is only for installation testing and is not a normal working mode.)(Fig.AA)

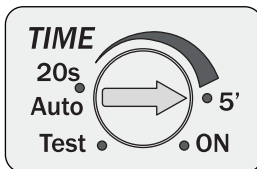

AUTO TIME After completing the initialization test, it is necessary to turn the TIME knob from TEST to AUTO mode,(Fig.BB) In the auto mode, you can adjust the light holding time after the motion sensor is activated, from 20 seconds to 5 minutes.Only within this mode's time range can you utilize the sensor button to switch between the three modes: DIM, ECO, and D2D. (Fig.CC)

Please refer to the motion sensor manual for more detailed function settings.