

# INSTALLATION INSTRUCTIONS



1. Begin by assembling the legs to the base plate. Fasten them securely with the screws.



2. Carefully turn the tabletop over so its bottom is facing up.

Place the assembled legs onto the tabletop, matching the holes on the base plate with those on the tabletop. Evenly tighten three screws per side to complete a stable connection.

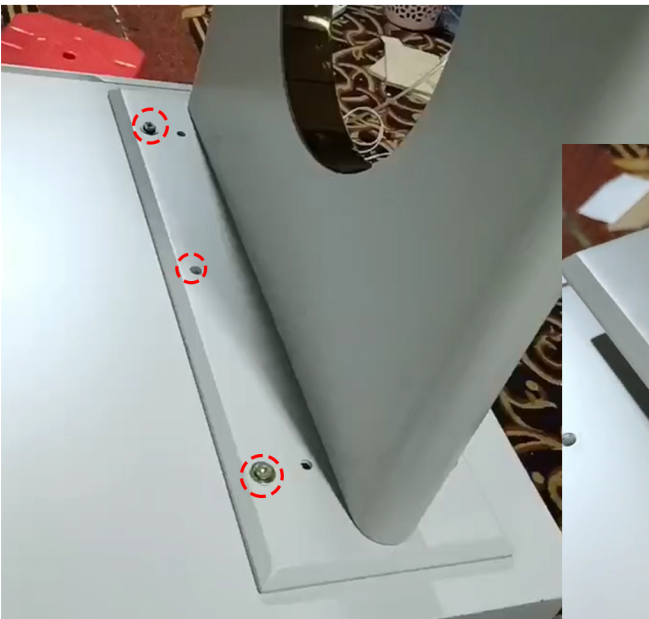

3. Attach the frame to the underside of the tabletop by aligning it with the pre-drilled holes, then secure it firmly with screws.



4. Flip the assembled tabletop over and place it onto the side cabinet to complete the installation