

Cabinet Pull

Specifications

Metal Material	100% Zinc alloy
Packaging	Poly bag
Mounting:	64 MM C-C
Hardware:	two 8-32 screws; included



Dimensions

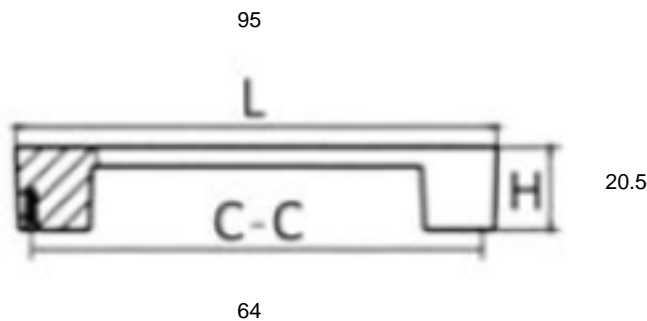

Warranty & Compliances

ANSI/BHMA N/A

Order Codes

Antique Brass
Antique Pewter

Type:
Job:
Order Code:
Approvals:

We reserves the right to make changes in materials, specifications & models at any time. We also reserves the right to discontinue product without notice or obligation.