

USER MANUAL



Lumary

Specifications

Color	RGB
Input voltage	100-240V
Output voltage	5V/3A
Size&LED	2.1m*1.5m(6.9ft*4.9ft) 540LED
Working temperature	-15 C-50 C

Dimmable,16Million Color,Music Sync, App Control, Local control.

 Please note that all colorful string lights cannot be DIY cut !

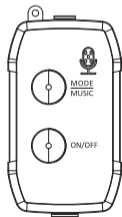

Mode/Music:

Long press the button for three seconds to cycle in sequence the three modes: scene mode, music mode, and monochromatic mode. In the monochromatic mode, click the button to swotch light colors. All the colors loop on sequence; in the music mode, click the button to switch to the next reactive mode. All reactive modes loop in sequence; in the scene mode, click the button to switch to the next scene. All the scene modes loop in sequence.

On/Off: Short press to turn on/off the LED light.

IR Remote Controller 40 KEY

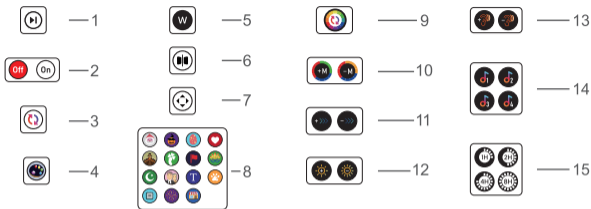

1. Pause/ Run Button

2. Turn On/ Off.

3.All modes in cycle button.

4.Color wheel, press to select color.

5.Cool white and warm white button.

6.Flip horizontally.

7.Shift upward/downward/left/right, flash, solid.

8.15 theme scenes button.

9.Theme single scene mode loop, switching one every 30 seconds.

10.Single scene mode and music mode switch from previous to next.

11.Scene mode speed adjustment (+/-).

12.LED brightness adjustment (+/-).

13.Music mode sensitivity adjustment [+/-].

14.4 music modes.

15.timer: 1 hour, 2 hours, 4 hours, 8 hours.

Please pull out the plastic tab from the bottom of the IR remote to ensure that the battery is powered properly.

pull out the
plastic tab



Make sure the IR remote aims at the IR receiver within the sensing distance. The angle of the IR receiver is 120 and the sensing distance is 5 meters. Please remotely control within the sensing range.

Installation Diagram

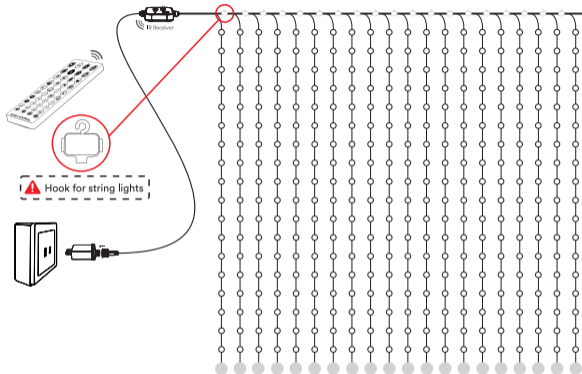

The role of transparent beads:

Each strand of our Christmas Smart Curtain Lights is equipped with a transparent bead at the end. These beads add just the right amount of weight to each strand to reduce bends, ensuring a clean, straight look.

Setting Lumary App

1. Download the "Lumary" App from App Store or Google Play Market, or scan the QR code and install the "Lumary" for either iOS or Android.

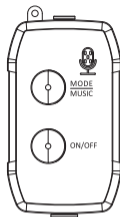
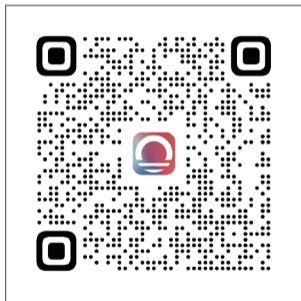

1. Plug in your curtain lights.
2. Once the lights are powered on, press and hold the ON/OFF button for 8-10 seconds.
3. The lights will begin to flash red, indicating they are now in pairing mode.

2. Register a Lumary account.

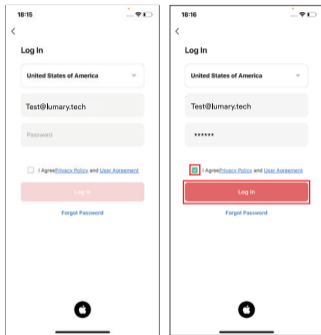

Enter your email address.

Log into the App.

Note: Please select your region and country.

3. Connect

NOTE: Lumary's products can't connect to 5GHz networks.

Steps:

1. Advised to enable Bluetooth, Enable Bluetooth to add some Wi-Fi device easily;

2. Each time the device without distribution network is powered on, confirm the light is breathing or blinking pairing mode;

3. Open the Lumary App, In the top corner of the Devices screen, click "+" and select "Add Device" to confirm that the device is paired.

If not, you need hold Light strip controller button for 5 second ensure red lights is fast blinking.

4. Find the device, choose Wi-Fi and enter password, press "Next". Click "Add", and wait patiently. After that, click "Done", and the device is successfully added to the App.

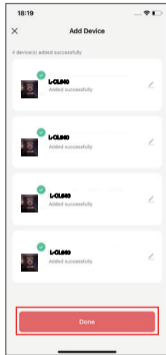
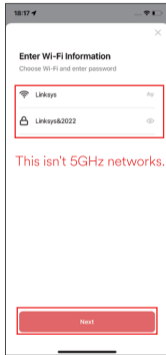
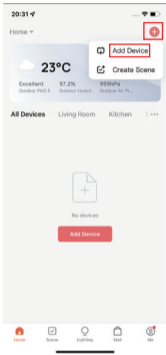

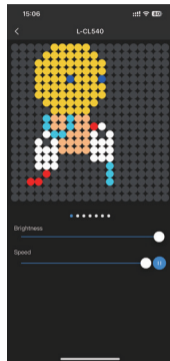
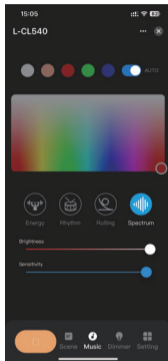
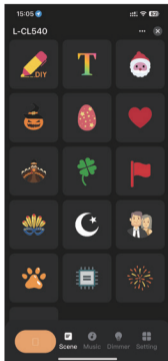

Curtain light string can provide 16 million kinds of colorful light with 16 single colors, more than 100 kinds of scenes, 5 kinds of music modes, customizable DIY text, scene modes in mobile App. The curtain light controller has a built-in highly sensitive microphone, which can make the light of the curtain light change with the surrounding sound, open the favorite song list, the light will move with the music, and make a better atmosphere for the party. The control of the curtain lights is diverse and simple, the remote control can quickly adjust the lights, both thought that is obtained; mobile App can be more refined adjustment of the lights, while the buttons on the controller allow you to cope with a variety of unexpected situations. The curtain light has memory function, after closing and turning on again, the curtain light is still the last set light, with the timer function, you can let the curtain light up your favorite light at any time.



Made in China

FCC ID:2AKBP-AESL37

VOICE CONTROL GUIDE

Name and Control Each Device by Voice



Work With Amazon Alexa

1. Log in to Lumary App, tap the smart device and enter into, click "✎" in the top right corner.
2. Tap "Alexa" in Third-party Control.
3. Tap "Sign In With Amazon".

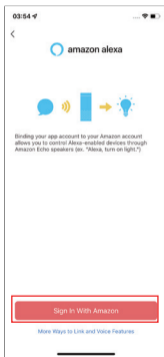
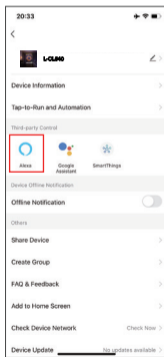

4. Tap "Allow";
5. Linked successfully, when add new device, there is no need to link again, just discover new device in Alexa.

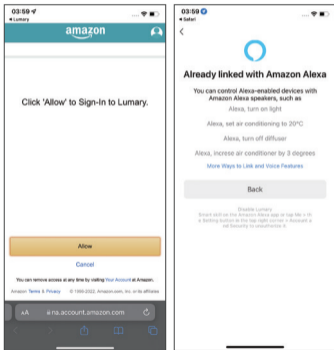

To control your Lumary smart device, just ask Alexa. Make sure your devices are already set up using the Lumary app.

Things you can say*:

"Alexa, discover my devices."

"Alexa, turn on the bedroom light."

"Alexa, set the bedroom light to orange."

"Alexa, turn off the coffee machine."

"Alexa, set the living room to 50%."

"Alexa, dim porch light."

*Some commands require compatible devices.

Work With Google Assistant

1. Log in to Lumary App, tap the smart device and enter into, click "✎" in the top right corner.
2. Tap "Google Assistant" in Third-party Control.
3. Tap "Link with Google Assistant".

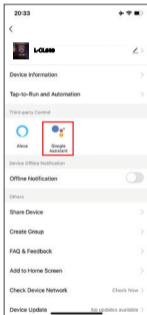

4. Click "Agree and link";
5. Linked successfully, when add new device, there is no need to link again, just discover new device in Google Home.

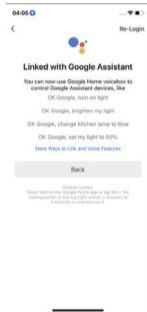
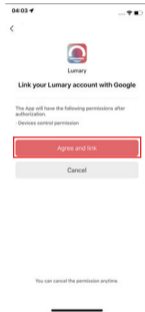



To control your Lumary smart device, just say

"Hey Google", and ask.

Make sure your devices are already set up using the Lumary app.

Things you can say*:

"Hey Google, turn on all the lights in my bedroom."

"Hey Google, turn off the light."

"Hey Google, set the bedroom light to orange."

"Hey Google, turn off the coffee machine."

"Hey Google, set the living room to 50%."

"Hey Google, dim porch light."

*Some commands require compatible devices.

After Sales & Social Media

If you have any questions about product settings or operations, please feel free to reach out to us!

Customer Service Email:

support@lumary.tech

You can also find us on social media. Simply search for our username on your preferred platform, or scan the QR code for quick access.

- Facebook: @lumary.official
- X: @lumary_official
- Instagram: @lumary.official
- Pinterest: @lumary_official
- YouTube: @lumary.official
- Reddit: @Lumarysmartlight
- TikTok: @lumary.official



Facebook



Instagram



YouTube



TikTok



X



Pinterest



Reddit

Can't connect? Need help?



HAVING AN EASY TALK TO US BEFORE YOU RETURN
THE PRODUCT WILL FIX A PROBLEM MORE QUICKLY

Lumary support:

support@lumary.tech

Visit us at:

www.lumary.tech

www.lumarysmart.com