

Dear customer, hello

Welcome to purchase DDLCOL multifunctional camping vehicle!

This product can be combined with the vast majority of bicycles to form a bicycle trailer with just a simple and fast installation. In addition, it can also be used as a pet car, camping trailer, DL folding bike multifunctional storage and storage box for British small cloth bronton outdoor products.

This unique product perfectly blends various outdoor needs together, bring more convenience and fun to your outdoor life, enjoy it freely the charm of outdoor sports!

Wishing you a pleasant outdoor life!

尊敬するお客様こんにちは

DDLCOL マルチキャンピングカーのご購入を歓迎します！

この製品は簡単に迅速な取り付けだけで、ほとんどの自転車と組み合わせて自転車トレーラーになることができます。そのほか、ペットカー、キャンピングトレーラー、DL折りたたみ自転車、英国製の小さな布bromptonの収納ボックスが一体となった多機能アウトドア製品としても利用できる。
この独創的な製品は、さまざまなアウトドアニーズを完璧に融合させ、アウトドア生活により多くの便利さと楽しみをもたらし、アウトドアスポーツの魅力を楽しむことができます！

アウトドアライフを楽しんでください。

尊敬的客户您好

欢迎您购买 DDLCOL 多功露营车！

这款产品只需简单快捷的安装，即可与绝大多数自行车结合成为一辆自行车拖车。除此之外，它还可以作为宠物车、露营拖车、DL折叠自行车、英制小布brompton的储存收纳箱于一体的多功能户外产品。

这款独具匠心的产品，将各种户外需求完美融合，为您的户外生活带来更多便利和乐趣，畅享户外运动的魅力！

祝您户外生活愉快！

01 Parts List

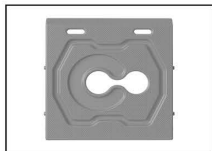

Front and rear
fender board 2pcs



Left and right
fender board 2pcs



Fender bottom
board 1pcs



Universal wheel
component 1pcs



Rear wheel 2pcs



Connector 1pcs

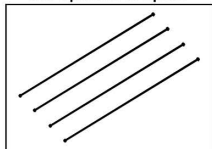

Cargo box
connecting axle
(ϕ 8*426mm) 4pcs

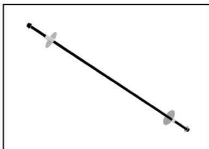

Rear axle
(ϕ 10*587mm) 1pcs



Connection
towbar 1pcs

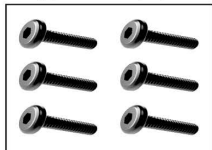

Cargo box screw
(M6*35mm) 6pcs



Connect the drag
tube (M8) to lock
1 set



Connecting the towing
tube (ϕ 8) 1 set of
quick release locking pins

02 Attachment Details



Safety lock hook 1set



Simple installation tool 4pcs

03 Product installation diagram

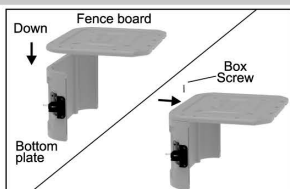

1. Take the left fence board and put it under the fence plate, lock the box screws.

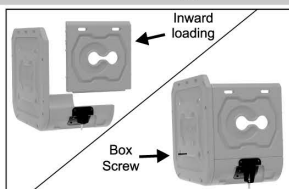

2. Put the front fence board into the bottom plate, right direction and slot position, lock the box screw.

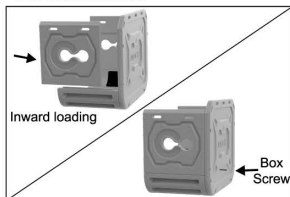

3. Put the rear fence board into the bottom plate, right direction and slot position, lock the box screw.

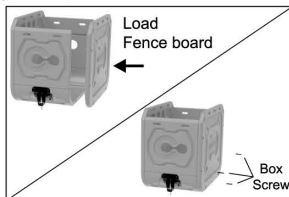

4. Put it into the right fence board and connect the car body. Install the screws in turn and lock them in place.

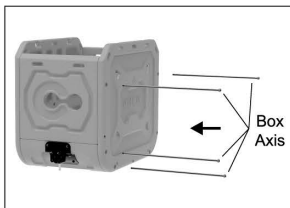

5. Twist one end of the nut and thread the connecting shaft of the box into the vehicle body in sequence.

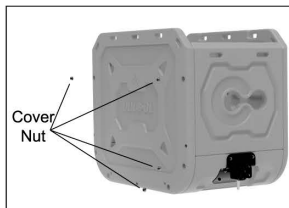

6. Lock the cap nuts in place in sequence.

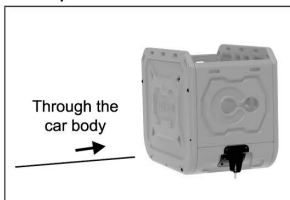

7. Put the rear wheel iron shaft into the car body hole.

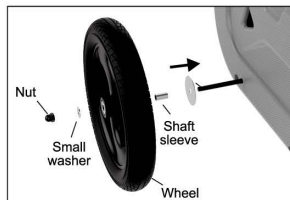

8. Install the rear wheels on both sides into the rear axle in sequence (washer, wheel, washer, nut).

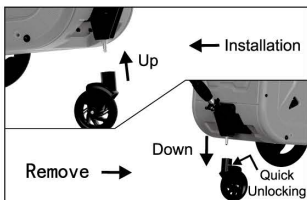

9. Align the universal wheel bracket to the hole position and put it upward. Hearing the sound of "bang", it indicates that it is in place; Press and hold the button of quick release lock to pull down the universal wheel to complete the disassembly.

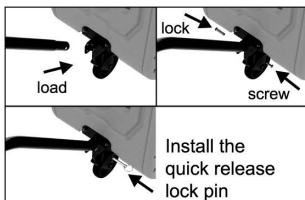

10. Take the connecting rod, install the connecting pipe into the fixed bracket, tighten the M8 locking screw, and then install the quick release locking pin.



11. 快拆锁销拆装可切换使用模式。

04 Trailer connection procedure

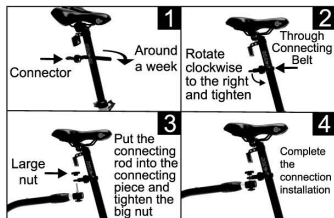

一、 Connection diagram of bicycle seat tube

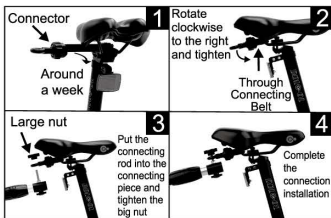

二、 Connection diagram of bicycle seat cushion

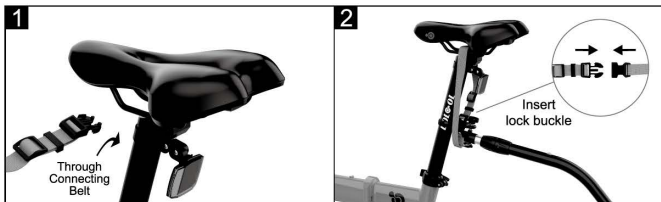

三、 Schematic diagram of installing safety lock webbing

05 Usage mode

bicycle trailer



Pet trailer



Camping Trailer



06 Precautions

WARNING

- Please read the instructions carefully before use, follow the relevant assembly and instructions, and keep them.
- This product must be assembled and used by adults. Please put away the packaging plastic bags in time to avoid suffocation caused by children's play.
- Confirm whether the trailer hook is firmly connected to the bicycle and whether the location of the trailer ring is correct.
- Place the trailer on the flat ground and make sure that the trailer legs are firmly supported on the ground.
- Adjust the length of the trailer rope to make the distance between it and the bicycle and the trailer moderate.
- Before use, please carefully check whether all parts are installed in place, whether the connection is tight, and whether the tires are intact.
- In the process of driving, pay attention to maintain a stable speed, avoid sudden brake or sharp turn, in case the trailer is out of control or overturned.
- When parking, put the trailer legs aside to ensure the stability and safety of the trailer.
- When using, traffic road rules should be followed to ensure safe and stable riding.
- It is forbidden to use the original spare parts not provided by the manufacturer, and it is forbidden to change the structure, add parts and other modifications, so as not to cause failure or insecurity caused by the damage of the car platform.
- The maximum weight of this product is 25KG.

07 Common sense of maintenance

- Please check and maintain this product frequently to avoid normal use.
- Solid grease should be regularly added to all rotating parts such as axle and movable joints to improve the service life of products.
- Regularly check whether all fasteners are in good condition and whether the parts are damaged. If necessary, please replace them to make the products safer and longer.
- Avoid long-term use or storage in humid, cold or high temperature environments. Overload operation is prohibited.
- When cleaning the car body, you need to gently wipe the stains with cleaning tools such as wet towel or brush.
- If the product has problems that cannot be handled, please consult relevant experienced professionals.

*The final interpretation right of this manual belongs to Dongguan City Dai Dai Le technology LTD.

Note: The pictures and configurations of the sample vehicle are for reference only, and the specific details are subject to the actual product