

# BEFORE YOU START

## Things You Need To Know

### Number of people required to assemble

Two people are required to assemble this item



### Time to assemble



40 Min.



⊕ NOT Supplied

### Guidelines

**FAILURE TO FOLLOW THESE WARNINGS  
WHEN IN USE COULD RESULT IN INJURY**

## DO



- We suggest you spend a short time reading through the leaflet before you start
- When you are ready to start, make sure that you have the right tools, plenty of space and a clean, dry area for assembly.
- Unwrap all packing materials and place the components on a clean surface to protect them from damage. We recommend using the product packaging to protect your floor during assembly.
- Carefully check that you have all the parts before beginning assembly.
- Due to the size of this product, we recommend assembly in the room intended for use.
- Make sure the product is fully assembled as illustrated and that all connections are fully tightened before use.
- Wipe occasionally with a soft, damp cloth then buff dry with a soft clean dry cloth.
- The wood will mellow and change color over time. As a result, we recommend that ornaments and items placed on the surface are moved regularly for the first few months to prevent an uneven mellowing.
- Check all bolts and screws every 90 days. As necessary tighten if any are loose.
- Keep small parts and pieces away from children and pets until fully assembled.

## DON'T



- Do not drag or pull your furniture.
- Do not rub or scrub the surface when cleaning.
- Do not use silicone based furniture polish. Silicone in furniture polishes can break down the finish.
- Never allow any kind of liquid to remain on your furniture. Absorption can cause wood to warp or finishes to de-laminate.
- Do not place hot items (e.g. hot drinks) directly on to the wood surface. Please make sure you use a placement or coaster.
- Do not stand on the item or use as a step ladder.
- **WARNING:DO NOT LET CHILDREN PLAY IN OR AROUND THE UNIT DUE TO THE POSSIBLE RISK OF INJURY.**

# Side Table

## Product Dimension

**Actual product size**  
**24.02" Height x 19.89" Width x 18.7" Depth**

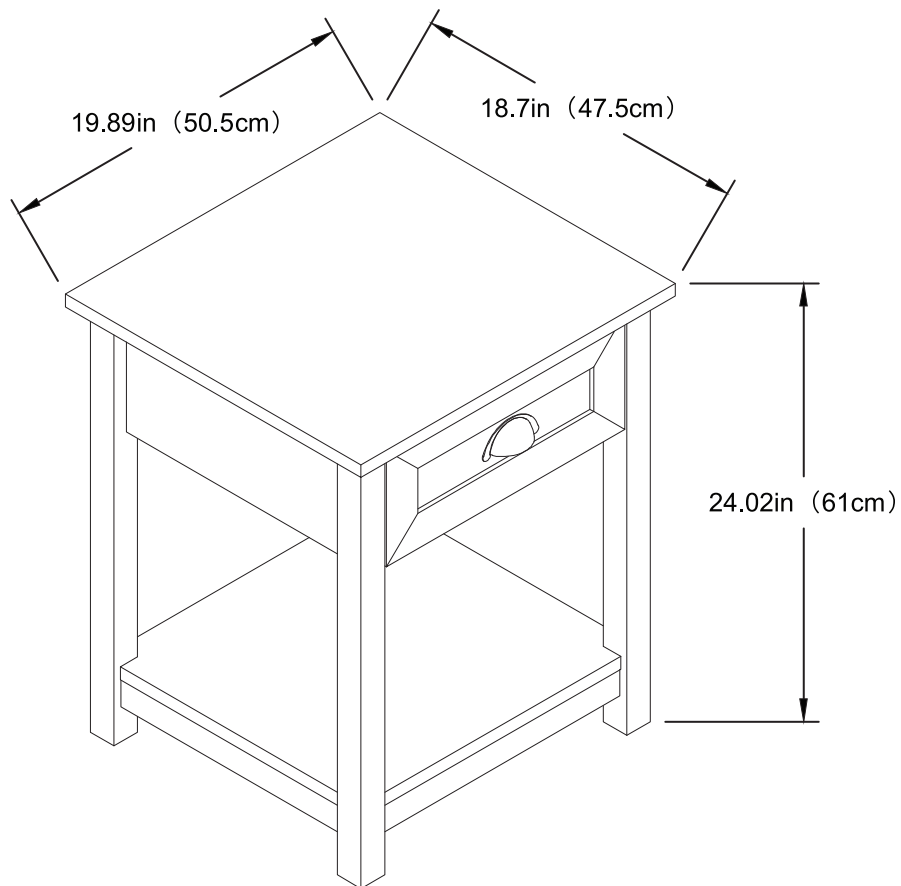

**IMPORTANT-RETAIN FOR FUTURE REFERENCE**

# Side Table

## Getting To Know Your Product

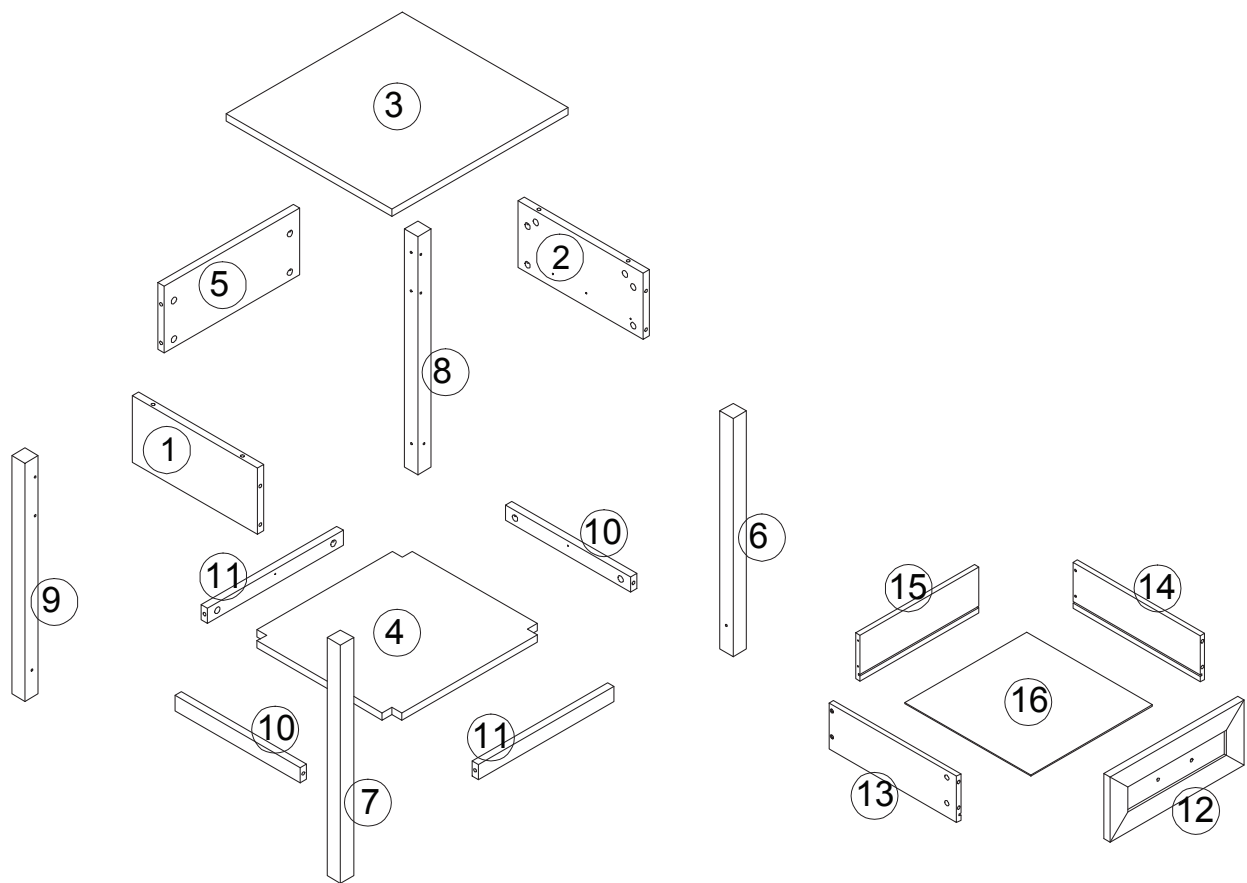

# Side Table

## Things You Need To Know

Components supplied. Please use this guide if you require replacement parts.  
Fixtures and fittings supplied (not to scale)

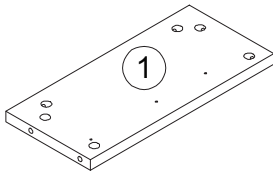

**(1) Left Side Panel x1**

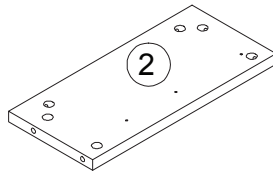

**(2) Right Side Panel x1**

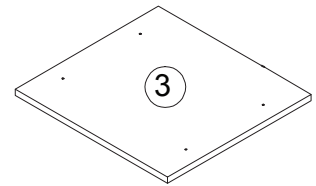

**(3) Top Panel x1**

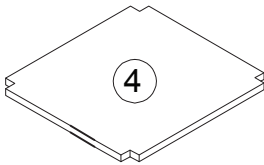

**(4) Shelf x1**

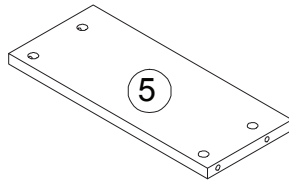

**(5) Back Panel x1**

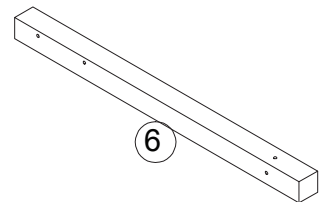

**(6) Front Right Leg x1**

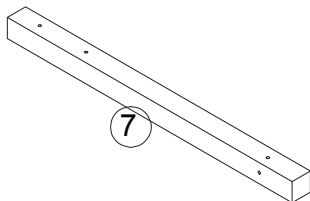

**(7) Front Left Leg x1**

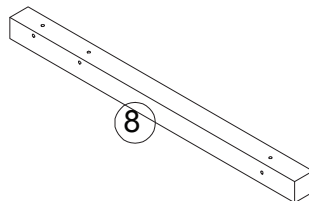

**(8) Rear Right Leg x1**

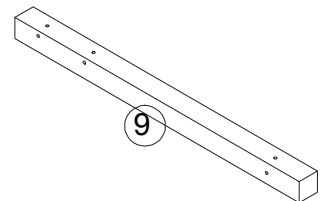

**(9) Rear Left Leg x1**

# Side Table

## Things You Need To Know

**Components supplied. Please use this guide if you require replacement parts.  
Fixtures and fittings supplied (not to scale)**

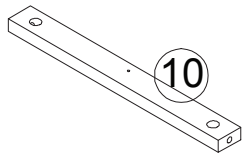

**(10) Side Rail x1**

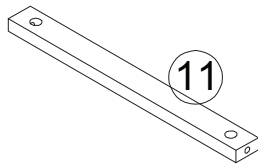

**(11) Front & Rear  
Rail x2**

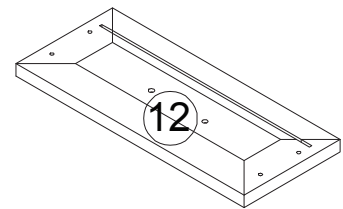

**(12) Drawer Front Panel x1**

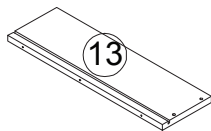

**(13) Drawer Left  
Side Panel x1**

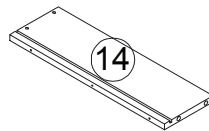

**(14) Drawer Right  
Side Panel x1**

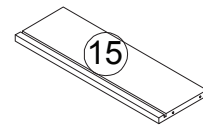

**(15) Drawer Back  
Panel x1**

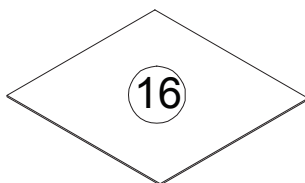

**(16) Drawer Bottom  
Panel x1**

# Side Table

## Things You Need To Know

Components supplied. Please use this guide if you require replacement parts.  
Fixtures and fittings supplied (not to scale)



**(A) Small Cam Lock for Drawer x4  
M12x10mm**

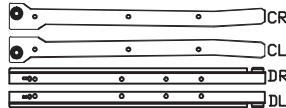

**(B) Runner (Left + Right)  
CR/CL on side panel  
DR/DL on drawer x1set  
350mm**



**(C) Large Cam Lock x24  
M15x11mm  
(Spare x2)**



**(D) Cam Bolt x28  
M6x28mm  
(Spare x2)**



**(E) L Bracket x4  
20x20x15mm**



**(F) Flat Washer x2  
M16x1mm**



**(G) Cup Handle x1**



**(H) Runner Screw x20  
M3.5x12mm  
(Spare x2)**

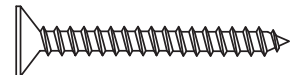

**(I) Long Screw x4  
M4.5x42mm**



**(J) Handle Bolt x2  
M4x6mm**



**(K) Foot Pad x4  
36mm**

# Side Table

## Assembly Instructions

1

STEP

1. Ensure all parts have been removed from the carton and place on a protected surface or carpet.
2. Check all parts and hardware are the same as the "Parts List."
3. Insert 28 x Cam Bolts (D) into Parts (3), (7), (6), (8), (9) & (12) and tighten with a screwdriver (not supplied).
4. Attach L Bracket (E) on to 2 x Side Rail (10) and 2 x Rail (11) and tighten with a screwdriver (not supplied).

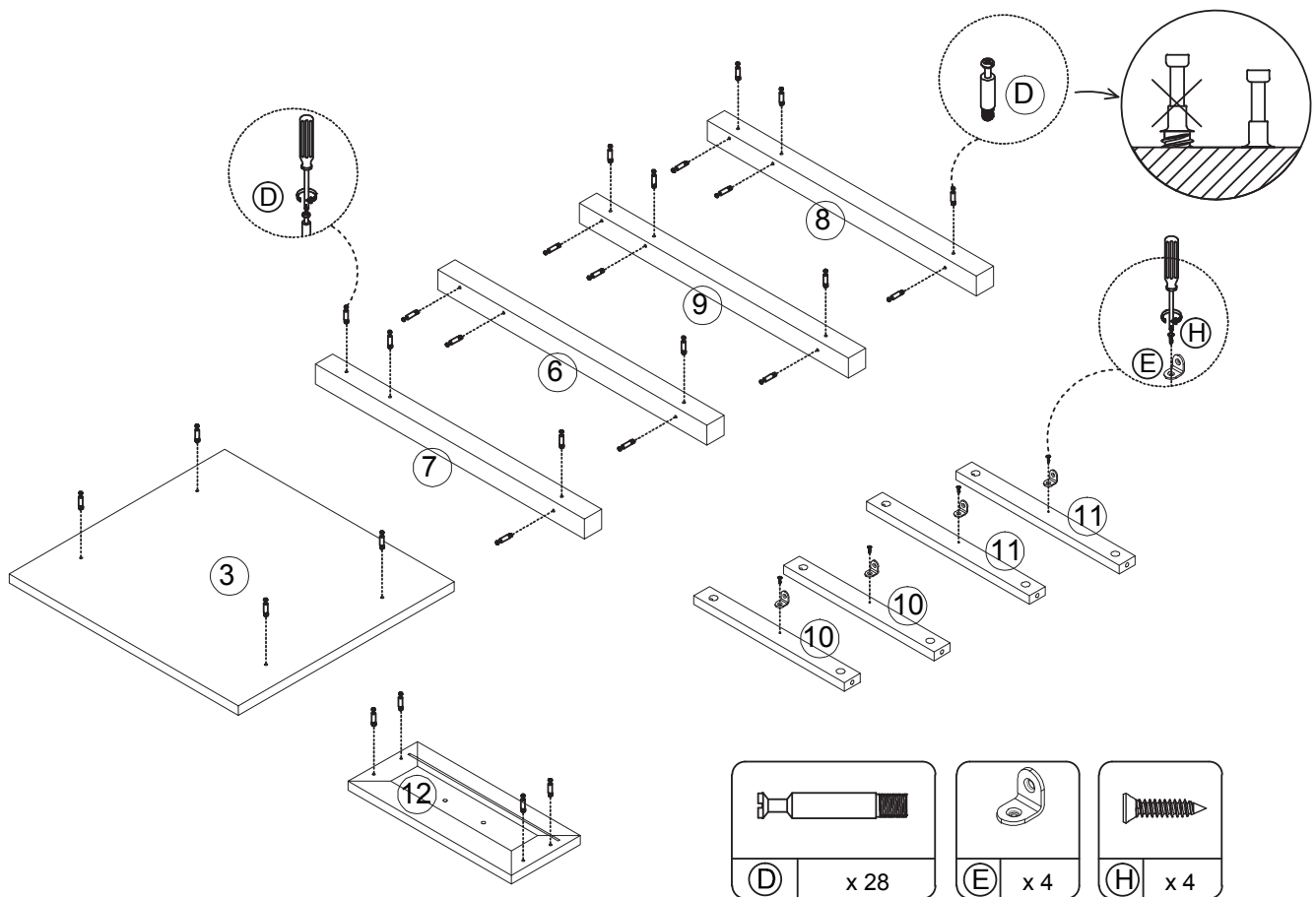

## Assembly Instructions

## STEP

Note: Ensure below assembly Steps & Parts are following below image.

1. Attach Left Front Leg (7) & Left Rear Leg (9) to Left Side Panel (1) & Side Rail (10) as below image.

Note: L Bracket (E) on Side Rail (10) must be in upper position as below image.

2. Insert 6 x Large Camlocks (C) into Panels (1) & (10) and tighten with a screwdriver (not supplied).

3. Attach Right Front Leg (6) & Right Rear Leg (8) to Left Side Panel (2) & Side Rail (10) as below image.

Note: L Bracket (E) on Side Rail (10) must be in upper position as below image.

4. Insert 6 x Large Camlocks (C) into Panels (2) & (10) and tighten with a screwdriver (not supplied).

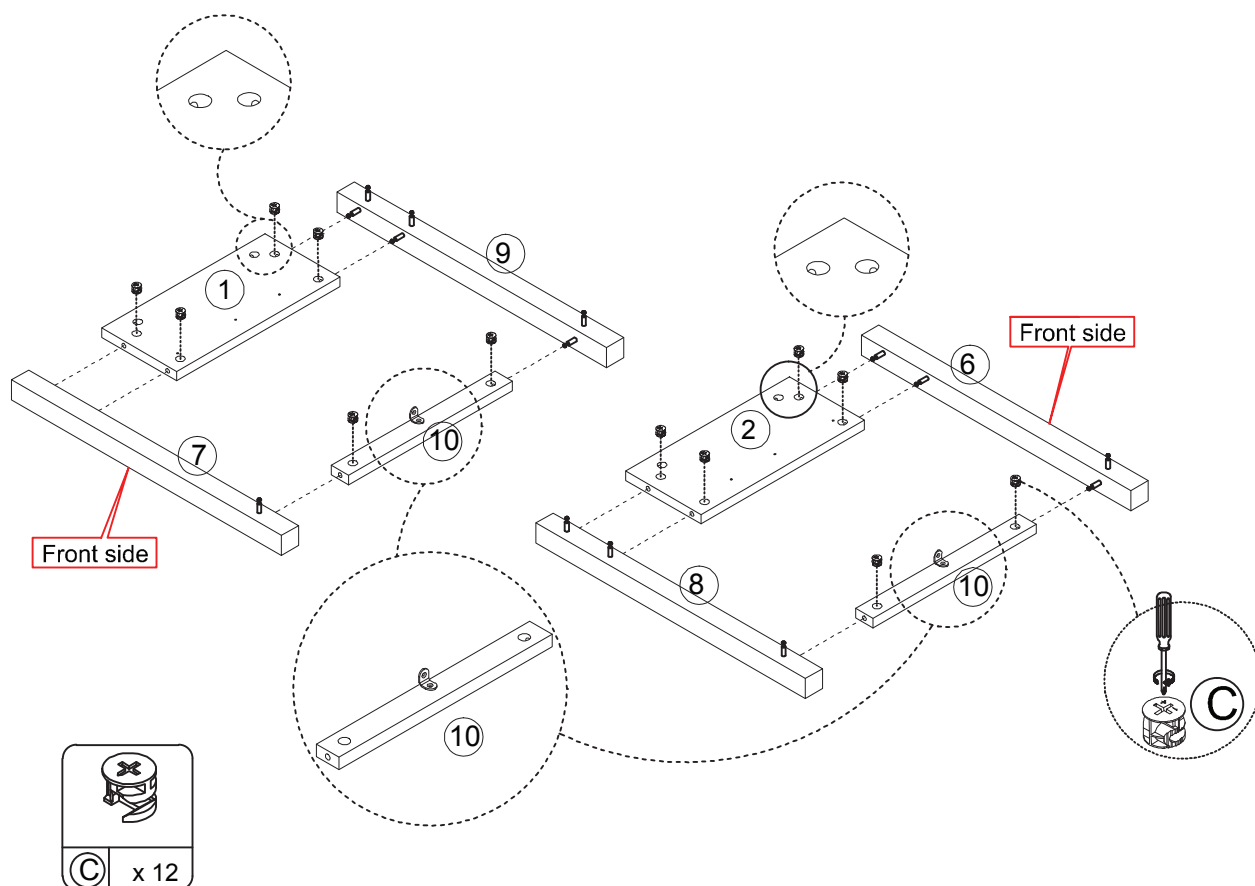



# Side Table

## Assembly Instructions

# 3

STEP

Note: Ensure below assembly Steps & Parts are following below image.

1. Attach Runner (B)/CL to Left Side Panel (1) with 3 x Small Screws (H) and tighten with a screwdriver (not supplied).

Note:

A. Please follow the CL mark on Runner (B)/CL to attach to Left Panel (1) as below image.

B. Align Runner (B) with the join line on the board. Fix Screw (H) to the second assembly hole of Runner (B)/CL on side panel.

2. Attach Runner (B)/CR to Right Side Panel (2) with 3 x Small Screws (H) and tighten with a screwdriver (not supplied).

Note:

A. Please follow the CR mark on Runner (B)/CR as below image.

B. Align Runner (B) with the join line on the board. Fix Screw (H) to the second assembly hole of Runner (B)/CR on side panel.

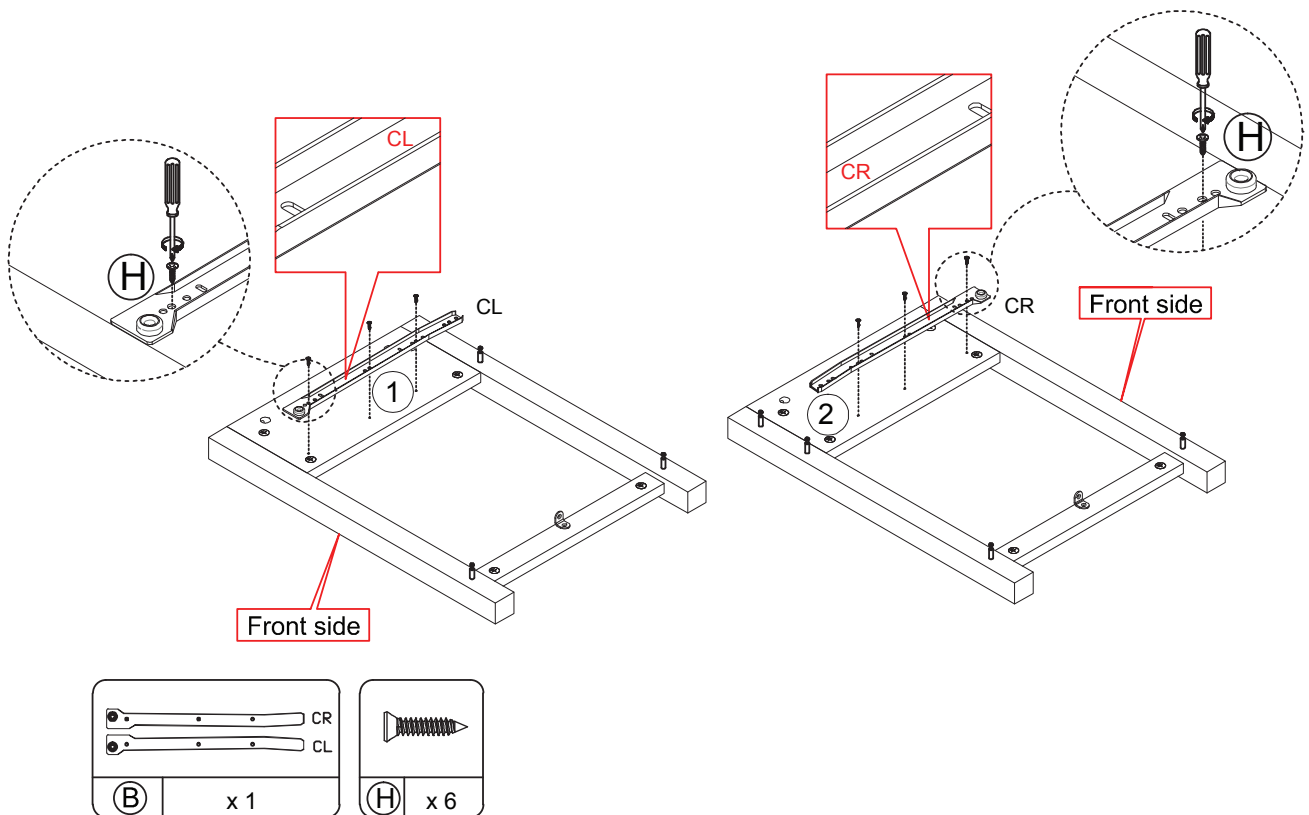

# Side Table

## Assembly Instructions

### 4 STEP

1. Attach Back Panels (5) & 2 x Rails (11) to assembled Left Panel as below image. Note: L Bracket (E) on Rail (11) must be in upper position as below image.

2. Insert 4 x Large Cam Locks (C) into Panel (5) & 2 x Rails (11). Tighten with a screwdriver (not supplied).

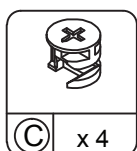
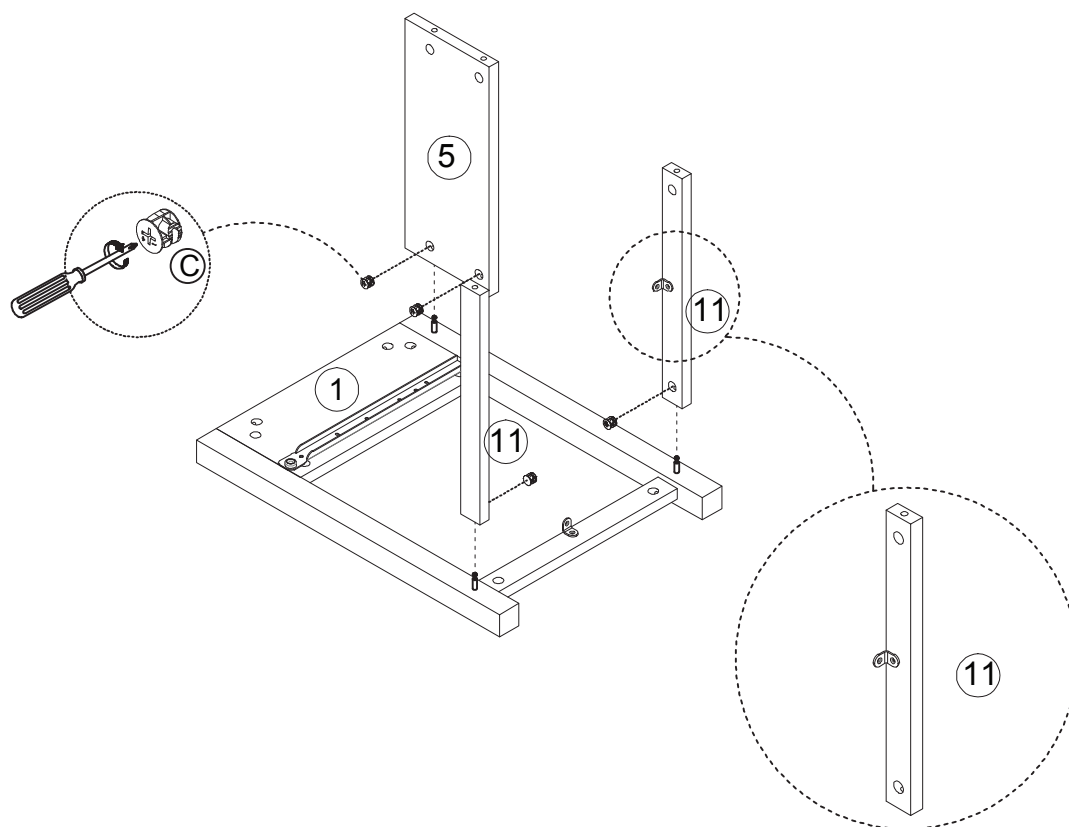

# Side Table

## Assembly Instructions

### 5 STEP

1. Attach assembled Right Side Panel (2) to assembled unit as below image.
2. Insert 4 x Large Cam Locks (C) into Back Panels (5) & 2 x Rail (11). Tighten with a screwdriver.

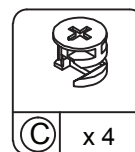
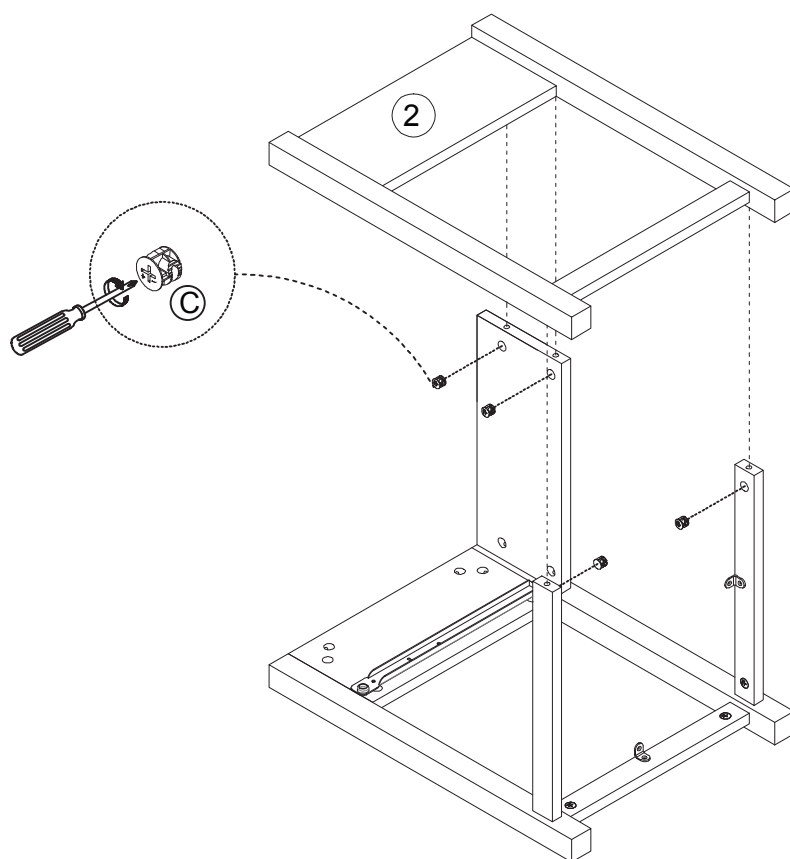

# Side Table

## Assembly Instructions

### 6 STEP

1. Attach Shelf (4) with assembly hole side down to assembled unit and fasten with 4 x Screw (H) as below image. Tighten with a screwdriver.

2. Attach 4 x Foot Pad (K) on the end of each foot.

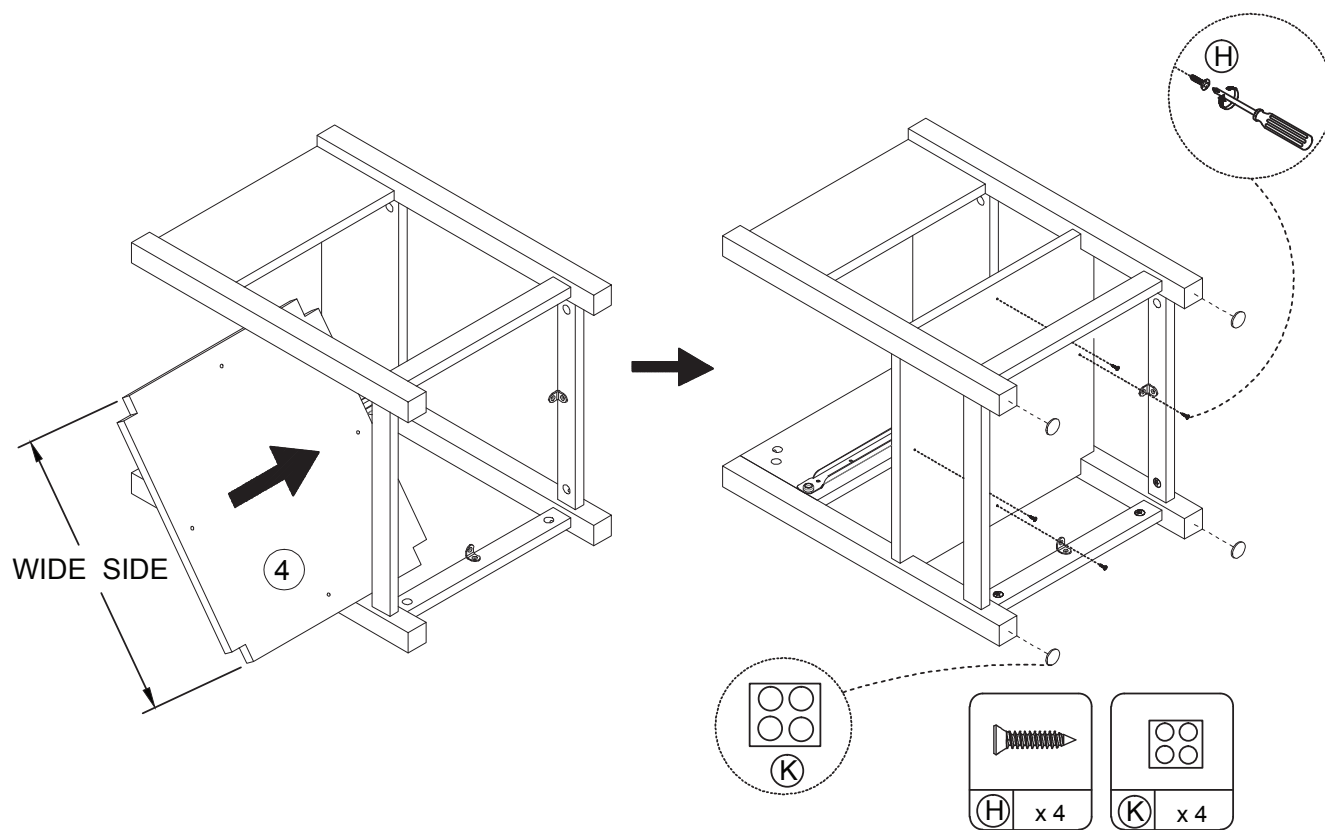

# Side Table

## Assembly Instructions

### 7 STEP

1. Attach Top Panel (3) to assembled unit as below image.
2. Insert 4 x Large Cam Locks (C) into Side Panel (1) & (2) and tighten with a screwdriver.

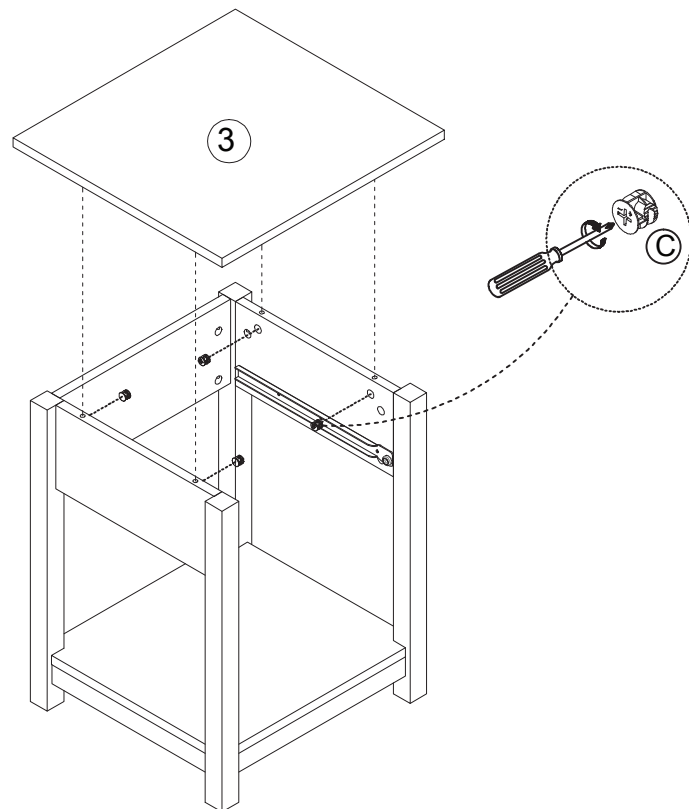
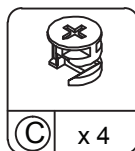

# Side Table

## Assembly Instructions

### 8 STEP

1. Attach Drawer Left Side Panel (13) & Right Side Panel (14) to Drawer Back Panel (15) with 4 x screws (I) and tighten with a screwdriver.

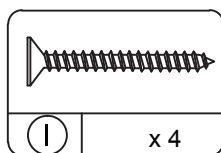
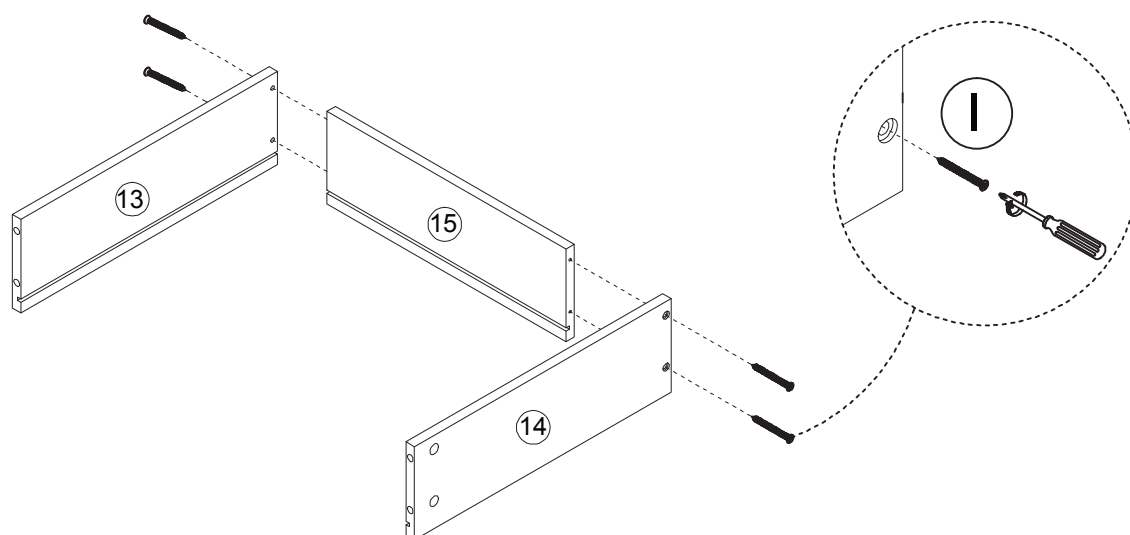

# Side Table

## Assembly Instructions

### 9 STEP

1. Slide Drawer Bottom Panel (16) into the groove of assembled drawer unit.



# Side Table

## Assembly Instructions

10

STEP

1. Attach Front Drawer Panel (12) to assembled drawer unit.
2. Insert 4 x Small Cam Locks (A) into Panels (13) & (14) and tighten with a screwdriver.

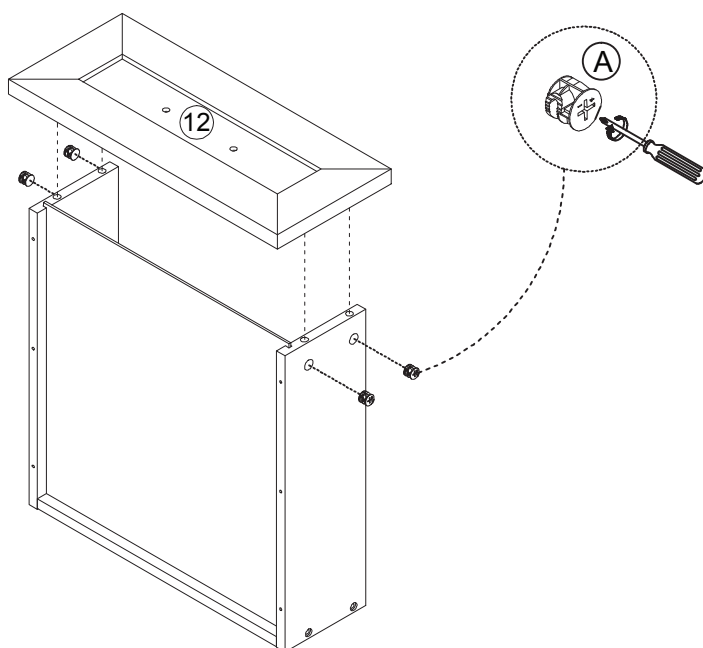



# Side Table

## Assembly Instructions

11

STEP

1. Attach Cup Handle (G) to assembled unit with 2 x Screws (K) & Flat Washer (F) as below image. Tighten with a screwdriver.

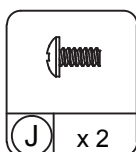
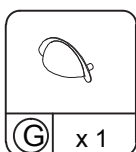
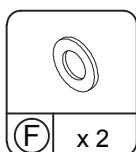
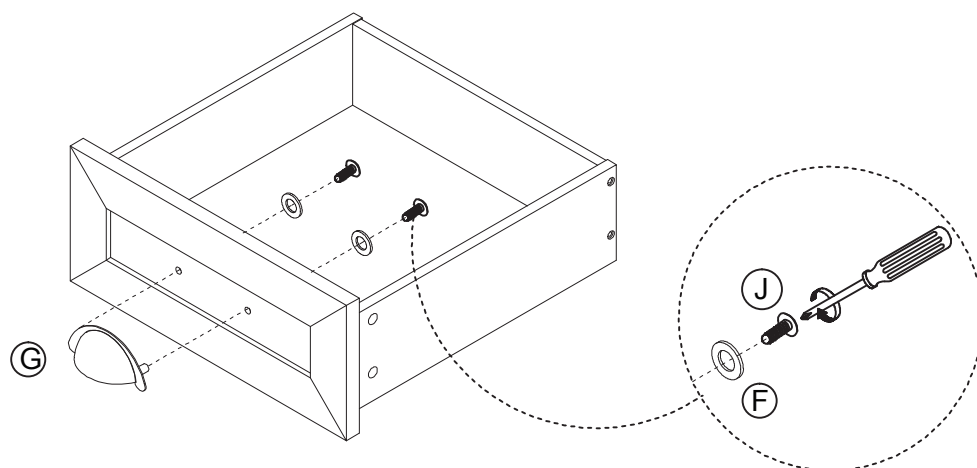

# Side Table

## Assembly Instructions

12

STEP

1. Attach Runner (B)/DR & DL to assembled drawer unit with 6 x Screws (H) as below image. Tighten with a screwdriver.

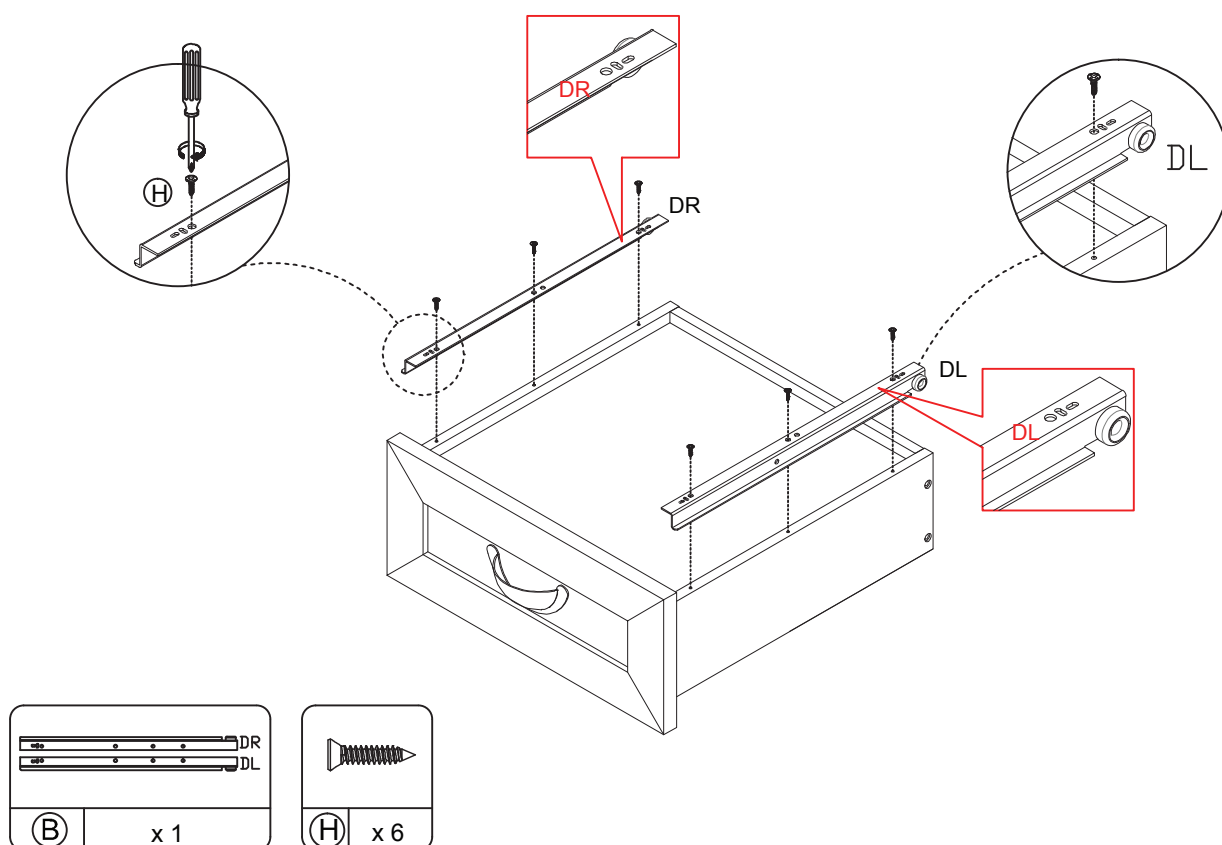

# Side Table

## Assembly Instructions

13

STEP

1. Insert the assembled drawer into the unit as below image.

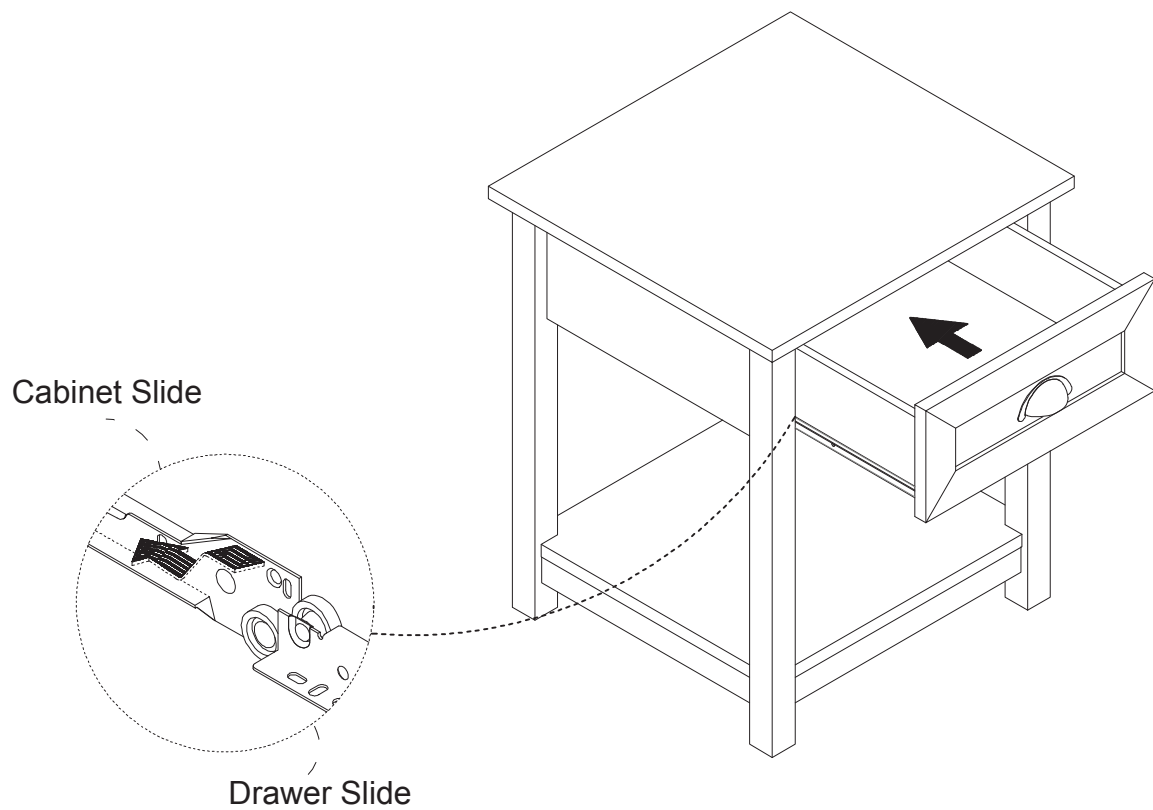

# Side Table

## Assembly Instructions

14  
STEP

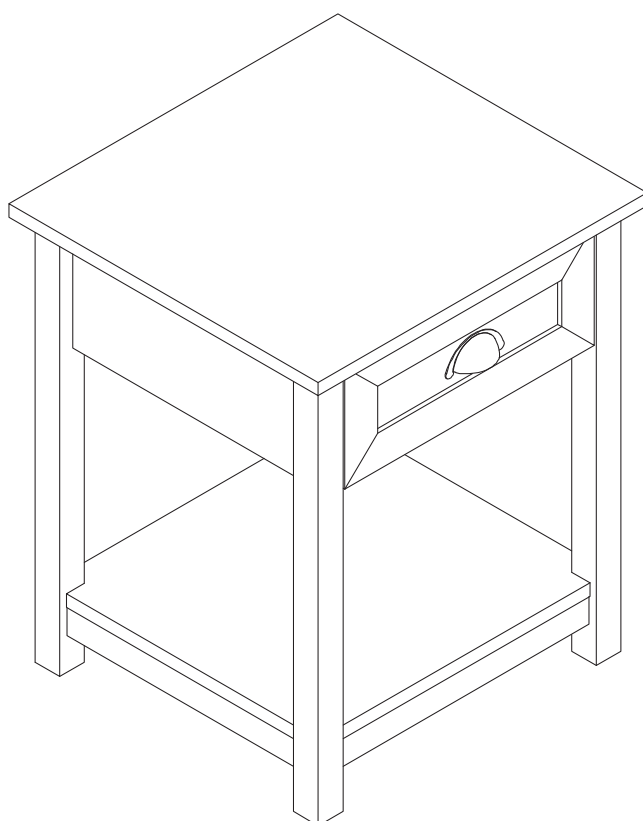

Periodically (every 90 days) make sure that all screws are still fully tightened.  
**ATTENTION:** Be certain that all screws are fully tightened before using this product.

# Limited Warranty

The product you have purchased is warranted against defects in material and workmanship while owned by the "Original Purchaser." The term "Original Purchaser" is defined as the party or entity that purchases these products from an authorized dealer or retailer as shown by the original sales receipt. The warranty does not apply to "as is" or previously owned products.

The manufacturer warrants its products to be free from defects in materials and workmanship (normal wear and tear, fading and stretching excepted), for one year from the date of purchase, except as provided below under the limited warranty.

This warranty gives you specific rights, and you may also have other rights, which vary from state to state (or country to country). All warranties are limited to the Original Purchaser for normal use by a maximum of two users. Total weight capacity per chair is 250 pounds for a single user.

The exceptions or exclusions to this warranty are:

- Upholstery material and foam cushion material is warranted against defects in material and workmanship for a period of one year, beginning on the date of purchase as shown on the original sales receipt.
- Any warranty claim that is submitted after the limited warranty period, or without proper proof of purchase will not include the cost of parts, labor, or delivery on the warranted parts within a reasonable amount of time. We reserve the right to require damaged parts to be returned to us upon request. Natural markings such as scars, brands, grain variations, wrinkles, color variations, etc. will be considered normal characteristics and not construed as defects.