

Assembly Instruction

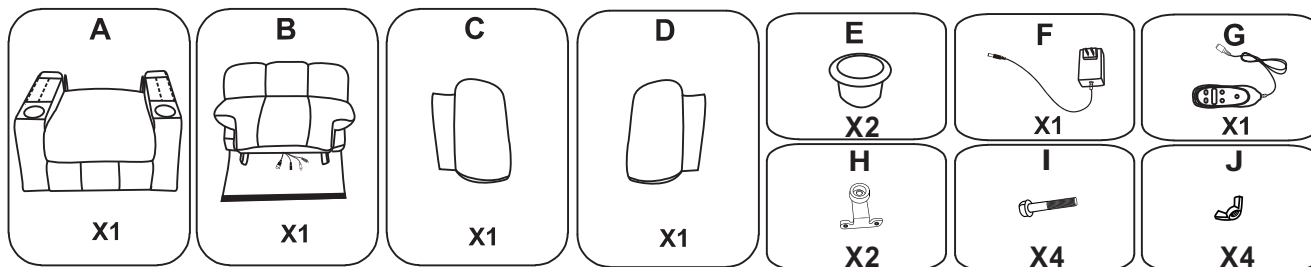

1

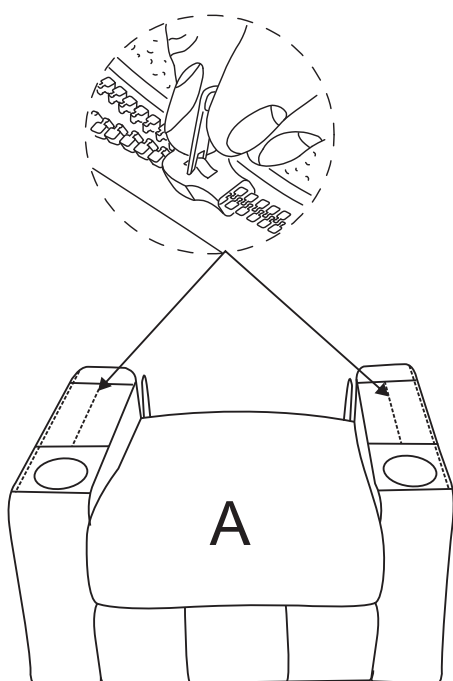

2

Press the rod in the inner pocket down with your hand until you hear a 'click' sound, which indicates that the armrest assembly is complete.

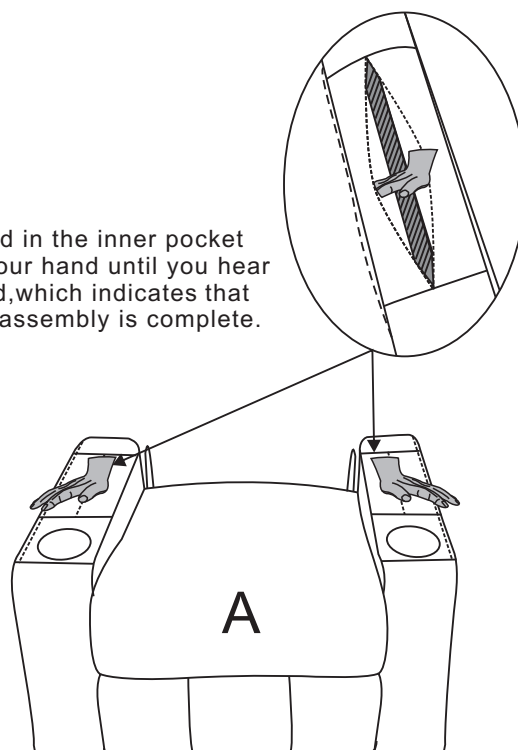

3

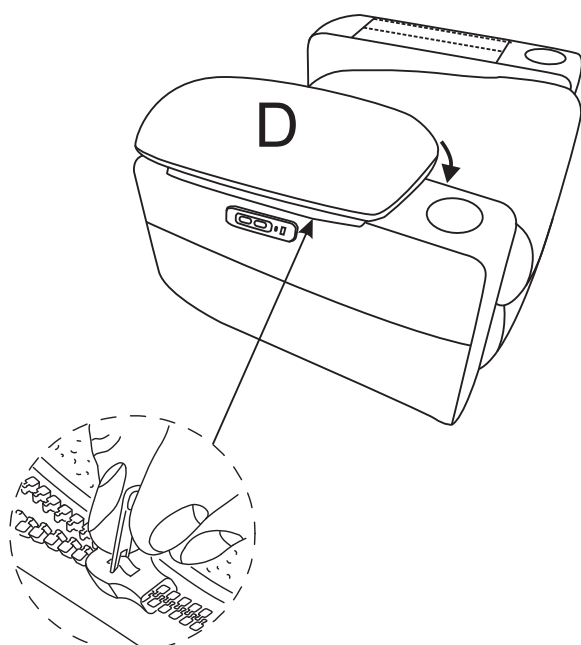

4

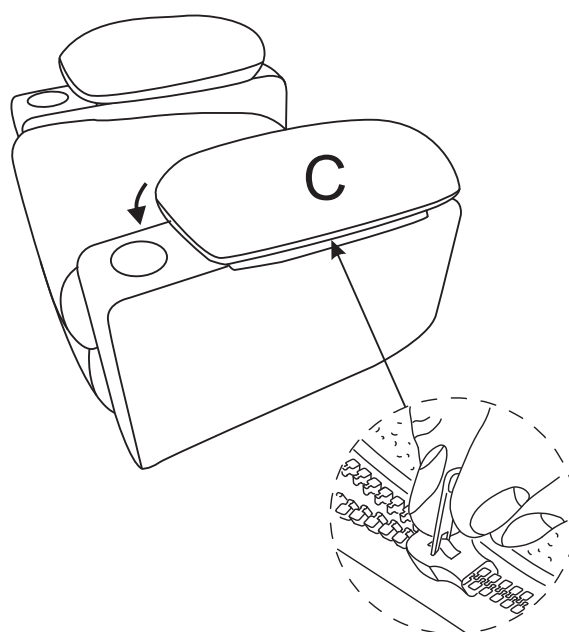

5

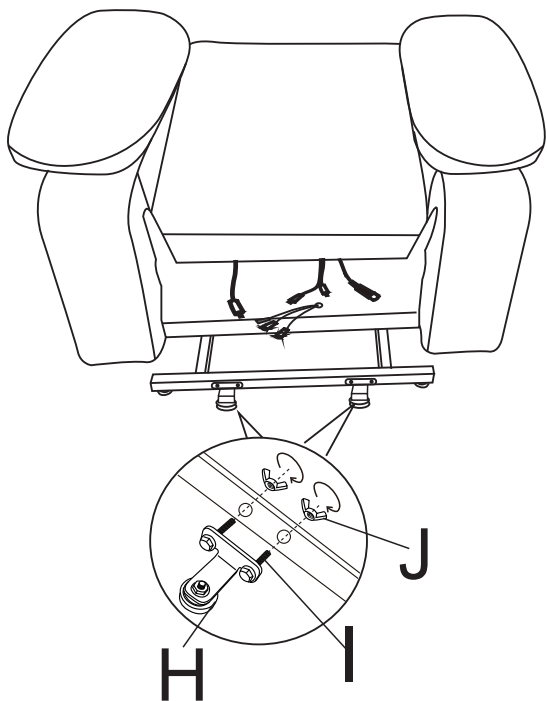

6

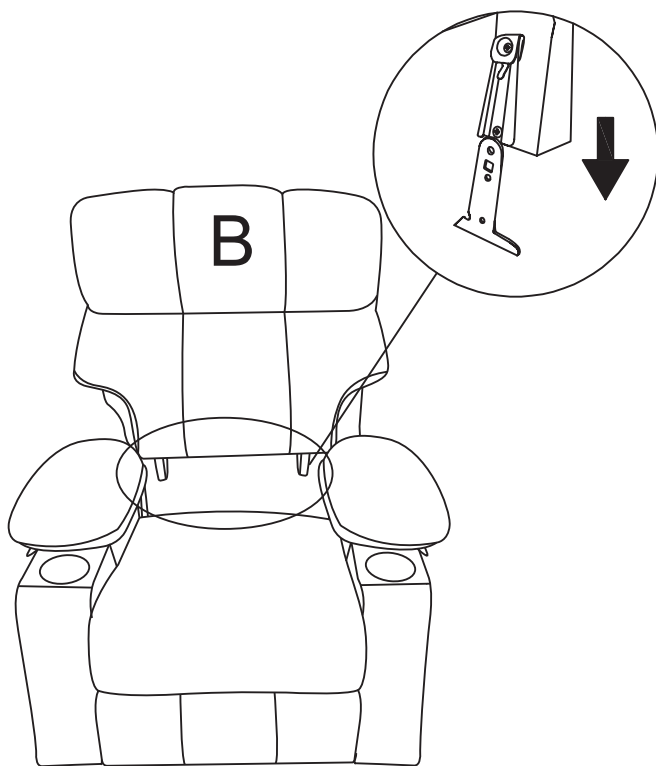

7

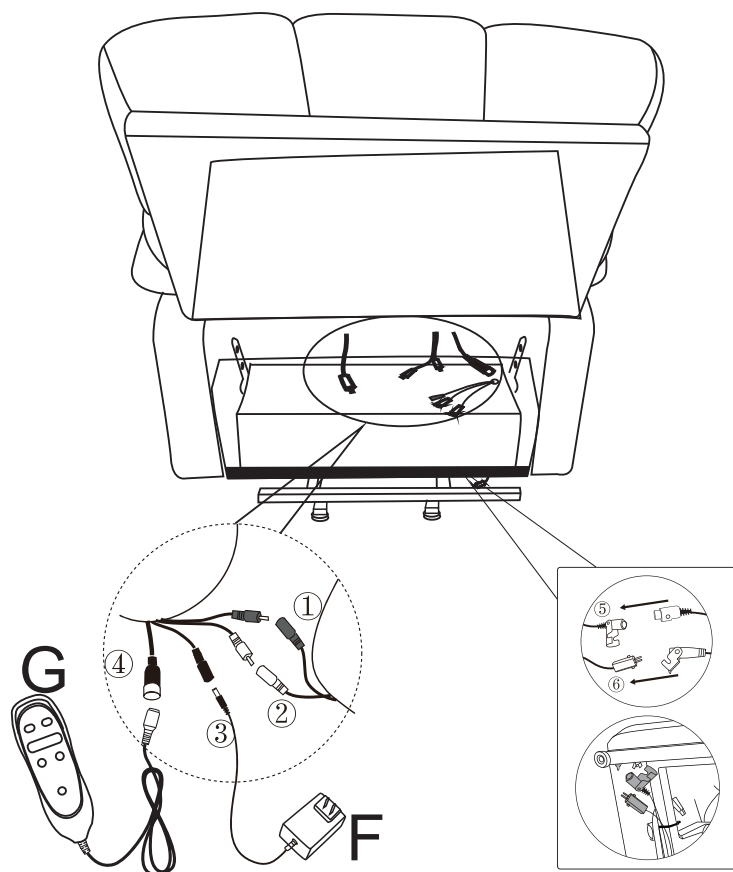

8

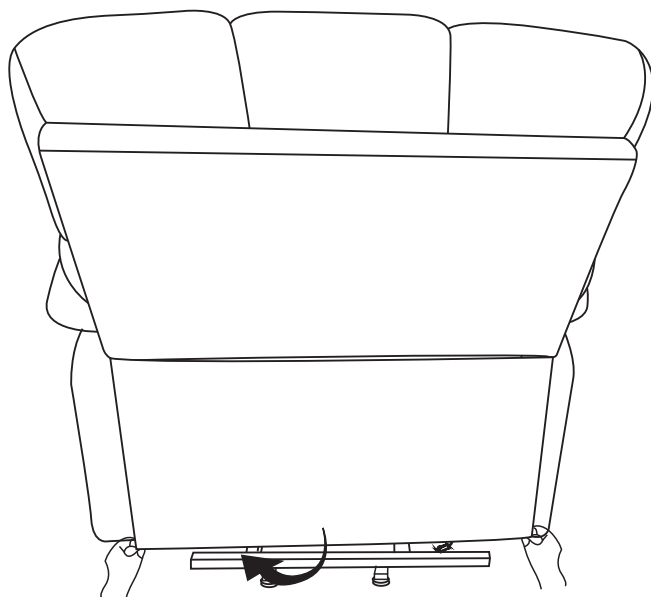

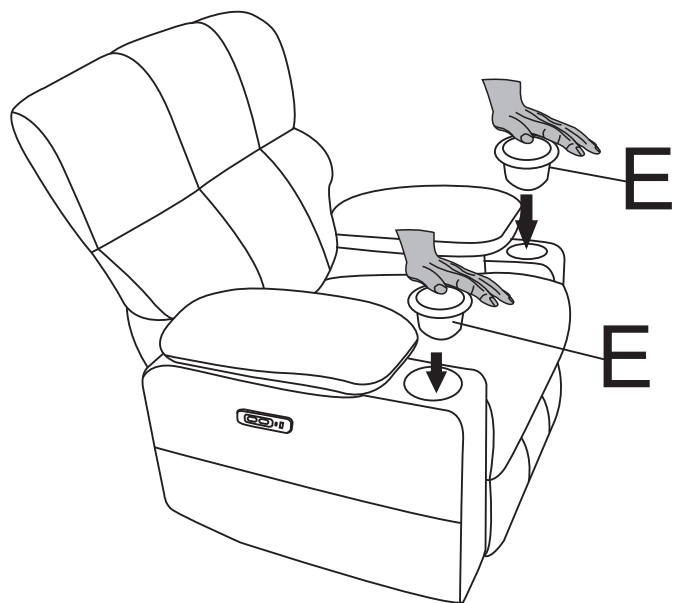

Remote Operation Instruction

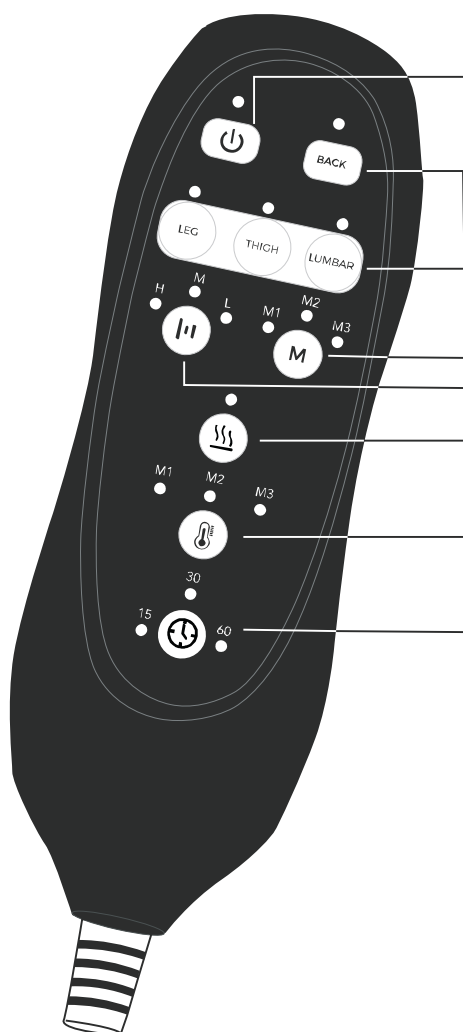

Turn on/off the massage function.

You can select different massage parts to enjoy.

You can select different massage mode to enjoy.

Control the massage intensity from low to high.

Turn on/off the heating function.

Select the heating temperature from M1 to M3.

Set a timer for massage from 15mins to 60mins.