

Ax2  
U-Frame

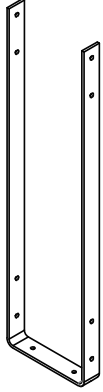

Bx1  
Bottom Basket

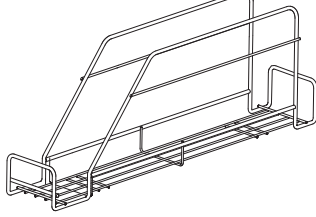

Cx2  
Left Glide

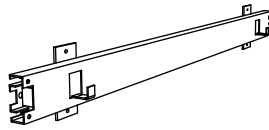

Dx1  
Top Basket

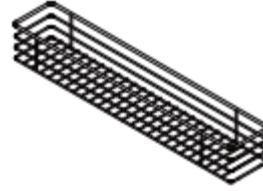

Ex16  
Screw



Fx2  
Right Glide

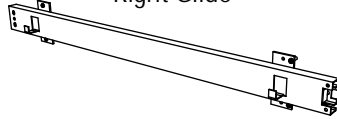

Gx1  
Divider

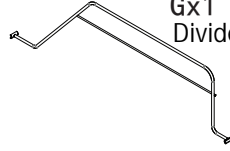

Hx4  
Wood Screw



Ix1  
Allen Wrench

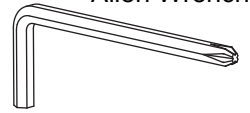

1

Assemble the U-Frames (A) and the Glides (C&F) with the Screws (E)

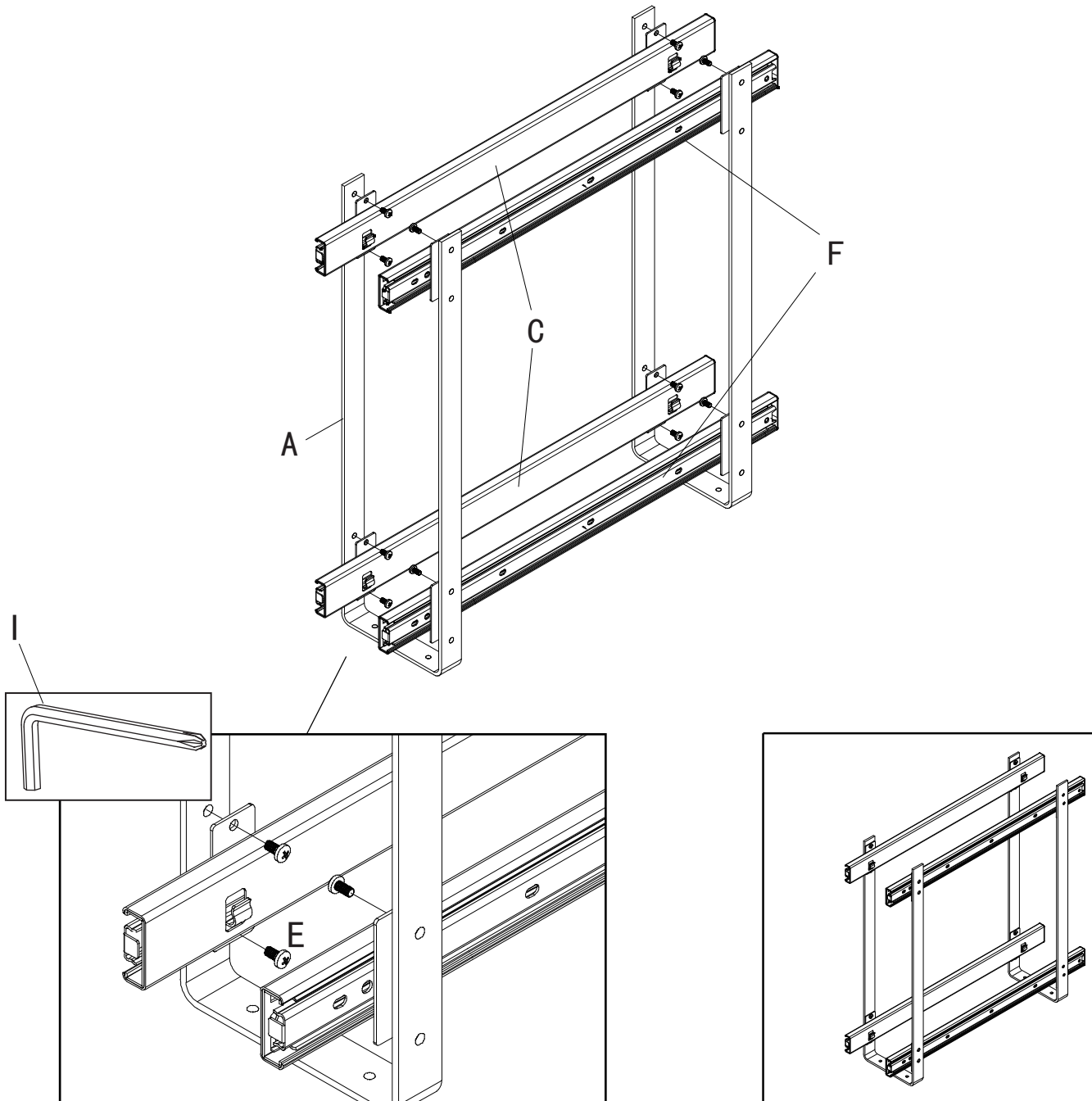

2

Place the organizer in your cabinet and center it in the cabinet opening, making sure slides are parallel to the sides of the cabinet. Mark the location of the holes in the u-frames foot on the cabinet floor. Remove the organizer.

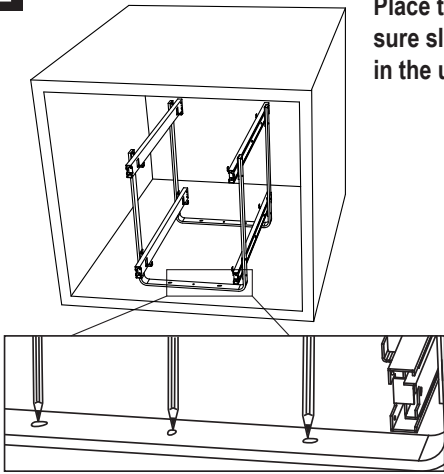

Attach the glides from back to front to the cabinet floor with screws (H).

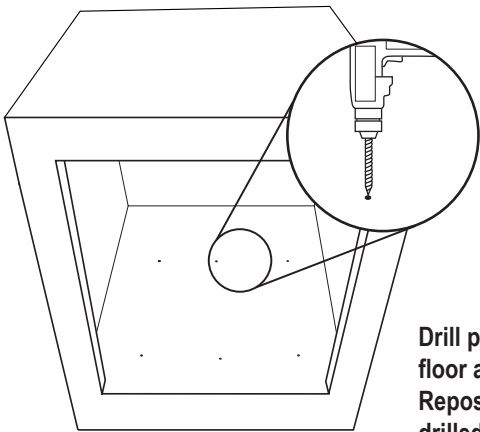
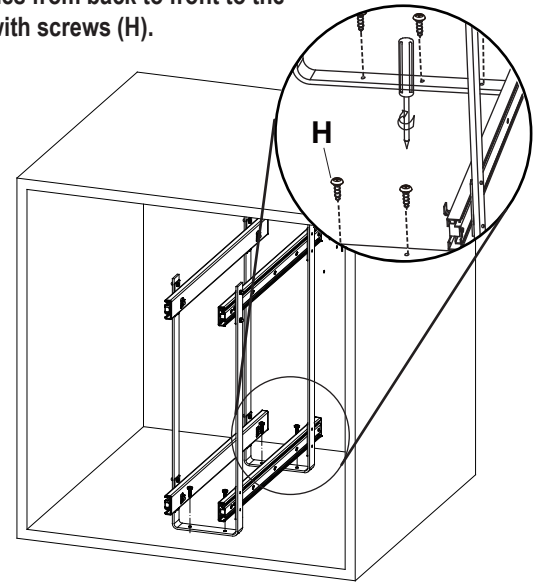

Drill pilot holes in the cabinet floor at the marked locations. Reposition the organizer over the drilled holes.

3

Hook divider (G) into place

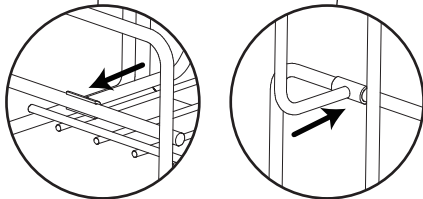
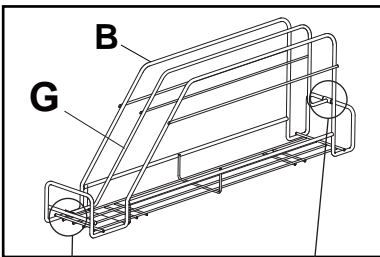

Place basket (B&D) into the hooks as seen below

