

Nightstand Installation Manual

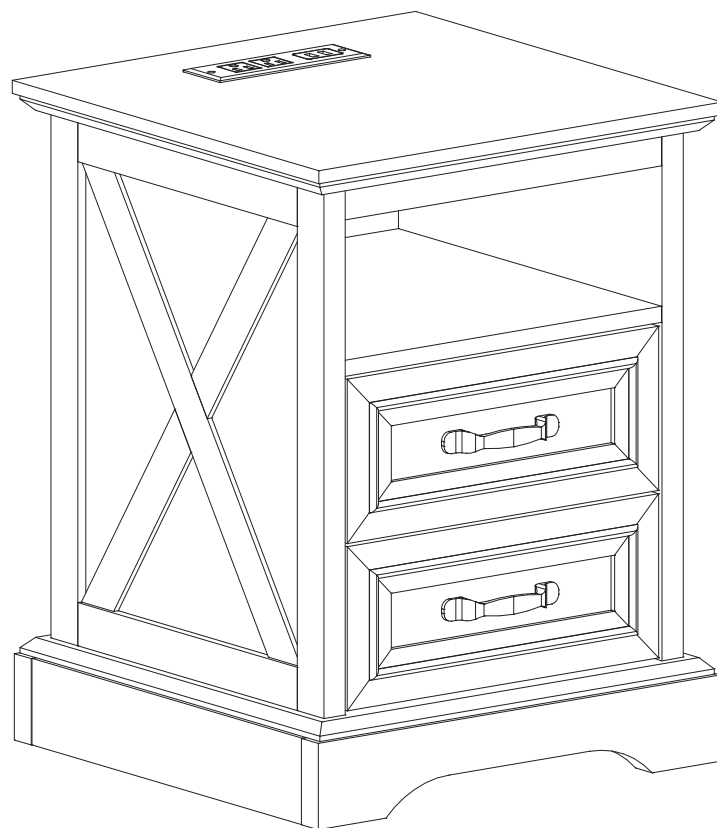

Assembly Guide

The assembly guide includes a Part List, Installation Steps, and Warning Tips.

Please note that your item may arrive in multiple packages to facilitate transportation, and it's important to check all packages once you receive them. If any questions or concern regarding the product, please don't hesitate to reach out to our customer service team by calling 678-926-3988 or emailing us at nbepeach@hotmail.com.

CAM LOCK/BOLT FASTENING INTRODUCTION (You will use it during assembly)

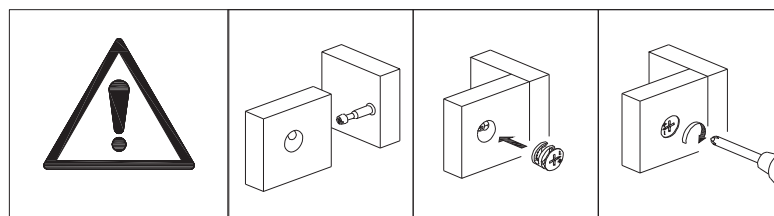
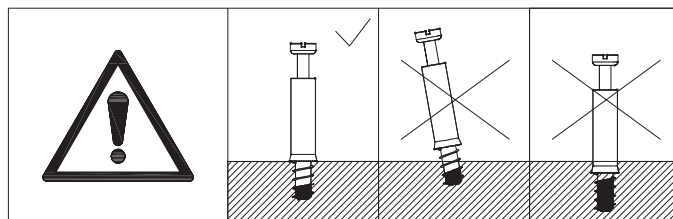

Parts list

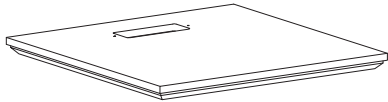

1 1pcs

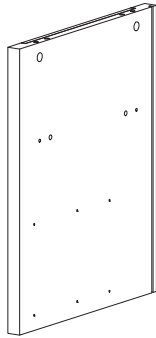

2 1pcs

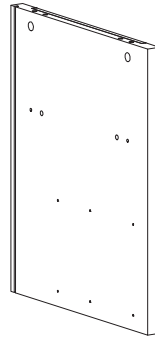

3 1pcs

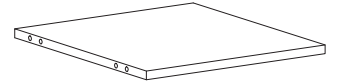

4 1pcs



5 1pcs

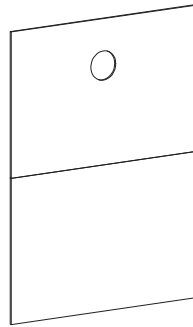

6 1pcs

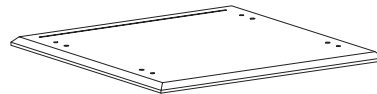

7 1pcs



8 1pcs

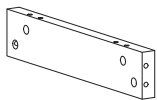

9 2pcs

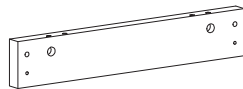

10 1pcs

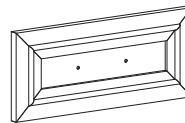

11 2pcs

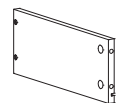

12 2pcs

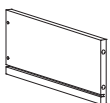

13 2pcs



14 2pcs



15 2pcs

Parts list

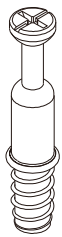

$\phi 6 \times 33.5 \text{ mm}$

A 28pcs



$\phi 15 \times 9.5 \text{ mm}$

B 28pcs



$\phi 8 \times 30 \text{ mm}$

C 26pcs

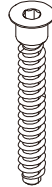

$\phi 6 \times 48 \text{ mm}$

D 4pcs

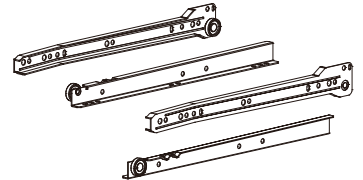

300mm

E 2pcs



$\phi 3.5 \times 12 \text{ mm}$

F 26pcs

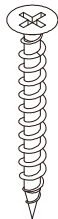

$\phi 4 \times 30 \text{ mm}$

G 10pcs



H 2pcs



M4*10mm

I 4pcs

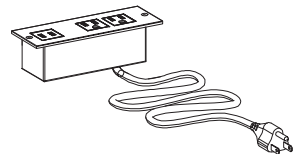

J 1pcs



K 12pcs



4mm

L 1 pcs

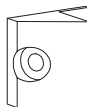

M 6pcs

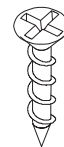

$\phi 3 \times 16 \text{ mm}$

N 6 pcs

Installation Steps

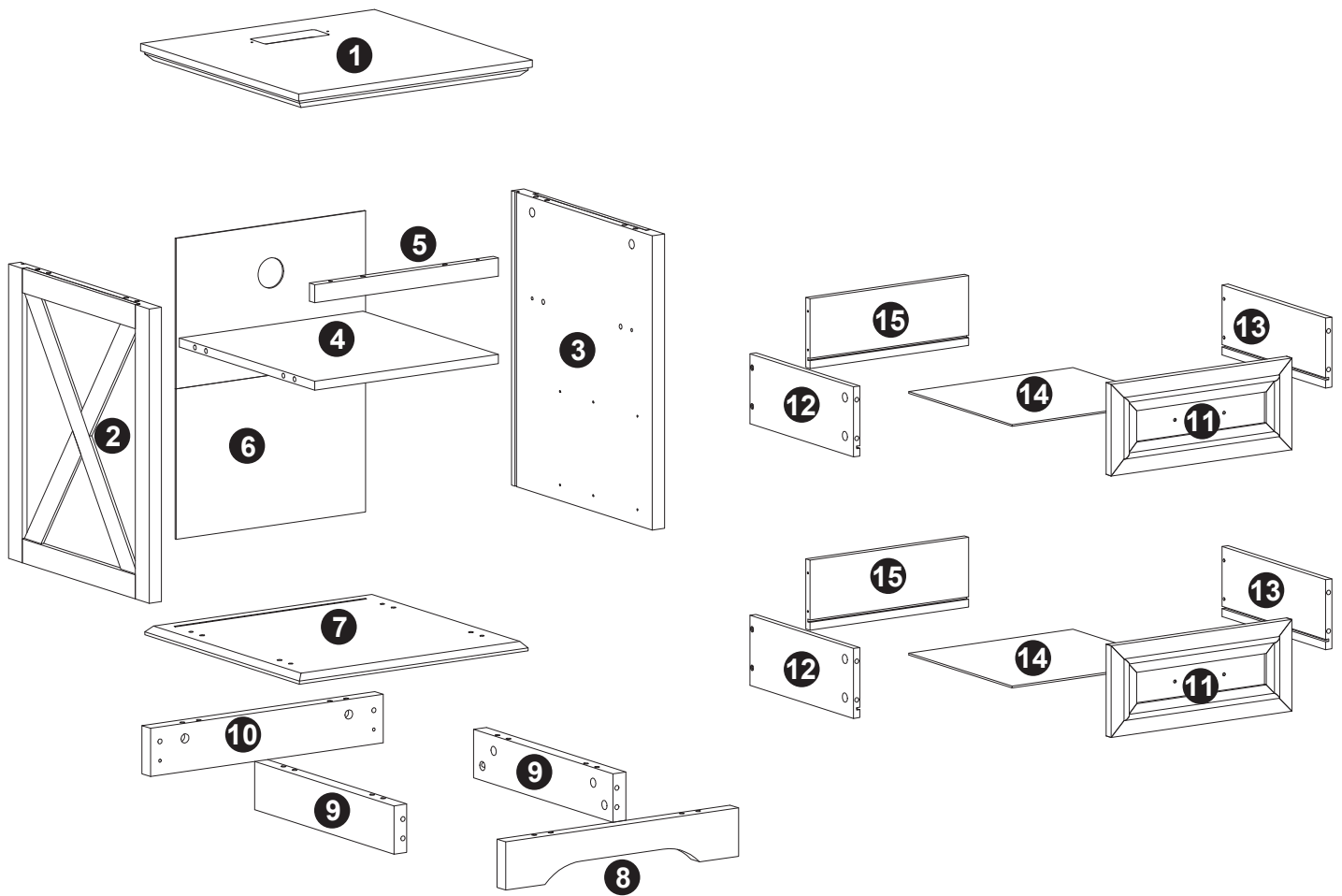

Checking

Before starting the installation process, please check that all parts are present and undamaged.

Ensure that the parts and quantities in the package correspond with the Part List. If there are any mistakes or missing parts, kindly contact us through the purchase platform for assistance.

Assembly

STEP1

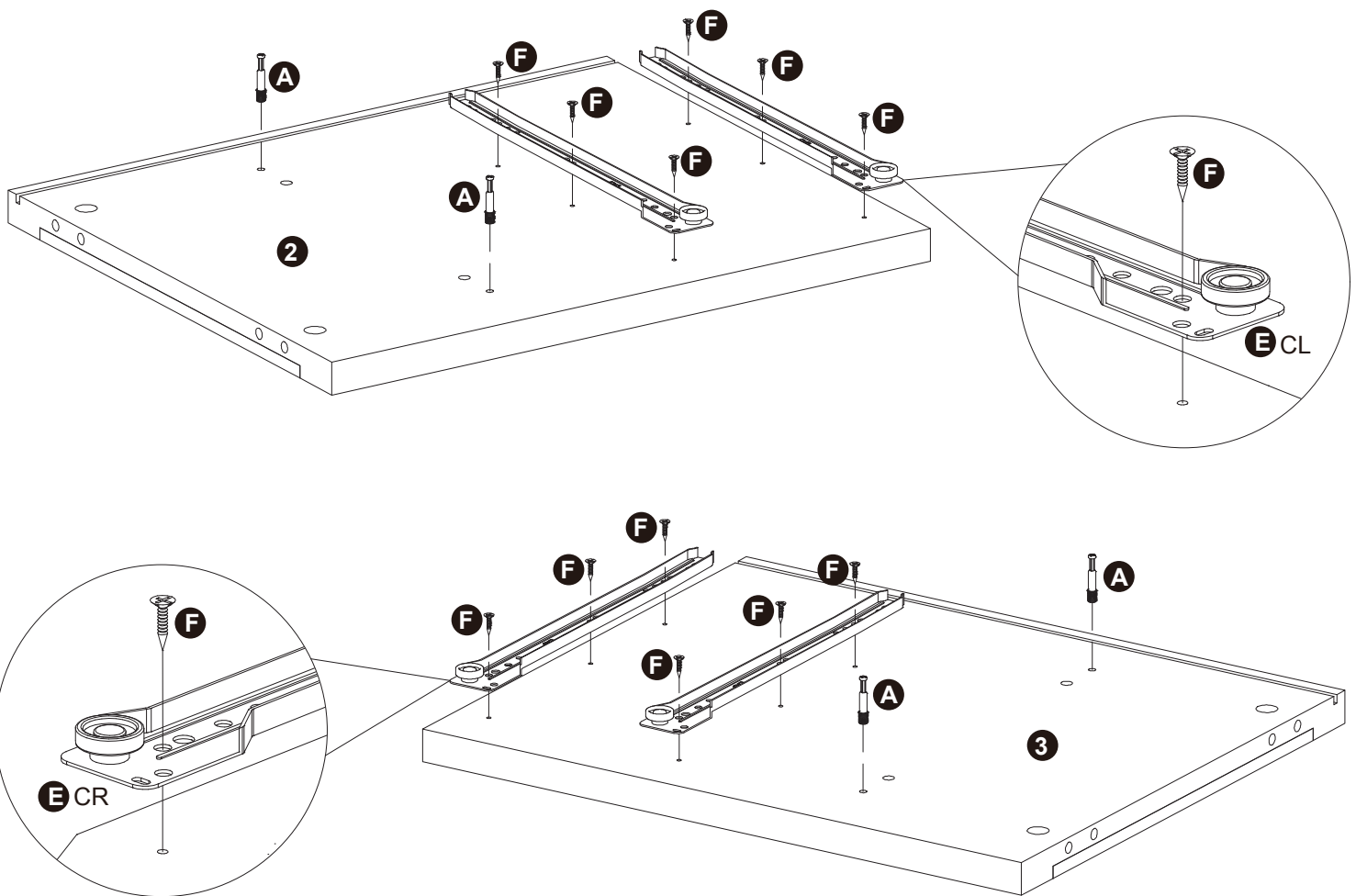
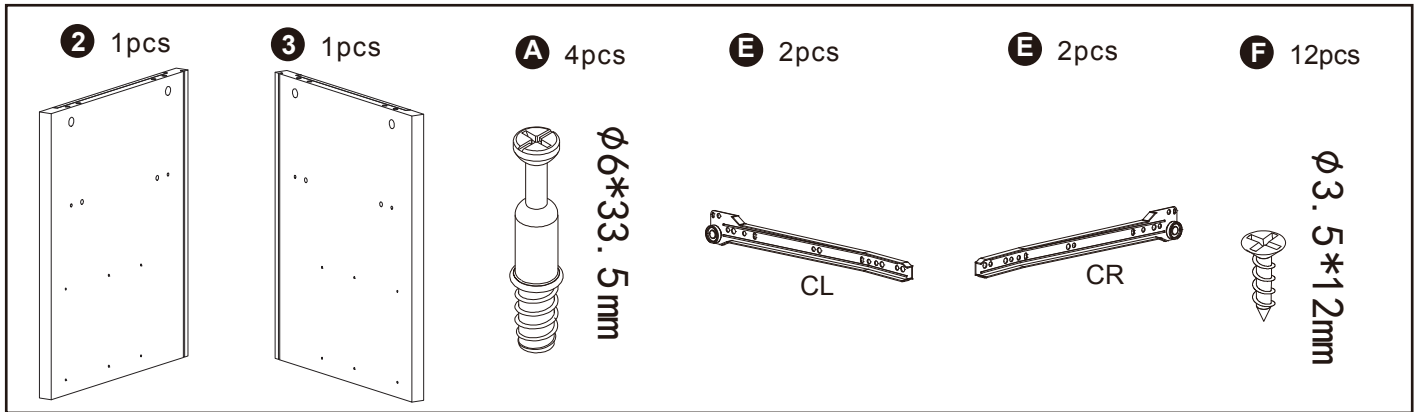

When installing the rail screws, you can distinguish the orientation by referencing the diagram. The direction of parts 2 and 3 can be identified by the slots on the back. Ensure the screws are aligned with the indicated positions.

Assembly

STEP2

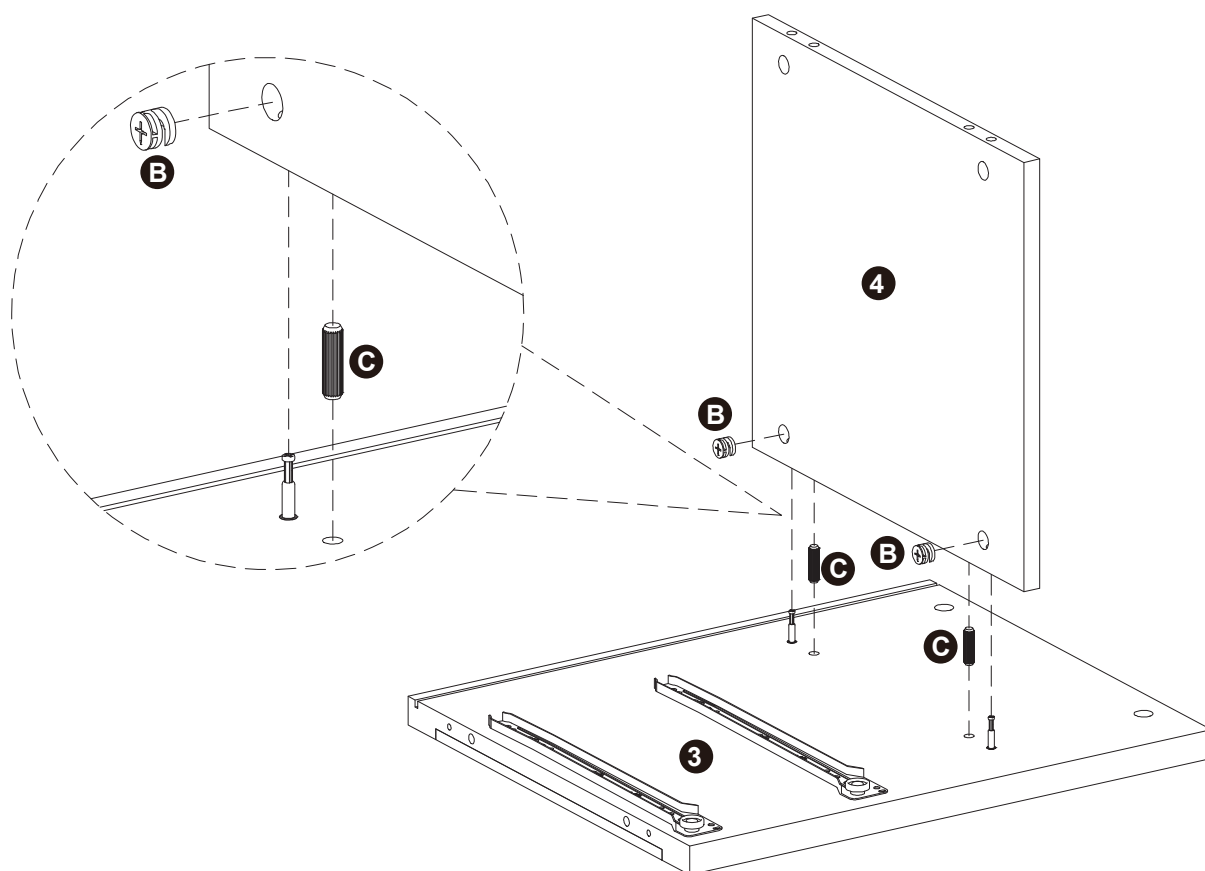
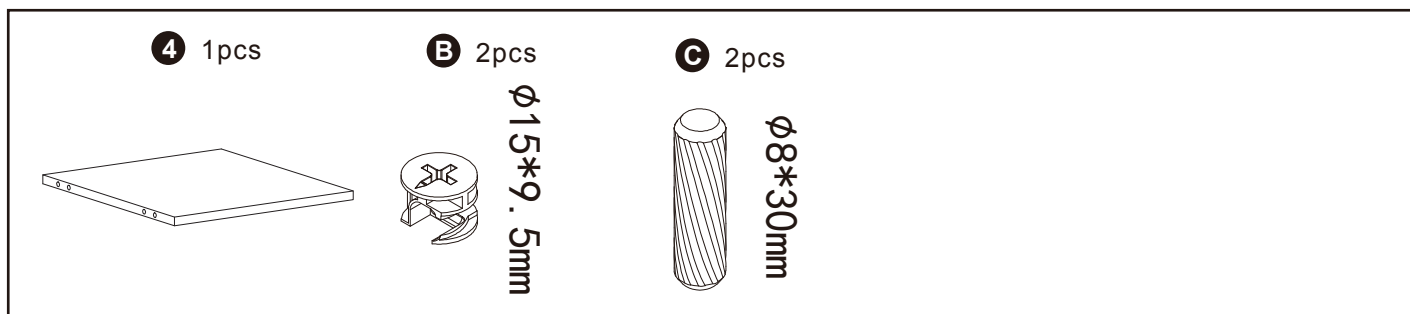

Assembly

STEP3

B 2pcs



Ø15*9.5mm

C 2pcs



Ø8*30mm

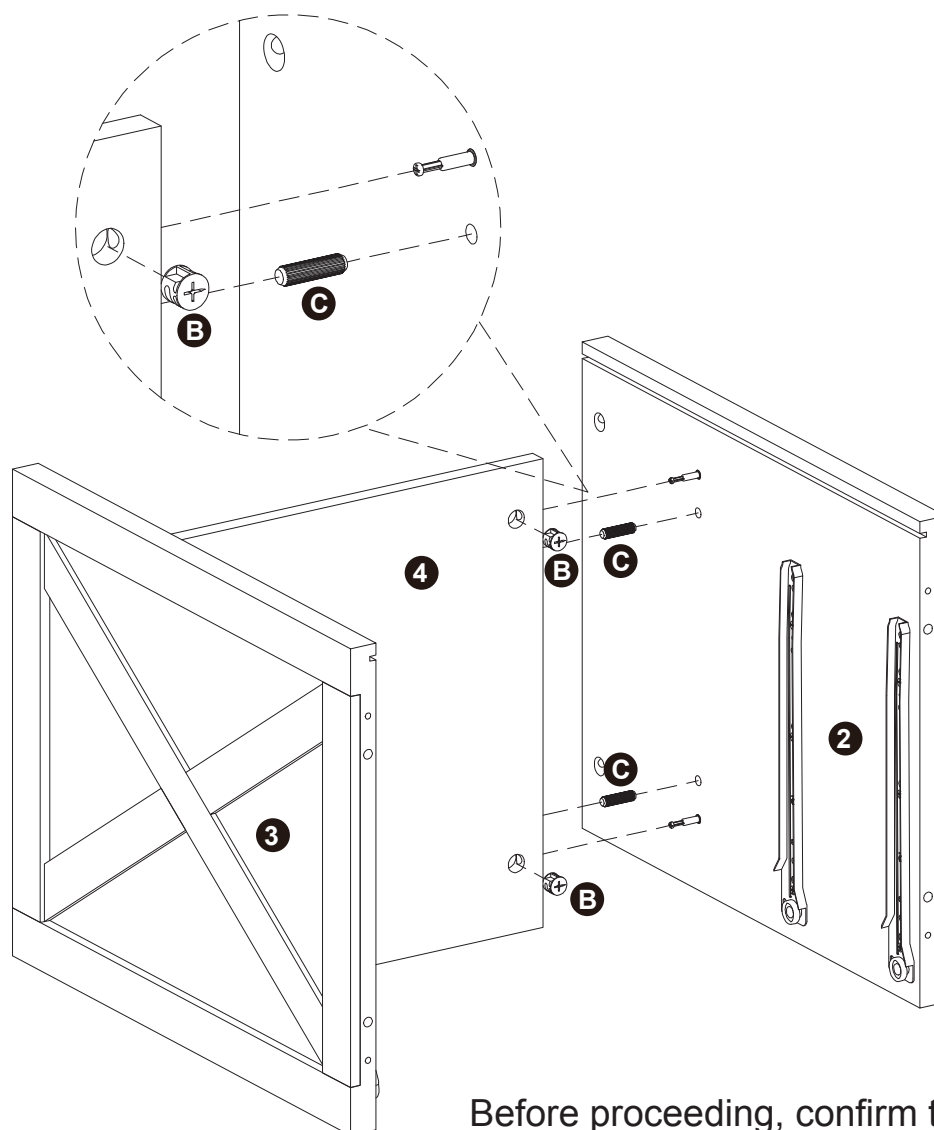

Before proceeding, confirm that the rails are facing the same direction.

Assembly

STEP4

C 4pcs



ø8*30mm

D 4pcs

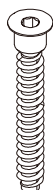

ø6*48mm

L 1pcs



4mm

7 1pcs

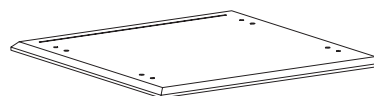

Make sure that the groove on part 7 aligns with the grooves on parts 2 and 3 during installation.

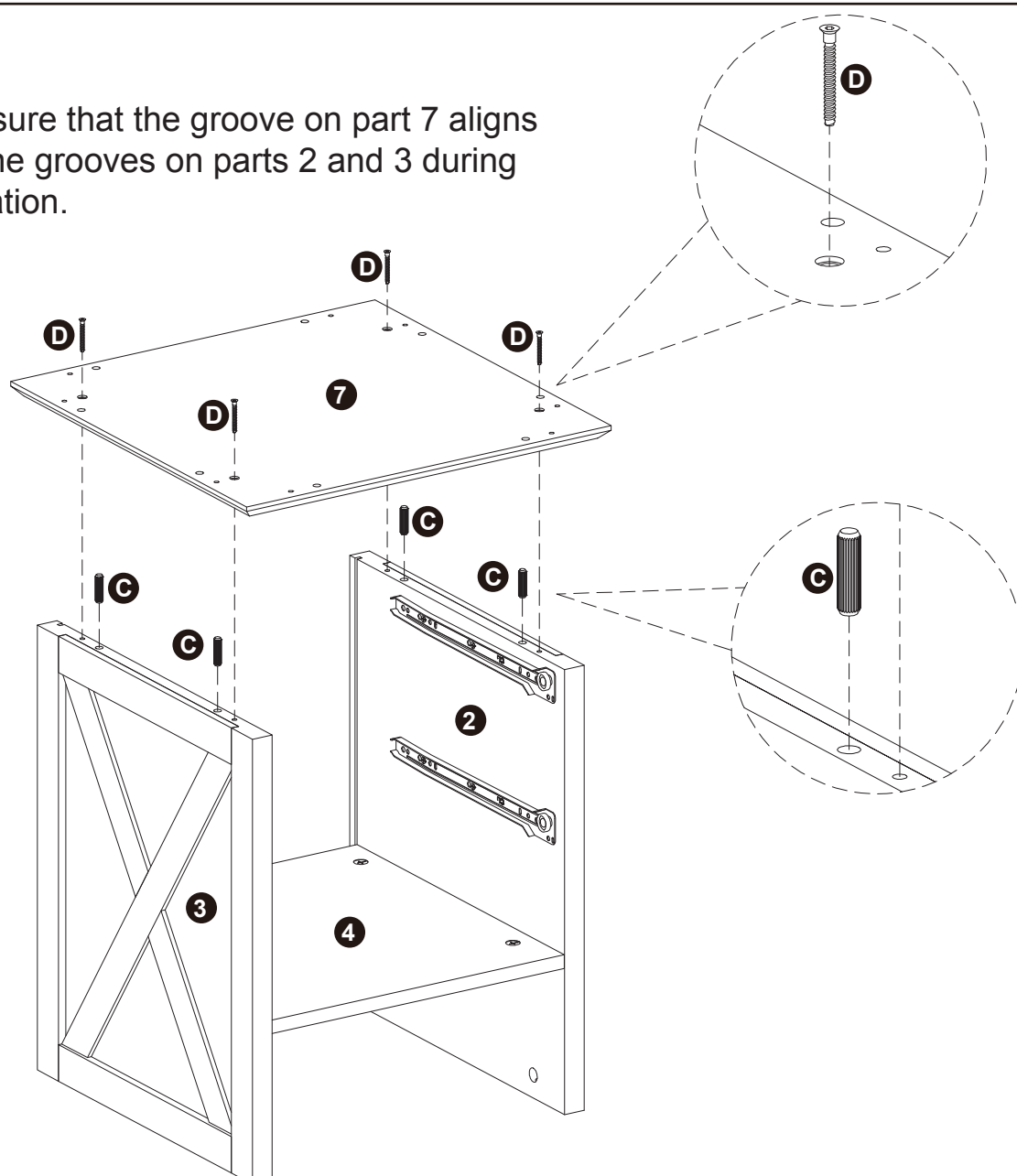

Assembly

STEP5

A 12pcs

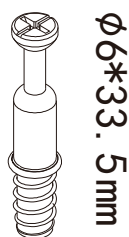

$\phi 6 \times 33.5 \text{ mm}$

C 8pcs



$\phi 8 \times 30 \text{ mm}$

8 1pcs



10 1pcs

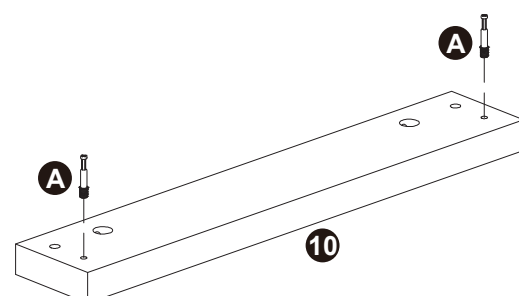
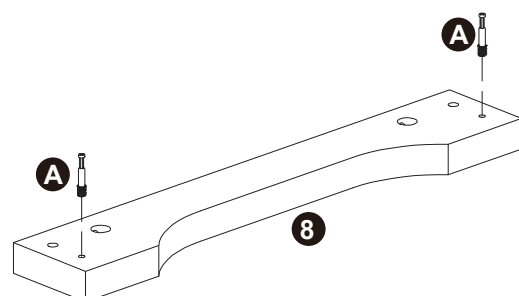
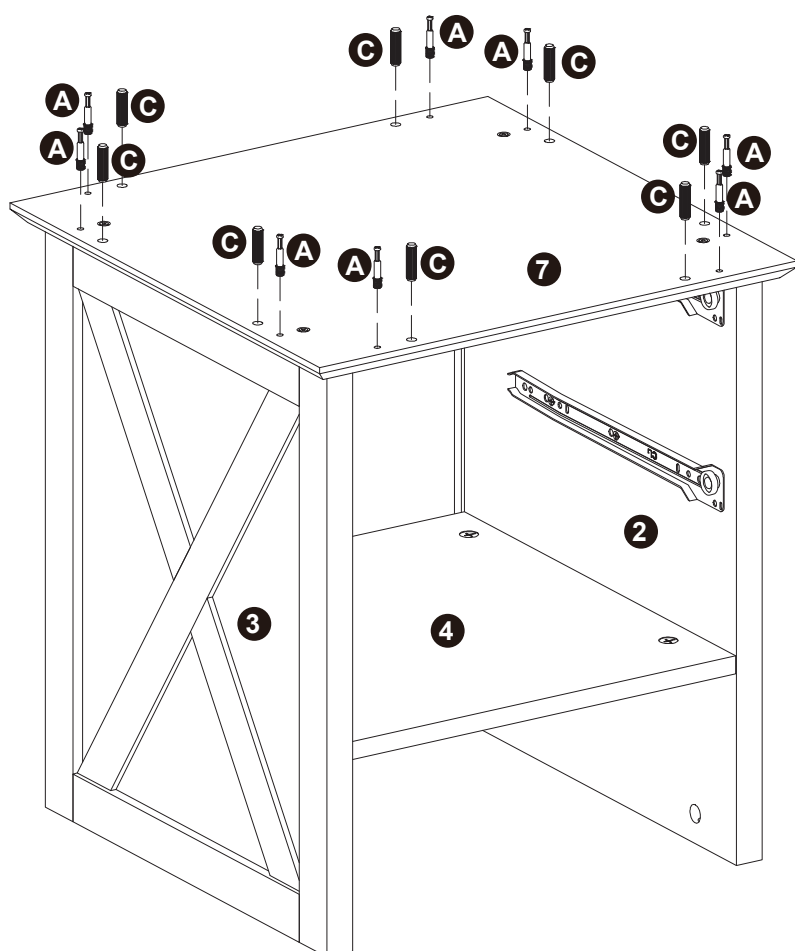

Assembly

STEP 6

B 4pcs



φ15*9.5mm

C 4pcs



φ8*30mm

9 2pcs

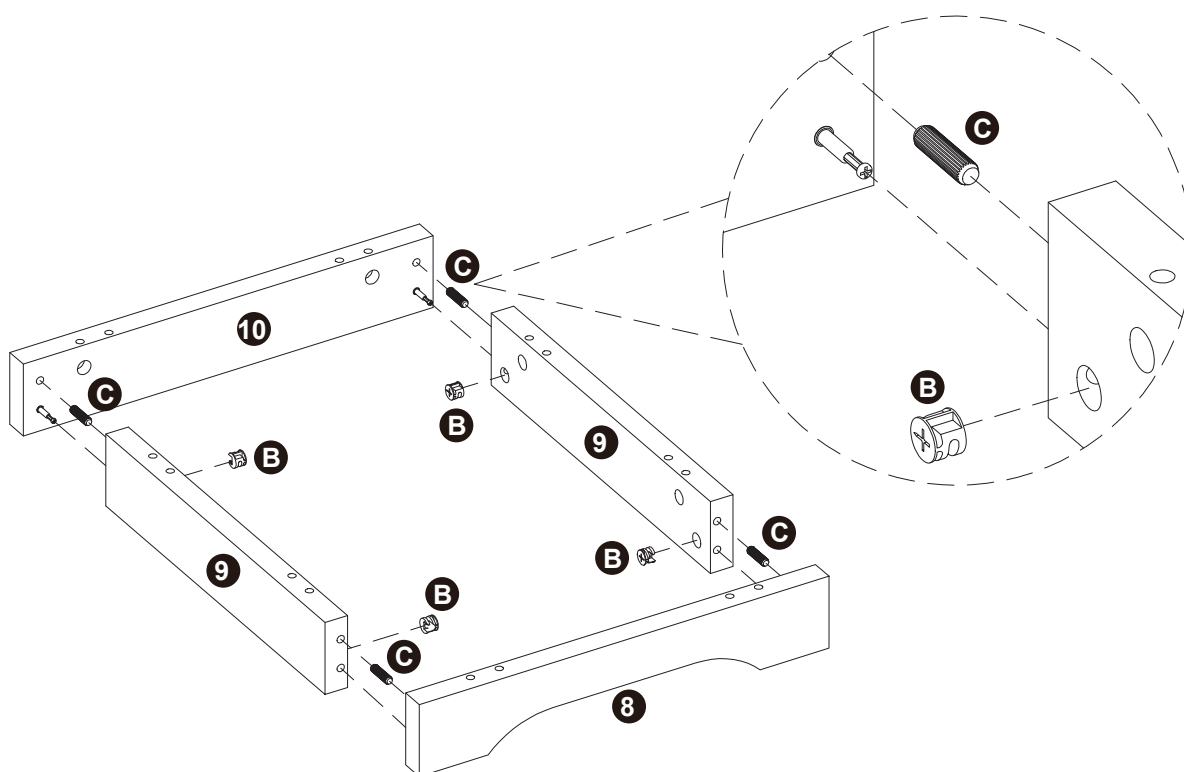
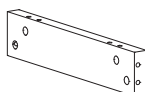

Assembly

STEP 7

B 8pcs



φ15*9.5mm

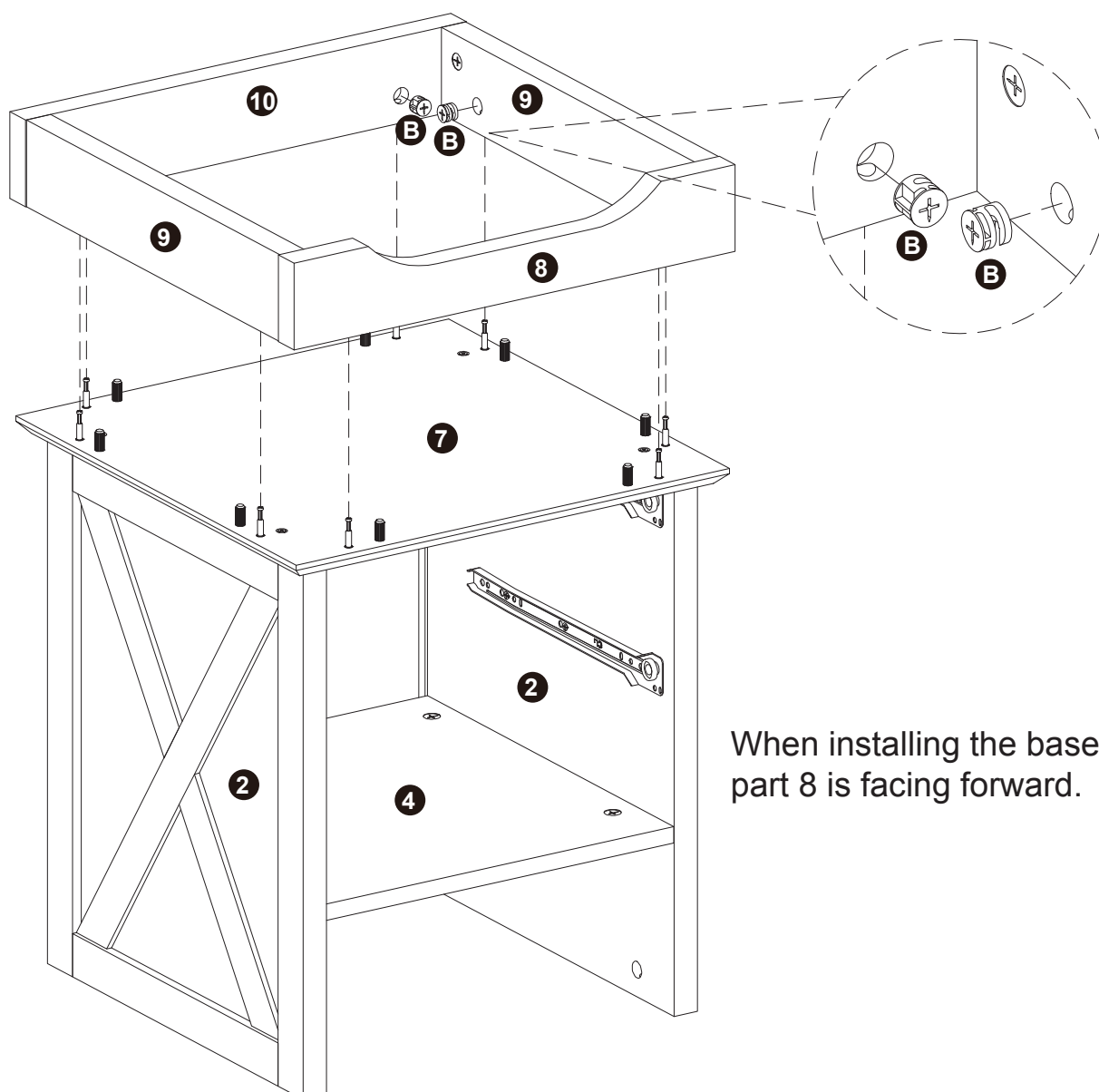

When installing the base, ensure that part 8 is facing forward.

Assembly

STEP8

6 1pcs

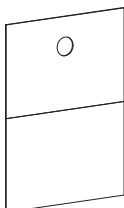

C 4pcs



Ø8*30mm

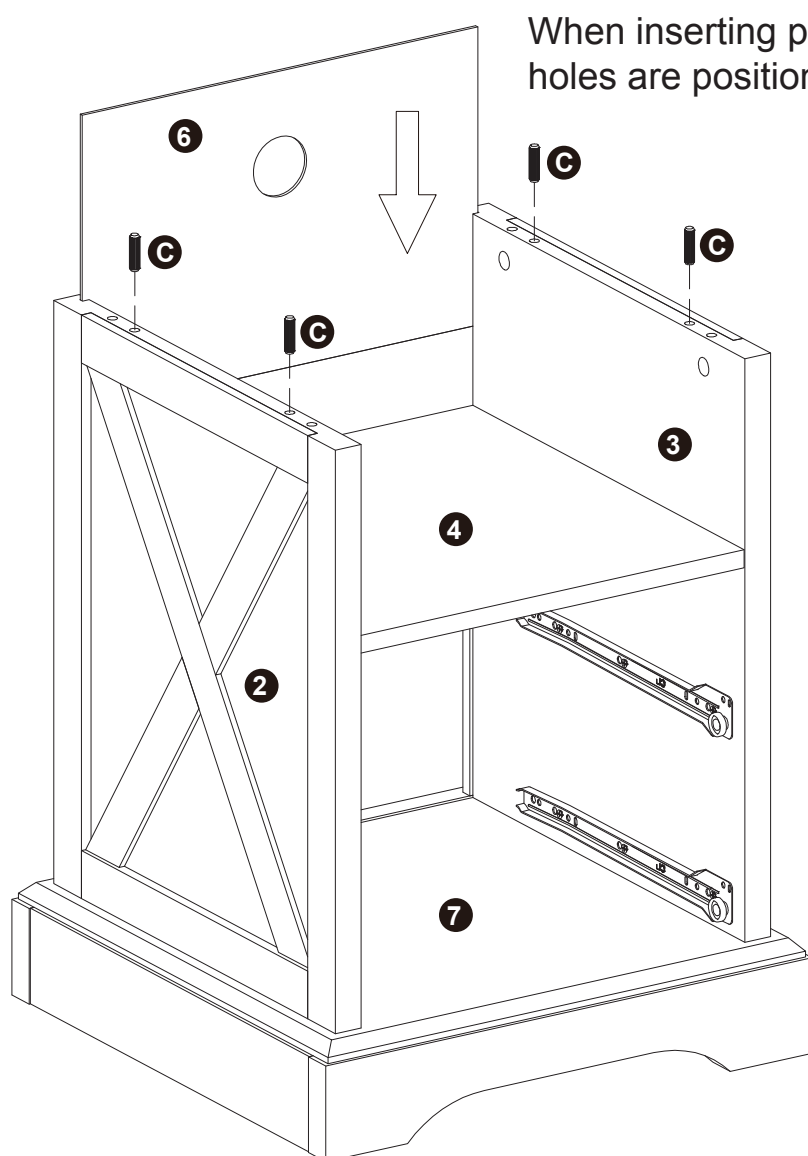

When inserting part 6, make sure the holes are positioned at the top.

Assembly

STEP9

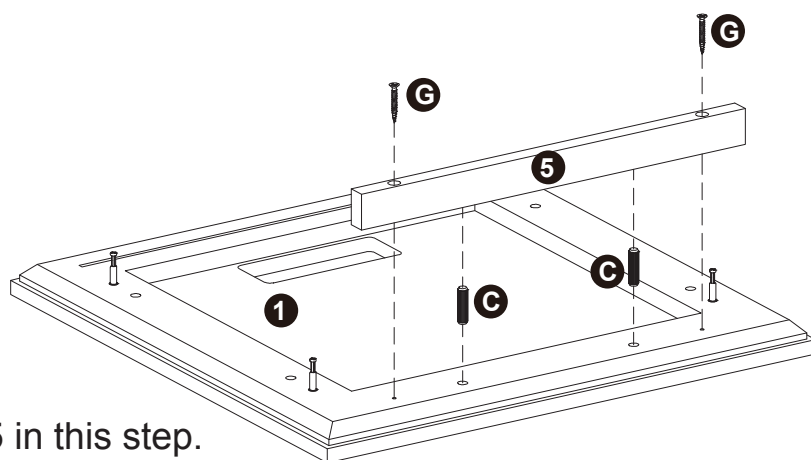
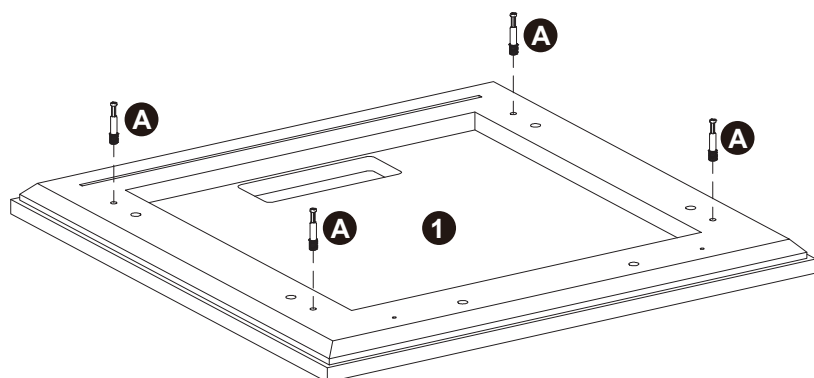
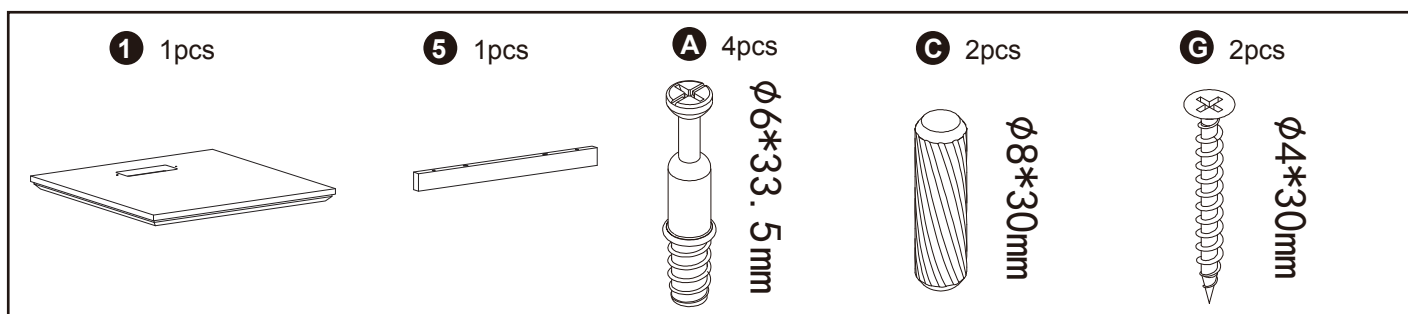

Don't overlook part 5 in this step.

Assembly

STEP10

B 4pcs



Ø15*9.5mm

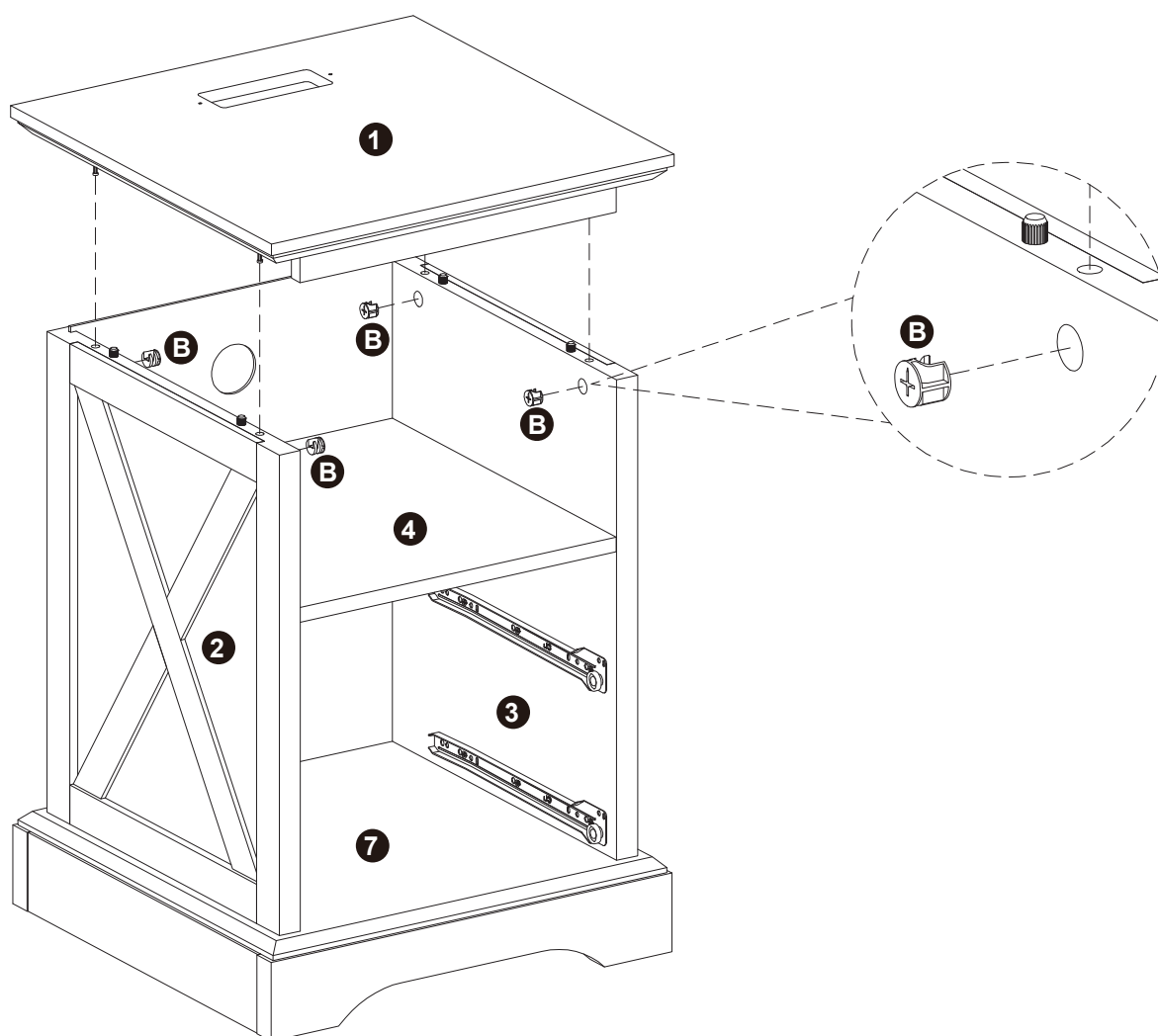

Assembly

STEP11

F 2pcs

Ø 3.5*12mm



J 1pcs

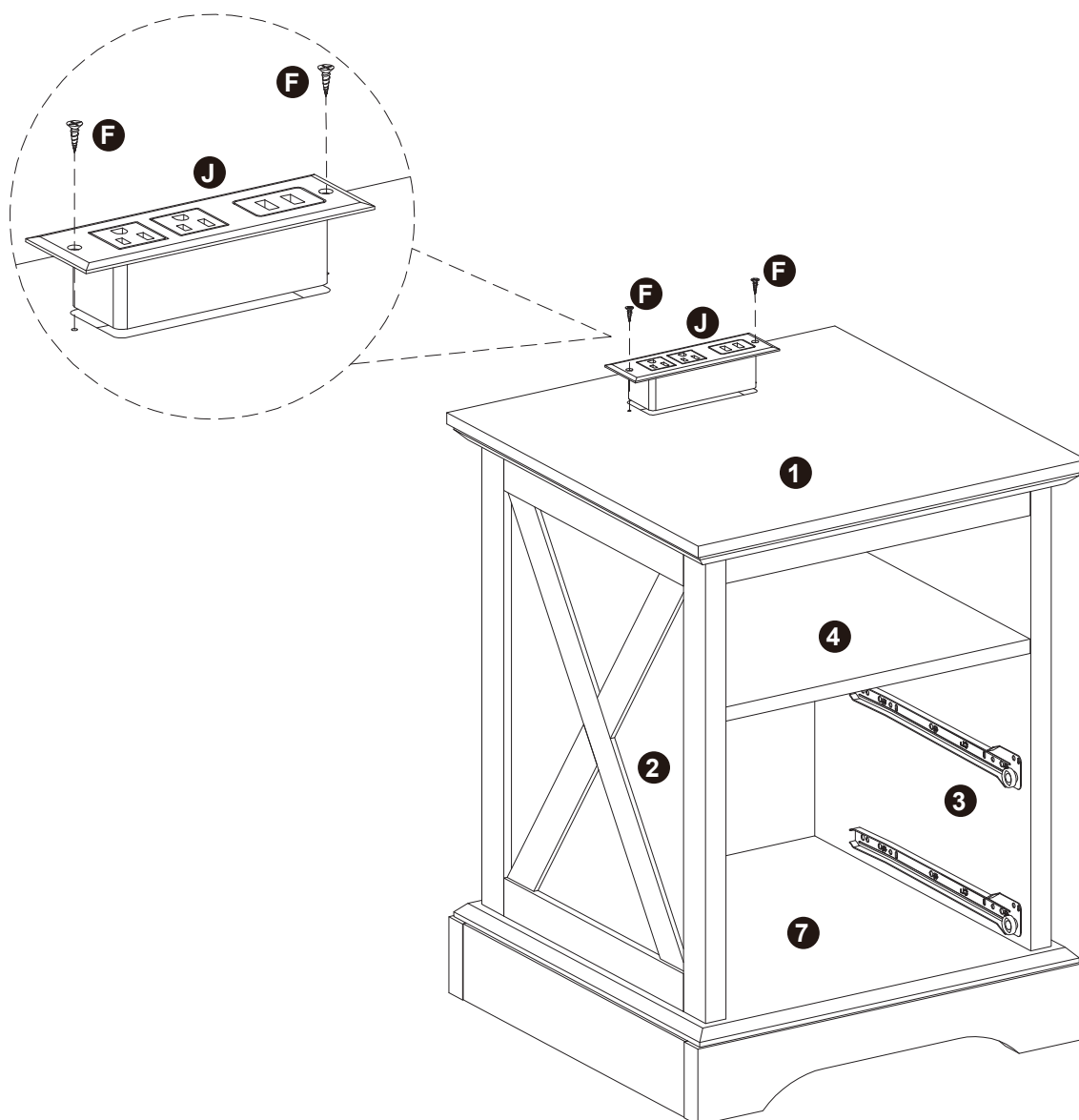
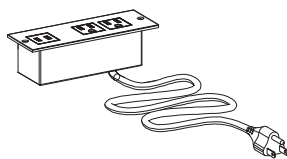

Assembly

STEP12

M 6pcs

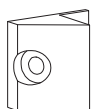

N 6pcs



Ø3*16mm

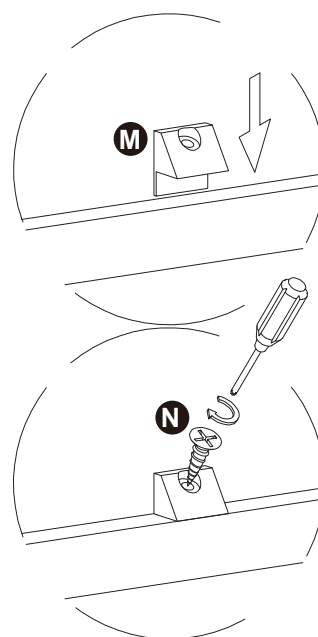
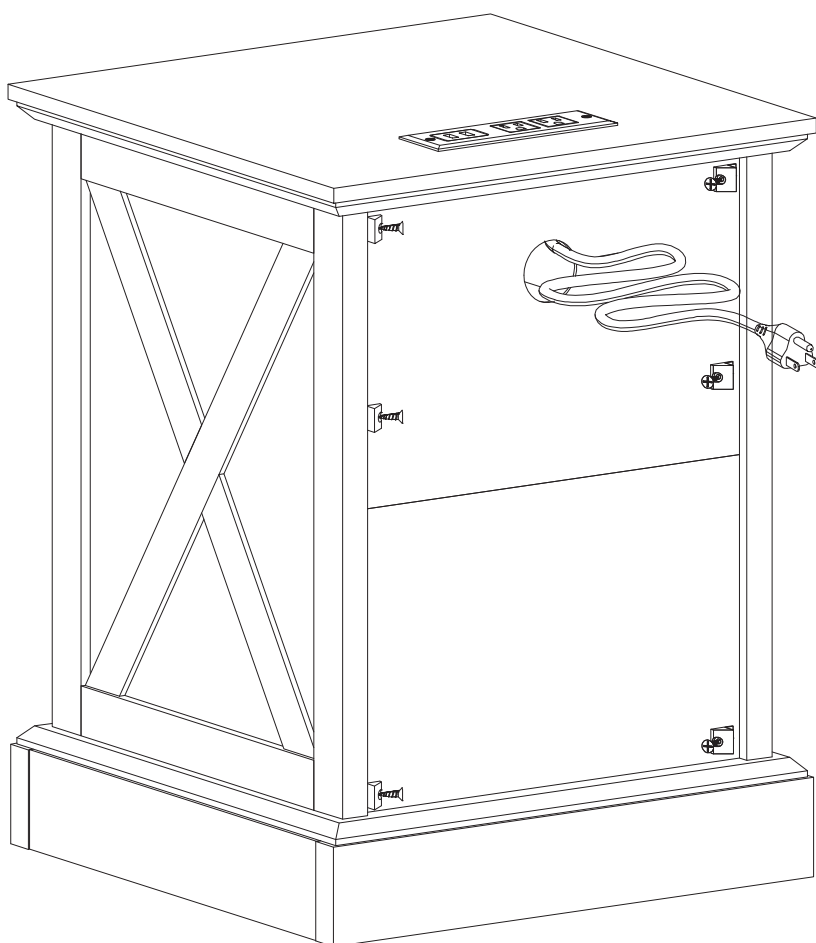

We highly recommend not skipping this step,
as part M will greatly enhance the stability of the product.

Assembly

STEP13

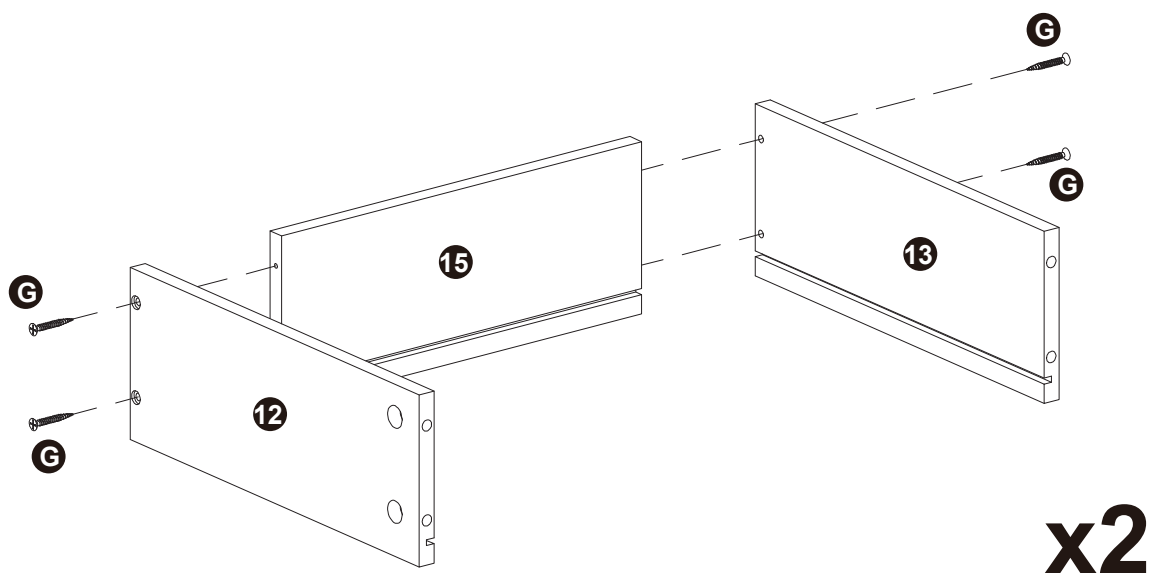
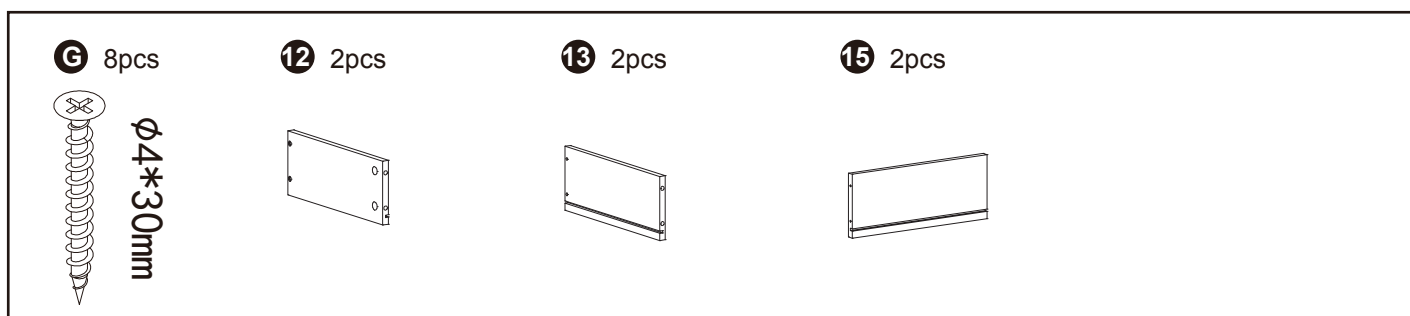

Assembly

STEP14

14 2pcs

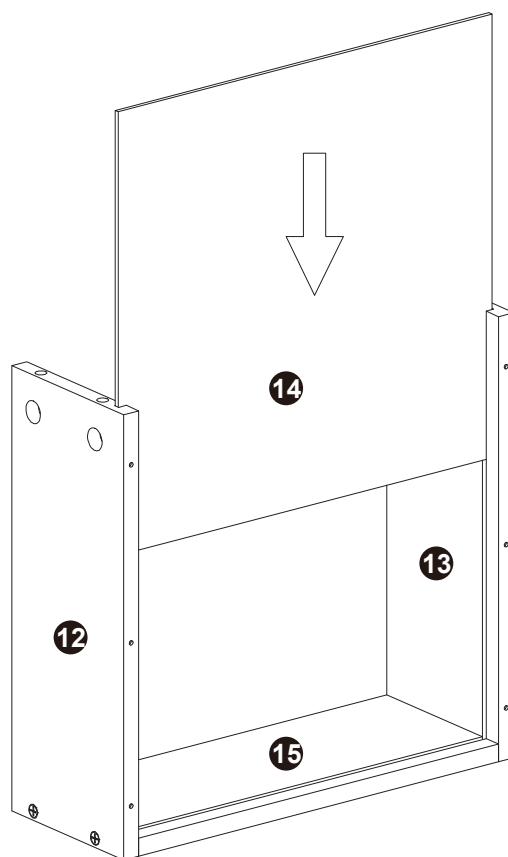

x2

Assembly

STEP15

A 8pcs

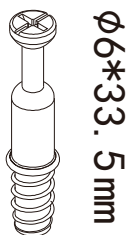

11 2pcs

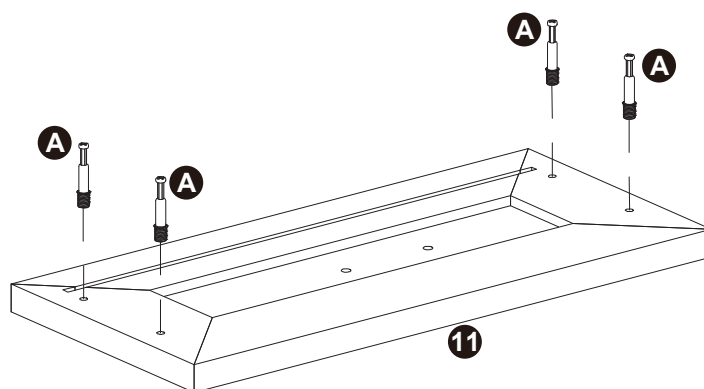
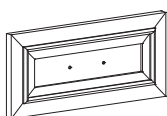

x2

Assembly

STEP16

B 8pcs



Ø15*9.5mm

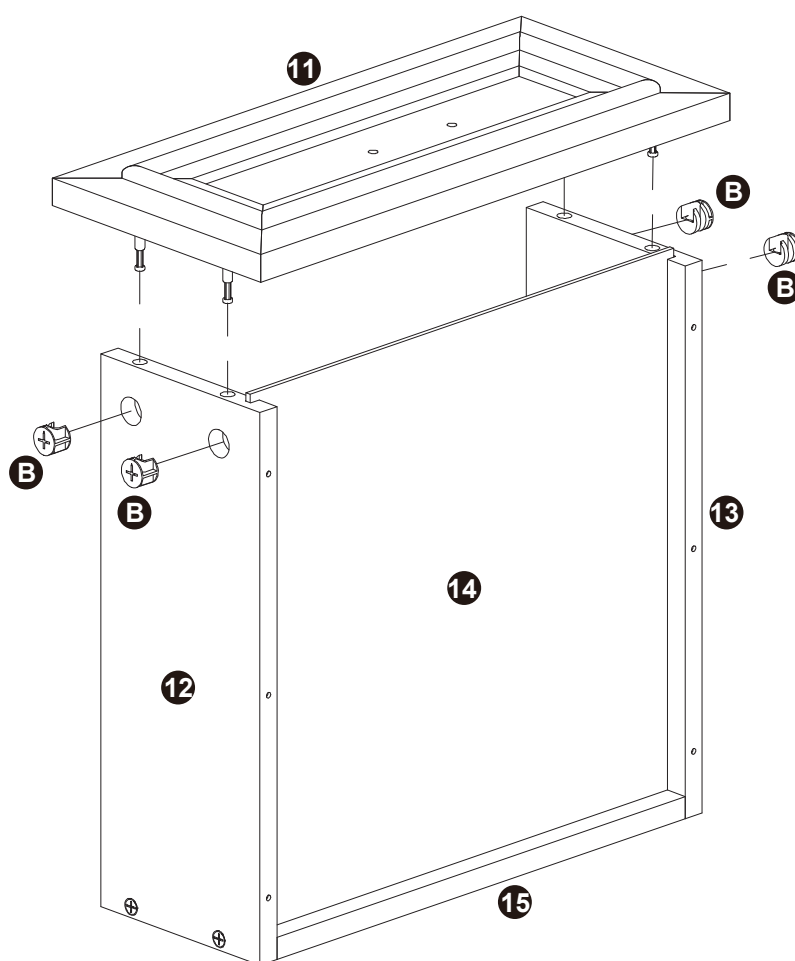

x2

Assembly

STEP17

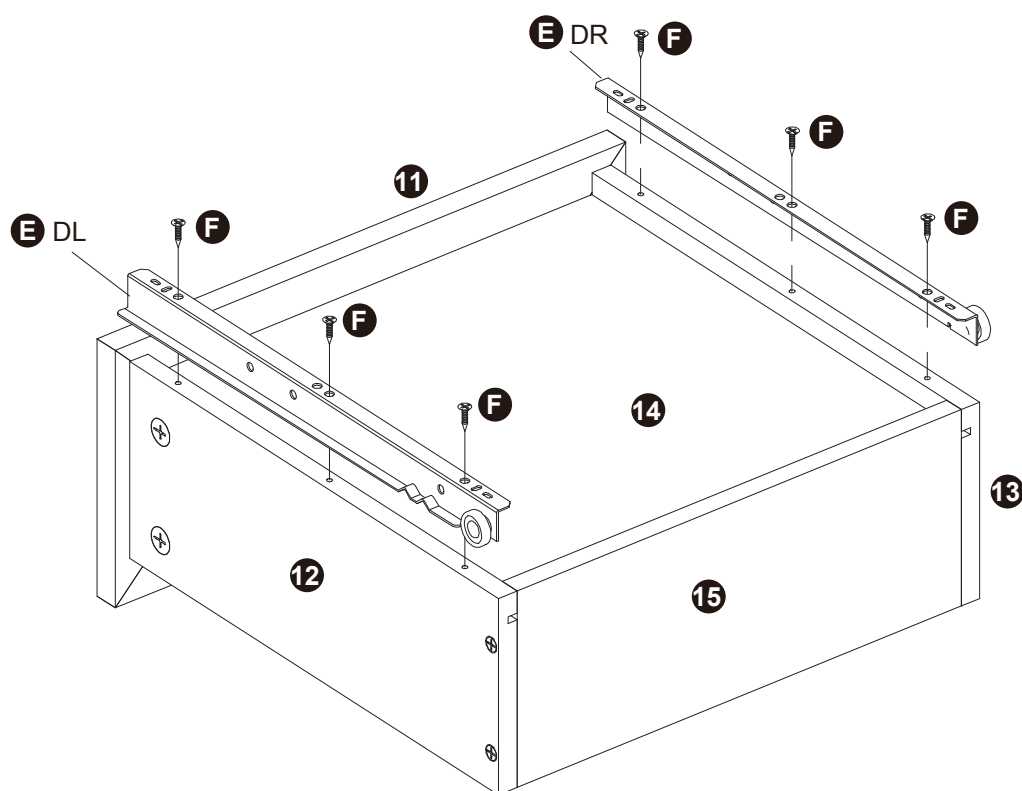
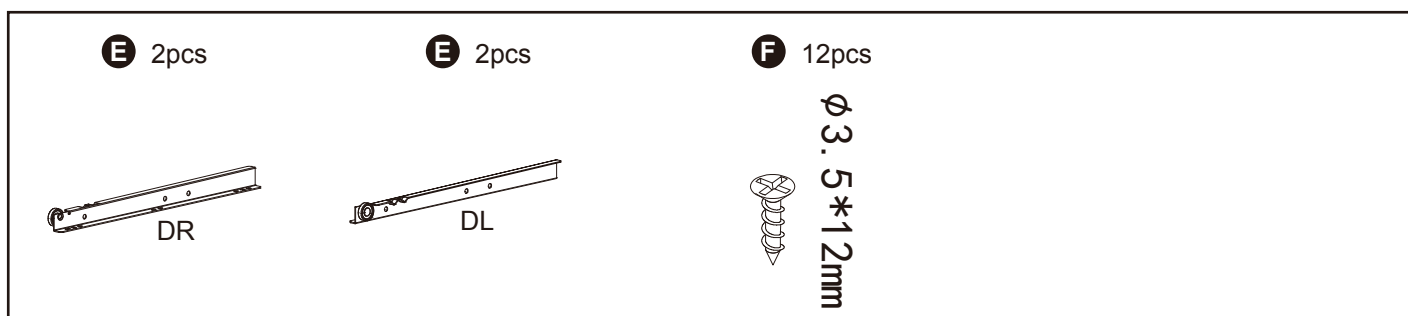

x2

Use the diagram to confirm the correct orientation of the rails.

Assembly

STEP18

H 2pcs



I 4pcs



M4*10mm

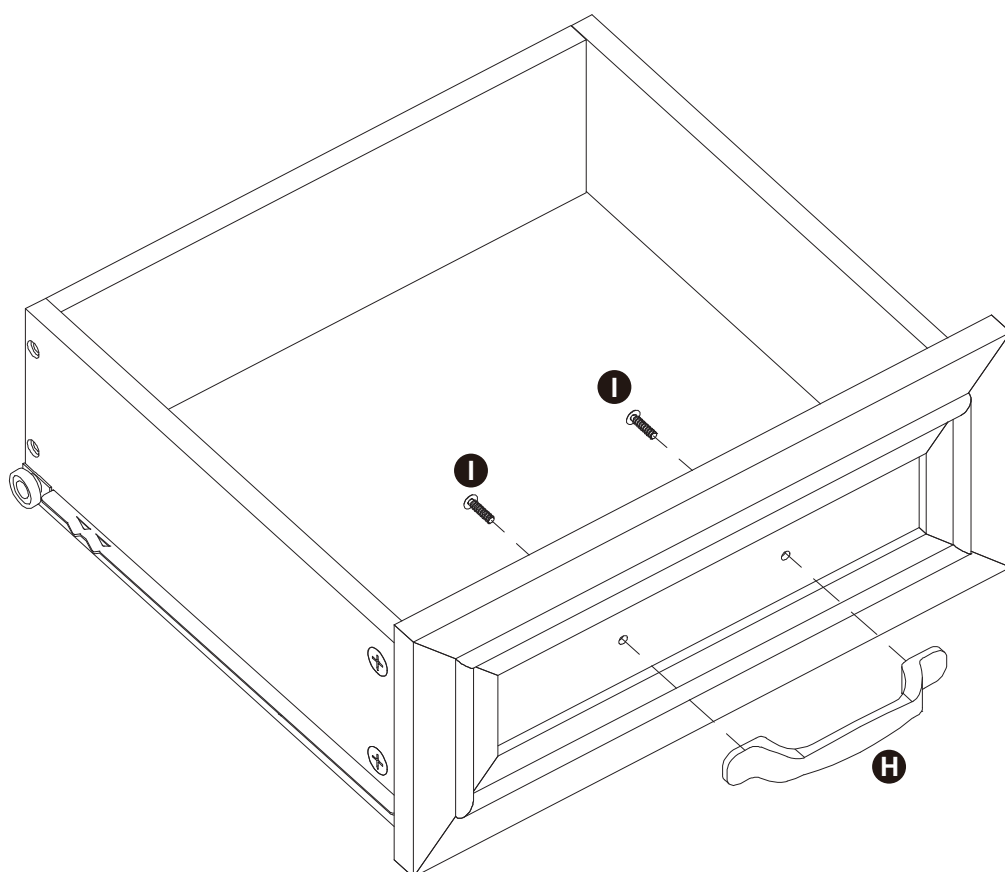

x2

Assembly

STEP 19

K 12pcs

