

Tall 6-drawer Dresser

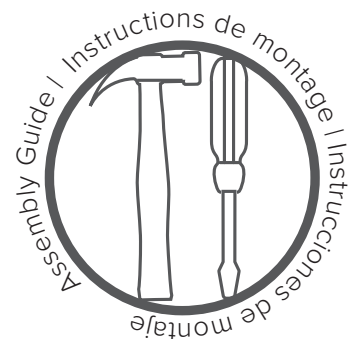

Tools

Vous aurez besoin / Necesitarás

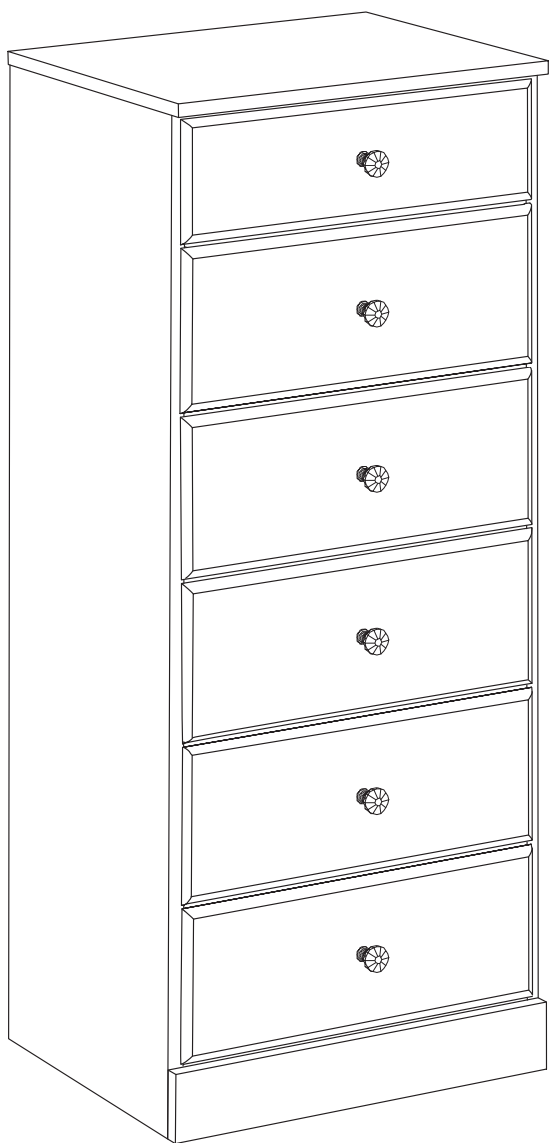
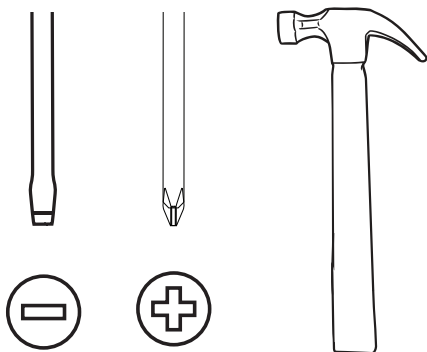

2 person recommended

2 personnes recommandées /

2 personas recomendadas

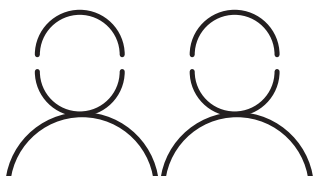

Parts

Pièces

Piezas

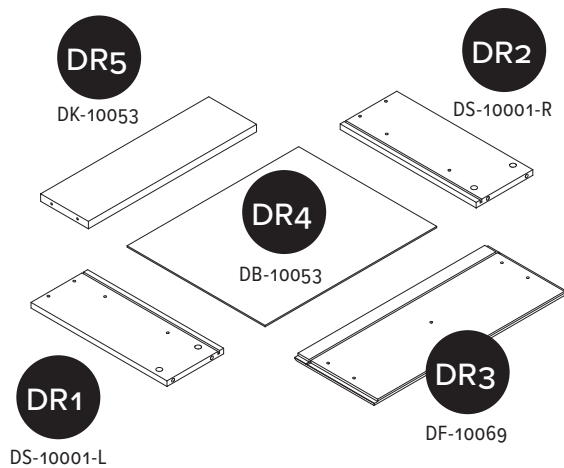
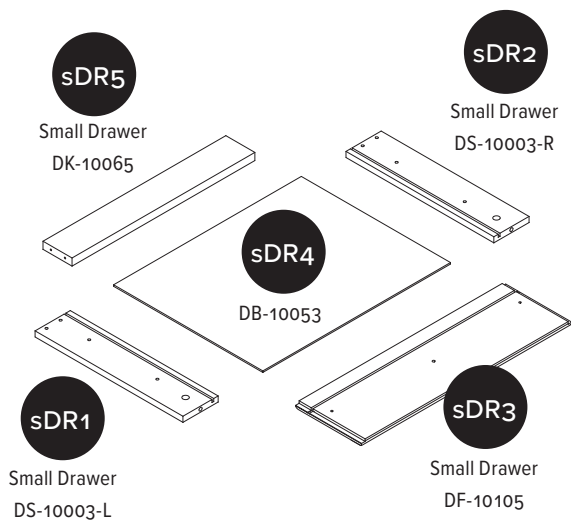
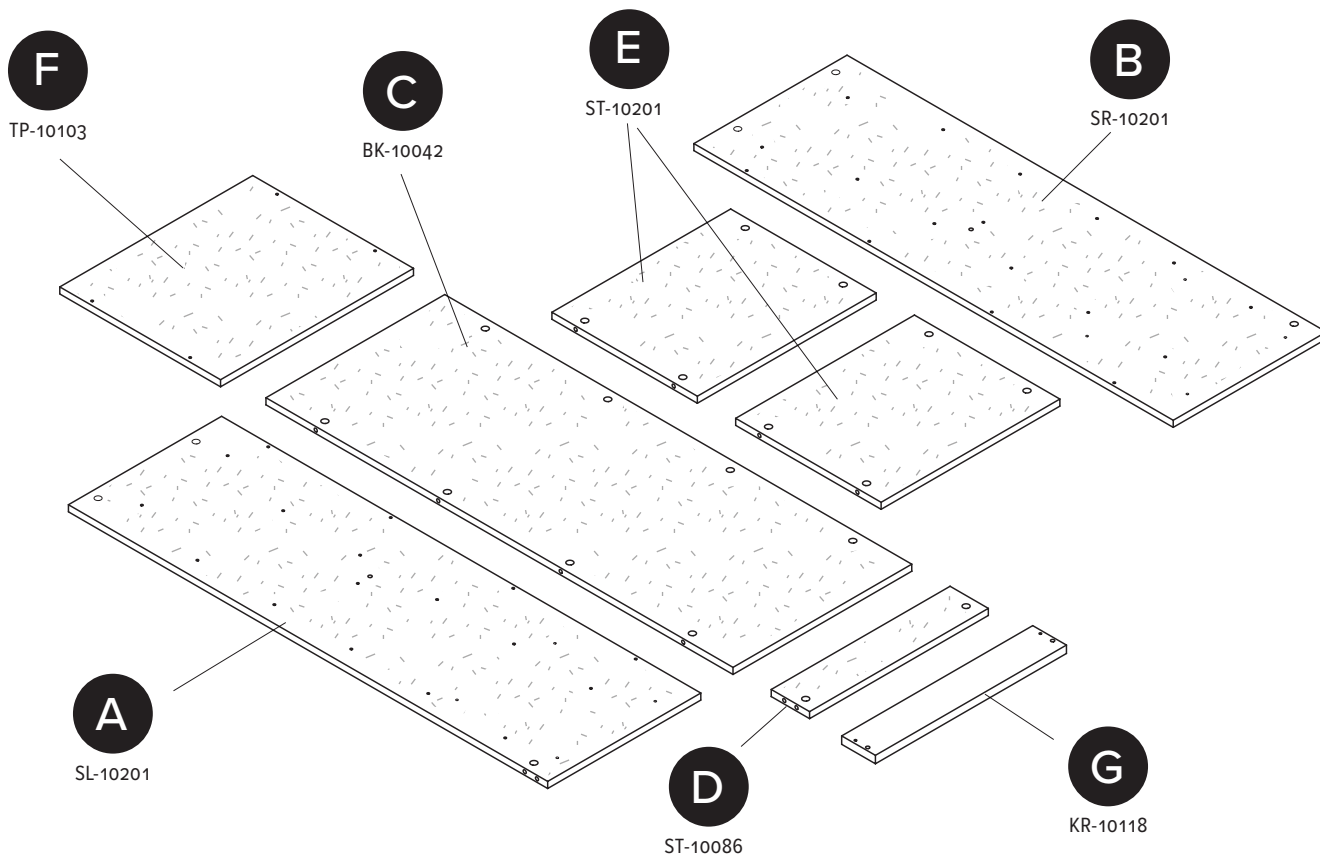

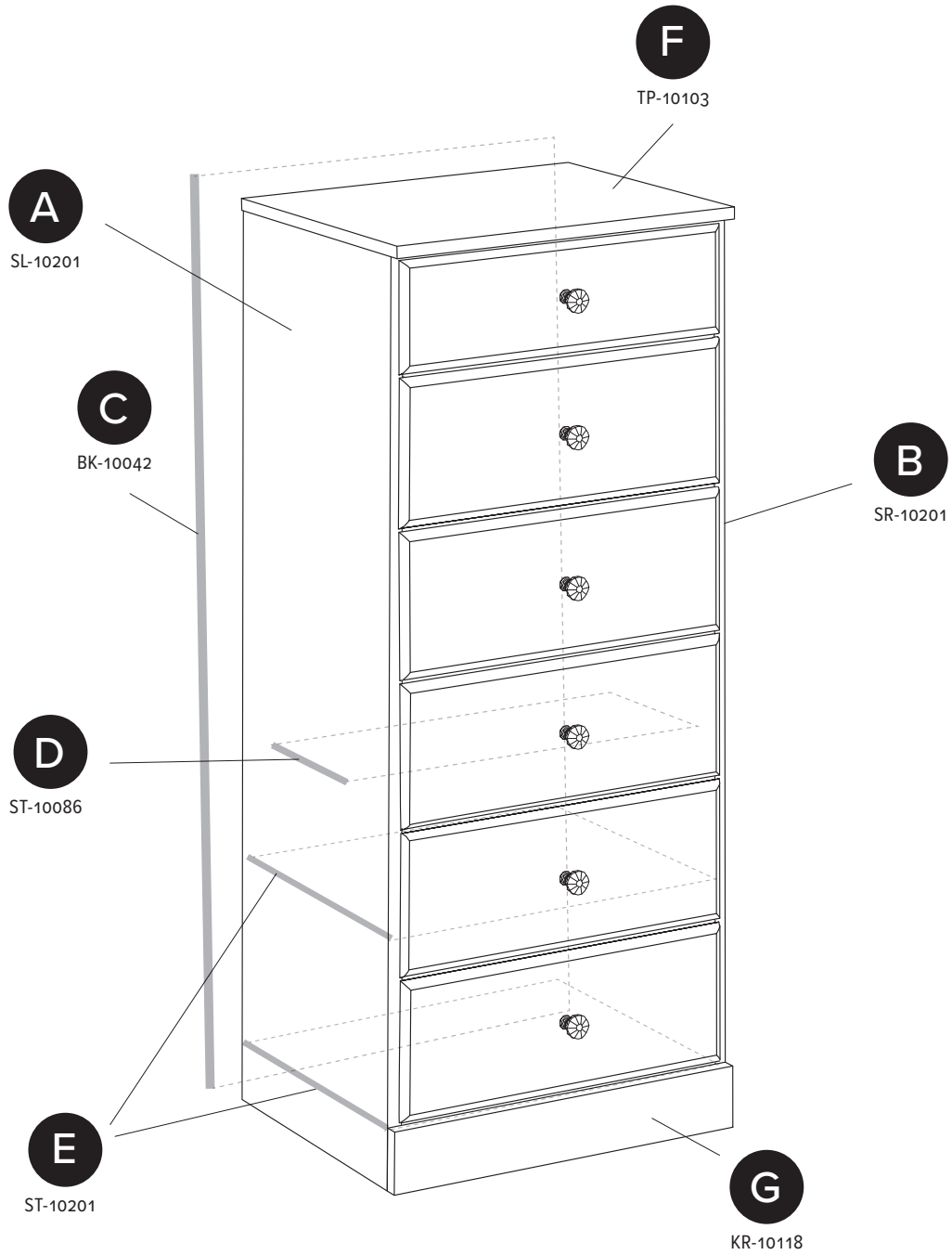

Hardware

Quincaillerie

Piezas de Conexión

24 X



RM-0103

24 X

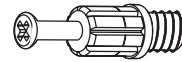

RM-0501
GREEN

4 X



RM-0069

48 X



RM-0074

22 X

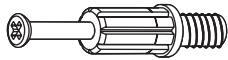

RM-0500
BLACK

22 X



RM-0715

24 X



RM-0504

30 X

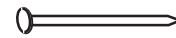

RM-0022

6 X

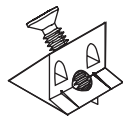

RM-0839

6 X

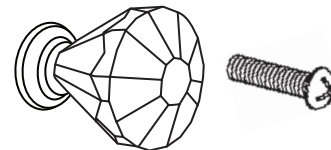

RM-0971

6X Drawer Slides Set (Blue Wheels)

Ensemble de glissières de tiroir (roues bleues)

Juego de guías para cajones (ruedas azules)

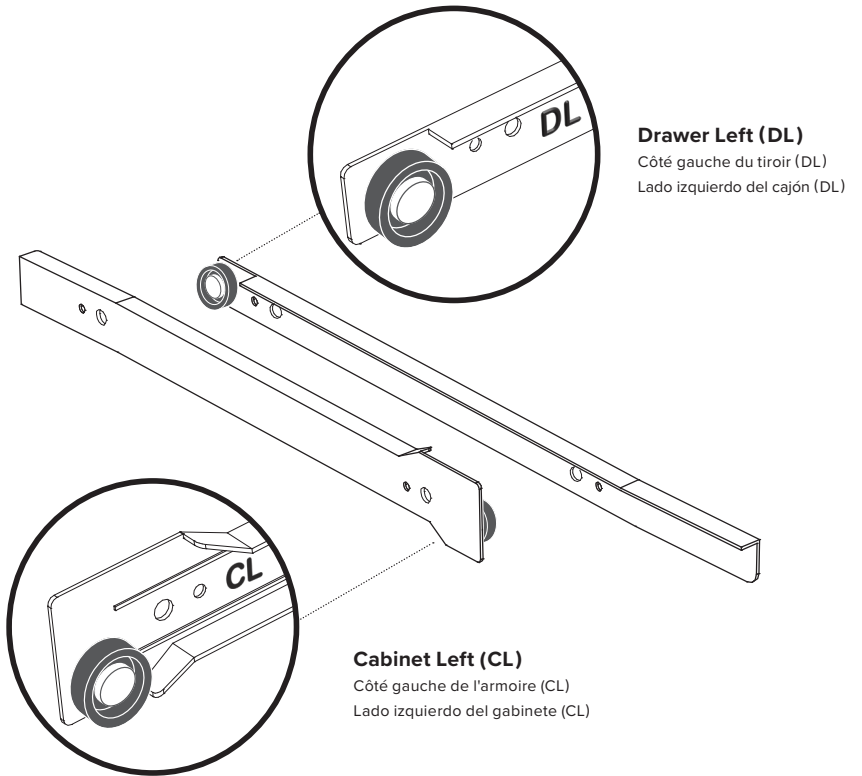

6X Drawer Slides Set (Red Wheels)

Ensemble de glissières de tiroir (roues rouges)

Juego de guías para cajones (ruedas rojas)

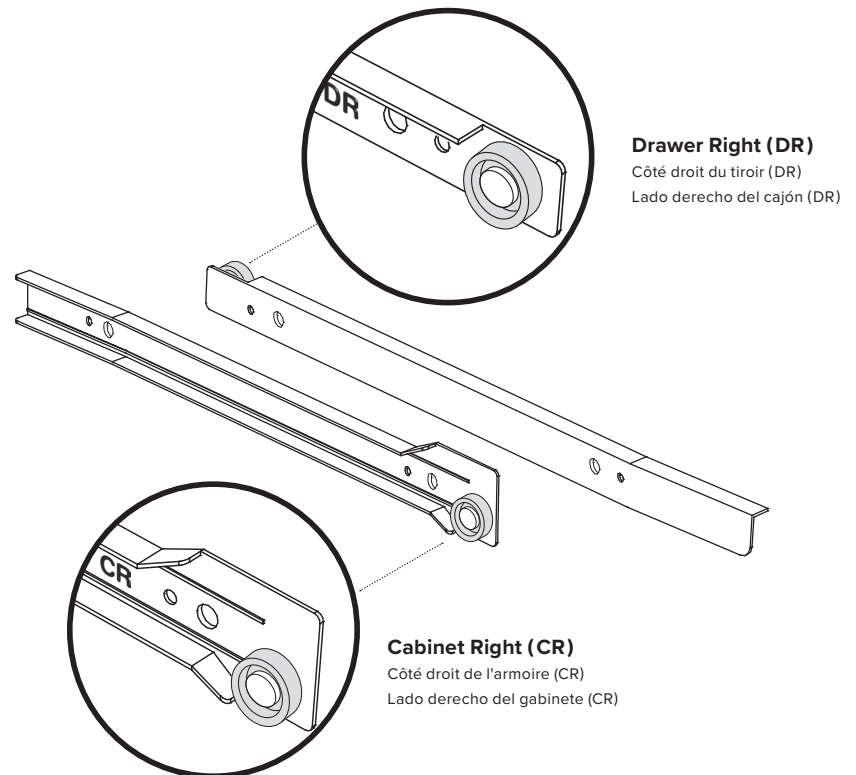

1X Tipover Restraint Kit

Kit anti-basculament

Kit de sujeción contra volcaduras

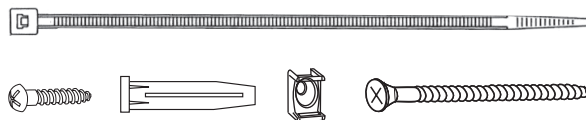

Assemble in 17 steps

Assemblage en 17 étapes

Montar en 17 pasos



60 mins

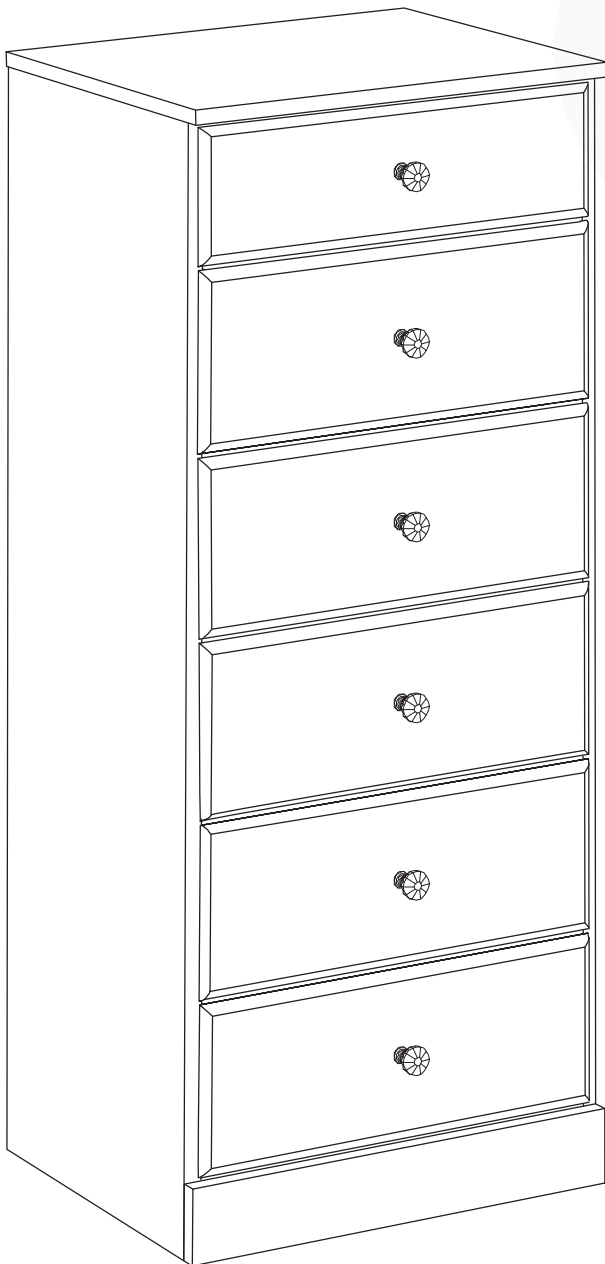

**Let's
start!**

Commençons!

¡Comencemos!

1



24 X  RM-0074

6 X Blue Wheel Slider Cabinet Left (CL)

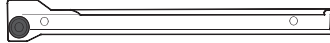

6 X Red Wheel Slider Cabinet Right (CR)

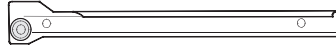

Blue Wheel Slider Cabinet Left (CL)

Red Wheel Slider Cabinet Right (CR)

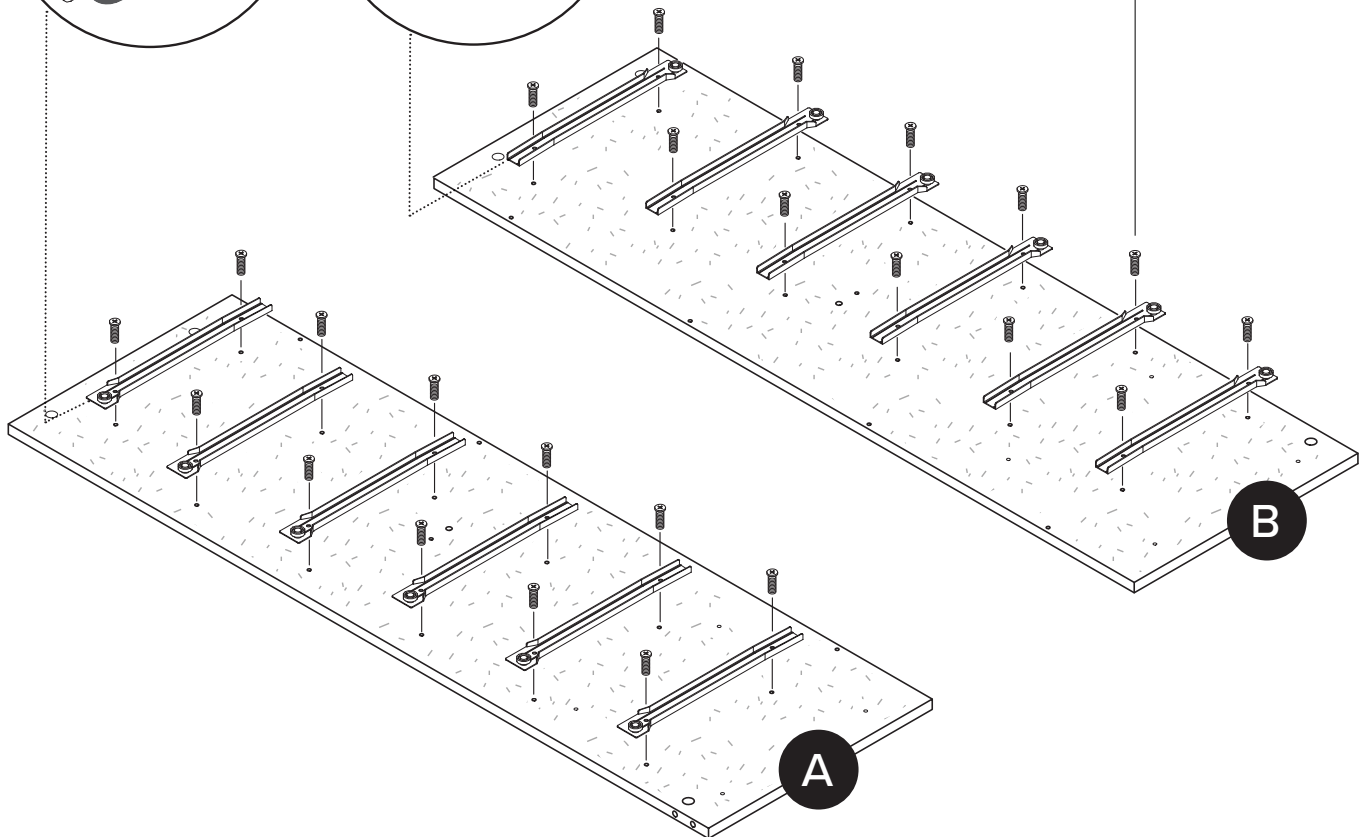
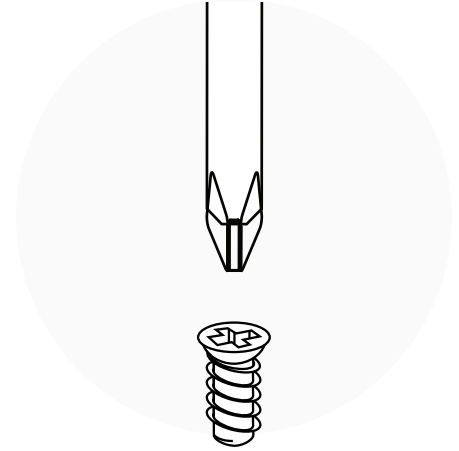
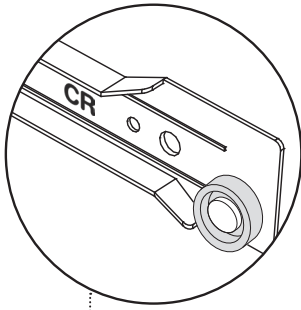
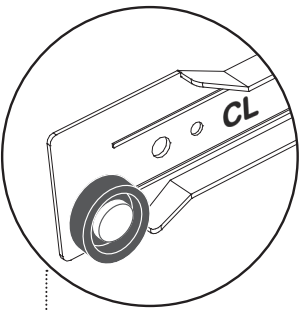

2



RM-0103



6X

RM-0069

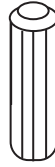

2X

RM-0501
GREEN

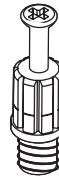

18X

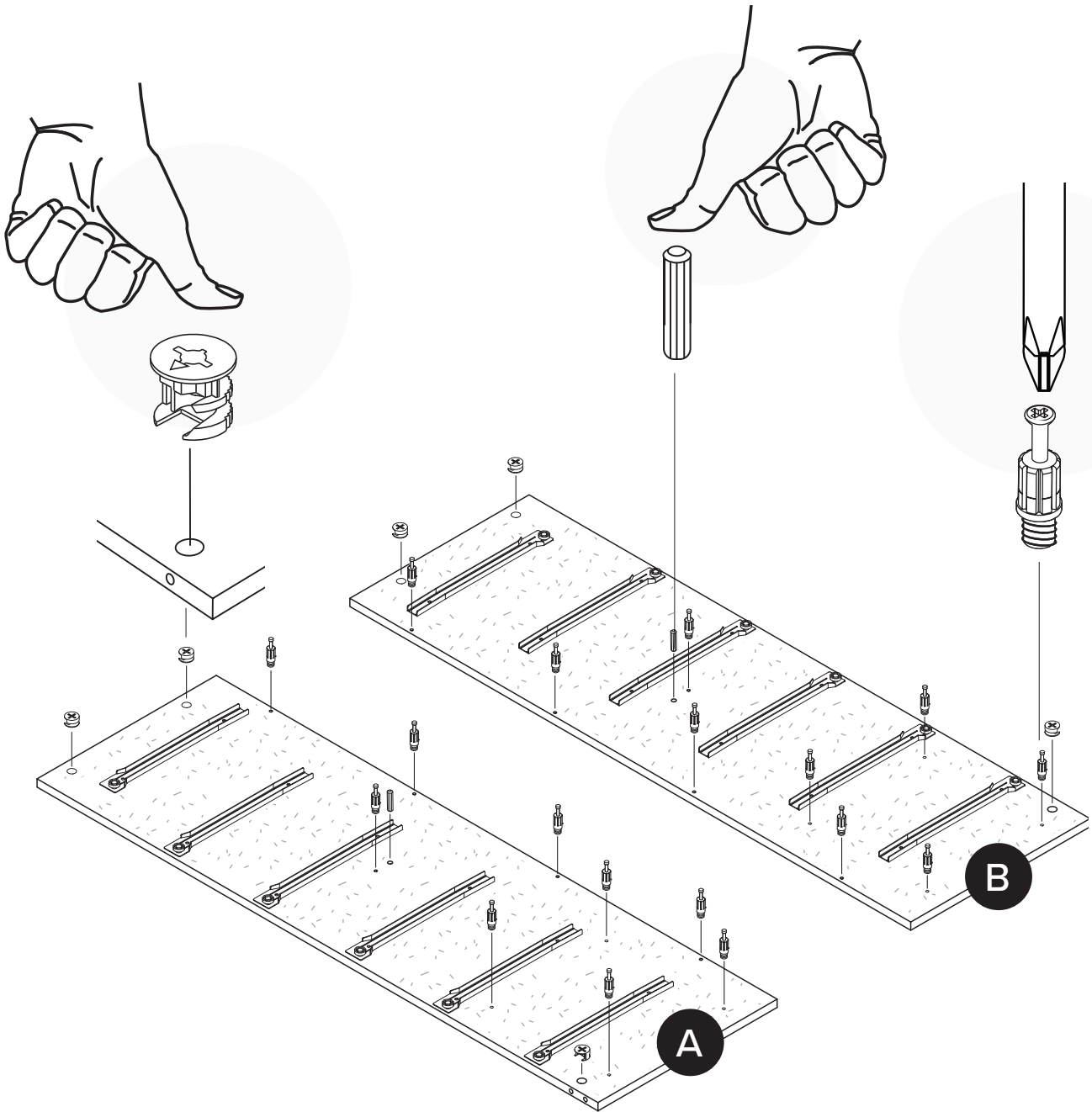

3



RM-0103



8X

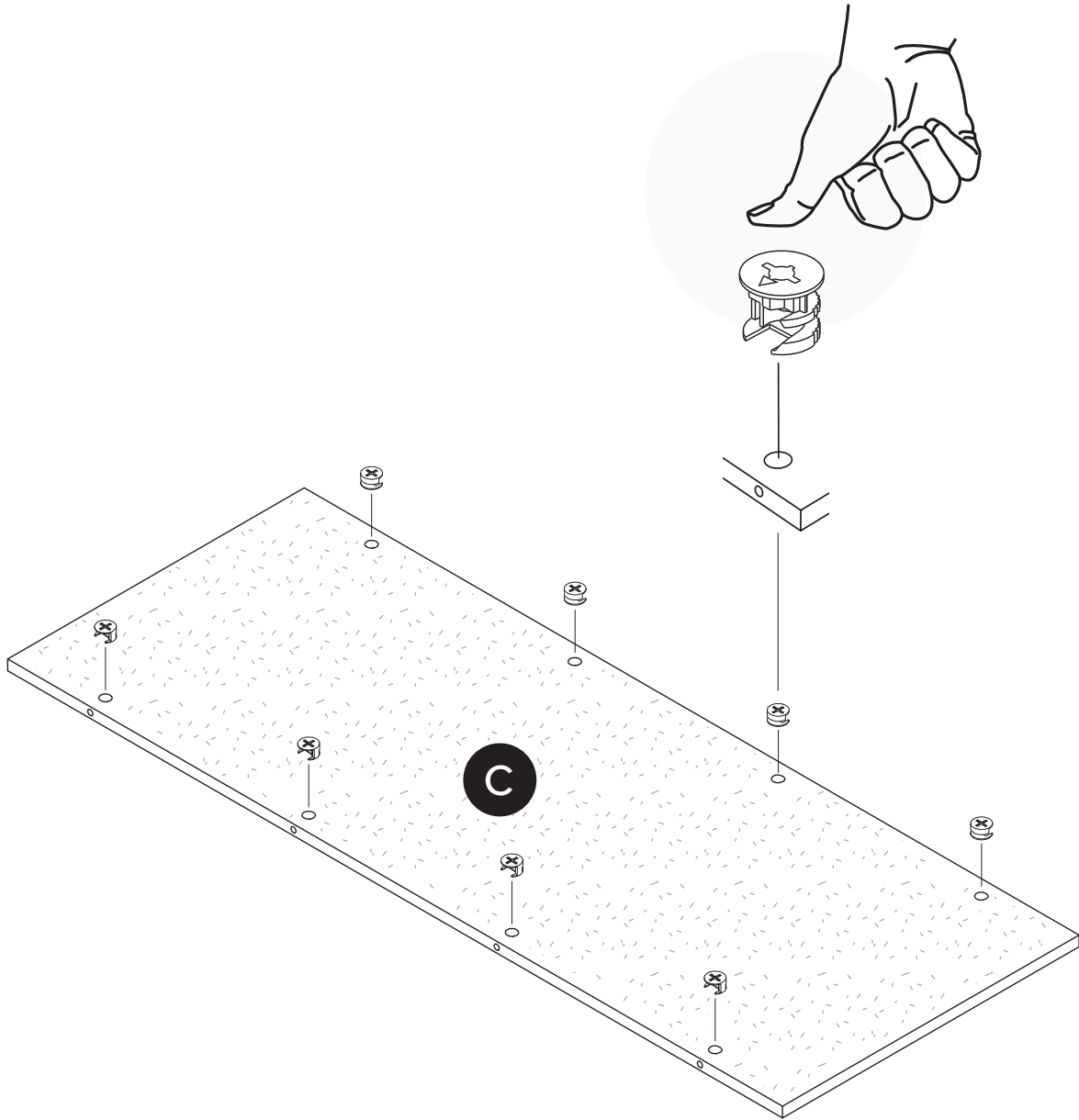

4

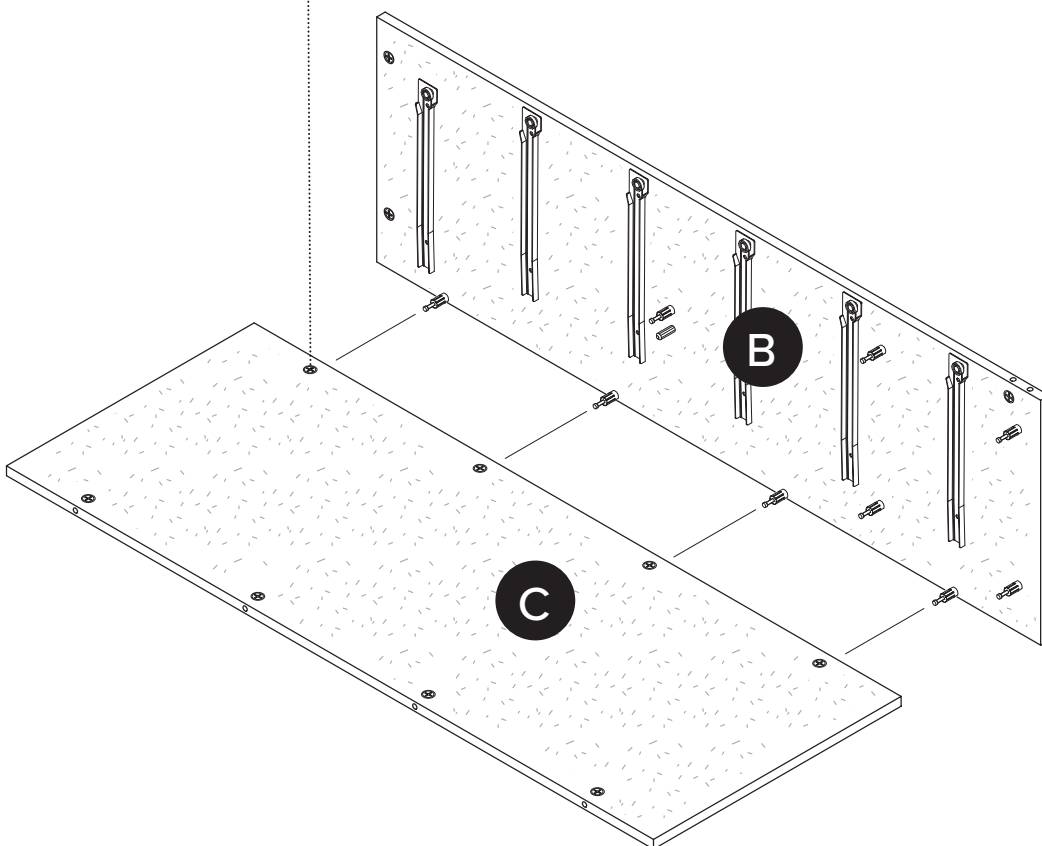
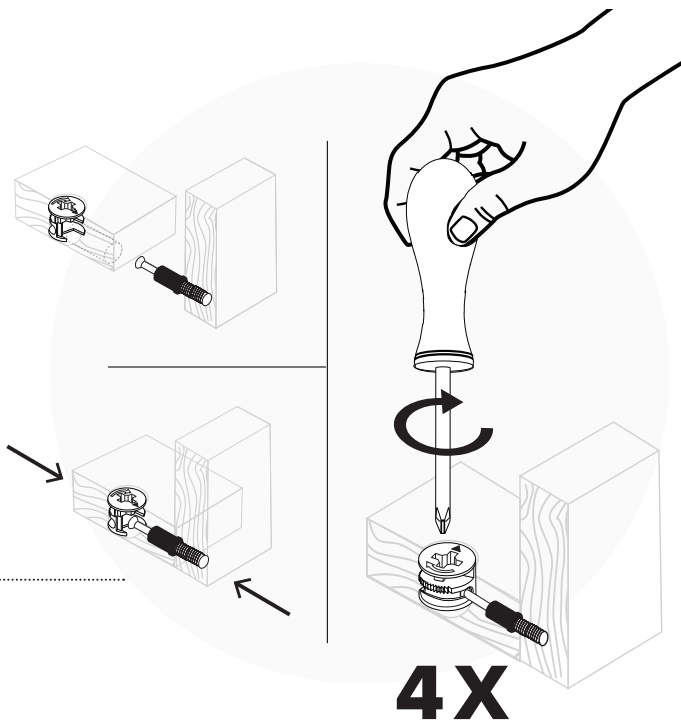

5



10X

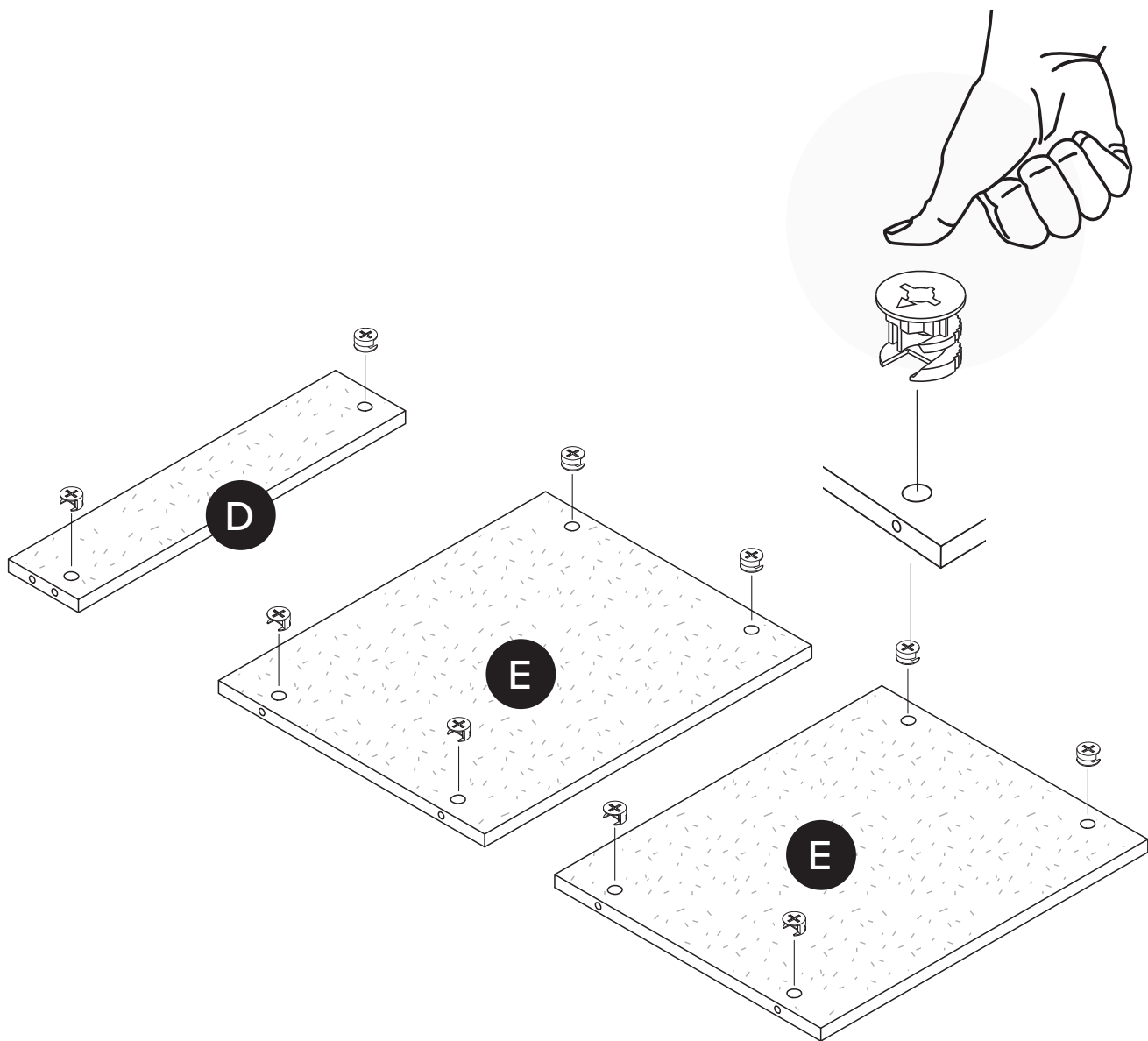

6

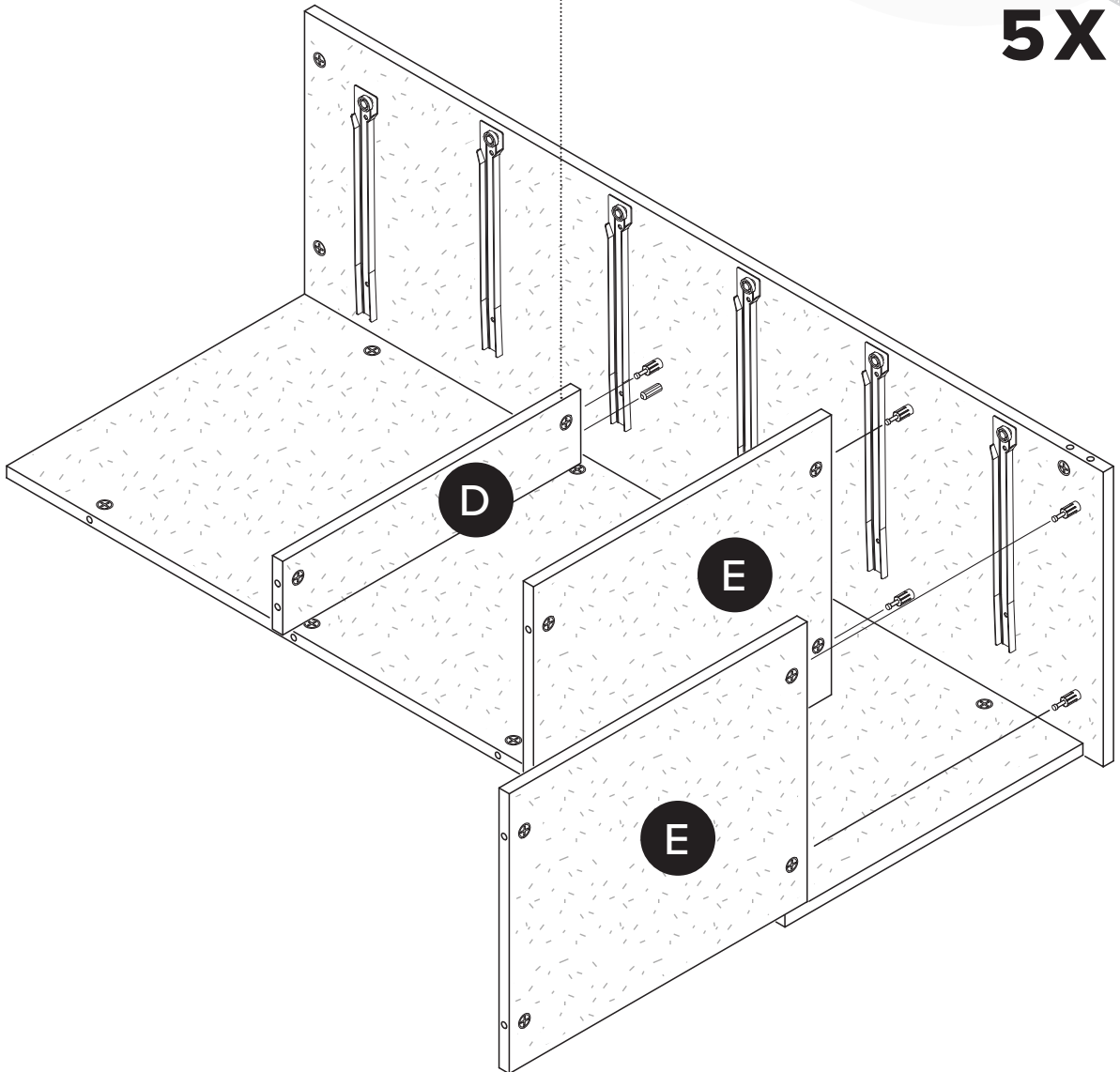
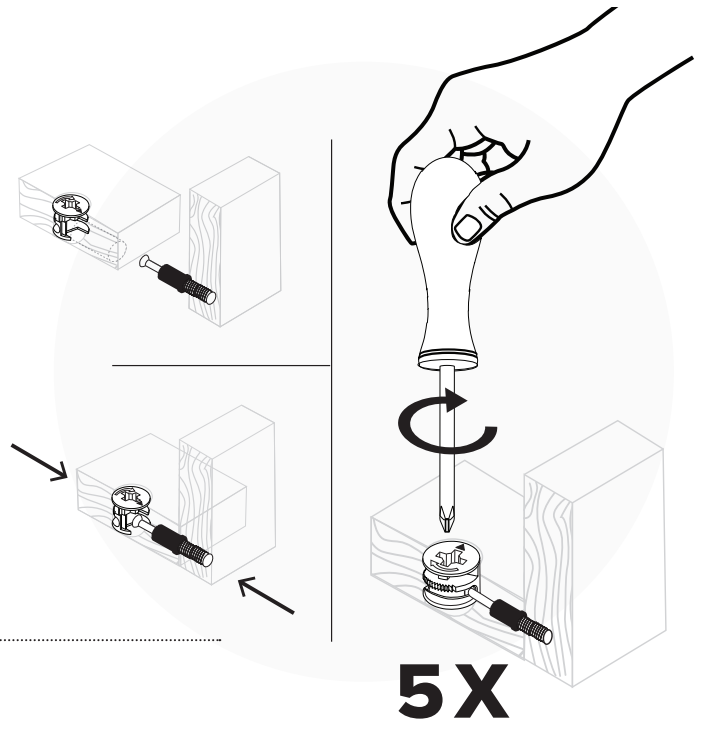

7

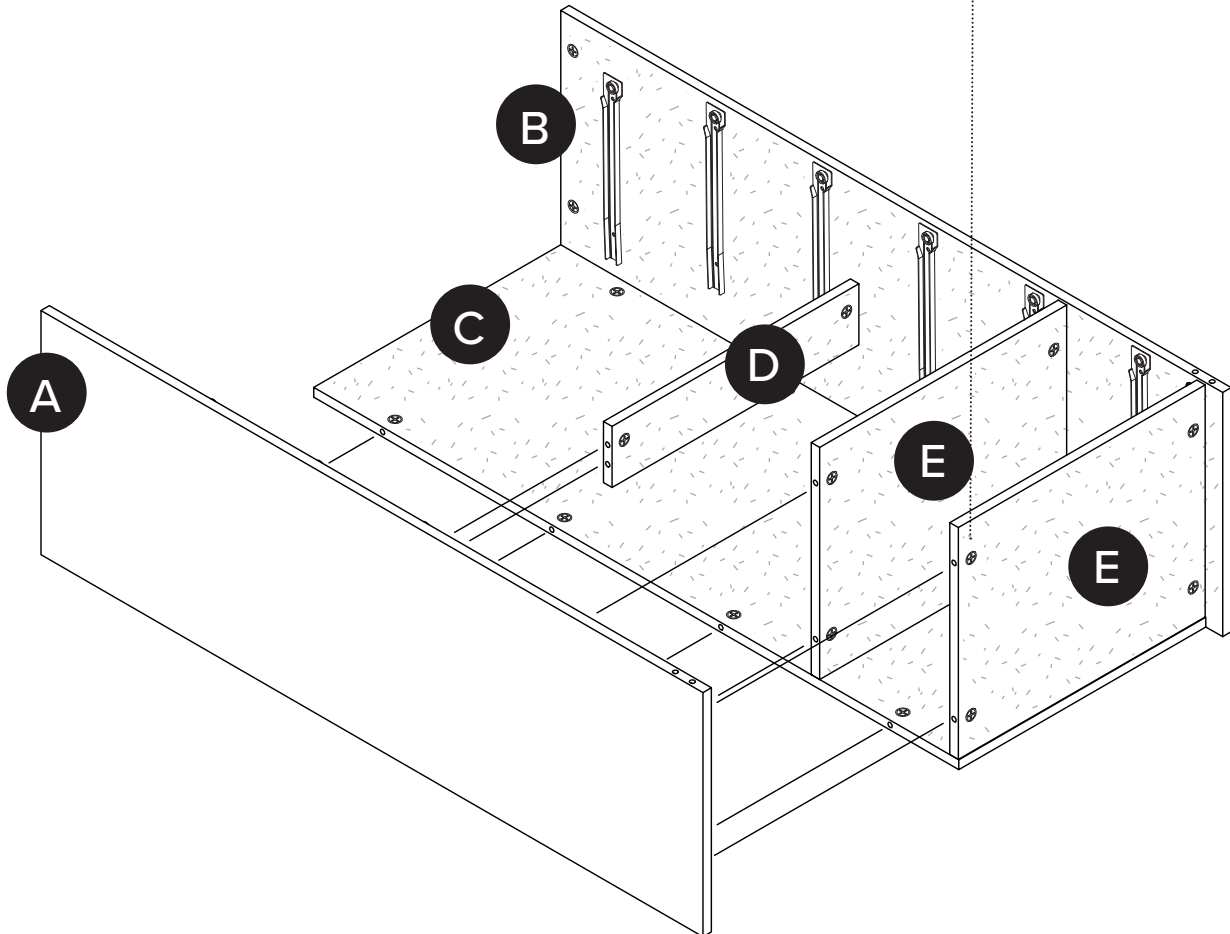
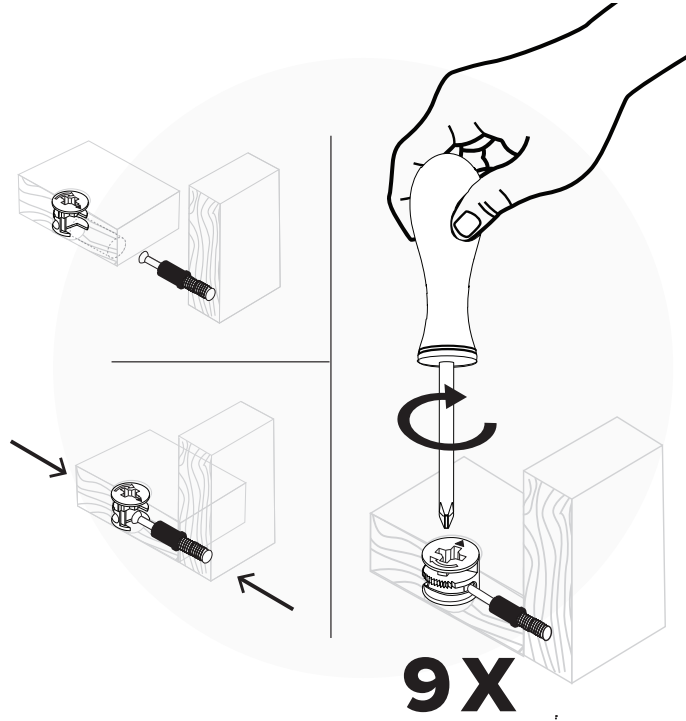

8

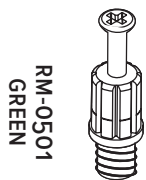

RM-0501
GREEN

6X



RM-0069

2X

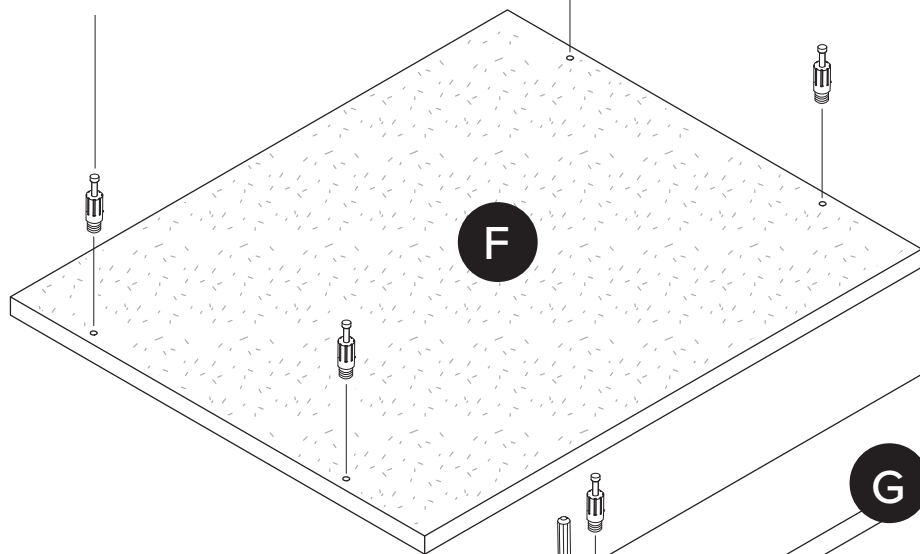
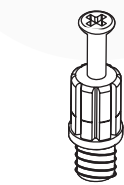
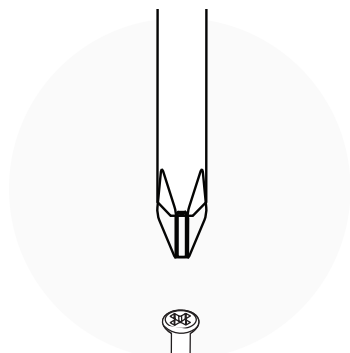

9

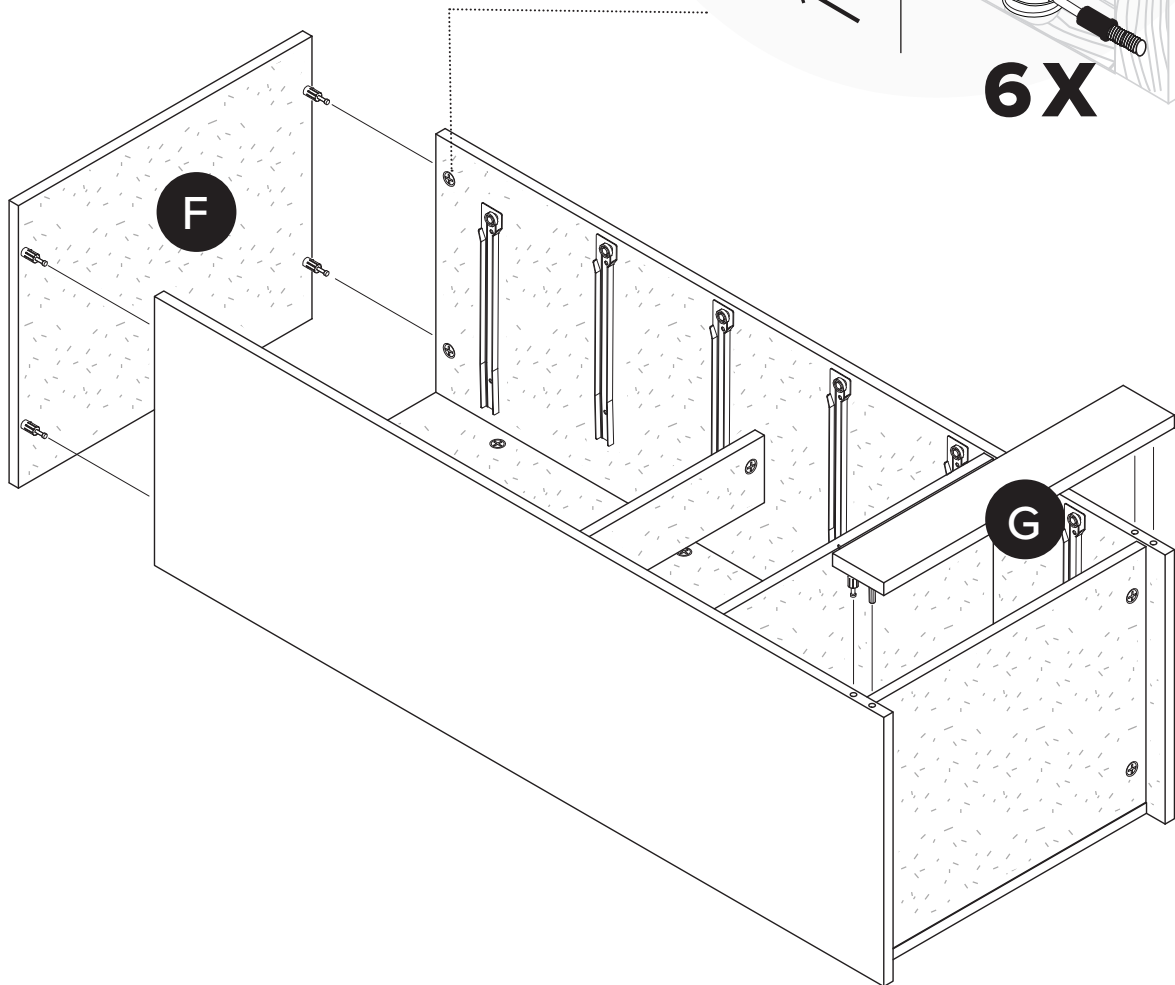
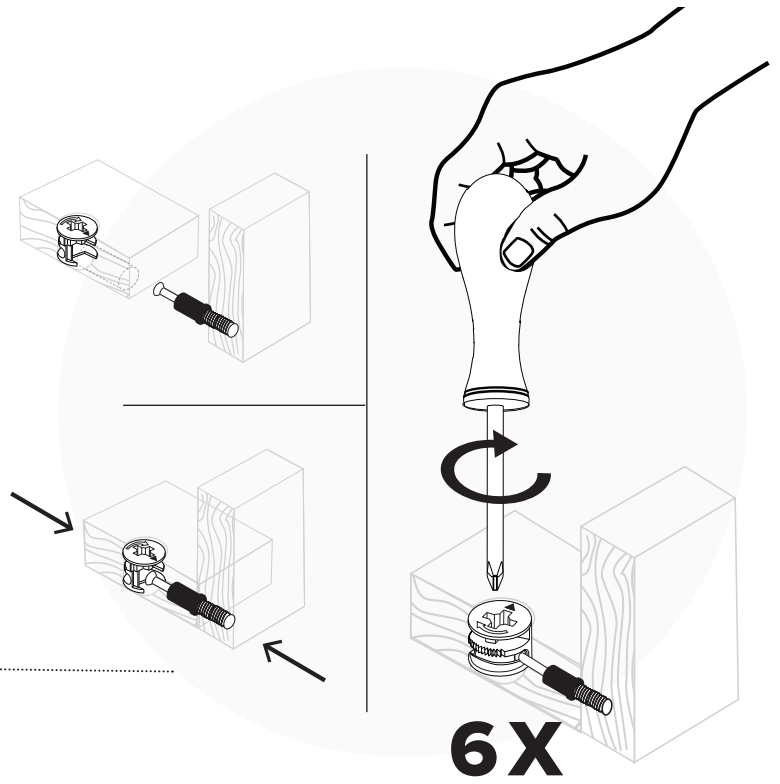

10

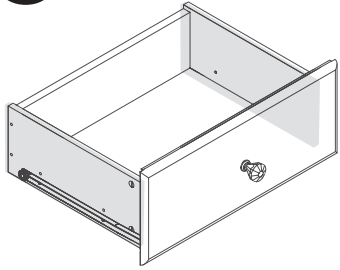

Large Drawers

4X  RM-0074

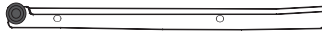
1X  Blue Wheel Slider (Drawer Side)

1X  Red Wheel Slider (Drawer Side)

Small Drawer

4X  RM-0074

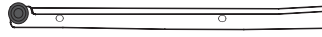
1X  Blue Wheel Slider (Drawer Side)

1X  Red Wheel Slider (Drawer Side)

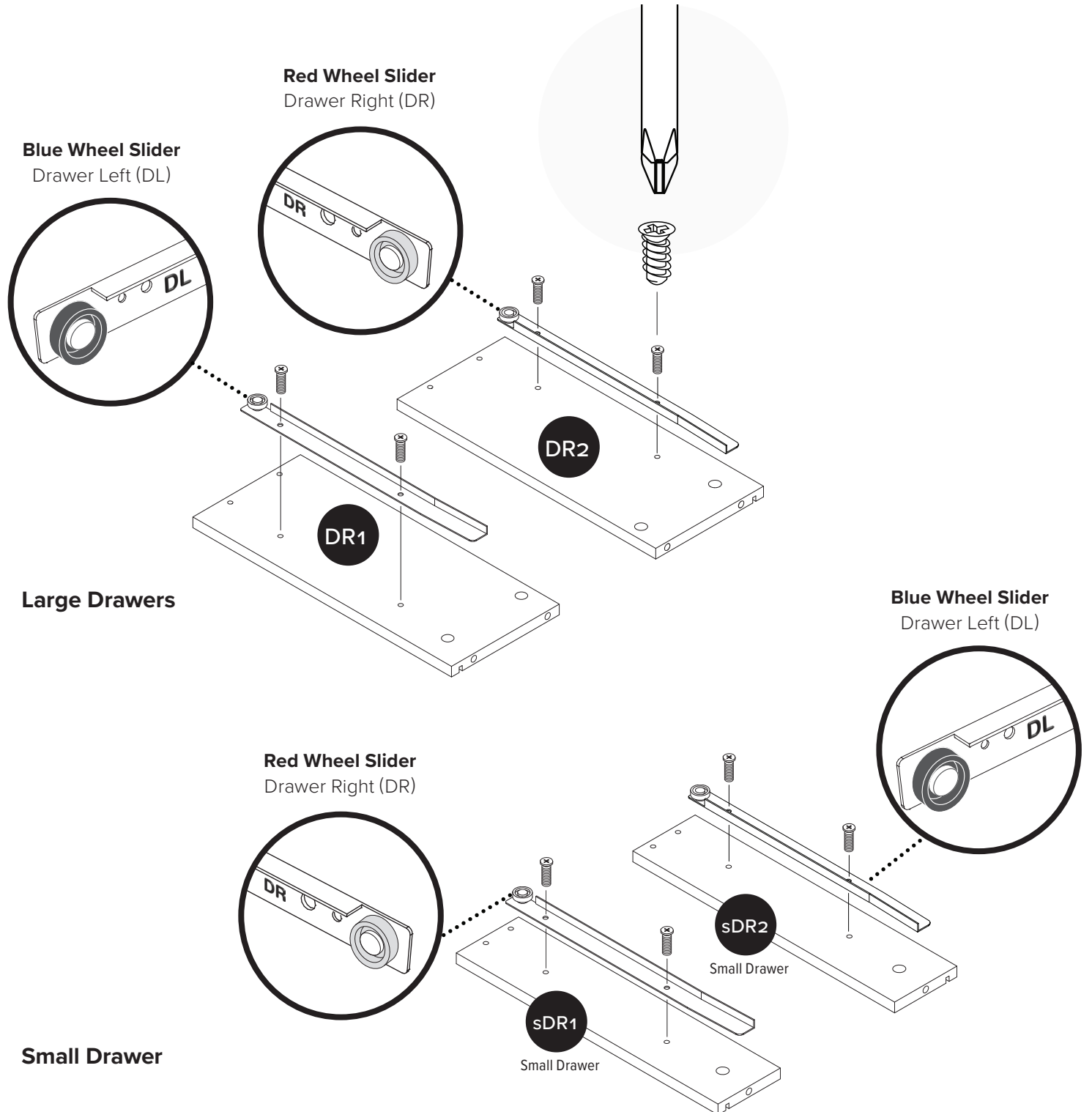

11

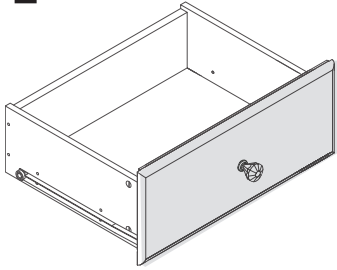

Large Drawers

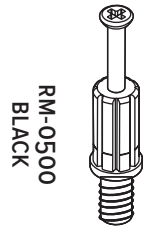

4X

Small Drawer



2X

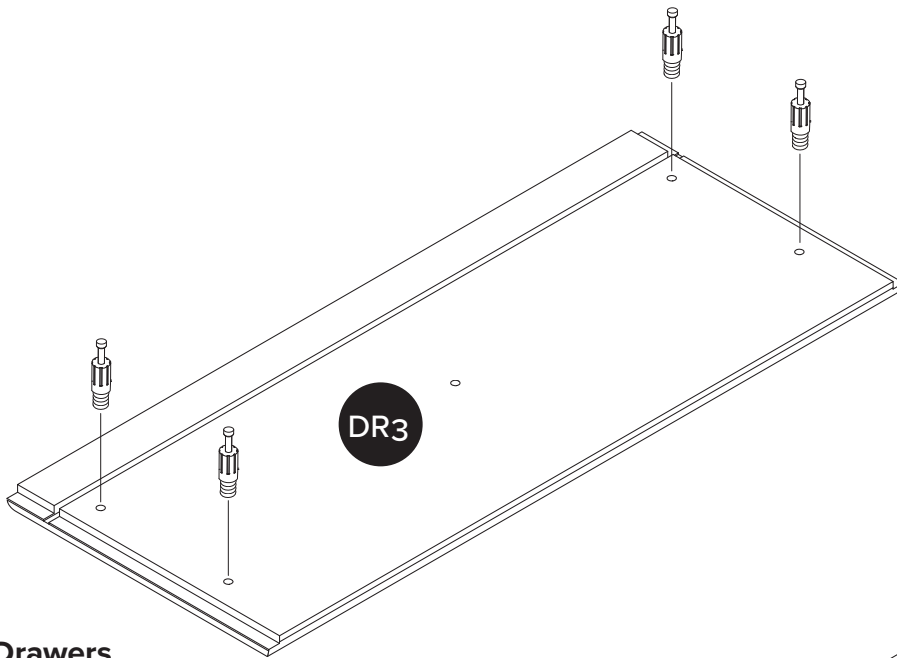

Large Drawers

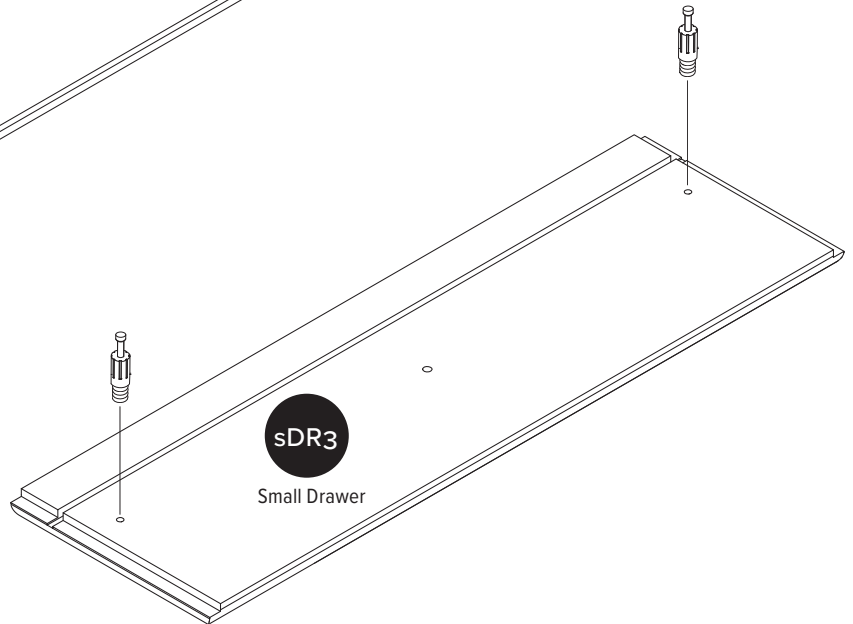
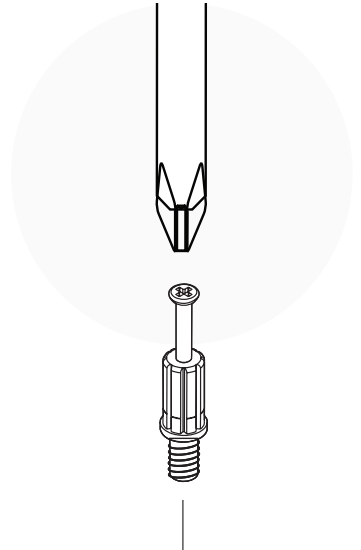

Small Drawer

Small Drawer

12

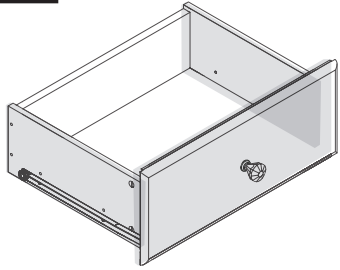

Large Drawers



4X

Small Drawer



2X

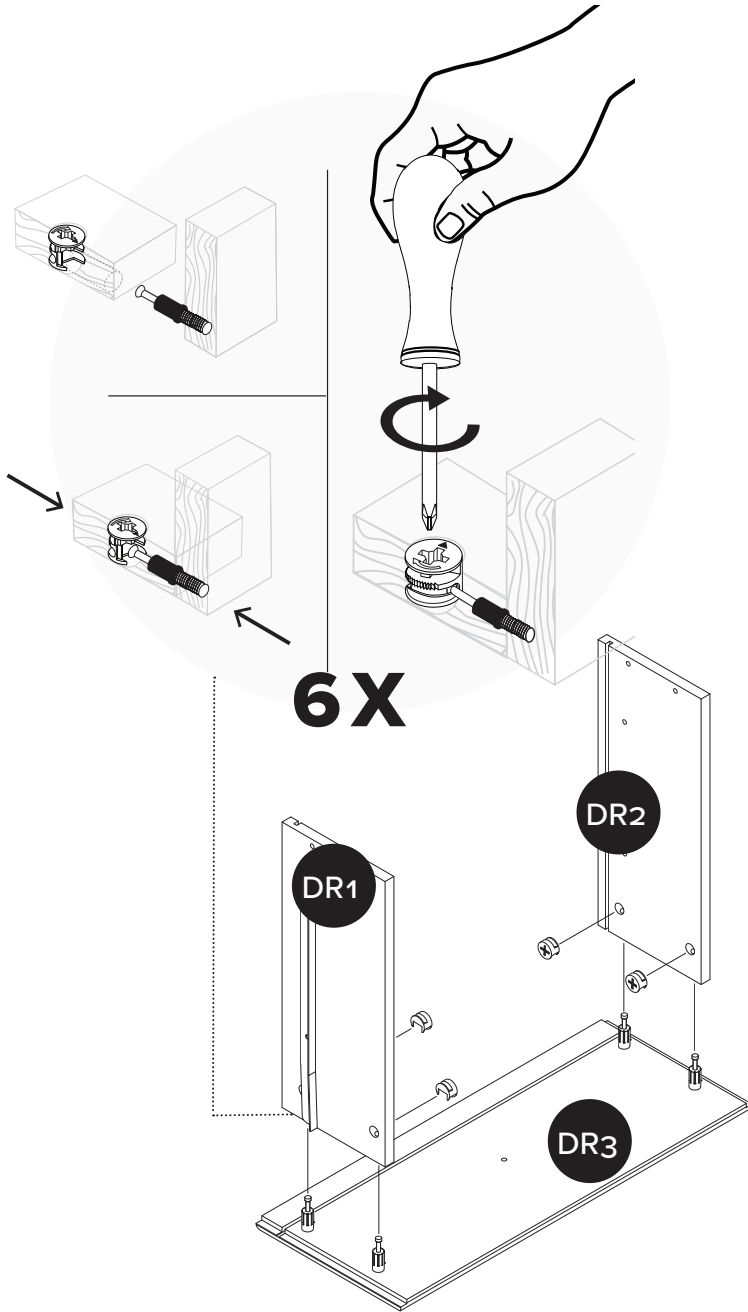

6X

Large Drawers

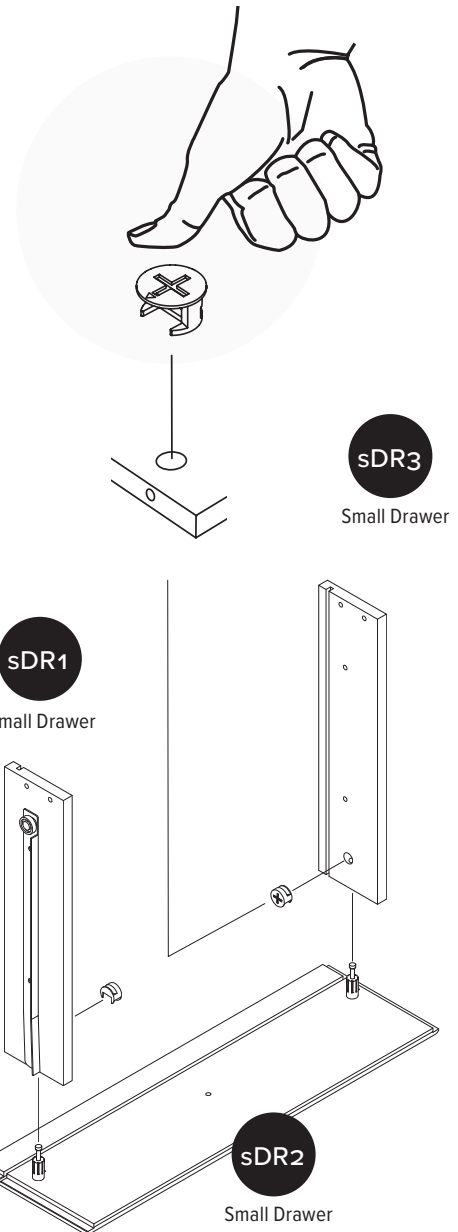

Small Drawer

13

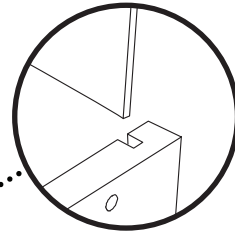
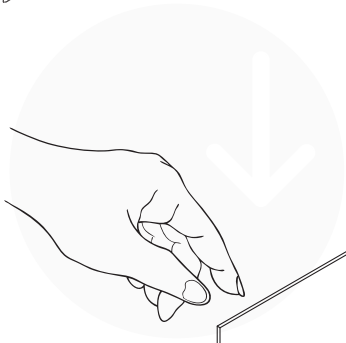
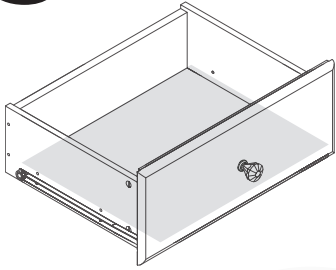

Large Drawers

DR4

sDR4

Small Drawer

Small Drawer

14

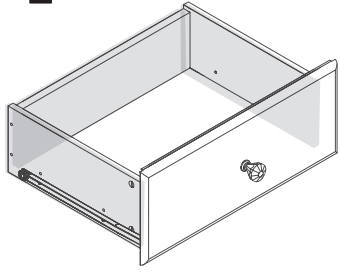

Large Drawers



4X

Small Drawer



4X

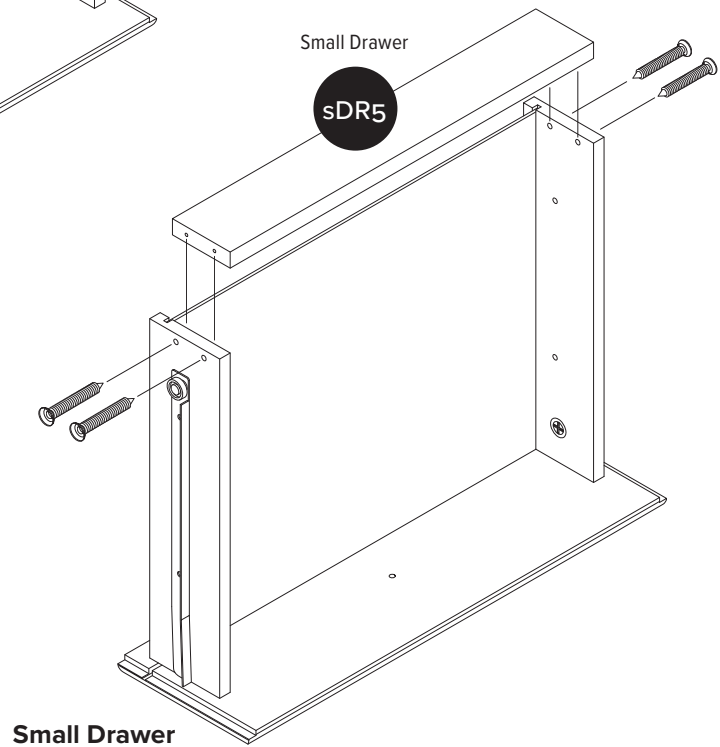
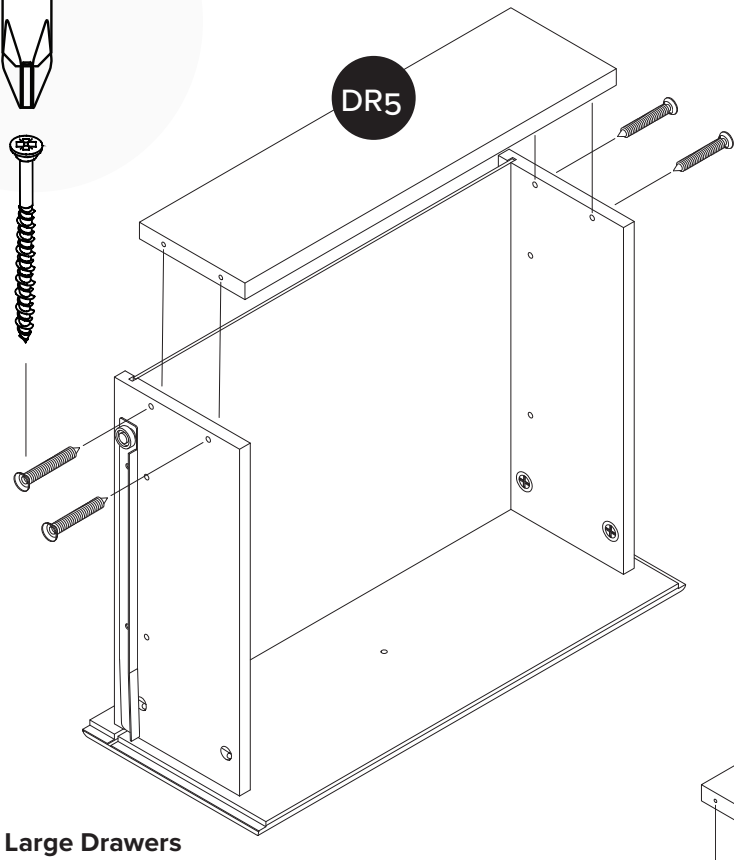
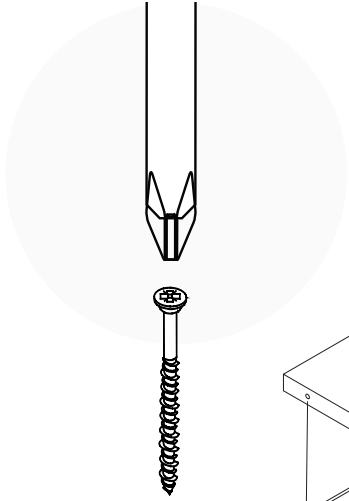

15

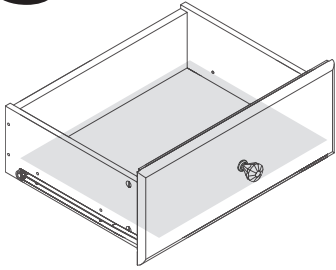

Large Drawers



5X

RM-0839

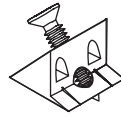

1X

Small Drawer



5X

RM-0839

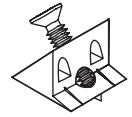

1X

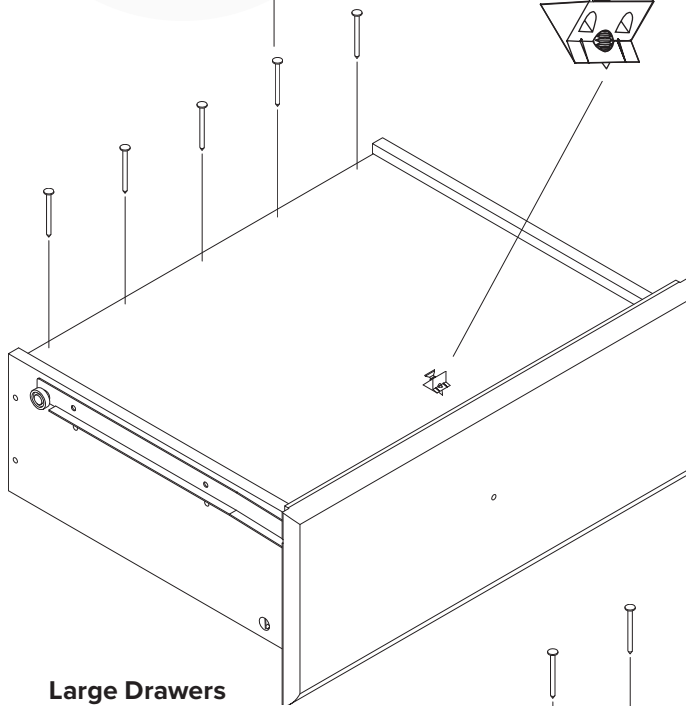
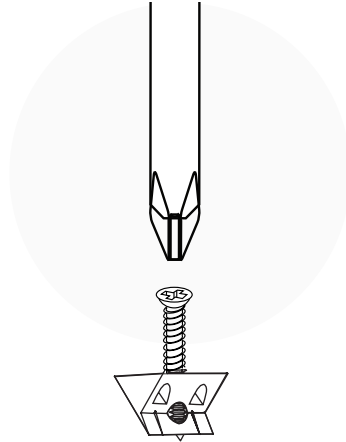
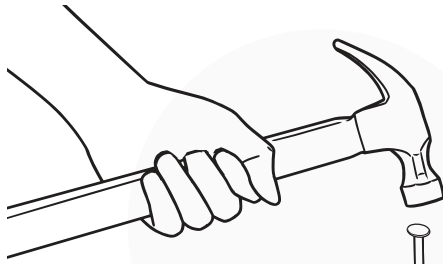

Large Drawers

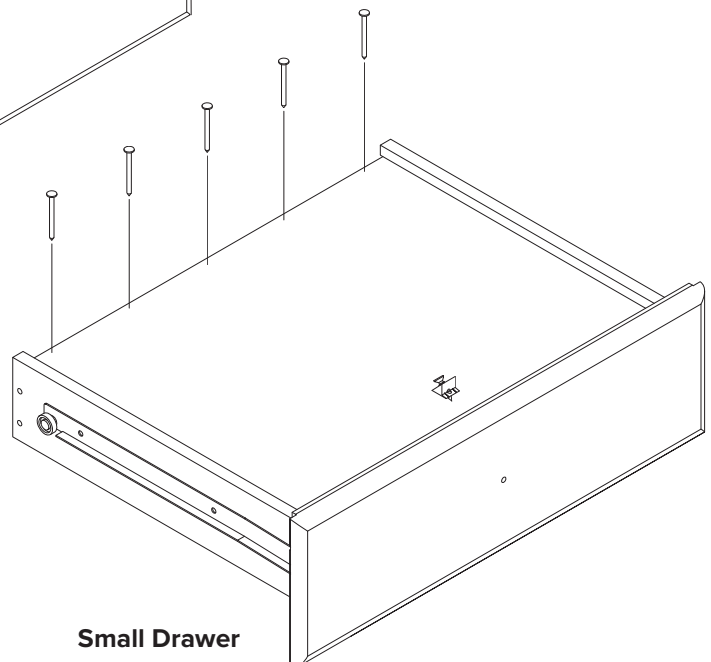

Small Drawer

16

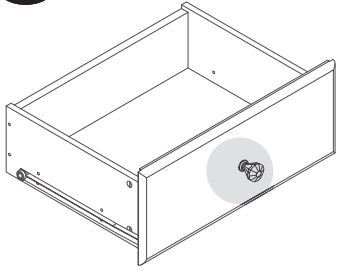

Large Drawers

RM-0971

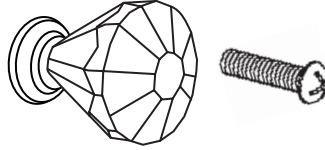

1X

Small Drawer

RM-0971

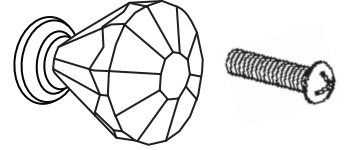

1X

▲ WARNING

Children have died from furniture tipover. To reduce the risk of furniture tipover:

- ALWAYS install tipover restraint provided.
- NEVER put a TV on this product.
- NEVER allow children to stand, climb or hang on drawers, doors, or shelves.
- NEVER open more than one drawer at a time.
- Place heaviest items in the lowest drawers.

This is a permanent label. Do not remove!

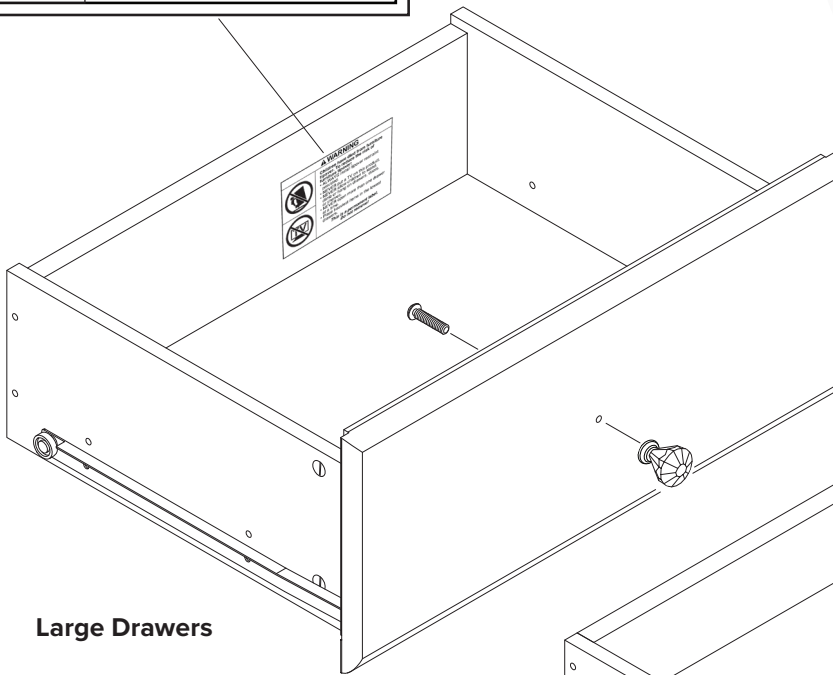

Large Drawers

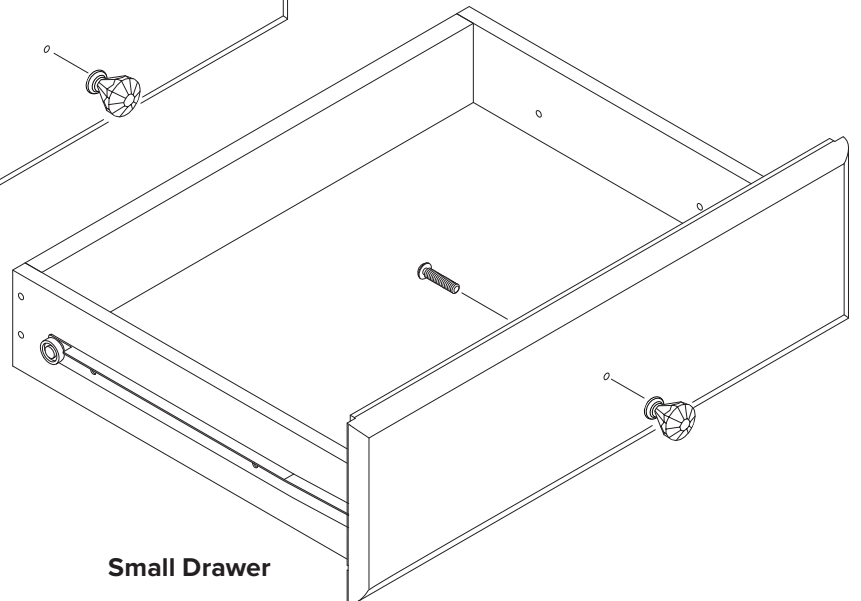
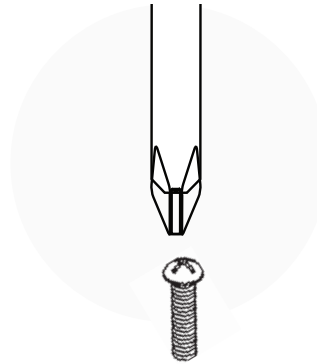

Small Drawer

5X

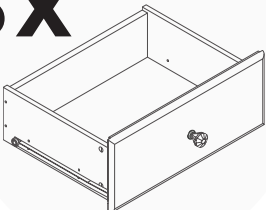

Large Drawers

Repeat step 10–16 for 5 Large drawers

Répétez les étapes 10–16 pour 5 grands tiroirs
Repita los pasos 10–16 para 5 cajones grandes.

17

Red Wheels for the right side

Roues rouges pour le côté droit

Ruedas rojas para el lado derecho

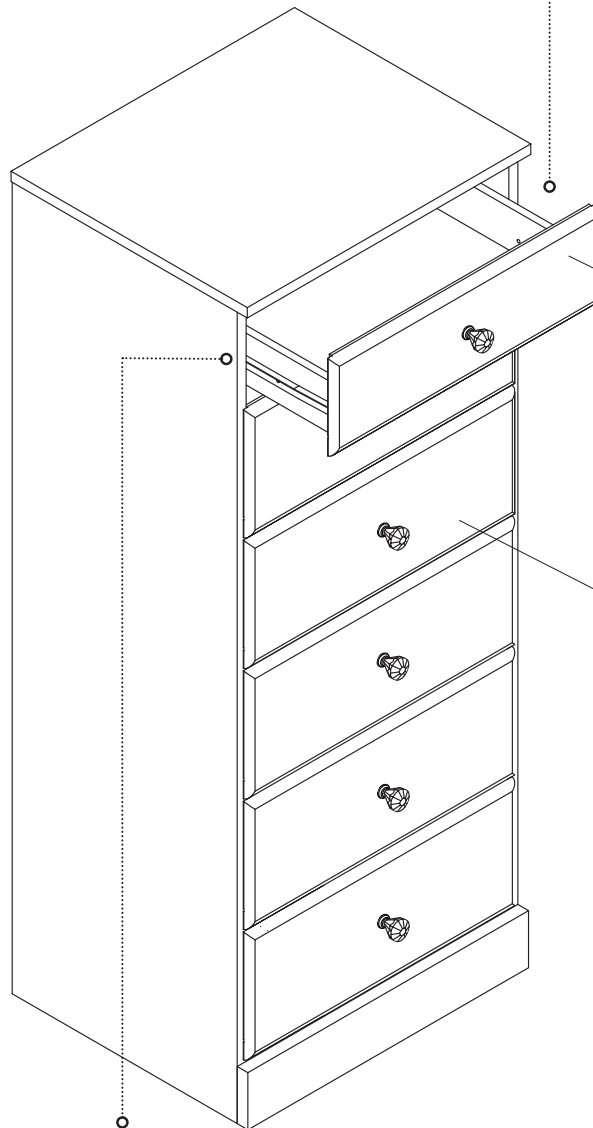
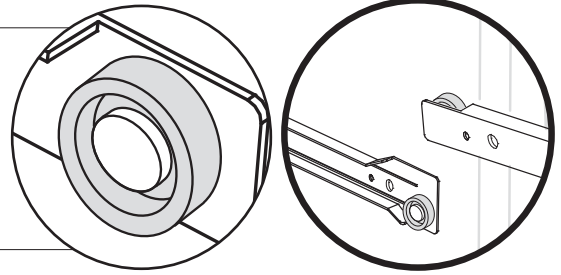

1X Small Drawer

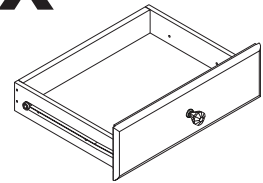

5X Large Drawers

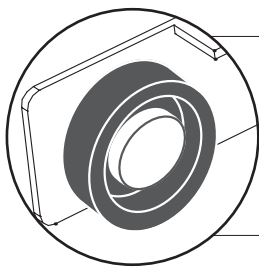
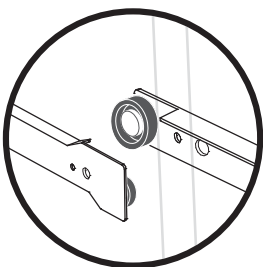
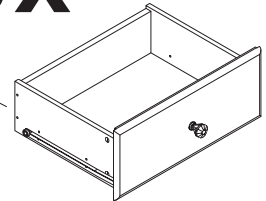

Blue Wheels for the left side

Roues bleues pour le côté gauche

Ruedas azules para el lado izquierdo

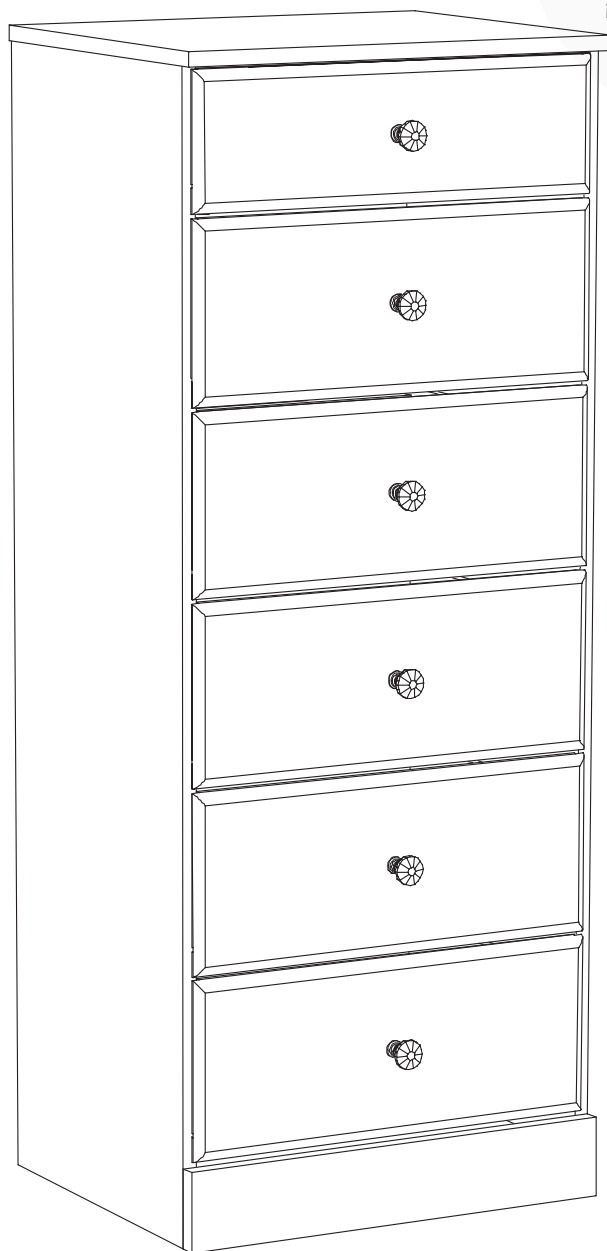

All done!
Good job!

Tout est fait! Bon travail!

¡Todo listo! ¡Buen trabajo!

Tipover Restraint Device

Fixation du dispositif de retenue
Instalando la correa de seguridad

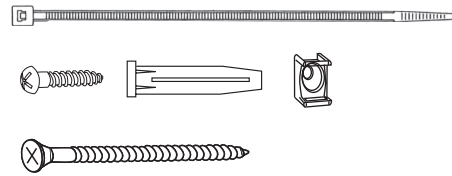

HP-1088-LB

Safety Notice

We recommends anchoring furniture in homes where children live or visit and has included an easy to install safety device. Please make sure that it is installed according to the following instructions.

Noticia de seguridad

recomienda anclar muebles en hogares donde viven niños o ellos visitan. ha incluido un dispositivo de seguridad de facil instalacion. Por favor seguese de que esta instalado de acuerdo a las siguientes instrucciones.

Avis de sécurité

recommande l'ancrage des meubles dans les domiciles où habitent ou visitent des enfants, d'où l'inclusion d'un dispositif de sécurité facile à installer. Veuillez vous assurer que ce dernier est installé conformément aux présentes instructions.

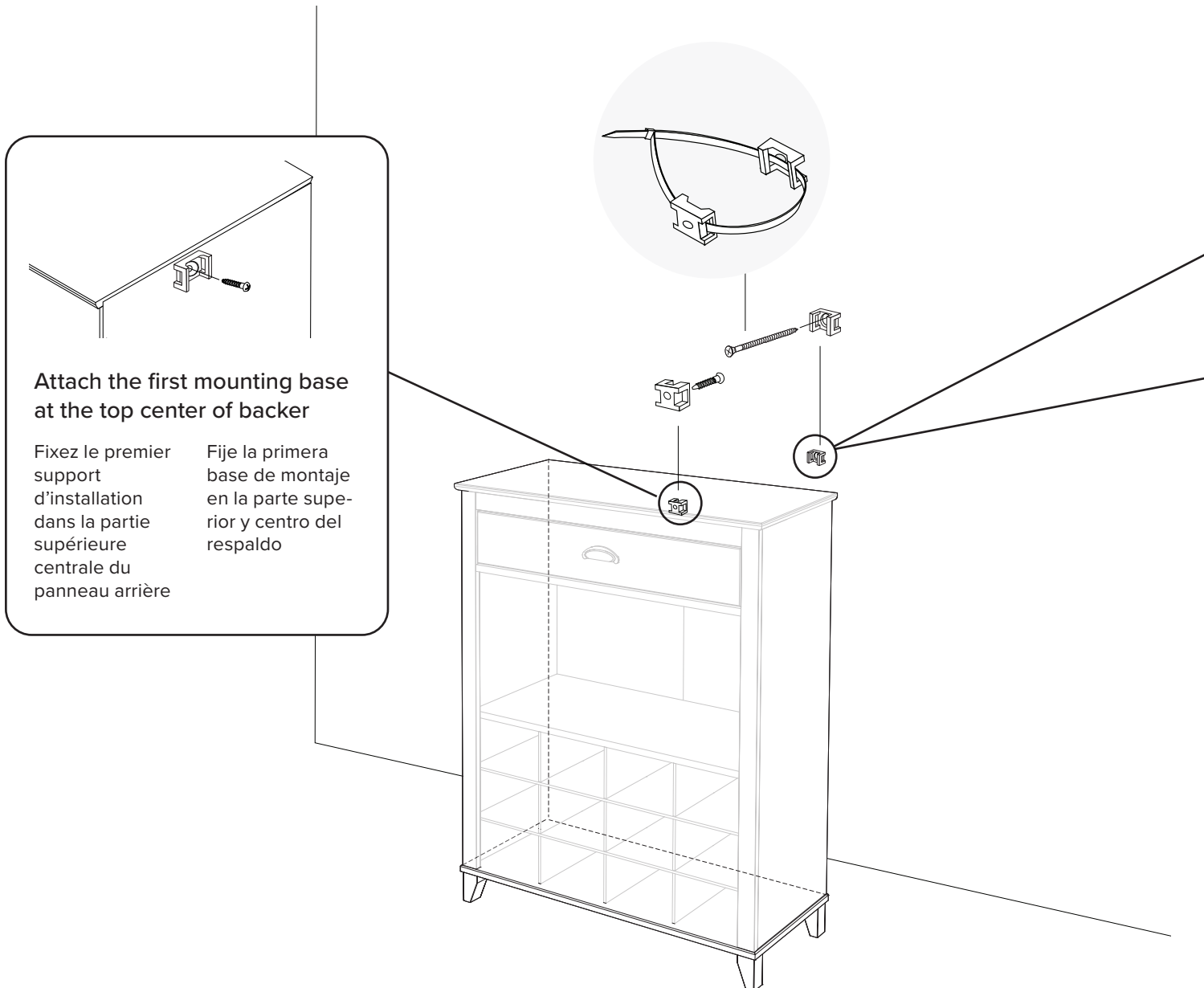

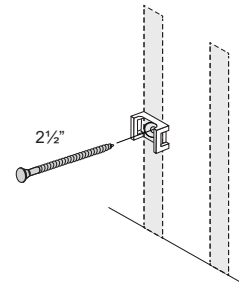
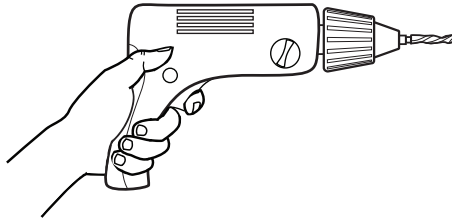
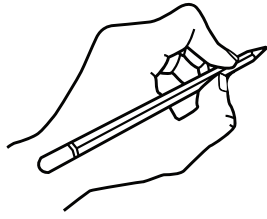

For walls constructed of wood with drywall

Pour les murs en cloison sèche avec montants en bois
Para paredes construidas de madera con paneles prefabricados

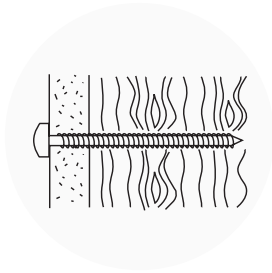

1. With a pencil mark location of second mounting base position
2. Drill pilot hole using an 1/8 inch drill bit 2 inches deep
3. Attach mounting base to wall using the 2 1/2 inch screw provided

1. À l'aide d'un crayon, marquez l'emplacement du deuxième support
2. Percez un avant-trou de 2 po de profondeur avec une mèche de 1/8 po
3. Vissez le support dans le mur à l'aide des vis de 2 1/2 po fournies

1. Con un lápiz marcar la ubicación de la segunda base de montaje
2. Perforar el agujero usando una broca de 1/8 pulgadas 2 pulgadas de profundidad
3. Montar el soporte a la pared utilizando los 2 tornillos de 2 1/2 pulgadas proporcionados

For walls constructed of drywall (unable to hit a stud)

Pour les murs en cloison sèche (où il est impossible de visser dans un montant en bois)
Para muros construidos de drywall (Sin travesaño)

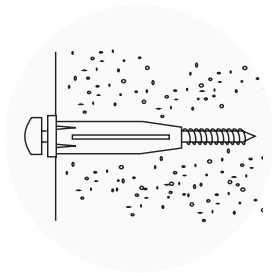

1. Drill pilot hole using a 5/16 inch drill bit only to the depth of drywall thickness
2. Using a rubber mallet or hammer insert wall anchor into drywall
3. Attach holder to wall anchor using 2 1/2 inch screw provided

1. Percez un avant-trou à l'aide d'une mèche de 5/16 po sans dépasser la profondeur de la cloison sèche
2. À l'aide d'un maillet en caoutchouc ou d'un marteau, insérez l'ancrage mural dans la cloison sèche
3. Vissez le support dans l'ancrage mural à l'aide des vis de 2 1/2 po fournies

1. Perforar el agujero utilizando una broca de 5/16 pulgadas solo a la profundidad del grosor del panel de yeso
2. Utilizando un martillo de goma o un martillo insertar el anclaje en pared de yeso
3. Fije el soporte de anclaje a la pared utilizando el tornillo de 2 1/2 pulgadas incluido

For walls constructed of concrete

Pour les murs en béton
Para muros construidos de hormigón

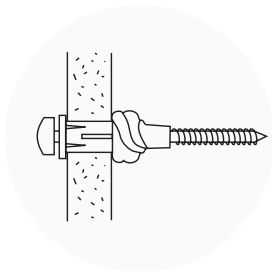

1. Drill pilot hole using a 5/16 inch drill bit 2 3/4 inches deep
2. Using a rubber mallet or hammer insert wall anchor into predrilled hole
3. Attach holder to wall anchor using 2 1/2 inch screw provided

1. Percez un avant-trou de 2 3/4 po de profondeur avec une mèche de 5/16 po
2. À l'aide d'un maillet en caoutchouc ou d'un marteau, insérez l'ancrage mural dans le trou
3. Vissez le support dans l'ancrage mural à l'aide des vis de 2 1/2 po fournies

1. Perforar un agujero de 2 3/4 de profundidad utilizando una broca de 5/16 pulgadas
2. Utilizando un martillo de goma o un martillo insertar el anclaje en el agujero preperforado
3. Fije el soporte de anclaje a la pared utilizando el tornillo de 2 1/2 pulgadas incluido

Tall 6-drawer Dresser

