

ASSEMBLY INSTRUCTIONS

Important Safety Instructions:

- Please read all instructions before beginning assembly
- Please make sure receive all the parcels to start the assembly
- For your safety and convenience, assembly by two people is recommended
- Use the parts and hardware lists to identify and separate each of the components included
- Save all packing materials until assembly is completed to avoid the accidental discarding of smaller parts or hardware
- Use of power tools is not recommended

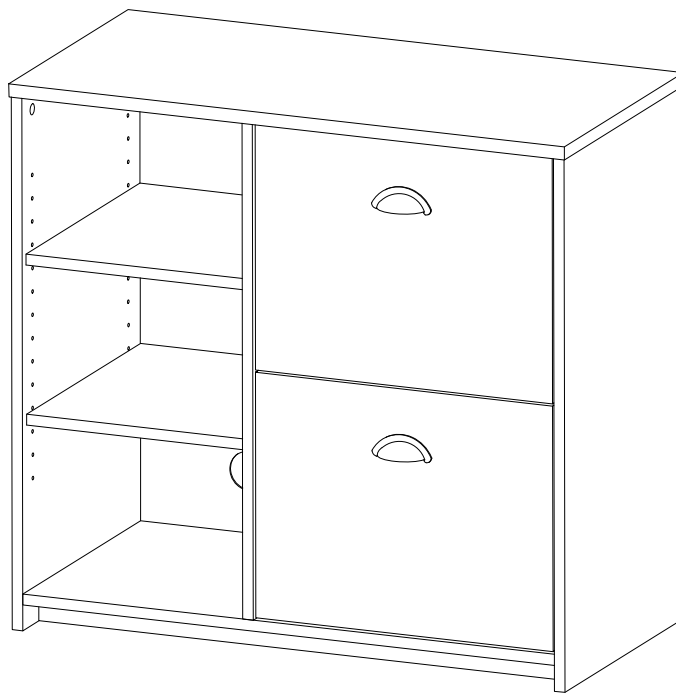

THANK YOU FOR PURCHASING

PARTS LIST

① X1	② X1	③ X1	④ X1	⑤ X1
⑥ X2	⑦ X1	⑧ X1	⑨ X2	⑩ X2
⑪ X2	⑫ X2	⑬ X2		

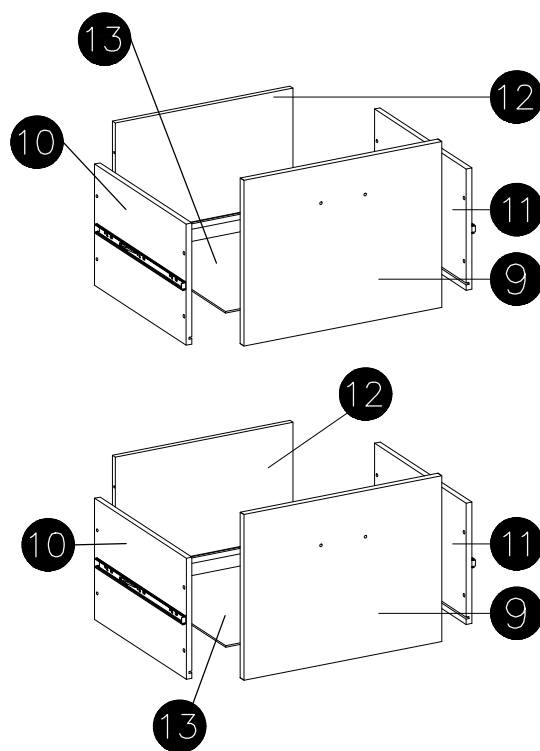
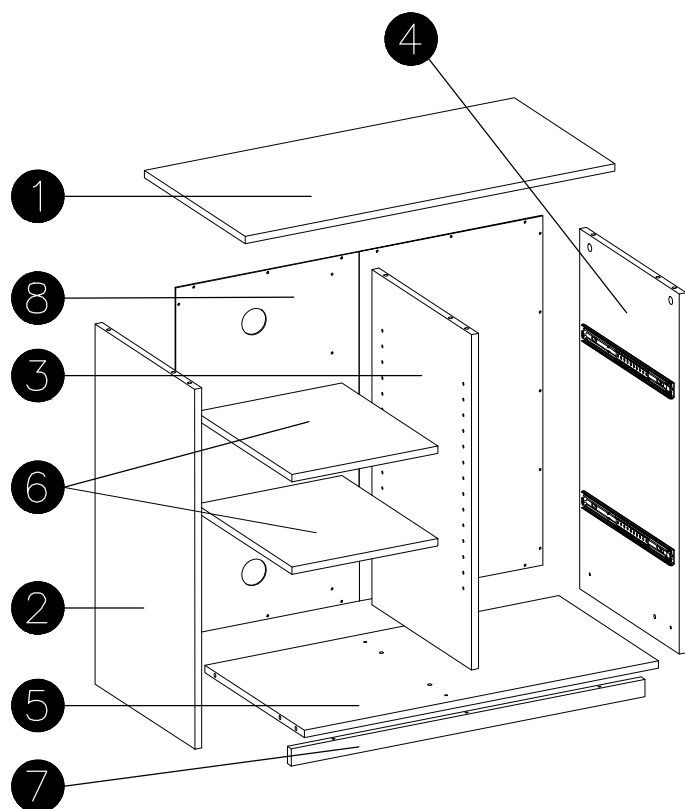

STEP 1

A x6pcs

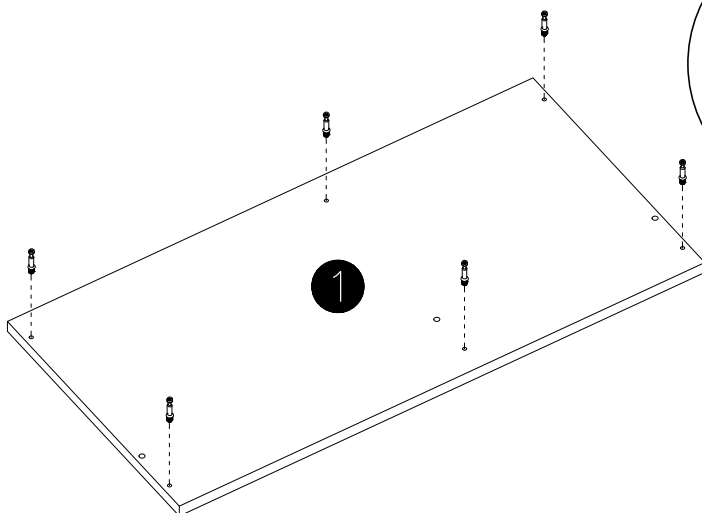
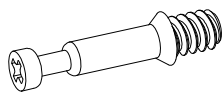

STEP 2

C x2pcs



A x4pcs

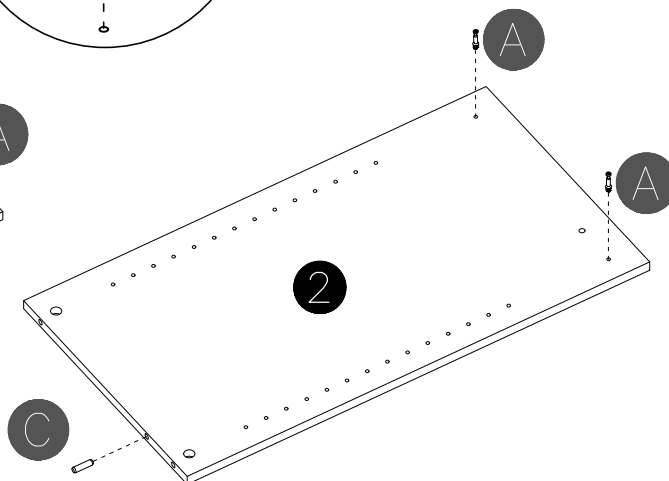
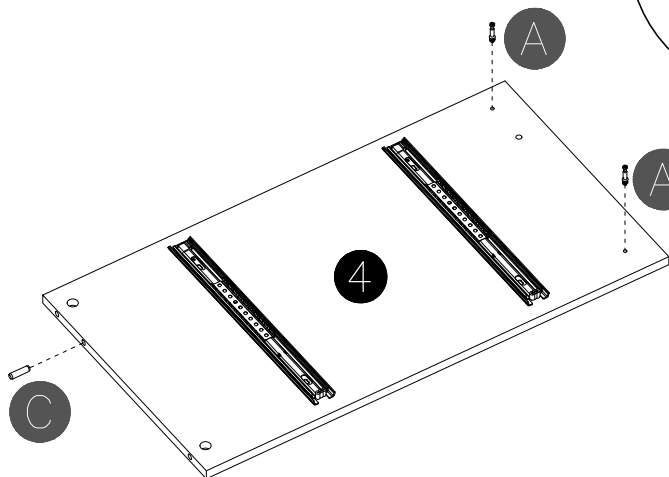
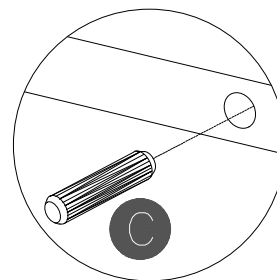
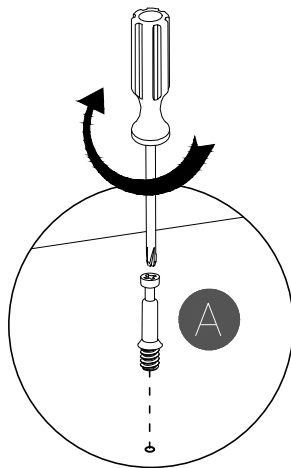
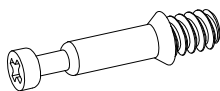

STEP 3

C x4pcs 

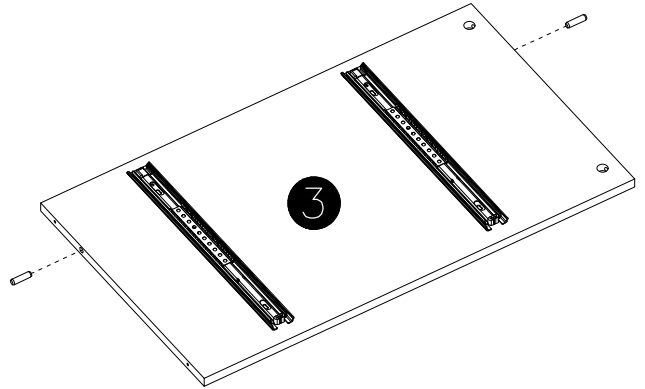
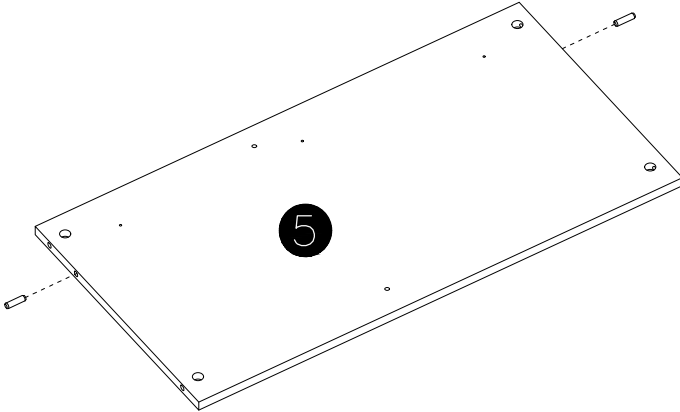
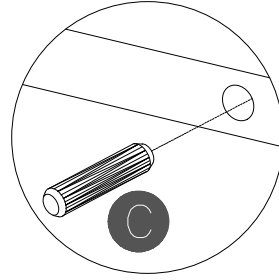

STEP 4

B x2pcs 

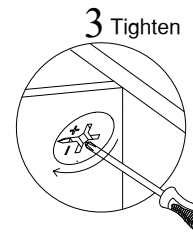
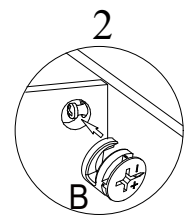
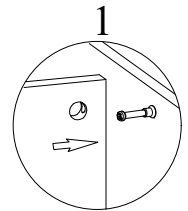
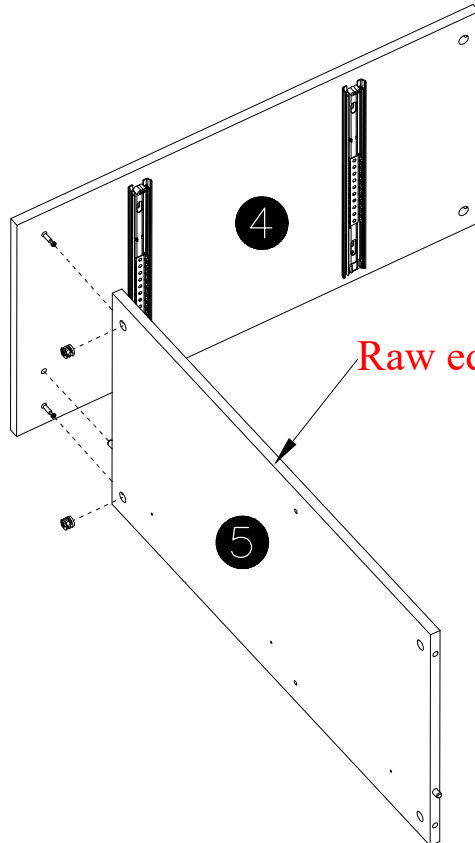

3 Tighten

STEP 5

B x2pcs

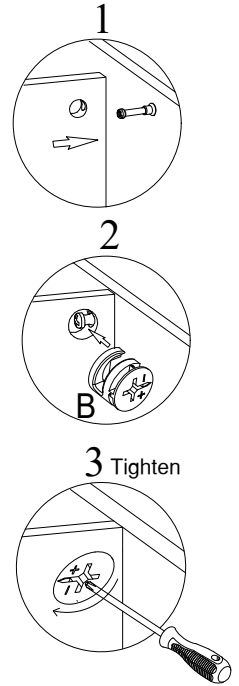
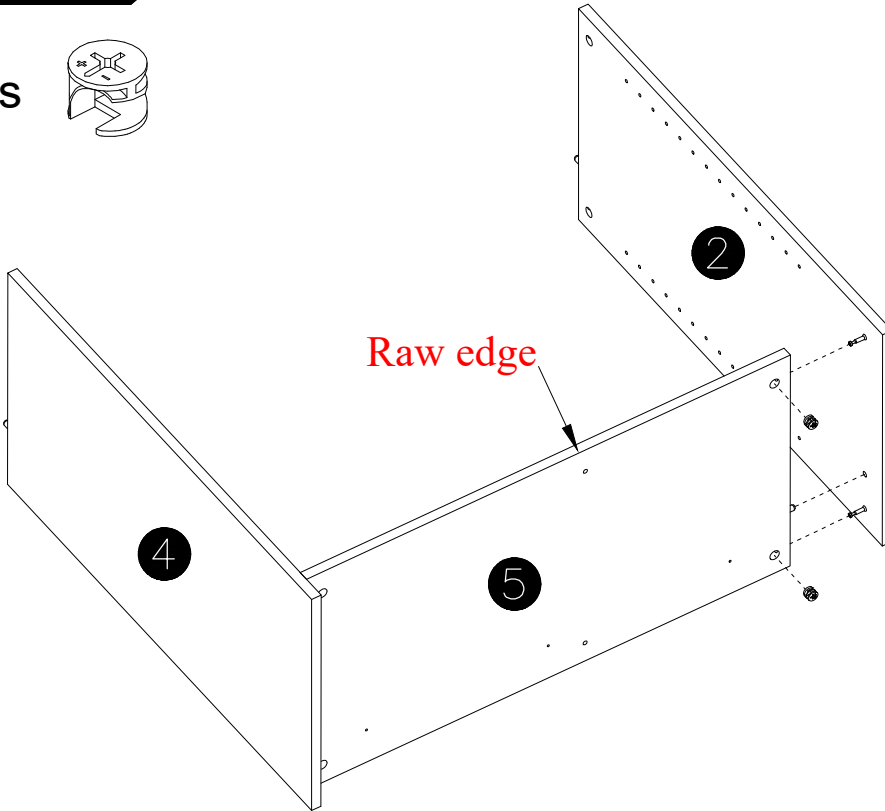

STEP 6

K x2pcs

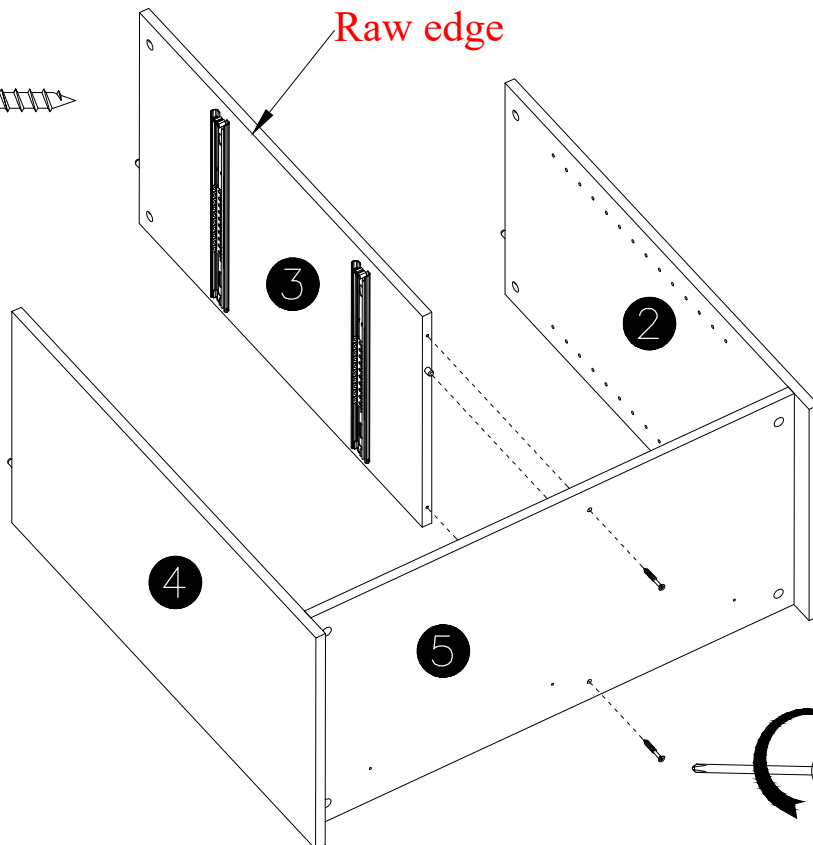
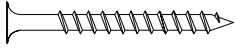

STEP 7

B x6pcs

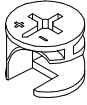

Q x2pcs

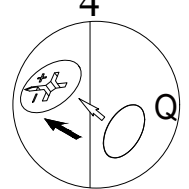
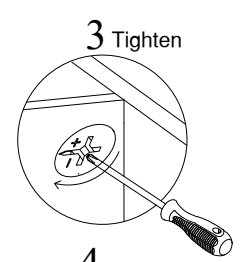
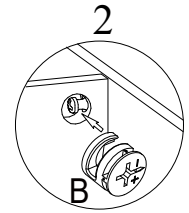
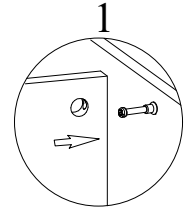
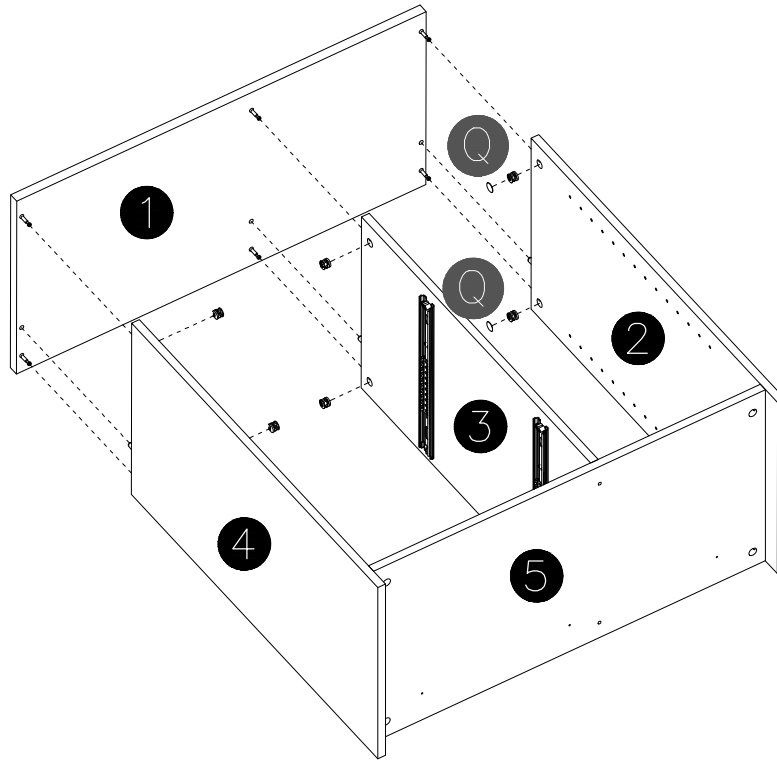

STEP 8

M x3pcs



1-1/2" Screw

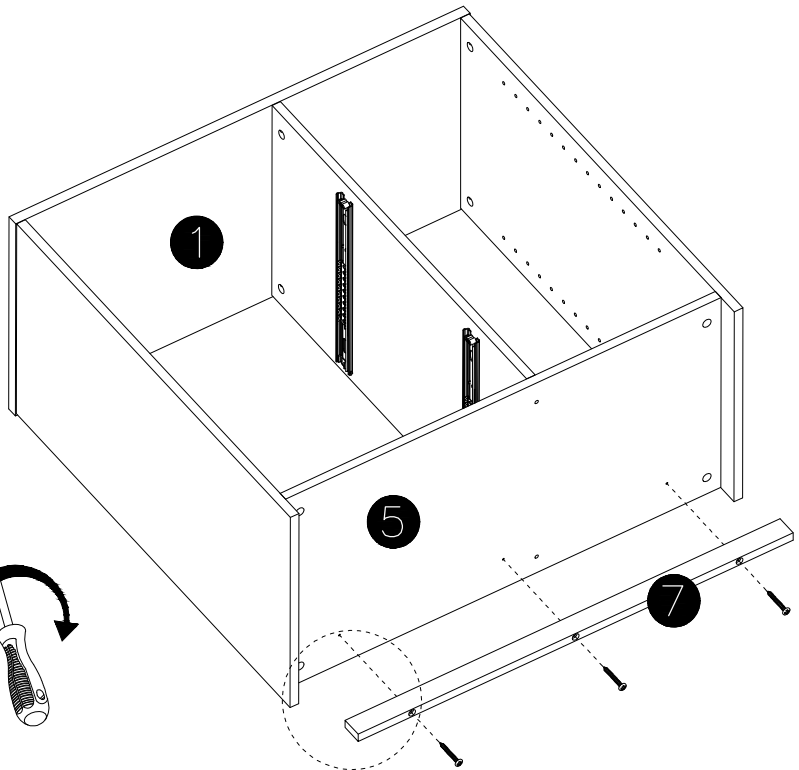
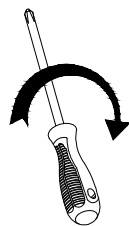
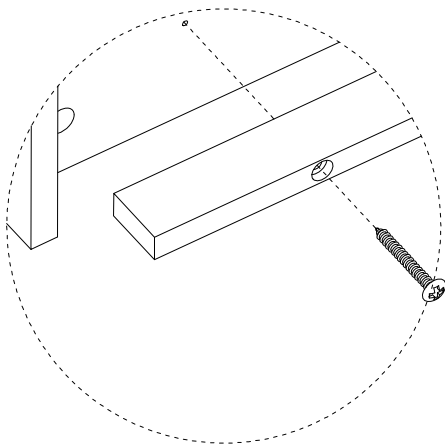

STEP 9

N x22pcs 

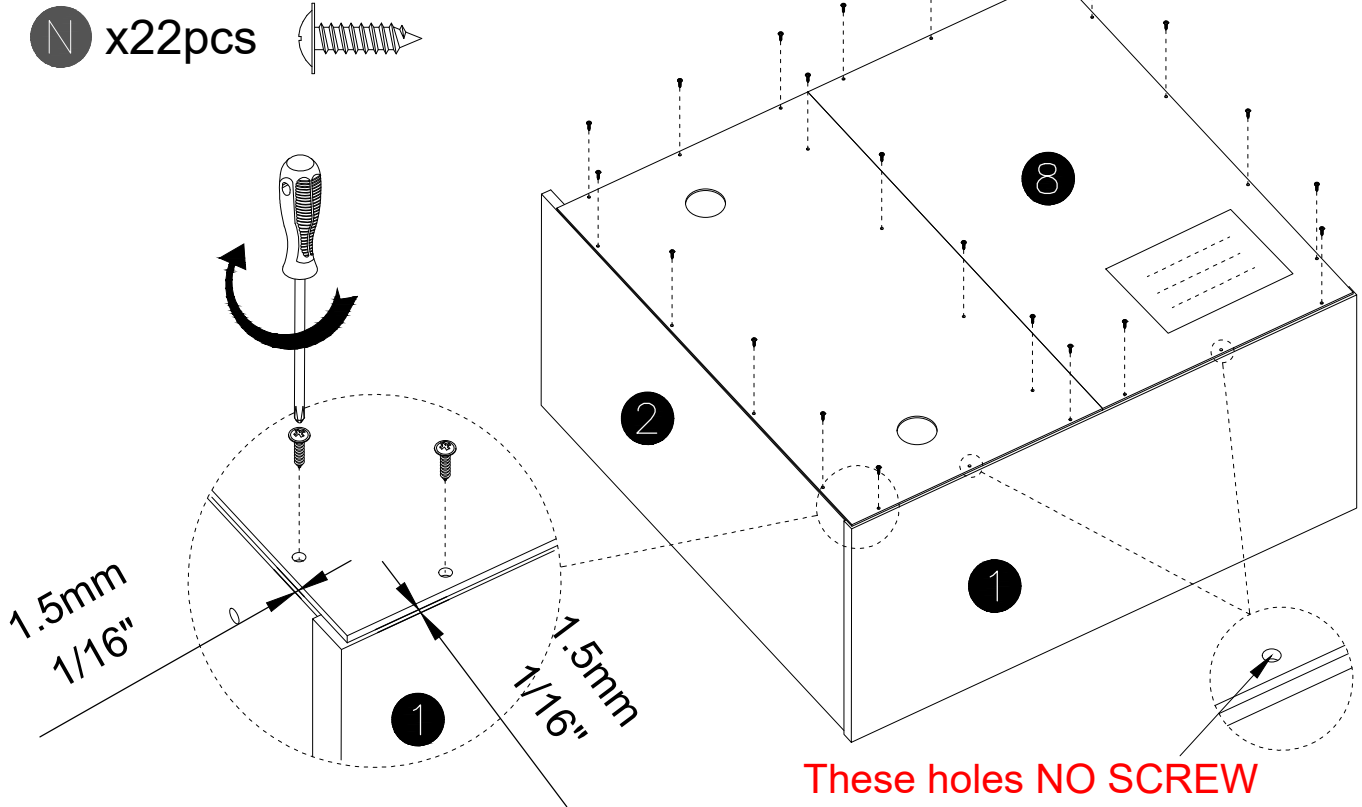

These holes NO SCREW

STEP 10

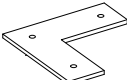
R x4pcs 

S x2pcs 

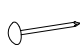
T x18pcs 

Peel off the adhesive sticker's protective paper and bond it onto the designated position before secure with nails.

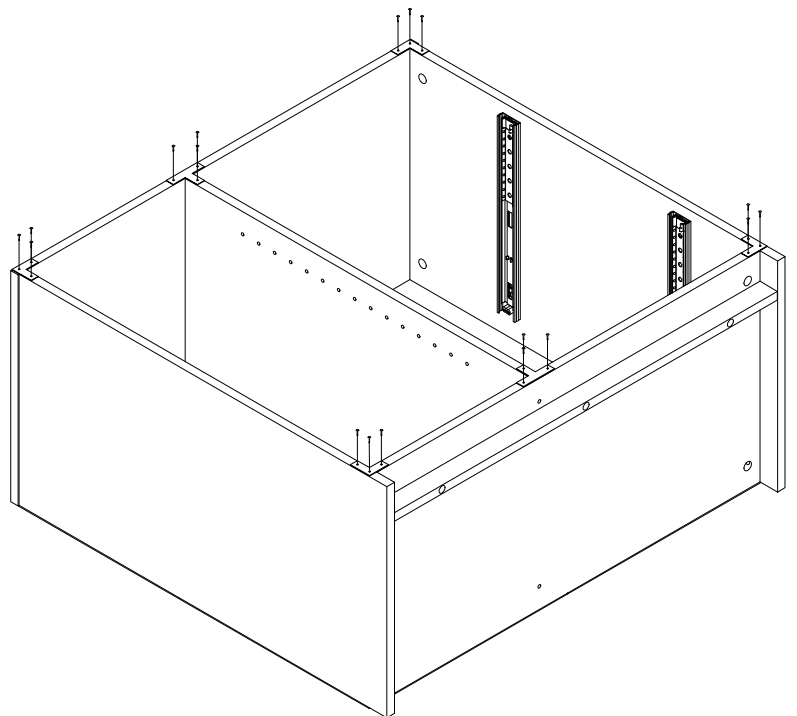
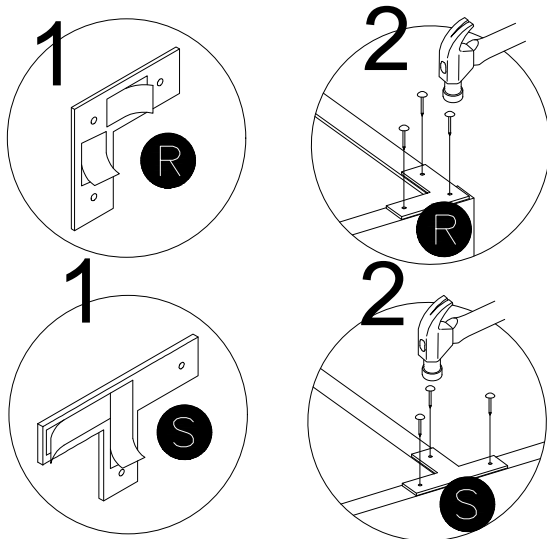

STEP 11

With assistant carefully stand unit up.

E x8pcs 

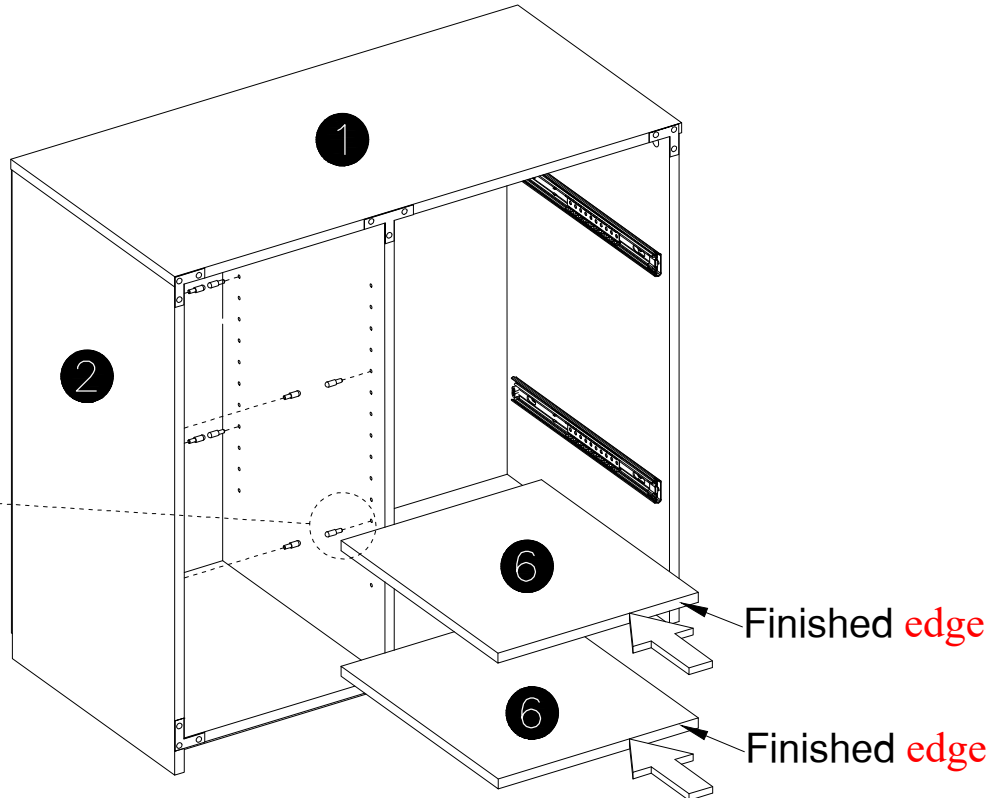
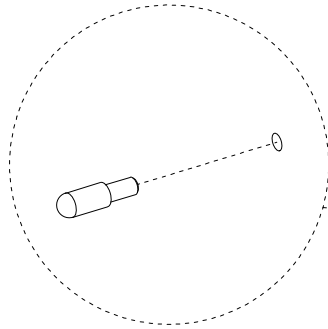

STEP 12

D x4pcs 

O x8pcs 

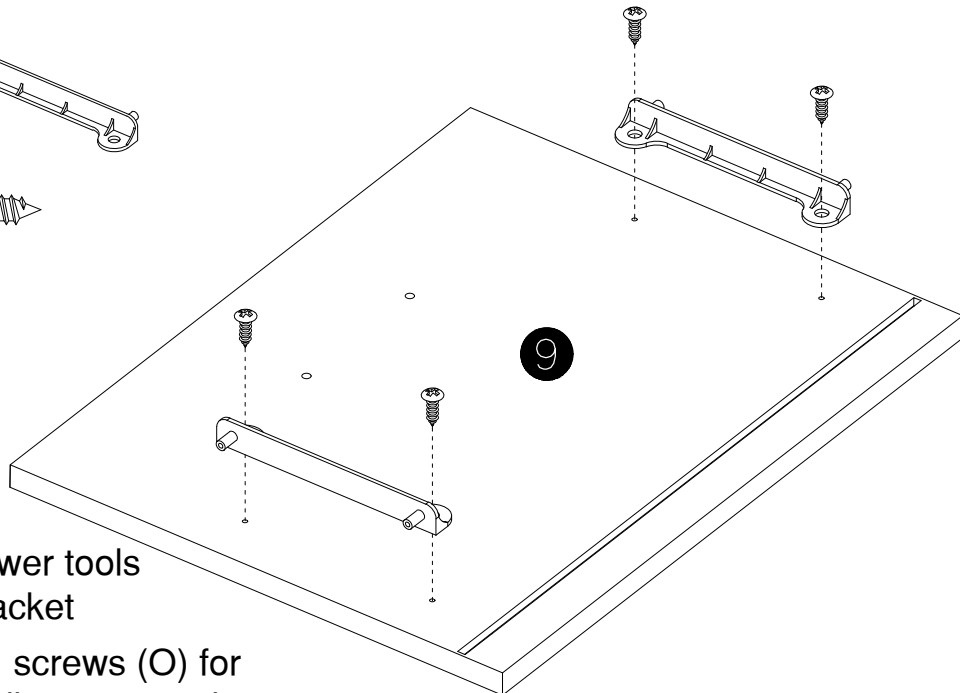

Do not use power tools
for Drawer Bracket

Do not tighten screws (O) for
drawer front adjustment on later step

x2

STEP 13

P x8pcs 

Do not use power tools
for Drawer Bracket

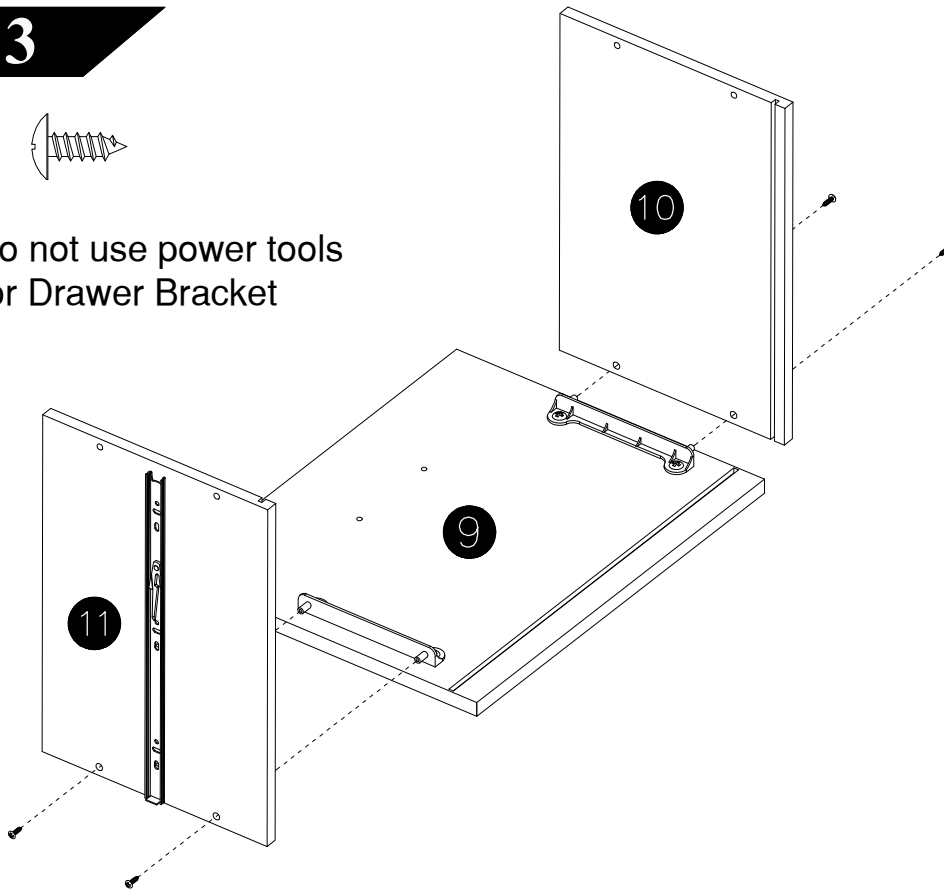

x2

STEP 14

L x8pcs 

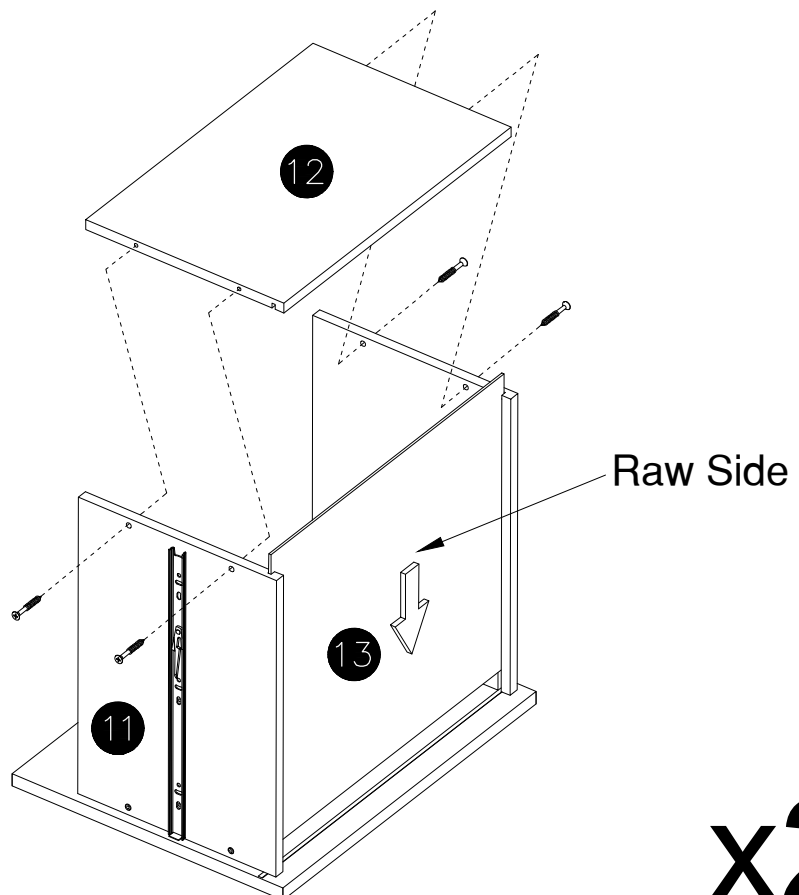

x2

STEP 15

F x2pcs 

G x4pcs 

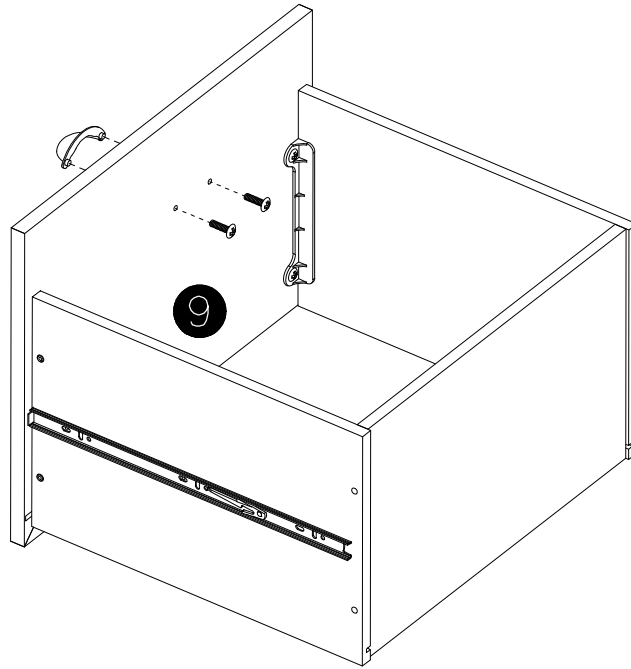

x2

STEP 16

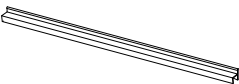
H x2pcs 

I x4pcs 

J x2pcs 

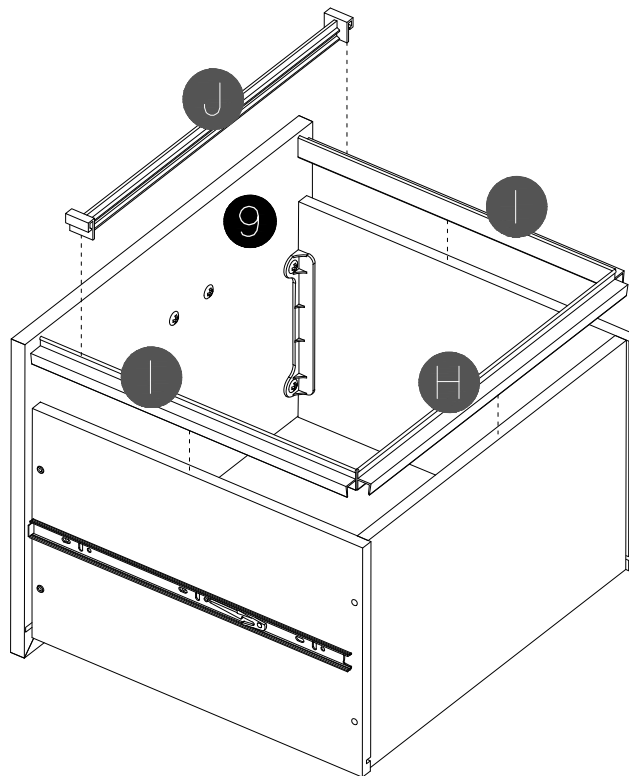

x2

STEP 17

-Move unit to final location.
-Adjust drawer fronts as shown below.

Step1--Loosen screws on back of drawer front brackets as shown.

Step2--Position drawer front as required.

Step3--Tighten screws while holding drawer front in position.

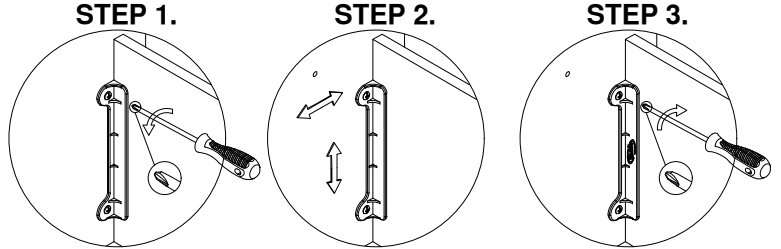
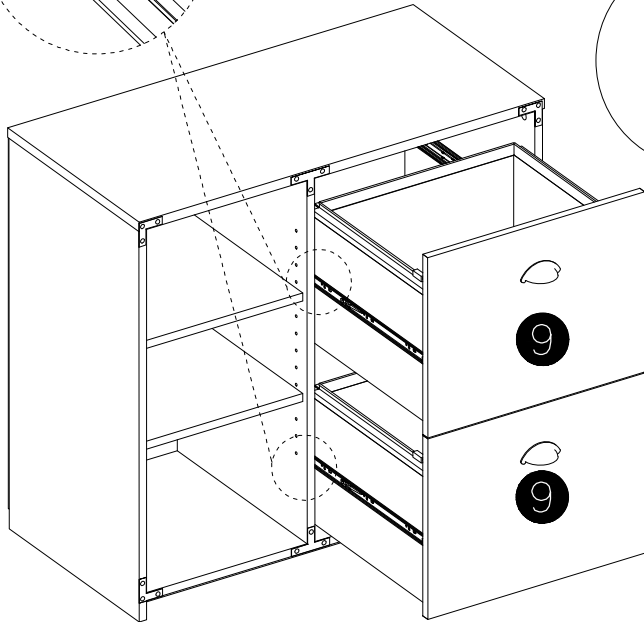
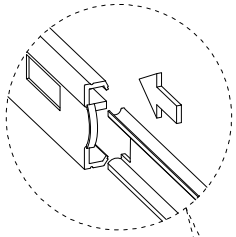

DRAWER FRONT VIEW

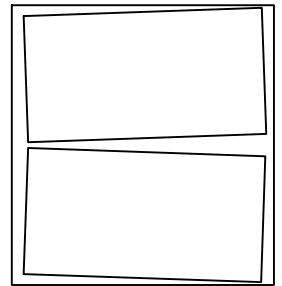
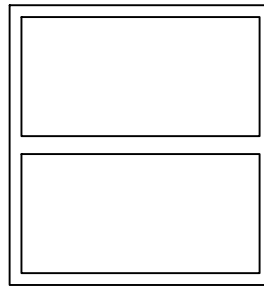

STEP 18

U₂ x2pcs

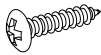

U₃ x2pcs

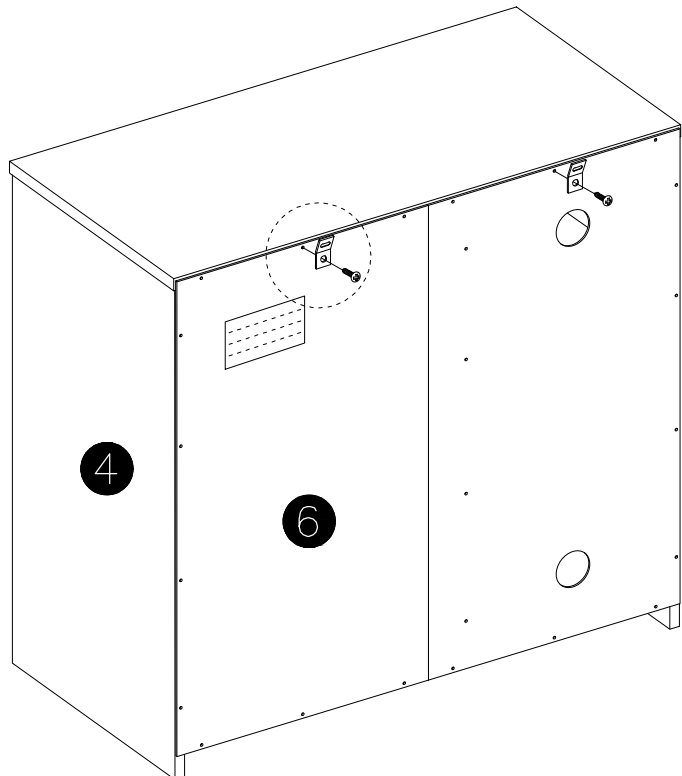
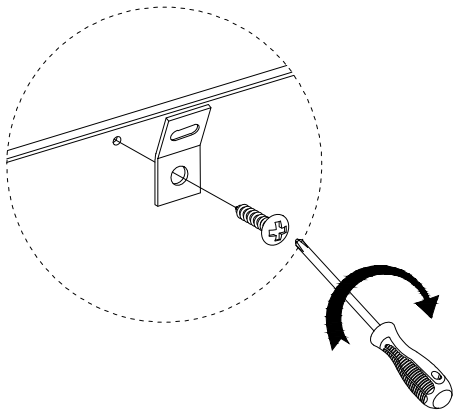
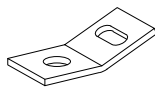

STEP 19

U₄ x2pcs

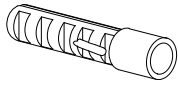

1. Place unit in desired location.
2. Mark stud location on the wall, 1" below top and side of unit.
3. Drill 5/16" hole 2" deep at marks on the wall.

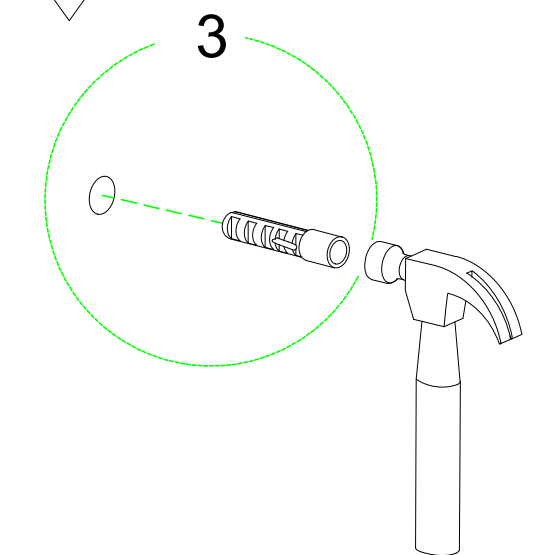
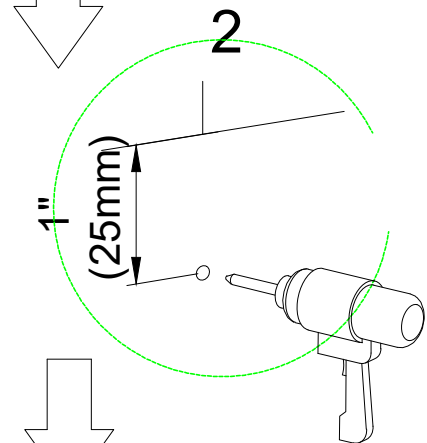
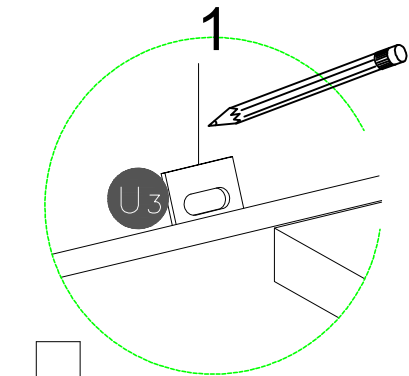
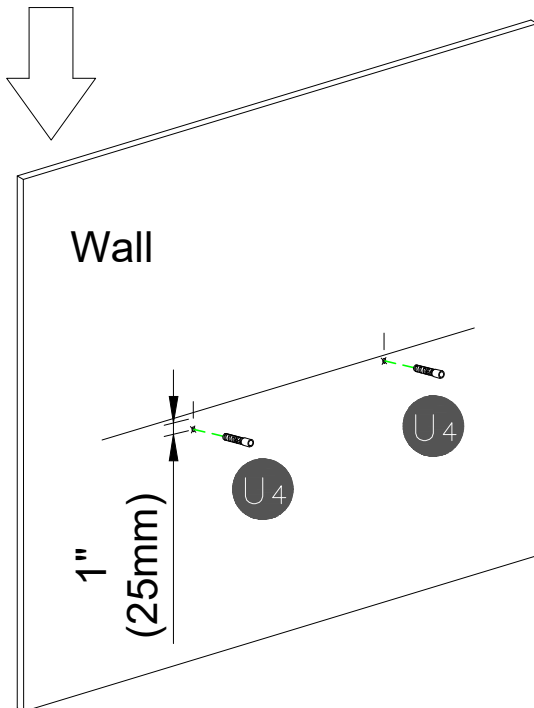
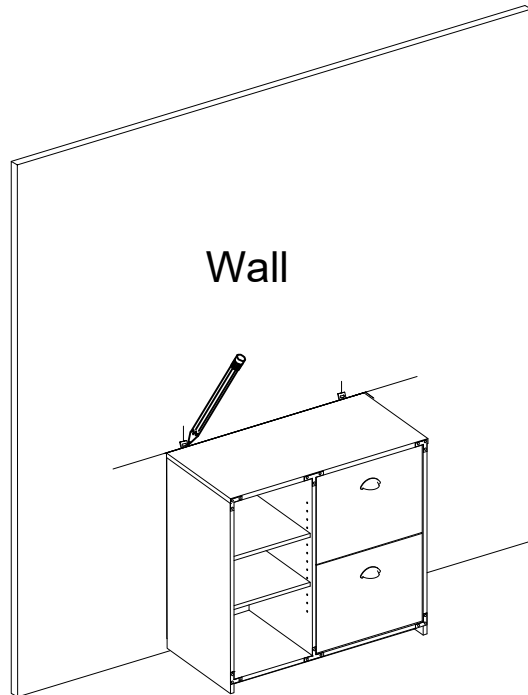

STEP 20

U₁ x2pcs

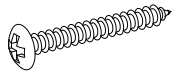

U₃ x2pcs

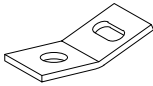

U₅ x2pcs

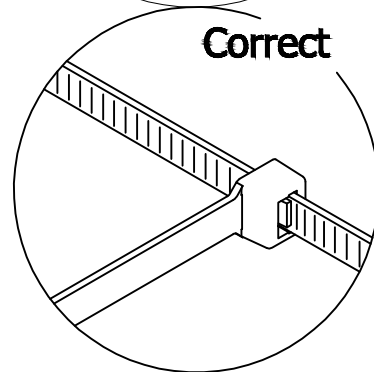
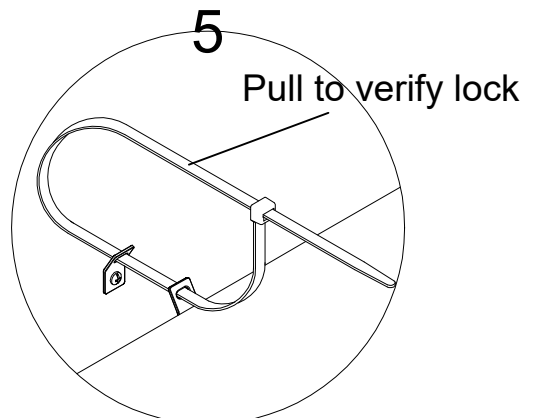
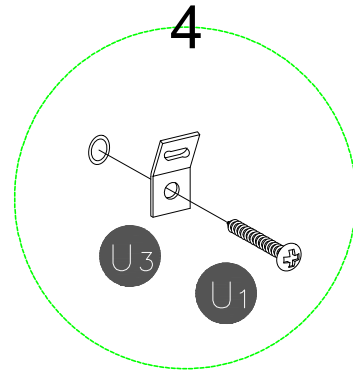
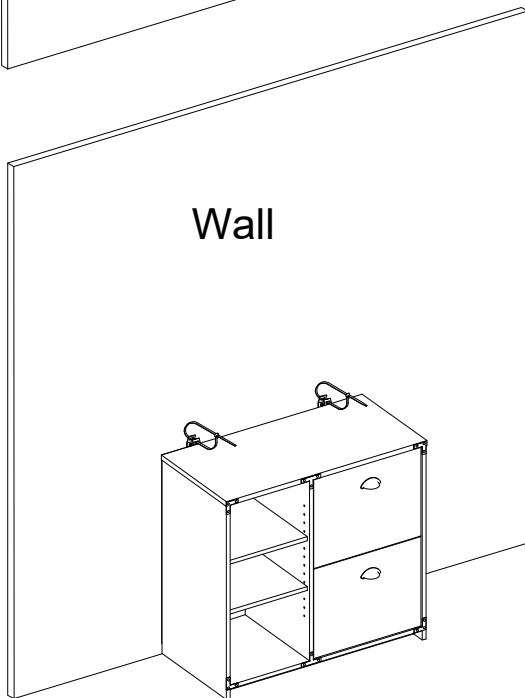
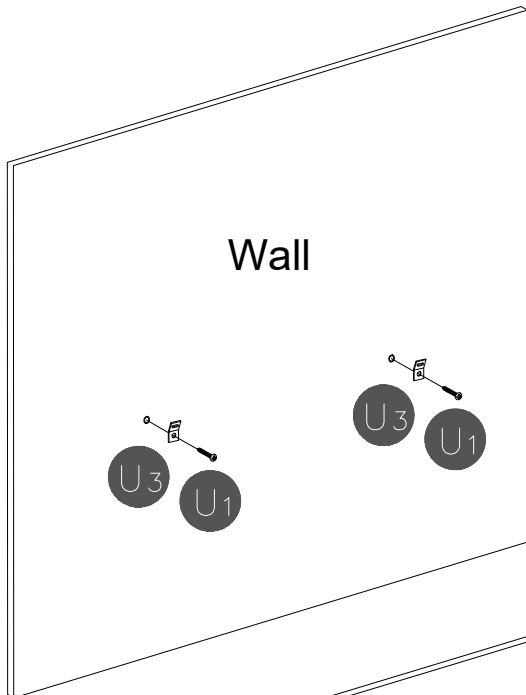

Maximum weight capacities

MAXIMUM WEIGHT: 200 LBS (91 KG)

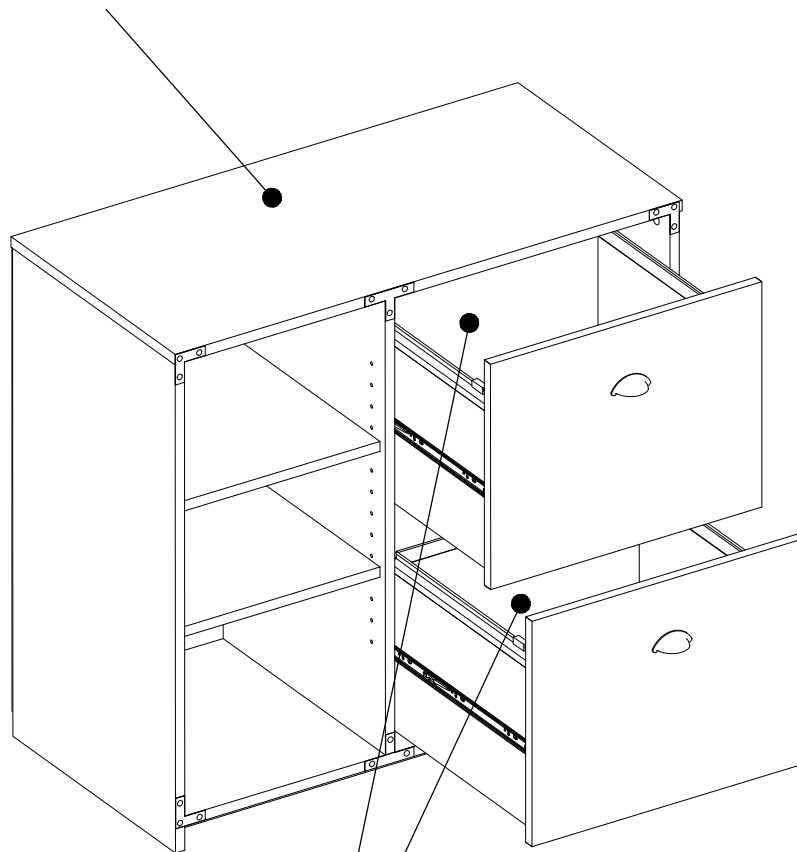

MAXIMUM WEIGHT: 50 LBS (23 KG)