

ASSEMBLY INSTRUCTIONS

STEP 1

Lay the BASE (B) upside down. Screw in the CASTERS (D). Make sure to use the provided WRENCH (E) to tighten the CASTERS (D) in all the way.

Use the provided caster wrench to tighten completely. Failure to do as instructed could result in the caster stem breaking.

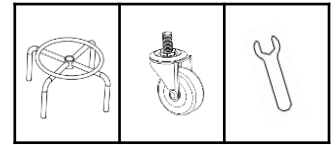

B (1) D (4) E (1)

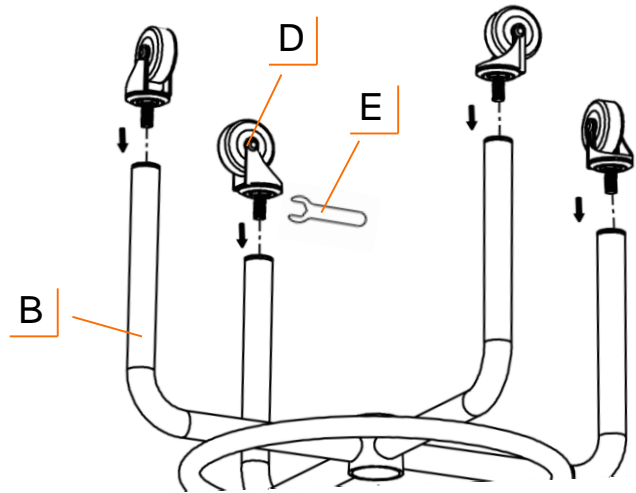

STEP 2

Turn the BASE (B) with CASTERS (D) right-side up, and insert the PNEUMATIC (C) cylinder into the center ring. Push down firmly and make sure that the PNEUMATIC (C) cylinder is straight.

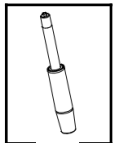

C (1)

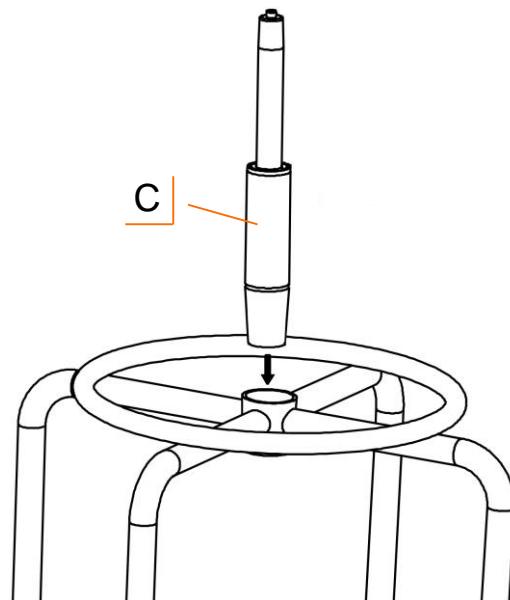

ASSEMBLY INSTRUCTIONS

STEP 3

Slide the SEAT (A) on top of the PNEUMATIC (C) cylinder. Ensure that the SEAT (A) is centered properly, and push down to affix the SEAT (A) to the PNEUMATIC (C) cylinder. To secure the entire Stool, sit down carefully on the SEAT (A), and slowly use your weight to affix all parts into place.

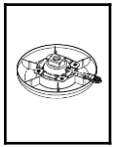

A (1)

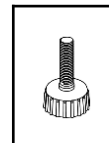
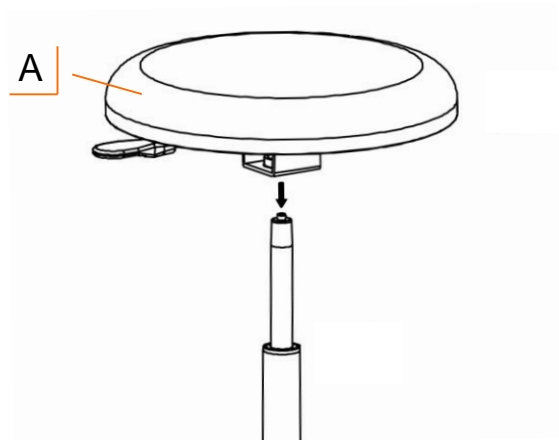

(4)

