

# Assembly Instruction

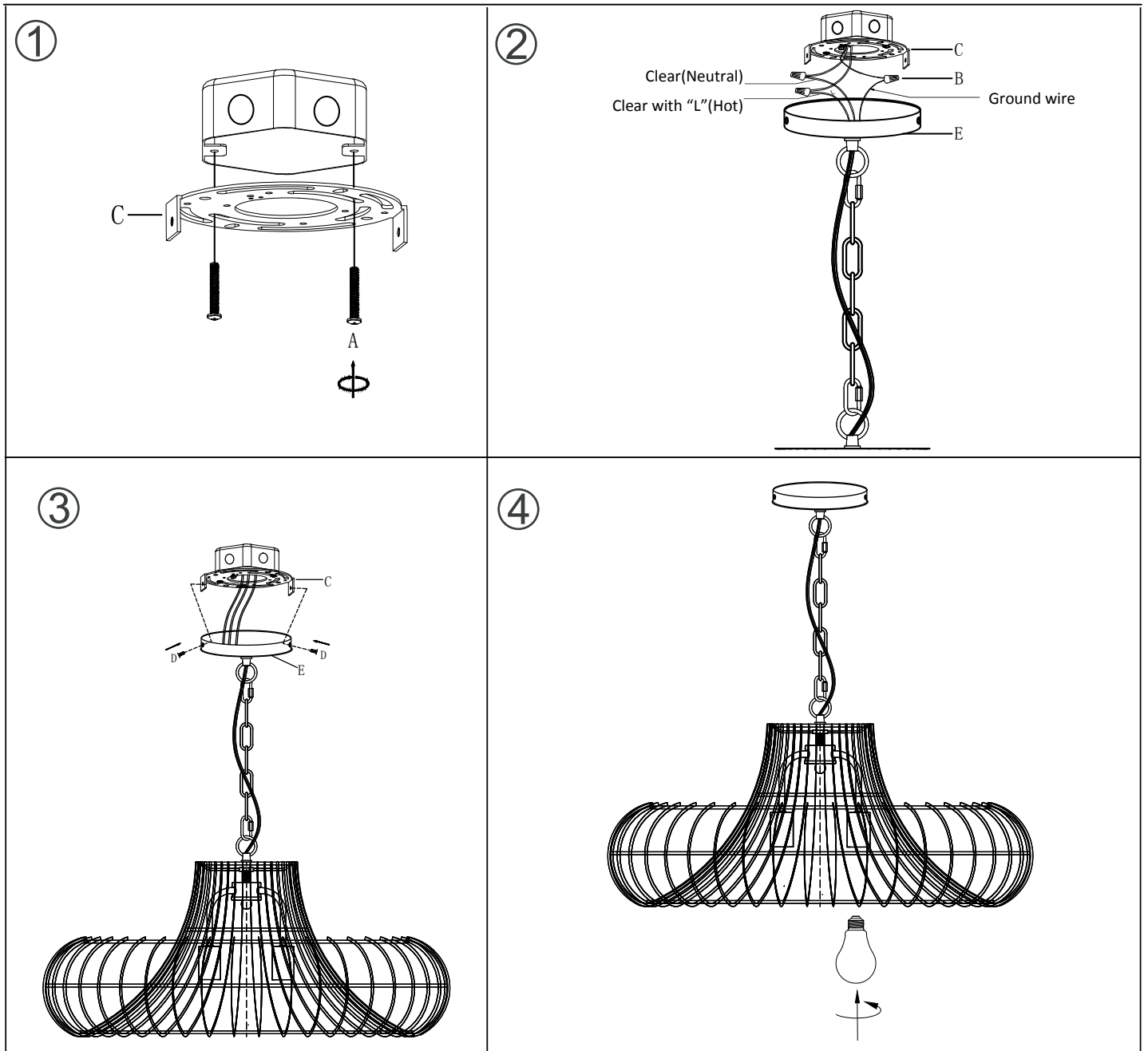

1. Carefully remove all parts from the box and remove all plastic covering.
2. Turn OFF power to the junction box, when the Pendant lamp will be installed.
3. Separate the Mounting Plate (C) from the Canopy (E) by removing the box screws (D). Install Mounting Plate (C) to your junction box using the Mounting Screws (A).
4. Use the Wire Connectors (B) to join the remaining matching colored wires (White to Clear, Black to Clear with "L"). Once complete, tuck the excess wire into the electrical box.
5. Attach the ground wire (not labeled) from the fixture to the ground junction box wire in the outlet box, or wrap the ground wire around the ground screw.
6. Place the canopy (E) against the mounting plate (C) secure with the box screws (D).
7. Put the Bulb into the lamp Body, then tighten in a clockwise direction. (not included bulb).