

40 INCH TOWER FAN WITH WIFI

Product Instructions

Product No. 2000326 / 8100108

vonhaus

Let's get started!

Visit our product hub for useful tips and tricks on getting the most out of your new product.

SCAN ME



Need further help?
support@vonhaus.com

See our full range at
www.vonhaus.com

Product Diagram

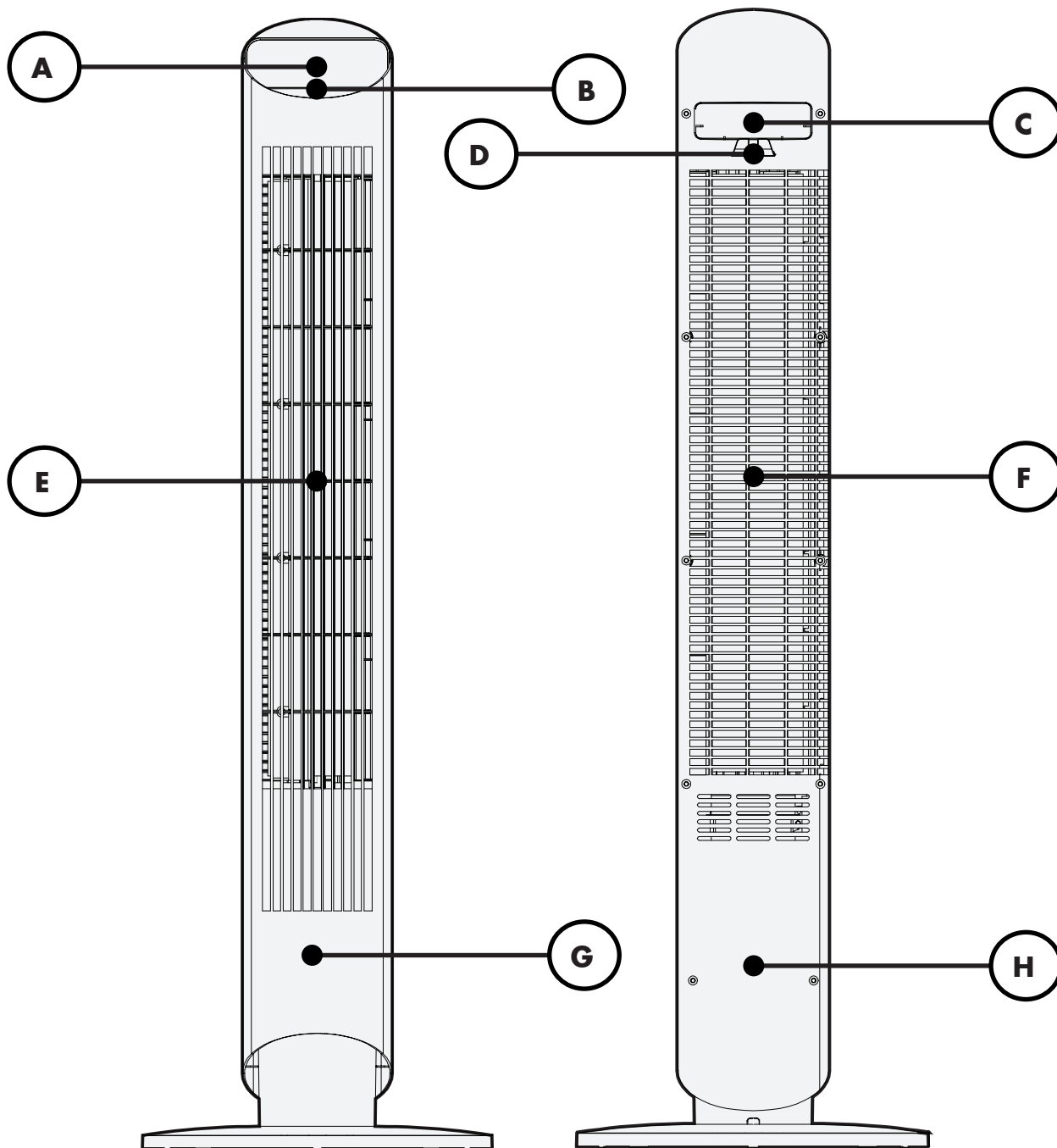

- A. Digital Display
- B. Control Panel
- C. Remote Control Storage/Carry Handle
- D. Cable Hook

- E. Air Outlet
- F. Air Inlet
- G. Front Housing
- H. Back Housing

Controls

The fan may be operated by the manual controls located on the fan or by the remote control.

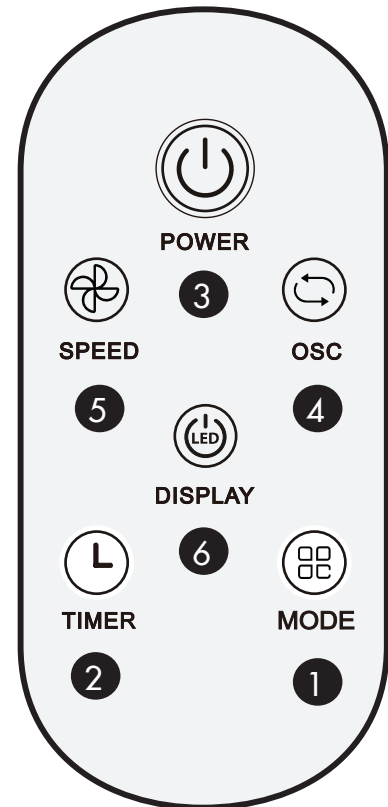
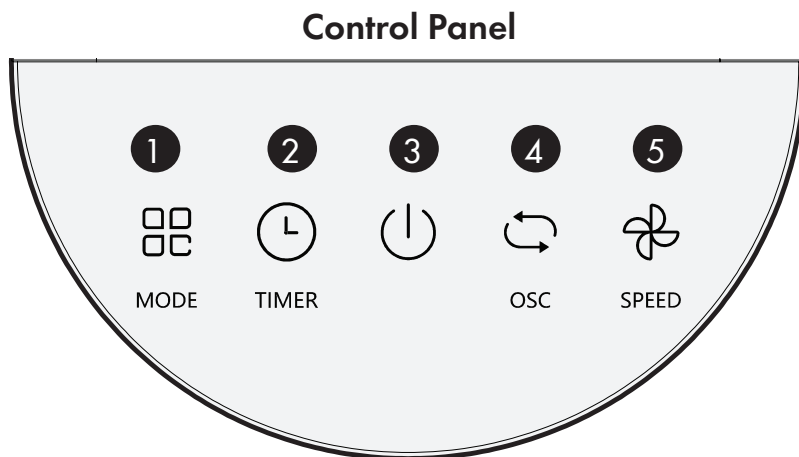

Remote Control

1. Mode

Pressing the mode button will set the fan into **NORMAL**, **NATURAL**, **SLEEP** or **CHILD** mode.

NORMAL Mode: The default mode. The fan will work at any speed you set.

NATURAL Mode: The fan will cycle through speeds in the following pattern: Speed 3 (5s) Speed 4 (5s) Speed 5 (5s) Speed 6 (5s) Speed 5 (5s) Speed 4 (5s).

SLEEP Mode:

If the fan is set at Speed 4, 5 or 6, it will work at the set speed for 30 minutes, then transfer to the next lower level and work for 30 minutes. If it reaches Speed 3, it will keep working at Speed 3 until you turn off the fan.

If you set the speed at Speed 1, 2 or 3, the fan

will work at Speed 3 until the fan is turned off. The LED display will turn off if you do not control the fan for 30 seconds. Touch any button to turn on the display.

CHILD Mode: The fan will automatically set a timer for 3 hours and activate oscillation. The fan will work at Speed 6 for 15 minutes, then transfer to Speed 4 for 15 minutes, then transfer to Speed 2 for the remaining 2.5 hours. You can turn off oscillation manually. The LED display will turn off if you do not control the fan for 30 seconds. Touch any button to turn on the display.

2. Timer

The fan is equipped with a timer that allows you to set its length of operation from 1 hour to 12 hours. The LED display will turn off if you do not control the fan for 30 seconds. Touch any button to turn on the display.

Controls

3. Power

Turn the fan on by pressing the power button; turn the fan off by pressing the power button again.

4. Oscillation

Pressing the oscillation button will start and stop the oscillation function. The oscillation symbol is displayed on the LED display.

5. Speed

Six speeds can be set by pressing the speed button. The speed setting is displayed on the LED display.

6. Display

Press the Display button on the remote or hold Speed on the control panel for 3 seconds to turn off the display. The display turns back on when any control button is pressed.

Digital Display Screen Icons

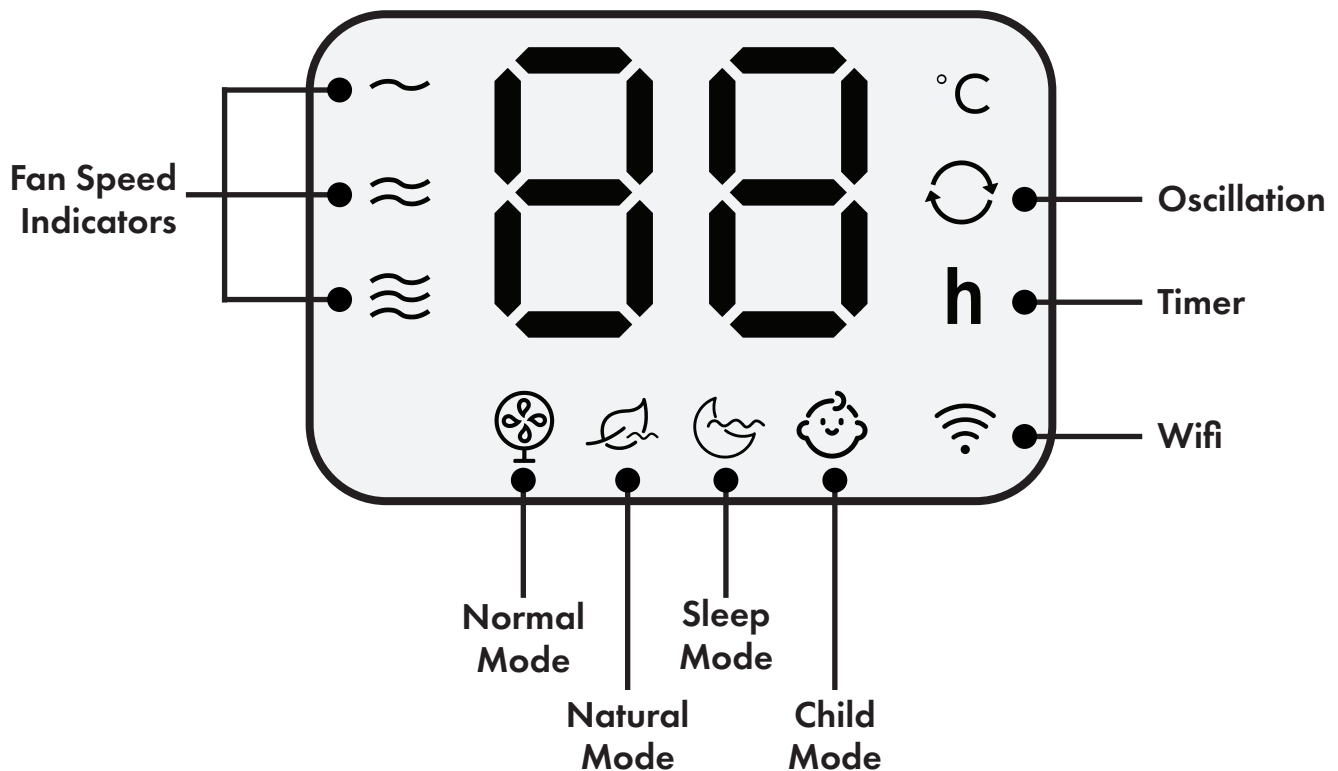

The display screen can be switched off temporarily by pressing the display button on the remote or by pressing and holding the

Speed button on the control panel for more than 3 seconds. The display will light up again once any control button is activated.

Assembly

1

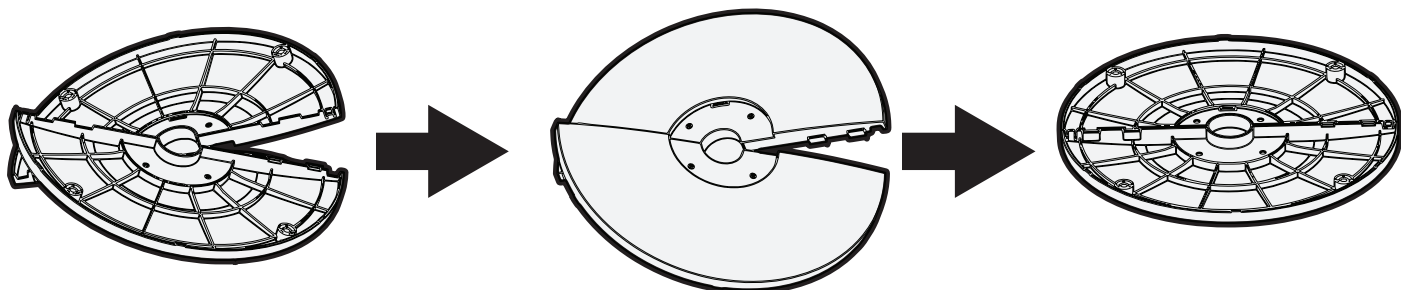

Take out the two parts of the base from the packing box. Align the centers of the two base parts and place them in a crossed form.

Rotate one of the two bases to align its hole and make it click into place correctly.

2

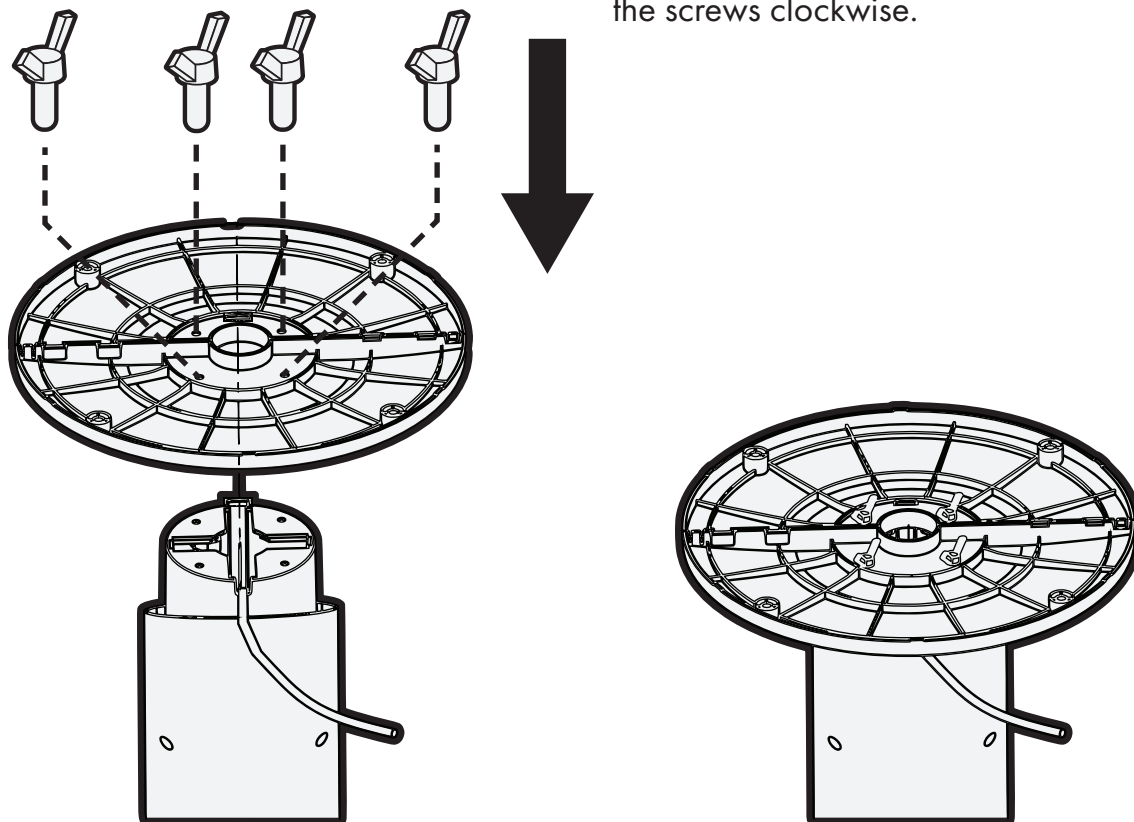

Place the wire in the recess, then fix the base to the fan body with four screws (included), turning the screws clockwise.

Attaching the Cable Hook

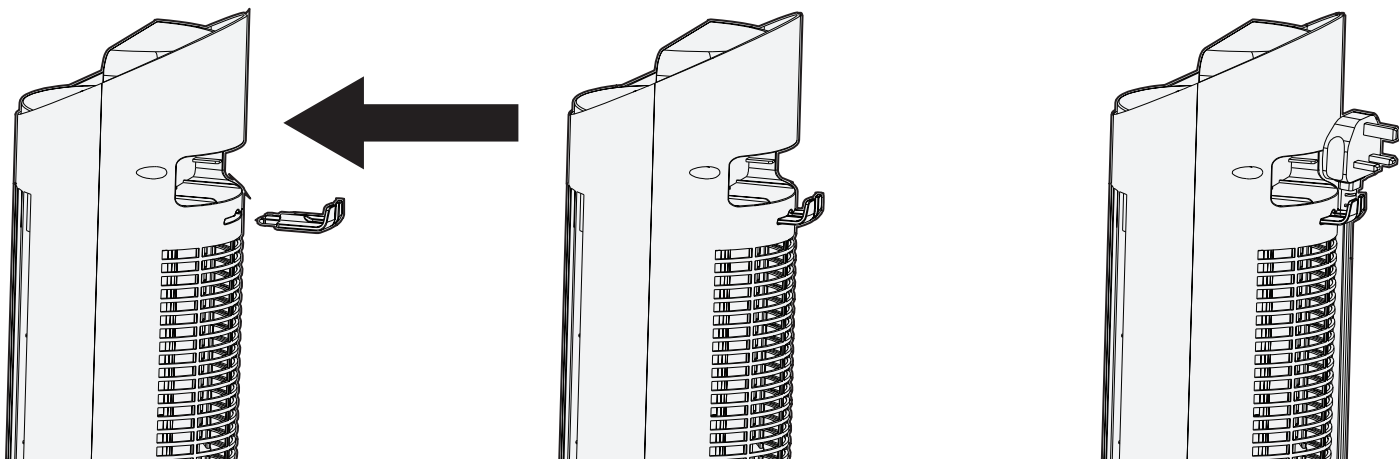

Connect to WiFi

Download the Smart Life App

The "Smart Life" app works on Android and iPhone. Scan the QR code to download it directly.



Step 1: Get Ready

- Install the "Smart Life" app and create an account
- Turn on WiFi and Bluetooth on your phone

Step 2: Prepare Your Appliance

- Place the fan within 5 meters of your router
- Hold the "Oscillation" button until the WiFi light flashes

Important: If the WiFi light goes off, just hold "Oscillation" again to restart in standby mode.



IMPORTANT

This app is supported only on 2.4GHz Wi-Fi networks. Please ensure your phone is 2.4GHz capable.

(Note: This device will only work within your home Wi-Fi system. It does not operate on 3G, 4G or 5G internet connections.)

Step 3: Step 3: Connect to WiFi

Now choose one of these two methods:

Method 1: Bluetooth

1. Make sure Bluetooth is on
2. Open the "Smart Life" app whilst the WiFi light is flashing
3. The app will connect your appliance to WiFi automatically

Method 2: Manual

1. Open the "Smart Life" app whilst the WiFi light is flashing
2. Select "Add Device" "Small Home Appliances" "Fan"
3. Follow instructions in the app
4. Watch your WiFi light:
 - **Fast flashing:** The app will connect directly
 - **Slow flashing:** Tap "Go to Connect," join the "SmartLife-XXXX" network, then return to the app

Success!

The WiFi light stays on solid (no flashing)
You can now control your appliance through the app

To Disconnect

Hold the "Oscillation" button for 5 seconds.
The WiFi light will turn off.

Safety Information

Important Safety Notice

This product is **not suitable for use by children** or by individuals with **physical, sensory, or mental impairments** that may limit their ability to operate the equipment safely, **unless** they have been given supervision or instruction concerning the safe use of the product by a person responsible for their safety.

Improper use may result in serious injury. Always ensure the operator is capable of understanding and following all safety instructions provided in this manual.

Safety

Please read the following instructions carefully before using the appliance and keep for future reference.

Read all instructions carefully before using the fan.

This appliance can be used by children aged 8 years and above and persons with reduced physical, sensory or mental capabilities or lack of experience and knowledge if they have been given supervision or instruction concerning safe use of the appliance and understand the hazards involved. Children shall not play with the appliance. Cleaning and user maintenance shall not be performed by children without supervision.

If the supply cord is damaged, it must be replaced by the manufacturer, its service agent or similarly qualified persons to avoid a hazard.

Warning: It is strictly forbidden to remove the protective guards before maintenance or cleaning.

Never use the fan without the guards in place.

Use this fan only as described in this manual. Any other use not recommended by the manufacturer may cause fire, electric shock or personal injury.

Remove the packaging and ensure that the fan is undamaged. If in doubt, do not use the fan and please contact customer services at support@vonhaus.com

Do not let children play with parts of the packaging.

Before using the fan, check that the voltage marked on the rating label corresponds to the mains supply in your home.

Extreme caution is necessary when the fan is used by or near children or persons with disabilities, and whenever the fan is left operating unattended.

Avoid using an extension cord, as it may overheat and cause a fire risk.

Do not pull the power cord to disconnect from the power source. Always grasp the plug to remove it.

Do not insert any objects into the fan, as this may cause electric shock, injury or damage to the fan. Do not block or tamper with the fan in any manner while it is in operation.

Do not leave the fan unattended.

This fan is not intended for use in wet or damp locations. Never locate the fan where it may fall into a bathtub or other water container.

Information

Do not use the fan outdoors.

Disconnect the fan from the mains power when not in use and before servicing or performing any maintenance.

WARNING: The main power switch and the on/off switch should not be used as the sole means of disconnecting power. Always unplug the power cord before servicing or moving the unit.

Keep the fan clean and maintain it in good condition (use an authorized service agent).

Use recommended parts only (non-genuine parts may be dangerous and will invalidate your warranty).

When not in use, store in a safe, dry, childproof location.

The back housing must not be dismantled; removal will be dangerous.

WARNING: To avoid danger of electric shock, unplug from outlet when not in use and before cleaning.

Maintenance

Maintenance can only be performed by an authorized service agent such as your local dealer or any agent qualified to undertake electrical repairs.

If the unit requires external cleaning, make sure it is switched off and unplugged from the mains supply. Use a soft tissue or cloth for general cleaning. To remove more persistent dirt or grime, wipe down with a cloth that has been dampened with warm soapy water. Do not use any solvents (such as thinners), as these may damage the plastic casing.

It is forbidden to disassemble the guards when cleaning.

Disposal

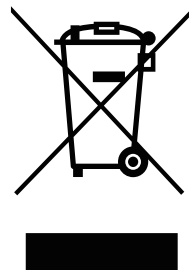

Dispose of this product correctly according to local regulations for electronic waste.

Specifications

Rated Voltage: 220-240V~

Frequency: 50-60Hz

Rated Power: 45W

Information

Customer Service

If you are having difficulty using this product and require support, please contact support@vonhaus.com

Warranty

To register your product and find out if you qualify for a free extended warranty please go to www.vonhaus.com/warranty

Please retain a proof of purchase receipt or statement as proof of the purchase date.

The warranty only applies if the product is used solely in the manner indicated in the warnings page of this manual, and all other instructions have been followed accurately.

Any abuse of the product or the manner in which it is used will invalidate the warranty.

Returns

Returned goods will not be accepted unless re-packaged in its original packaging and accompanied by a relevant and completed returns form. This does not affect your statutory rights.

No rights are given under this warranty to a person acquiring the appliance second-hand or for commercial or communal use.

Copyright

All material in this instruction manual are copyrighted by DOMU Brands.

Any unauthorised use may violate worldwide copyright, trademark, and other laws.

Thank You

Thank you for purchasing your product/appliance.

Should you require assistance with your purchase, please contact us at support@vonhaus.com

Vonhaus is a registered trademark of DOMU Brands Ltd.

Made in China for DOMU Brands Ltd.
Unit 30, Stakehill Industrial Estate
Middleton, Manchester, M24 2RW

EU Authorised Representative

Authorised Representative Service
77 Camden Street Lower
Dublin, D02 XE80
Ireland

Let's get started!

Visit our product hub for useful tips and tricks on getting the most out of your new product.

SCAN ME

