

INSTALLATION INSTRUCTIONS

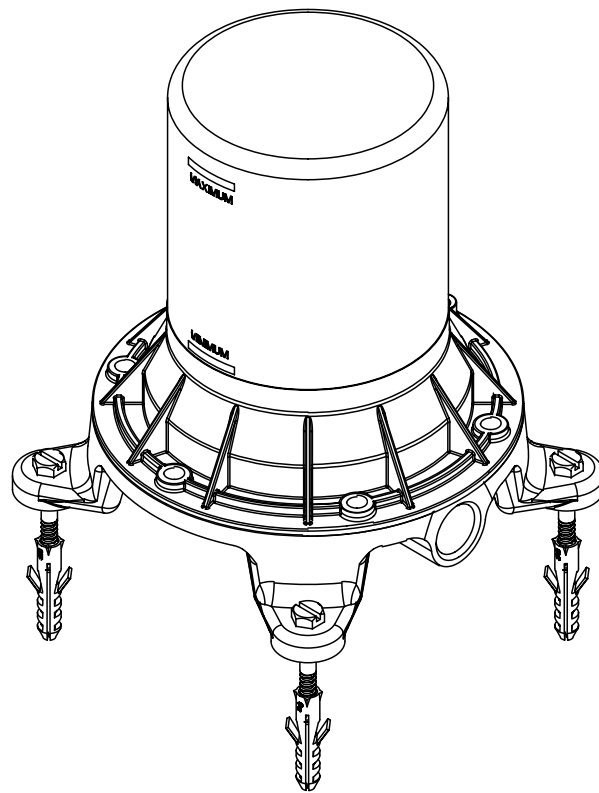

FREESTANDING TUB FILLER ROUGH-IN VALVE

DIMENSIONS In Inches & Millimetres

FREESTANDING TUB FILLER ROUGH-IN VALVE

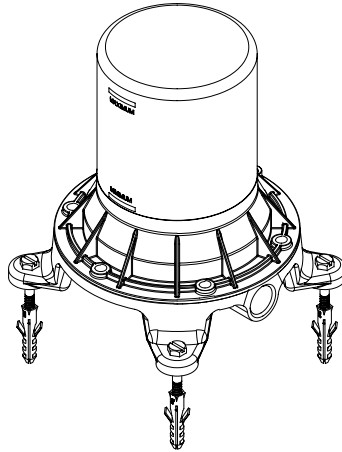

TOP VIEW

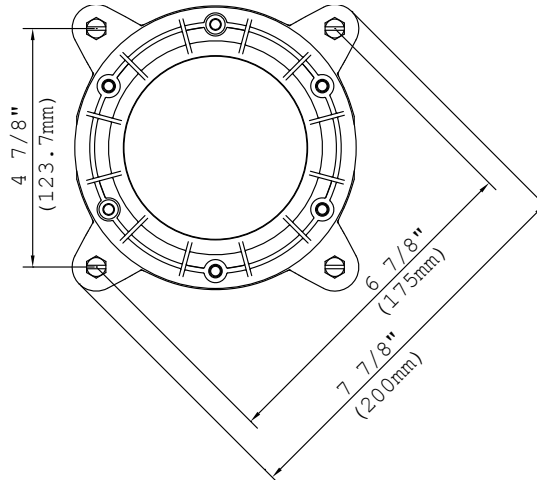

FRONT VIEW

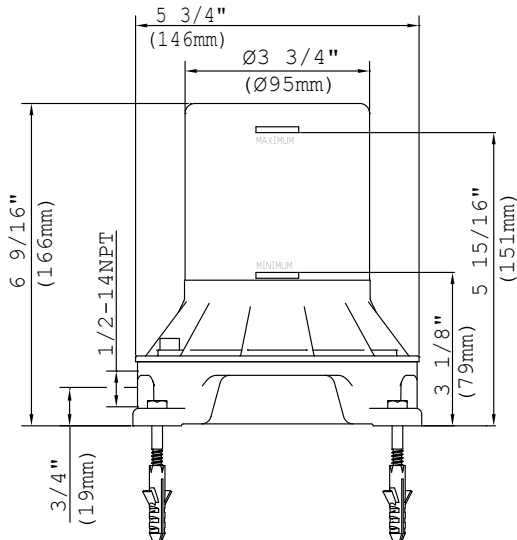

SIDE VIEW

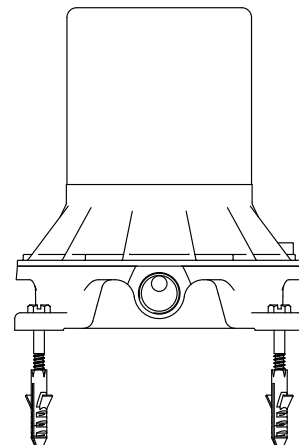

PRODUCT INFORMATION

TOOLS



Groove Joint Pliers



Adjustable Wrench

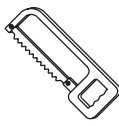

Hacksaw



Phillips
Screwdriver

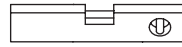

Level



Pipe Tape

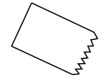

Spatula

MAINTENANCE

- Your new product is designed for years of trouble-free performance.
- Keep it looking new by cleaning it periodically with a soft cloth. Avoid abrasive cleaners, wire wool and harsh chemicals as these will dull the finish and void your warranty.

IMPORTANT POINTS

- Prior to beginning installation, turn off the cold and hot water lines. If applicable, open the existing valve to release built-up pressure.
- Overtightening nuts may cause damage.
- Wrap all threaded connections with pipe tape available at your local plumbing supply store. Always wrap in clockwise direction. The fittings should be installed by a state licensed plumber.
- Note: When there is a difference in water pressure between hot and cold supplies to the mixing valve, the pressures should be equalized by a plumber in accordance with best practice and legislation.
- Note: This product is designed to function as part of the water system at a supply pressure between 140 and 860 kPa (20 and 125 psi). The leakage test to the water system should be carried out using water as this product contains the components are specifically designed for water, for which the viscosity and surface tension are much greater comparing to air or gas, both of these are unique forces that resist the tendency of water to flow, particularly through a small opening, however at the same condition the air or gas might be able to escape through. In the exceptional circumstances should pneumatic pressure testing using compressed inert gas or air be used, the pressure should be equal or less than 3bar. Conducting the pneumatic pressure test at a higher pressure can be very hazardous not only to the person who does the test, but also to the product itself or the users. Due to the air or gas is very compressible, the same pressure of compressed air or gas contains much more energy than the liquid therefore should a joint, pipe, or any other component fail under test pressure when using compressed air or gas, the energy can be released with dangerous force to human or damaging the system.

SAFETY TIPS

- If you are soldering during faucet installation, remove cartridges, seats, gaskets and washers prior to applying flame, otherwise you will void the warranty.
- When cutting or soldering pipe, use safety glasses to protect your eyes.
- Cover drain openings to avoid losing small parts.

CODES/STANDARDS

- Certifications: IAPMO(cUPC)



FLOW RATE

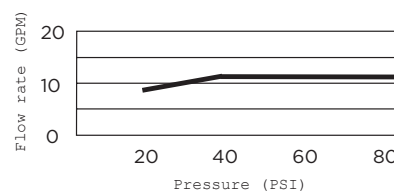

PLEASE NOTE: Final achievable flow rate is dependent on the outlets fitted, see relevant outlets (spouts, rose, sprays) for assembled product flow rate.

INSTALLATION METHOD

STEPS 1-3

We always recommend that plumbing products be installed by a licensed professional.

1.

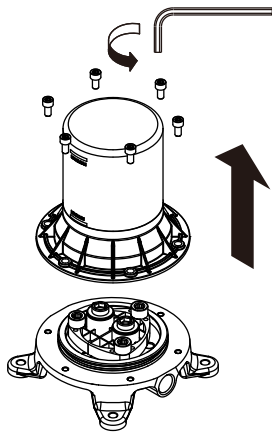

Use a 5 mm Allen wrench to loosen the screws, then take off the protect cap.

2.

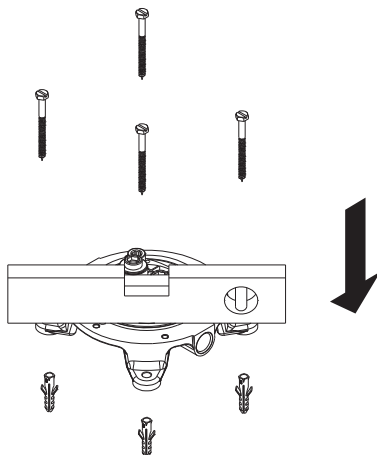

Use the body as a template to mark the position of the screw holes in the subfloor. Fasten the body to the subfloor with the screws provided. Make sure that the body is level.

3.

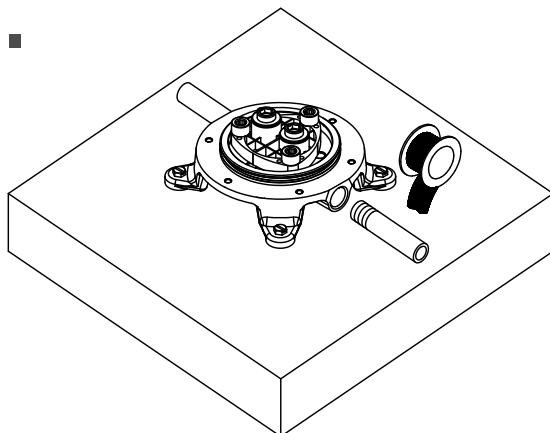

Wrap the threads on the supplies with pipe tape. Install the supplies in the body.

INSTALLATION METHOD

STEPS 4-6

We always recommend that plumbing products be installed by a licensed professional.

4.

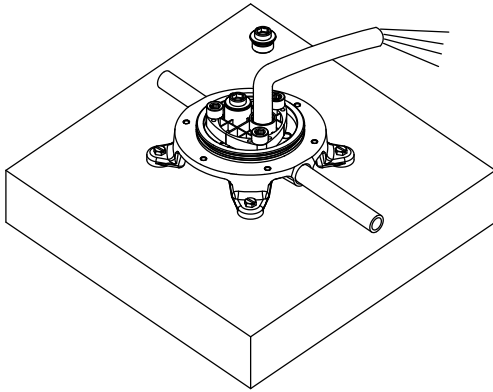

Remove the flush insert plug from the cold water side of the body. Install a hose bibb and a hose. Turn on the water and allow the line to the flush thoroughly. Repeat the flushing procedure on the hot water side.

5.

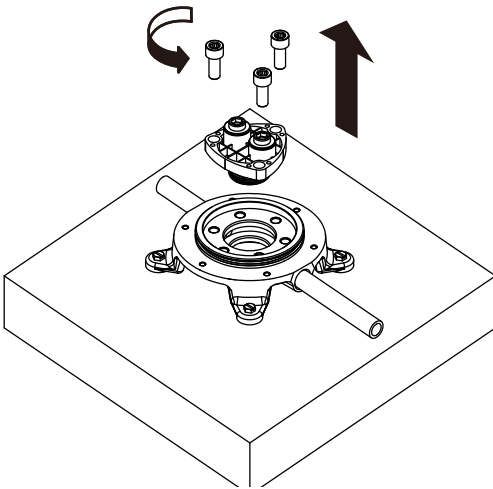

Use a 10 mm Allen wrench to remove the plastic body only when the building construction is completed and you are ready to fit the trim kit.

6.

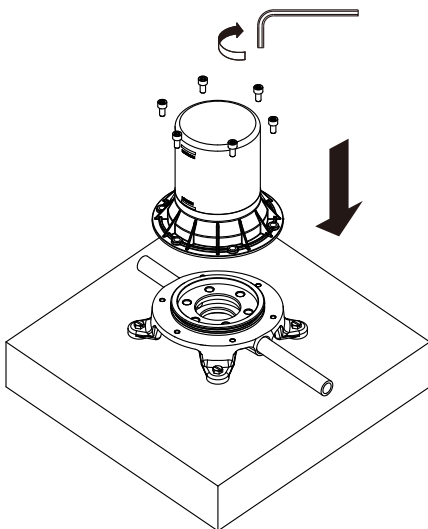

Install the protect cap. Use a 5 mm Allen wrench to tighten the screws.

We always recommend that plumbing products be installed by a licensed professional.

7.

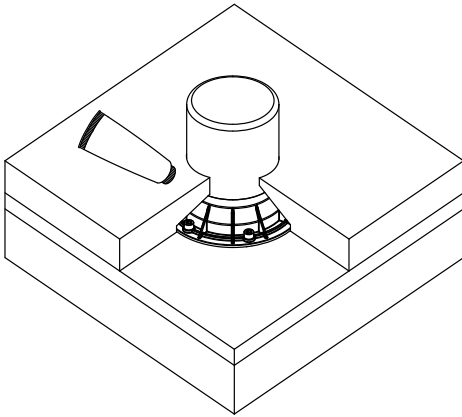

Install the flooring material. Please know and follow all applicable local codes regarding waterproofing.

8.

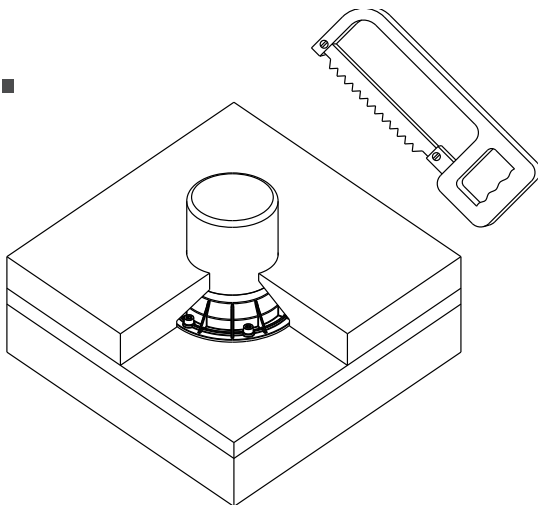

The surface of the finished floor must fall somewhere between 15mm to 90mm from the top of the protective cap. After the floor is finished, cut off the protective cap with a hack saw or reciprocating saw. Please note that the cutting point should be within 10mm height from the floor surface.

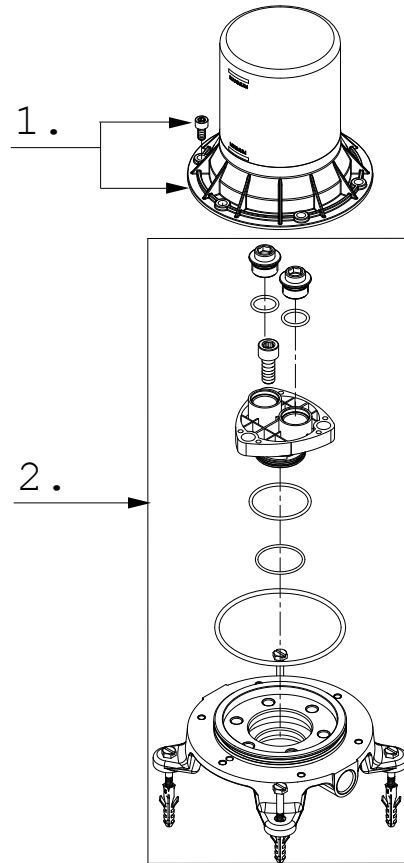

1. Protective Cap Assembly (A663A33)
2. Body Assembly (A661518)

