

ASSEMBLY INSTRUCTIONS

ABK-24615

BC-1162

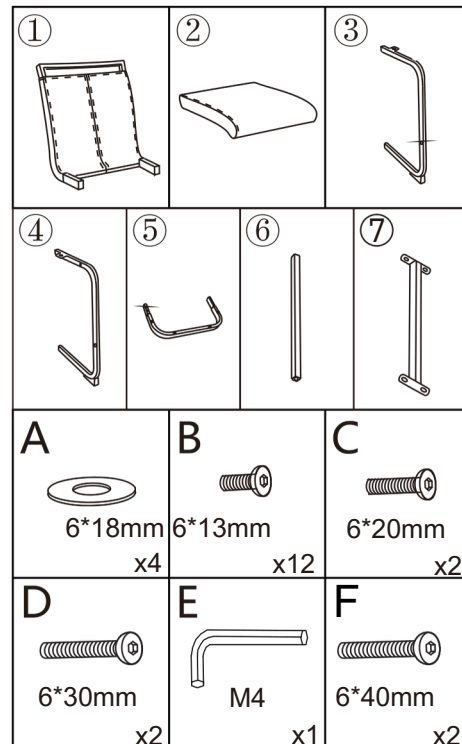
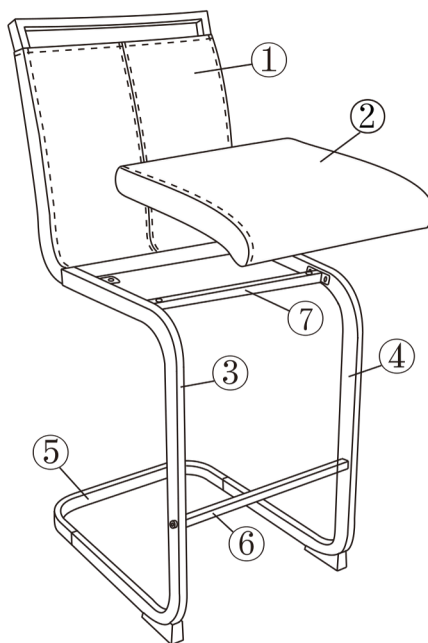
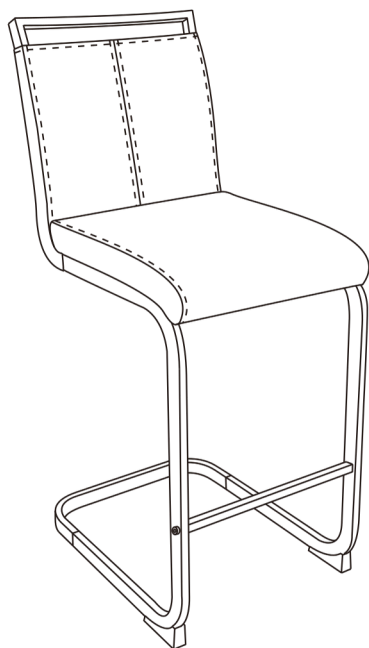

STEP 1 ③ and ④ are connected to ⑤ respectively, ⑥ is connected to ③ and ④, ⑦ is connected to ③ and ④. B and D are inserted into the corresponding hole and fastened with E.

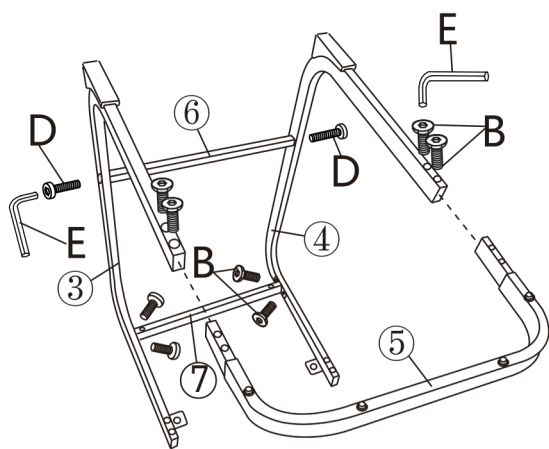

Bx8
Dx2
Ex1

STEP 2 Connect ① to ③ and ④ respectively, insert B into the corresponding hole and tighten with E.

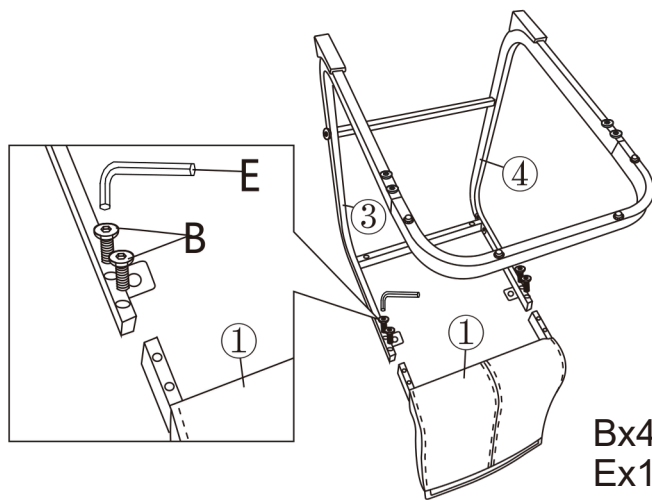

Bx4
Ex1

STEP 3 Connect ② to ③, ④ and ⑦ respectively, fit C, A to the corresponding holes in turn and fit F, A to the corresponding holes in turn and tighten C, F with E.

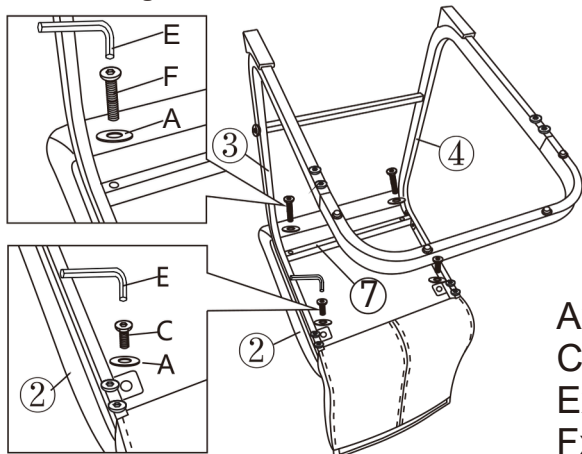

Ax4
Cx2
Ex1
Fx2

STEP 4 Installation complete

