

Assembly Instructions

Storage Cabinets

A1	A2	B1	B2	C1	C2	D	E
x6	x1	x2	x1	x4	x2	--	Long x8

F1	F2	F3	G	H	J	K	L
Short x8	Short x8	Short x4	x3	x4	x16	x56	x16

I	II	III	N				
4mm x2	5mm x2	x1	x1				

①	②	③	④	⑤	⑥	⑦	⑧	⑨
x6	x6	x18	x6	M5*12 x16	x3	M4*25 x18	M4*14 x6	M6*30 x6

Step 1	Step 2	Step 3	Step 4
<p>Don't tighten too tightly</p> <p>Kx3 x12</p>	<p>using N: Assistance tools</p> <p>Rotate counterclockwise using I: 4mm</p> <p>F1x2 F3x2 x2</p>	<p>Attention: The hole position faces inward 80°; Then use transparent film to cover the hole position</p> <p>F1x1 F2x2 x2</p>	<p>Rotate clockwise using II: 5mm</p> <p>Kx4 x2</p>

Step 5

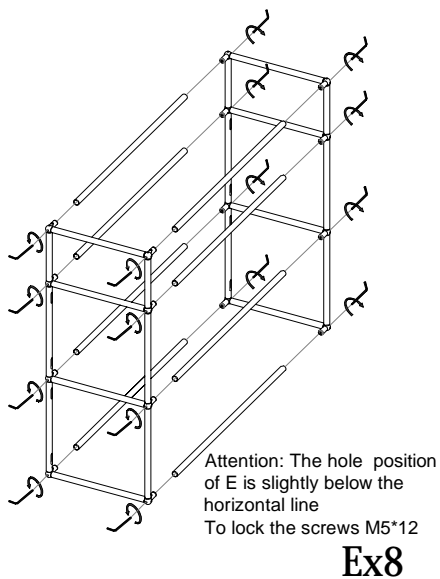

Step 6

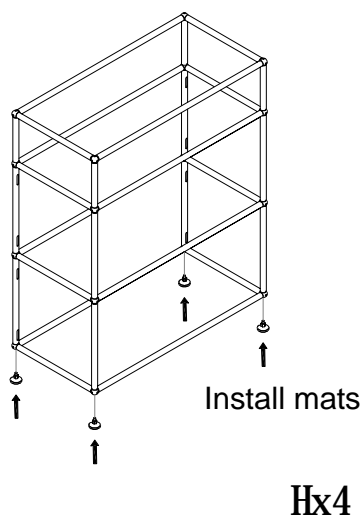

Step 7

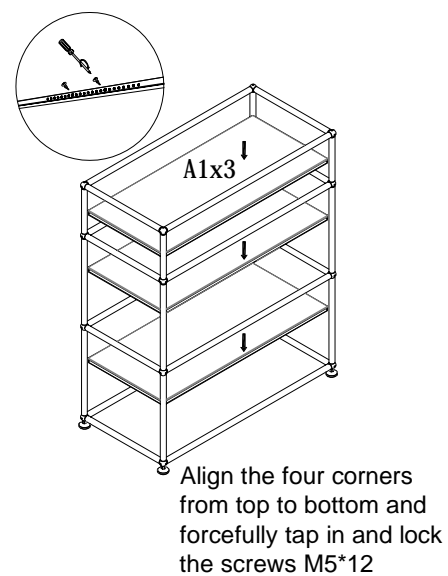

Step 8

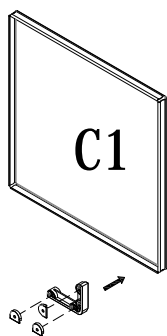

Only 3*③ are needed here
The remaining hole position is spare

② x1
③ x3

Step 9

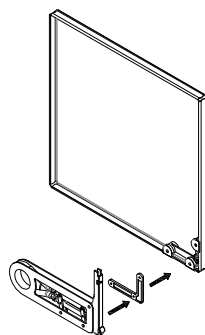

① x1
④ x1

Step 10

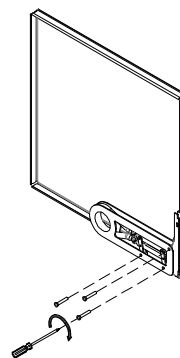

Only 3*⑦ are needed here

⑦ x3
x2

Step 11

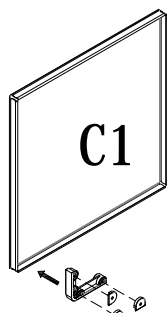

Same as the step 8
Pay attention to distinguishing left and right

② x1
③ x3

Step 12

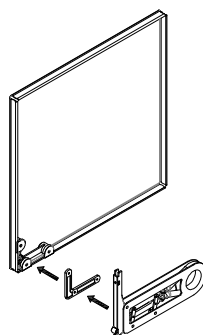

① x1
④ x1

Step 13

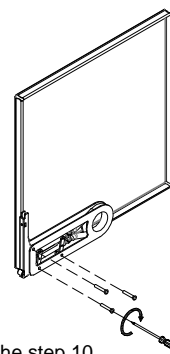

Same as the step 10

⑦ x3
x2

Step 14

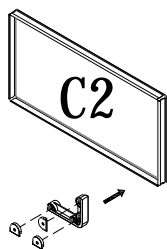

Only 3*③ are needed here
The remaining hole position
is spare

② x1
③ x3

Step 15

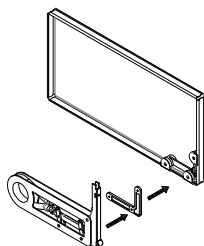

Align hole positions

① x1
④ x1

Step 16

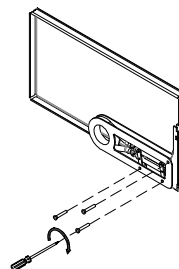

Only 3*⑦ are needed here

⑦ x3

Step 17

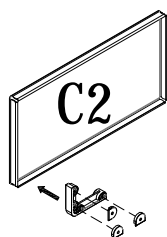

Same as the step 8
Pay attention to
distinguishing left and right

② x1
③ x3

Step 18

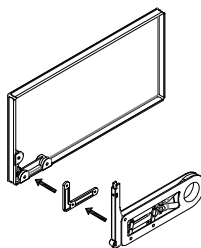

Same as the step 9

① x1
④ x1

Step 19

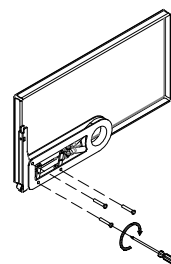

Same as the step 10

⑦ x3

Step 20

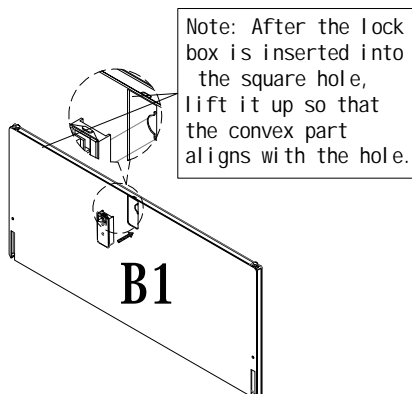

Note: After the lock box is inserted into the square hole, lift it up so that the convex part aligns with the hole.

⑥ x1
x2

Step 21

keep the keyhole like "——"
Then screw on the screws

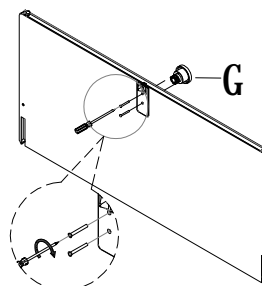

⑨ x2
x2

Step 22

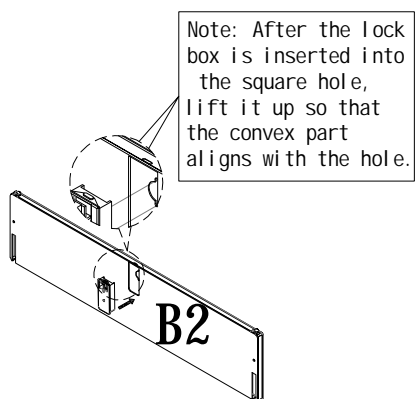

⑥ x1

Step 23

keep the keyhole like "—"
 Then screw on the screws

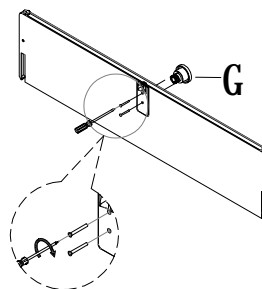

⑨ x2

Step 24

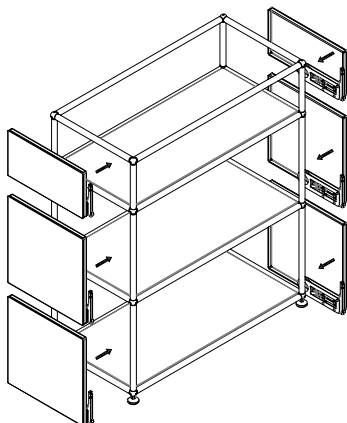

Step 25

Tap the plates and lock the screws M5*12

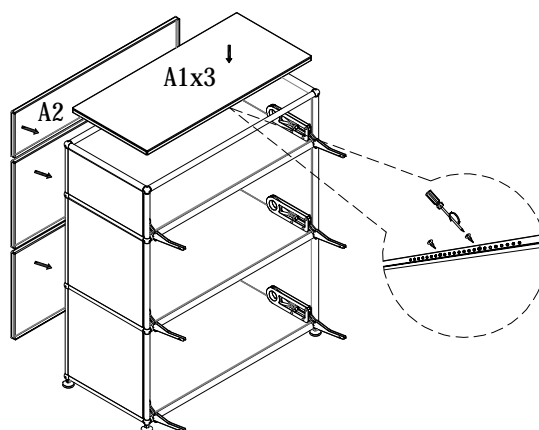

⑤ x4

Step 26

Insert door panel and lock the screws M4*14

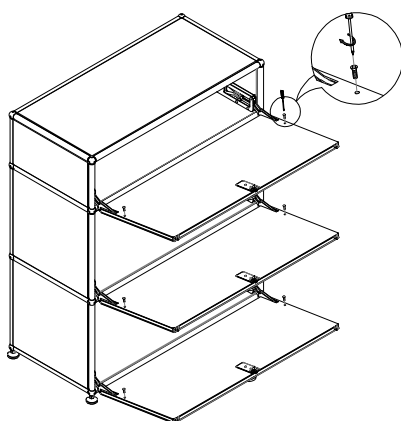

⑧ x6

Fi ni sh

