

# Operating Instruction

Assemble the pet stroller in accordance with the following steps and confirm that all parts are fixed before use.

## 01 Understand each part of the product

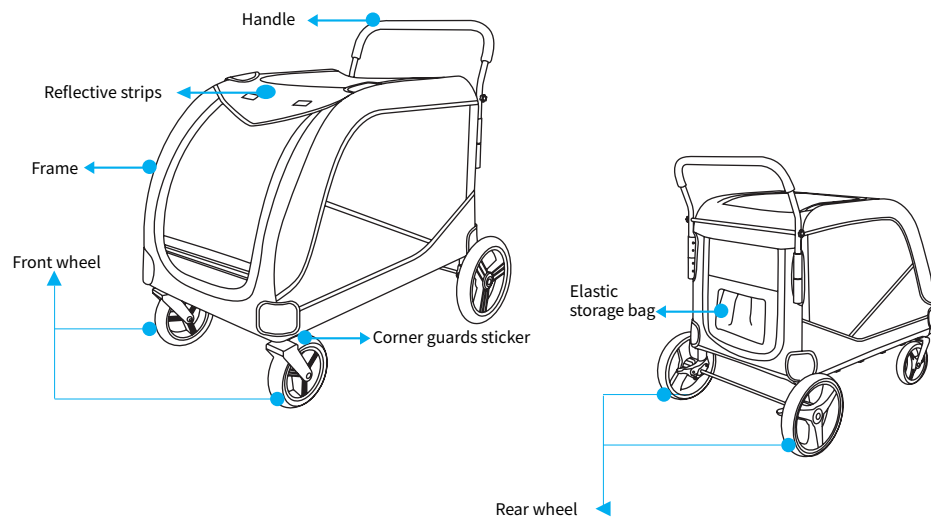

## 02: Unfolded frame section

Align the two fittings, to hold the sleeve in place that two fittings to complete the brace to smooth out the frame.

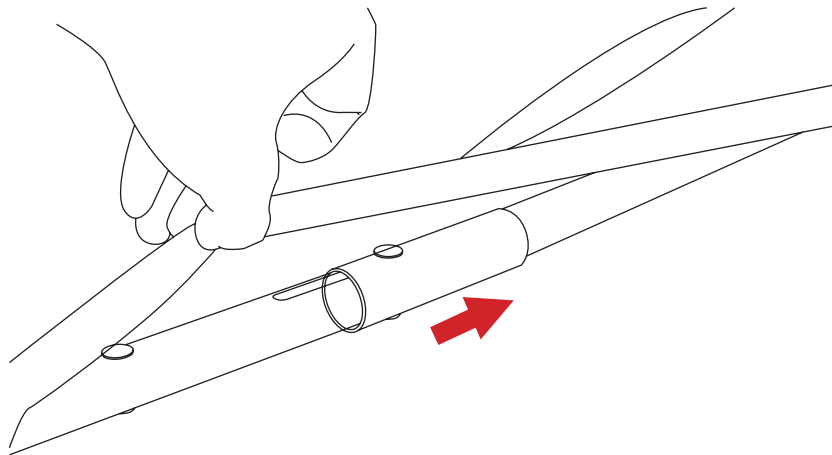

## 03: Installing the rear wheels

Align the rear axle with the frame rear wheel assembly hole and press both sides at the same time until the ball pops out of the hole and is installed in place.

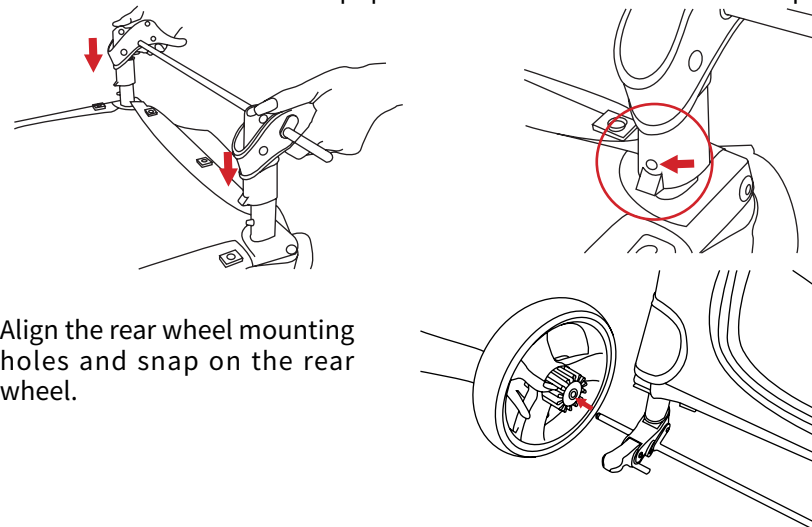

Align the rear wheel mounting holes and snap on the rear wheel.

## 04: Installing the front wheels

Align the front wheel insert rod with the bottom wheel hole position, then push it to the corresponding position. Use the insert Insert the pin card into the fixed hole position and cover with the protective cover, the front wheel installation is completed.

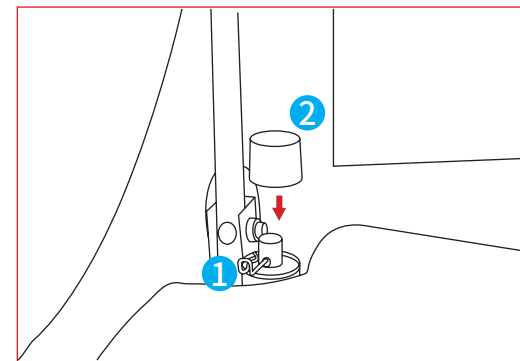
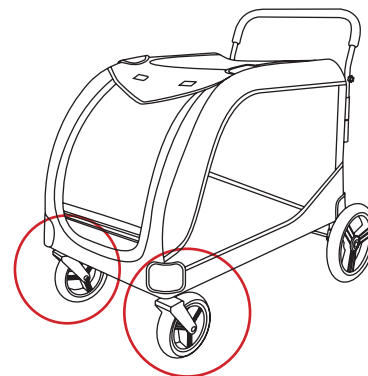

# Operating Instruction

Assemble the pet stroller in accordance with the following steps and confirm that all parts are fixed before use.

## 05: Mounting handle

Insert the handle tube into a hole first (not fully inserted), the other side needs to be inserted into the hole with a little force. Press in the middle.

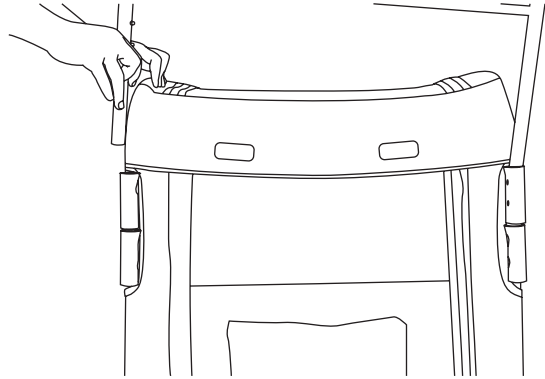

## 06: Putting on corner guards

Put the four corner guards stickers on separately.

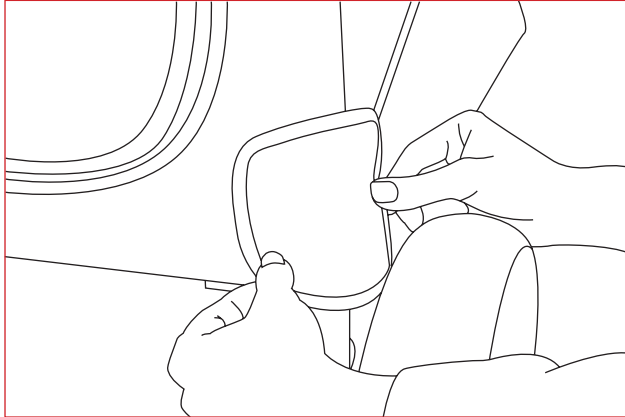

## Close the pet stroller

Unclamping the sleeve allows you to separate the two fittings.

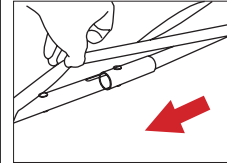

Open the protective cover and unplug the pin. Then the front wheel can be removed.

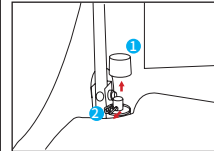

Hold down the marble and lift your handle tube upwards, both sides are the same operation.

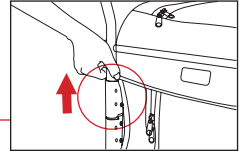

Press the button in the center of the rear wheel to remove the rear wheel.

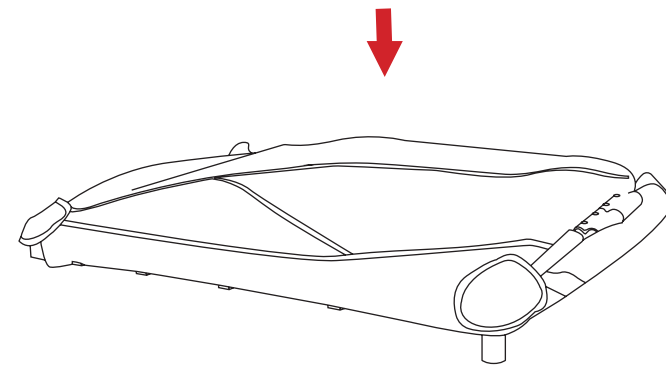
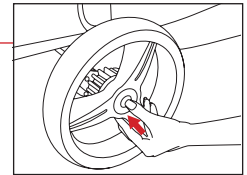

# Operation and Maintenance

## Matters needing attention

- When using this stroller, the braces or collars of the pet can be fixed on the hook buckle in the cradle to prevent the pet from losing.
- There are comfortable cushions in the stroller that can be removed for cleaning, which can be used according to the specific situation.
- Please keep this product away from the fire source and corrosive liquid.

## Routine maintenance

- If you do not use this product for a long time, it is recommended to fold it and store it.
- Please avoid placing the product in direct sunlight, so as to avoid discoloration and product aging.
- Prevent the product from touching sharp objects, and avoid scratching and damage.
- If the product has dirt, please clean it with a soft brush or towel, and put it in the ventilation place to dry completely. Be sure not to wring it out.
- If this product needs to be washed after removing the padding and lining, please follow the washing instructions.

## Washing instructions

The maximum washing temperature is 30 °C , hand wash, do not machine wash, do not bleach, do not iron, do not dry repeatedly and do not dry clean. Hang it dry.