

# ET631B; ET631BZ ET631CP; ET631N ET631W

Gimbal Ring  
PAR38

## PROJECT INFORMATION:

Project Name: \_\_\_\_\_

Fixture Type: \_\_\_\_\_

Date: \_\_\_\_\_

## DIMENSIONS

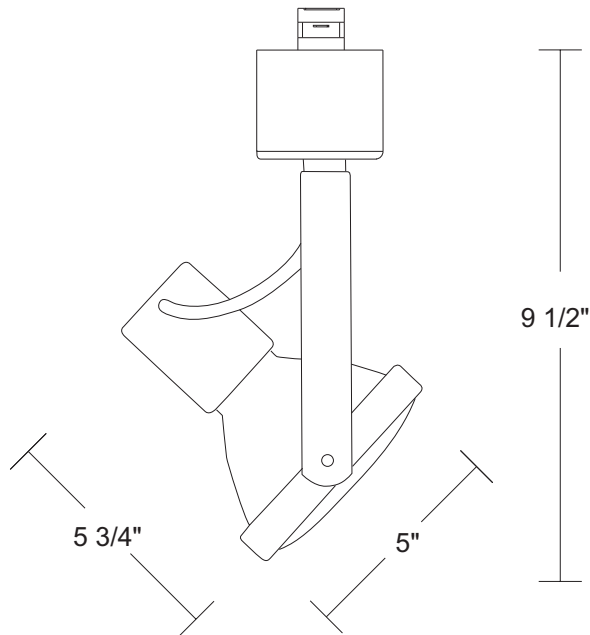

## PRODUCT SPECIFICATIONS

All track heads except HID have adjustable track adapter to allow for use with single circuit and double circuit tracks

- Gimbal Ring
- Metal Housing
- 90° vertical adjustment  
358° rotation
- Use with ELCO 120V Single or Double Circuit Track or 120V Monopoints

**Lamp:** 150W 120V R30 PAR38 (not included, by others)

**Lamp Holder:** PAR38 included

**Dimensions:** Length: 5 3/4"  
Diameter: 5"  
Max. Extension: 9 1/2"

**Finish:** (B) Black, (BZ) Bronze, (CP) Copper, (N) Brushed Nickel, (W) White

**Labels:** U.L. listed

## CATALOG NUMBER

**Example:** ET631B (Black)  
ET631BZ (Bronze)  
ET631CP (Copper)  
ET631N (Brushed Nickel)  
ET631W (White)