

Quick installation

Tool-Free Connection in 3 Easy Steps!

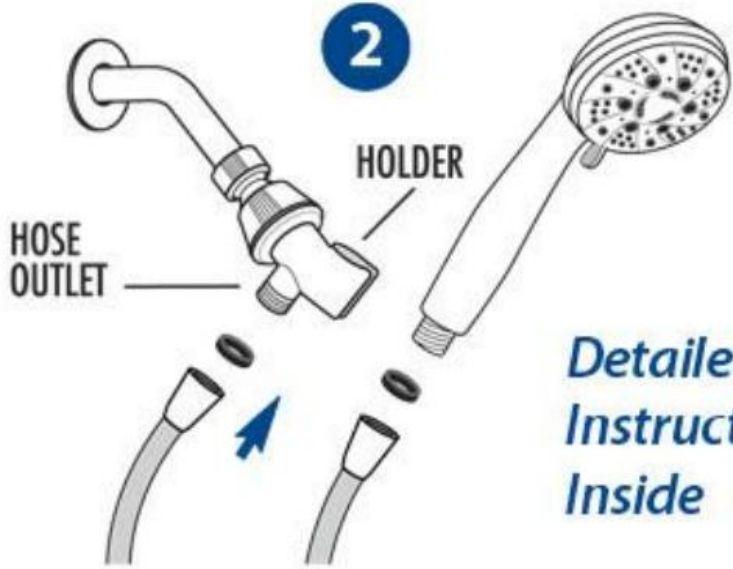

1
Remove old shower head. Screw Bracket onto Shower Arm and hand tighten Crack-resistant Nut.



2
Screw Hose with washers in place onto Hose outlets.

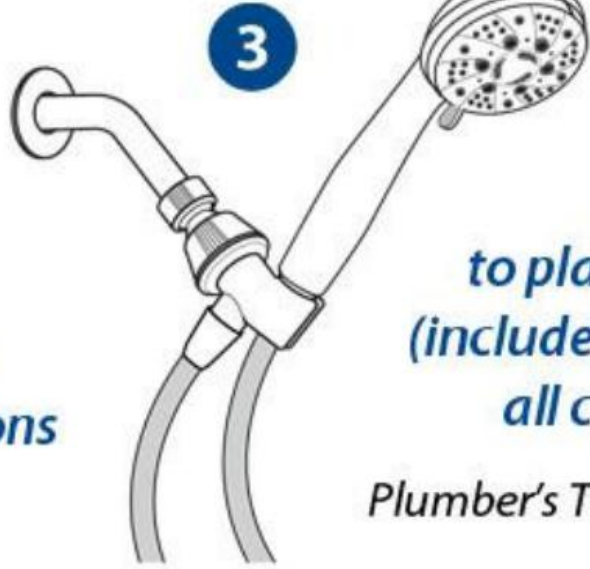

3
Detailed Instructions Inside

Screw Hand Shower with Washer in place onto conical Hose end, then insert into Bracket's Holder.

BE SURE
to place washers
(included) between
all connections

Plumber's Tape Included



You can contact us if you meet any problem