

Specifications



Height Adjustment Range
27.9"–46.8" (71–119cm)



Power Input
100V–240V



Max. Speed
10mm/s



Operating Noise
≤55dB

Max. Load

110 lbs / 50kg (Desktop + Other Items)

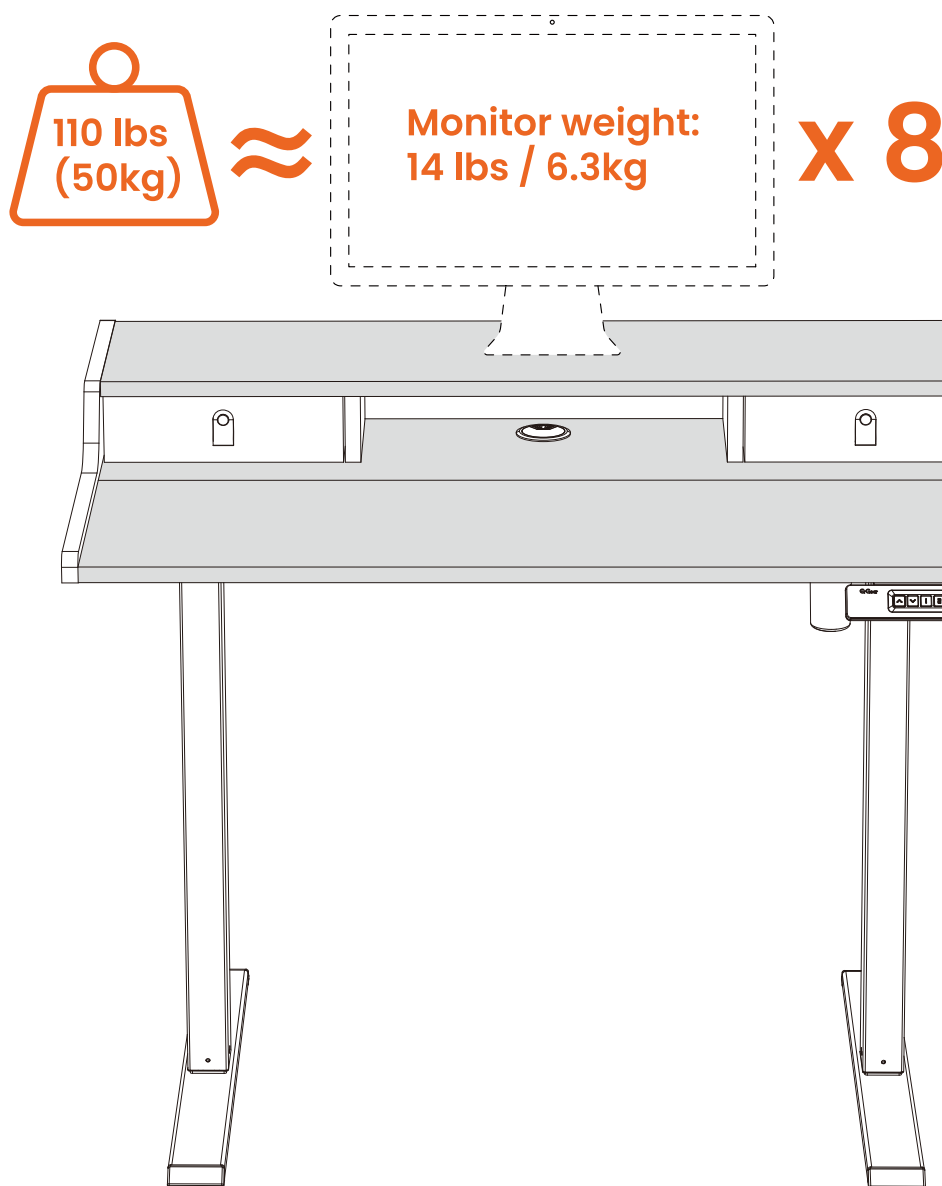

Tools Needed (Not Included)

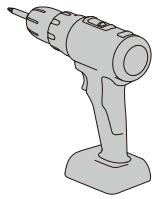

Drill

OR

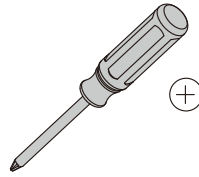

Phillips Screwdriver

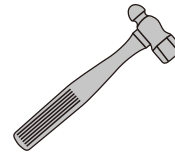

Hammer

Step 1 Supplied Parts and Hardware

A x 8



Bolt
M6 x 30mm

B x 10



Bolt
M6 x 10mm

C x 1



Allen Wrench
5/32" (4mm)

01 x 1



Crossbar

02 x 1



Left Desk Leg

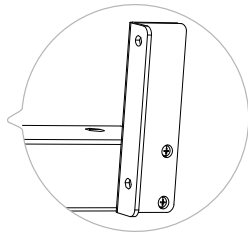

03 x 1

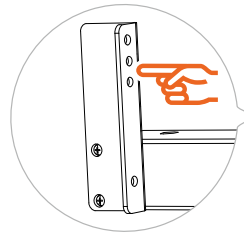

Right Desk Leg

04 x 2

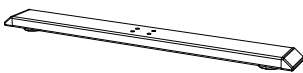

Leg Base

05 x 2

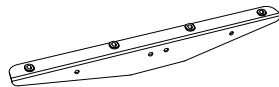

Side Plate

06 x 1



Transmission Rod

07 x 1

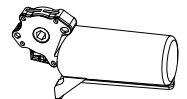

Motor

I x 1



Wrench

Step 2 Supplied Parts and Hardware

L1 x 2



Cam Bolt

L2 x 2



Cam Lock

G x 2



Wood Dowel Pin

08 x 1

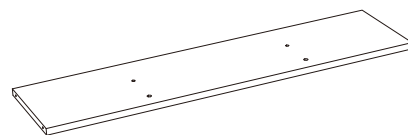

Drawer Top Panel

09 x 1

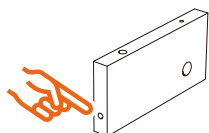

Drawer Side Panel
(R)

10 x 1



Drawer Side Panel
(L)

Step 3 Supplied Parts and Hardware

D x 6



Screw
ST5 x 14mm

F x 3



Desktop Panel
Connector

G x 10 (For 40")
x 11 (For 48")



Wood Dowel Pin

L1 x 6



Cam Bolt

L2 x 6



Cam Lock

M x 6



Screw
ST4 x 35mm

11 x 1

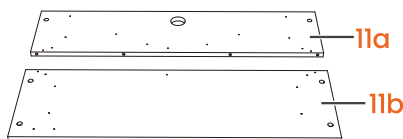

Desktop

12 x 1

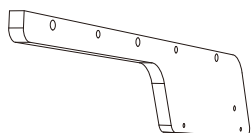

Drawer Side Panel
(R)

13 x 1

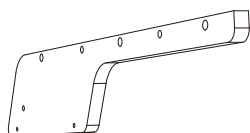

Drawer Side Panel
(L)

Step 4 Supplied Parts and Hardware

D x 16

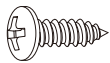

Screw
ST5 x 14mm

14 x 2

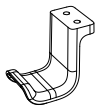

Storage Hook

15 x 1

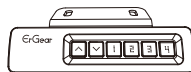

Controller

Step 5 Supplied Parts and Hardware

H x 4



Cable Clip

K x 6 (For 40")
x 7 (For 48")

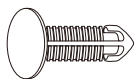

Plastic Rivet

16 x 1



Power Cable

Actual part
may vary.

17 x 1



Grommet Cover

18 x 1

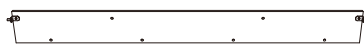

Felt Backstop

Step 6 Supplied Parts and Hardware

19a x 2

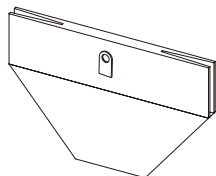

Drawer

19b x 2



Drawer Bottom

Not all hardware included in this package will be used.

Contact Us

If you receive parts that are damaged, defective, or are missing parts, please contact us.



1-800-651-9525 (US/CA) Mon-Fri, 8am-8pm (CST)
44-808-196-3875 (UK) Mon-Fri, 2pm-10pm (UTC)



support@ergear.com

Step 1 Assembling the Frame

Left Leg End

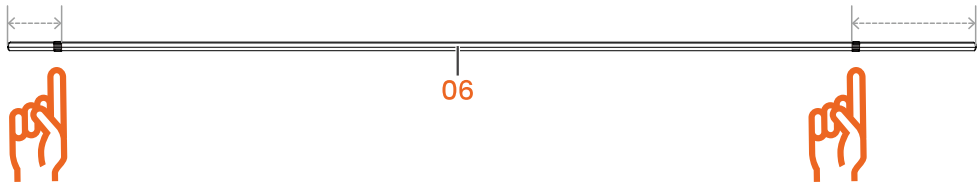

The bump is set back closer.

Motor End

The bump is set back farther.

Insert the motor onto the transmission rod.

! **Note:** Note the direction of the tab.

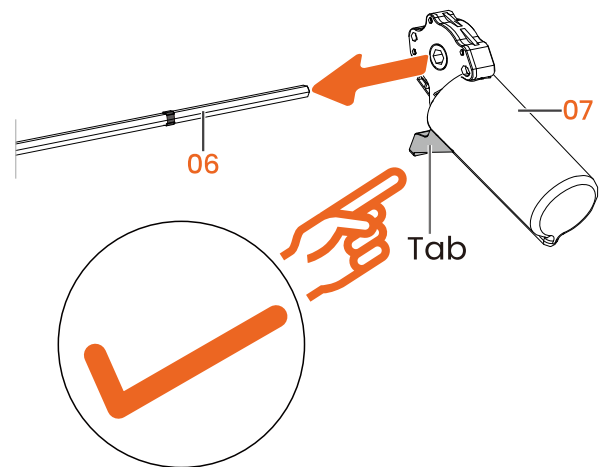
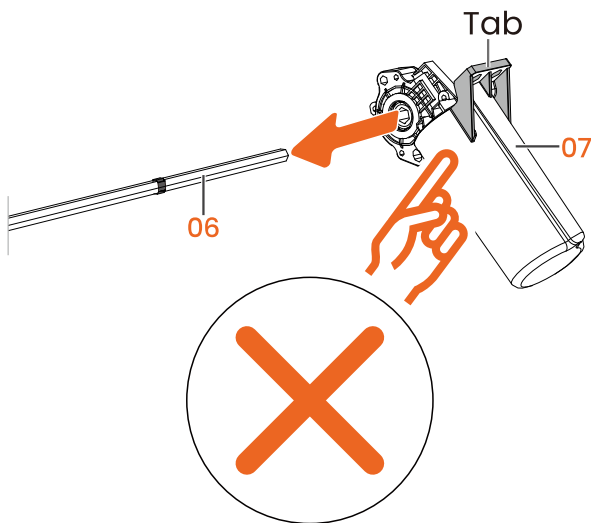

The bump is set back farther.

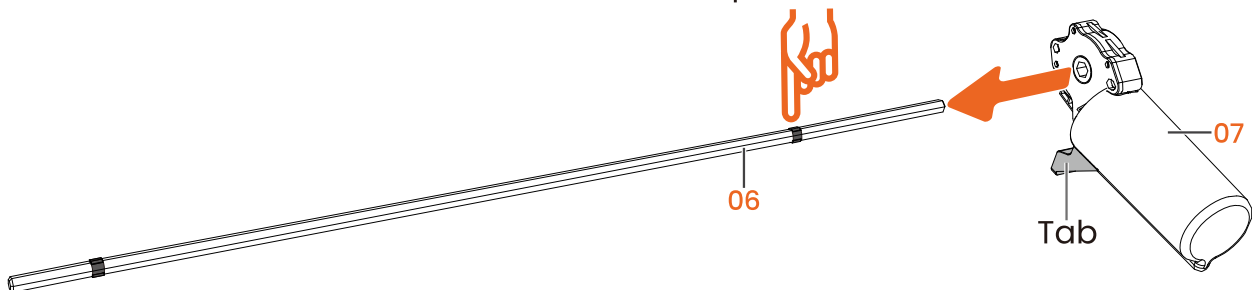

Insert the transmission rod with the motor into the right leg.

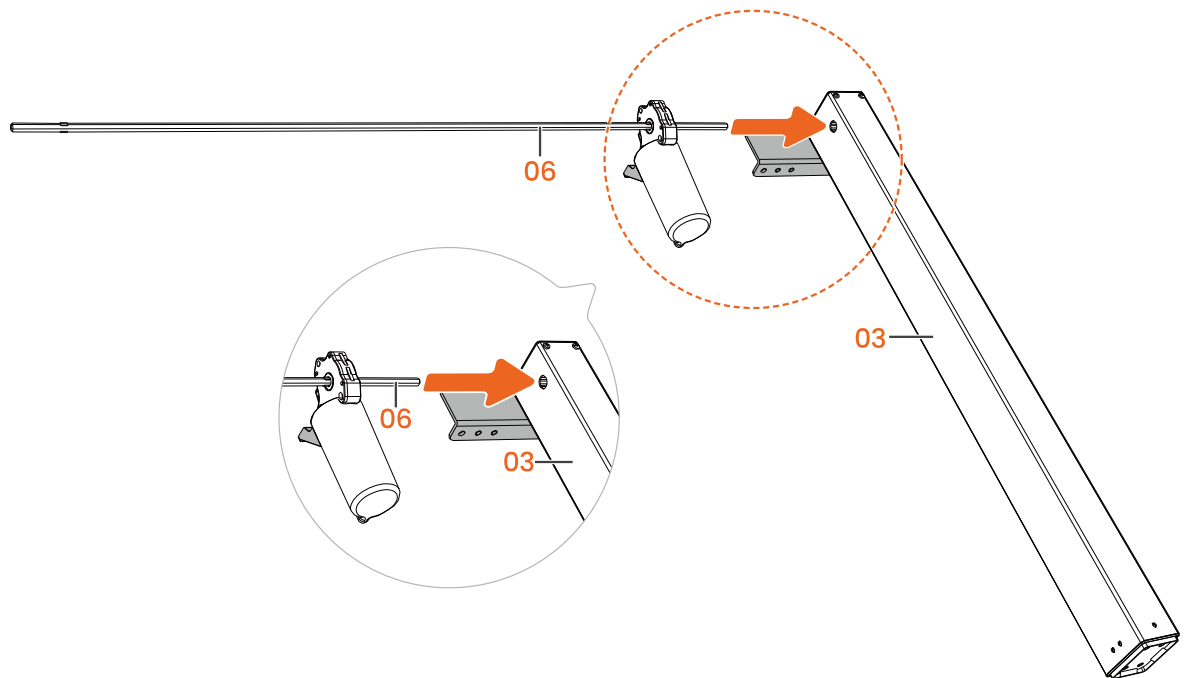

Insert the left leg onto the other end of the transmission rod.

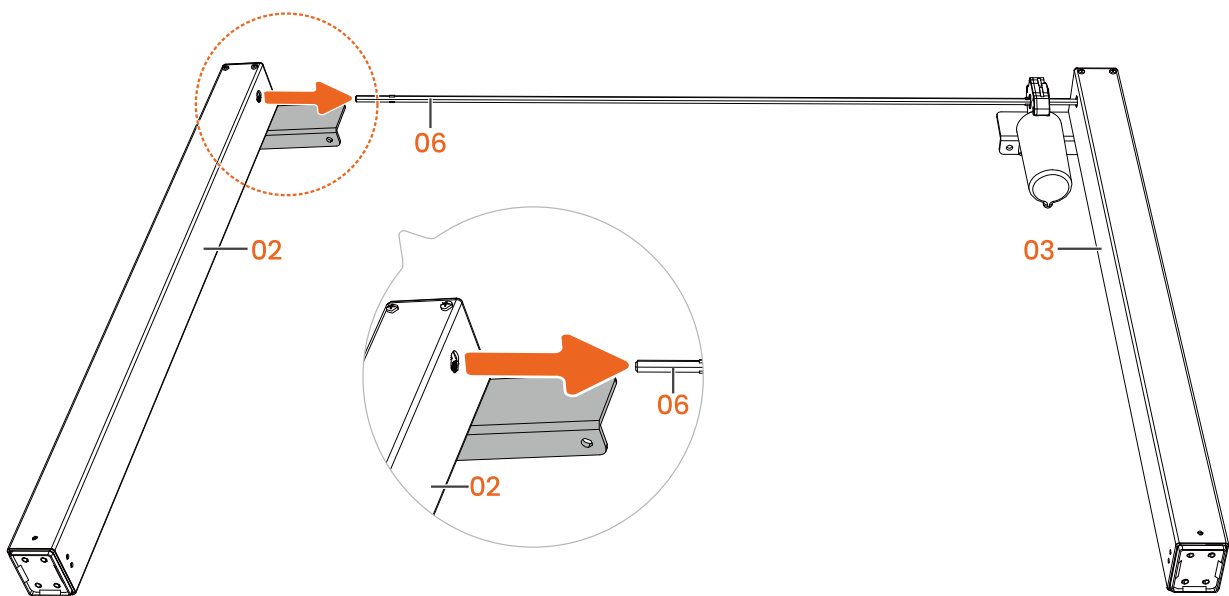

Note: If the transmission rod doesn't fit smoothly into the hole in the left leg, use the wrench to fine-tune the position.

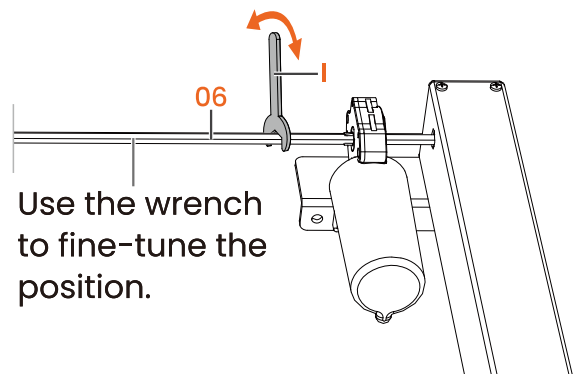

Carefully flip each leg over one by one.

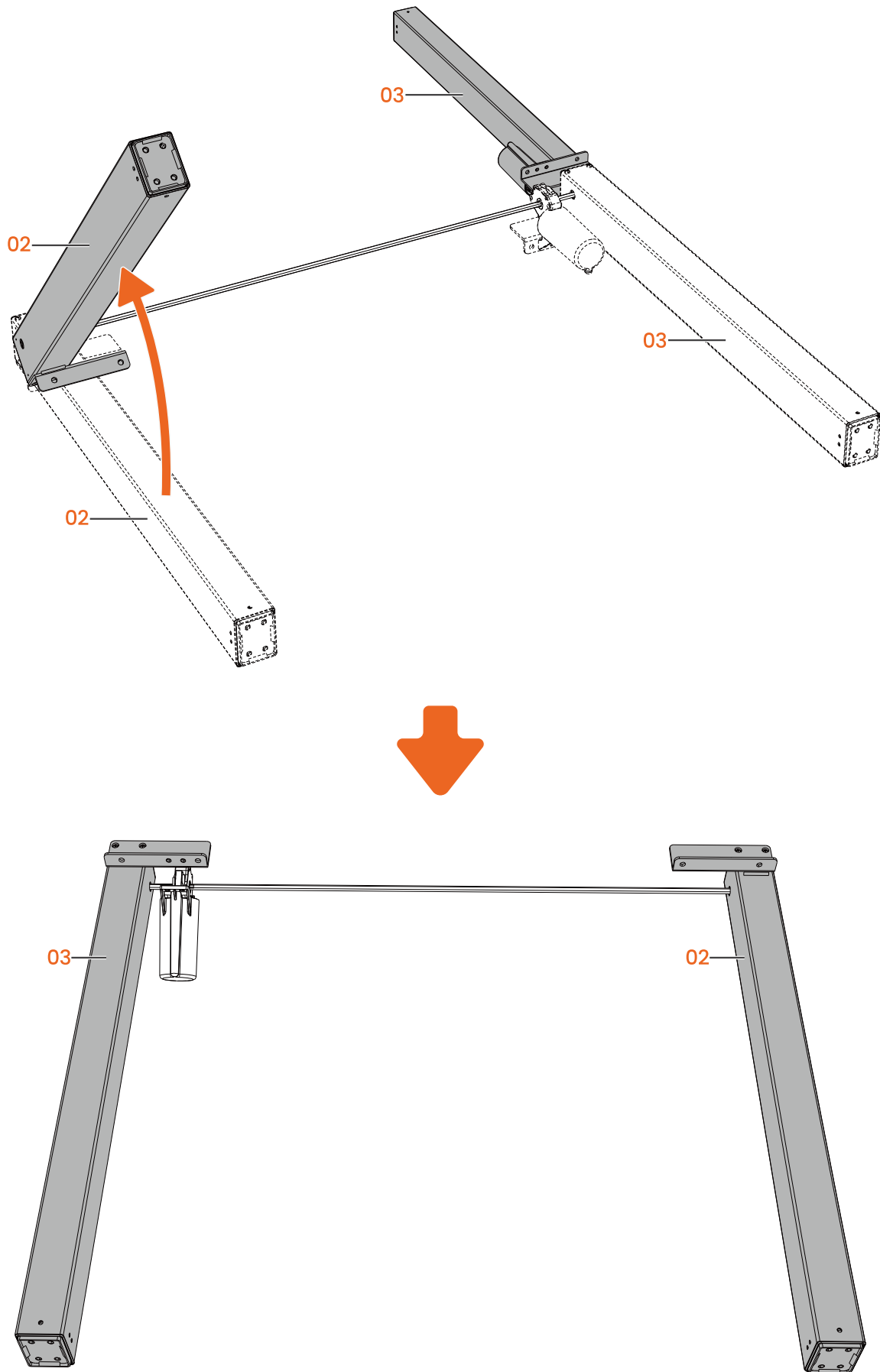

Secure the crossbar to the right leg, then to the left leg. If the holes in the crossbar and left leg are not aligned, adjust the left leg to align.



Note: When tightening the bolts, press the crossbar downward.

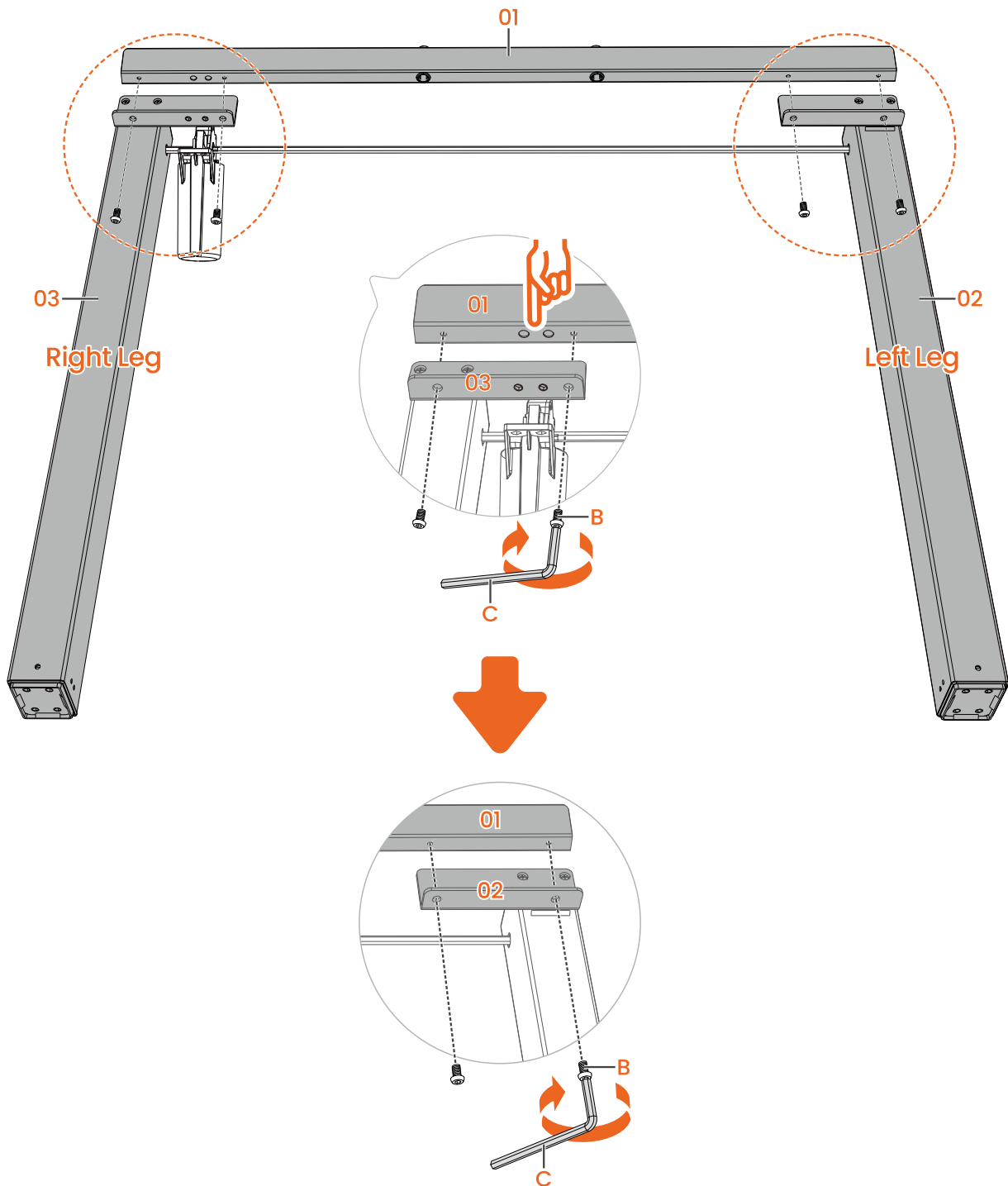

Secure the motor.

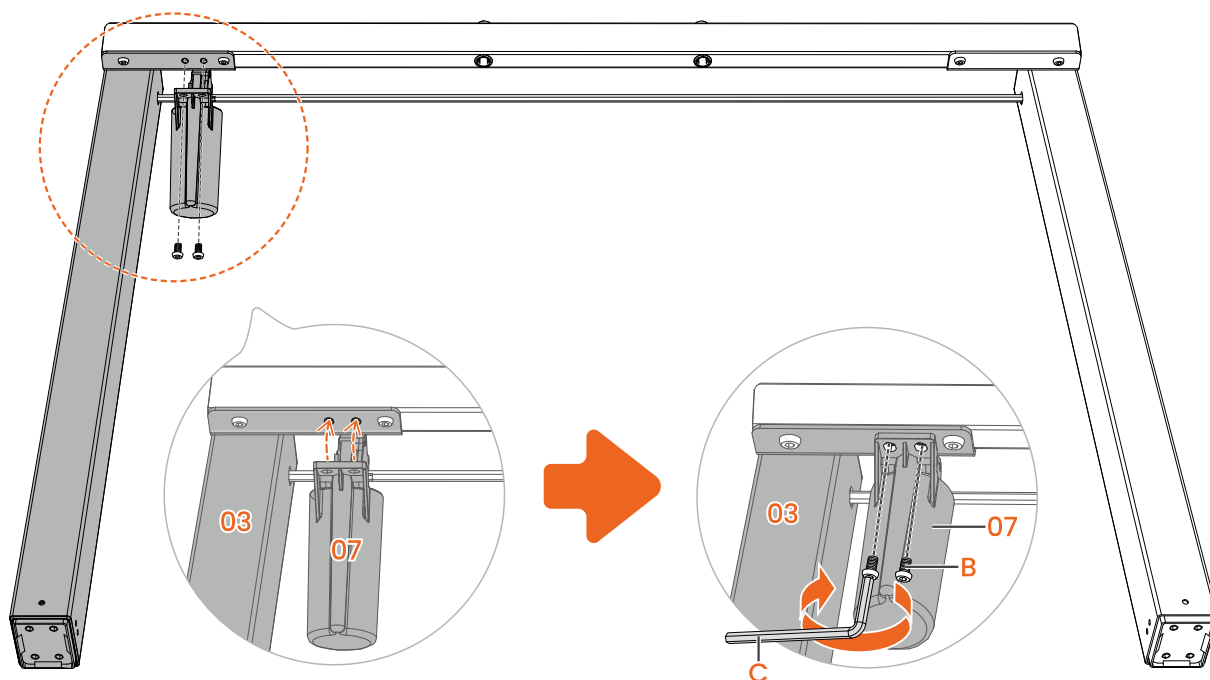

Attach the leg bases.

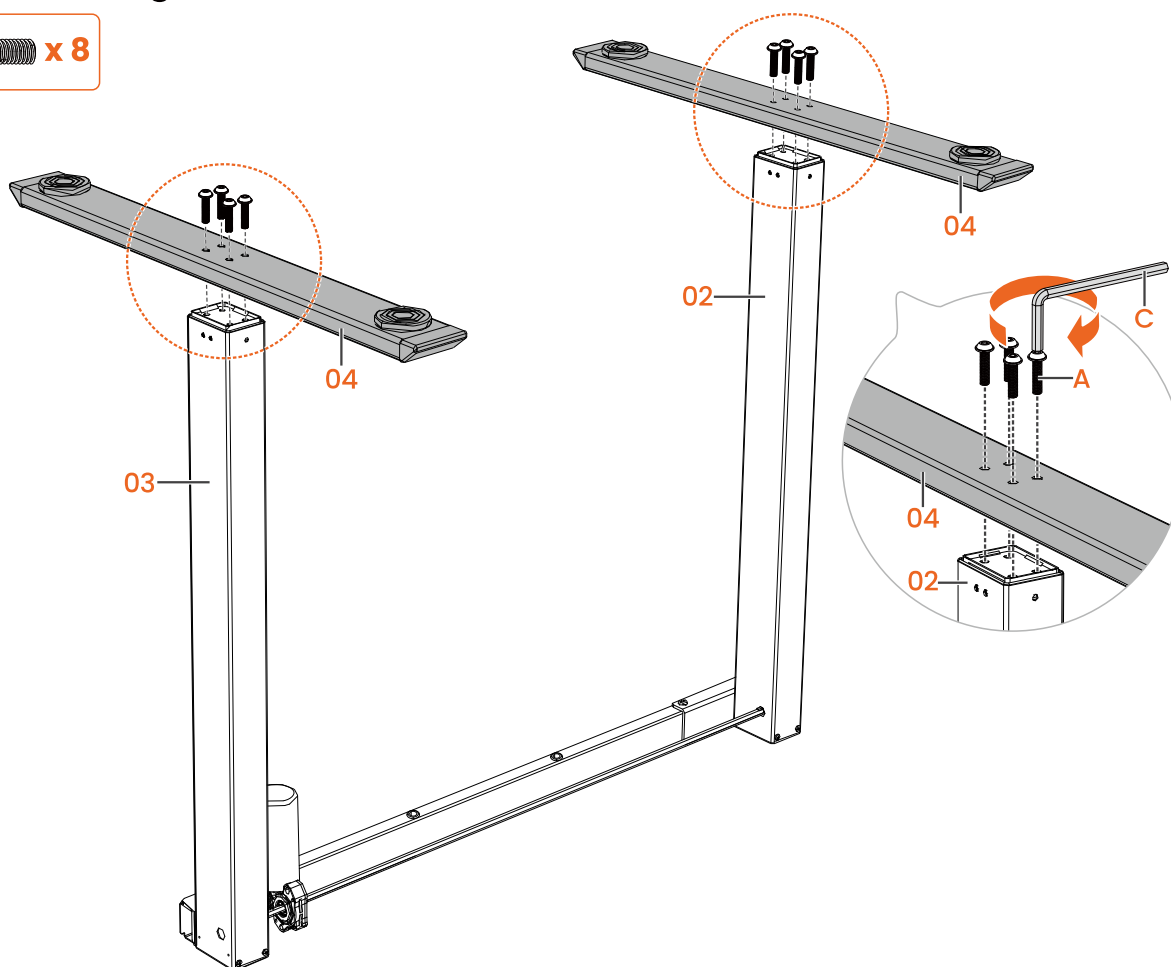
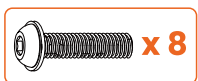

Attach the side plates.

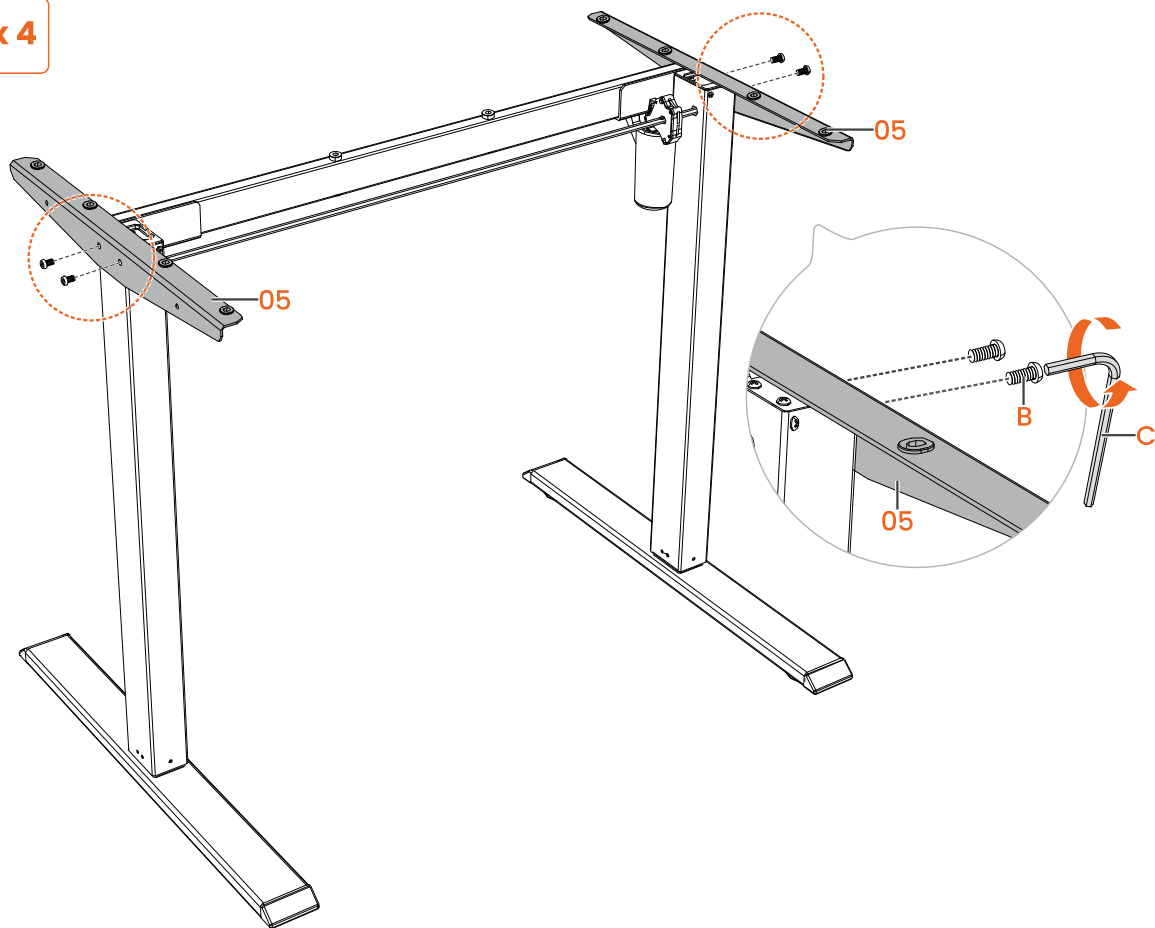

Ensure the rubber pads are attached to the frame. If any have fallen off, reattach them or use the spare rubber pads.

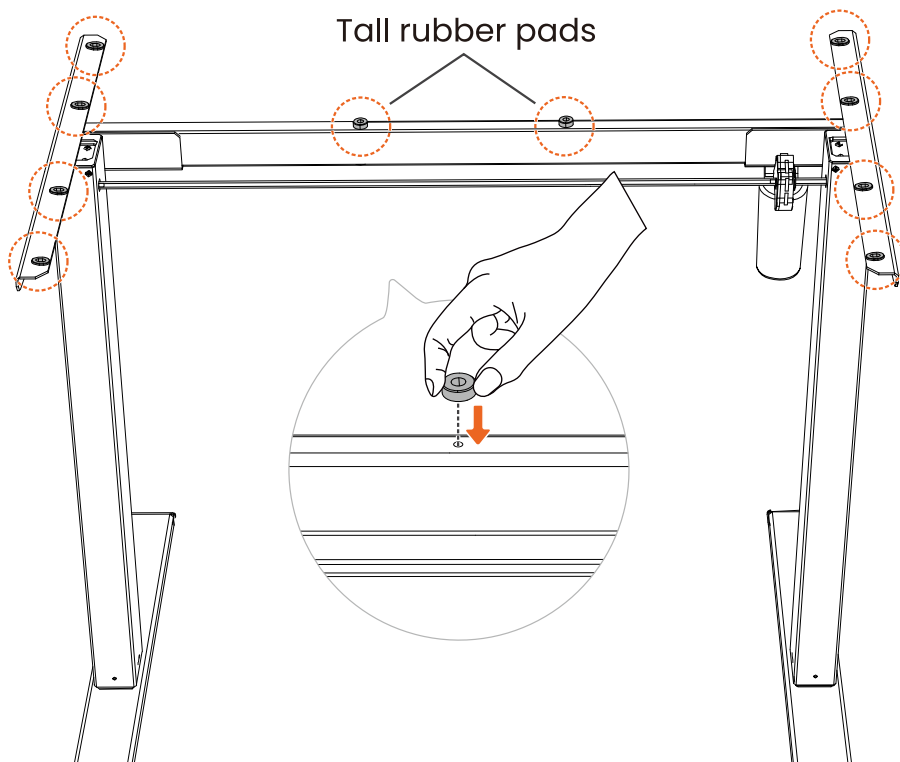

Step 2 Assembling the Top Stand

Screw the cam bolts in and push the wood dowel pins into the drawer top panel.



Note: The holes for wood dowel pins are set toward the back of the panel.

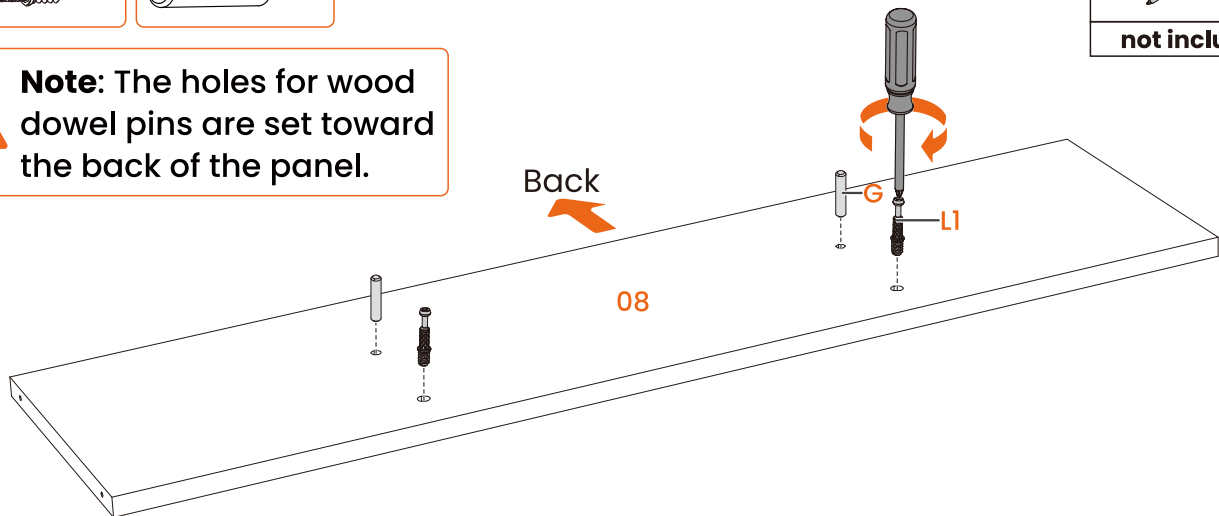

Position the drawer side panels as indicated below. Secure the panels with the cam locks.



Note: These holes face the back.

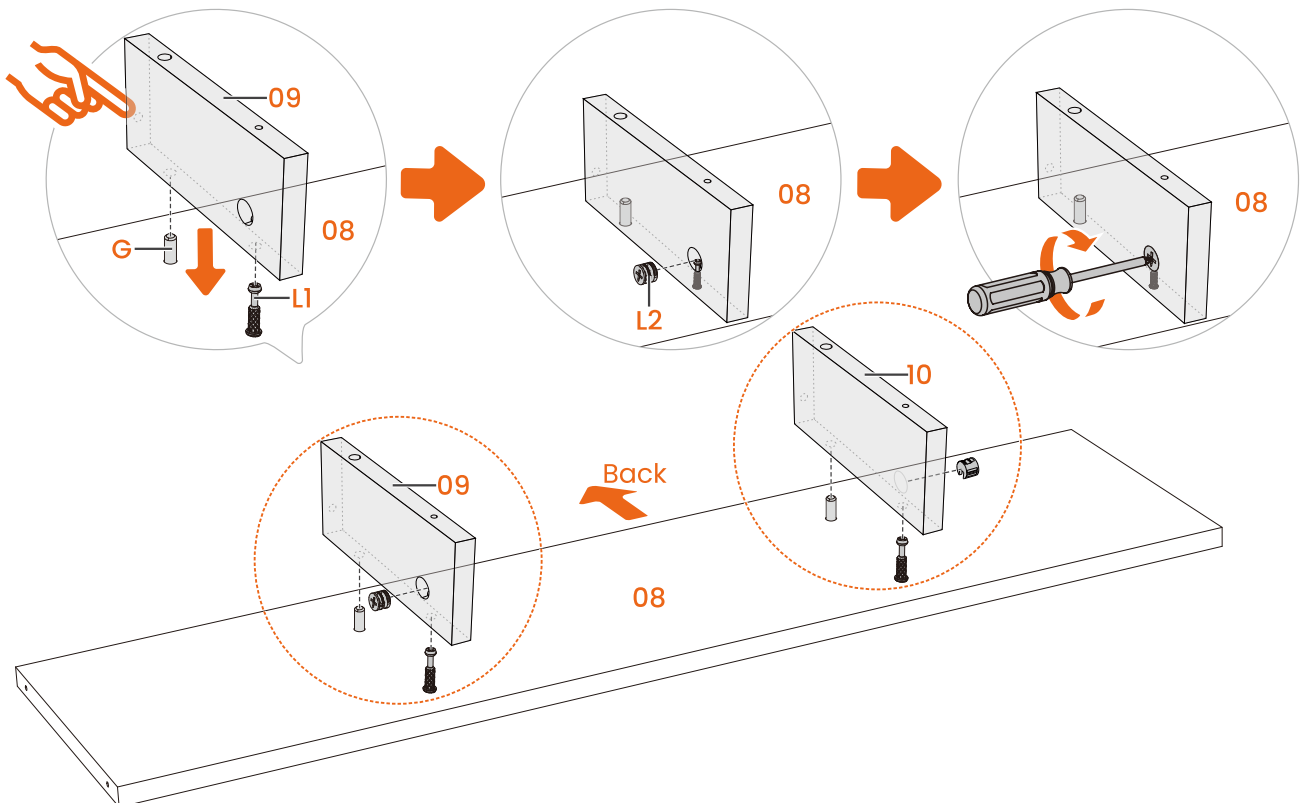

Step 3 Assembling the Desktop



Tip:  indicate pre-drilled hole locations.

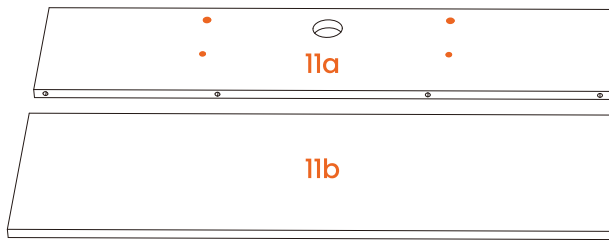

Top

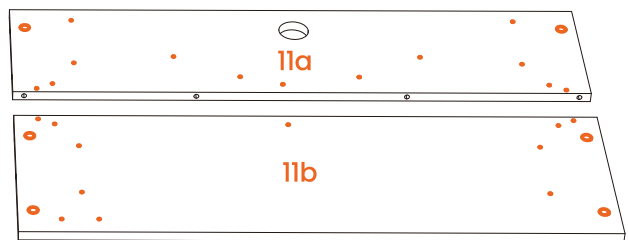

Bottom

For 40" long desk

Use four wood dowel pins to join the two desktop panels together.

 x 4

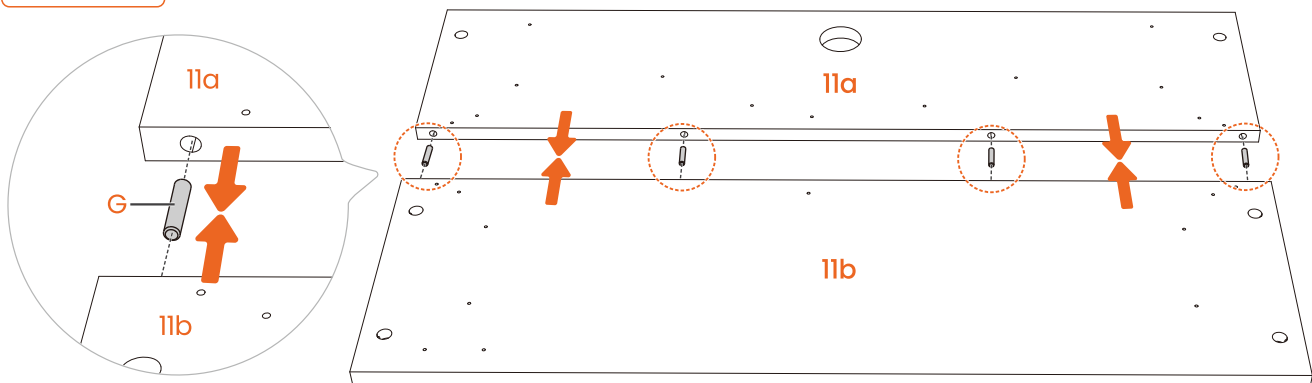

Secure the desktop panels with the connectors.

 x 6

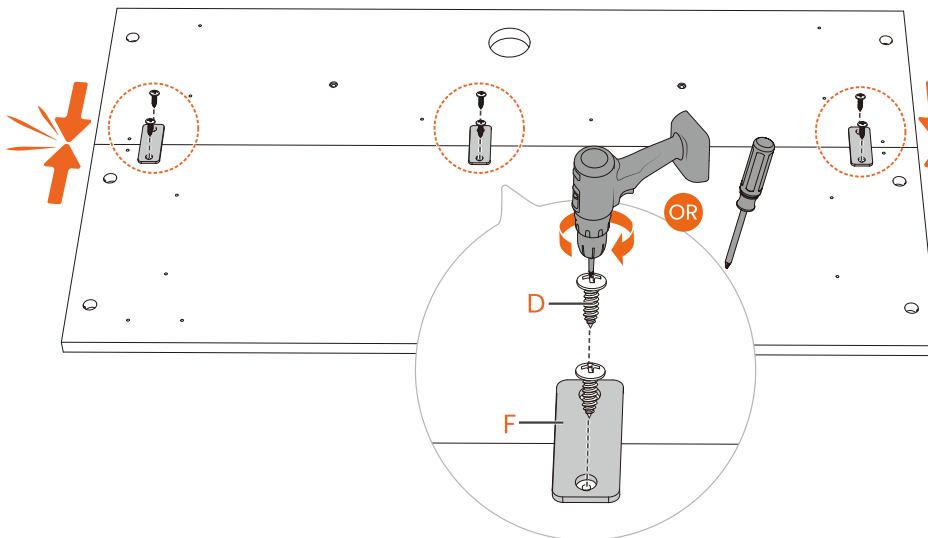

Drill with
suitable
torque and
speed  OR 
not included

Press tightly
together to
ensure no gap

For 48" long desk

Use five wood dowel pins to join the two desktop panels together.

 x 5

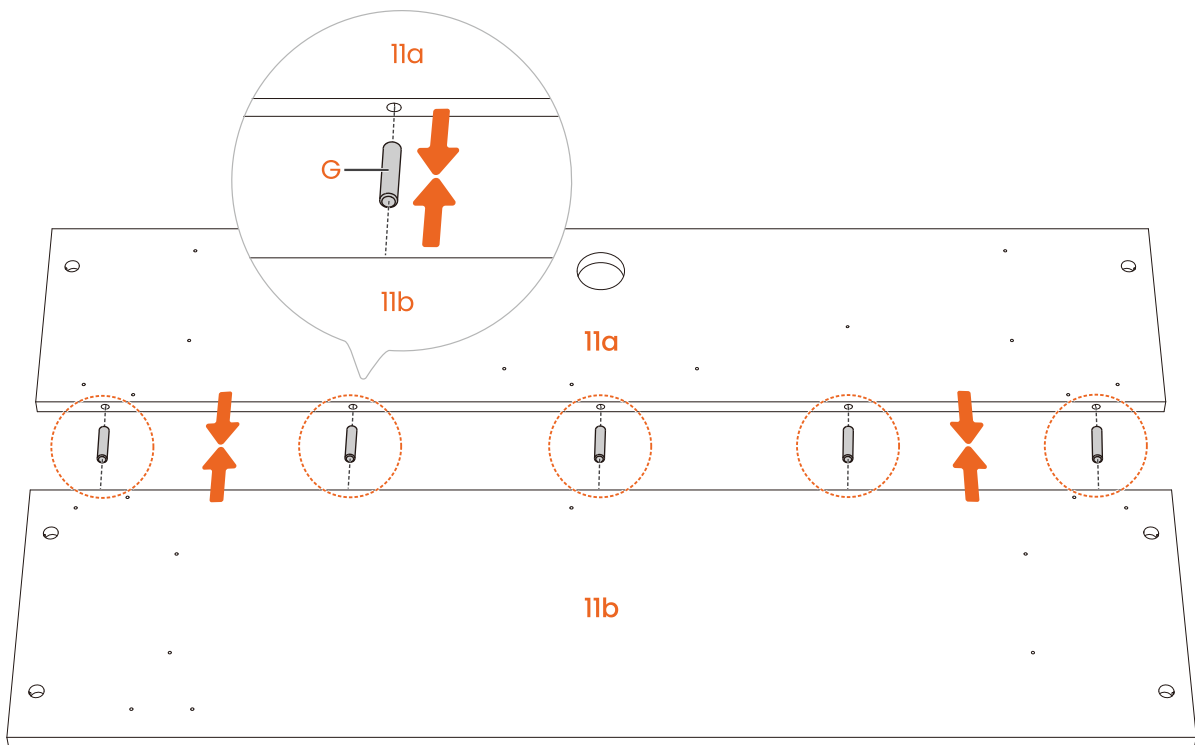

Secure the desktop panels with the connectors.

 x 6

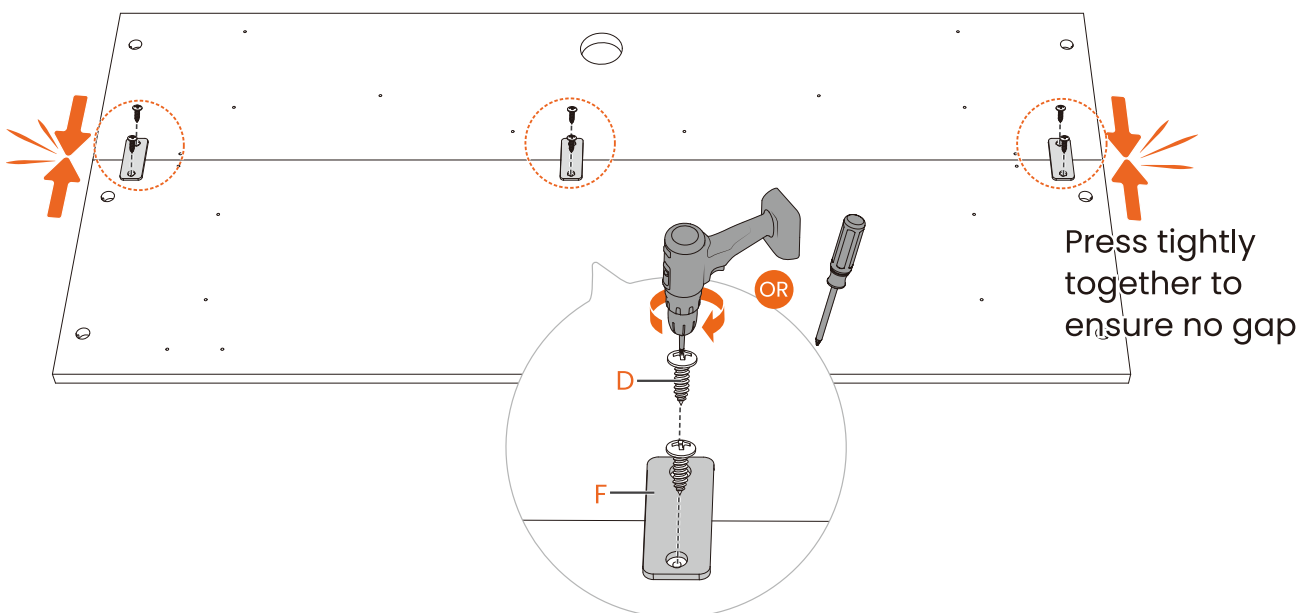

Push the wood dowel pins into the side panels.

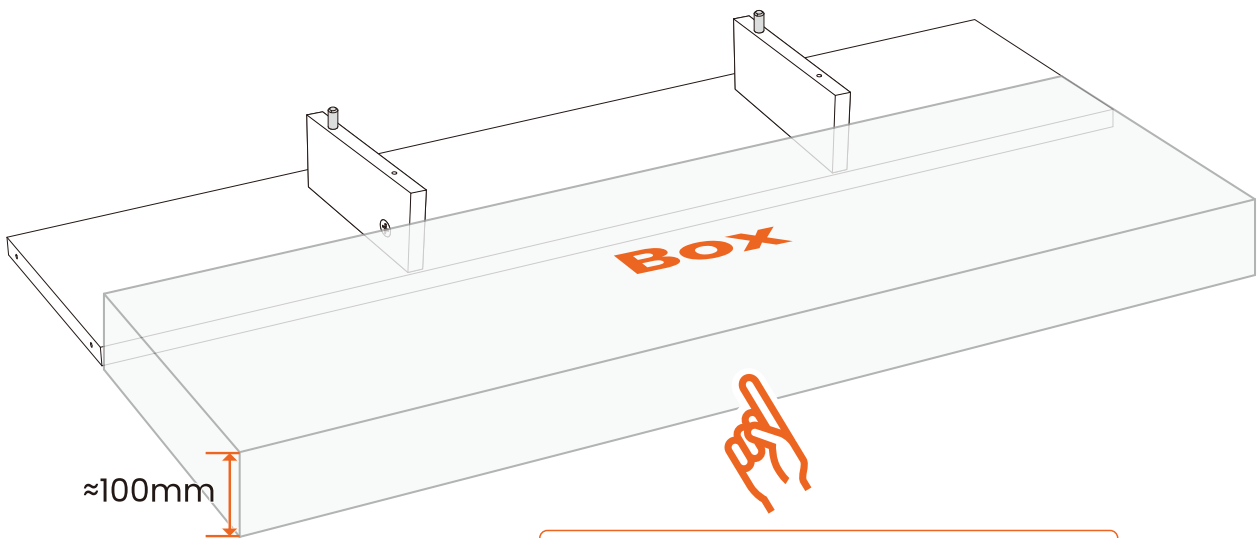
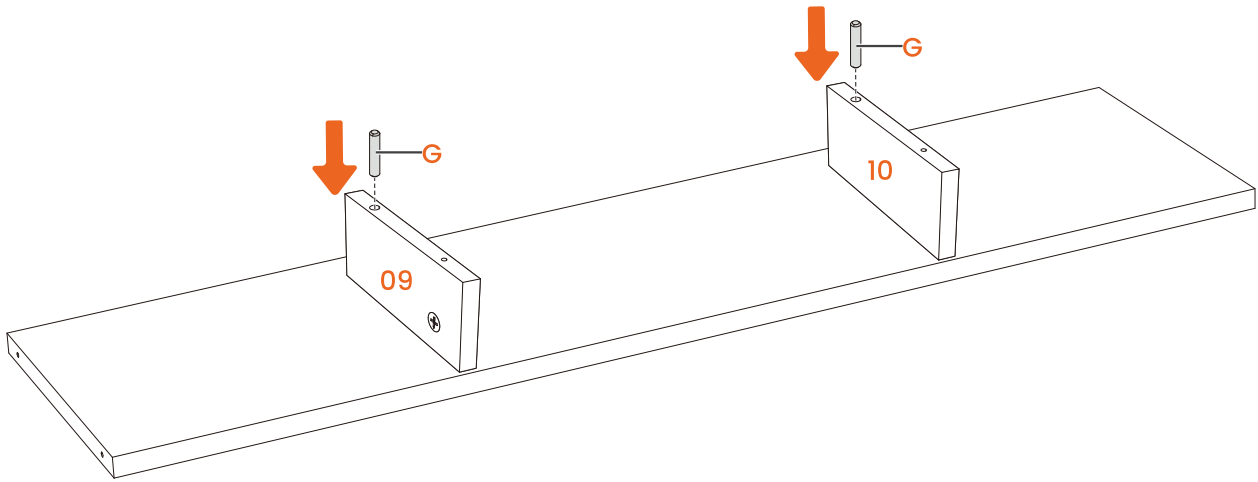

Tip: Use a box to support the desktop before positioning.

Carefully lift and attach the desktop.



HEAVY! You may need assistance with this step.

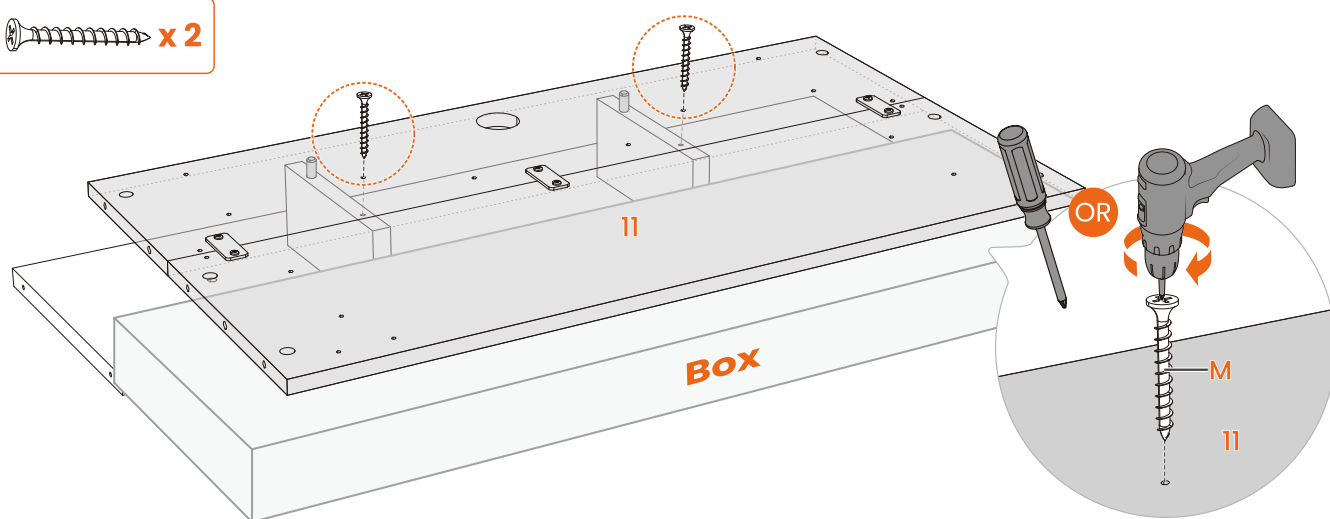
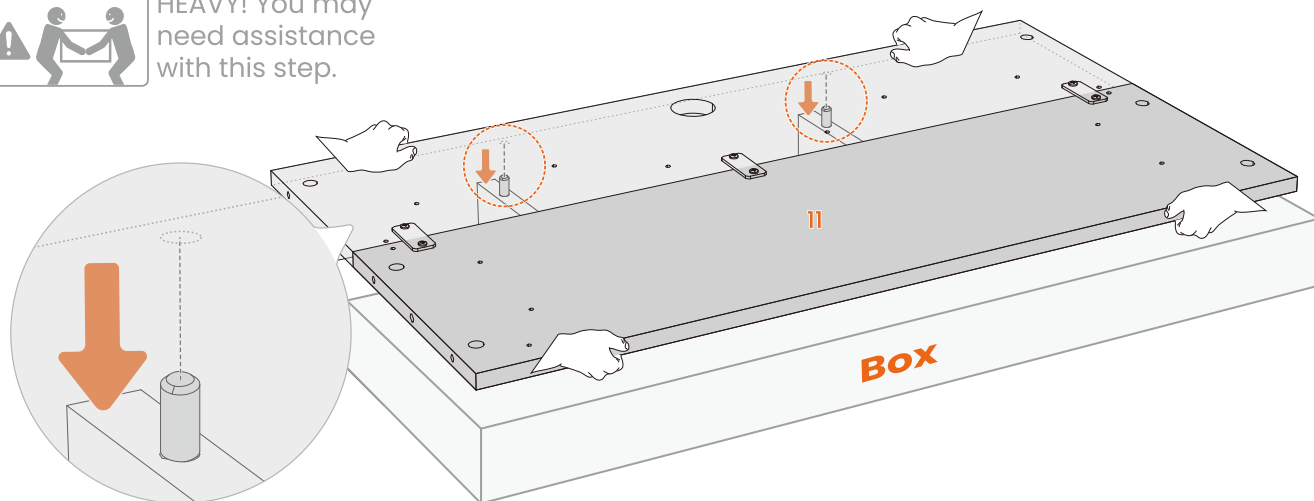

Screw the cam bolts in and push the wood dowel pins into the drawer side panels.

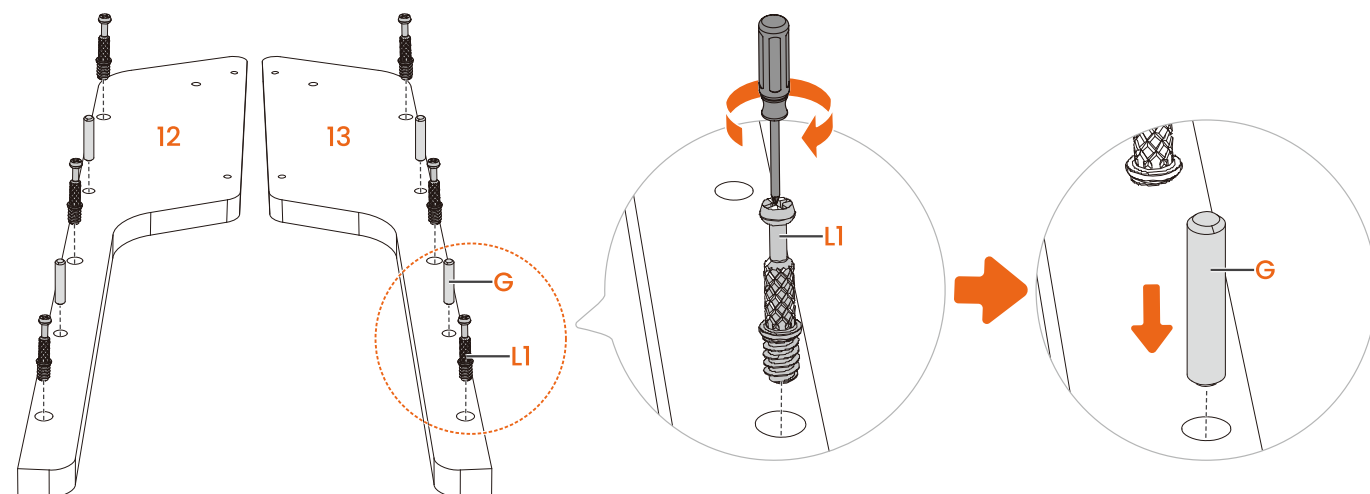

Secure the drawer side panels with the cam locks and screws.

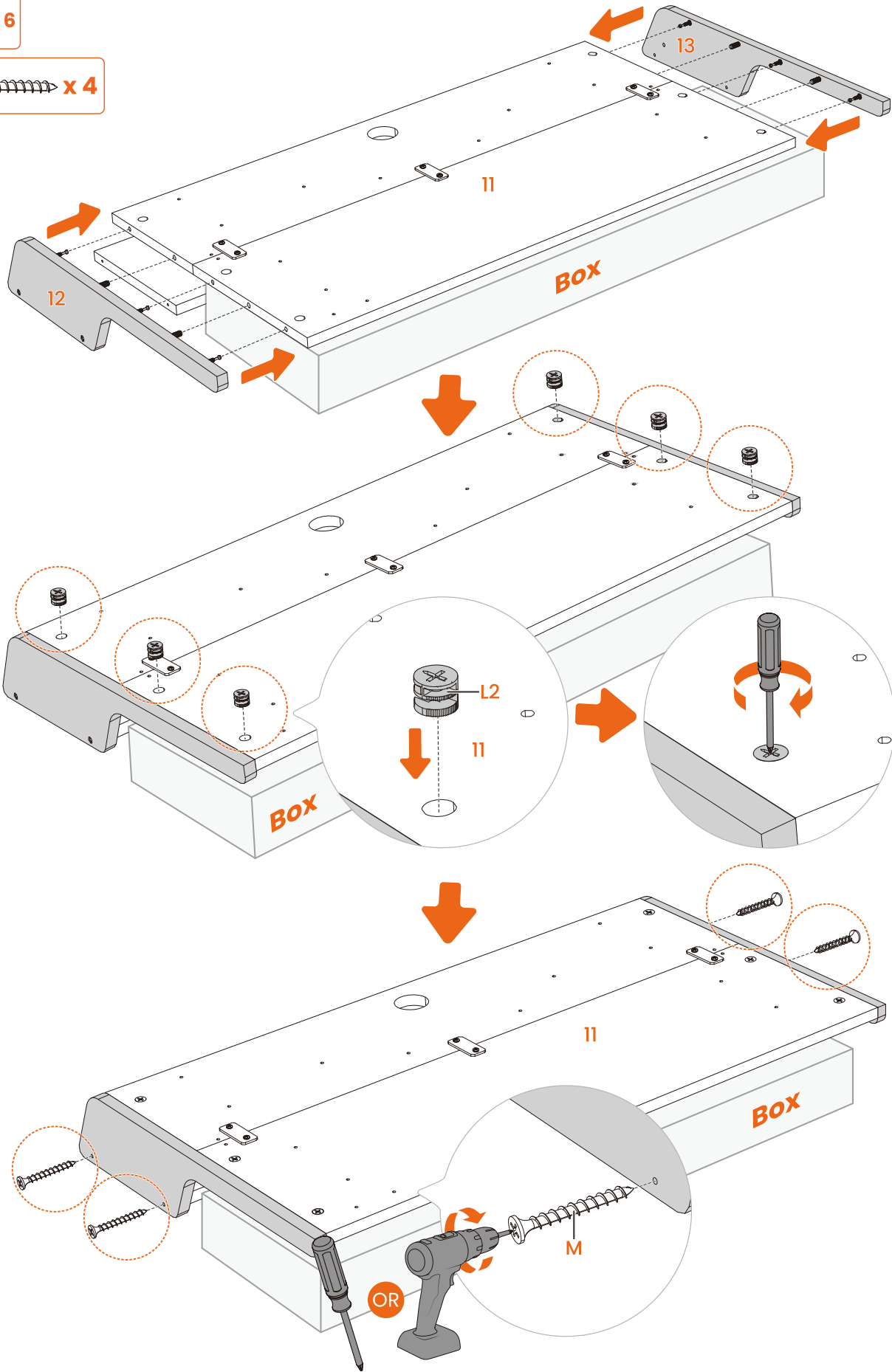

Step 4 Attaching the Frame

Attach the frame to the desktop.

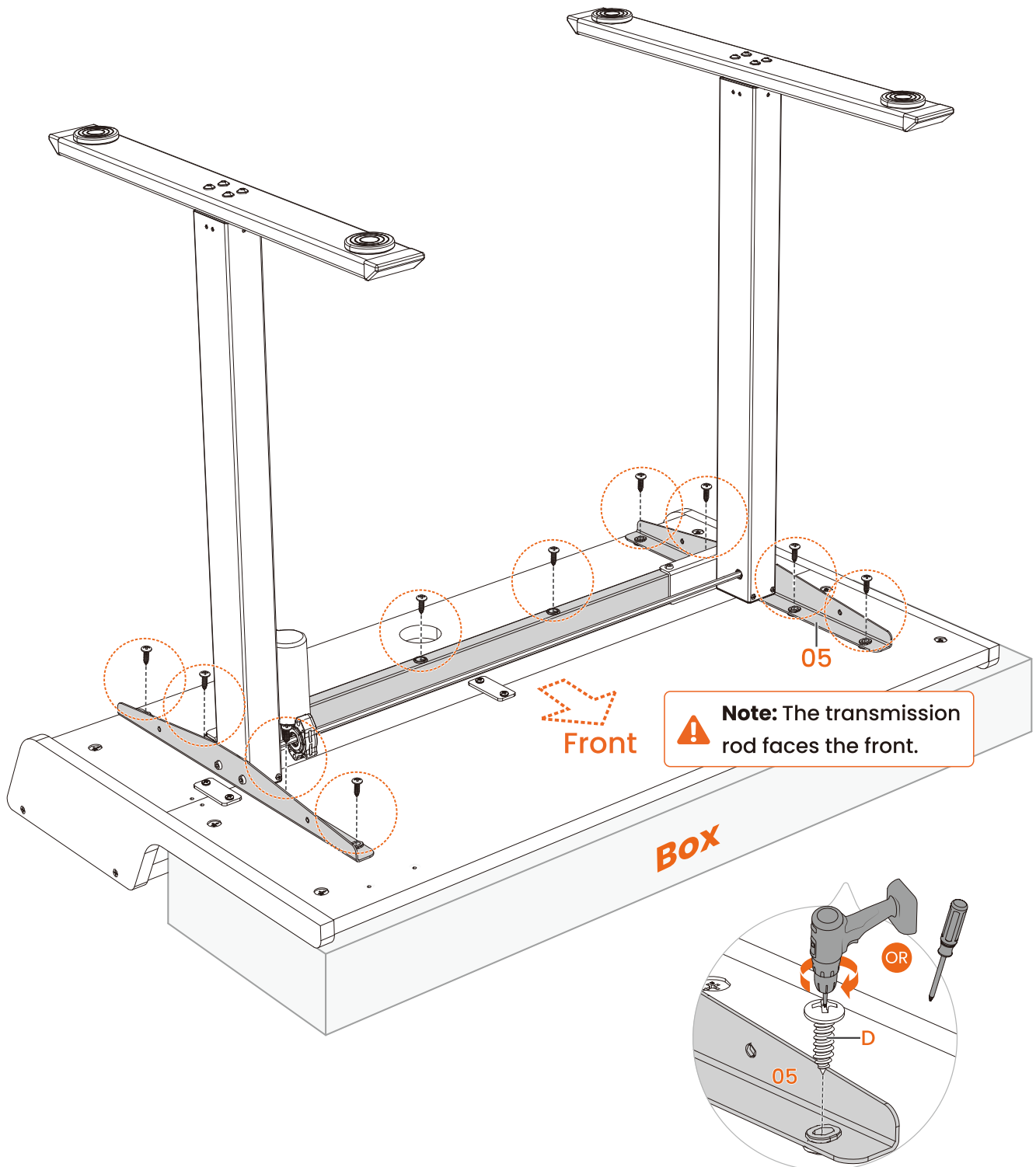
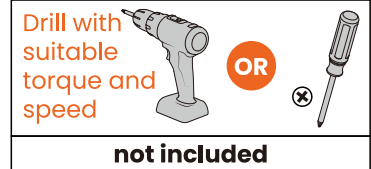

Attach the storage hooks and controller to the desktop.

For 40" long desk

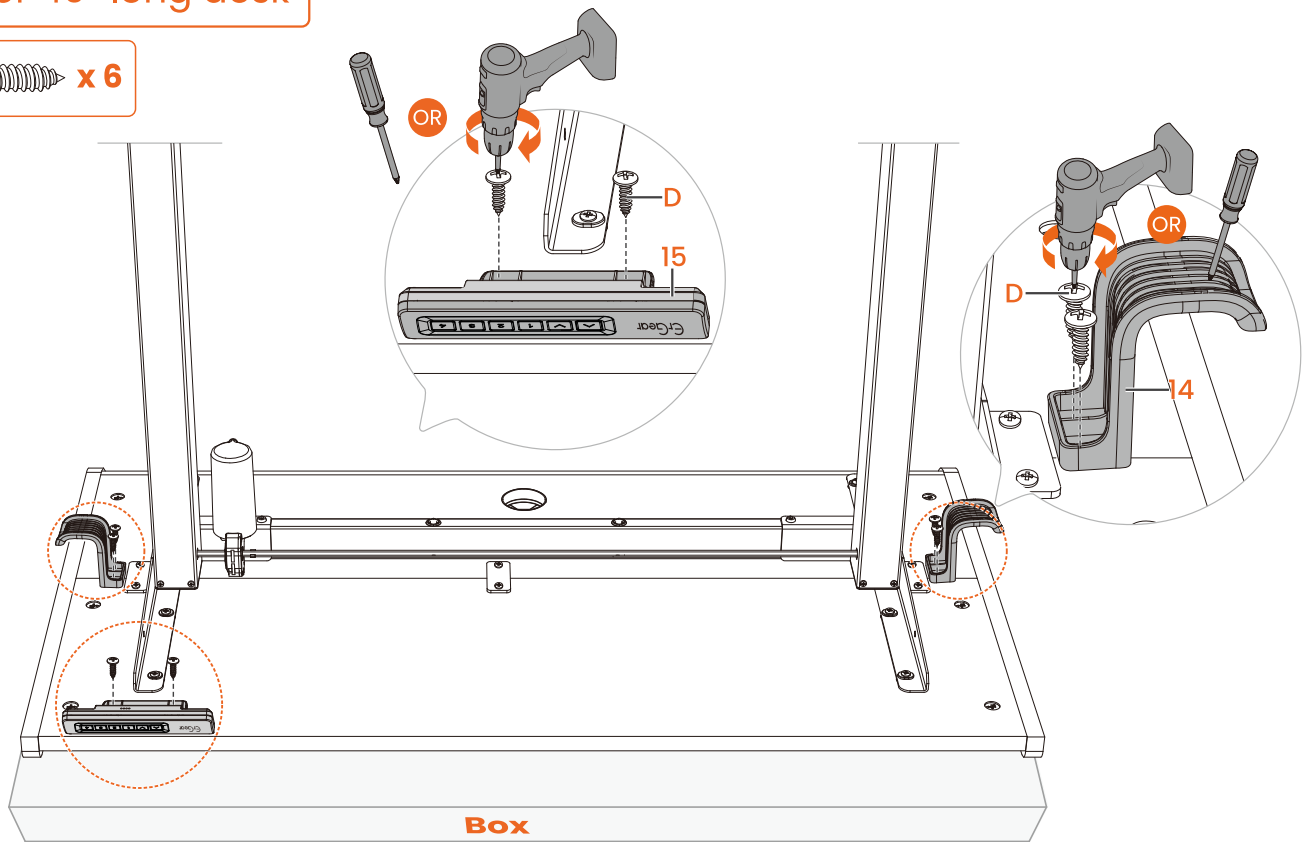

For 48" long desk

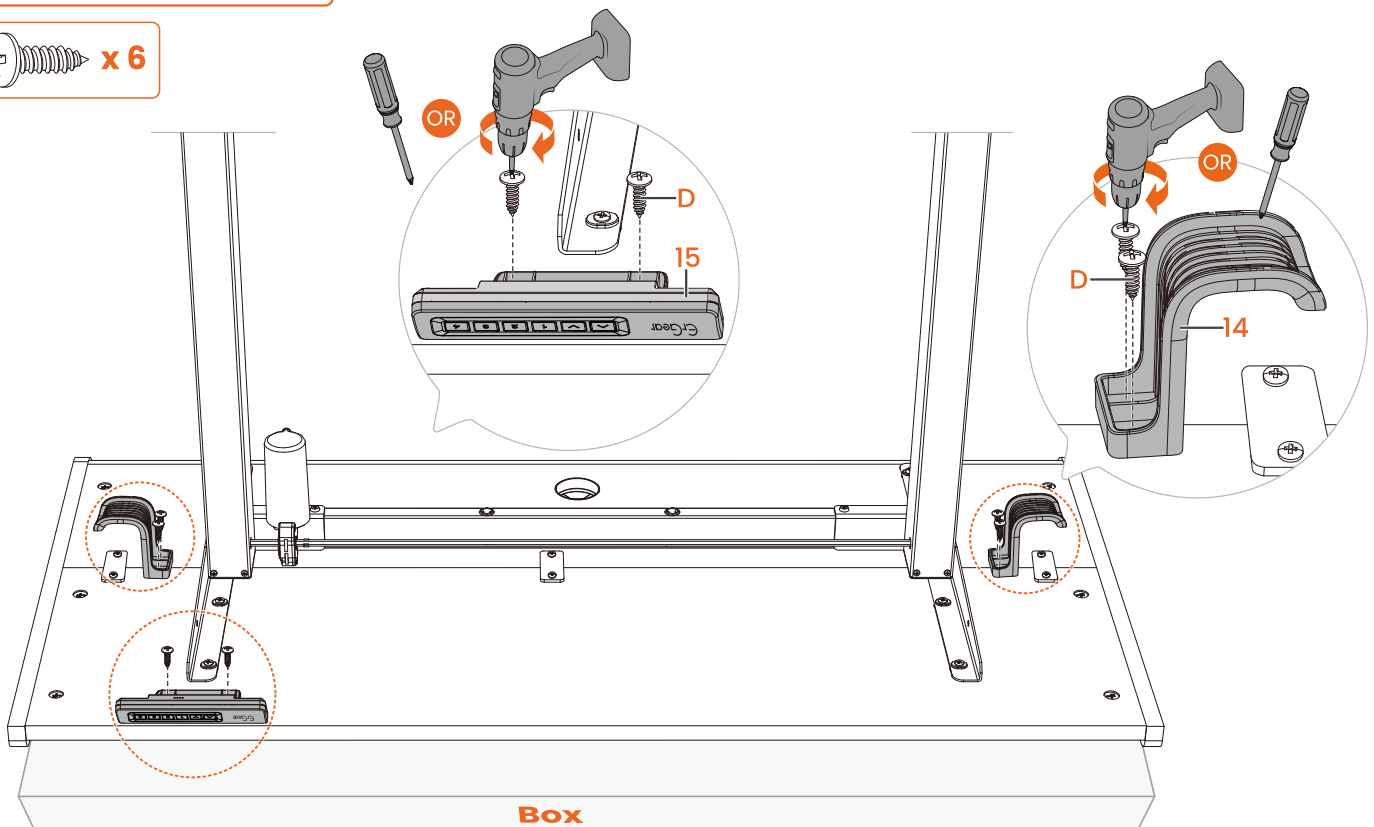
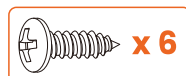

Step 5 Connecting the Cables

Note: An example of a cable clip layout is indicated below. However, the cable clips can be arranged according to your needs.

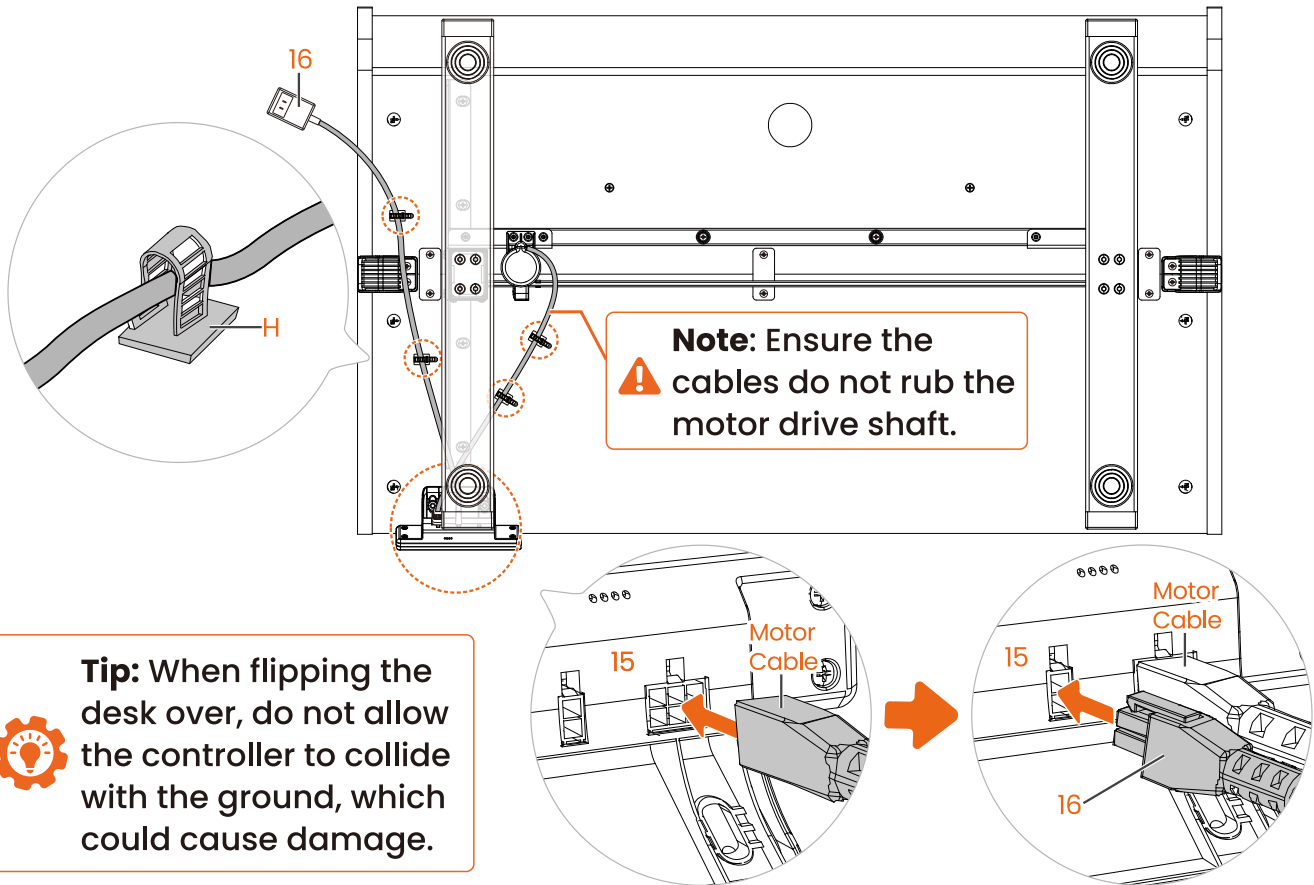

Insert the grommet cover.

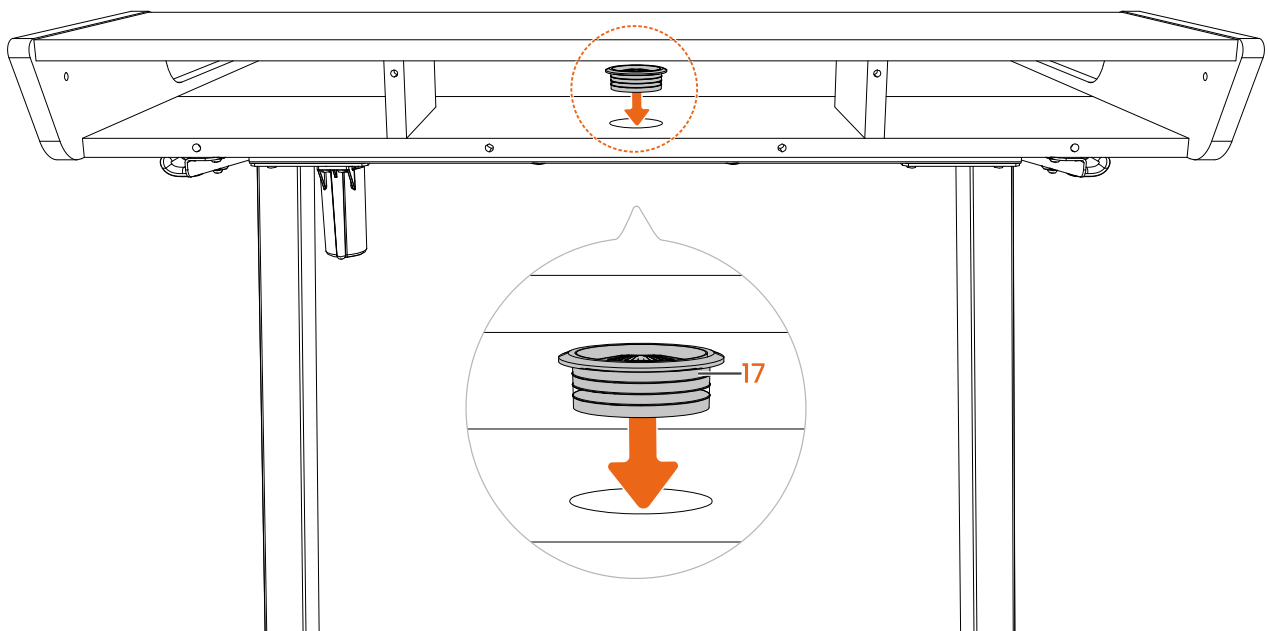

Attach the felt backstop with its support pins inserted into the holes of the side panels, then secure with the plastic rivets.

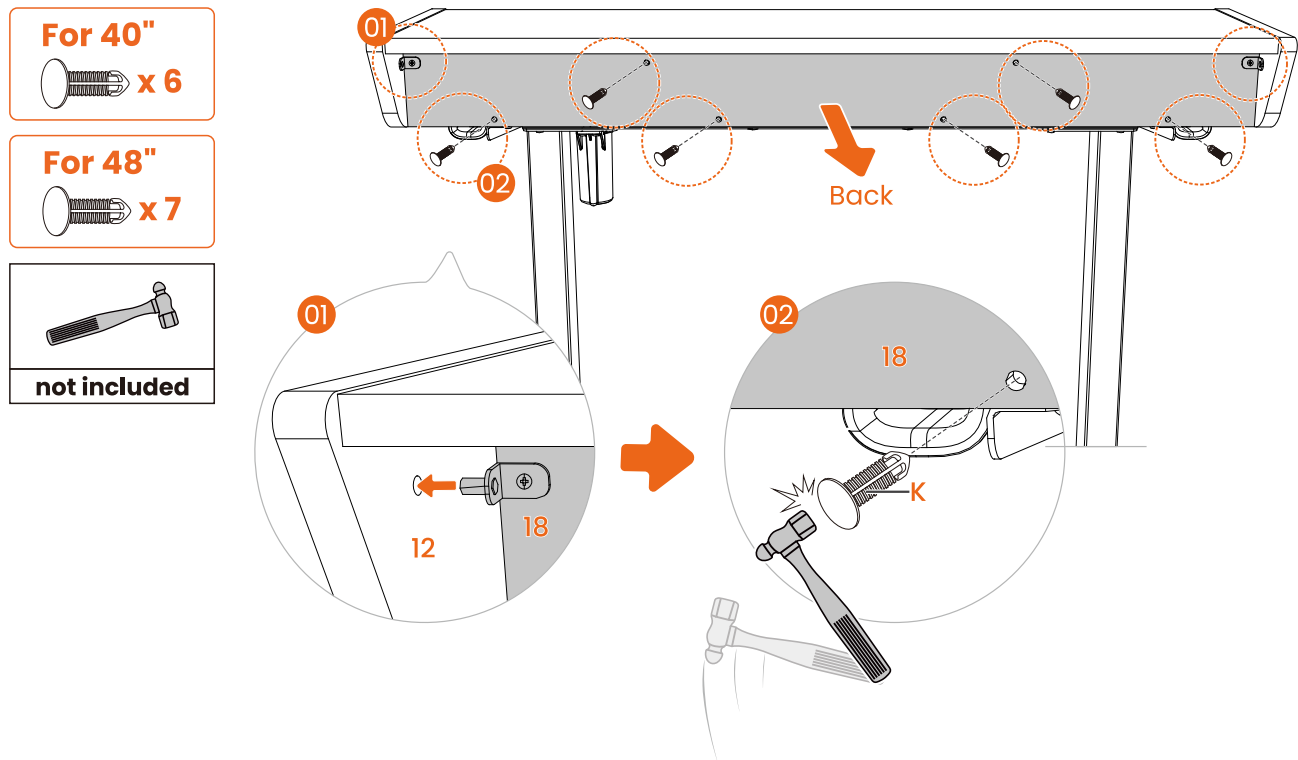

⚠ Note: The positions of plastic rivets for a 40" long desk are indicated above. However, the positions of plastic rivets for a 48" long desk may vary.

Step 6 Attaching the Drawers

Unfold the fabric drawers, then place the boards on the bottoms of the drawers.

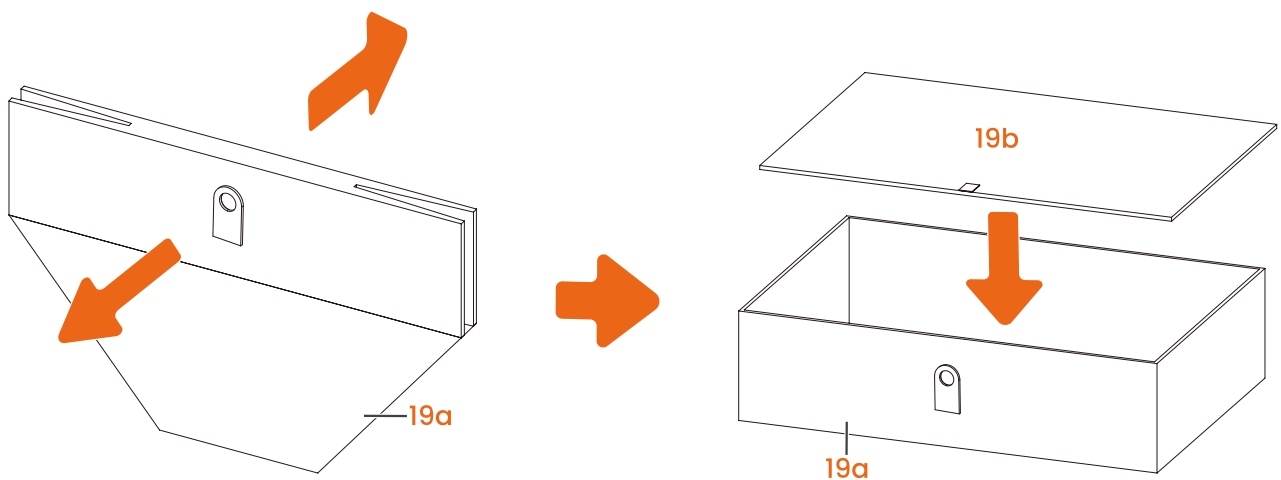

Insert the fabric drawers.

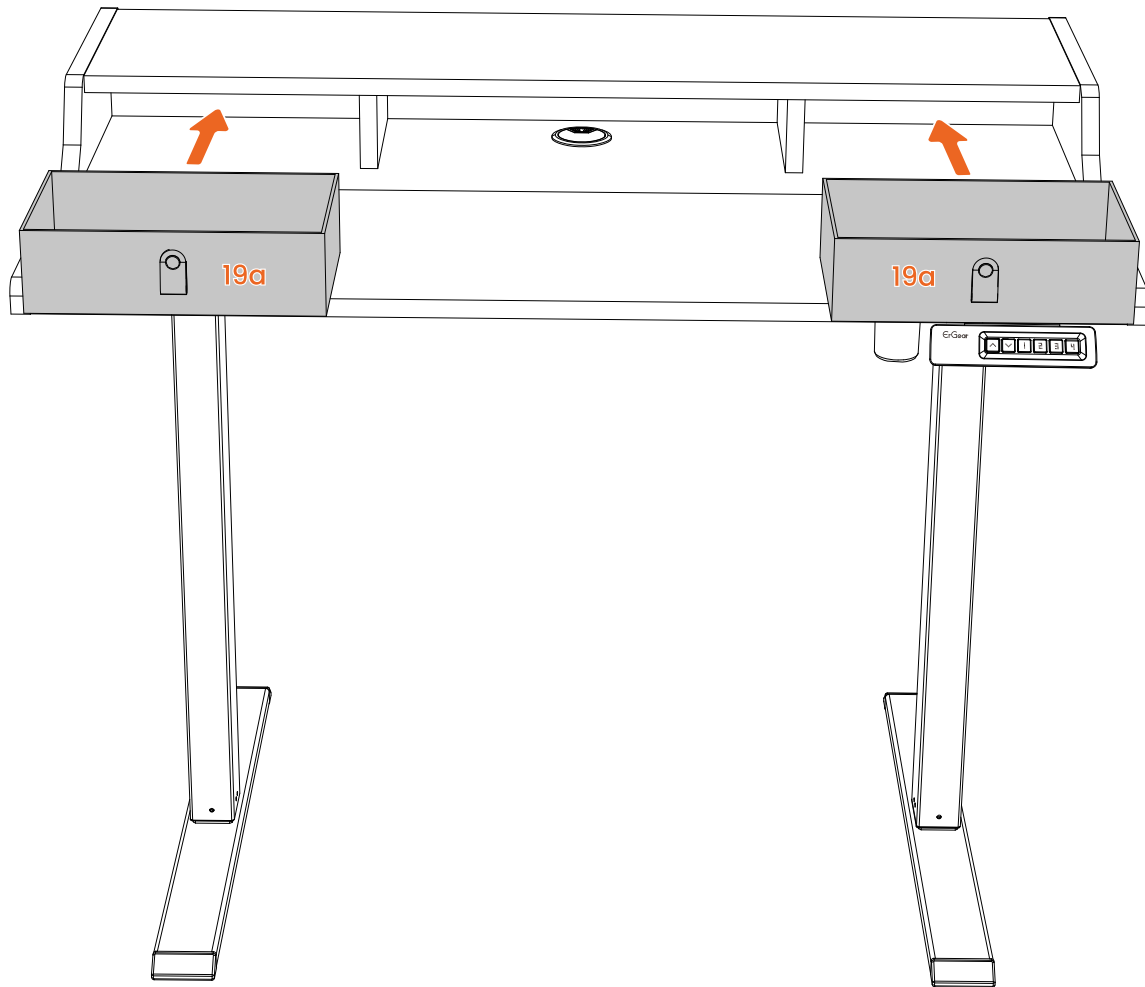

Using the Controller

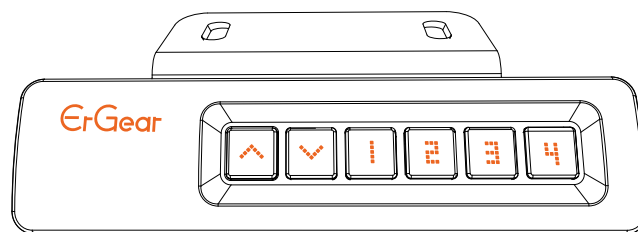

Tip: Reset before first use.

Note: Ensure that there are no obstacles when using the desk, that the desktop is not too close to the wall, and that all cables are long enough for the desk to move up and down freely. When the controller screen is off (power-saving mode), press any button to wake it before operating the desk.

Suggestion: Set the most comfortable height when you sit down to **1** and the most comfortable height when you stand up to **2**. The other two presets can be set for another user or to other heights you want to use.





Raise the Desk

Press the  button to raise the desk continuously until it reaches the highest position of 46.8" (119cm) or the button is released.

Lower the Desk

Press the  button to lower the desk continuously until it reaches the lowest position of 27.9" (71cm) or the button is released.

Save Height Settings

Four heights can be stored. Press and hold the  /  /  /  button for 3 seconds. The digital number will flash three times and the current height will be stored to that button.

Select Height Setting 1

Press the  button. The desk will move to the height that was previously set for that button. Press any button to stop the desk.

Select Height Setting 2





Press the  button. The desk will move to the height that was previously set for that button. Press any button to stop the desk.

















Select Height Setting 3

Press the  button. The desk will move to the height that was previously set for that button. Press any button to stop the desk.

Select Height Setting 4

Press the  button. The desk will move to the height that was previously set for that button. Press any button to stop the desk.

Settings	
Reset	<div>1. Press and hold the  button until the desk goes down to its lowest level, then release the button.</div> <div>2. Press and hold the  button for 5 seconds until the screen displays 'RST,' then release the button with 'RST' flashing.</div> <div>3. Press and hold it again until the desk goes down to its lowest level and comes back up slightly. The screen will display current height again, and reset is complete.</div> <div>Note: It is recommended that you remove all items from the desktop before performing a reset.</div>
'RST' displays as  on the screen.	
Lock/Unlock	<div>Press and hold  and  buttons together for 3 seconds to turn the lock on. The screen will display 'LOC' and the buttons will be disabled. Repeat to turn the lock off again.</div>

Change Display Height Units	Press and hold  and  buttons together for 3 seconds to switch the display height unit. The default unit is imperial.
Change Collision Detection Sensitivity	<p>1. Press and hold  and  buttons together for 3 seconds, and 'S02' will flash on the screen. The last digit displayed is the current sensitivity level, and the value range is 0–3 (0: off; 1–3: highest to lowest).</p> <p>2. Select other levels by pressing  or  button, and then press and hold  and  buttons together for 3 seconds. The digits will stop flashing, and the screen will display current height again.</p> <p>Note: Sensitivity is preset to Normal by the factory. However, sensitivity may be adjusted if needed.</p>
Set/Clear Lowest Limit	<p>1. To set the lowest height limit, press and hold  and  buttons together for 3 seconds, and the screen will display '–dO.' Whenever the desk reaches the lowest limit, the screen will display '–LO.'</p> <p>2. To clear the lowest height limit, move the desk down to the lowest height (screen displays '–LO') and press  and  buttons together for 3 seconds. '–dO' will flash on the screen, and the limit will be cleared.</p>
Set/Clear Highest Limit	<p>1. To set the highest height limit, press and hold  and  buttons together for 3 seconds, and the screen will display '–UP.' Whenever the desk reaches the highest limit, the screen will display '–HI.'</p> <p>2. To clear the highest height limit, move the desk up to the highest level (screen displays '–HI') and press  and  buttons together for 3 seconds. '–UP' will flash on the screen and the limit will be cleared.</p>

Troubleshooting

- Please try resetting the desk if you have any issues including the following:
 - Abnormal operation.
 - The controller screen displays 'RST' (reset).
 - The controller screen displays error message E01–E08, but the motor cable is correctly connected.
- If the controller screen displays 'HOT,' please wait 20 minutes for the motor to cool down before making any further height adjustment.