

PARTS LIST

Your TRINITY Foosball Cooler should include the following parts. Please inspect box contents to ensure you have received all components. You will need a Phillips screwdriver for assembly.

If you are missing any parts, need assistance with assembly or have questions, please contact TRINITY Customer Service: 800.985.5506 or customerservice@trinityii.com. Parts can also be requested online via our "Contact Us" section at www.trinityii.com.

A

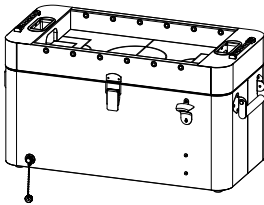

TUB (1)

B

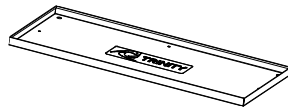

SHELF (1)

C

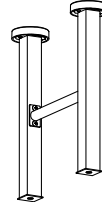

FRAME (2)

D

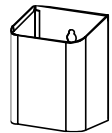

CAP CATCHER (1)

E



CASTER (4)

F



WRENCH (1)

G



GRAY PLAYER (8)

H



ORANGE PLAYER (8)

I



GRAY GOALIE (1)

J



ORANGE GOALIE (1)

K

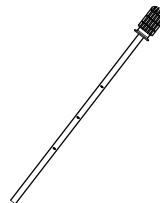

ROD (6)

L



**SCREW (18)
+ (2) extra**

M



END CAP (6)

N

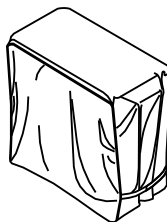

COVER (1)

O



BALL (3)

ASSEMBLY INSTRUCTIONS

STEP 1

Place FRAMES (C) upside down so that black circular receivers are on floor and approximately SHELF (B) width apart.

Align holes in SHELF (B) with bottom of FRAME (C), making sure that SHELF Lip is facing downwards.

Screw CASTERS (E) into bottom of FRAMES (C), securing SHELF (B) in-between. Tighten all CASTERS (E) with provided WRENCH (F).

Use provided caster wrench to tighten completely. Failure to do as instructed could result in caster stem breaking.

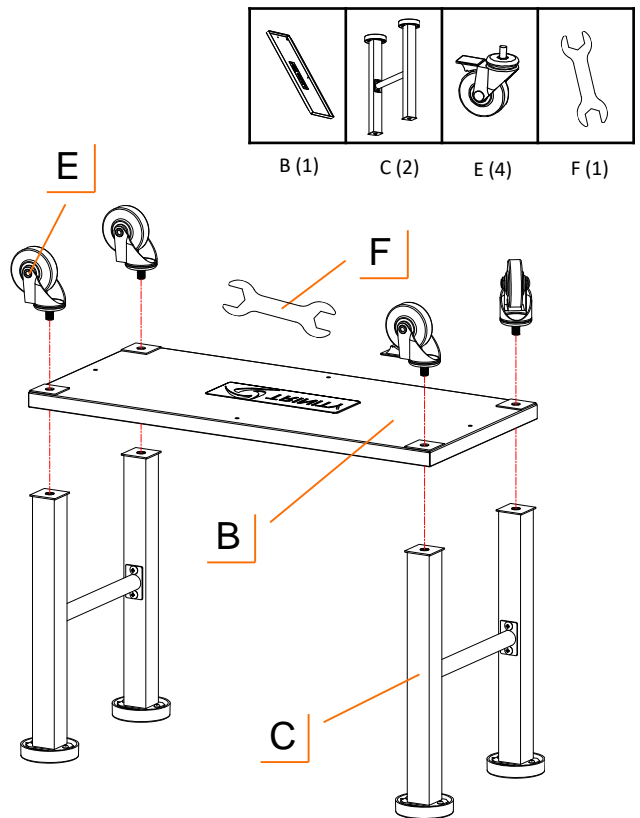

STEP 2

Carefully turn cart right side up. Set TUB (A) on top of Cart. Make sure Tub Feet sit securely inside receivers on top of FRAME (C).

Attach CAP CATCHER (D) to TUB (A) by sliding it downward, over metal notches.

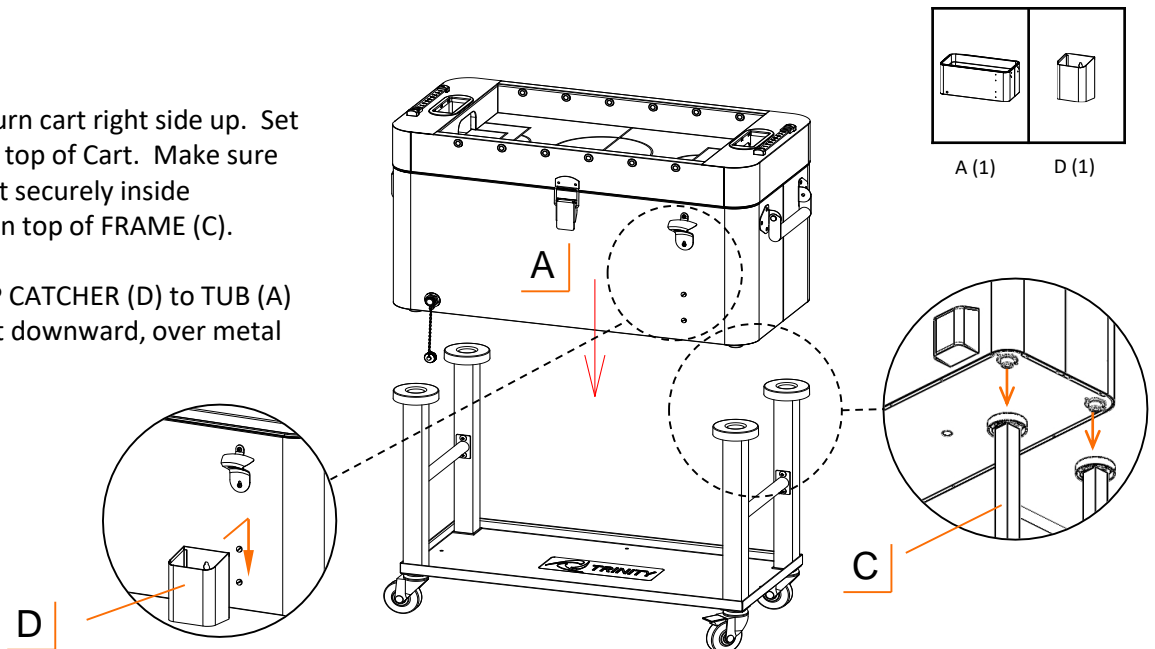

ASSEMBLY INSTRUCTIONS

STEP 3

Identify correct players and goalies and ensure they are in correct position and orientation.

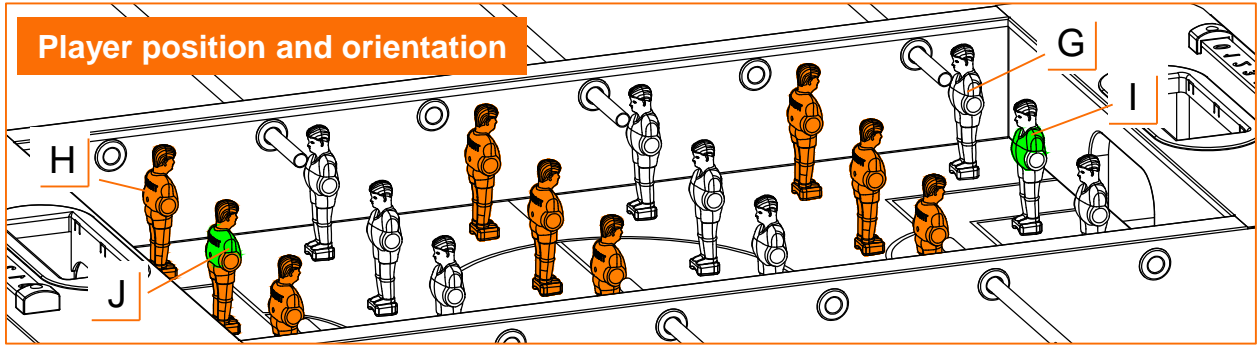
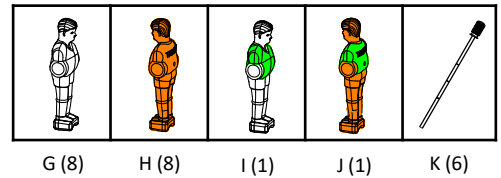

Take 1st ROD (K) and insert it through hole on side of playing field closest to goal. Then in sequence place a GRAY PLAYER (G), GRAY GOALIE (I), and another GRAY PLAYER (G), onto ROD (K). **Ensure players and goalie are facing same direction away from their own goal.** Insert ROD (K) through hole on opposite side.

Staying on the same side of field, take 2nd ROD (K) and skip over one hole, insert it through next hole. Then place three GRAY PLAYERS (G) onto ROD (K). Insert ROD (K) through corresponding hole on the opposite side.

Take 3rd ROD (K) and repeat for remaining three GRAY PLAYERS (G) same as 2nd ROD (K).

Now, move to opposite side of field and repeat for 4th, 5th, 6th ROD (K) placing ORANGE PLAYERS (H) and ORANGE GOALIE (J).

Once all players are placed on rods, check to ensure all players and goalies are in correct position and orientation.

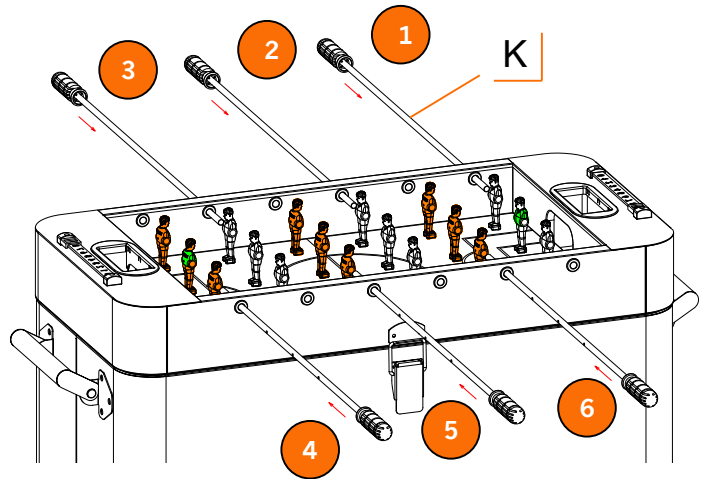

ASSEMBLY INSTRUCTIONS

STEP 4

Slide each player or goalie until hole on back of player or goalie align with hole on ROD (K). Insert a SCREW (L) through back of each player or goalie and fasten tightly to ROD (K) with a Phillips screwdriver. Only tighten until SCREW (L) seat flush with player or goalie's back.

Do NOT use an electric screwdriver to fasten the screw. Do NOT over tighten with screwdriver. You might strip the screw.

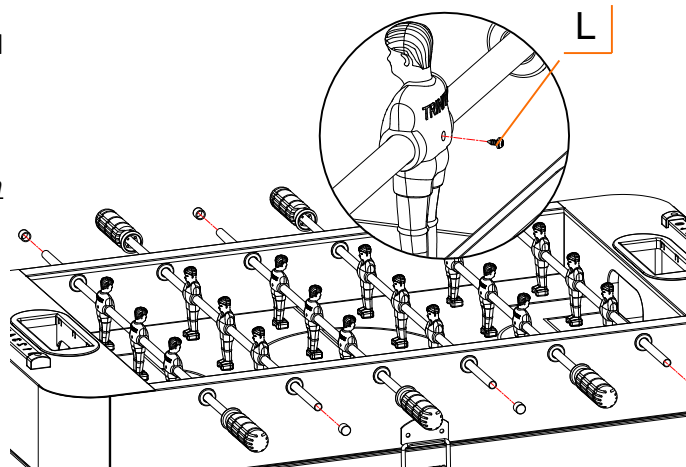
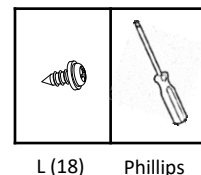

STEP 5

Attach END CAP (M) to each ROD (K) by pushing it on securely.

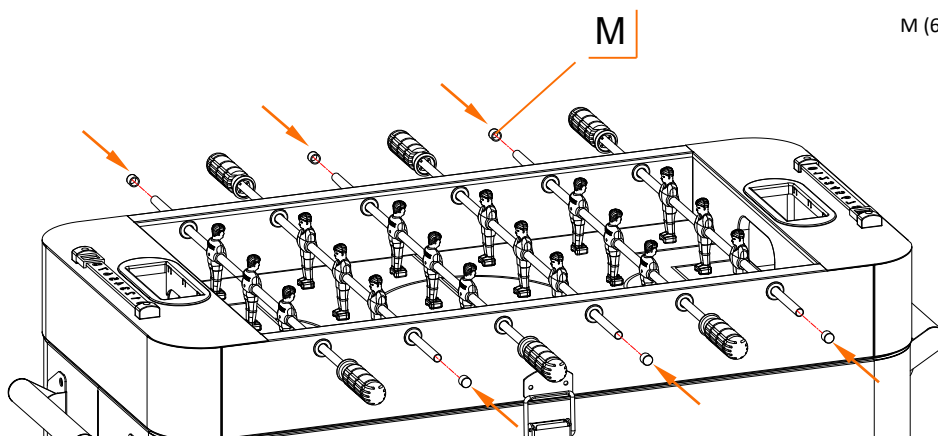
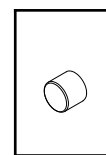

ASSEMBLY INSTRUCTIONS

STEP 6

Unfold COVER (N) and put it onto assembled cooler. Pull touch fastener straps to secure COVER (N).

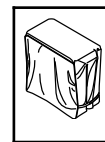

N (1)

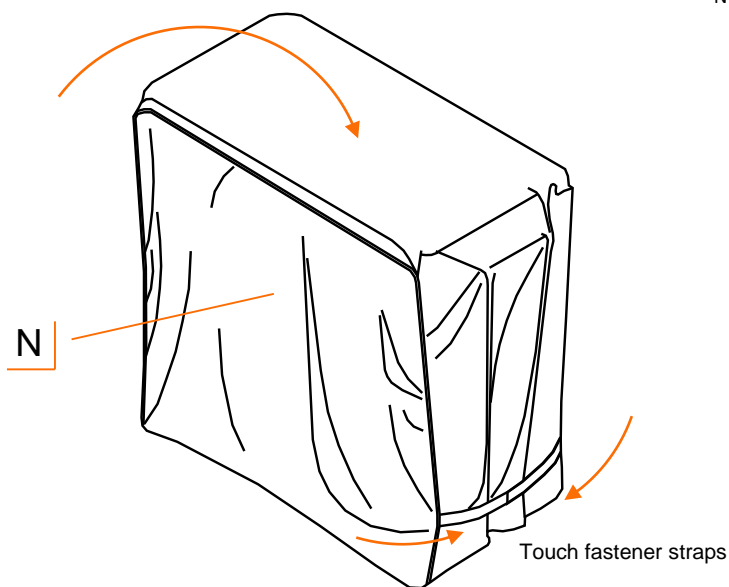

SERVICE PARTS LIST – TXKPGN-0809 / TXKPGR-0809

TRINITY Customer Service provides the following replacement parts:

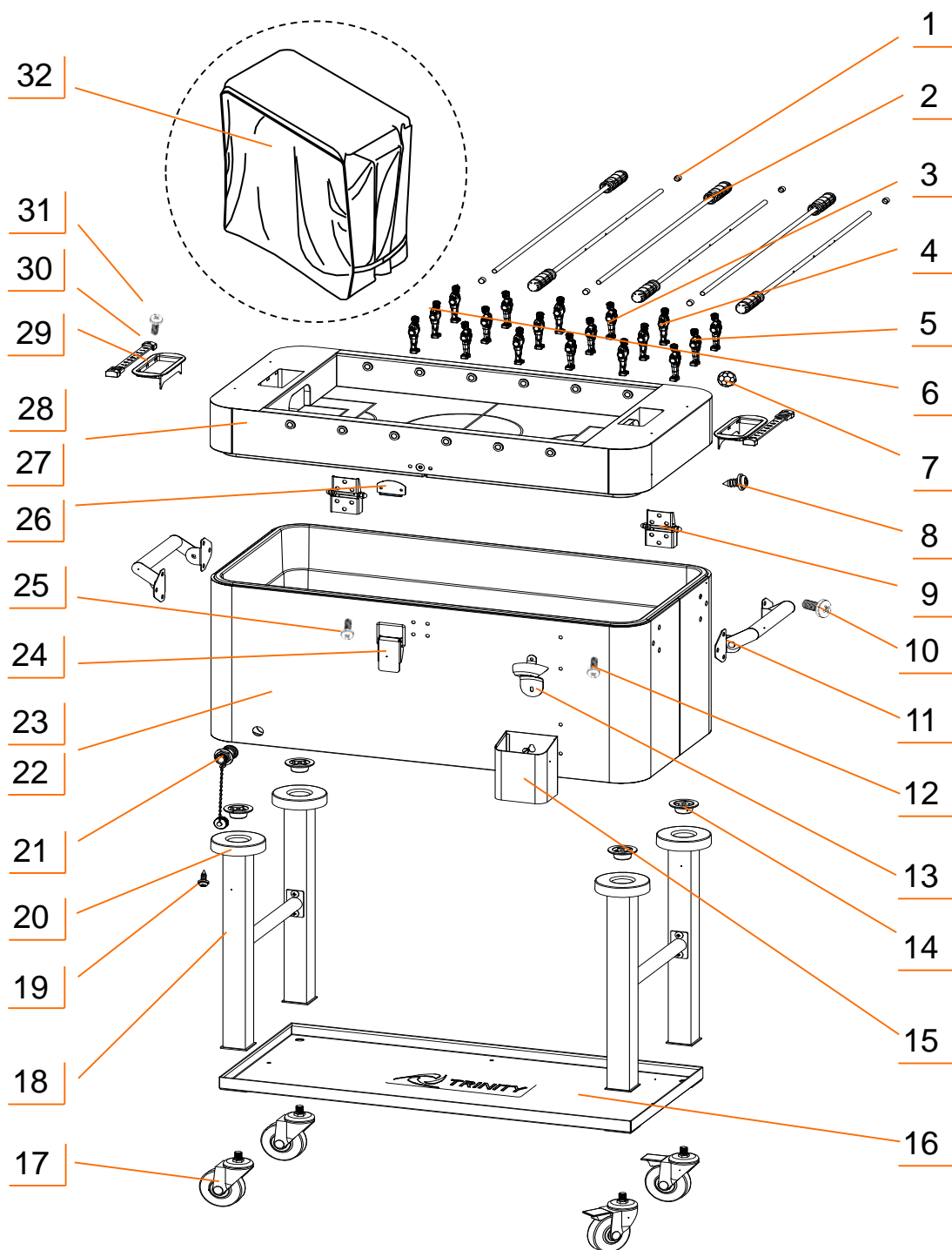

SERVICE PARTS LIST – TXKPGN-0809 / TXKPGR-0809

TRINITY Customer Service provides the following replacement parts:

	Part Number	Description		Part Number	Description
1)	XBK-23-011-0001	End Cap	17)	ZSV-99-012-3010	Caster
2)	XSV-13-016-2400	Rod	18)	PGR-14-015-1517	Frame
3)	XOR-02-048-0001	Orange Player	19)	XSV-01-033-0415	Receiver Screw
4)	XGR-02-048-0001	Gray Player	20)	XBK-02-019-0001	Plastic Receiver
5)	XOR-02-049-0001	Orange Goalie	21)	CGL-02-003-0001	Drain Plug
6)	XGR-02-049-0001	Gray Goalie	22)	PGN-18-025-3115	Cooler Tub (Green)
7)	XWH-02-050-0001	Ball	23)	PGR-18-025-3115	Cooler Tub (Gray)
8)	XSV-01-036-0310	Screw	24)	XST-11-007-0002	Buckle
9)	XST-09-016-0001	Hinge	25)	XSV-01-010-0410	Buckle/Latch Screw
10)	XSV-01-010-0615	Large Screw	26)	XST-11-007-0001	Latch
11)	XSV-05-023-0675	Folding Handle	27)	PGN-17-011-3115	Foosball Lid (Green)
12)	XSV-01-010-0416	Small Screw	28)	PGR-17-011-3115	Foosball Lid (Gray)
13)	XST-02-004-0001	Bottle Opener	29)	XBK-02-051-0001	Bezel
14)	XBK-98-009-4818	Tub Foot	30)	XBK-02-052-0001	Score Strip
15)	XST-02-005-0002	Cap Catcher	31)	ZBK-01-003-0416	Score Strip Screw
16)	PGR-03-028-2913	Shelf	32)	UBK-24-001-3524	Cover