



ULTRASONIC COOL MIST HUMIDIFIER

USER MANUAL

FOR MODEL:
PAU16



Before using your ultrasonic humidifier, please read this manual carefully and keep it for future reference, along with your receipt.



CONSUMER PRODUCT INFORMATION

For your own records, please attach a copy of your sales receipt to this manual.
Also, write the store name/location and date purchased below:

Store Name: _____

Location: _____

Date Purchased: _____

CONTENTS

Safety Guidelines2-3

Technical Data..... 3

Features..... 3

Structure Diagram 4

Setting Up Your Humidifier 5

Operating Instructions 6–7

Weekly Maintenance Cleaning & Care 7

Storage Instructions 8

Warranty 8

Troubleshooting 9

SAFETY GUIDELINES

When using electrical appliances, basic safety precautions should always be followed. Failure to follow these safety precautions may result in personal injury, property damage, fire or shock.

1. Always have water in water tank when operating unit.
2. Use only clean, distilled or FILTERED tap water. Using tap water with a high mineral content (hard water) will result in a white dust and the need for more frequent cleanings. Hard water can be harmful to unit and may eventually cease its operation.
3. Be sure the cap of the tank is firmly tightened.
4. Position the unit within the room so the air output from the mist control output nozzle is aimed away from children, walls and furniture (min. 36 in. clearance).
5. When removing the tank, firmly hold tank with both hands, using one hand to support the bottom of the tank.
6. DO NOT use if tank is cracked.
7. DO NOT place the appliance near heating devices such as a stove. Keep it out of direct sunlight. Keep the cord away from heated surfaces and areas where it can be stepped on or tripped over.
8. Use only 110-120V AC outlet. Be sure unit is plugged in firmly and completely. As with any electrical device, plug and unplug unit with dry hands only.
9. Turn the humidifier off and unplug the unit when not in use, when moving or when cleaning.
10. To avoid the risk of fire, shock or personal injury, do not use an extension cord.
Warning: Never operate unit with a damaged cord or plug.
11. DO NOT place on floor or carpet. Always place unit on a flat, level, waterproof surface at least 24 inches off floor AWAY from direct sunlight, computers or other sensitive electronic equipment.
12. DO NOT place the humidifier on wood furniture or other surfaces that can be damaged by water.
13. DO NOT place on towel or soft surface. This will block the air vent and cause overheating.
14. DO NOT add medication or cleaning products of any type into the mist control nozzle, base or water tank. (See "Weekly Maintenance Cleaning & Care" section of this manual for proper instructions on cleaning the unit.) DO NOT cover, block or place anything over any opening. NEVER drop or insert any object into any openings.
15. The unit should not be left unattended in closed rooms as air could become saturated and leave condensation on walls or furniture. Always leave room door partially open.
16. DANGER: NEVER immerse the humidifier motor unit (base) in water or other liquids as electrical shock may occur.
17. DO NOT use outdoors.
18. Turn humidifier OFF if the relative humidity exceeds 60% or if you notice condensation on inside of windows. For proper humidity reading, use a hygrometer which is available in many retail stores.
19. The nebulizer (ultrasonic transducer) is highly sensitive. Keep this important part clean and treat it gently. Only clean per instructions (page 7).
WARNING:
 - Do not touch the nebulizer while the unit is operating, as possible burns could result.
 - Do not touch the nebulizer with fingers. Any residue on the metal will reduce mist output.
20. The unit contains no consumer serviceable parts. To reduce the risk of electrical shock, do not attempt to open the base of the humidifier.

SAFETY GUIDELINES (CONTINUED)

DANGER! To reduce the risk of electrical shock, this product has a polarized plug (one blade is wider than the other). As a safety feature this plug will fit into the outlet only one way. If the plug does not fit fully into the outlet, reverse the plug. If it still does not fit, contact a qualified electrician. DO NOT attempt to bypass this safety feature. Improper use of electric cords and plugs can cause a fire or electric shock hazard. NEVER pull on the cord to remove the plug from the outlet. Grip plug and pull from outlet. Check the power cord and plug for damage. A damaged cord or plug must be repaired before using the humidifier.

TECHNICAL DATA

Model: PAU16

Voltage: 110-120V~/60Hz

Watts: 20W

Max. Run Time: 10 hours

Water Tank Capacity: 0.4 gallons

FOR HOUSEHOLD USE ONLY

All data was tested by the factory and is for reference only.

This product is designed for home use only.

FEATURES



**PERFECT AIRE
MICRO MIST®**



**WHISPER QUIET
OPERATION**



**ADJUSTABLE
OUTPUT LEVELS**



**AUTO
SHUT-OFF**



**ACTIVE CARBON
FILTER (WASHABLE)**



**REFILL
INDICATOR**



EASY TO FILL

ULTRASONIC TECHNOLOGY

Ultrasonic technology is widely used in various domains. Water is atomized by ultrasonic sound waves and propelled through the air by a small fan. These ultrasonic pulses are silent and produce visible mist that quickly disperses to increase the level of humidity in the immediate area. The unit features an easy to clean ultrasonic transducer (nebulizer) for increased longevity.

AUTO SHUT OFF PROTECTION / WATERLESS INDICATOR

When the water tank is empty, the motor will shut off automatically and the Power Indicator Light will turn red.

PERFECT AIRE MICRO MIST®

Perfect Aire Micro Mist® water particles are smaller than water particles produced by regular ultrasonic humidifiers. Benefits of Perfect Aire Micro Mist® technology include up to 40% greater output, water vapor particles 70-80% smaller for quicker air dispersion, 25% greater room coverage, and less condensation on and around unit.

OVERLOAD PROTECTION

The unit will automatically shut off if a circuit is overloaded.

STRUCTURE DIAGRAM

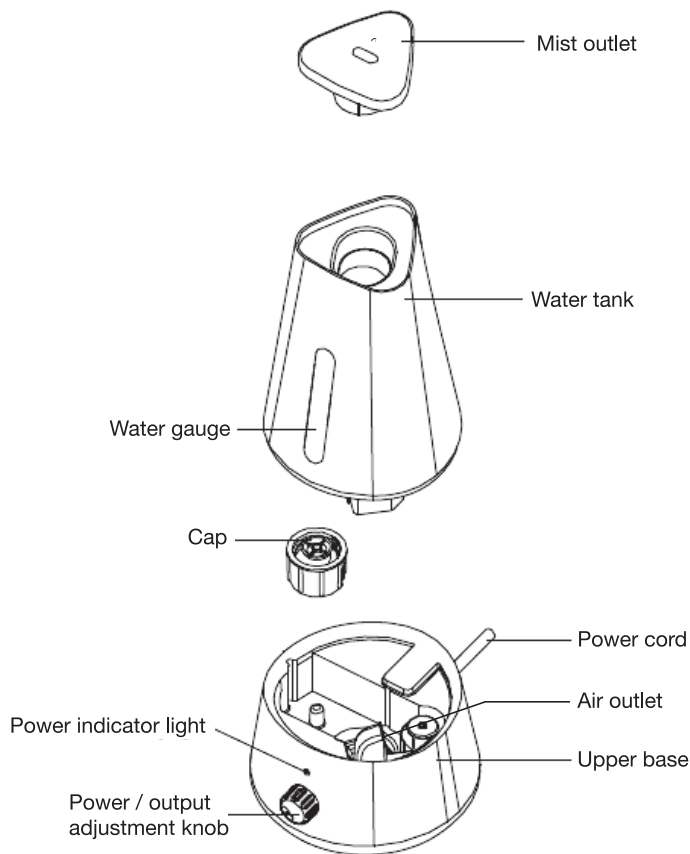

TOP VIEW OF BASE

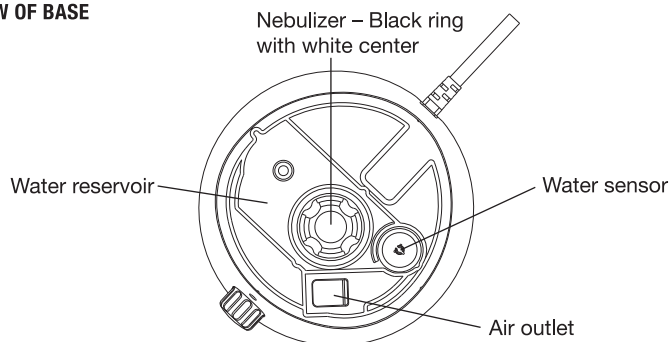

Pictures for reference only.

SETTING UP YOUR HUMIDIFIER

1. Carefully pull water tank up to remove it from base.

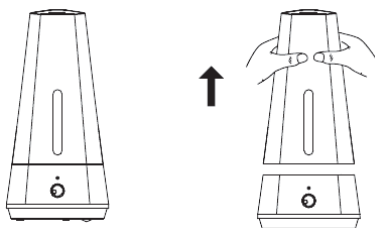

2. Turn the water tank upside down.

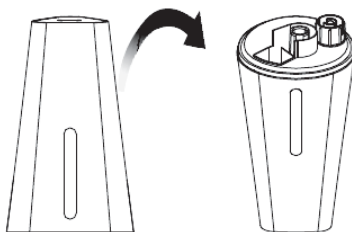

3. Turn the cap counter clockwise.

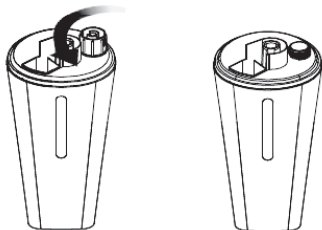

4. Fill up the water tank with FILTERED or distilled water.

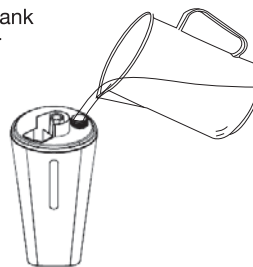

5. Replace the tank cap by firmly turning it clockwise.

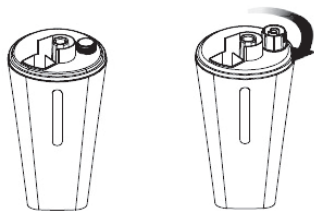

6. Carefully return the water tank back to the base. Base will partially fill with water.

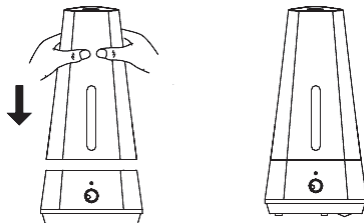

7. Plug in the unit completely into an adequate outlet. (See page 3 for technical data.)

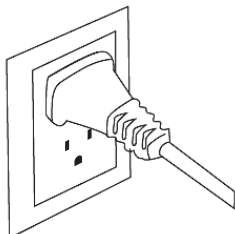

8. Turn unit on by turning the knob clockwise. The indicator light will come on and mist will come from the mist outlet. The indicator light will turn red when the water tank is empty. NOTE: Turn the unit off when refilling the tank or moving the unit.



Off



Minimum
mist volume



Maximum
mist volume

OPERATING INSTRUCTIONS

IMPORTANT NOTES REGARDING HUMIDIFIER USAGE

It is recommended that the humidifier base be cleaned before first use. See cleaning instructions on the next page.

Be sure unit is at least 24 inches off of the floor. Place unit on a firm, level surface. Do not place unit on a soft, unstable surface, towel or wood. Placing the unit on a soft surface will block the air vent and cause overheating. The humidifier should be placed at least 24 inches away from all walls and away from heat sources and at least 6½ feet from any electronics such as a TV set, speakers, etc.

WHEN FILLING THE TANK, NOTE:

- Always unplug unit before filling and replacing tank.
- Distilled or softened water is highly advised. Minerals in (hard) tap water may cause a “white dust” to appear on furniture and also can eventually cause unit failure.
DO NOT ADD ANY SOLUTIONS OR ADDITIVES TO THE WATER. DOING SO WILL CAUSE THE UNIT TO FAIL.
- Extreme temperatures can damage unit. Water temperatures should NEVER be too hot or too cold.
- Return tank securely to base before turning on humidifier.

TO TURN UNIT ON

1. Plug power cord directly into a 110-120V AC wall outlet only. Do not use an extension cord.
2. Turn the On/Off Output Adjustment Knob clockwise to begin operating the unit and to adjust the mist output level.

TO TURN UNIT OFF

Turn unit off when desired room humidity is achieved. Turn the On/Off Adjustment Knob counter-clockwise, to the far left.

- Always turn unit off when water tank is empty.
- Unit will automatically stop creating mist when water level in base is very low.
- Do not let water sit in water tank or base for more than 24 hours without use.
- Unplug the unit when not in use.

DANGER!

Improper use of electric cords and plugs can cause a fire or electric shock hazard. NEVER pull on the cord to remove the plug from the outlet. Grip plug and pull from outlet. Check the power cord and plug for damage. A damaged cord or plug must be repaired before using the humidifier.

OPERATING INSTRUCTIONS (CONTINUED)

IMPORTANT: DISPOSING OF WATER IN BASE

When emptying water out of the base, it is important to hold the base from the air outlet side and pour away from it, as shown in diagram B. Avoid pouring the water out of the base in the direction of the air outlet and the protection switch. It is important that water does not enter the air outlet. If water were to enter the air outlet it may cause damage to the interior electrical workings of the humidifier and damage the unit.

A - TOP VIEW OF BASE

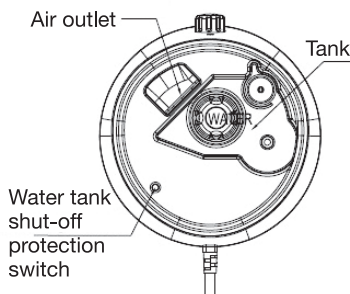

B - WATER DUMPING DIAGRAM

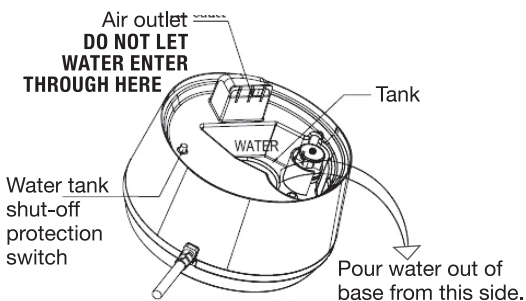

WEEKLY MAINTENANCE CLEANING & CARE

IMPORTANT:

- ALWAYS unplug the power cord before cleaning.
- NEVER use any cleaning products/solutions (especially abrasive, corrosive or flammable cleaner such as alcohol) in unit as these can be harmful to the unit and void warranty if used.

CLEANING INSTRUCTIONS

Thoroughly clean the humidifier weekly. It is recommended that the unit be cleaned more frequently if tap water/hard water is being used. Using hard water in the unit leaves mineral deposits and creates "white mist".

TANK CLEANING

1. Fill the water tank 1/3 of the way with clean water and 1 tablespoon of white vinegar or bleach.
2. Set aside for 20 minutes. Over a sink, shake the tank every few minutes. DO NOT place the tank on the base or run the unit while cleaning.
3. Drain and rinse the tank twice with clean water. Use a soft wash cloth to wipe down and dry off the tank.

BASE CLEANING

1. Use a cup to fill the base of the unit with 2 cups of clean water and 1 tablespoon of white vinegar or bleach. Set aside for 5 minutes. NEVER submerge or place base of unit under running water.
2. Carefully use a soft washcloth to clean around the nebulizer and loosen any mineral deposit build-up. DO NOT touch nebulizer with fingers as any fingerprints or other residue can affect mist output.
3. Empty the cleaning solution by holding the base from the side where the air outlet is located and having the water run to the opposite end.
4. Rinse the base twice using by pouring 2 cups of clean water in the base each time. NEVER submerge or place base of unit under running water.
5. Wipe the base and outer surfaces with a soft, damp wash cloth.

STORAGE INSTRUCTIONS

1. Clean unit thoroughly according to instructions on the previous page and allow the unit to dry completely before storing. DO NOT leave water in the tank or base for more than 24 hours.
2. Store unit in an upright position away from sunlight. Do not store in temperatures below 41°F.

ONE YEAR LIMITED WARRANTY

PERFECT AIRE® warrants that during the first year from the original date of purchase, this product will be free from defects in material and workmanship. Perfect Aire, at its discretion, will repair or replace this product or any component of this product found to be defective during the warranty period. This is a one-time replacement warranty. If the product is no longer available, Perfect Aire will replace the unit with a similar model of equal or greater value.

THIS WARRANTY IS NOT TRANSFERABLE.

PROOF OF PURCHASE IS REQUIRED IN ORDER TO OBTAIN WARRANTY ASSISTANCE.

THIS WARRANTY DOES NOT COVER:

- Damages caused by improper installation or improper cleaning.
- Negligent use or misuse of the product.
- Damages as the result of not using product in accordance with provided instructions.
- Damage to product, walls paintings/portraits, furniture, floor, etc. as the result of high mineral content in water.
- Damage to product, walls, paintings/portraits, any furniture (wood), floors, etc. as a result of improper installation and/or cleaning.
- Use of improper voltage or current.
- Additional or extended warranties offered by retailers.
- Disassembly or repair by anyone other than an authorized Perfect Aire service center provider.
- Products used in a commercial setting.
- Floor display 'as-is' models.
- Damage caused by acts of nature such as hurricane, tornado, fire, etc.
- Incidental or consequential damages caused by breach of any expressed, implied or statutory warranty or condition with exception to the extent prohibited by law.
- Any performance issues that fall outside of the 1 year warranty.

Note: Some states do not allow the exclusion or limitation of incidental or consequential damages. This limitation or exclusion may not apply to you.

DO NOT RETURN THIS PRODUCT TO THE STORE.

IF YOU HAVE ANY QUESTIONS ABOUT THIS PRODUCT OR ITS WARRANTY, PLEASE CALL CONSUMER SERVICES AT TOLL-FREE 844-4PA-AIRE (844-472-2473).

TROUBLESHOOTING

Please check the following troubleshooting tips before calling for assistance.

PROBLEM	REASON	SOLUTION
Power light is off	Unit not plugged in.	Plug in unit and turn on the power / output adjustment knob.
	Wall outlet has no power.	Check the circuit and fuse; try another socket.
	Check power cord.	If damaged, call Consumer Services at 844-4PA-AIRE (844-472-2473)
Unit / Mist has peculiar smell	New unit.	Air unit out in cool place for 12 hours without the tank on the unit.
	The water is dirty or stale.	Thoroughly clean unit and place fresh water in tank.
Excessive noise	Vibration between the humidifier and surface.	Place the unit on a stable, waterproof surface.
	Low water level in water tank.	Fill the water tank.
White dust	Water contains high mineral content.	Switch to distilled or filtered water; clean nebulizer according to instructions.
Damp table or floor	Unit too far from end of table or too close to floor.	Move unit closer to edge of table so mist has more time to disperse. Do not place unit on floor.
	Base overflowed.	Tank cap not securely attached or needs replacement.
No mist / Little mist / Mist stuck	Base overfilled.	Empty base and restart.
	No water in the water tank.	Add water to the water tank.
	The power / output adjustment knob is not turned on.	Rotate the power / output adjustment knob clockwise to power the unit on.
	The humidifier is not on a flat surface.	Put the humidifier on a flat surface.
	There is scaling on the nebulizer / transducer.	Clean the nebulizer / transducer according to instructions.
	Tank was cleaned with wrong type of cleaner.	Use fresh water to clean the water tank completely and then let tank dry completely.
	The water level is too low.	Add water to the water tank.
	The water is dirty or stale.	Thoroughly clean unit and place fresh water in tank.
Condensation on windows or machine	The room is too small or too humid.	Turn down the mist volume or turn the unit off completely.
	Scaling on nebulizer / transducer	Use distilled or filtered water.

After reviewing the above troubleshooting tips, should you have any questions or concerns, please call Consumer Services at 844-4PA-AIRE (844-472-2473).

Distributed by:



Perfect Aire, LLC
5151 Belt Line Rd.
Suite 878
Dallas, TX 75254

844-4PA-AIRE | 844-472-2473
www.perfectaire.us

PA/ManualPAU16/05192017

Specification and performance data is subject to change without notice.

Printed in China