

WARNING

 **Please read the instructions carefully and follow the assembly steps.**

To ensure proper assembly, please follow all steps and use all parts provided. Not following this warning may result in serious injury to you or others.

To prevent misalignments, keep the screws loose and do not tighten them until they are all in their correct positions.

Avoid overtightening or forcing the screws, as this could cause them to break, strip, or damage the threads of the holes.

Using the wrong size of screws for a particular part could cause damage to the screw or the part.

Please lubricate all moving parts regularly and tighten all bolts and screws every 6 months, or as needed.

SAFETY INFORMATION

WEIGHT CAPACITY FOR SEATING: 300LBS



Sit in the center of the chair with your back against the backrest



Do not sit at the front edge of the chair



Do not stand on the chair



Do not use the chair with more than one person



Do not push the chair around when a person is sitting in it



Do not push down on the backrest when a person is reclined



Do not place all your weight on the backrest only

ASSEMBLY PARTS AND TOOL

 **BEFORE YOU GET STARTED, A FEW POINTERS:**



Having a friend to help makes assembly extra-easy



Please use the included wrench instead of an ELECTRIC HAND DRILL in case of damage to the product.

A



Sofa Back *1

B

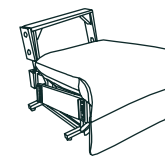

Sofa Seat *1

C



Right Arm*1

D



Left Arm*1

E



Right Cushion*1

F



Left Cushion*1

G



Wrench *1

H



Massage Power Cord *1

I



Power Plug *1

J



Power Adapter *1

K



Massage Controller *1

L



Lift Controller *1

ASSEMBLY INSTRUCTIONS

Step 1

Please remove Four screws on the wood frame by Wrench G, then remove the wood frame from Sofa Seat B.

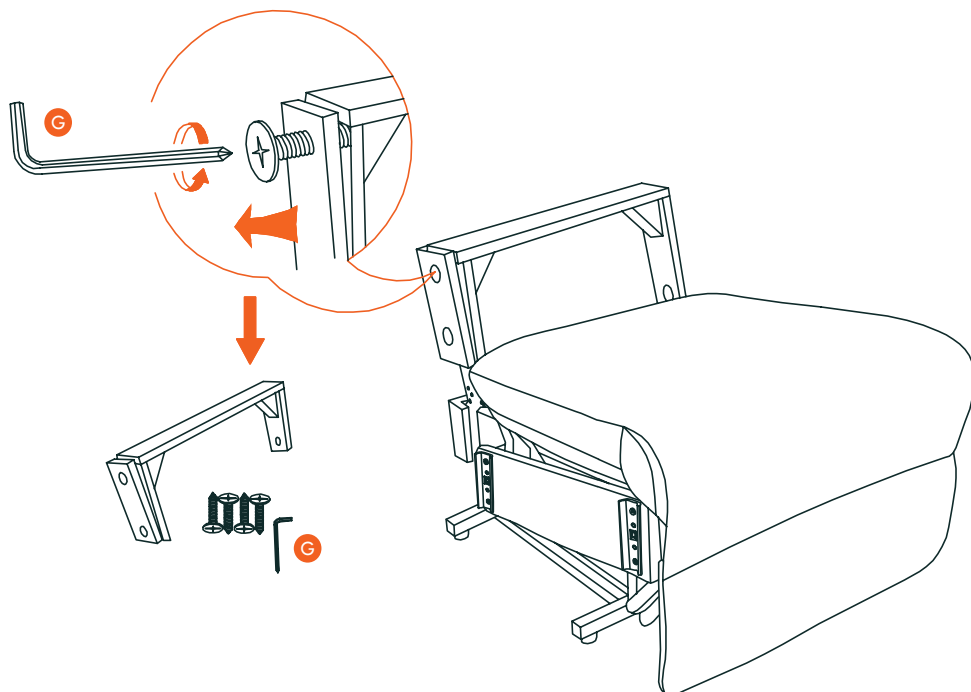

ASSEMBLY INSTRUCTIONS

Step 2

Attach Right Arm C & Left Arm D to Sofa Seat B, align the slots on the two arms and both sides of the sofa seat, press down the arms until the connection is secure.

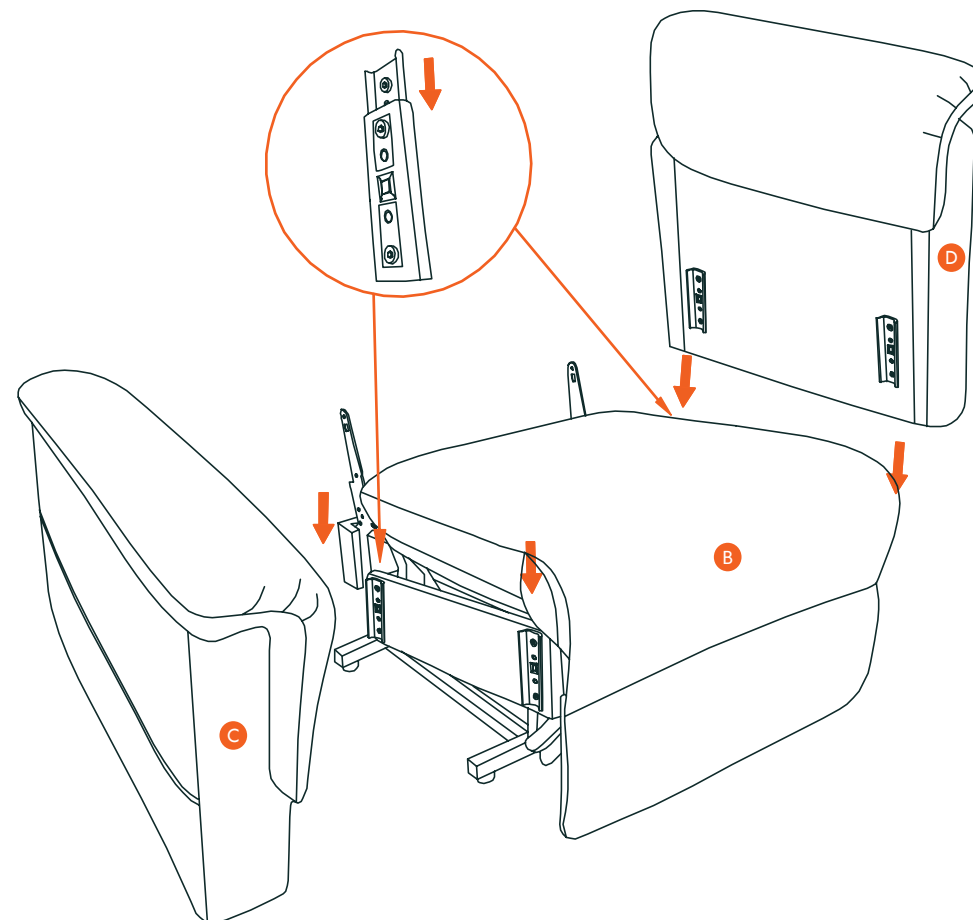

ASSEMBLY INSTRUCTIONS

Step 3

Connect Sofa Back A to the finished sofa base. Align the slots on the back and sofa seat, press down the sofa back until the connection is secure.

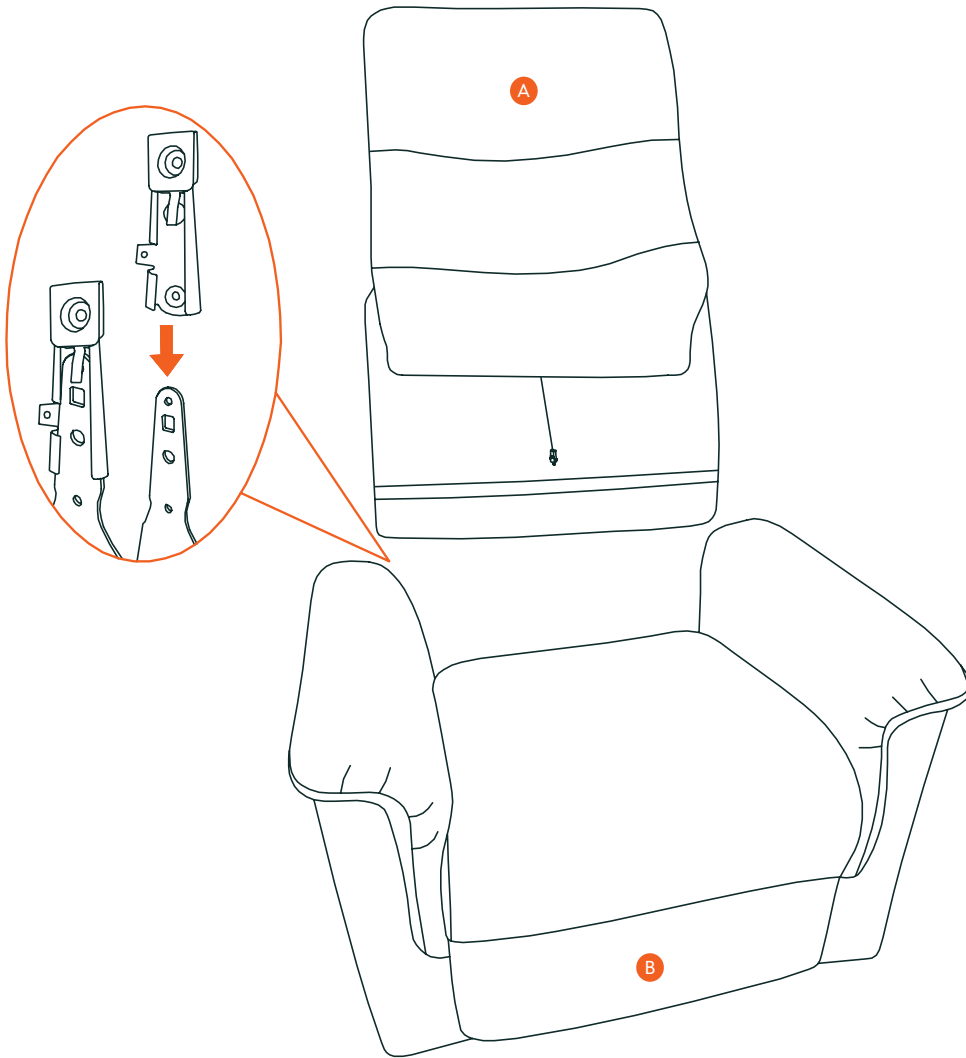

ASSEMBLY INSTRUCTIONS

Step 4

Attach Right Cushion E & Left Cushion F to Sofa Back A, press down two cushions until the connection is secure.

Note: Cushions are marked with L/R labels to show which side should be placed on.

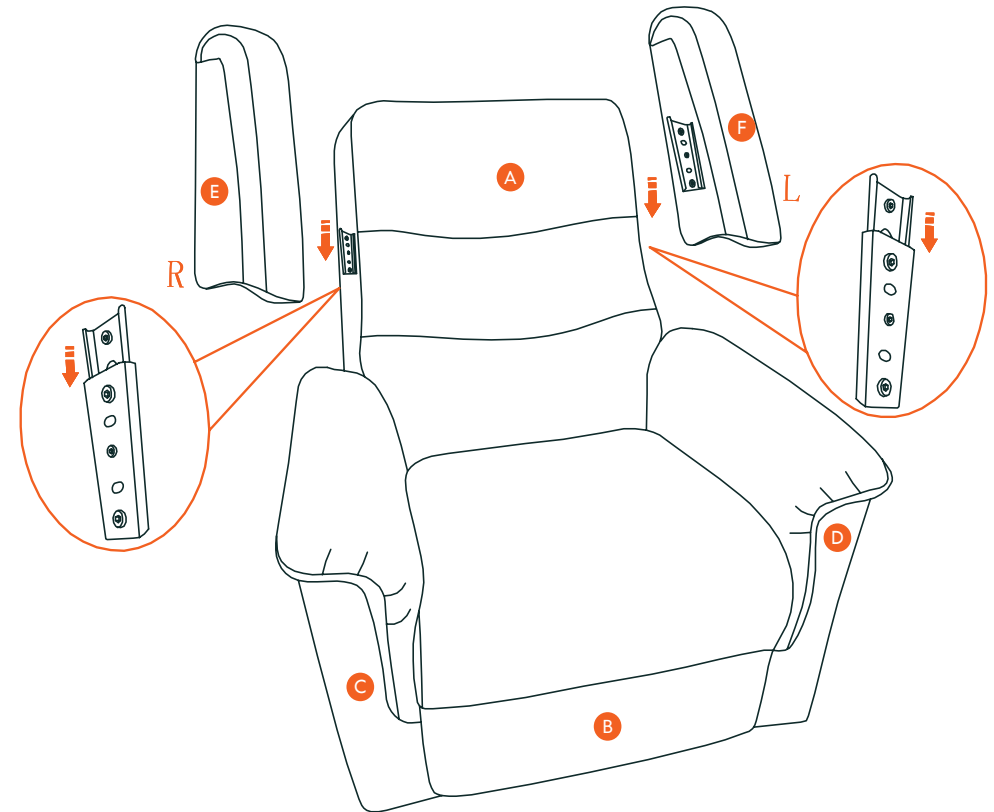

ASSEMBLY INSTRUCTIONS

Step 5

1. Connect Power Adapter J and Power Plug I, then connect Lift Controller L.
2. Connect Massage Power Cord H (connect the lines according to the line-drawing) and Massage Controller K, finally fasten the velcro on the bottom of backside.

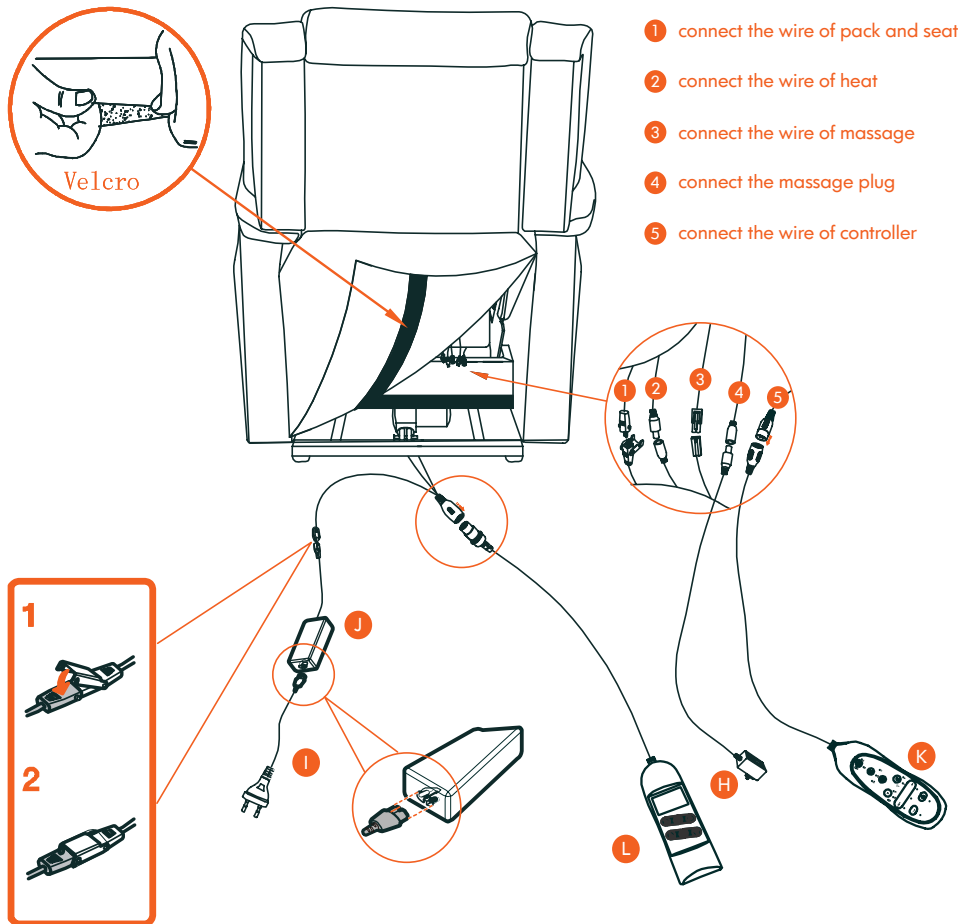

ASSEMBLY INSTRUCTIONS

Step 6

Now your sofa is successfully assembled.

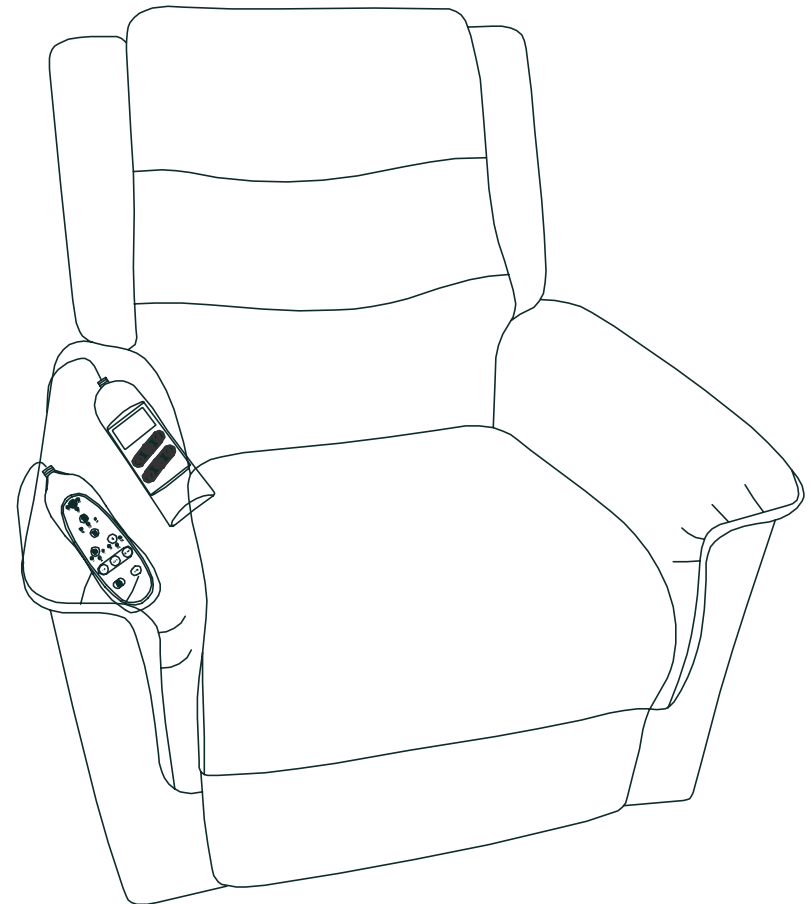

PRODUCT DETAILS

1.Sofa Extended:

Long press the Left  button on the switch panel to lie down.

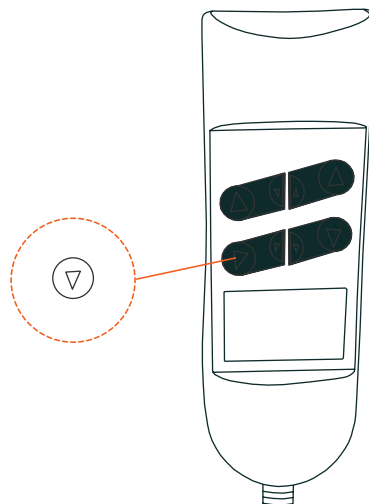

2.Sofa Stand:

Long press the Left  button on the switch panel to stand.

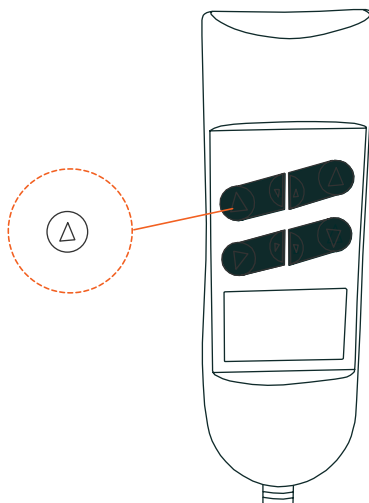

PRODUCT DETAILS

3.Headrest Extended:

Long press the Right  button on the switch panel to extend the headrest.

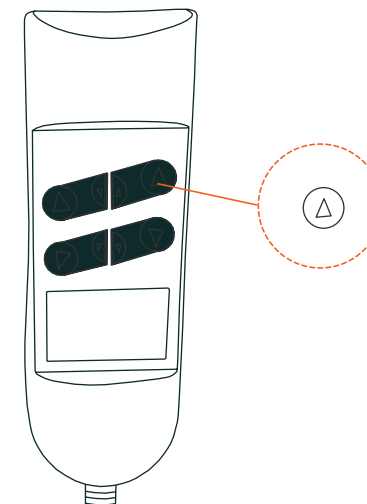

4. Headrest Retracted:

Long press the Right  button on the switch panel to retract the headrest.

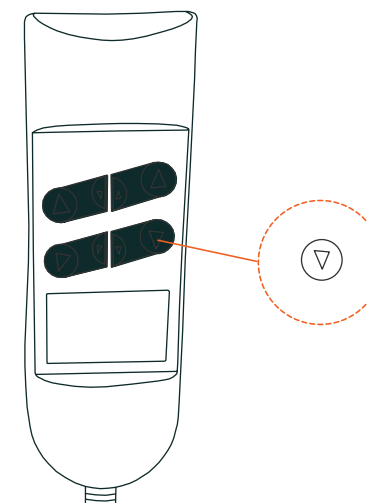

PRODUCT DETAILS

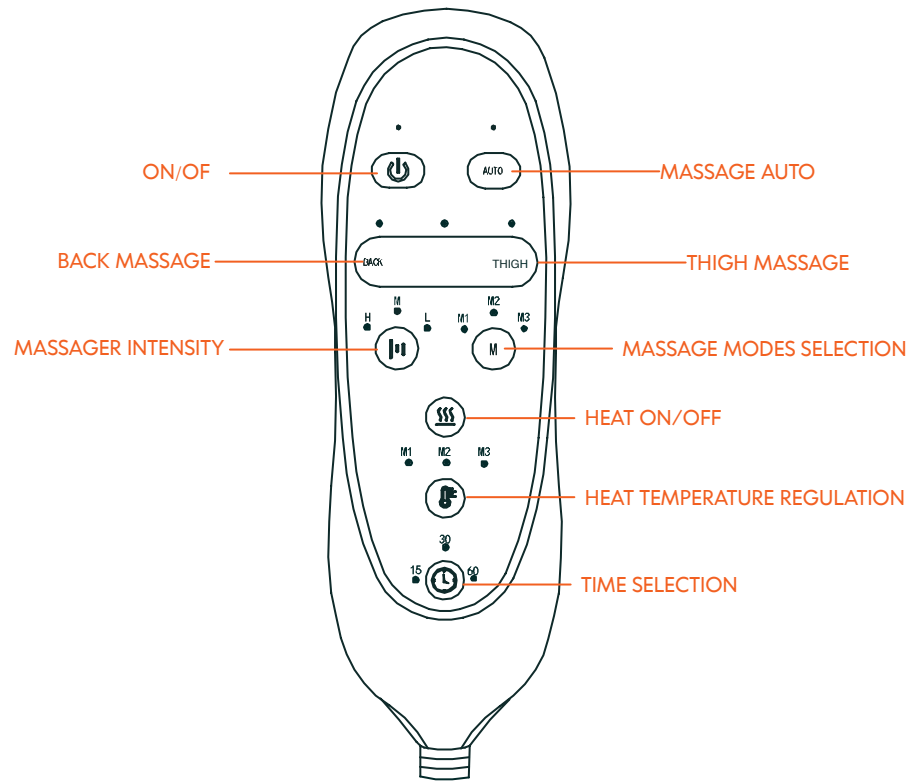

LIMITED WARRANTY

- Modifications or attachments to the product that are not approved by.
- Products that were not installed, used, or maintained in accordance with product instructions and warnings.
- Products used for rental purposes or unauthorized retail activities.

LIMITED WARRANTY

promises to repair or replace any chair that is found to be defective in material or workmanship within one year from the date of original purchase so long as you, the original purchaser, still owns it. This is your sole and exclusive remedy. This warranty is subject to the provisions below.

EXCLUSIONS

This warranty does not apply and no other warranty applies to:

- Normal wear and tear, which are to be expected over the course of ownership.
- Misuse, abuse, or excessive use of the product.