



# Russell Hobbs

# STEAM & CLEAN

## Operating Manual

### RHSM1001-G

### ASSEMBLY

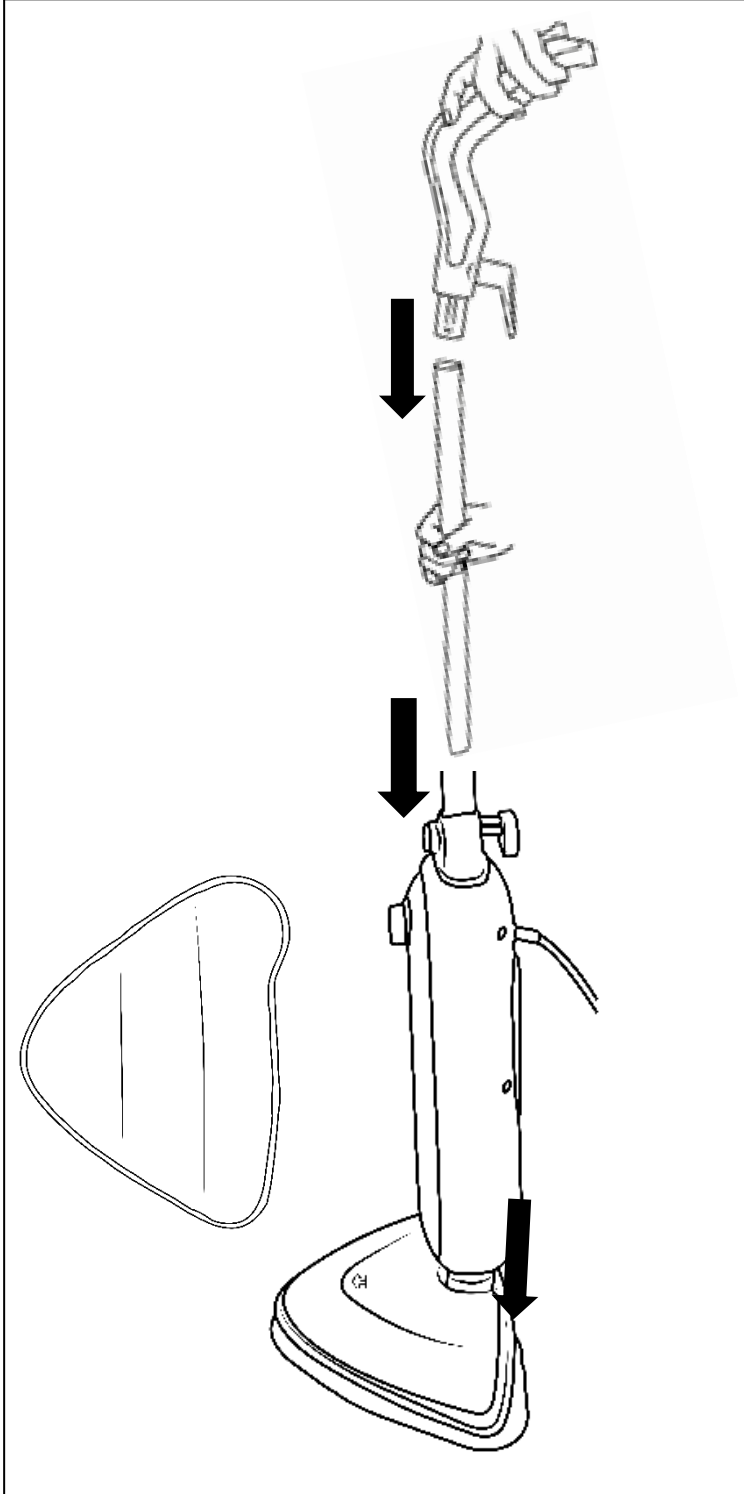

### POWERING ON

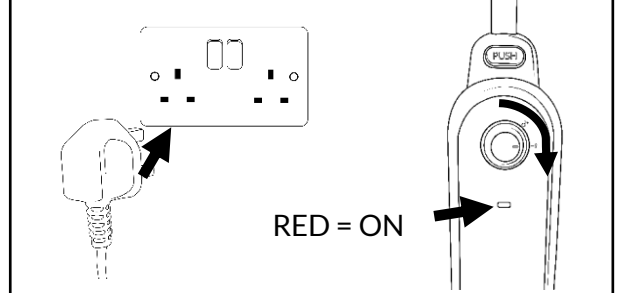

### SUITABLE FOR USE

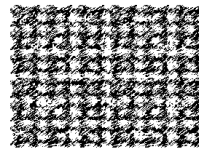

Carpet/  
Upholstery

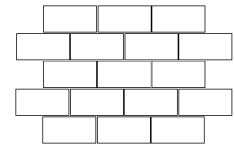

Floors/  
Tiles

### WASH PADS

Microfibre mop pads are suitable for home washing machines at least once a month

# 1 MONTH

## REGISTER YOUR FREE ADDITIONAL 1 YEAR GUARANTEE TODAY

# GUARANTEE

At Russell Hobbs, we take all our customer feedback seriously.

Feel free to contact our Product Care Team, on **0345 209 7461** who will be more than happy to assist you.

This product is guaranteed for 12 months from the date of the original purchase. If any defect arises due to faulty materials or workmanship, the faulty product must be returned to the place of purchase.

Refund or replacement is at the discretion of the retailer.

The following conditions apply:

- The product must be returned to the retailer with the original proof of purchase.
- The product must be installed and used in accordance with the instructions contained in this instruction guide and any other instructions for use which are supplied.
- It must be used for domestic purposes only and for its intended use.
- This guarantee does not cover wear and tear, damage, misuse or consumable parts.
- This does not affect your statutory rights.

## RUSSELL HOBBS CONTACT DETAILS

**Website:** <https://mda.russellhobbs.com>

**Telephone:** 0345 209 7461

**Address:** Product Care Customer Service, Green Bank Business Park, Hindley Green, Wigan, WN2 4AY

Note your serial number below for future reference.



*Image for illustration purposes only*

## REGISTER ONLINE

Visit our website to register your full parts and labour guarantee online.

<https://mda.russellhobbs.com>

## REGISTER BY PHONE

Call our friendly Product Care team.

0345 209 7461

## IMPORTANT SAFETY INSTRUCTIONS

- It is hazardous for anyone other than a competent person to carry out any service or repair operation that involves the removal of a cover which gives protection against exposure to electrical parts.
- Do not remove parts from the appliance such as screws.
- If the supply cord is damaged, it must be replaced by the manufacturer, its service agent or similarly qualified persons in order to avoid a hazard. Do not use with damaged cord or plug.
- This product is intended for household use only. Do not use outdoors.
- This appliance can be used by children aged from 8 years and above and persons with reduced physical, sensory or mental capabilities or lack of experience and knowledge if they have been given supervision or instruction concerning use of the appliance in a safe way and understand the hazards involved. Children should not play with the appliance. Cleaning and user maintenance should not be made by children without supervision.
- Do not direct at people, animals, electrical outlets, or equipment containing electrical components.
- The use of accessory attachments, detergents or cleaning solutions not recommended by the appliance manufacturer may cause fire, electric shock, injury or damage. Use only those as recommended by the manufacturer.
- Descale the product monthly using 50% white vinegar & 50% water solution.
- Do not use in enclosed spaces filled with vapour, such as paint thinner, moth proofing substances, or any flammable or combustible vapours.
- Do not use on leather, wax polished floors, natural wood and/or unsealed floors, and any fabric not recommended for steam treating. If in doubt, consult the flooring manufacturer and test an inconspicuous area.
- Do not store with a wet pad attached.
- Do not immerse in water, such as for cleaning.
- Clean pads at least monthly. Change filter when required.
- Distilled or demineralized water will maximise the performance of the mop.
- Quality testing during manufacture may result in water droplets remaining in the tank. This is normal.
- If you shake this product the water cut-off valve will make a rattling noise. This is normal and is not a defect.

Symbol IEC 60417-5597 (2002-10) is used on the unit to indicate that this unit operates with hot water vapour (steam).

To avoid scalding and burns take extra care when in use



# OPERATION

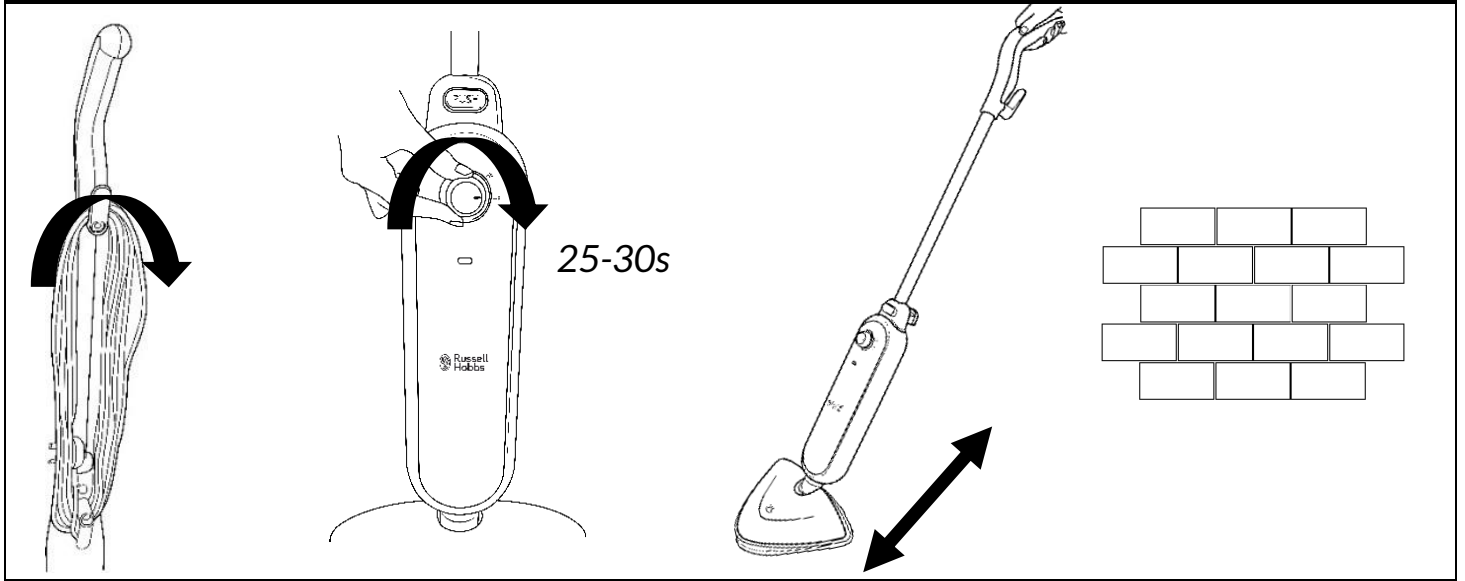

# USING ON CARPET

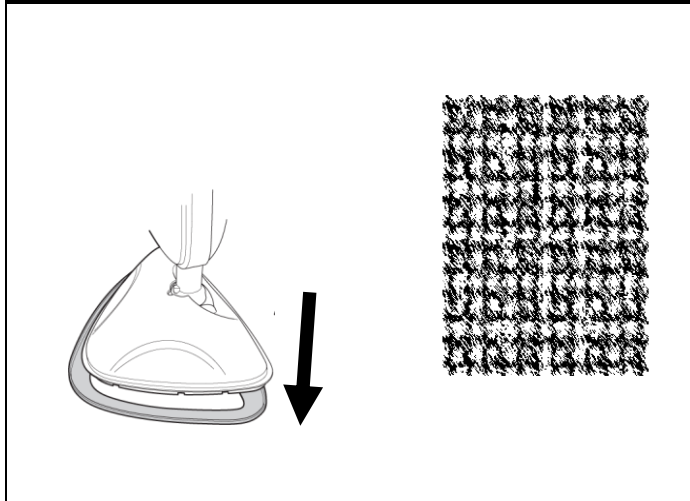

# CARRYING THE APPLIANCE

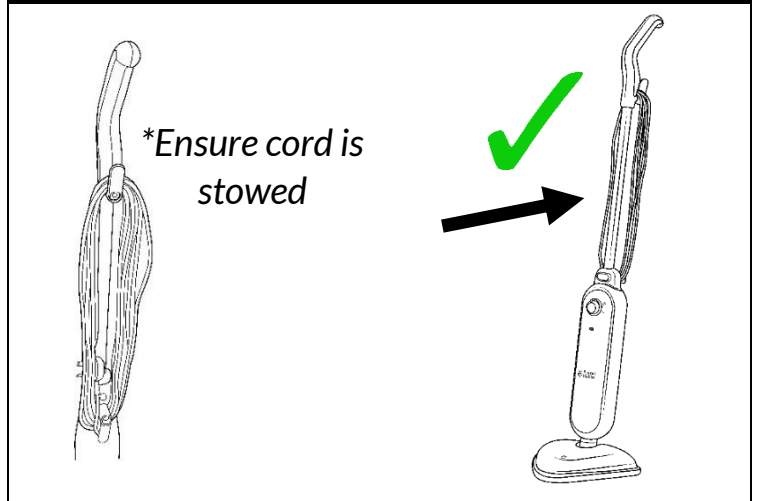

# FILLING THE TANK

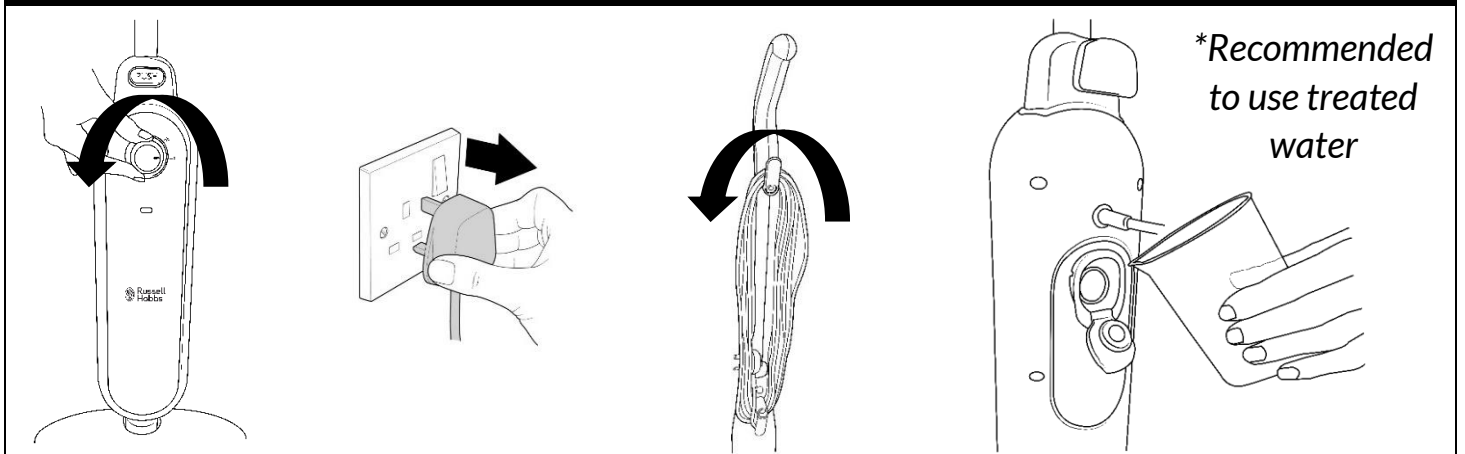

## STORING THE APPLIANCE

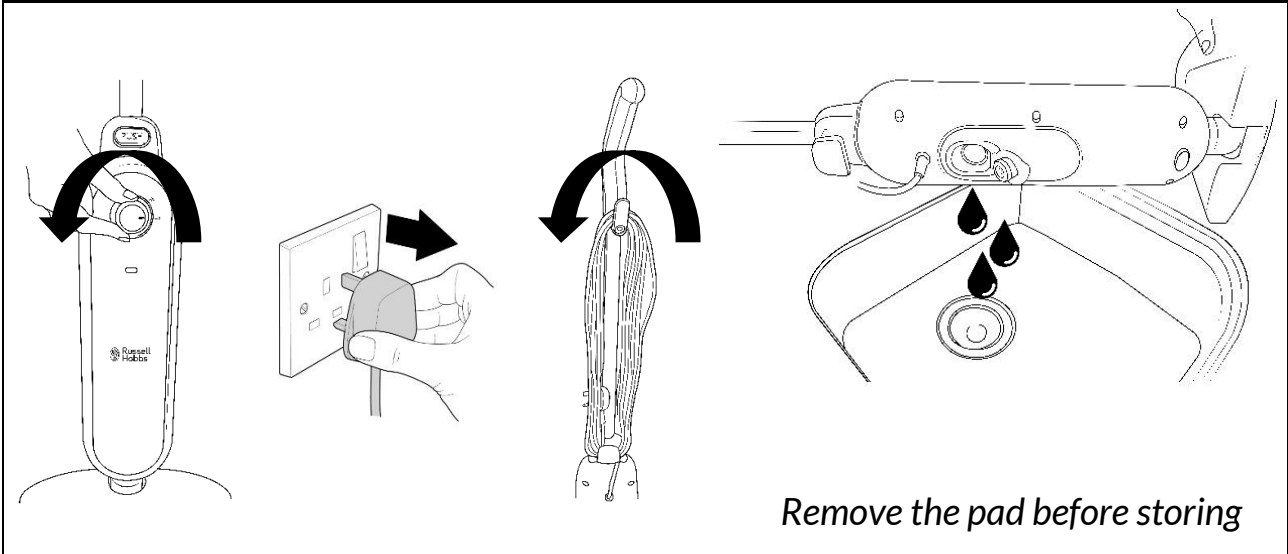

# IMPORTANT! WASH THE PADS

## WASH PADS

Microfibre mop pads are suitable for home washing machines at least once a month

# 1 MONTH

## REGISTER YOUR FREE ADDITIONAL YEAR GUARANTEE TODAY

## **WARNING- THIS APPLIANCE MUST BE EARTHED**

This appliance is designed to operate from a mains supply of 220-240V~ 50/60Hz. Check that the voltage marked on the product corresponds with your supply voltage.

This product is fitted with a 7A fuse complying with BS1363.

If this plug is unsuitable, damaged or needs to be replaced, contact customer services.

**REGISTER YOUR FREE  
ADDITIONAL YEAR  
GUARANTEE TODAY**

## PROBLEM SOLVING

Reduced steam/no steam is coming out	<ul style="list-style-type: none"><li>• Check the water tank is filled</li><li>• Check the steam dial is turned on at the front</li><li>• Check the appliance is plugged in correctly</li></ul>
The appliance smells	<ul style="list-style-type: none"><li>• Check the microfiber pad is clean</li><li>• Wash the microfiber pad in a washing machine or warm soapy water and allow to dry naturally</li><li>• If first time use, new parts heating may cause a smell but this will dissipate quickly</li></ul>
A puddle has formed/the floor is soaking wet	<ul style="list-style-type: none"><li>• The mop pad is saturated</li><li>• Wash the mop pad allow to dry naturally, or replace with a new pad</li><li>• If still too much water, contact customer services</li></ul>
Parts have broken	<ul style="list-style-type: none"><li>• Contact customer services</li></ul>
The mop pads aren't cleaning in the washing machine	<ul style="list-style-type: none"><li>• Pads need replacing</li><li>• Visit your local retailer, or contact customer services to purchase additional pads</li></ul>

If you are still experiencing difficulties with the appliance please contact us **BEFORE** returning the appliance to the retailer it was purchased from:

**Website:** <https://mda.russellhobbs.com>

**Telephone:** 0345 209 7461

**Address:** Product Care Customer Service, Green Bank Business Park, Hindley Green, Wigan, WN2 4AY

# IMPORTANT!

## WASH PADS

Microfibre mop pads are suitable for home washing machines at least once a month

# 1

MONTH



## Russell Hobbs

This product is guaranteed for 12 months from the date of the original purchase. If any defect arises due to faulty materials or workmanship, the faulty product must be returned to the place of purchase.

By registering your product with us you will get an additional year guarantee free of charge. Further cover can be purchased through the website.

### REGISTER ONLINE

Visit our website to register your full parts and labour guarantee online.

<https://mda.russellhobbs.com>

### REGISTER BY PHONE

Call our friendly Product Care team.

0345 209 7461



# Russell Hobbs

Russell Hobbs is a registered trademark used under license from  
Spectrum Brands (UK) Ltd. Made under license by G2S Limited, Wigan,  
WN2 4AY/G2S (NI) Ltd, Belfast, BT5 5AD

Russell Hobbs Support: call 0345 209 7461 or visit  
<https://mda.russellhobbs.com>

UK  
CA

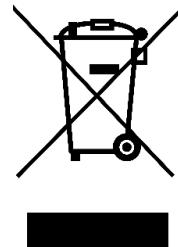
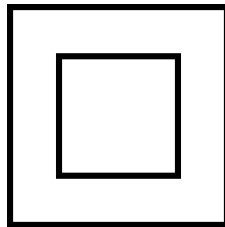

The 'wheeie bin' symbol is known as the 'Crossed-out wheeie bin Symbol'. When this symbol is marked on a product/batteries, it means that the product/batteries should not be disposed of with your general household waste. Only discard electrical/electronic/battery items in separate collection schemes, which cater for the recovery and recycling of materials contained within. Your co-operation is vital to ensure the success of these schemes and for the protection of the environment. For your nearest disposal facility, visit [www.recycle-more.co.uk](http://www.recycle-more.co.uk) or ask in store for details.

SEDEX – Connecting businesses and their global suppliers to share ethical data and enabling improvement in ethical performance. Visit [www.sedex.org.uk](http://www.sedex.org.uk) for further information.

We reserve the right, due to possible changes to design, to alter the instruction manual without prior notice.