

Installation diagram

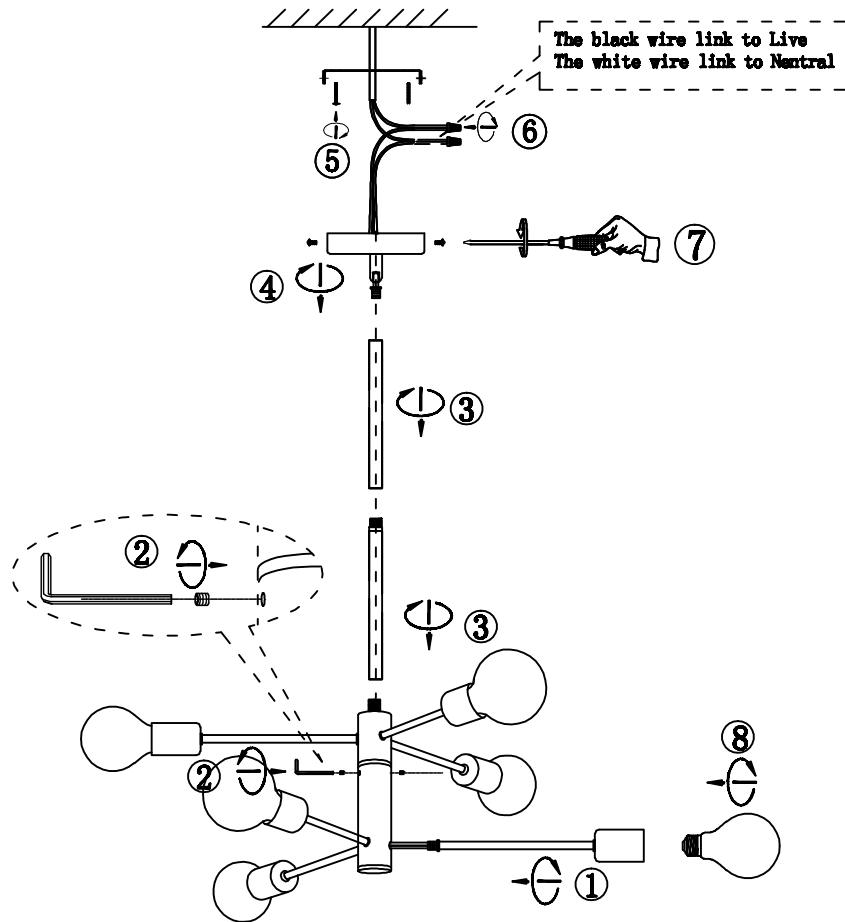

Installation steps

First open the outer case, find the various accessories, and carefully place them in the clean

On the platform, prevent scratch, collision light body.

- 1: Install all lamp cap tubes on the reserved hole position of the central column.
- 2: Arbitrarily adjust the shape Angle of the lamp body, tighten it with a wrench
- 3: Turn on the water pipe
- 4: Screw on the top suction disc
- 5: Remove the hanging plate and fix the hanging plate in the position to be installed with the gecko nail and expansion screw
- 6: Connect the light cord and the power cord. Please turn off the power when wiring And according to the correct polarity connection.
- 7: With a screwdriver screw, the lamp body fixed firmly
- 8: Install light bulbs

Notes:

It is strictly prohibited to wipe the surface of lamp body with tianna and other chemical solvents. Cotton cloth is recommended Glue a small amount of water to gently wipe the lamp.

Warm tips: this lamp is only for indoor installation and is strictly prohibited for outdoor use