

ASSEMBLY INSTRUCTION

- Please follow the instructions to assemble the items correctly.
- Please ensure the safety of the glass when assembling.
- Do not make the screws too loose or too tight.
- As shown in the figure, Insert the screw into the hole.
The arrow in the picture, Then rotate 90° or 180° clockwise.
- The accessory bag contains some small accessories, which should be kept away from children.
- Ensure that the product enjoys a 90-day product warranty.
If you have any questions, Help or support, please contact product customer service. We will further send you effective information and related solutions.
- The remaining parts are spare parts.

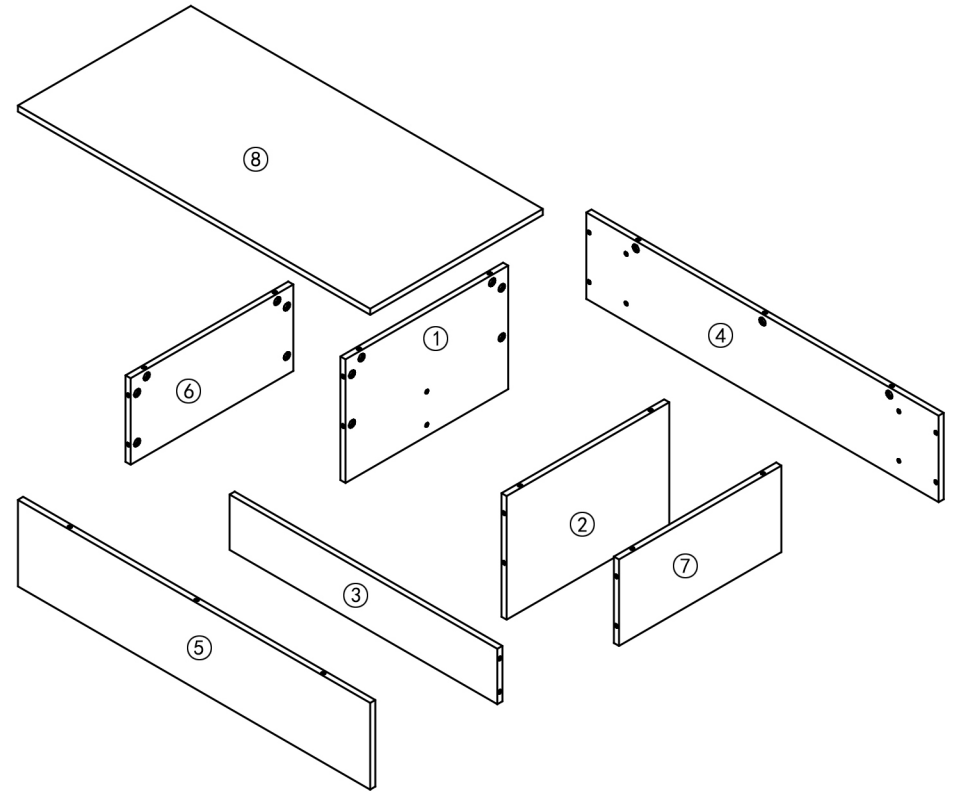

- | | |
|------------|------------|
| ① 294*496 | ⑥ 496*194 |
| ② 294*496 | ⑦ 496*194 |
| ③ 788*150 | ⑧ 1060*530 |
| ④ 1058*194 | |
| ⑤ 1058*194 | |

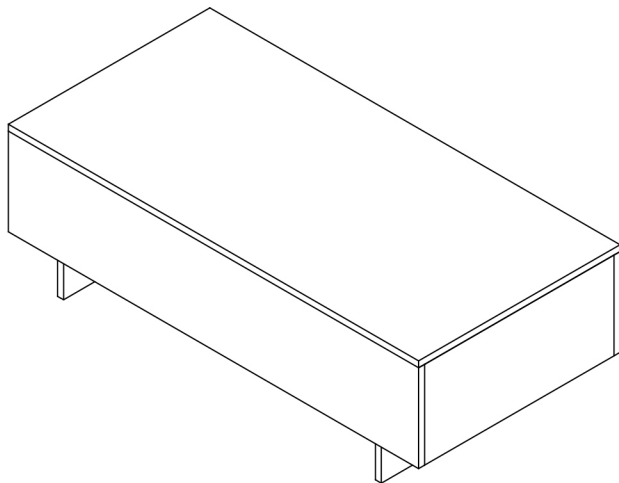
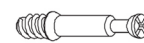

A*34



B*34

STEP 1

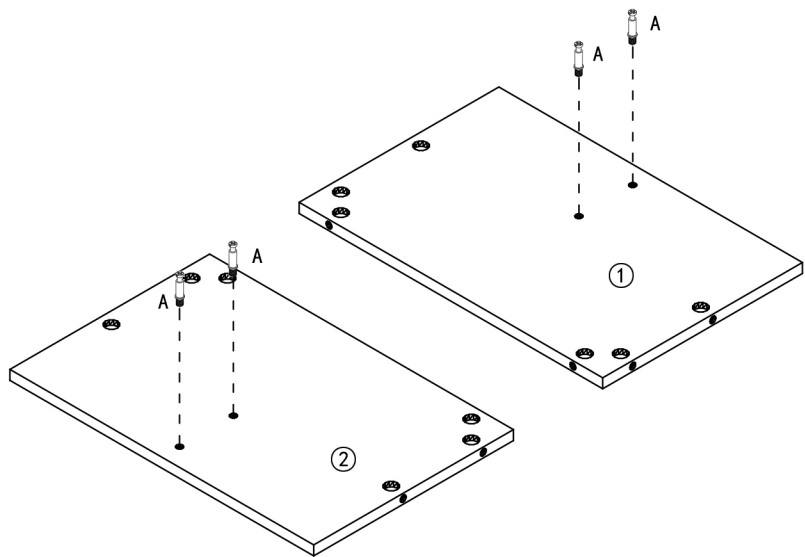

 A*4

STEP 3

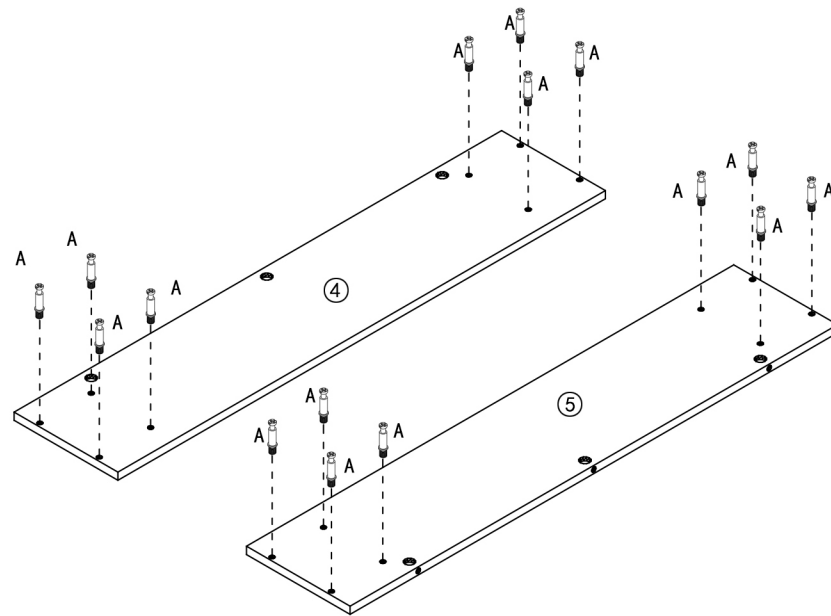

 A*16

STEP 2

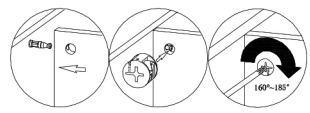
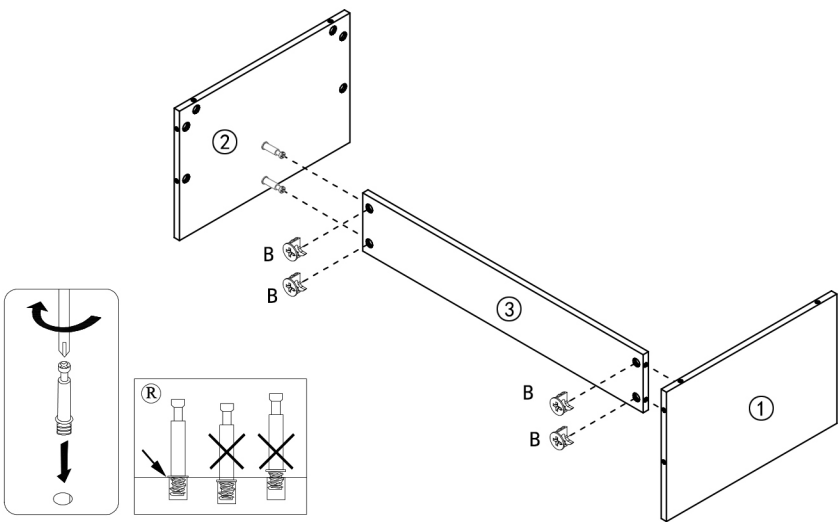

 B*4

STEP 4

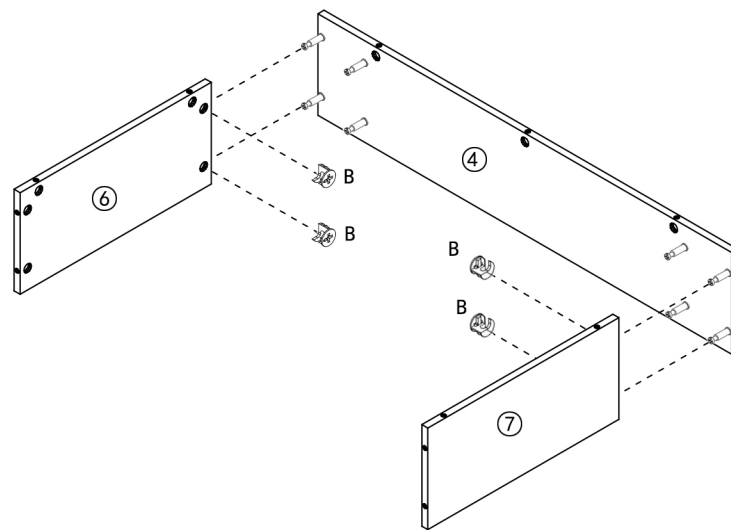

 B*4

STEP 5

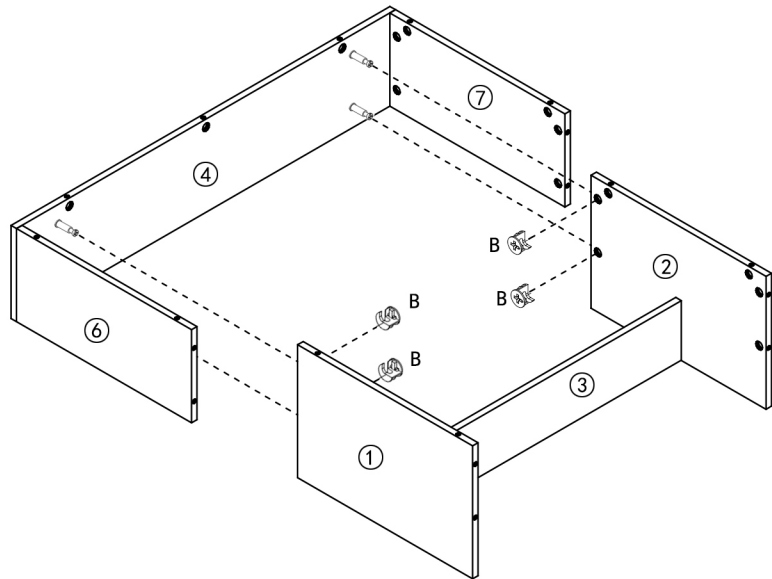

 B*4

STEP 6

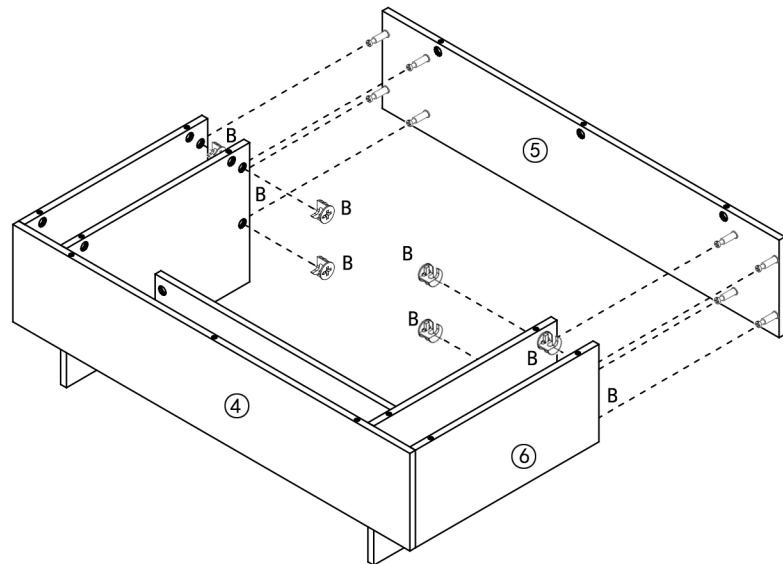

 B*8

STEP 7

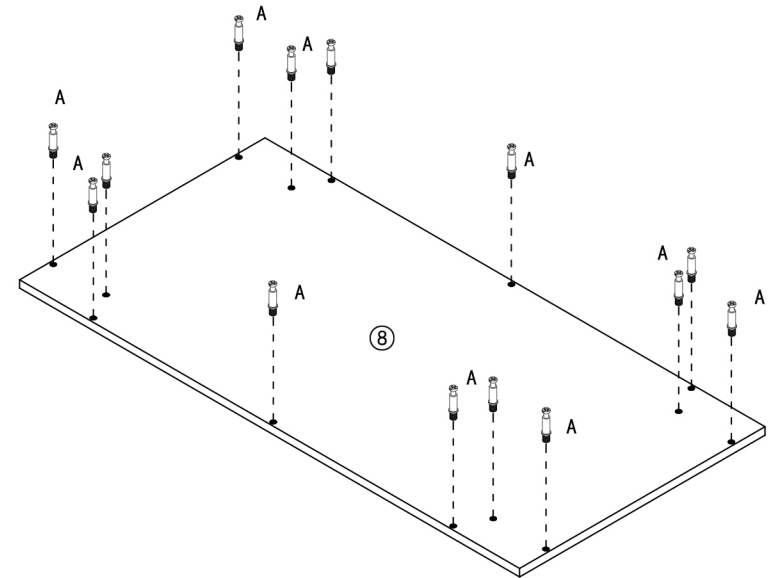

 A*14

STEP 8

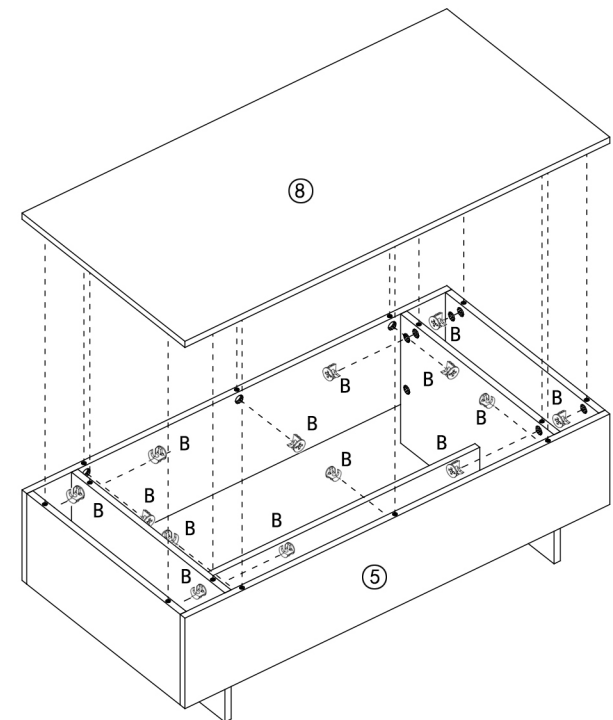

 B*14