

1. Shut off the power at the circuit breaker and remove old fixture, including the crossbar.

2. Carefully unpack your new fixture and lay out all the parts on a clear area. Take care not to lose any small parts necessary for installation.

3. Attach the Mounting Plate to the Outlet Box (not supplied) by using 2 Outlet Box Screws.

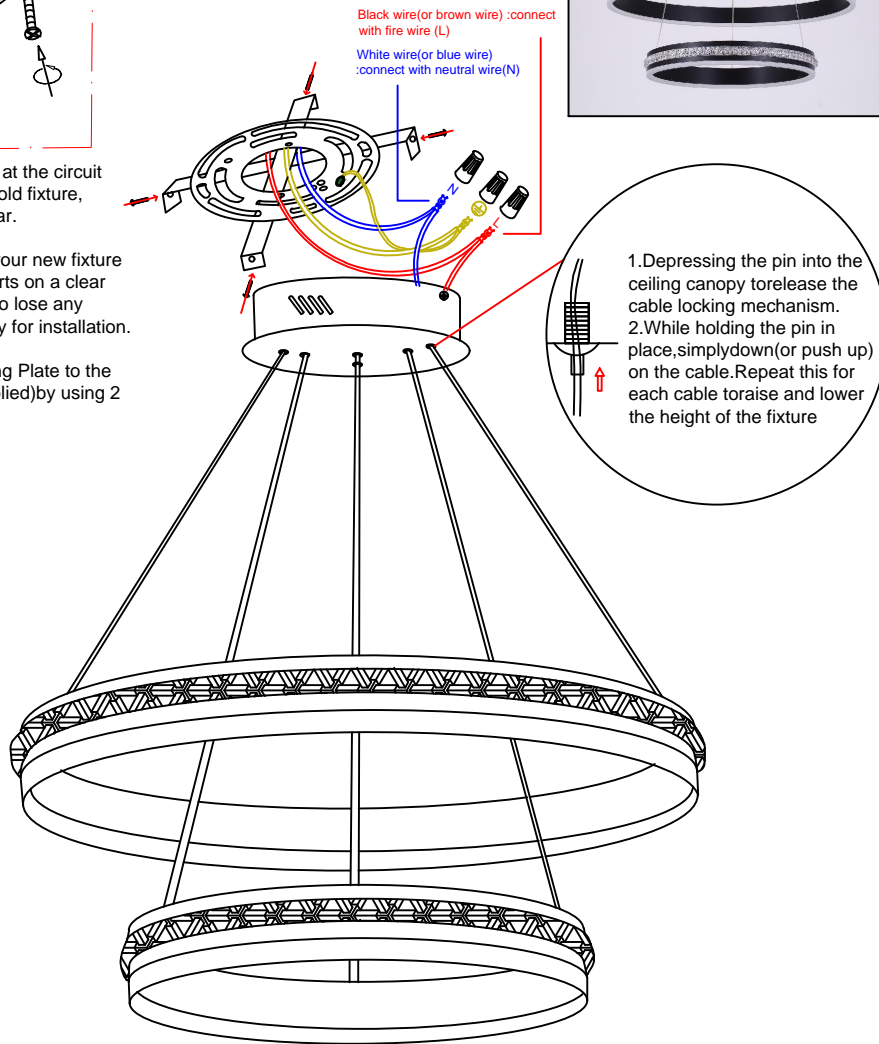

The instructions

Installation steps:

1. now disassemble the lamp body, and then measure and locate the installation hole position on the ceiling with the hanging plate hole position.
2. Drill holes in the positioning marks according to the size of the expansion screw and then hammer the expansion screw into the hole, and then twist the nut counterclockwise to lock the mounting plate. (Tip: If you have a wooden ceiling instead of a concrete one, use self-tapping screws to secure the cross-board.)
3. Use the nut to pad the spacer respectively to lock the hanging plate on the ceiling. Please connect the hanging plate with the ceiling firmly and securely, and ensure that the hanging plate is connected with the expansion screw enough to bear the weight of the lamp body.
4. Connect the 110V power supply and the main line of the lamp body to test to see whether the lamp works normally. It is recommended to ask a professional electrician to install it.
5. The hole of the lamp body corresponds to the screw of the ceiling hanging plate, and check whether the lamp chassis is completely sucked. On the ceiling, screw the tapping screws, and make sure that the lamp body and the ceiling are securely connected. After installation, please turn on the power to check whether the lamps are all on.

Matters needing attention:

1. Please read the assembly drawing carefully before installing, using and repairing the lamps, and keep it properly for future use.
2. the power supply shall not exceed the specified range for a long time in the case of higher than the rated voltage range, which may cause overheating of the lamps and lanterns damage.
3. before use, please pay attention to check whether the cable and switch are in good condition, ensure that the local voltage and lamp voltage.
4. Please turn off the power before installing the lamp. .
5. Do not let the lamp be installed above high temperature objects, such as stoves, gas and exhaust cylinders, so as not to damage the lamp. .
6. Do not modify the lamps without permission to avoid failure.
7. When the lamp does not light after the power is switched on, please check whether the energy-saving lamp is good or not.
8. please regularly clean, check, please turn off the power before cleaning, wipe the surface with a soft dry cloth, but do not use acid or alkaline chemical solvent wipe, otherwise it will cause damage to the surface.