

TV Fire Stand

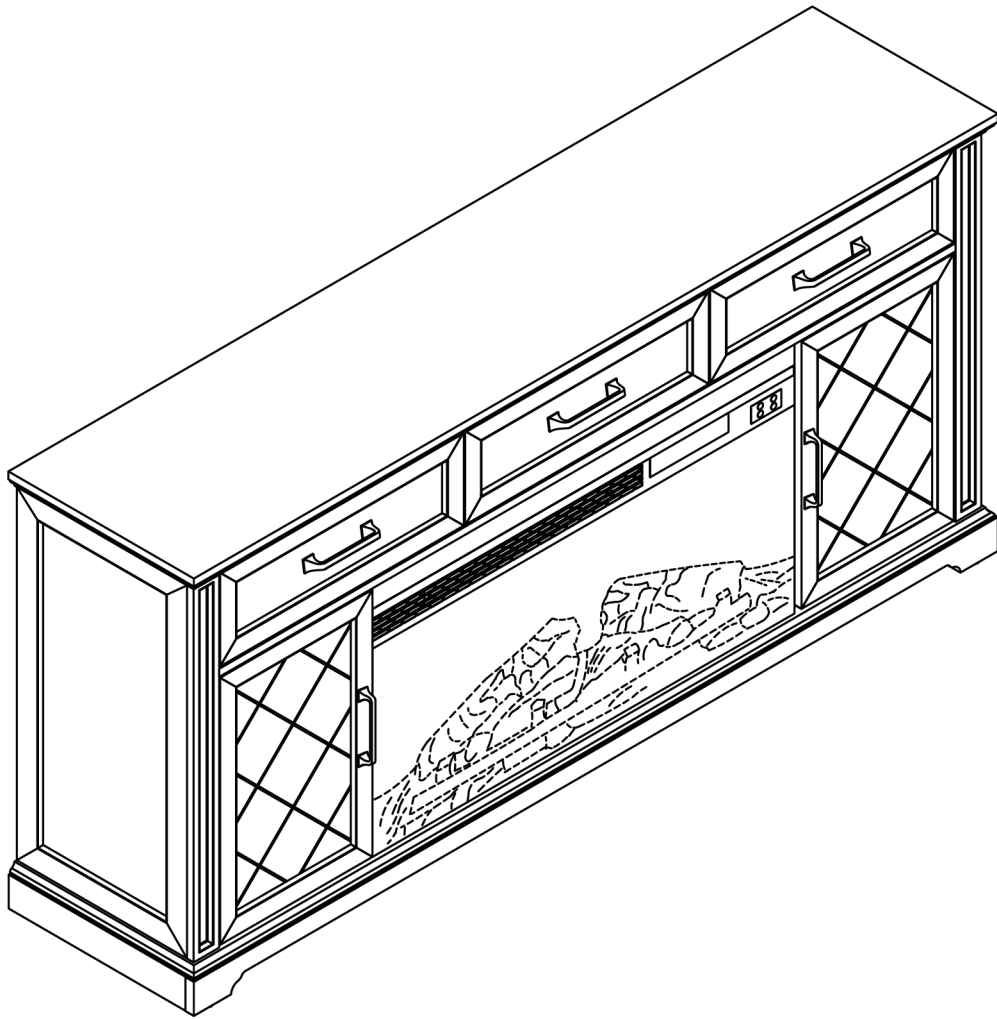



Estimated time for assembly:

120 mins



Weight limitations are as follows:

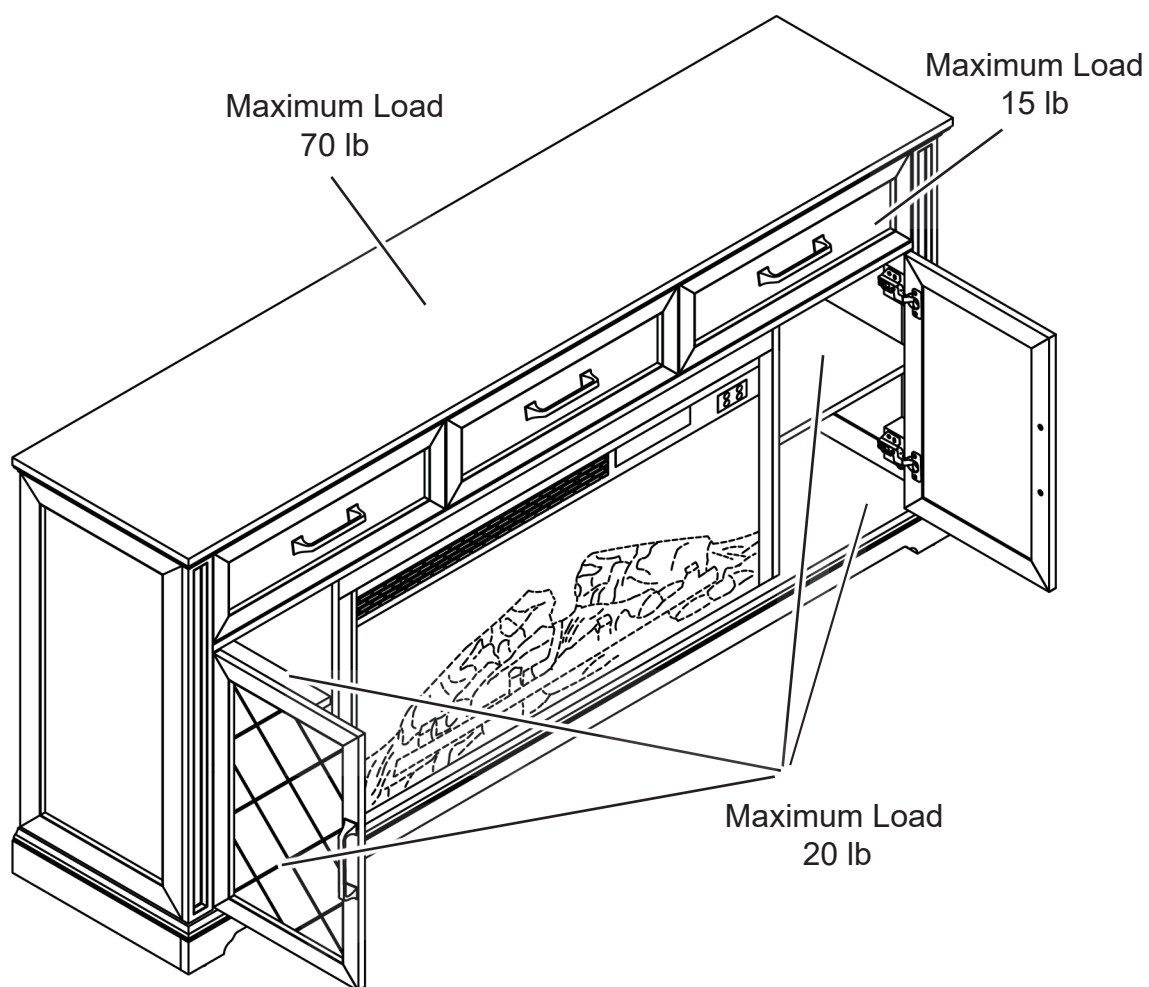

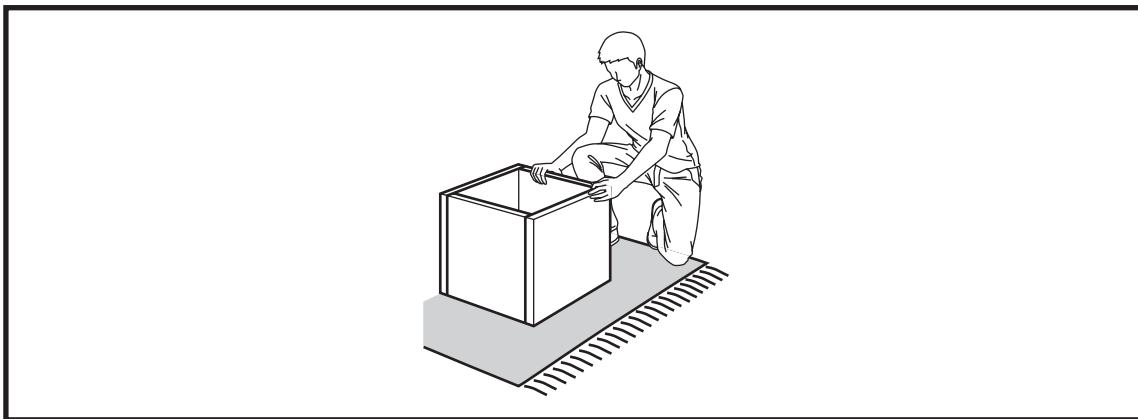

Assemble the furniture on an empty carton, carpet, or rug to prevent scratches or damage.

For safety, please keep pets and children away from the assembly area.

Ensure the product is fully assembled before use. If you are missing any hardware or products, do not use it until you have restored the missing parts.

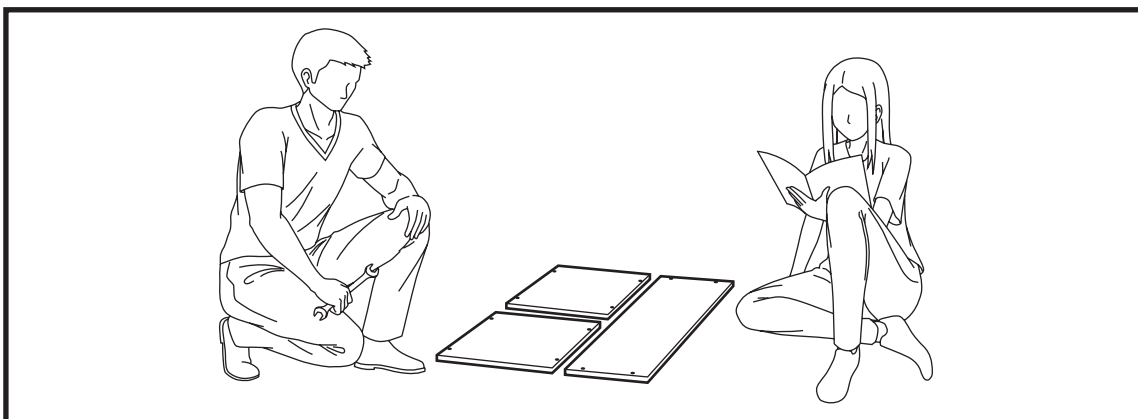

This furniture requires 2 people for assembly.

Read this instruction manual prior to assembly to familiarize yourself with the various steps.

Lay out all components and hardware separately on a flat surface and make sure that no parts are missing or damaged before assembly. Do not destroy or discard any packaging until you are certain that you have all the necessary parts for assembly.

Hand tight all hardware and careful not to over tighten to avoid damaging the product.

CAUTION

There are small components used in the construction of this product. Loose items should be kept away from pets and children to avoid a choking hazard.

Keep all plastic bags and packaging film away from pets and children to avoid suffocation.

PACKAGE CONTENTS

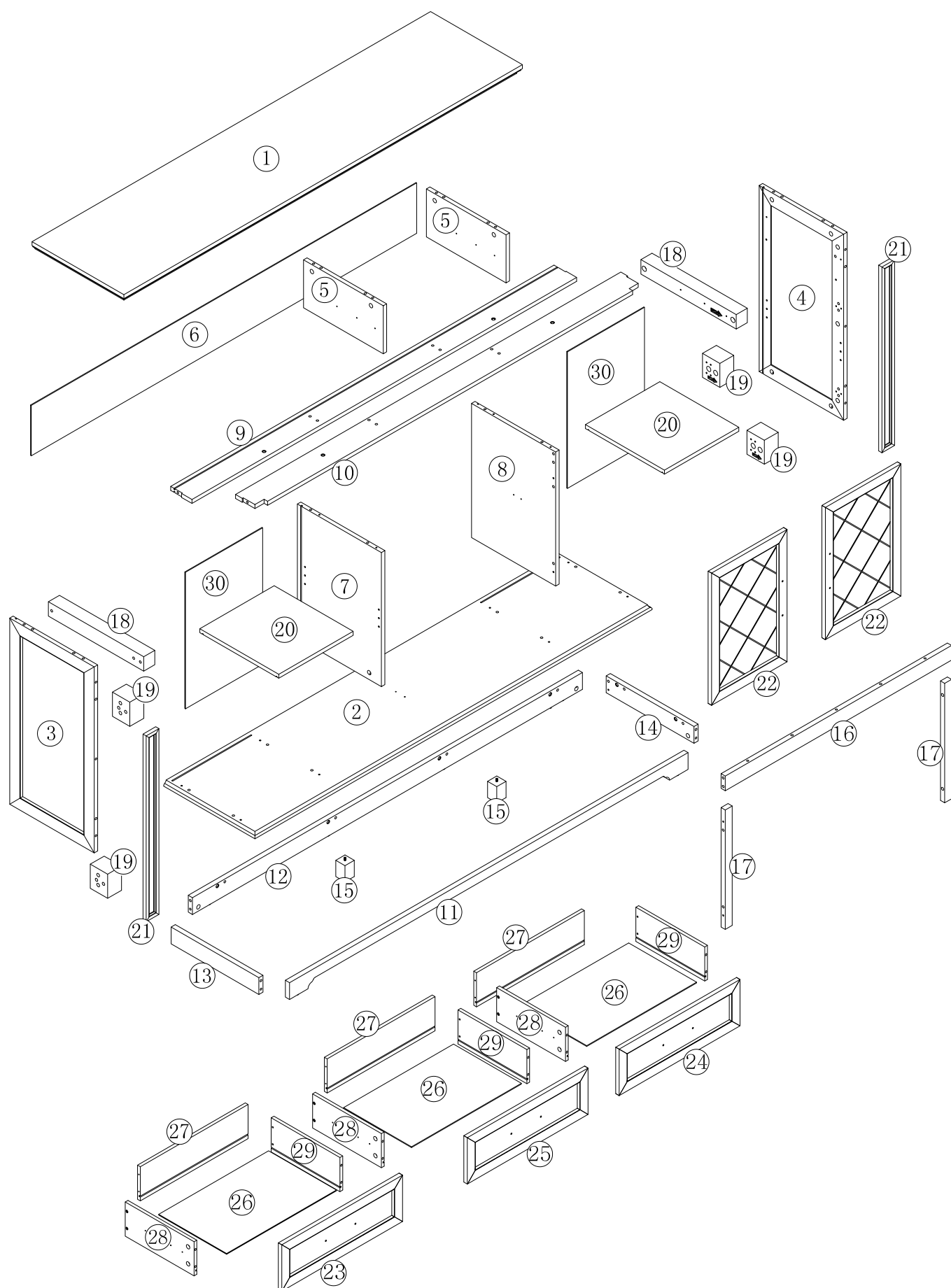

PACKAGE CONTENTS

CODE	DESCRIPTION	QTY
1	Top Panel	1
2	Bottom Panel	1
3	Left Lateral Panel	1
4	Right Lateral Panel	1
5	Upper Divider Panel	2
6	Upper Back Panel	1
7	Left Medial Panel	1
8	Right Medial Panel	1
9	Upper Back Crossbar	1
10	Upper Front Crossbar	1
11	Front Base Strip	1
12	Back Base Strip	1
13	Left Base Strip	1
14	Right Base Strip	1
15	Support Leg	2
16	Top Surround Strip	1
17	Side Surround Strip	2
18	Slider Rail Attach Block	2
19	Door Hinge Attach Block	4
20	Storage Shelf Panel	2

PACKAGE CONTENTS

CODE	DESCRIPTION	QTY
21	Decoration Strip	2
22	Cabinet Door	2
23	Drawer Front Panel	1
24	Drawer Front Panel	1
25	Drawer Front Panel	1
26	Drawer Bottom Panel	3
27	Drawer Back Panel	3
28	Drawer Left Panel	3
29	Drawer Right Panel	3
30	Side Back Panel	2

PACKAGE CONTENTS

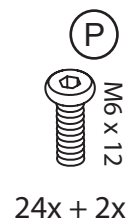
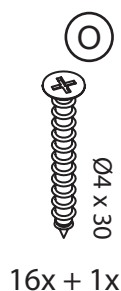
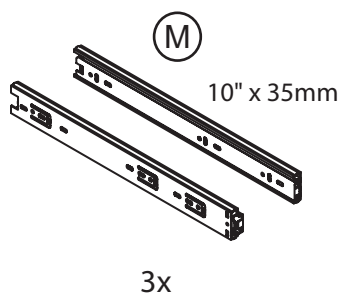
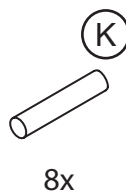
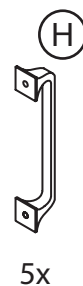
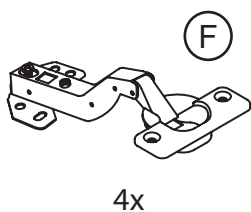
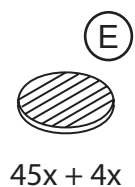
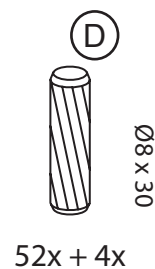
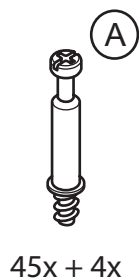

Install all hardware perpendicular to the opening.

PACKAGE CONTENTS

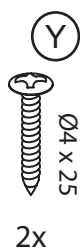
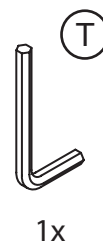
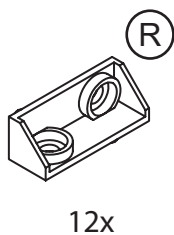
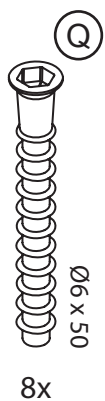

Install all hardware perpendicular to the opening.

Required tools for assembly (Not included)

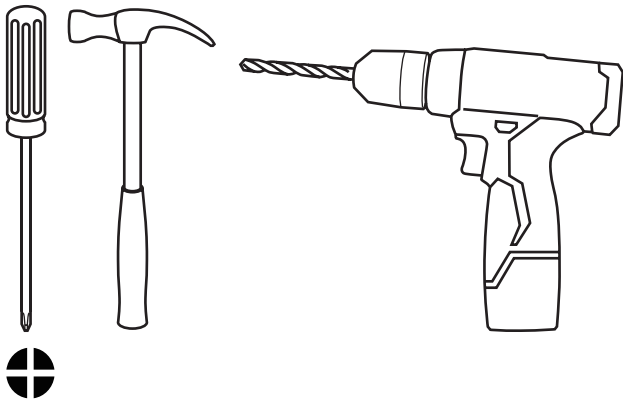

1

Attach cam bolts to front, left, and right base strips (11, 13, 14).

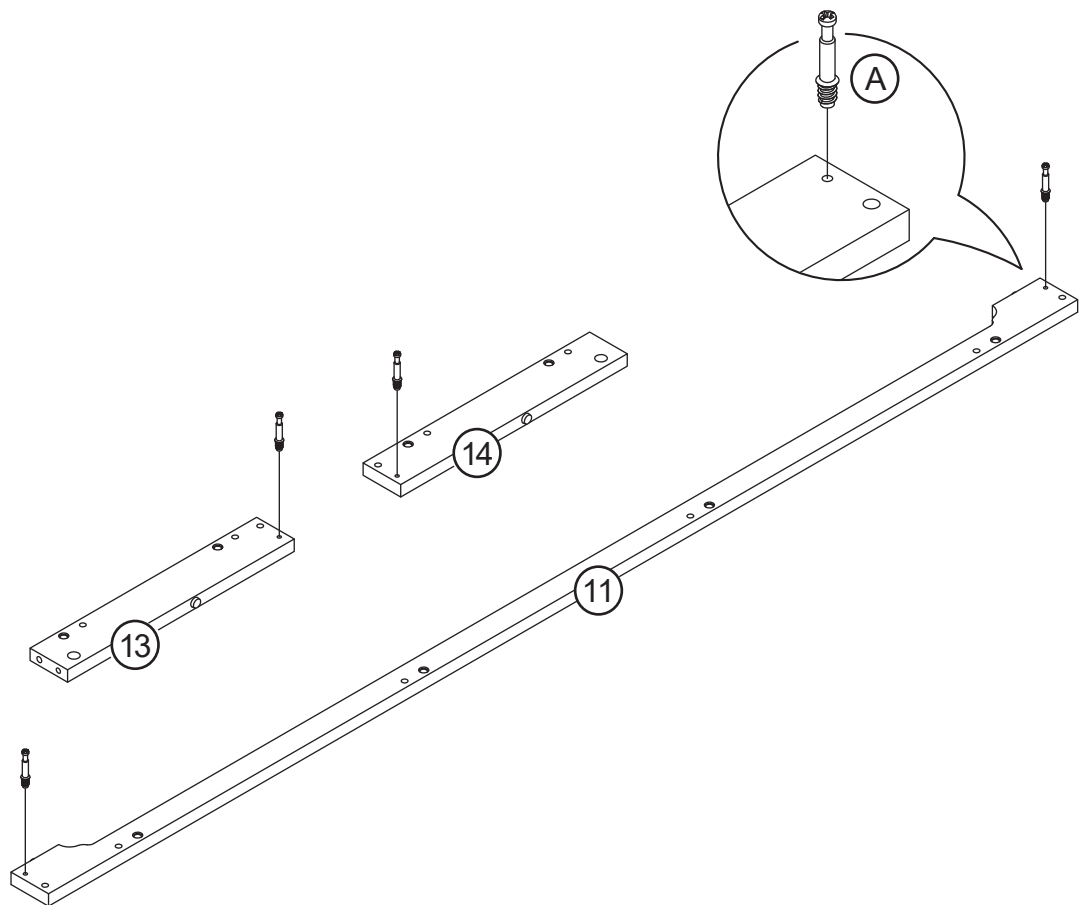
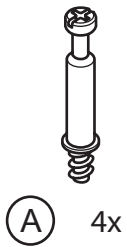

2

Insert wood dowels to the back, left, and right base strips (12, 13, 14).

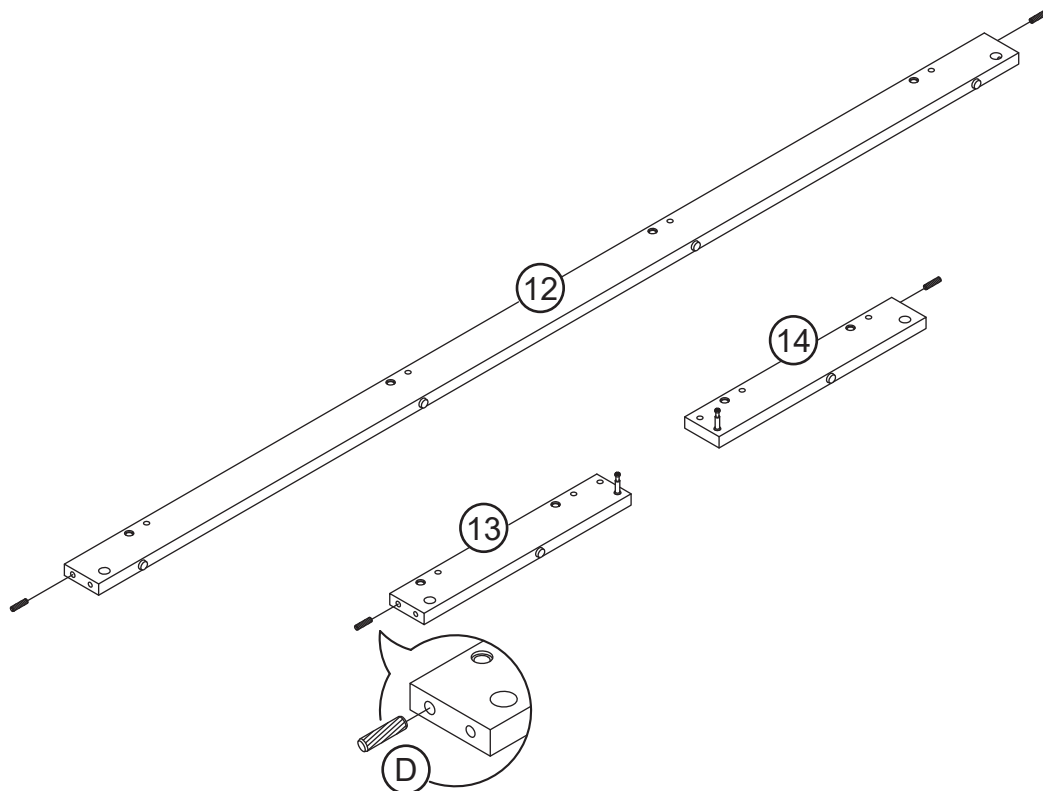
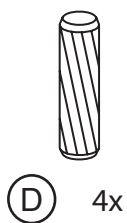

3

Attach corner connectors to all the base strips (11, 12, 13, 14).

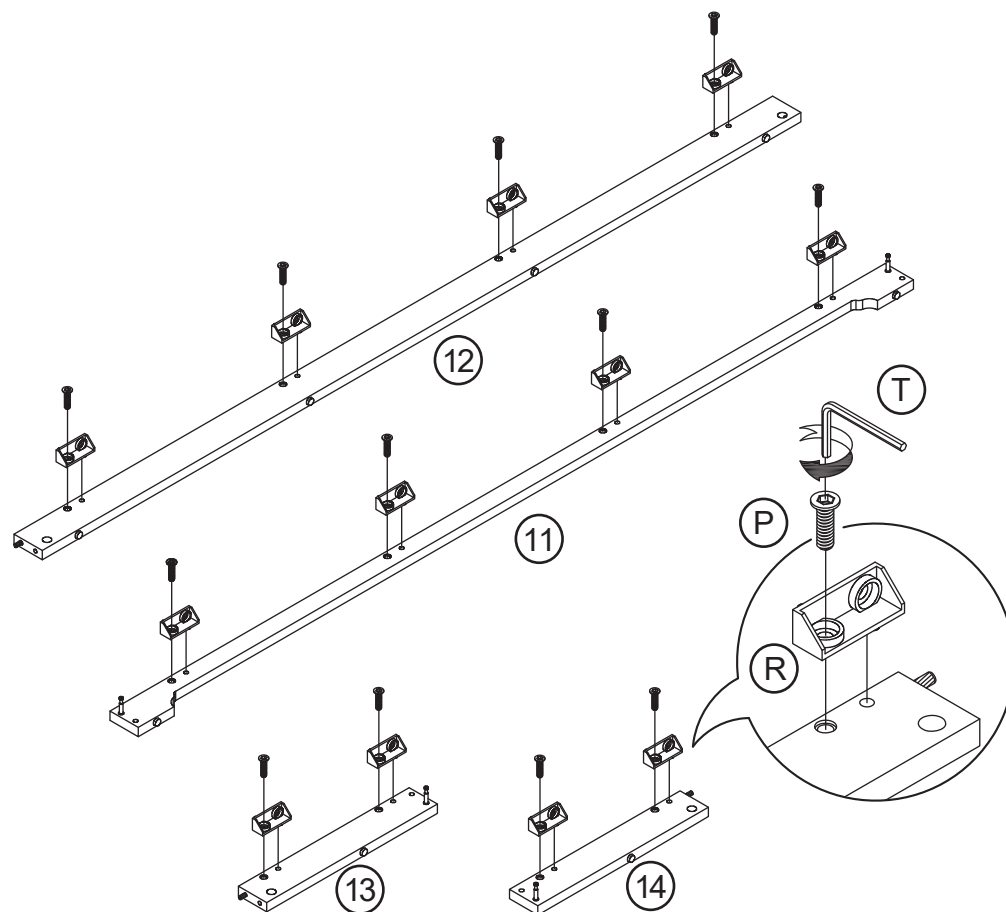
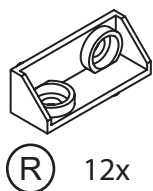
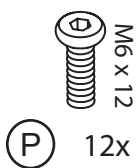

4

Assemble the back base strip (12) between the left and right base strips (13, 14).

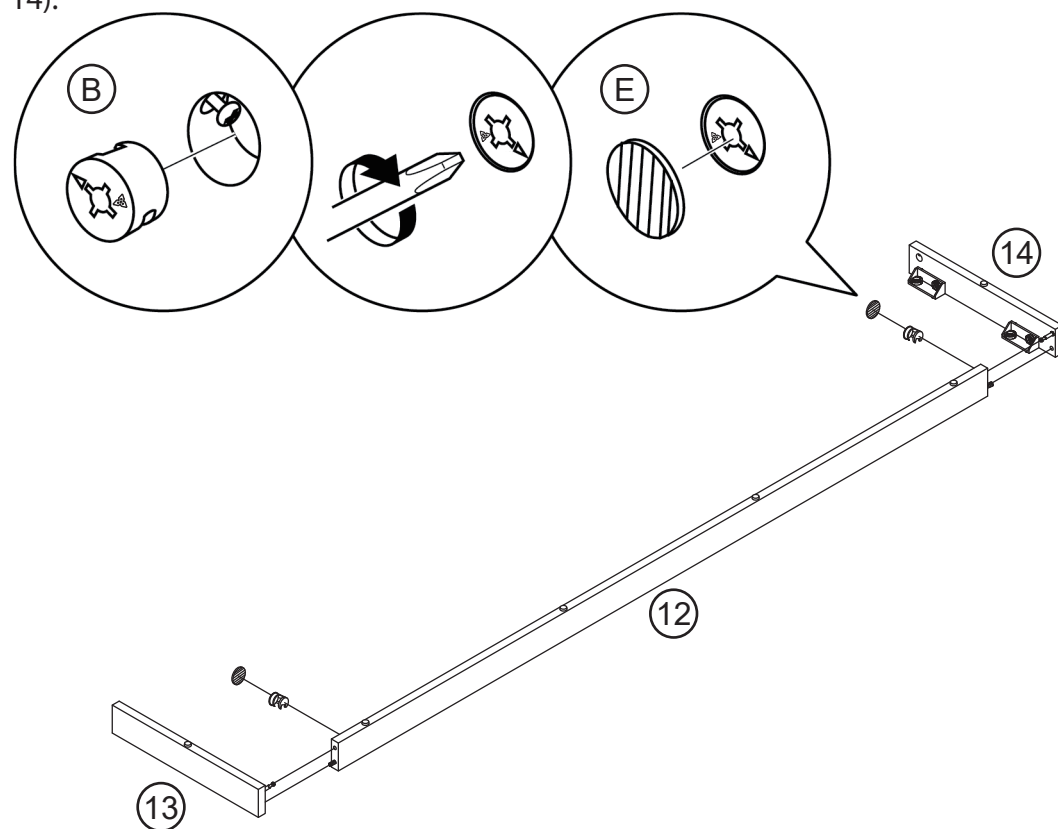
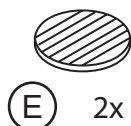
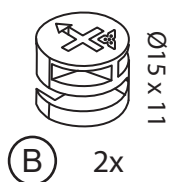

5

Assemble the front base strip (11) to the base assembly.

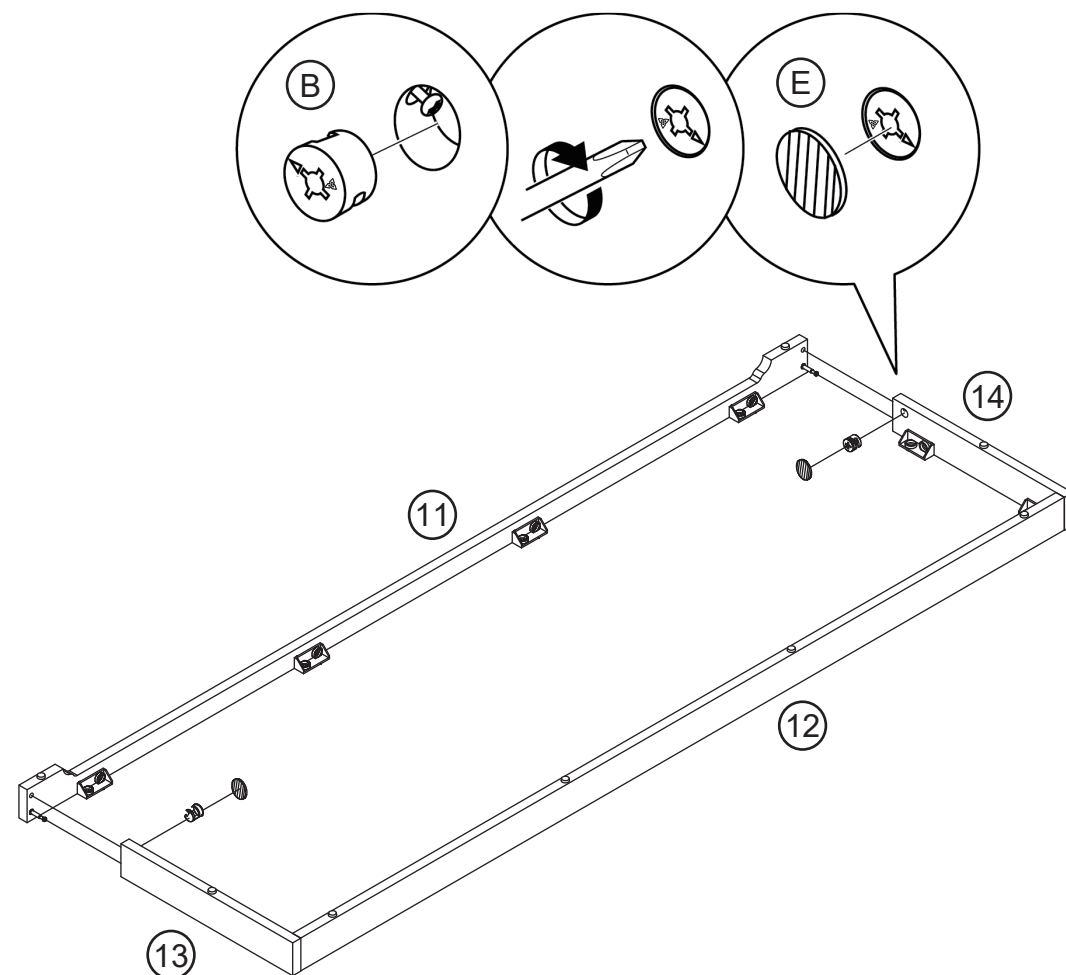
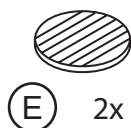
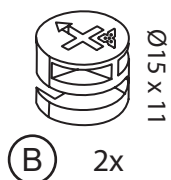

6

Assemble the base assembly to the underside of the bottom panel (2).

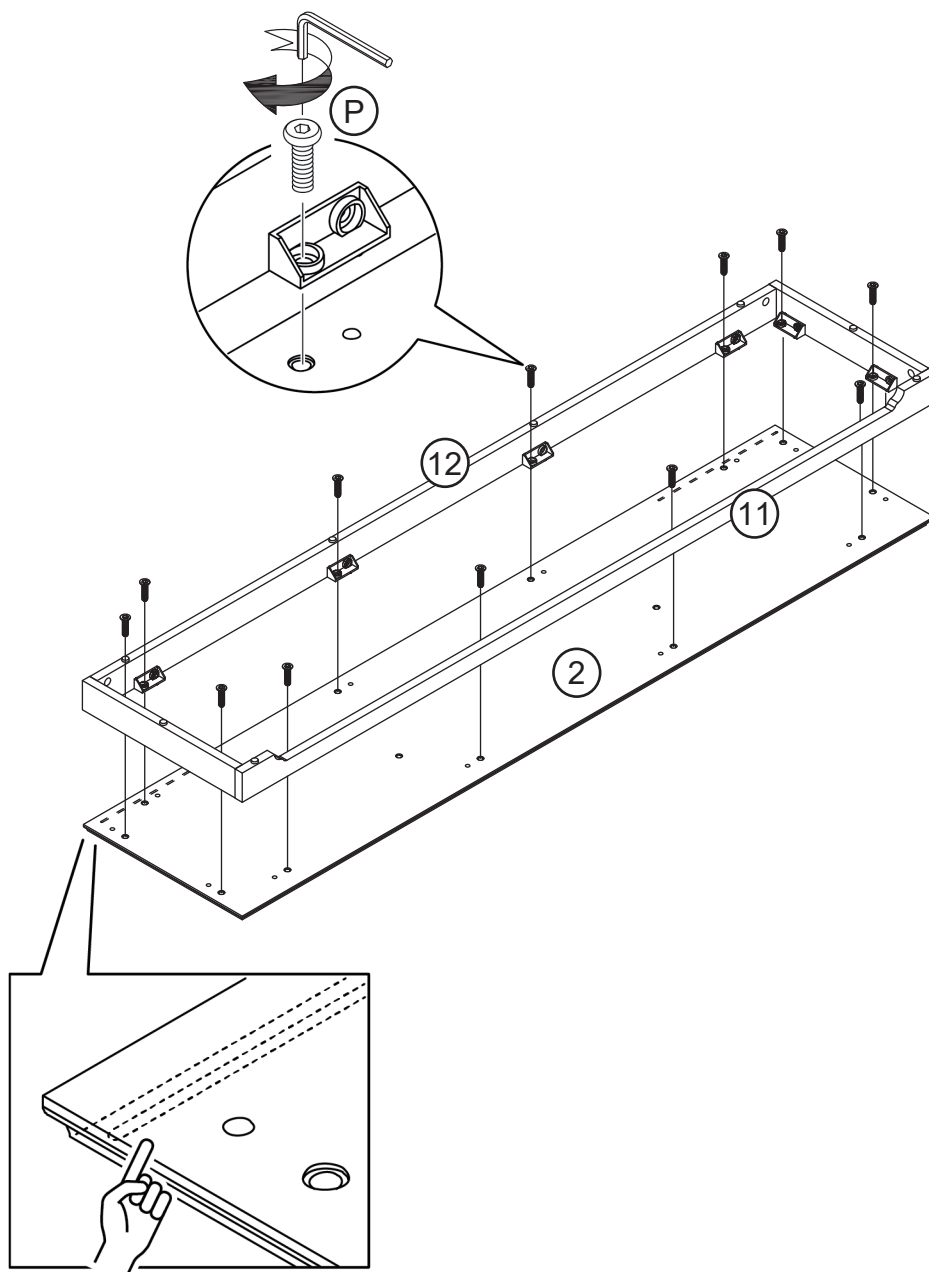
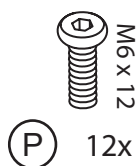

7

Attach support legs (15) to the bottom panel (2).

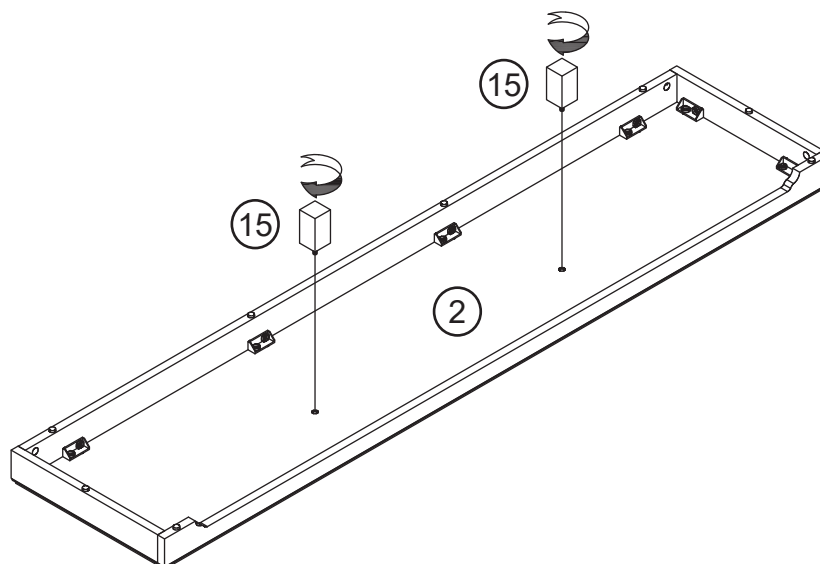

8

Attach cam bolts to the top of the bottom panel (2).

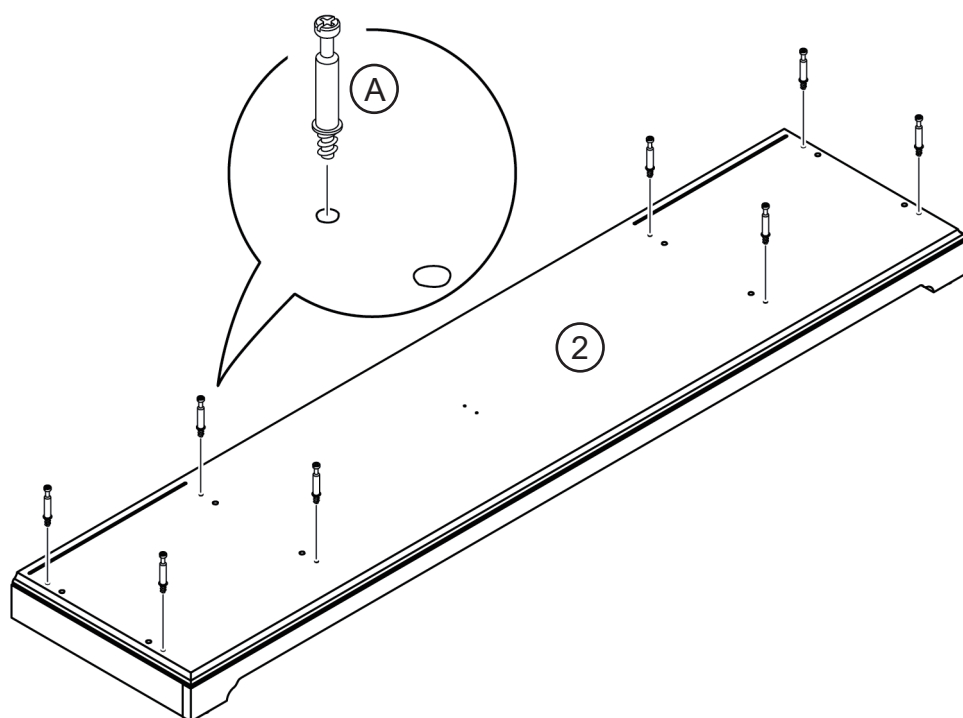
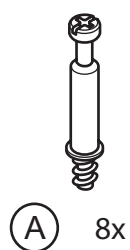

9

Attach cam bolts to the lateral panels (3, 4) and the decoration strips (21)

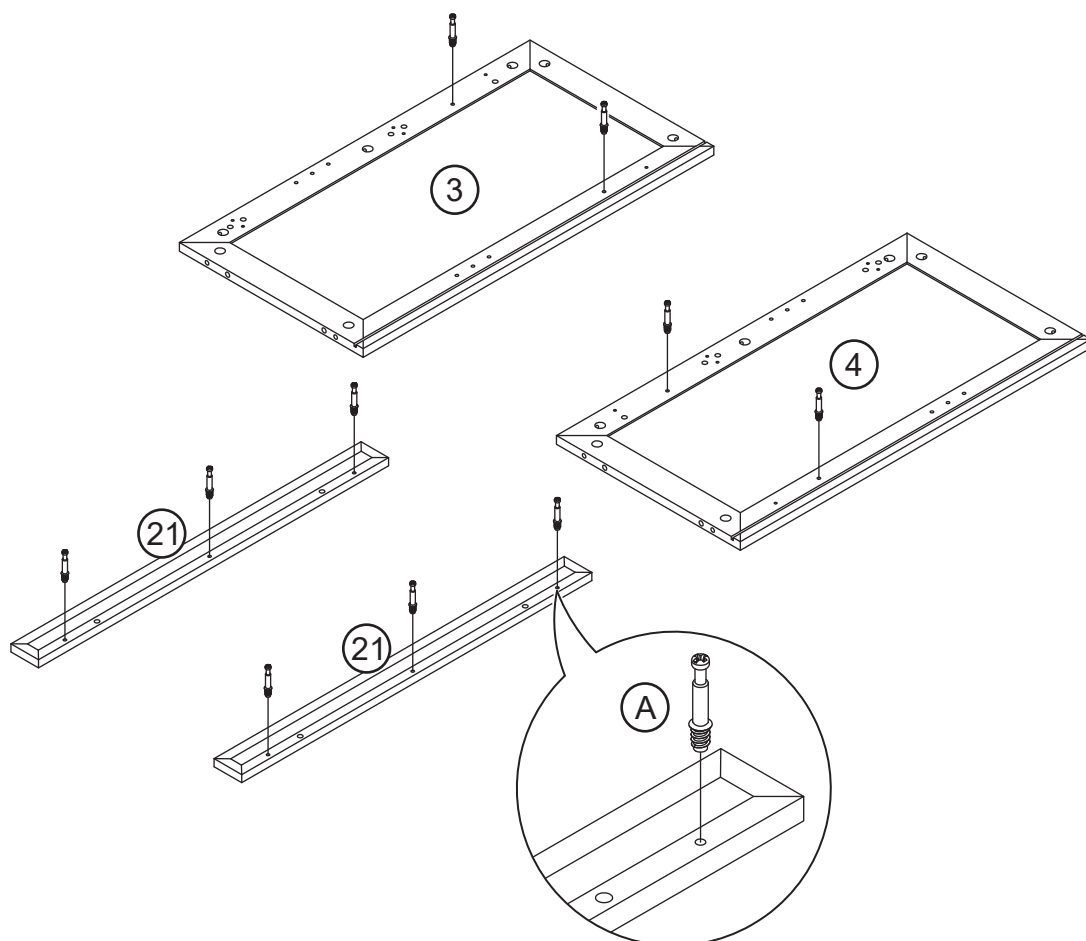
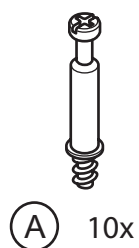

10

Insert wood dowels to the lateral panels (3, 4).

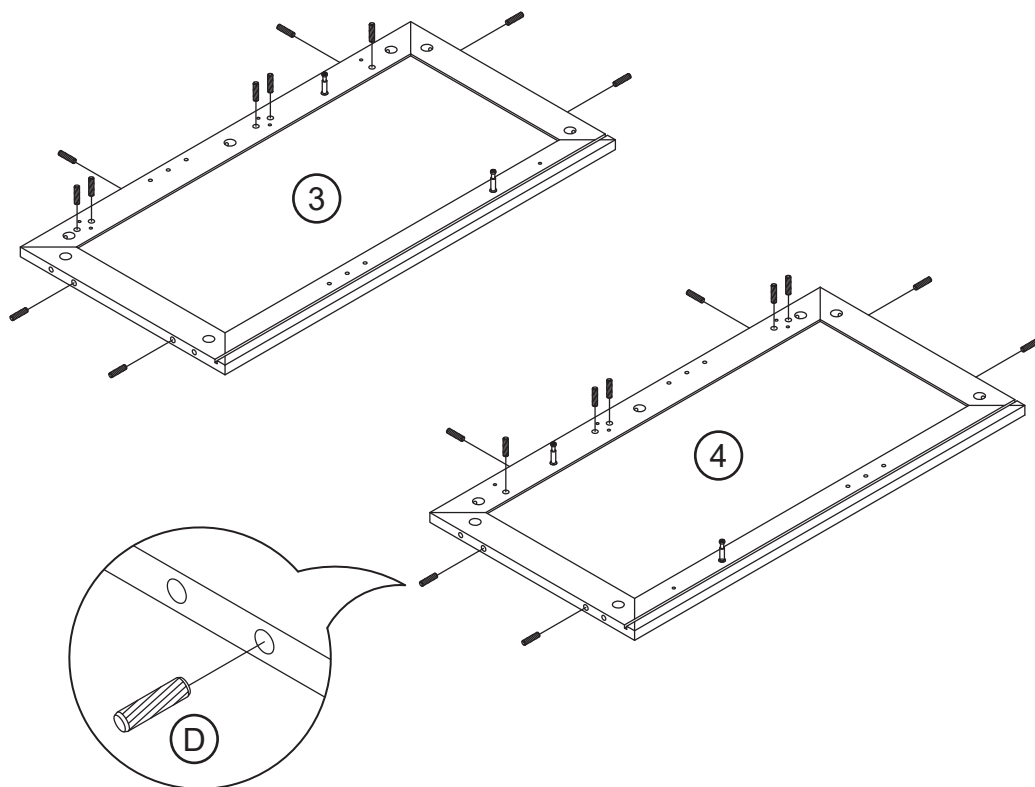
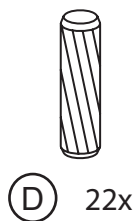

11

Attach decoration strips (21) on each of the lateral panels (3, 4).

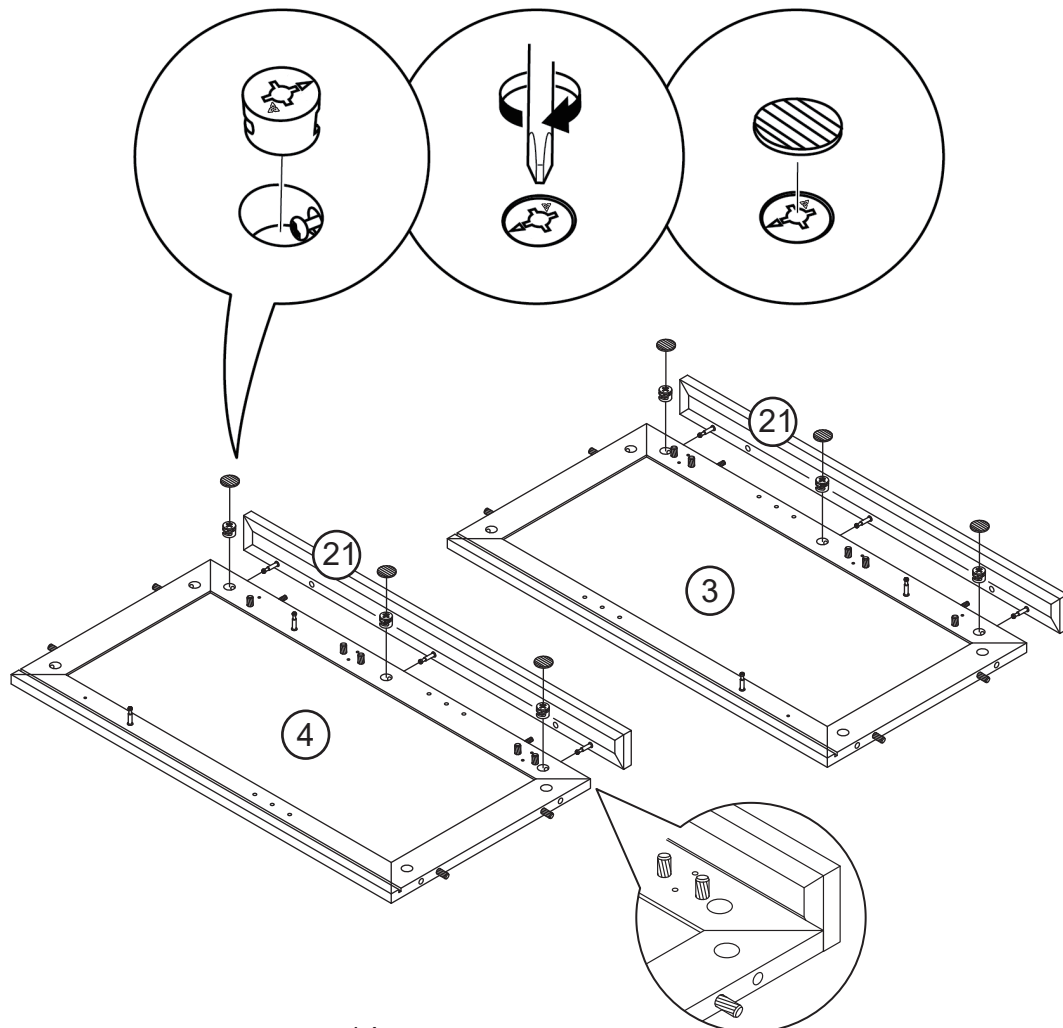
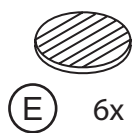
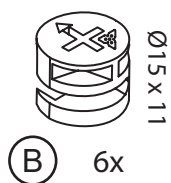

12

Attach door hinge blocks (19) onto the lateral panels (3, 4).



M5 x 35

(L)

8x

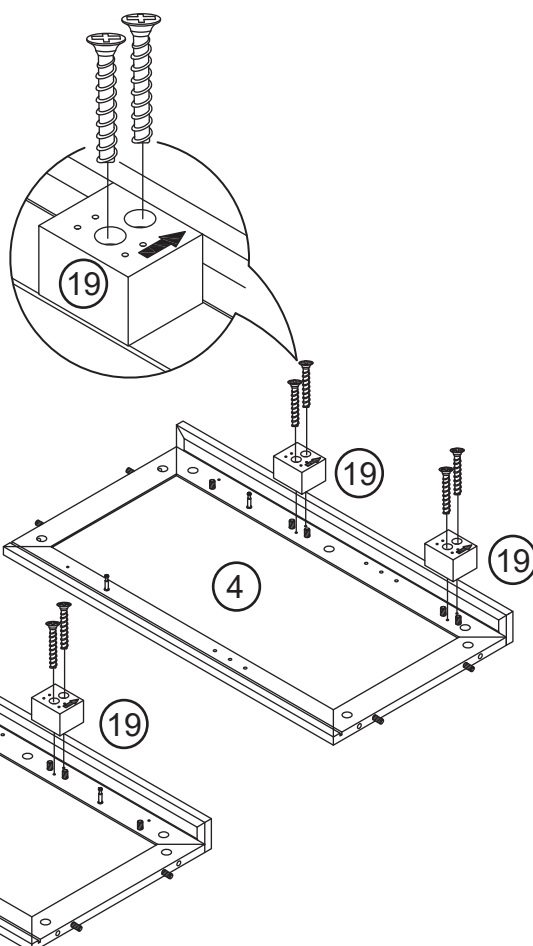
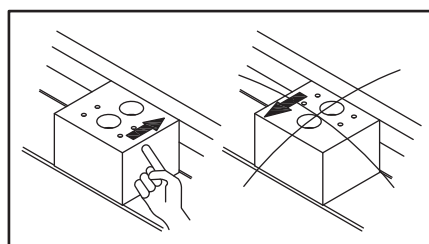

13

Attach slider rail blocks (18) onto the lateral panels (3, 4).

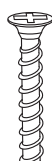

M5 x 35

(L)

4x

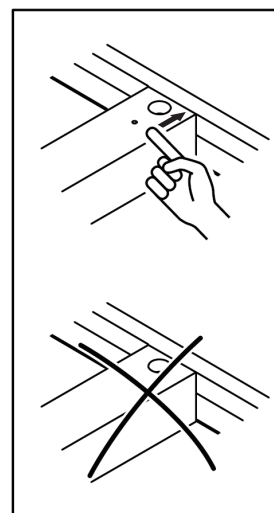
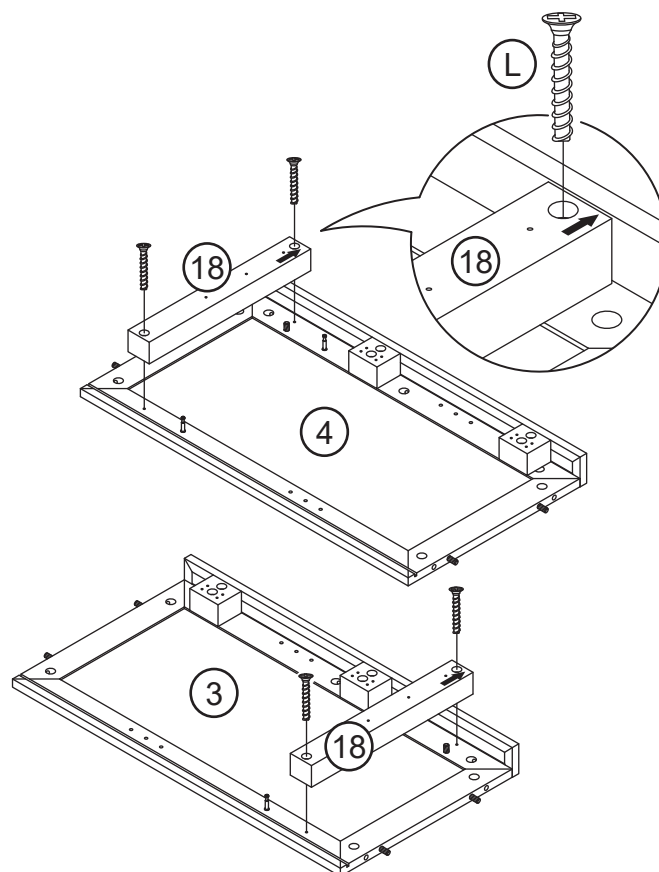

Detach the slider from all the slide brackets.

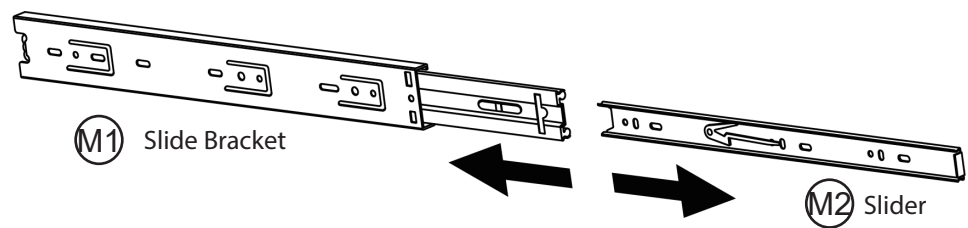
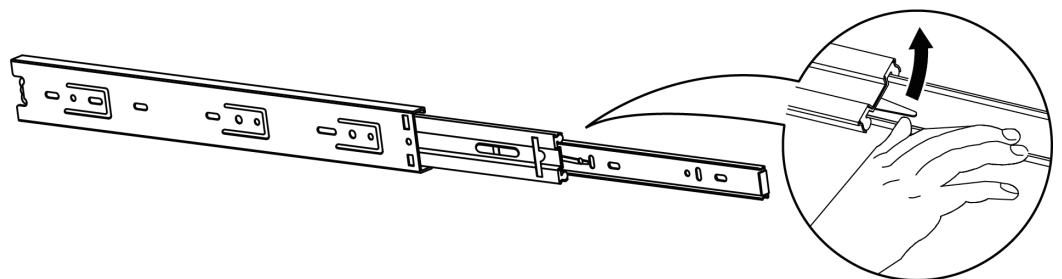
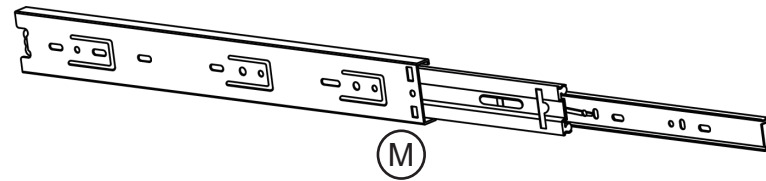

Attach slide brackets to the lateral panels (3, 4).

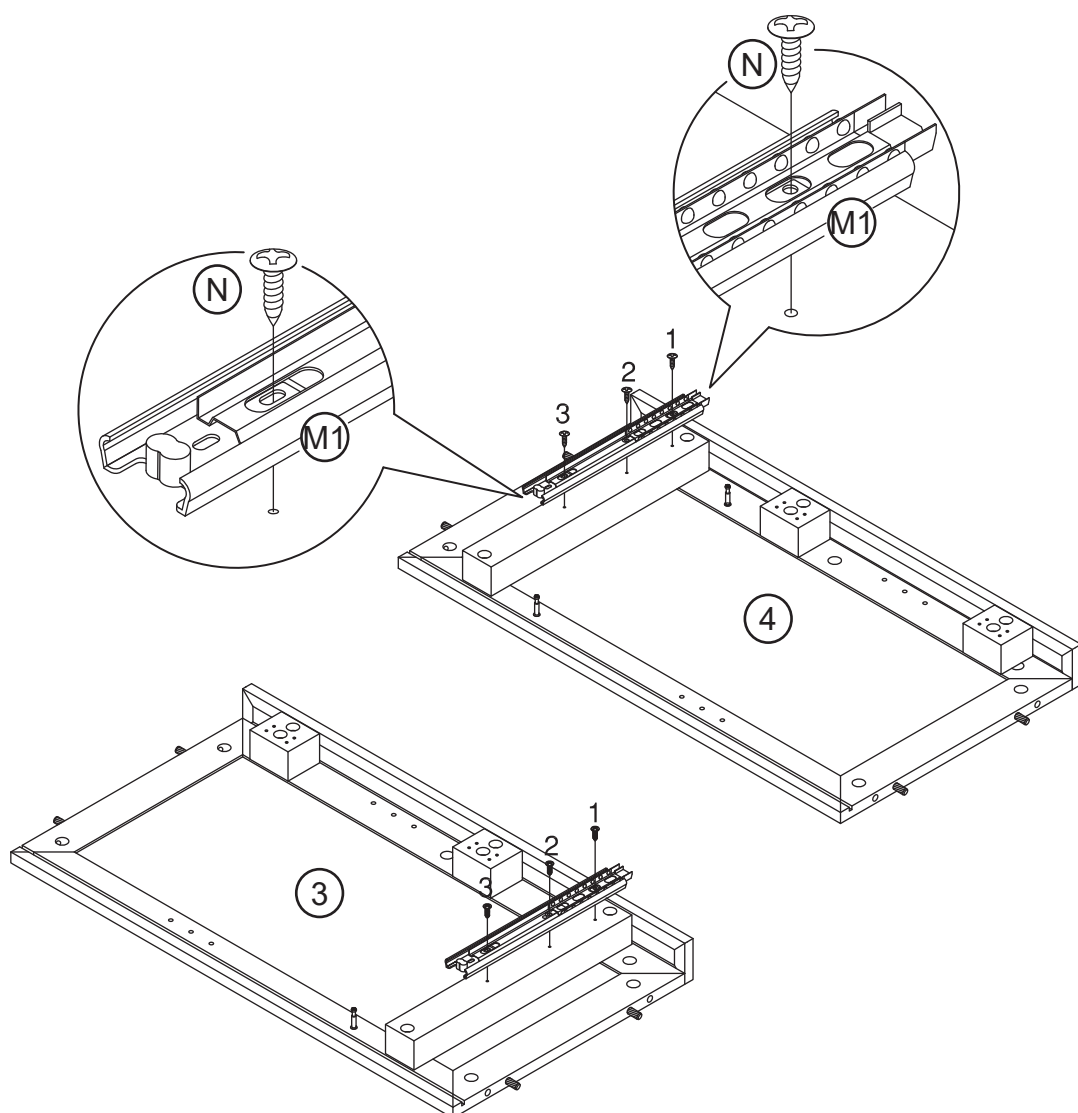
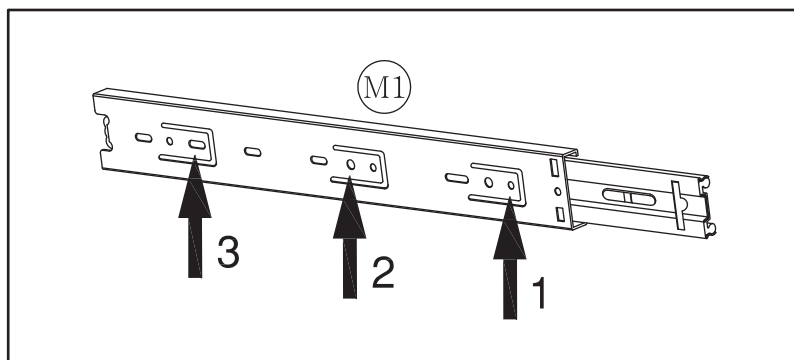
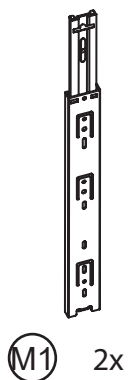

16



(M1) 2x



(N) 6x

Attach the rest of the slide brackets to both sides of the upper divider panels (5).

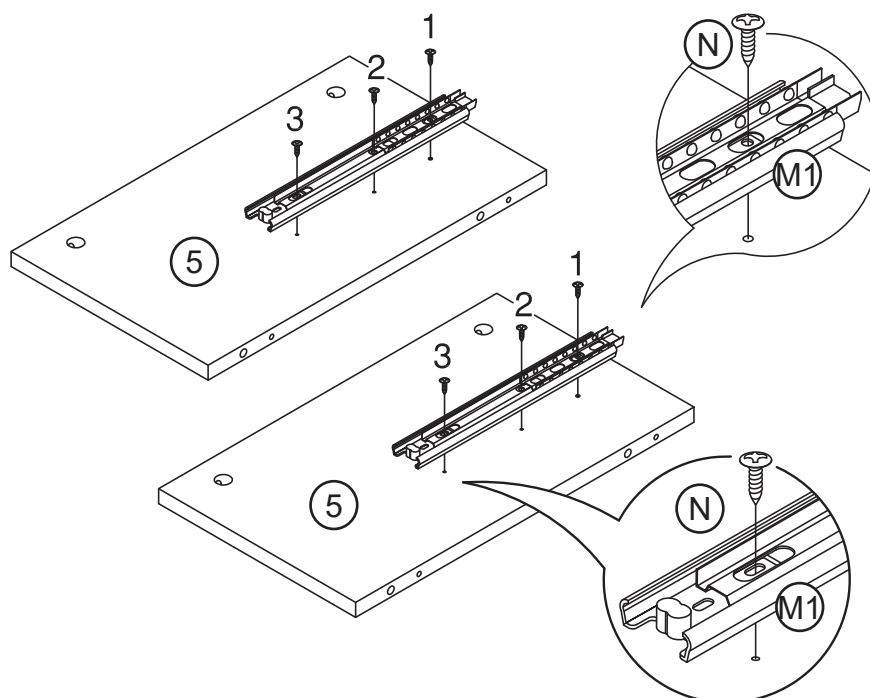
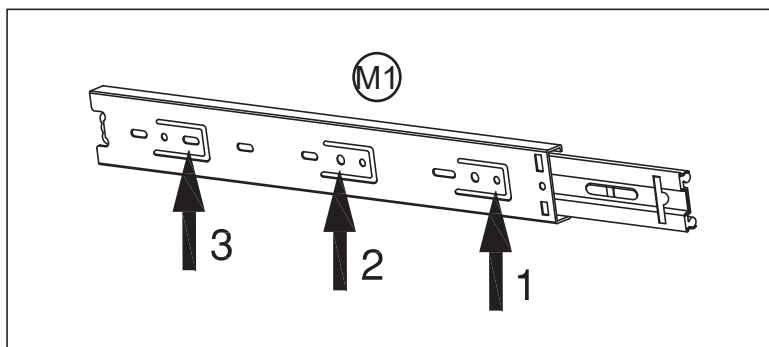

17

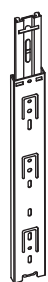

10" x 35mm

(M1) 2x



Ø3.5 x 12

(N) 6x

Attach the sliding bracket to the other side of the upper divider panels (5).

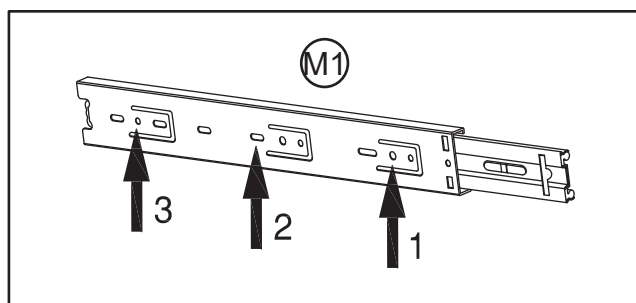

Please note that the position of the premounting holes is different.

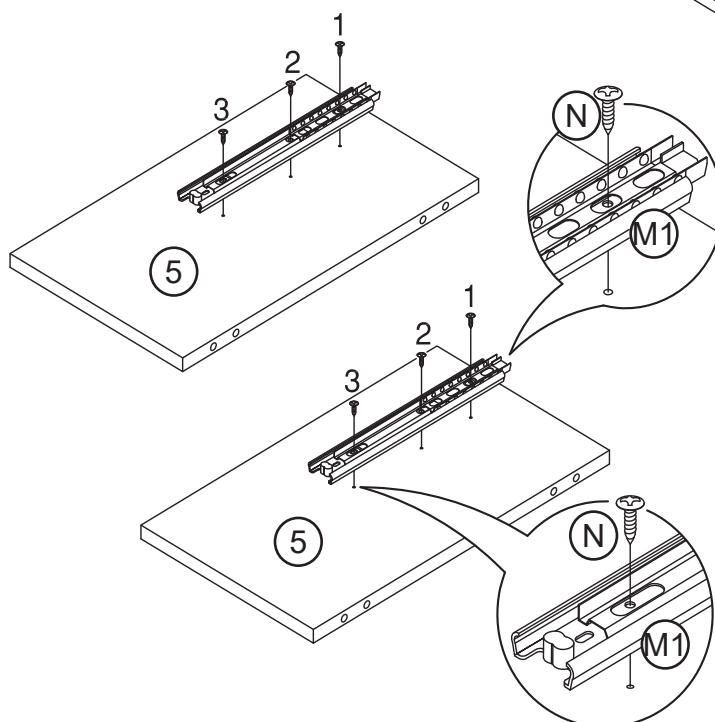
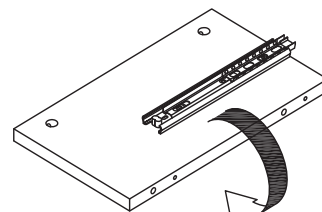

18

Insert wood dowels to the surround strips (16, 17).

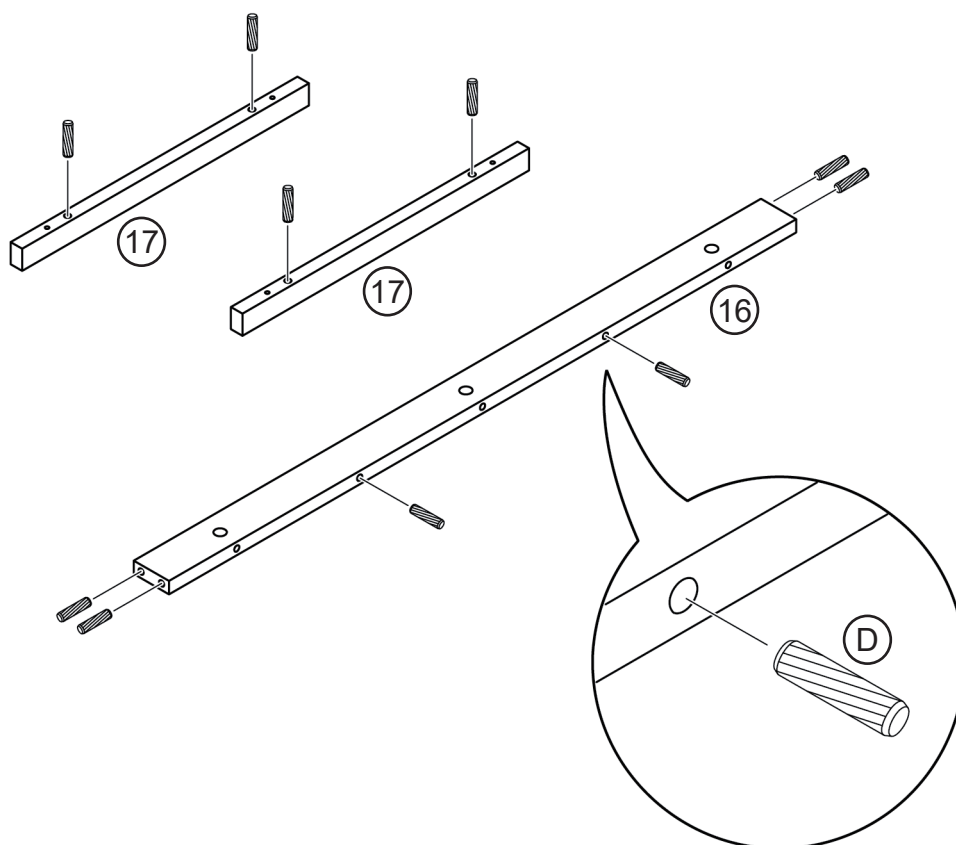
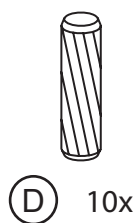

19

Attach side surround strips (17) to each of the medial panels (7, 8).

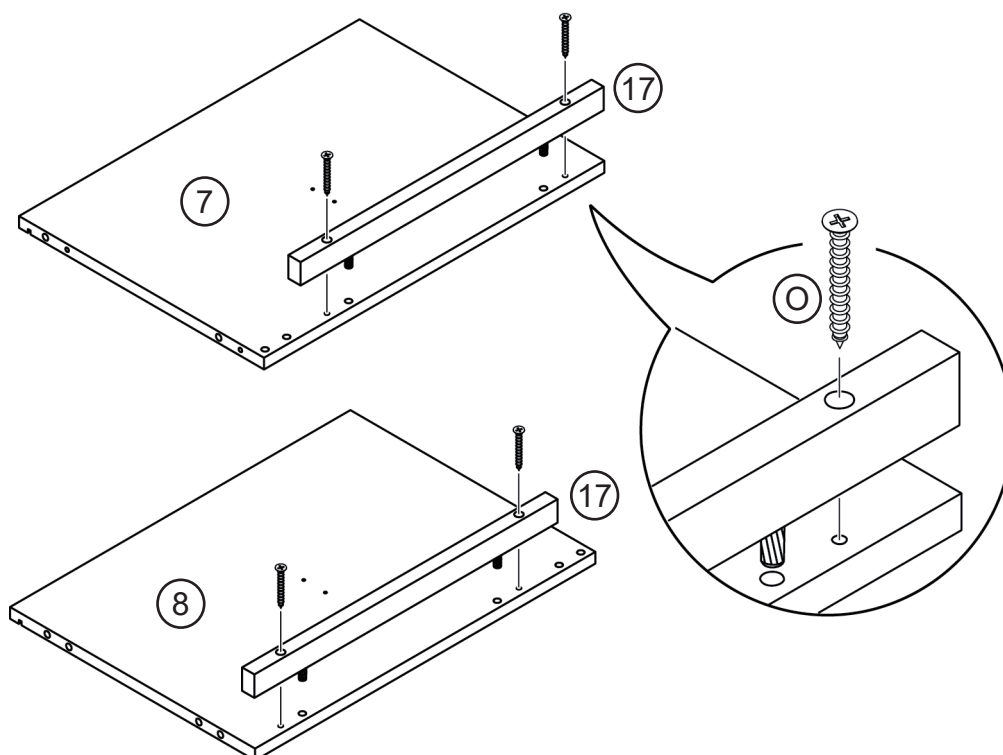
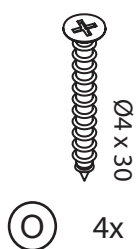

20

Assemble the top surround strip (16) between the medial panels (7, 8).

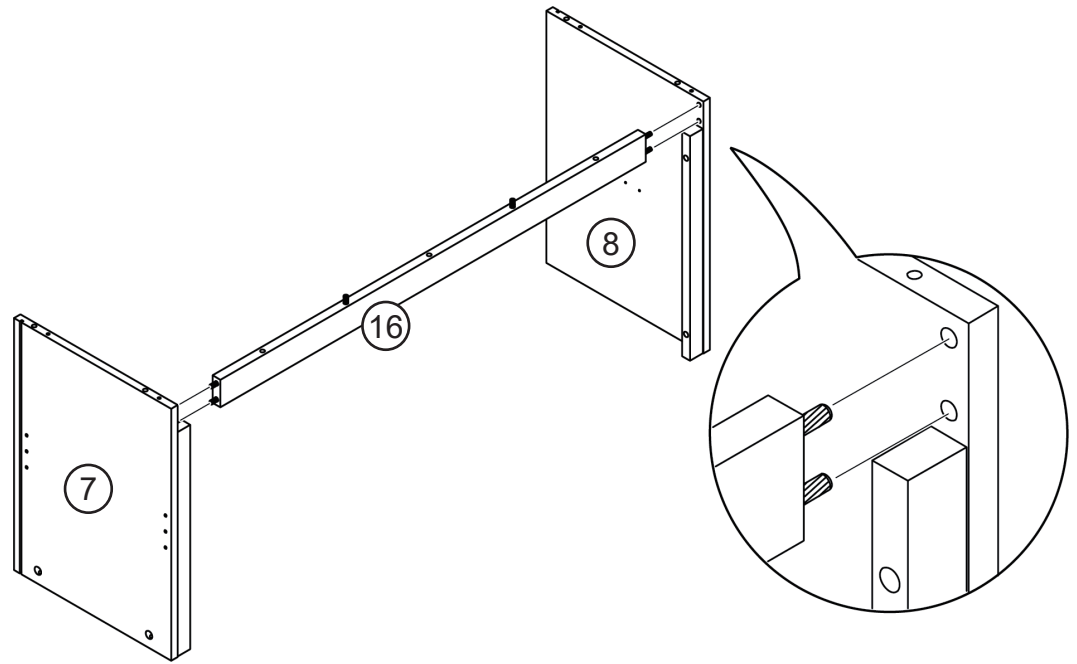

21

Insert wood dowels into the medial panels (7, 8).

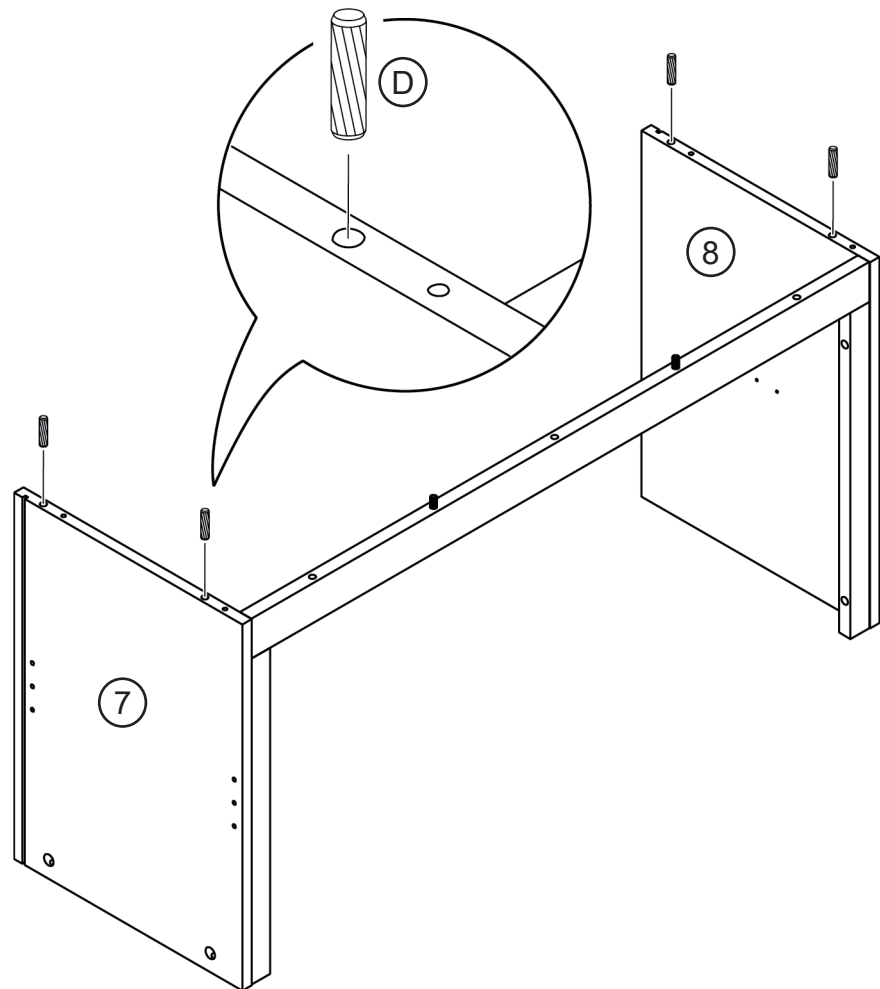
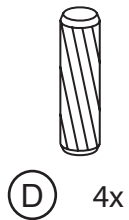

22

Attach cam bolts to the upper front crossbar (10).

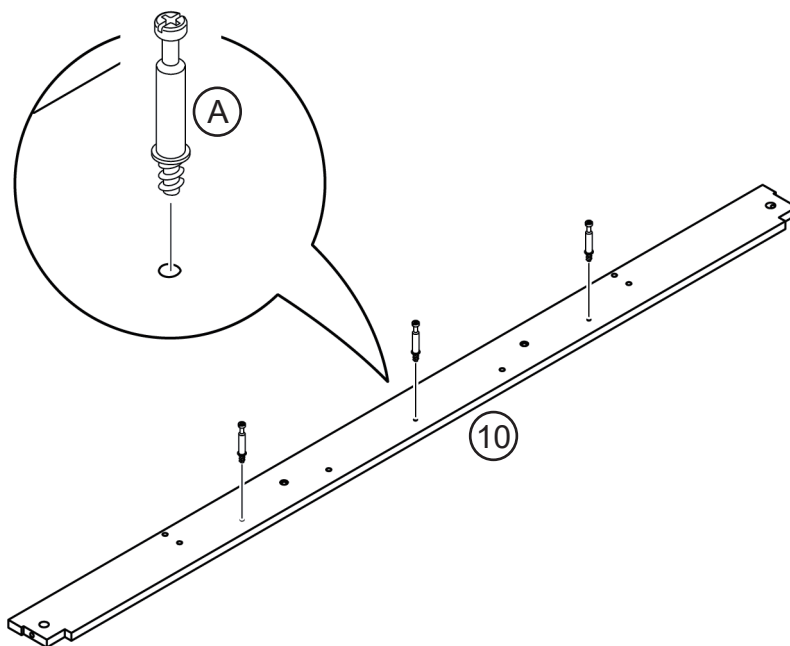
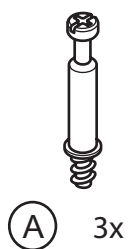

23

Assemble the upper front and back crossbars (9, 10) to the upper divider panels (5).

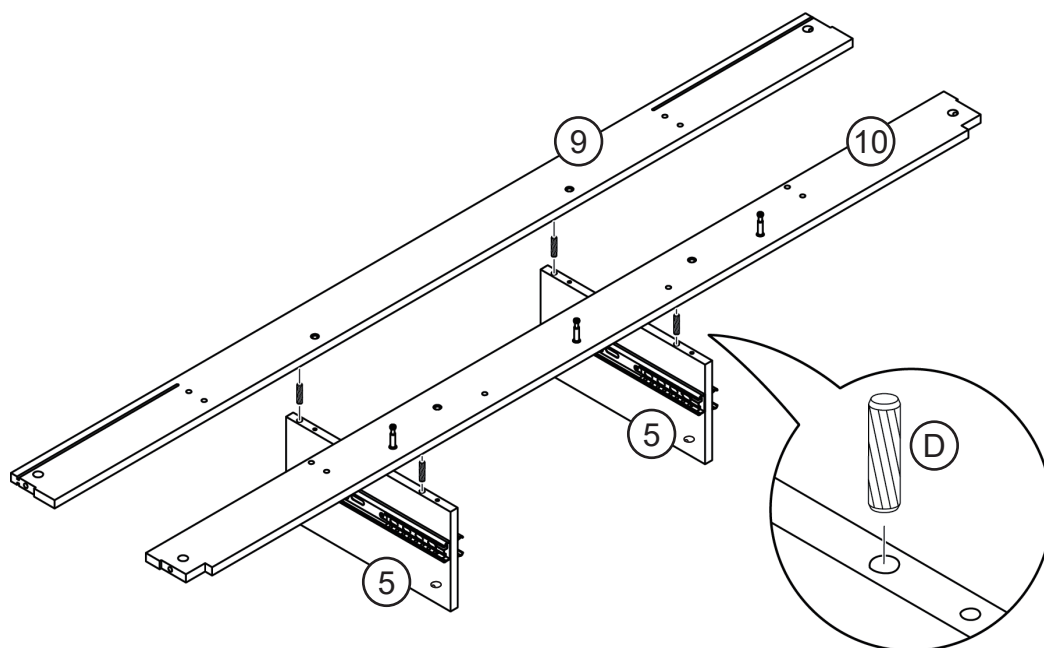
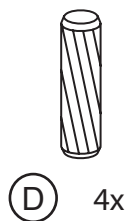

24

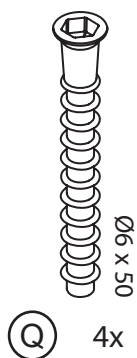

Secure the upper crossbars (9, 10) to the upper divider panels (5).

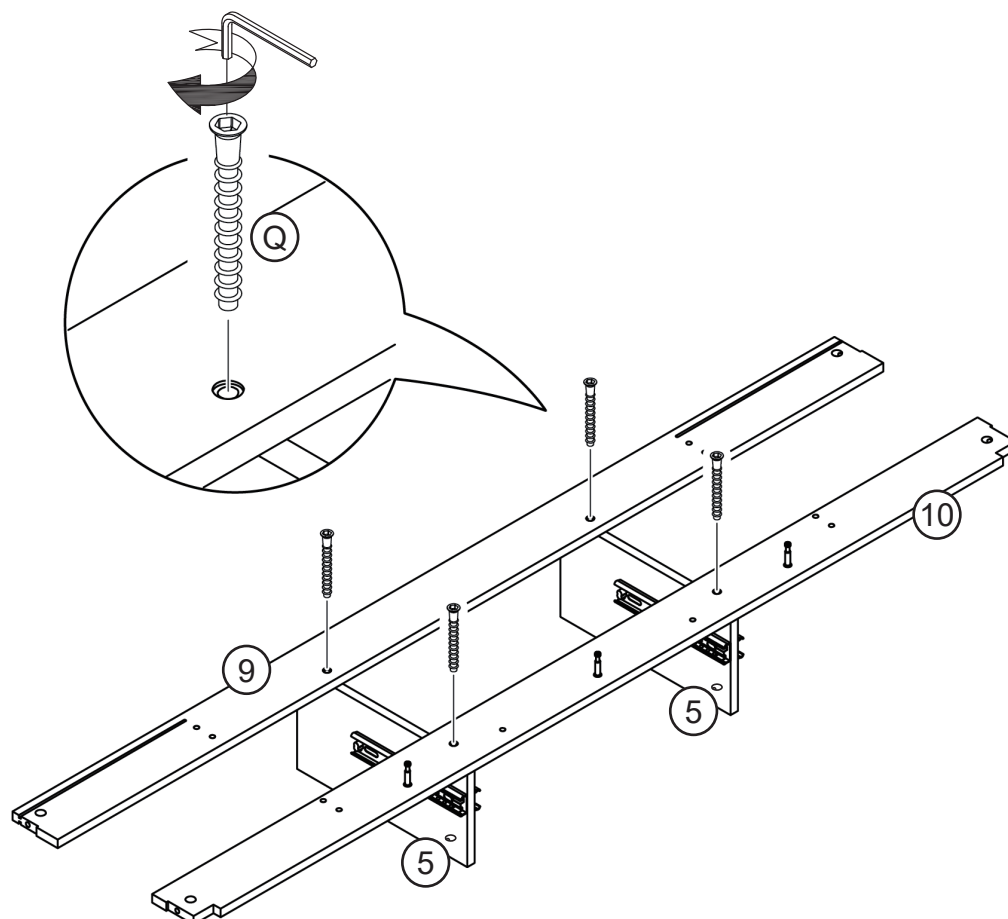

25

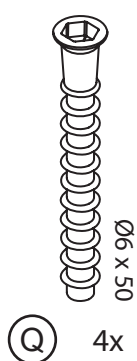

Assemble the upper crossbar assembly on top of the medial panels (7, 8).

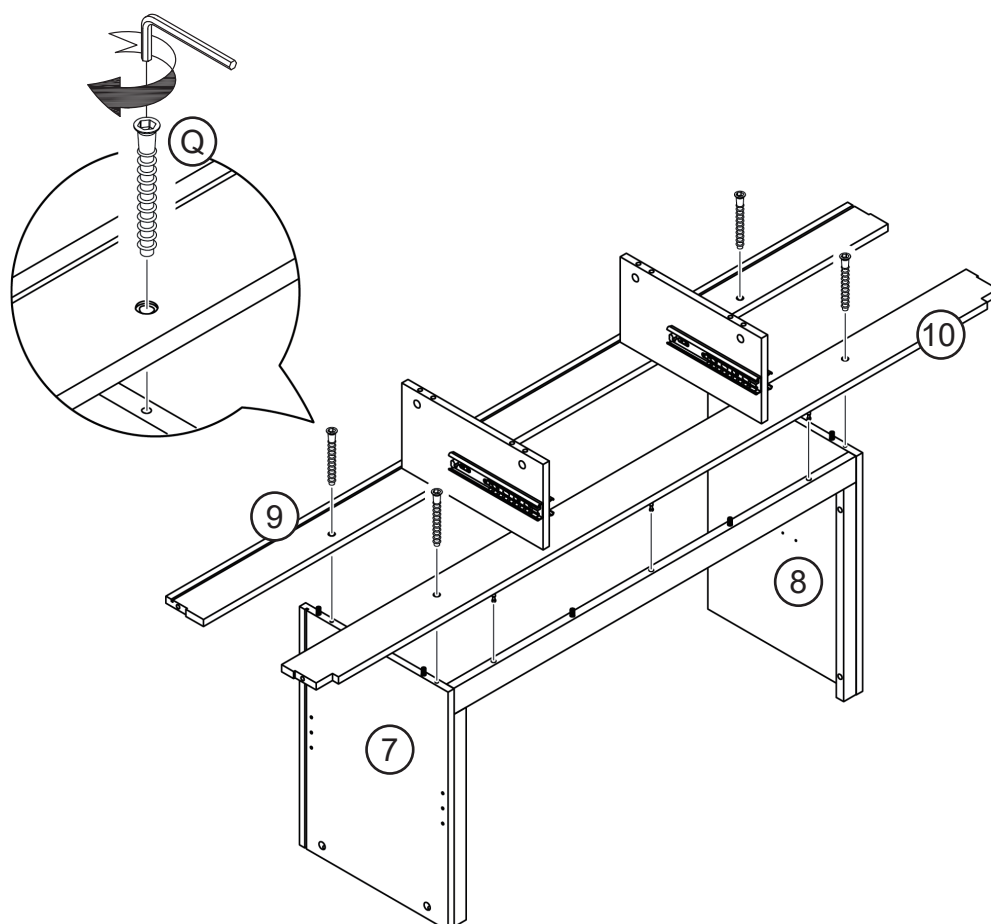

Further secure the upper front crossbar (10) to the top surround strip (16).

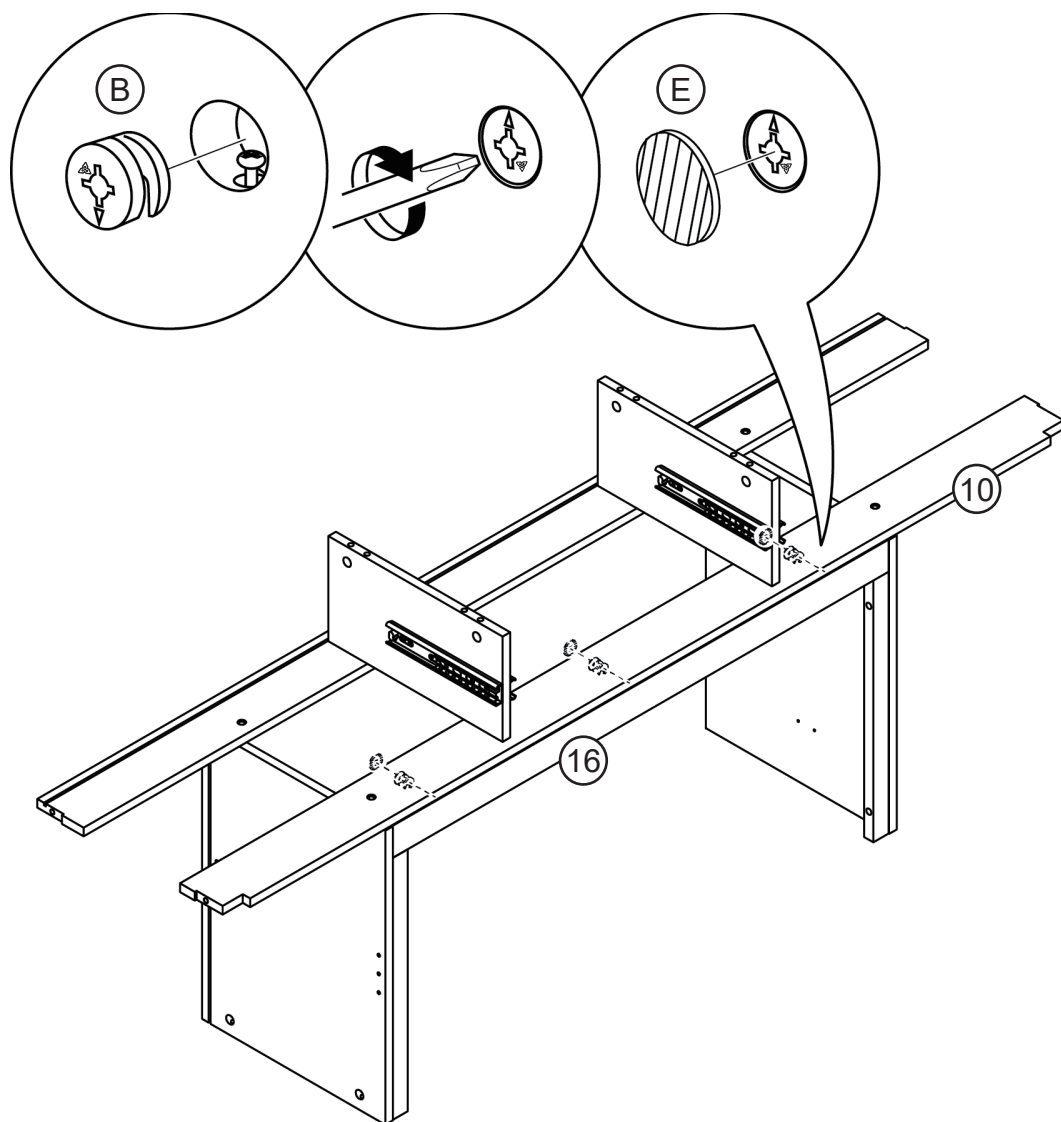
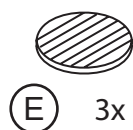
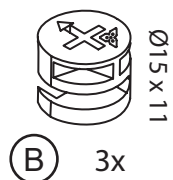

Assemble the lateral panels (3, 4) to the sides of the upper crossbars (9, 10).

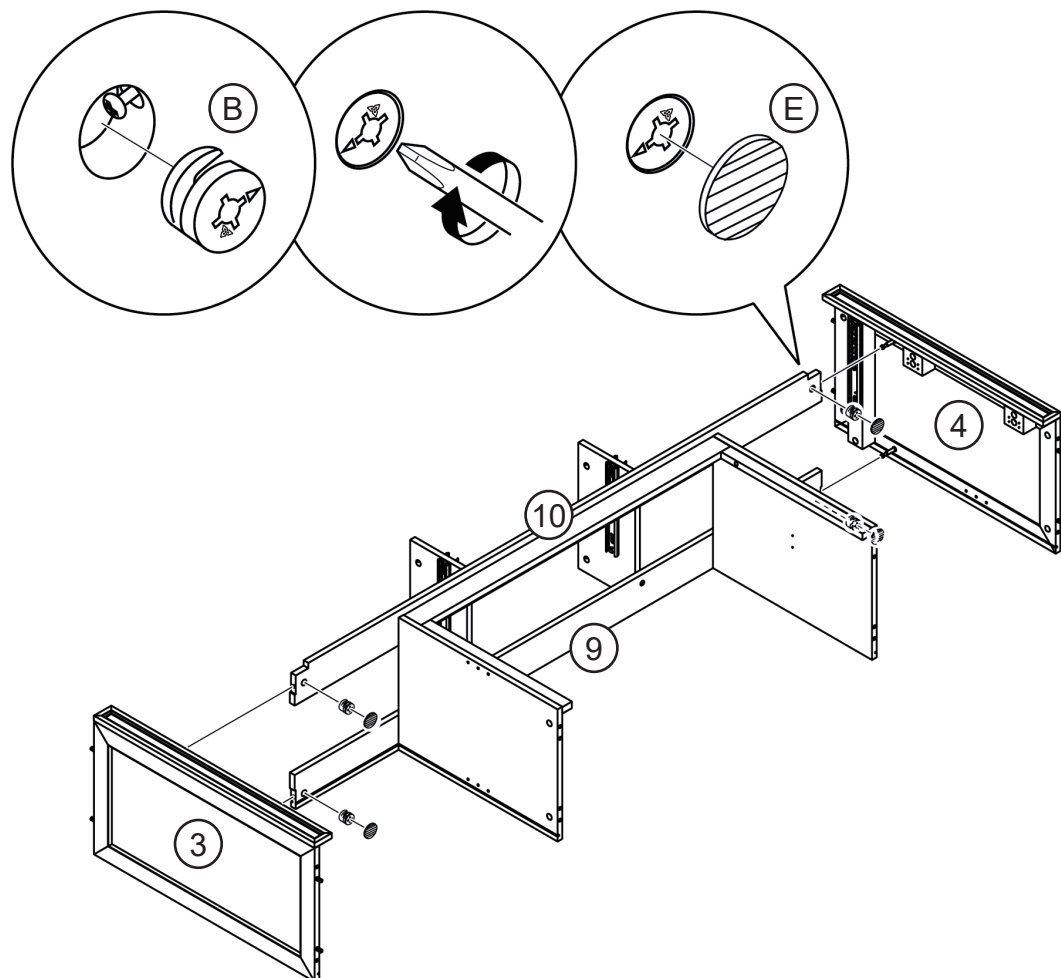
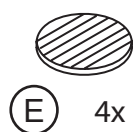
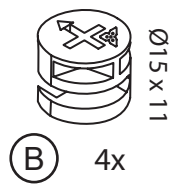

28

Insert wood dowel into the bottom of the medial panel (7, 8).

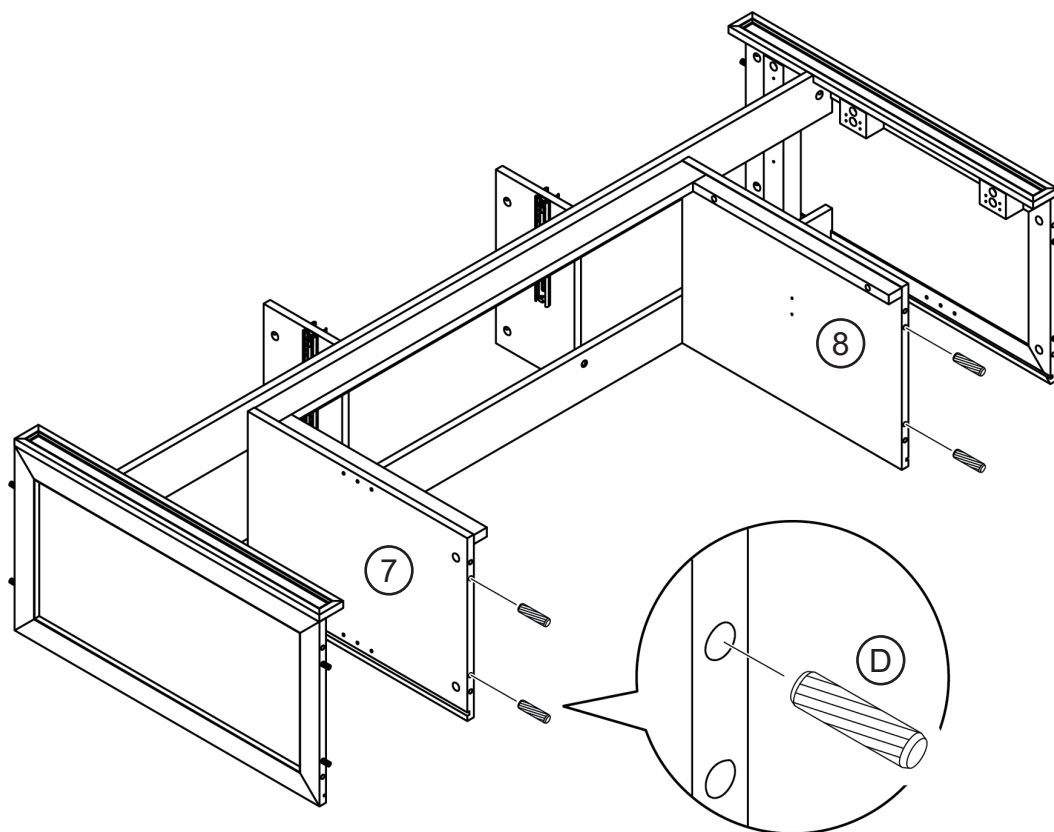
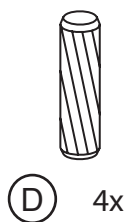

29

Slide the side back panels (30) between the lateral panel and medial panel on each sides.

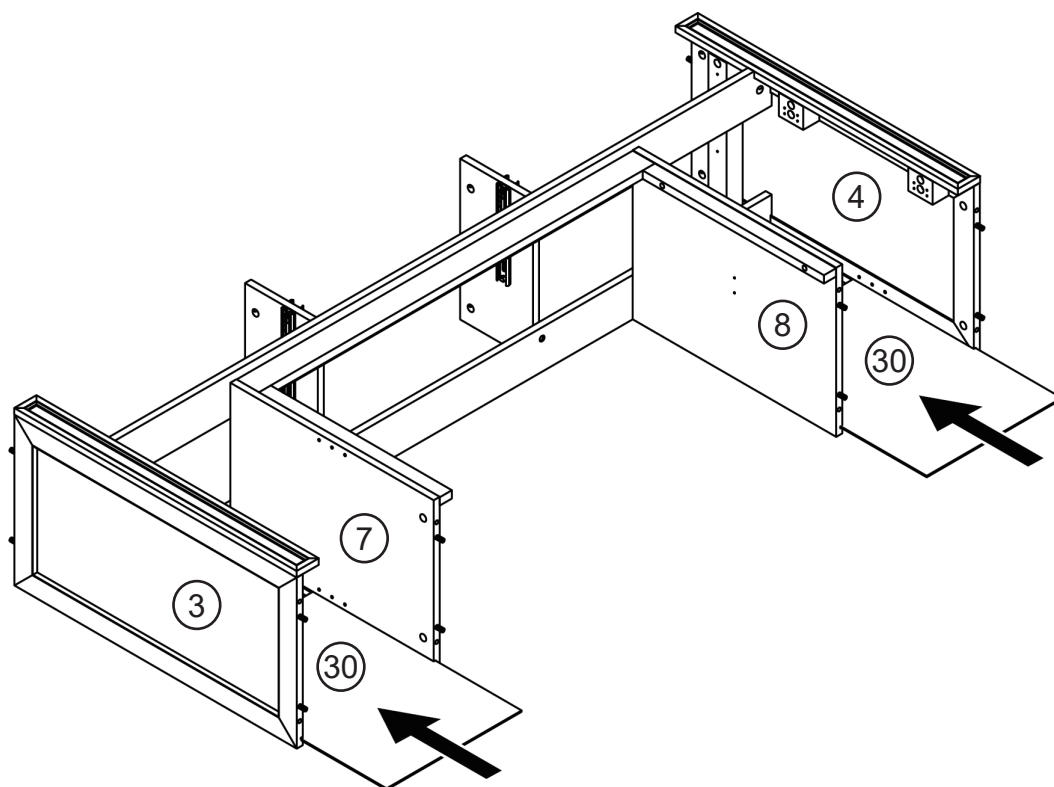

Assemble the lateral panels and medial panels to the base assembly.

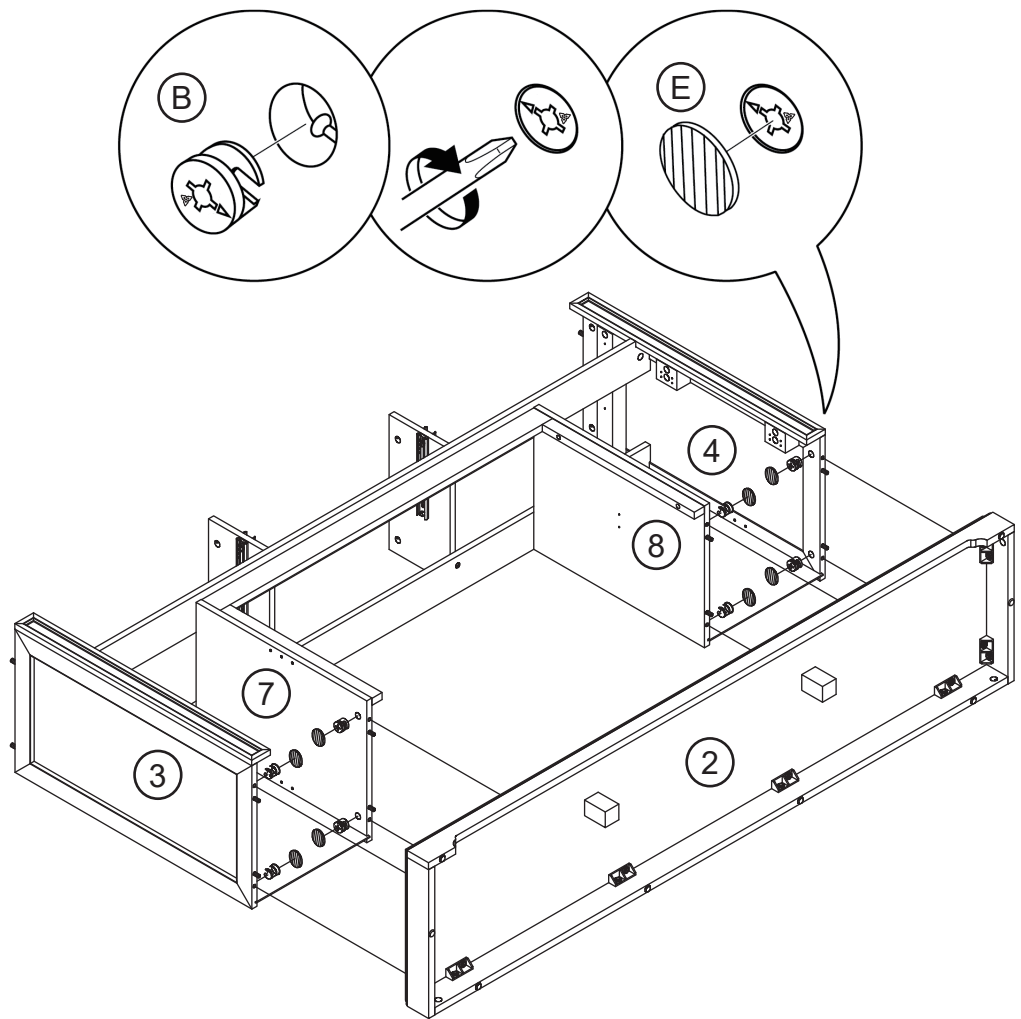
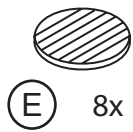
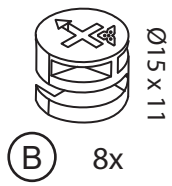

31

Place the stand assembly on its upright position and slide in the upper back panel (6).

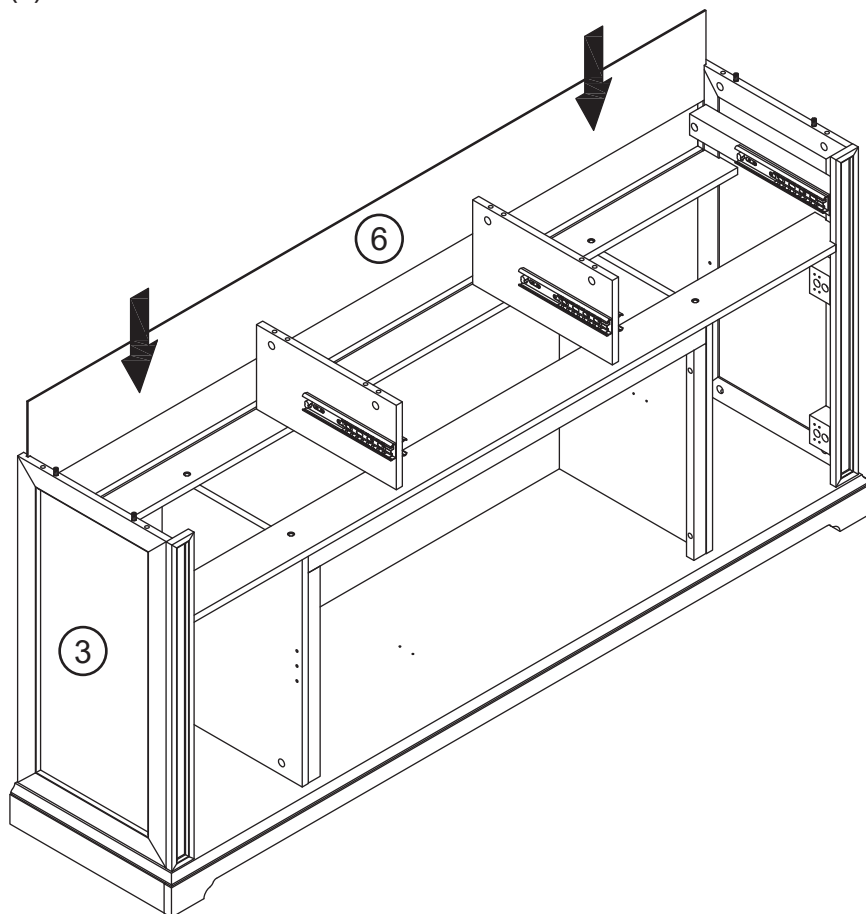

32

Insert wood dowels to the upper divider panels (5).

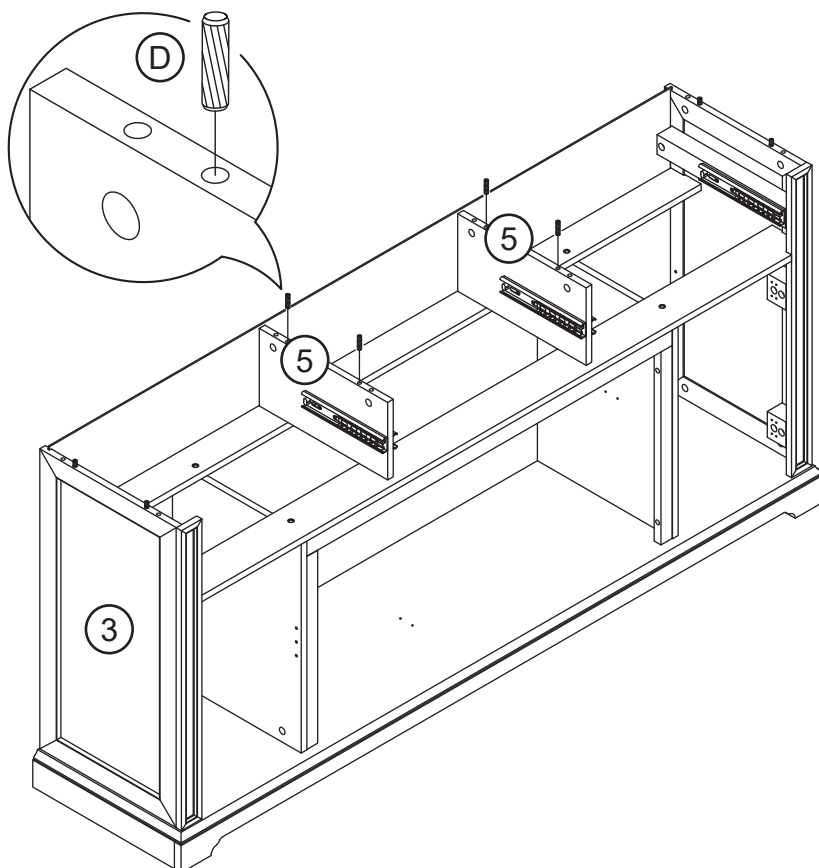
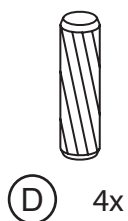

33

Attach cam bolts to the top panel (1).

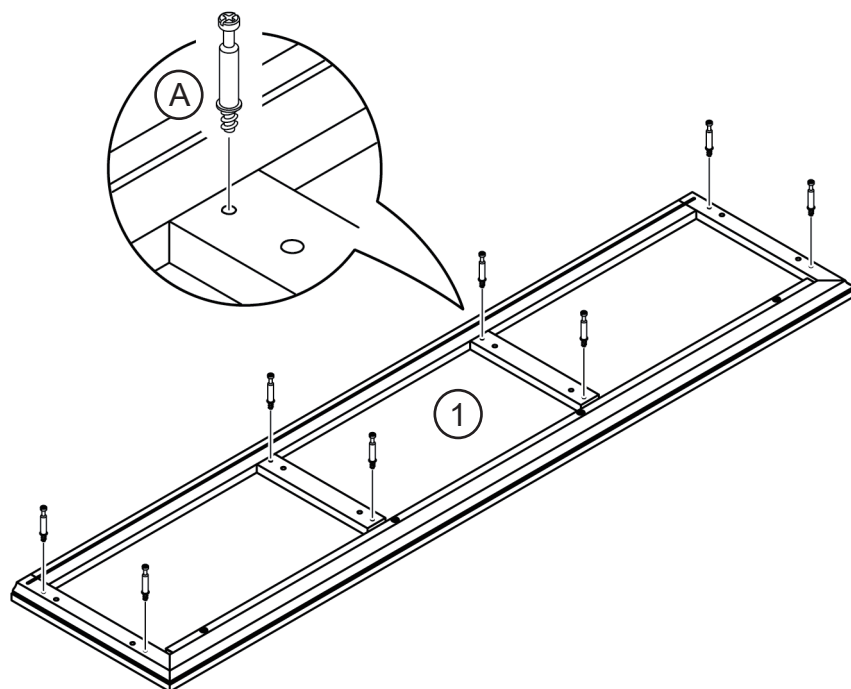
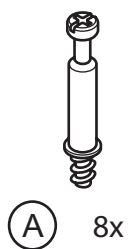

34

Assemble the top panel (1) on top of the stand assembly.

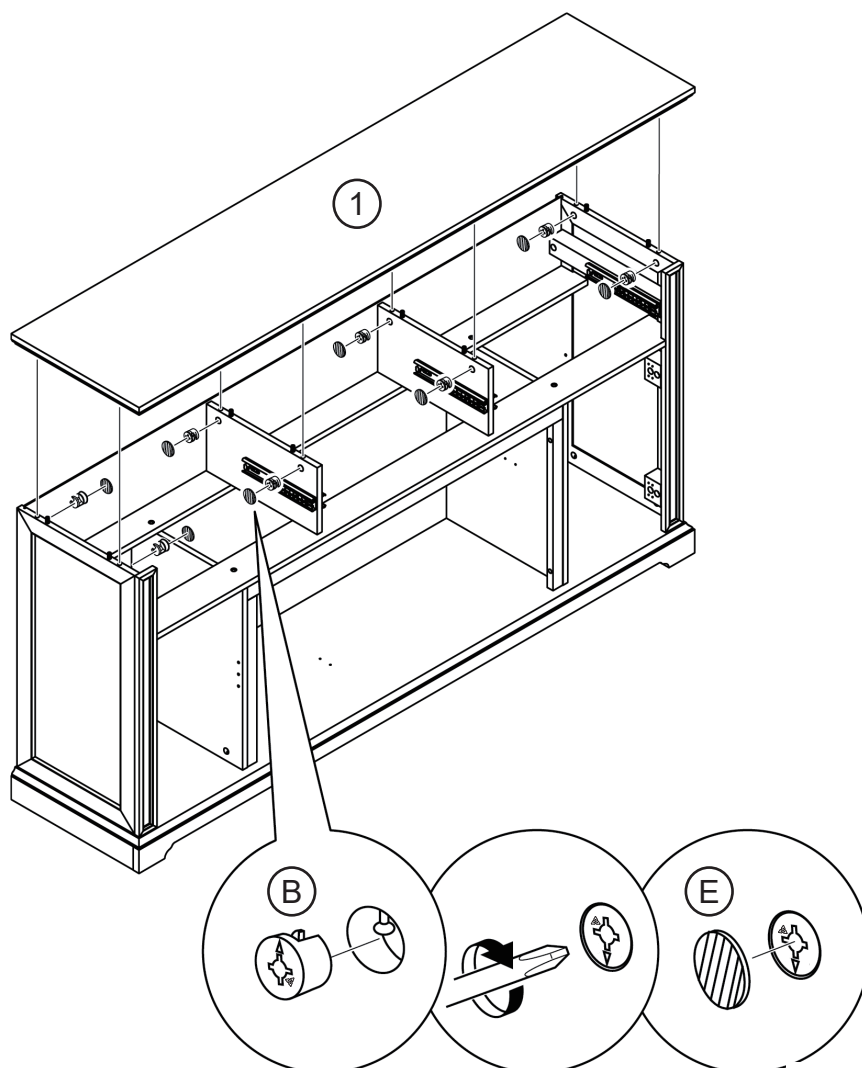
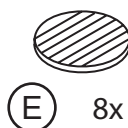
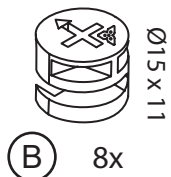

Attach sliders to the drawer side panels (28, 29).

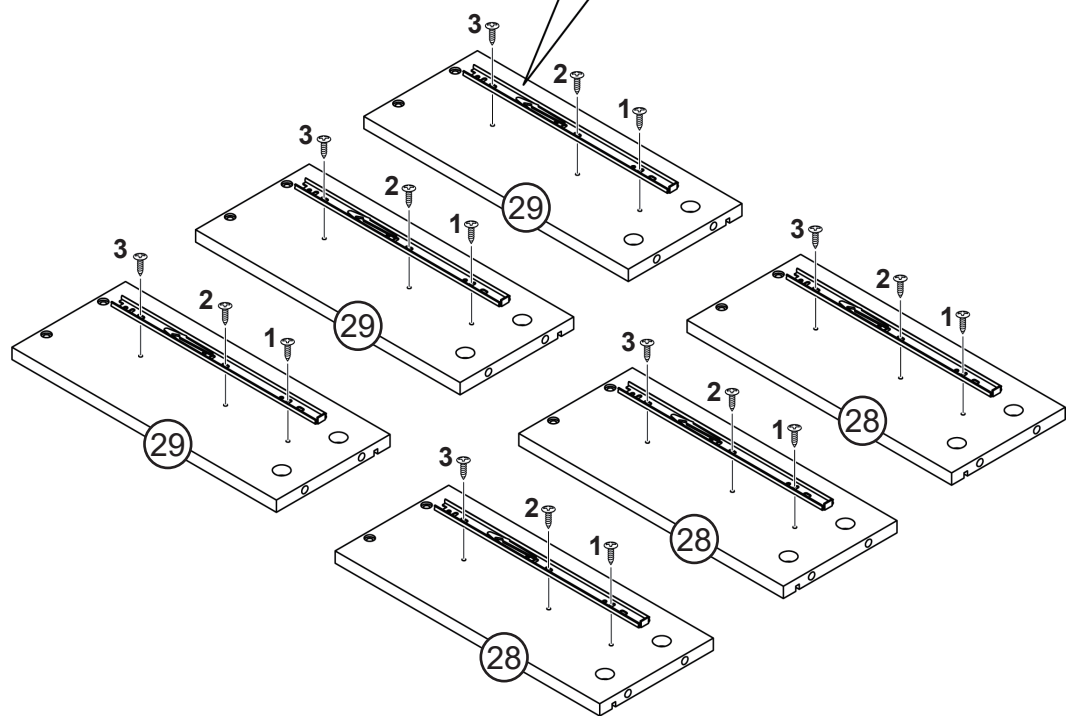
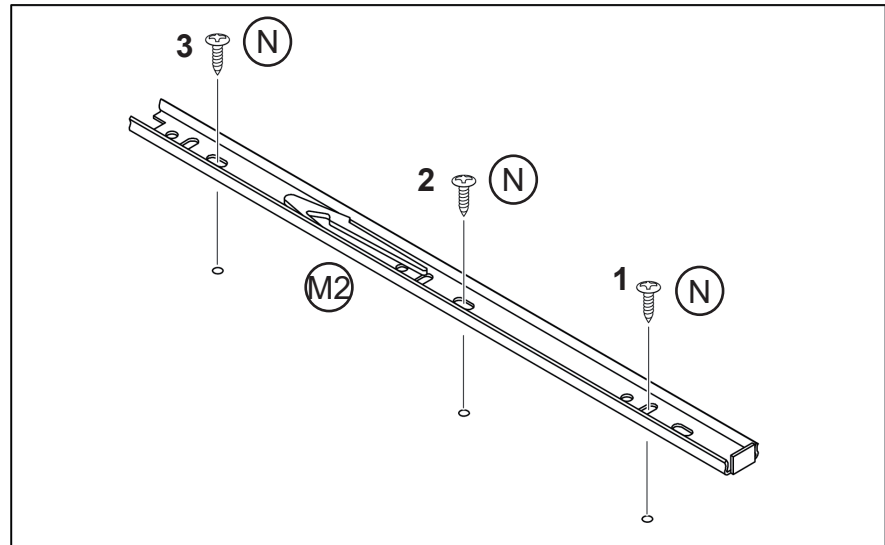
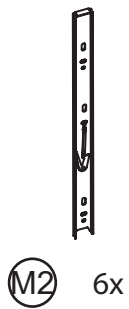

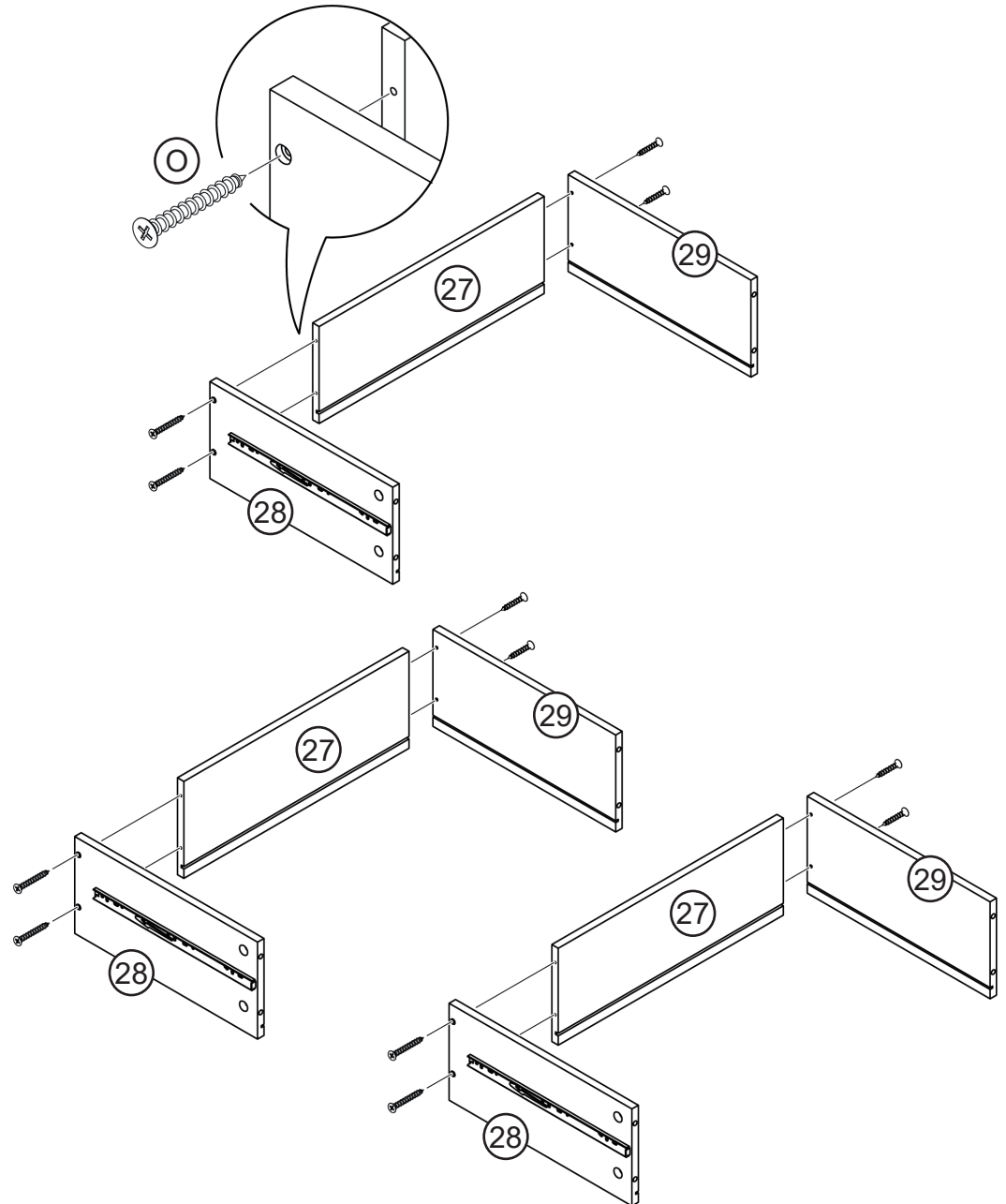
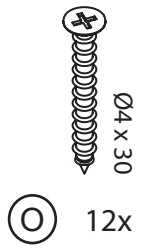

37

Slide the drawer bottom panels (26) into the drawer assemblies.

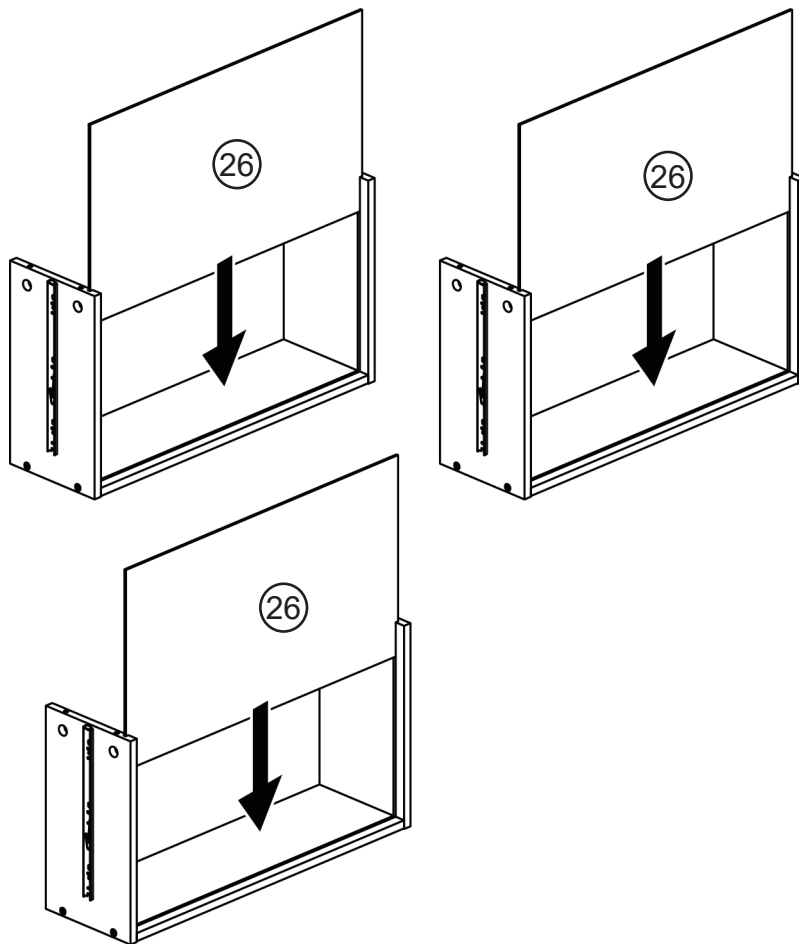

38

Attach cam bolts to drawer front panels (23, 24, 25).

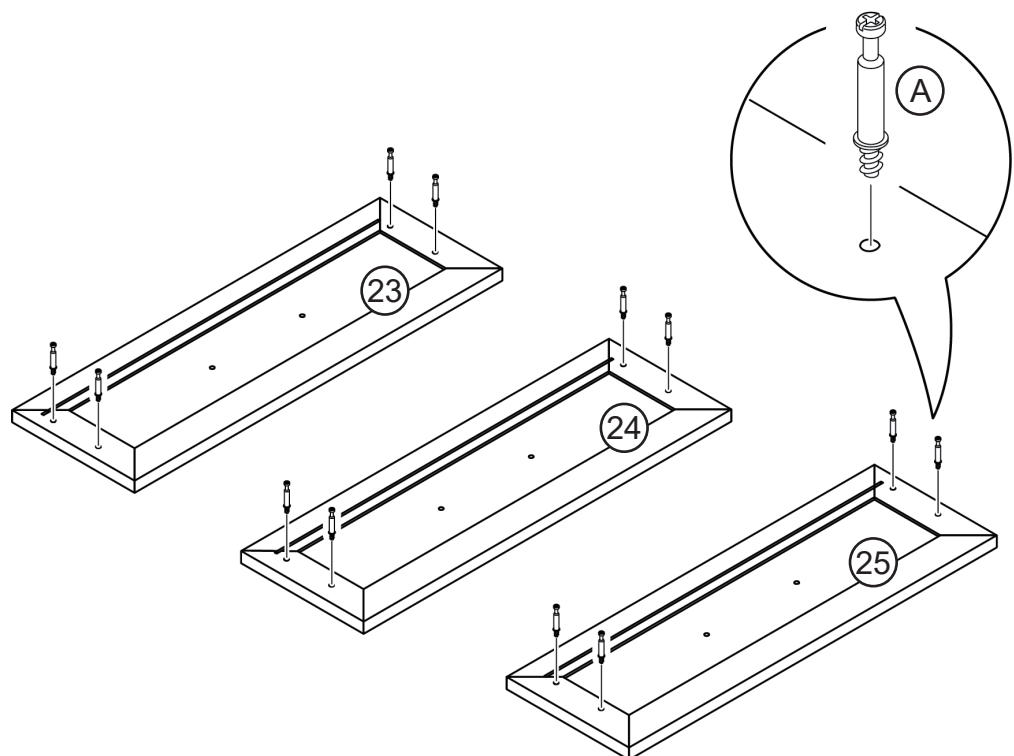
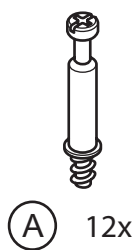

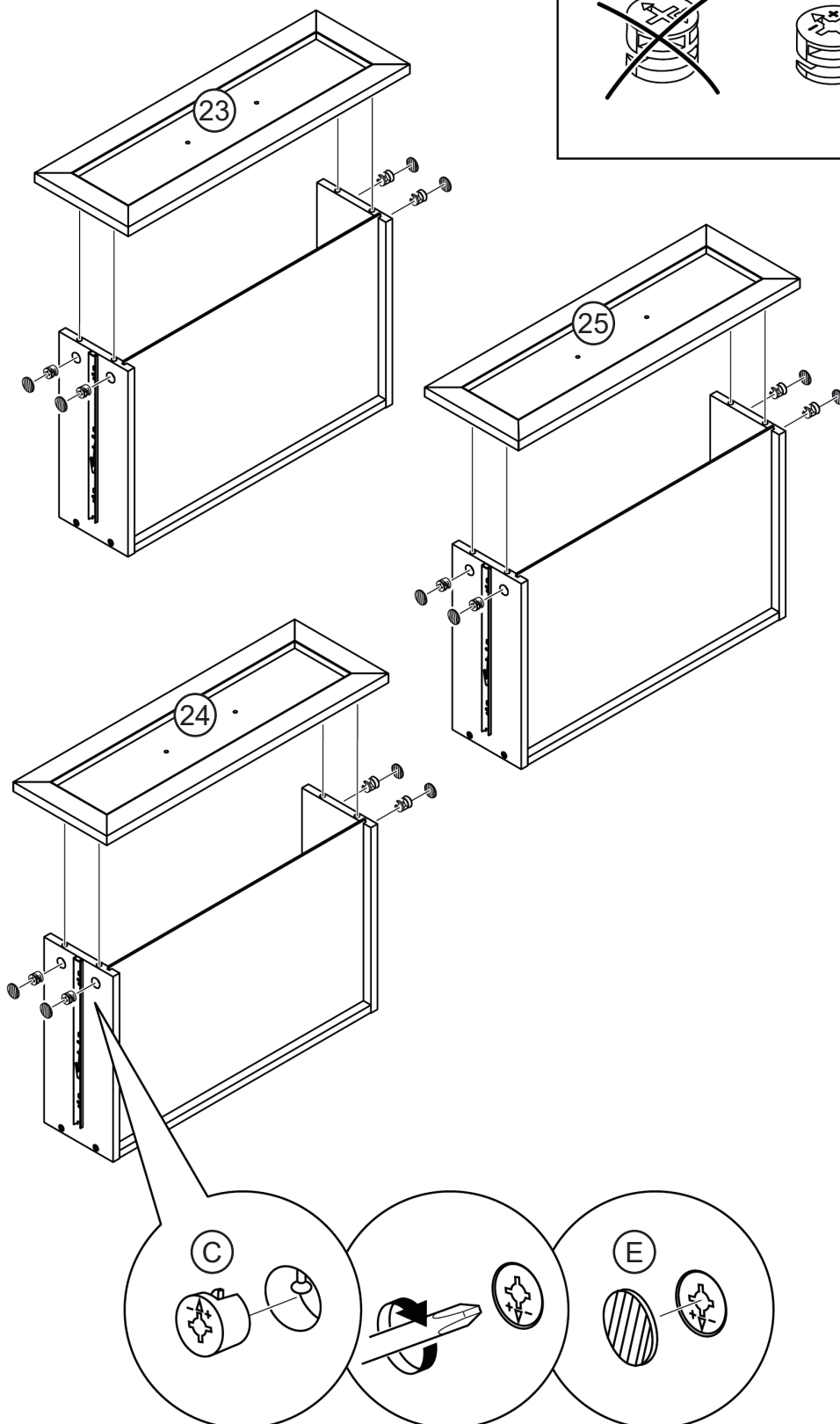
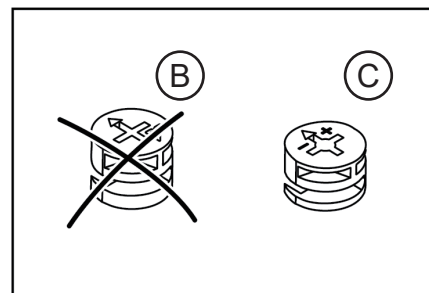
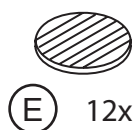
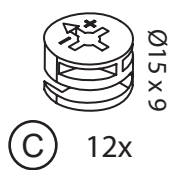

Attach drawer handle to each of the drawers.

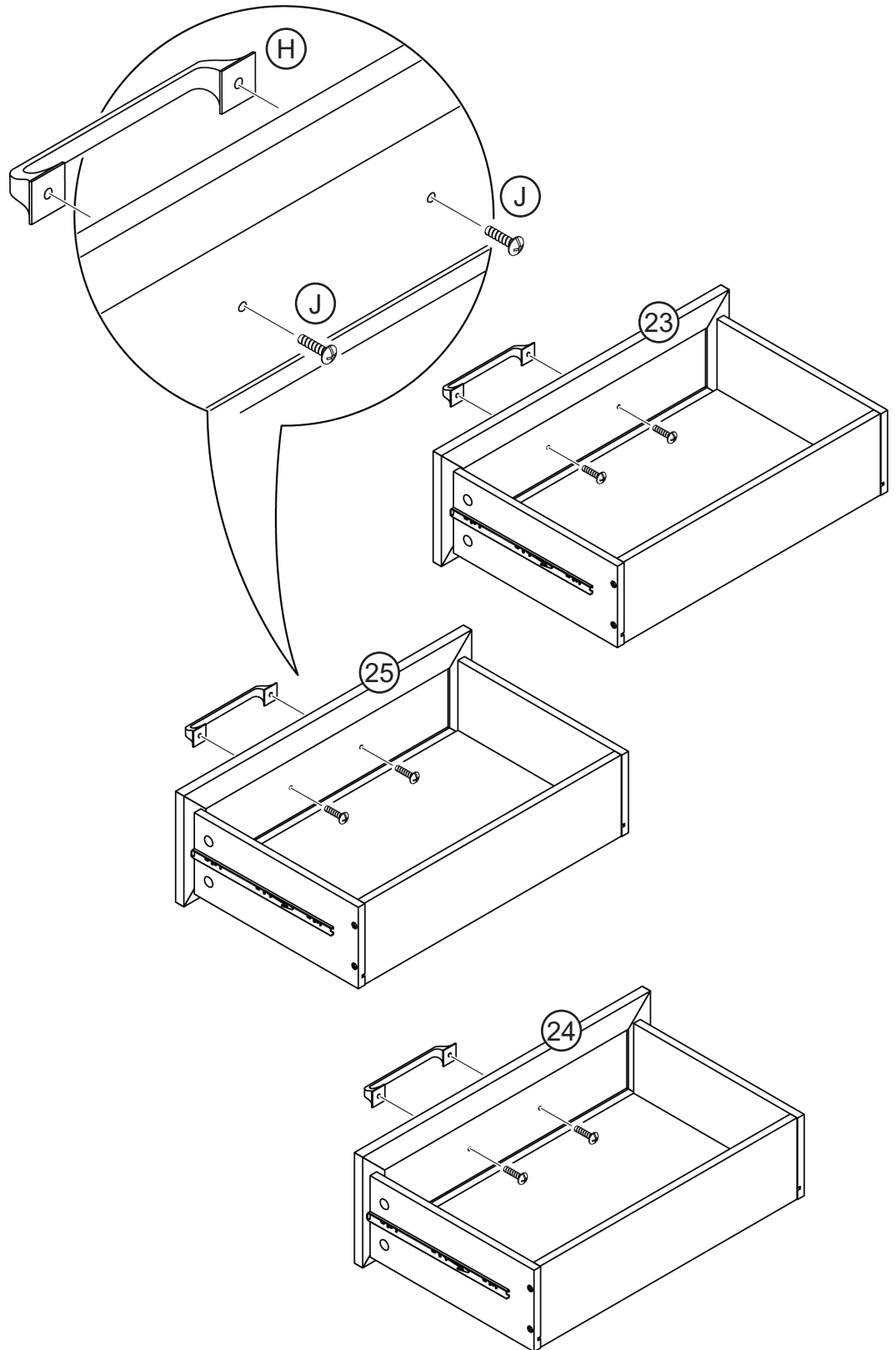
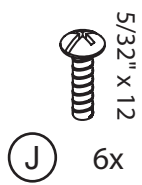
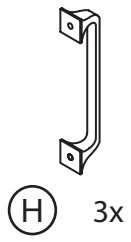

Slide drawers into the stand.

Slide the slider plate to the forward position.

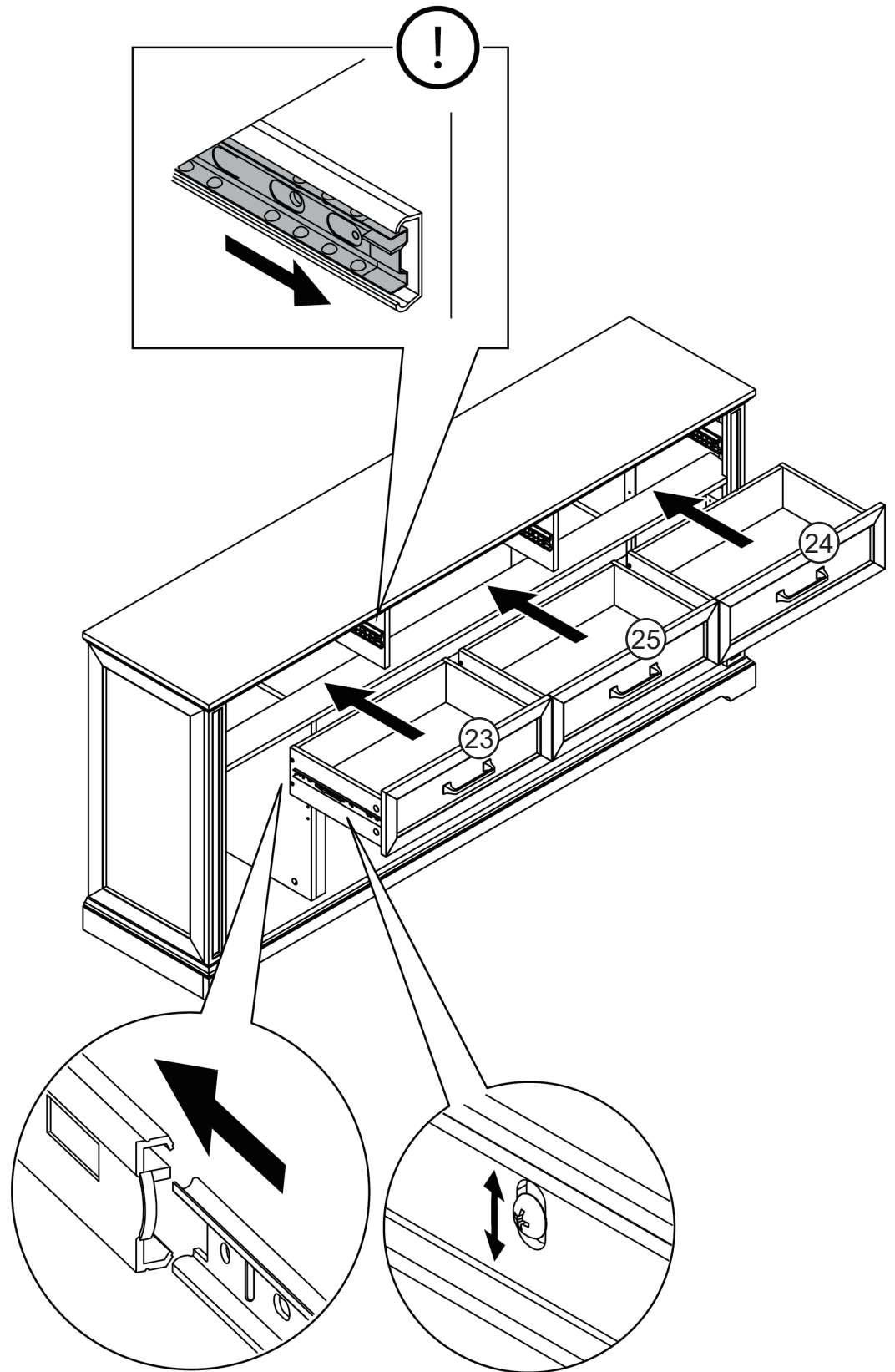

Slowly push the drawer in.

Up and down adjustment by loosening the screws on the slide runner.

42

Insert shelf pegs into the stand and put storage shelf panels (20) on top of the pegs.

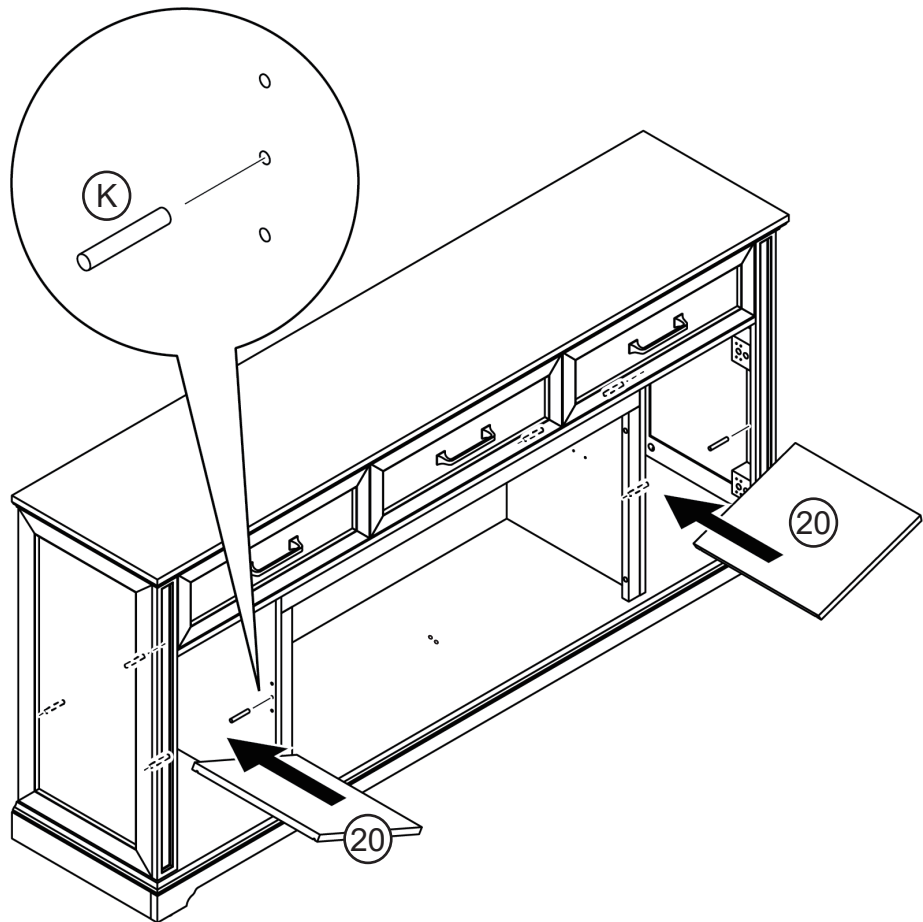
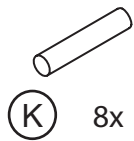

43

Attach door hinges to the cabinet doors (22).

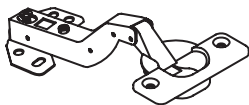

(F) 4x



(G) 8x

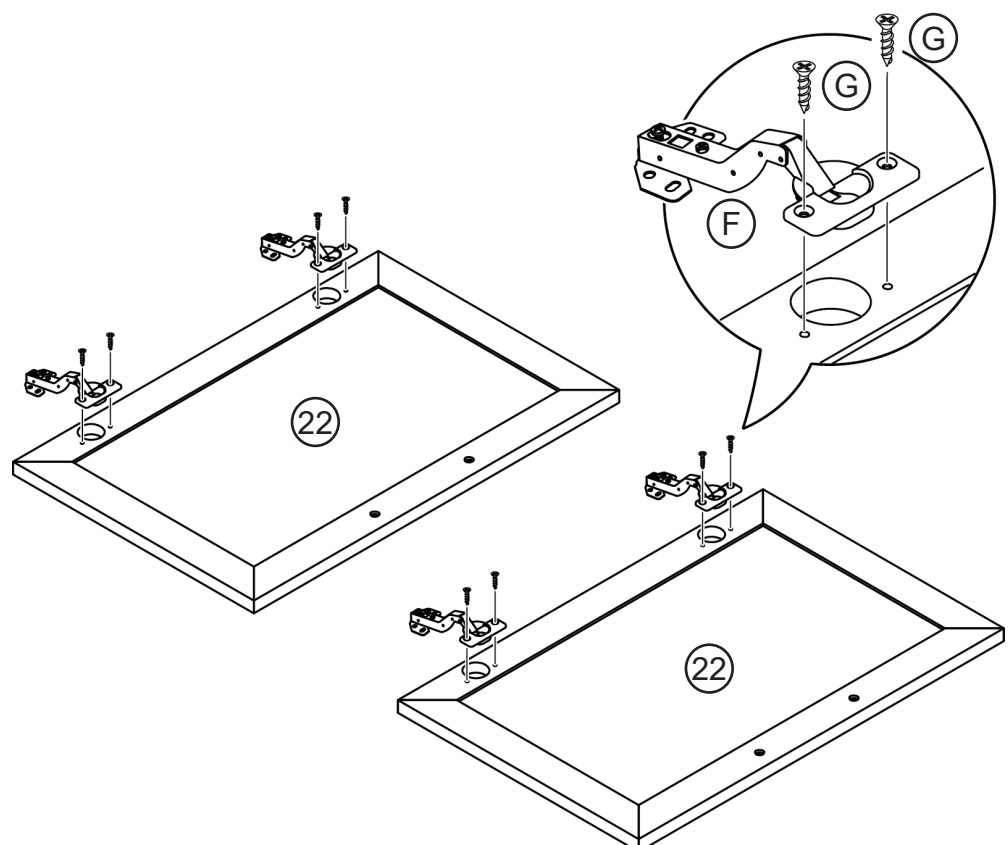

44

Attach door handles to the cabinet doors.

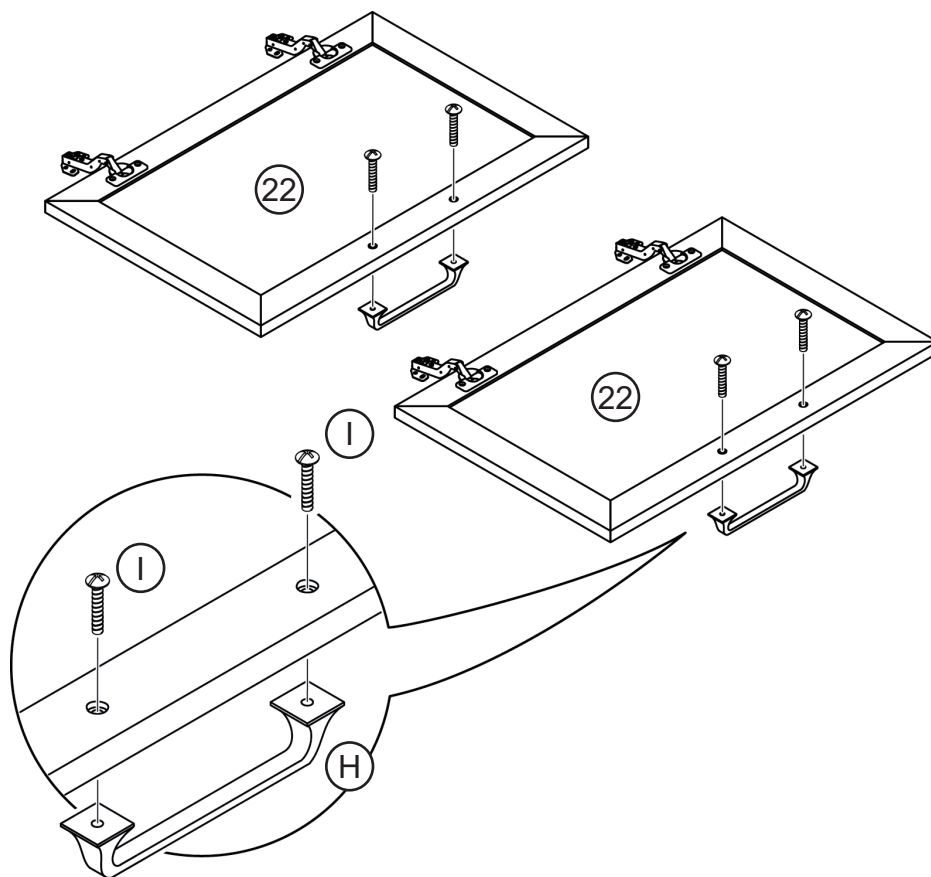
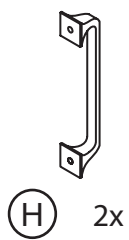

45

Attach cabinet doors (22) to the stand.

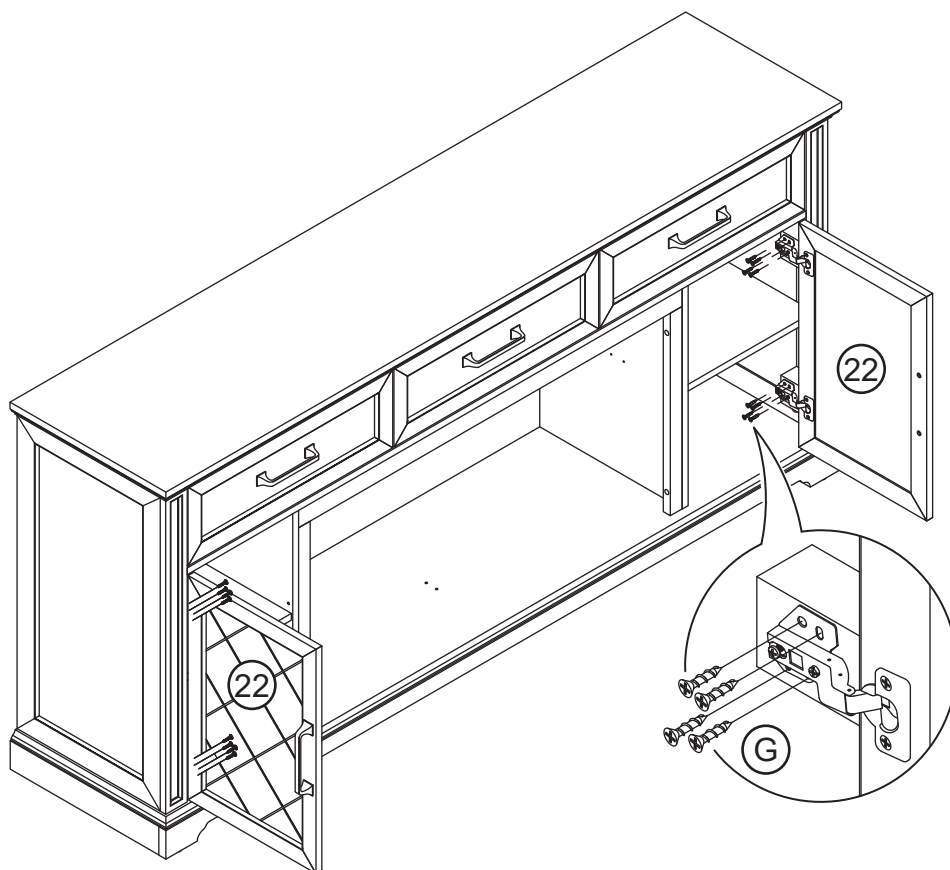

When the clearance of the door is uneven, Adjust the cabinet door according to the figure.
If you still have trouble adjusting the door, please contact us.

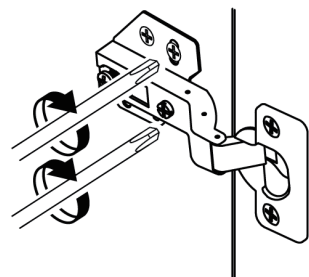
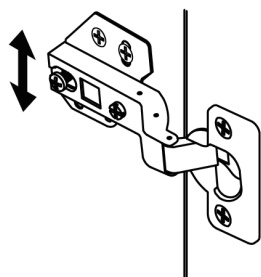
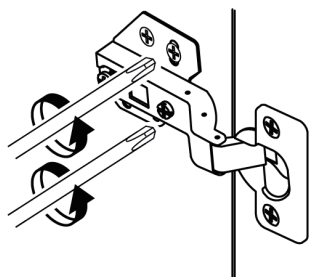
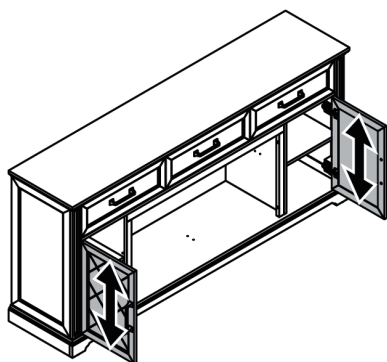

Up and down
adjustment by
loosening the screws
on the mounting
plate.

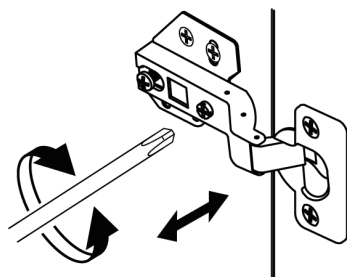
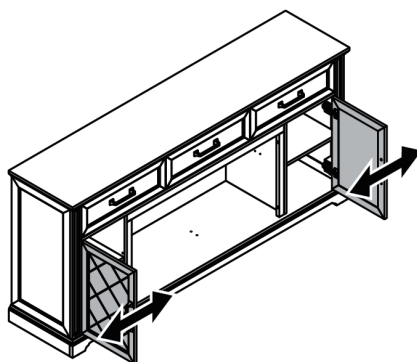

Side to side
adjustment using
the front adjustment
screw on the hinge.

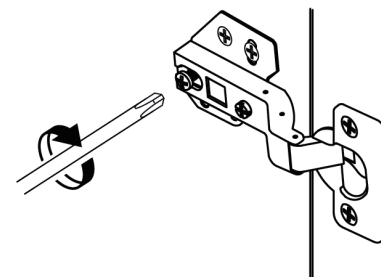
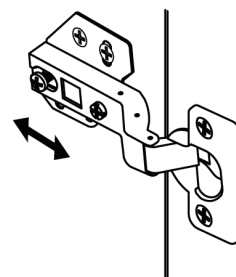
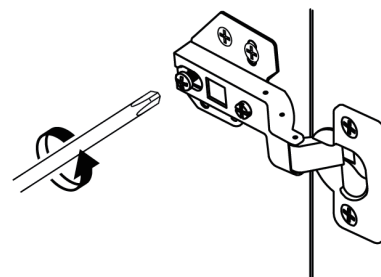
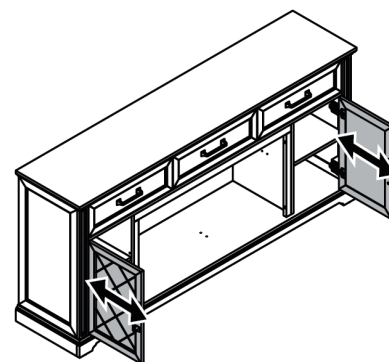

In and out
adjustment by
loosening the screws
on the hinge arm.

Secure the back panels in place.

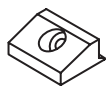

U 20x



V 20x

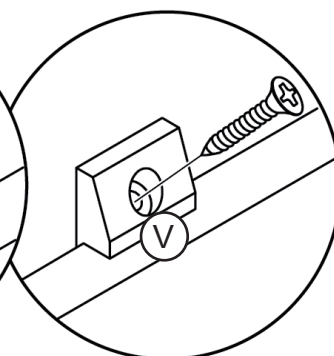
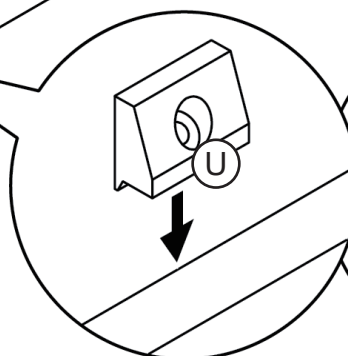
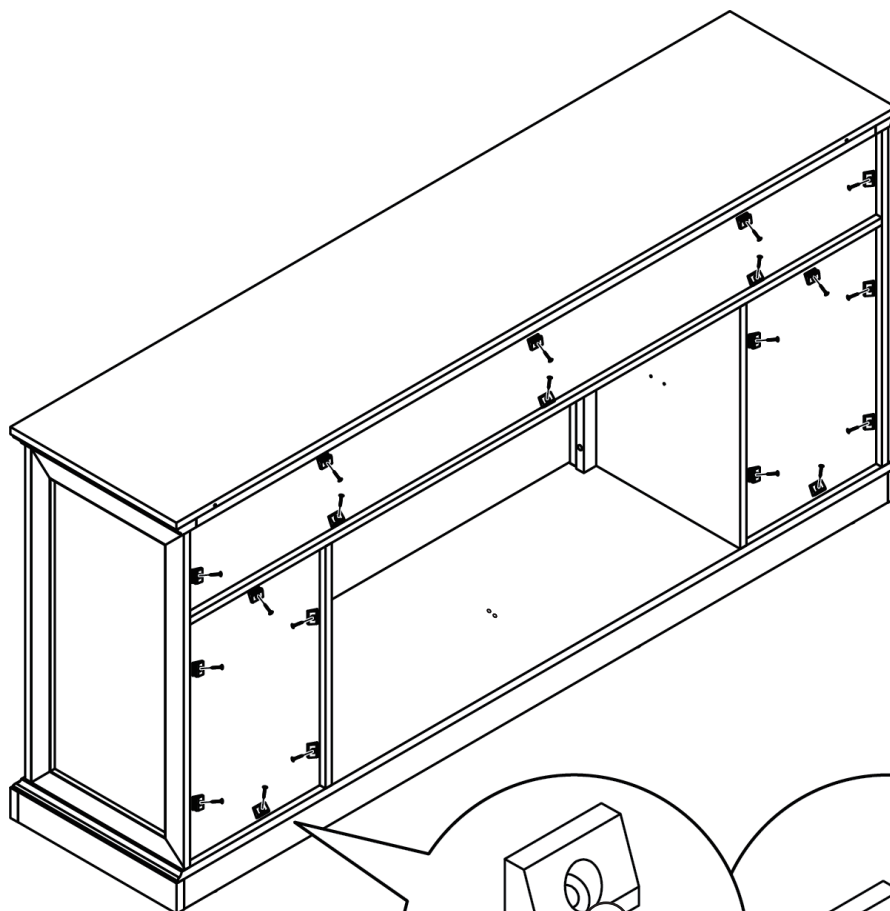

Attach fireplace heater into the stand from the back opening.

CAUTION: The heater has a glass front panel. Careful when handling glass to prevent injury or damage.

Set the fireplace heater from the back of the mantel and center it in the opening. For the exact instruction, please refer to the user's manual provided with the fireplace heater.

NOTE: Do not attempt to install the unit from the front of the fireplace mantel. It will not fit.

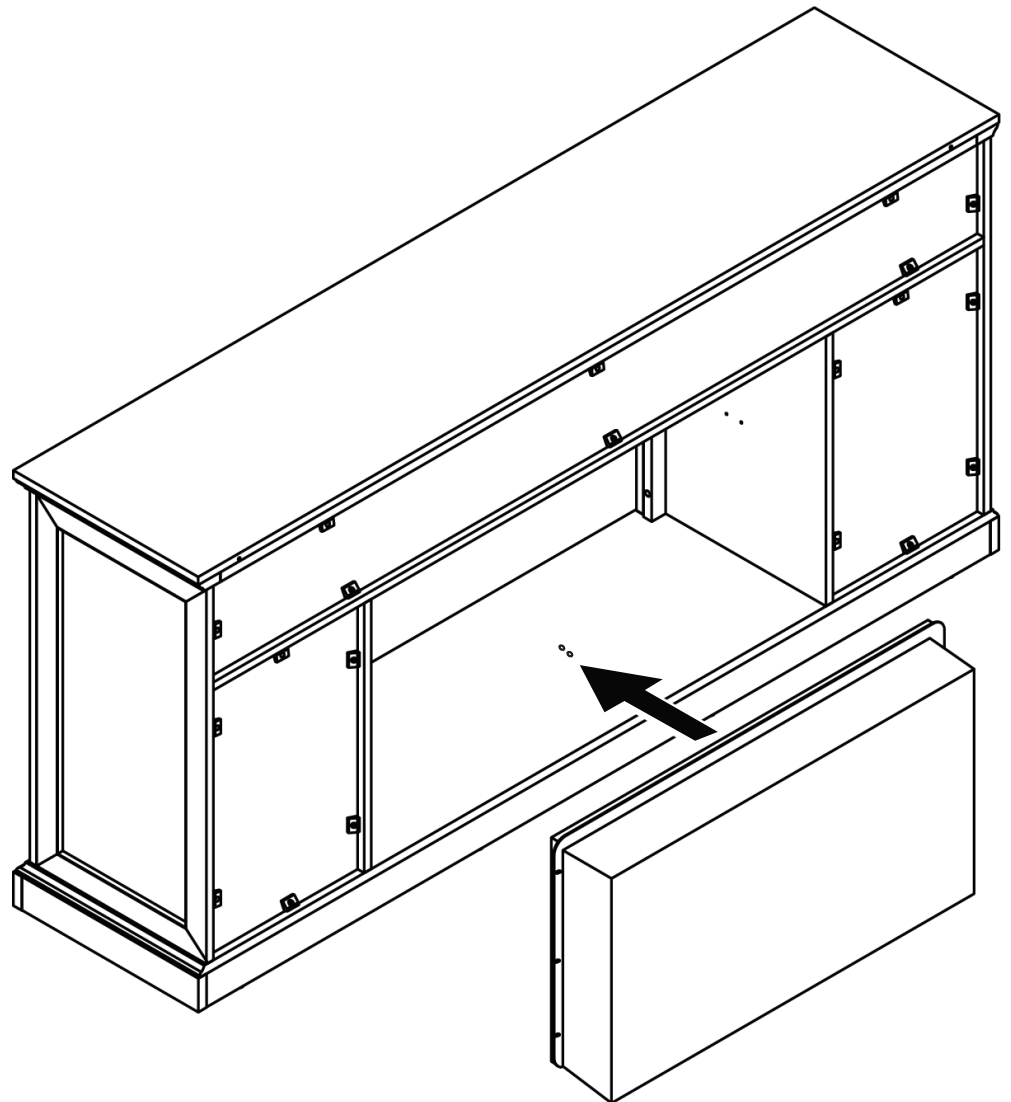

Secure the fireplace heater in place with metal braces.

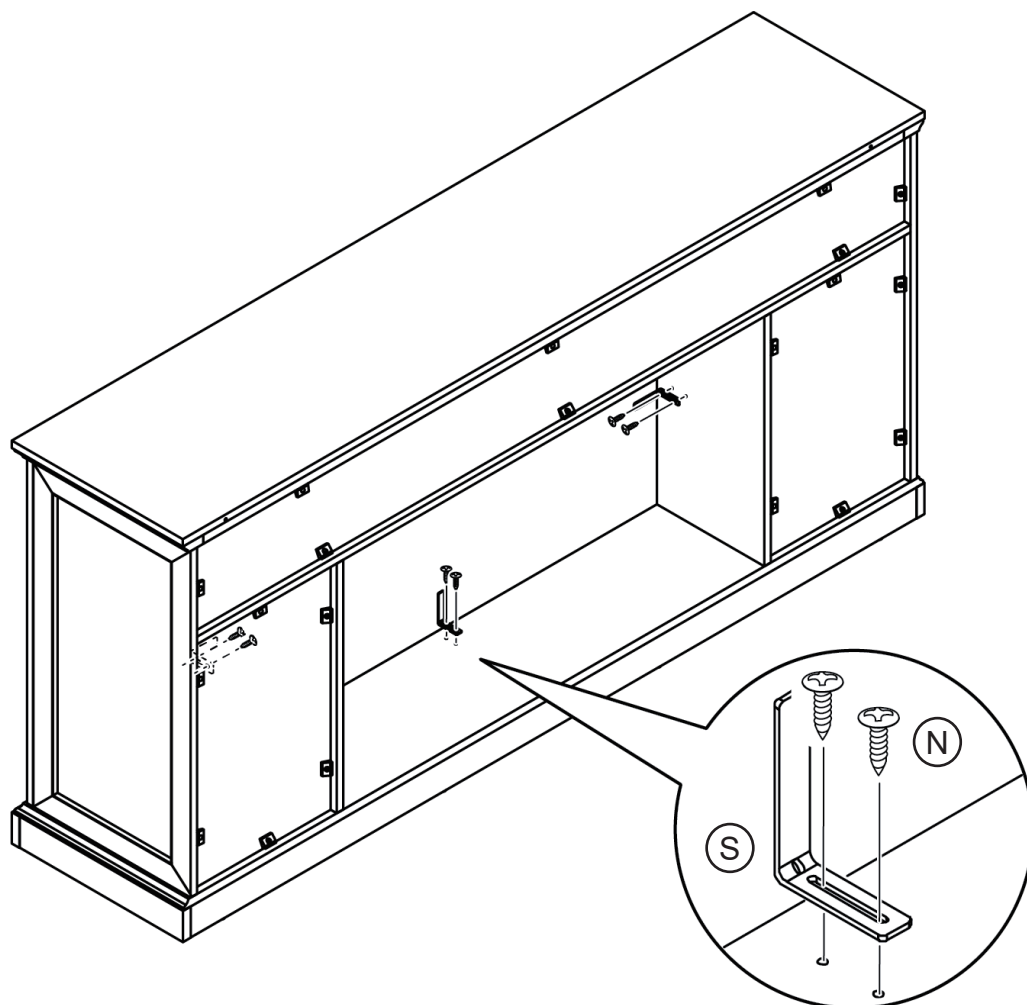
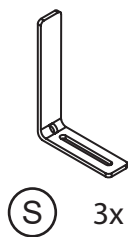
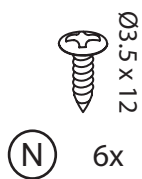

49

Attach anti-tipping straps to the back of the stand.

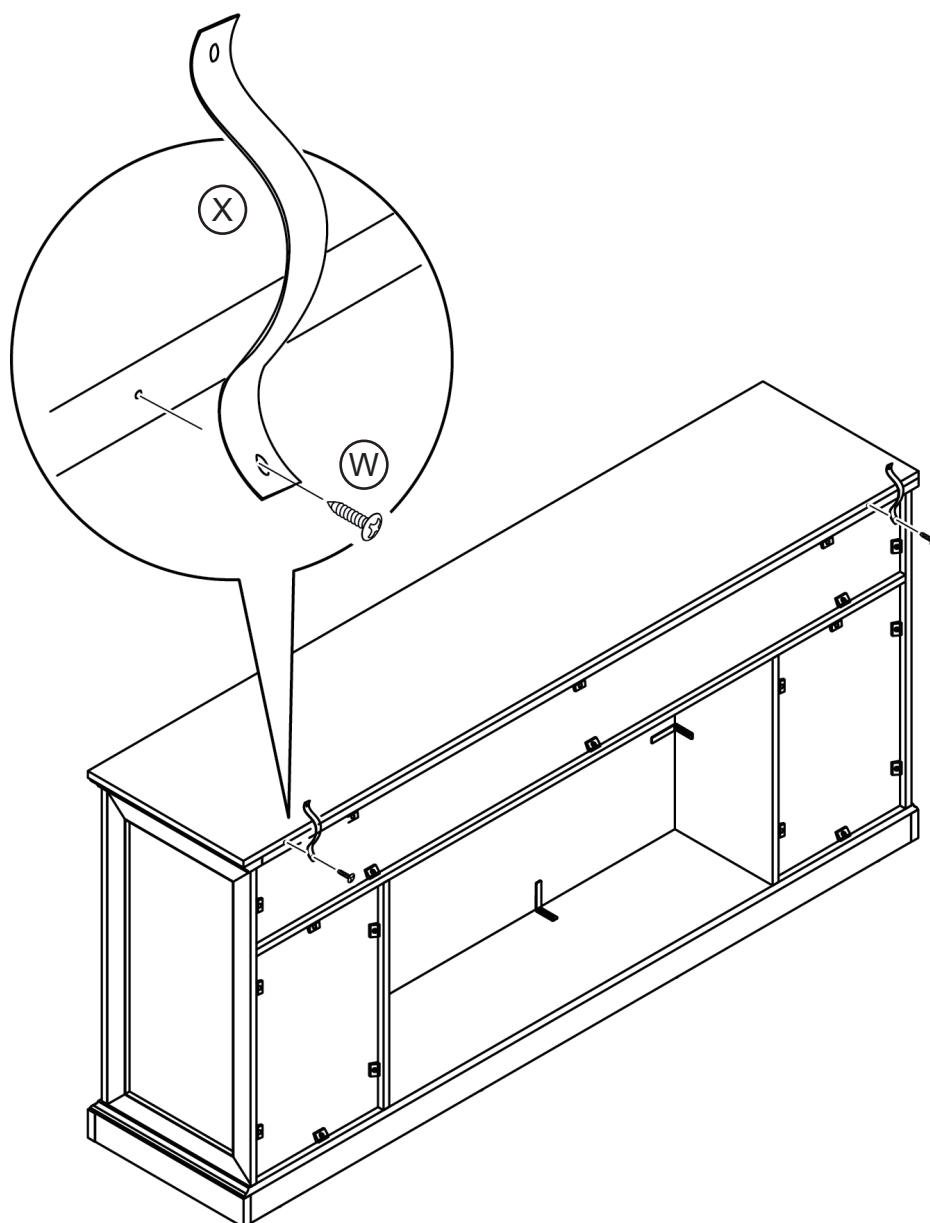
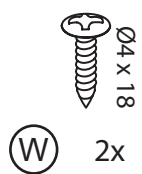

Affix the stand to a wall.

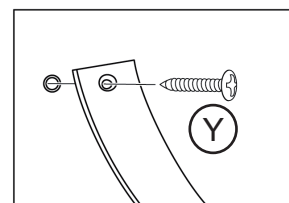
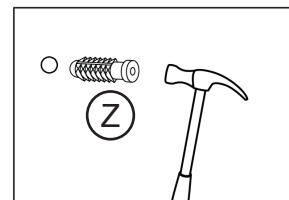
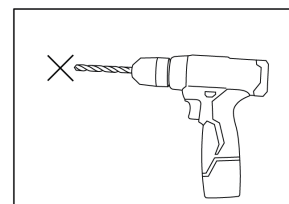
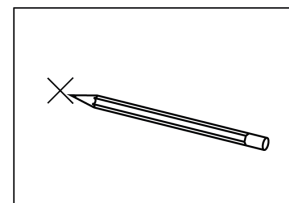
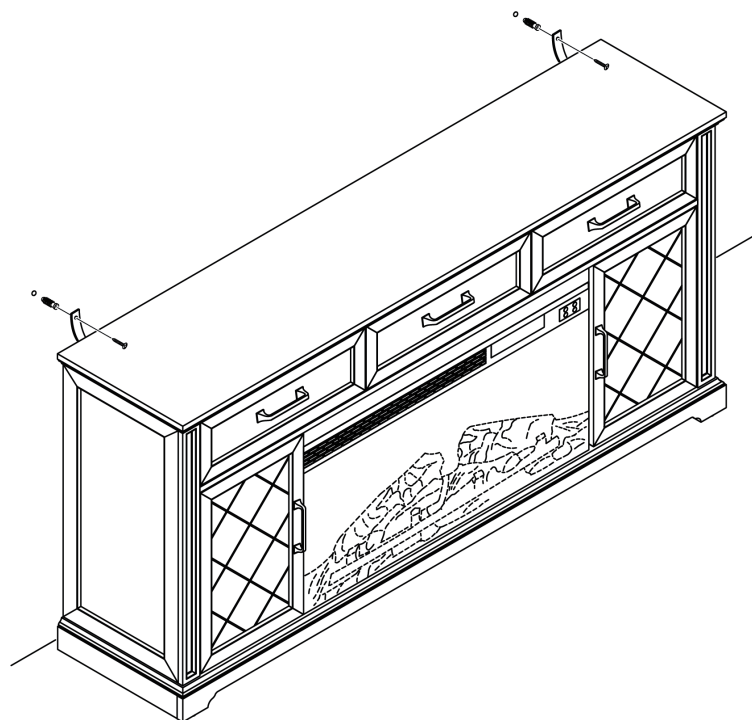
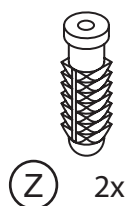
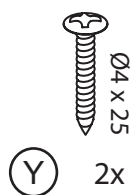

Furniture must permanently fixed to the wall stud with included anti-tipping device to prevent the furniture from tipping over.

- Mark the drill position on the wall with a pencil.
- Drill a small hole on the marked position.
- Insert a wall anchor into the drilled hole.
- Fixed the anti-tipping strap to the wall with provided screws.

YOU'RE FINISHED!

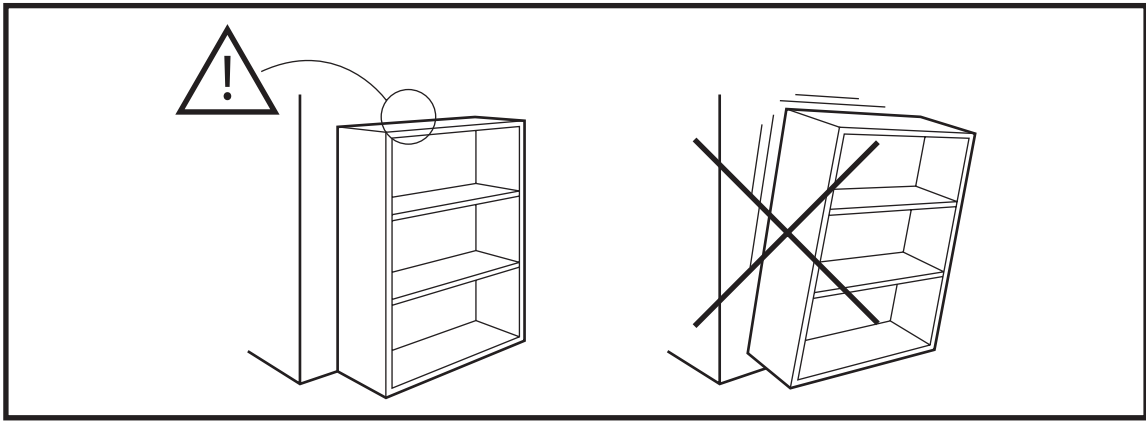

Warning

Serious or fatal crushing injuries may occur if the furniture tip-over. Furniture must permanently affixed to the wall with included anti-tipping device in order to prevent the furniture from tipping over.

Different wall materials requires different types of wall anchors or screws. Use a suitable wall anchors or screws for your specific wall in order to secure the stability and load bearing capacity of the furniture. If you are uncertain about which type of device to use, please contact us or your local hardware store.

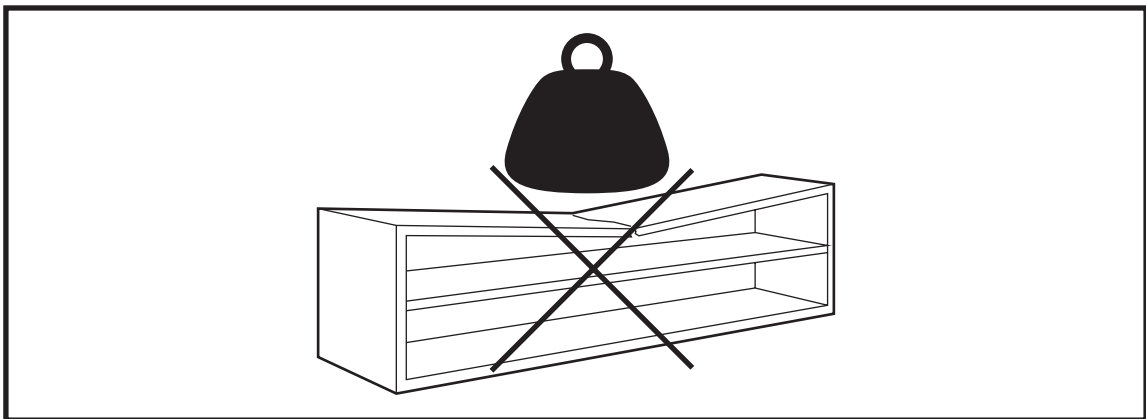

Warning

Only place items on top of the product if they meet the recommended size and weight limits.

Climbing on, stepping on, or placing overweighted objects on the product may cause property damage and/or injuries.

Items placed onto this product must be resting on a support surface without hanging over the edges.

WARNING

For use with televisions weighing 70lbs (31.8kg) or less. Use with heavier televisions may result in instability, causing tip over resulting in death or serious injury.

Death or serious injury may occur when children climb on audio and/or video equipment furniture. A remote control or toys placed on the furnishing may encourage a child to climb on the furnishing and as a result the furnishing may tip over on to the child.

Relocating audio and/or video equipment to furniture not specifically designed to support audio and/or video equipment may result in death or serious injury due to the furnishing collapsing or over turning onto a child.

NOTICE

The recommended maximum width of the television is 75 inches. Do not exceed the maximum load capacity.

This product is designed for flat panel TVs only.

FURNITURE CARE AND MAINTENANCE

Medium - Density Fiberboard

Thank you for your purchase. We want your item to last as long as possible. To ensure the product gives you years of longevity, please follow the recommendations in this care and maintenance guide.



MAINTENANCE

- Tighten all bolts and screws again within the first 2 weeks of assembly.
- Check the tightness of all bolts every 2 months and tighten them if necessary.



CLEANING

- Clean the surface of the MDF (medium - density fiberboard) with a lightly dampened cloth.
- A small amount of mild soap can be used if necessary.
- Dry the surface immediately after cleaning.

⚠ DO NOT use bleach or alcohol to clean the surface.

⚠ DO NOT apply wood treatment on parts made with MDF.

MDF will swell and distort when exposed to water damage. Make sure to dry the furniture immediately after cleaning.

⚠ WARNING

The manufacturer and seller are not responsible for any and all liability relating to personal injury, property damage or losses, whether direct, indirect, or incidental, resulting from the incorrect attachment, improper use, inadequate maintenance, unapproved modification or neglect of this product.