

# JFCZ- 002/004 Sanitary products installation guide

## 1. Required installation tools and materials:

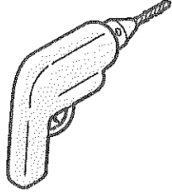

Electric hand drill (including Phillips head, 5mm bit, 10mm bit)

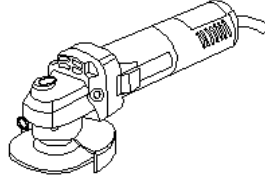

Angle grinder (including cutting sheet)

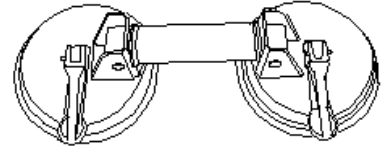

Tile suction tray

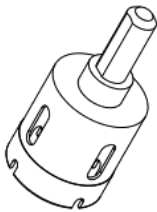

Tile hole-drill (two sizes)

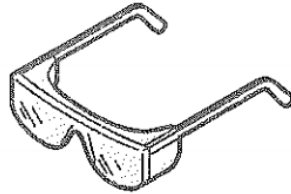

protective glasses

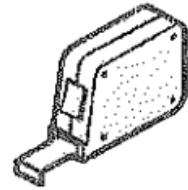

Tape ruler

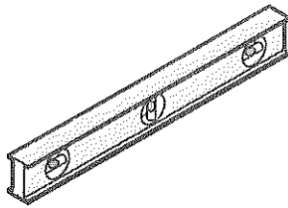

Leveling ruler



Glue gun



Square ruler

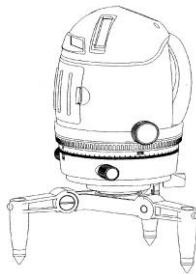

infrared level

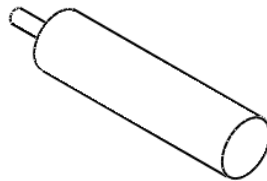

Mildew proof sealant

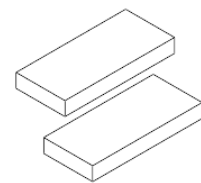

cushion block

## 2. Introduction of finished products:

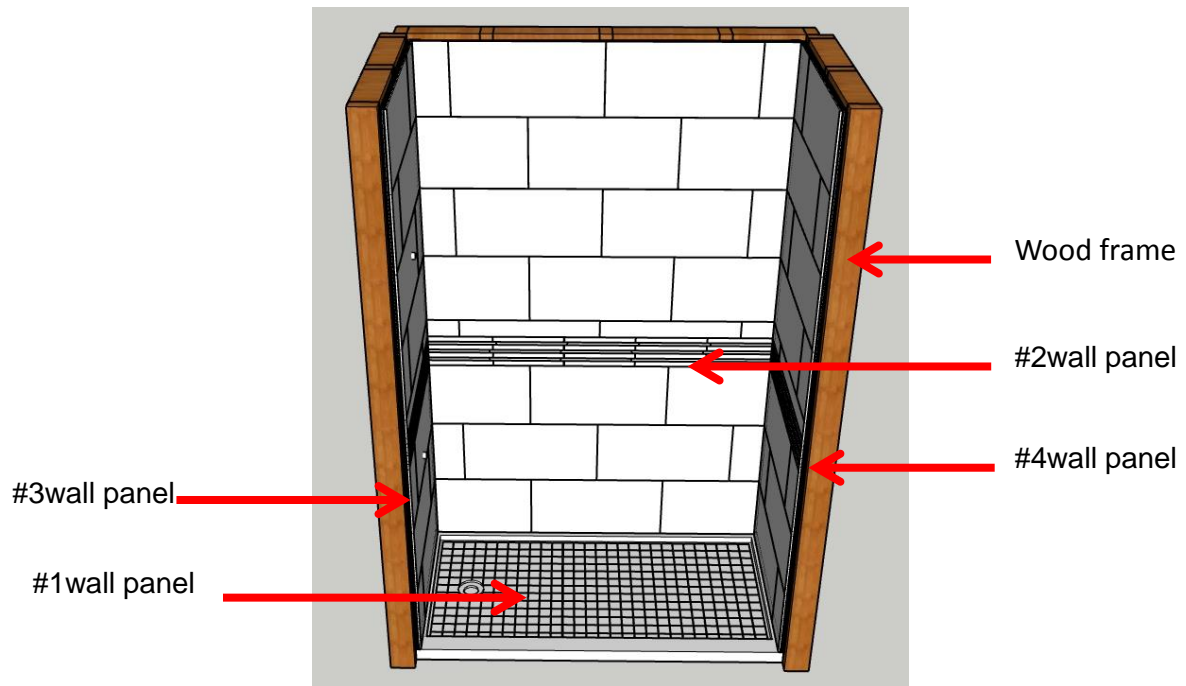

## 3. Product list:

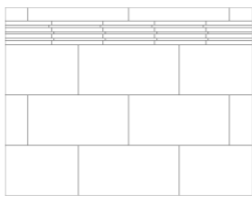

Wall panel#1

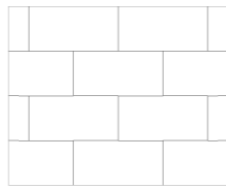

Wall pane#2

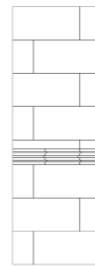

Wall pane#3



Wall pane#4

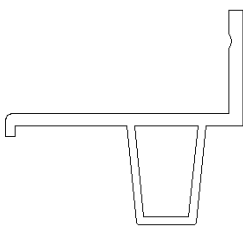

Capping seal stripX2

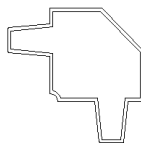

Internal corner stripX2

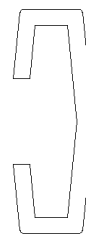

Flat joint stripX1

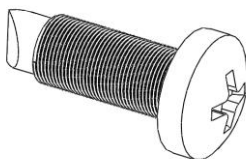

Drill tail round head

Phillips screw,4.2\*13



Round head Phillips

screw,M4.2\*35

**1**

Install structural section for #1 wall panel

top

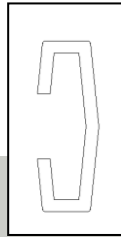
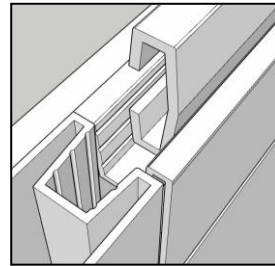
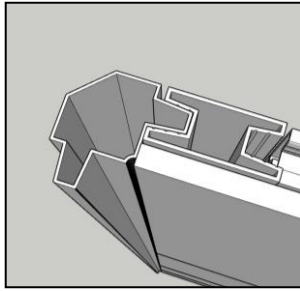

Flat joint strip

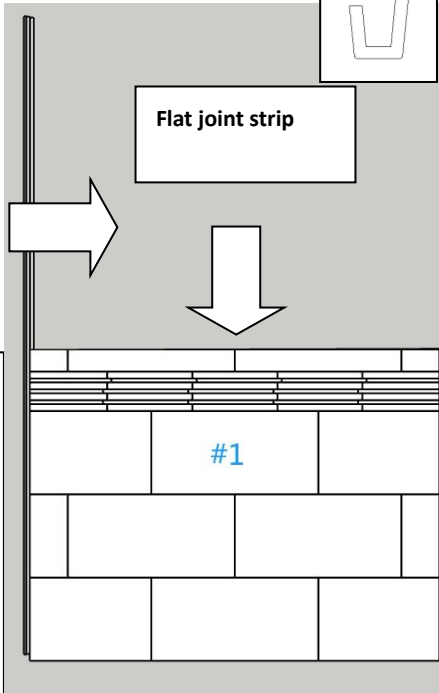

#1

bottom

Internal corner strip

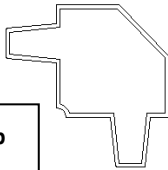

Note: When installing strips, please check whether the top and bottom positions of the wall panel are reversed, here shows the bottom.

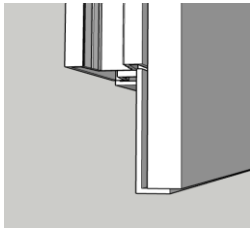

Find the #1 board, flat joint strip and internal corner strip, install the flat joint strip on the TOP of the #1 panel according to the photo, and install the internal corner strip on the left side of the #1 panel, paying attention: opening side of flat joint strip is same with tile surface.

Top

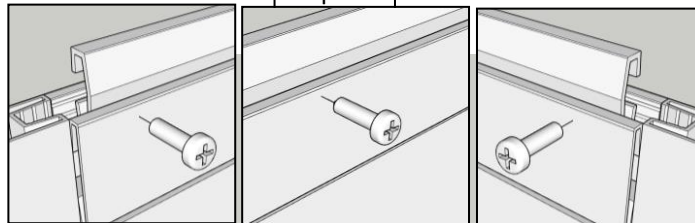

Use screws to fix according to the position of the red joint strip

Use drill tail round head phillips screws to fasten the back according to photo

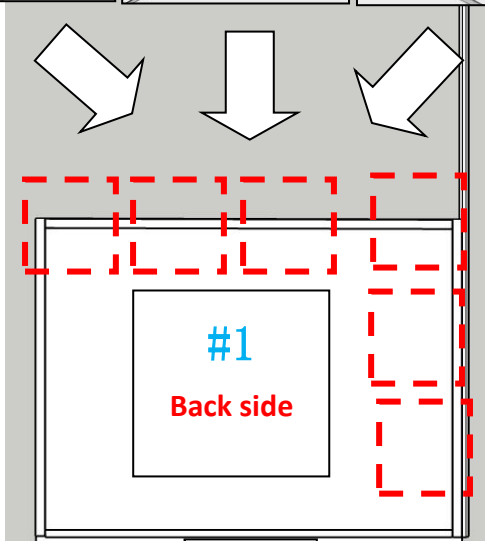

#1  
Back side

bottom

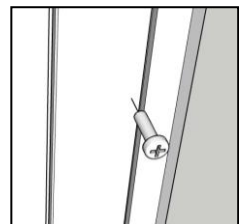

In the range showed

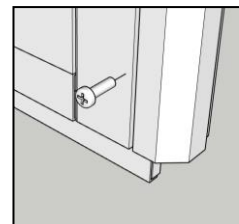

About 0.1 inch from the bottom

2

# Install #2 wall panel

Top

Top

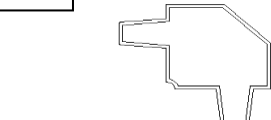
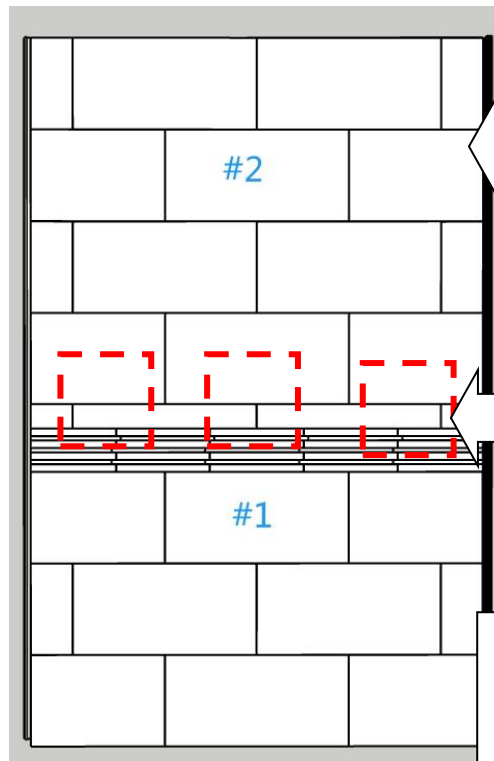
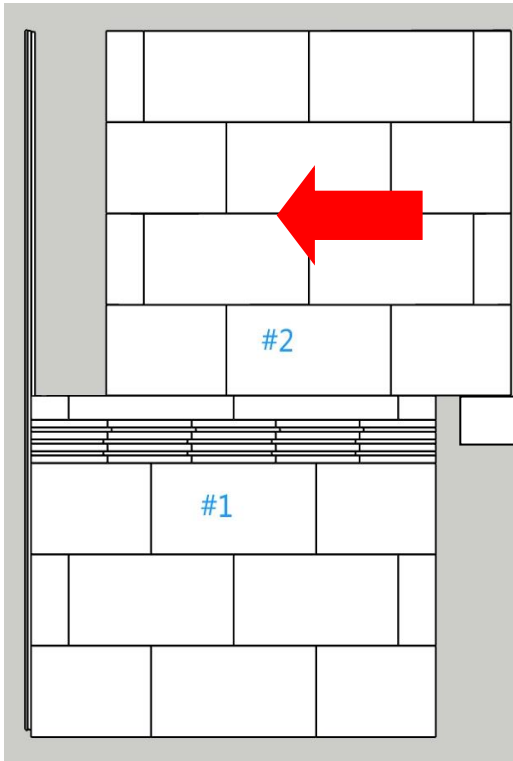
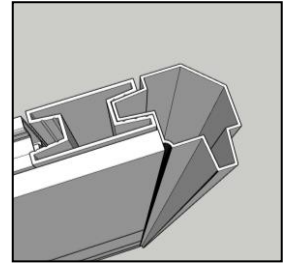

Internal corner strip

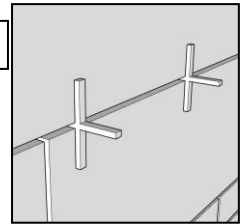

Push board #2 to the top of board #1 in the direction shown, and use the tile cross bar to fix the distance of the board

bottom

bottom

Top

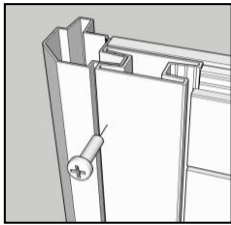

About 0.1 inch from the top

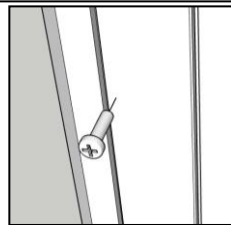

About in the middle

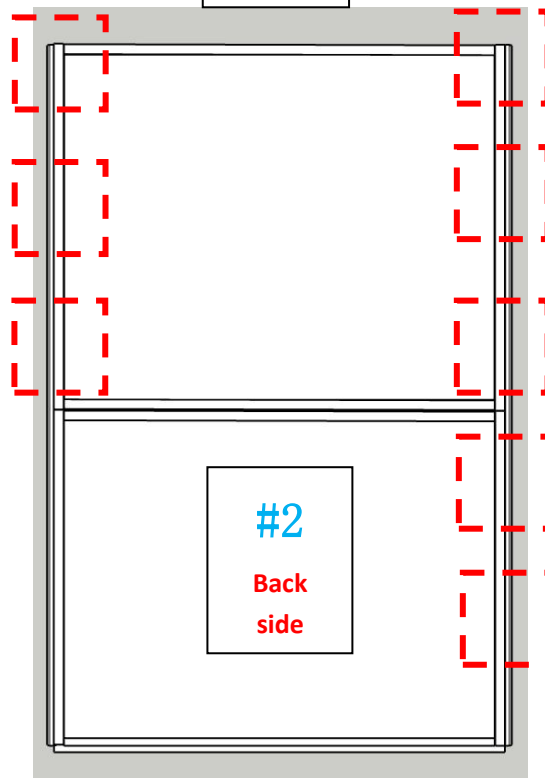

#2

Back side

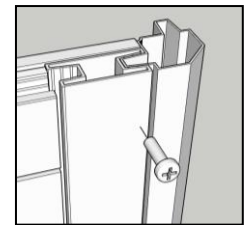

About 0.1 inch from the top

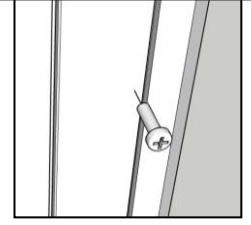

About in the middle

bottom

Use drill tail round head phillips screws to fasten the back according to photo

3

### Install the water-proof tray

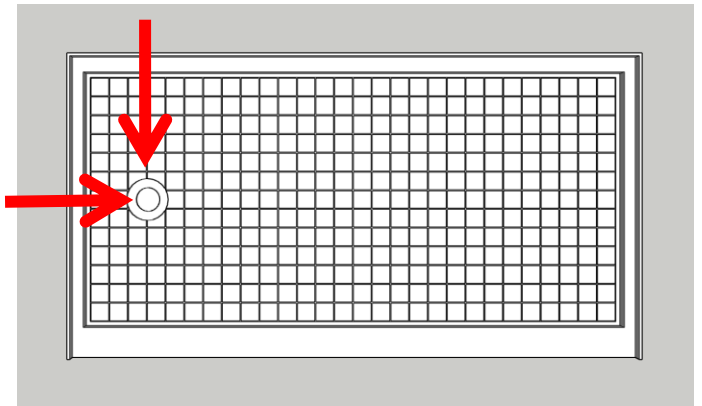
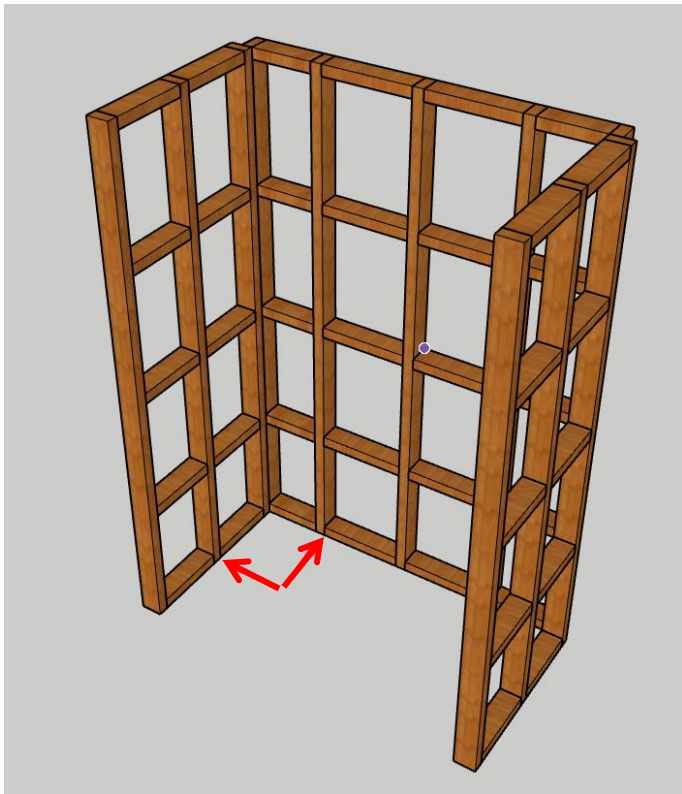

Firstly, confirm the position of the floor drain, and then install the drainage pipe from the floor drain. The picture is based on the floor drain on the left. Please be subject to the tray you purchased.

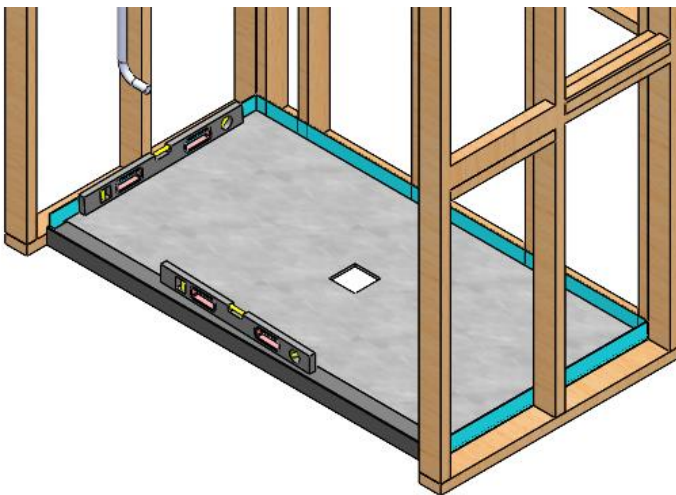

Place the waterproof tray, and then put a level ruler to on the tray to ensure the tray is placed horizontally.

4

## Drill water hole on siding wall panel

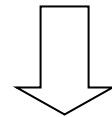
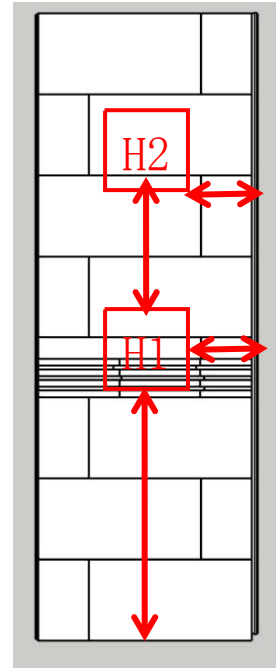
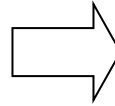
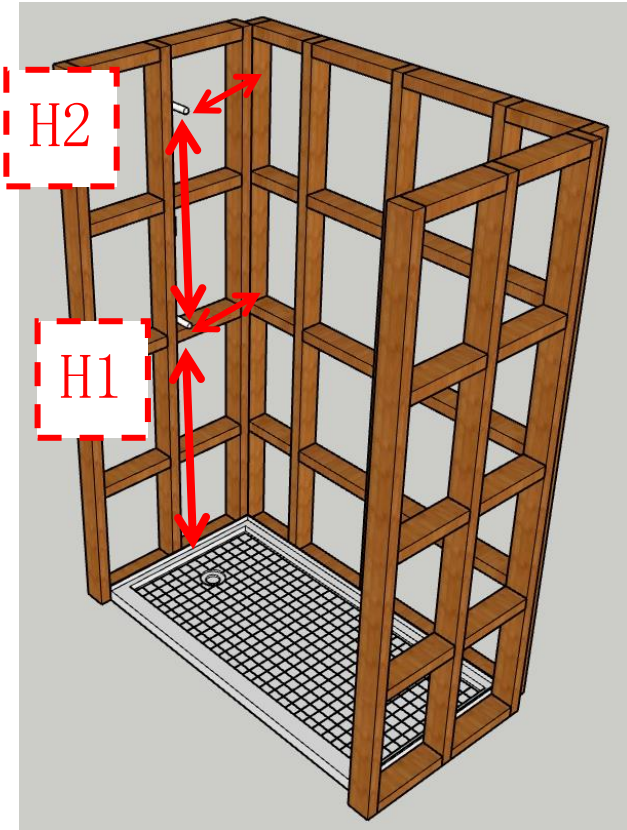

After the waterproof tray is installed, measure the position and height of the water supply hole (the picture shows the water supply hole of board #3 as an example, please be subject to the actual water supply hole position), and drill the water supply hole according to the measurement size with a hand drill and tile hole drill-head.



5

Install #1 #2 wall panel

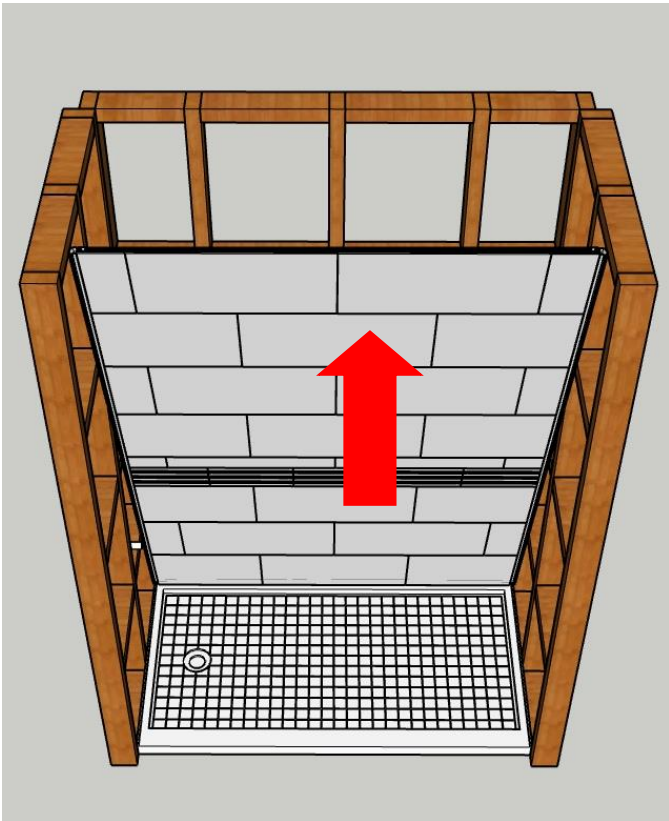

Please install panels #1 and #2 in the sequence of arrows shown.  
Note: The wall panel is heavy, at least two people or more to install!

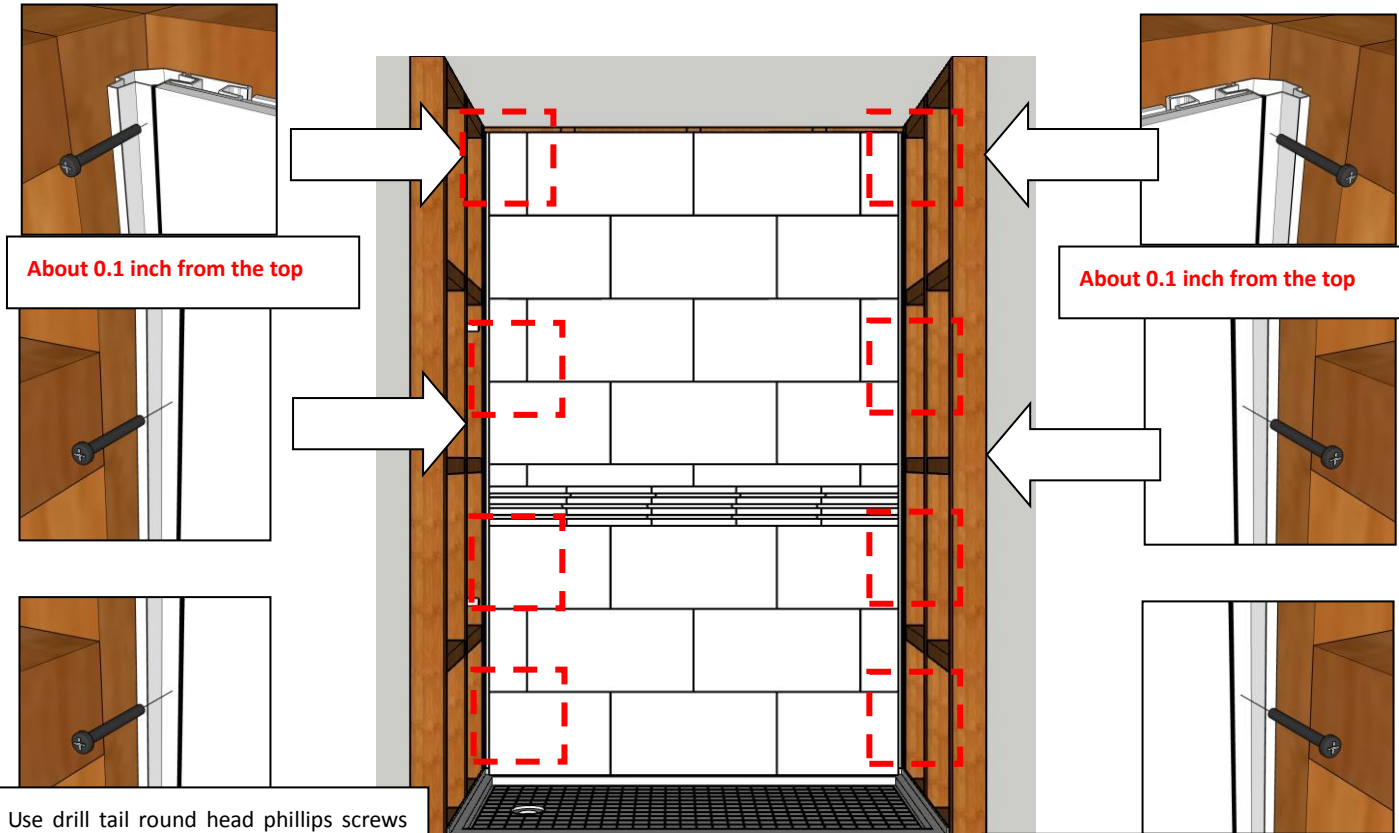

About 0.1 inch from the top

About 0.1 inch from the top

Use drill tail round head phillips screws to fasten according to frame

Use drill tail round head phillips screws to fasten according to frame

fasten the wooden frame with round head phillips screws (M4.2\*35) according to the position of the wooden frame.  
Check whether the top and bottom are vertical  
Note: The screw holes must be drilled with a drill bit in the internal corner strip

7

Install #3 wall panel

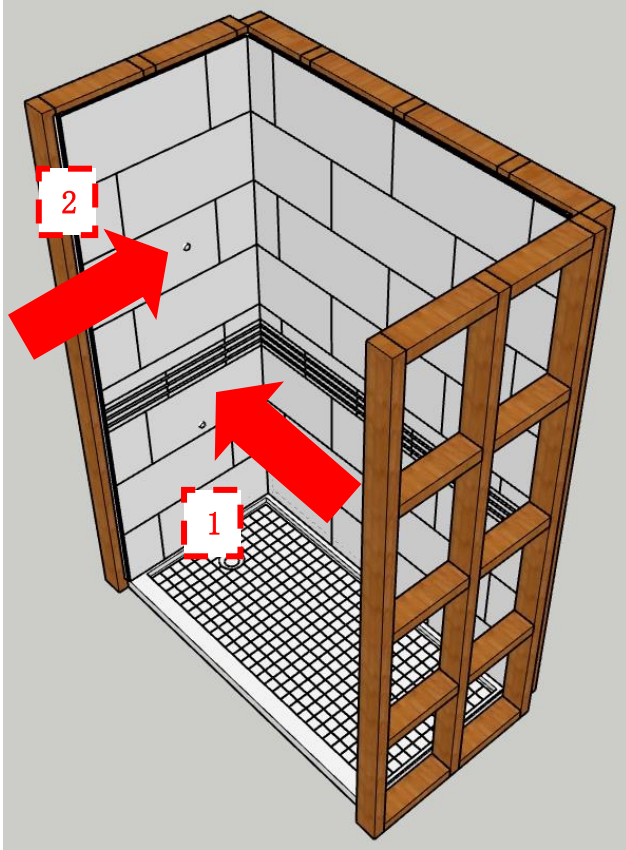

Please install the #3 wall panel in the sequence of arrows shown. Pay attention to the horizontal and vertical flatness of the wall panel, which can be measured by infrared level.

8

Install #4 wall panel

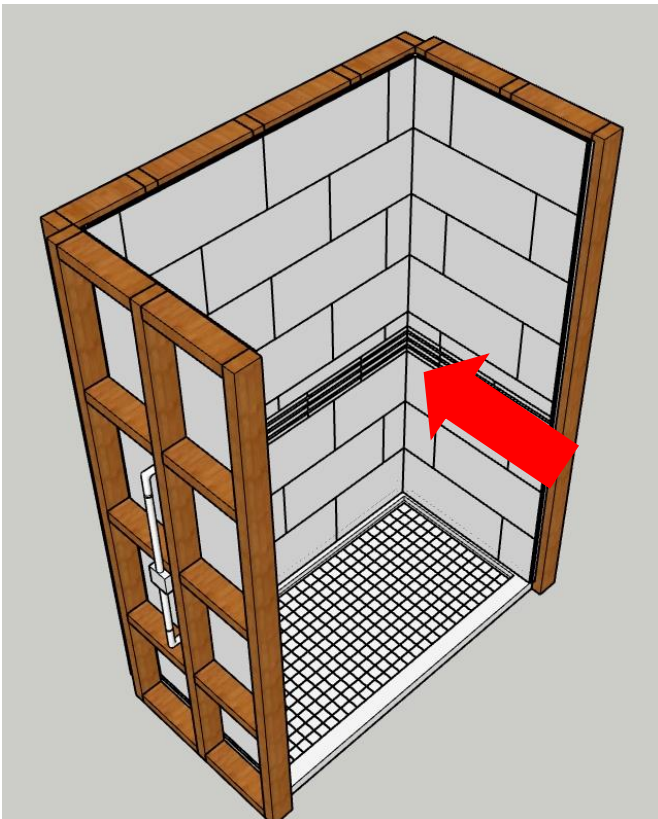

Please install the #4 wall panel in the sequence of arrows shown. Pay attention to the horizontal and vertical flatness of the wall panel, which can be measured by infrared level.

9

### Install capping seal strip

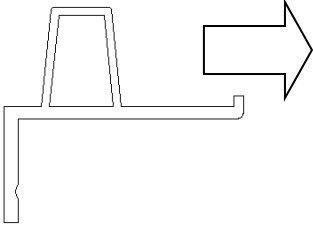
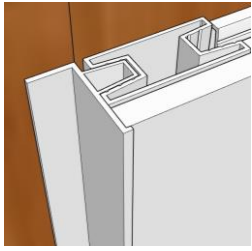

Capping seal strip

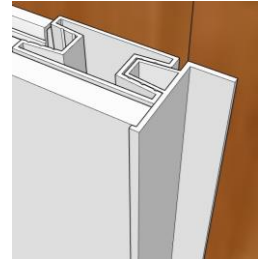
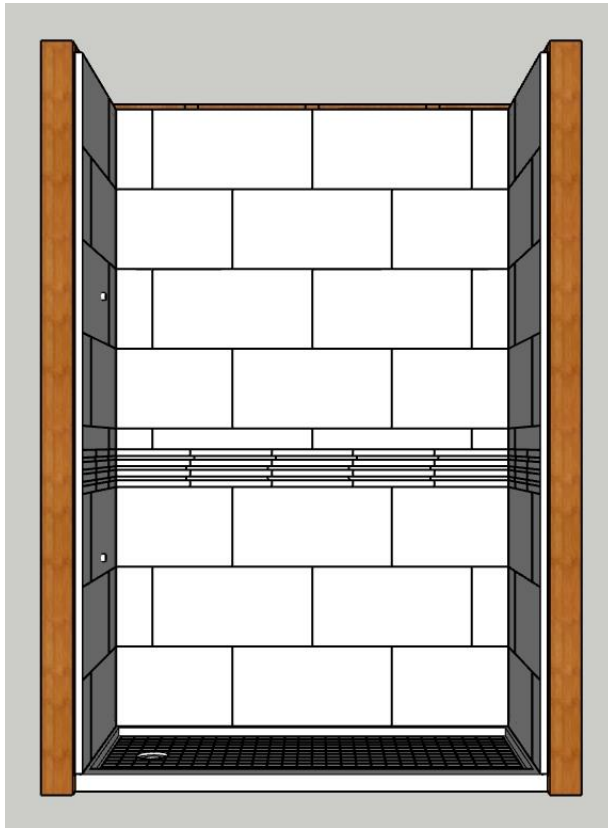

Capping seal strip

Install the capping seal strip into the slot of the panel according to the photo.



About 0.1 inch from the top

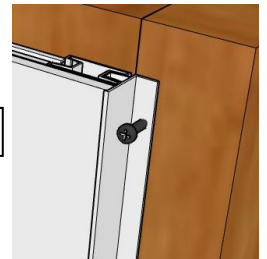
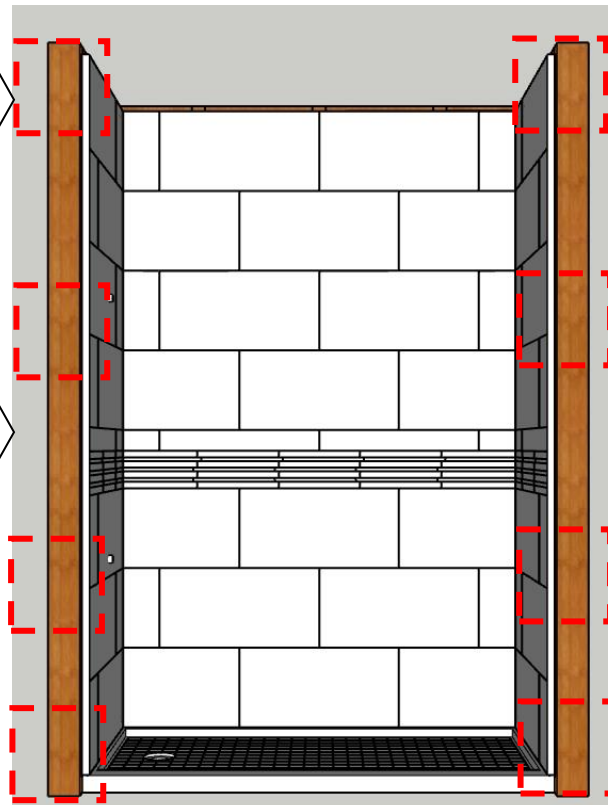
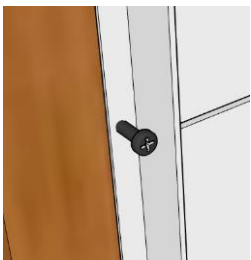

About 0.1 inch from the top

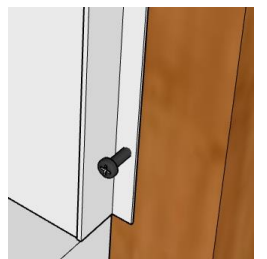

Fix the wooden frame with round head **phillips screws (M4.2\*35)** according to the position of the wooden frame. Check whether the top and bottom are vertical

10

Tile seam filling

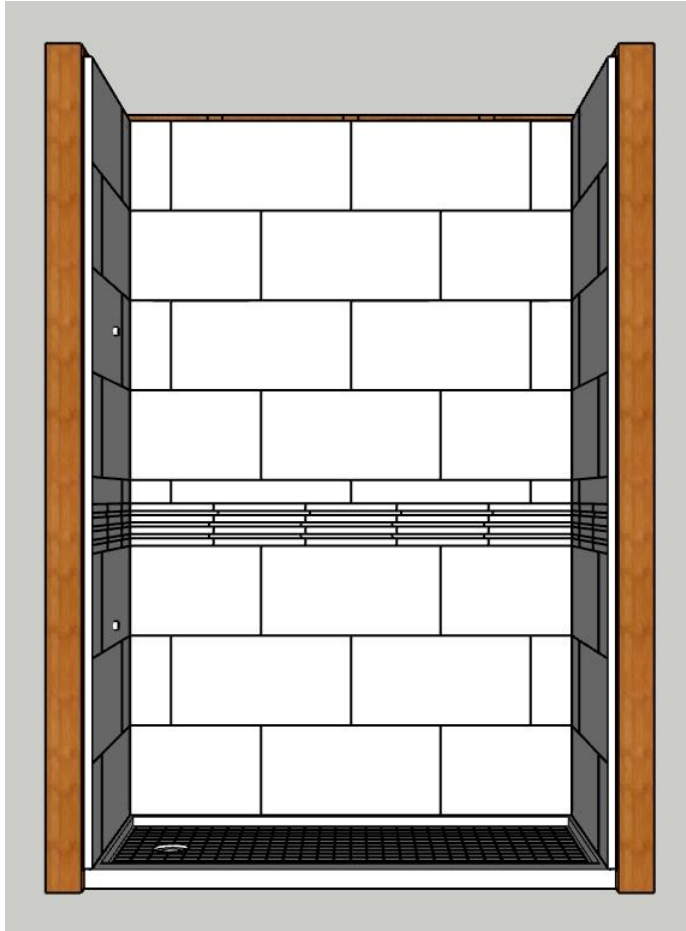

After the product is installed, use mildew proof sealant to fill the wall tile seam of each wall panel.

11

Product expanded view

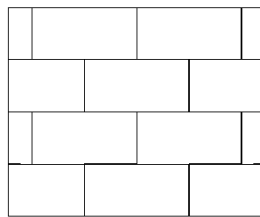

2

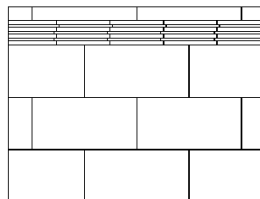

1

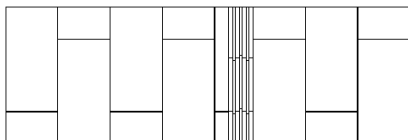

3

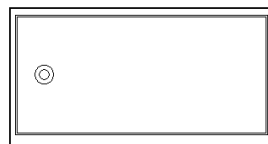

4

