

Magnetic Screen Door

• KEEP FRESH AIR IN AND BUGS OUT •

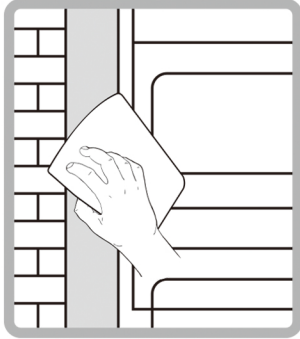

Step1: Clean the door frame

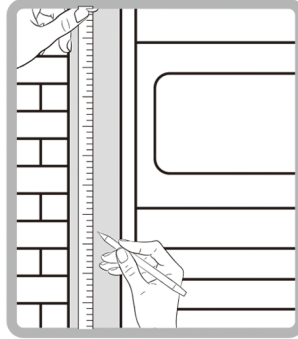

Step2: Measure and mark the location of velcro on the door frame

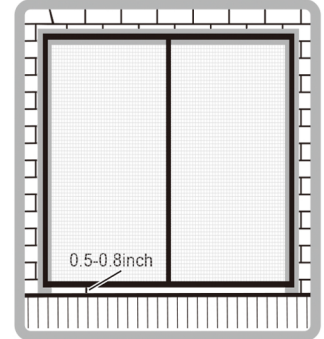

Step3: Please leave a 0.5-0.8inch margin at the bottom to help the curtain can close naturally

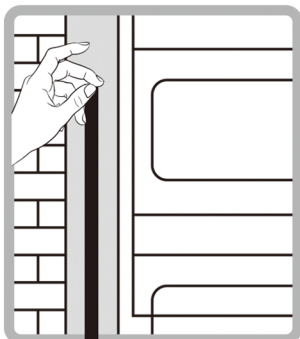

Step4: Fix the velcro to the door velcro to the door frame. (Note: the wider strip apply to the top and the narrower apply to the sides)

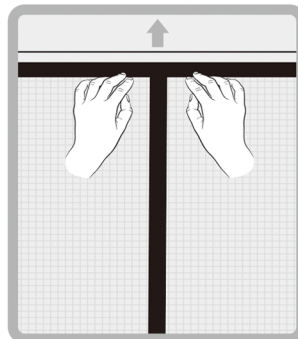

Step5: Stick the curtain on the Velcro, the central part of the screen door should be slightly higher than the two sides

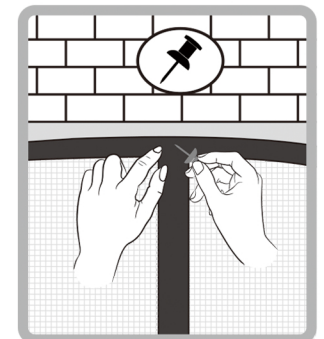

Step6: Push the attached pins when extra fasten is needed(optional)

Note:

- Your screen door is covered by a 1-year warranty. If you have any questions or concerns about it, please contact us to solve. **Warranty Access: innhom@hotmail.com**
- The gravity sticks at the bottom of the screen door may get together, you can disperse them manually to achieve a better windproof effect.
- When you install the magnetic screen door, please leave a 0.5-0.8inch margin at the bottom to make sure the curtain can close naturally.
- Then central part of the screen door should be slightly higher than the two sides in order to be balanced.
- Press the adhesive tape until secure and don't move the curtain for at least 24 hours.
- When not using the screen door, you can use the storage belts to store it or you can also tear off the curtain and keep the adhesive velcro in the door frame for next use.
- The new screen door will have a small smell during the long transportation. It's a normal phenomenon. You can put it in a cool and ventilated place for 1-2 days, then the smell will dissipate.