

G57JAS03XX Series Stainless Steel

18" Center on center stainless steel grab bar with concealed flange plates. 1.25" diameter, 1.2mm wall thickness, 304 stainless steel.

Mounting hardware supplied for wood stud installation.

Product Data

Overall Dimensions (Inch.)	21-1/8x2-3/4x3-1/8
Net Weight (lbs.)	1.37

Installation Hardware Details

Stainless steel screw and dowels

Packaging Details

Package	Polyethylene package
Package dimensions (Inch.)	21-1/8 x 2-13/16 x 3-1/8
Weight with Packaging (lbs.)	1.37

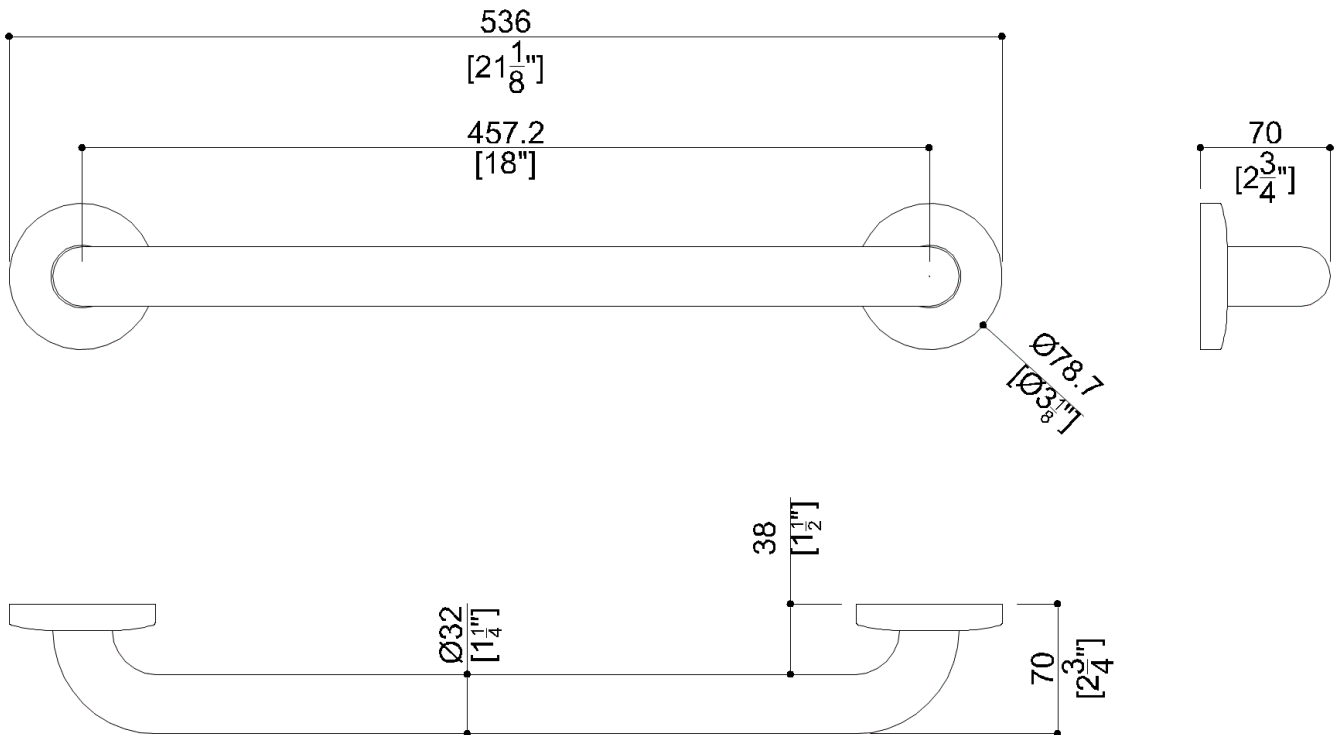

G57JAS03XX Series Stainless Steel

AISI304 stainless steel fixing plate

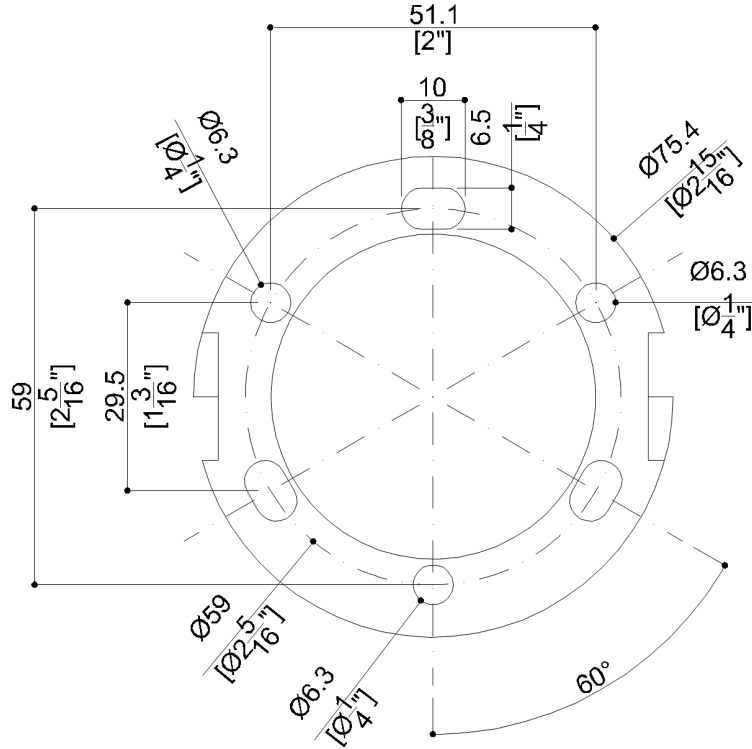

Available Finishes (xx)

- | | |
|---|--|
| N1 | N2 |
|  Satin |  Bright |

Load Capacity

Vertical 450 lbs.

Warning

Before installation and use, read the installation and use instructions in their entirety. If questions arise please contact Ponte Giulio company.

Cleaning

Product can be cleaned with a cloth and warm soapy water. Non abrasive, solvent free cleaners can also be used.

Warranty

Please visit www.pontegiulio.com for complete warranty details.

Materials and finishes

Stainless Steel N/A.