

Picture 1

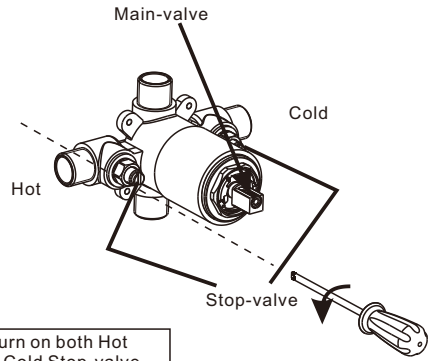

Turn on both Hot & Cold Stop-valve to full-open Position.

Picture 2

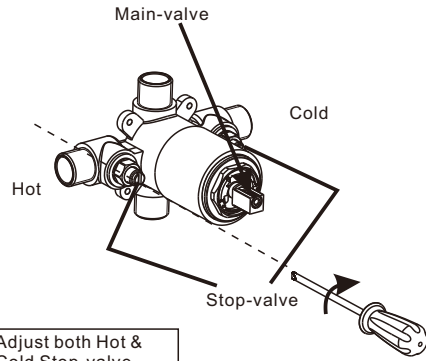

Adjust both Hot & Cold Stop-valve (Clockwise) half turn.

How to solve the issue of Spout & Shower running in the same time?

1. Disassemble the Handle & Escutcheon;
2. Make sure the Hot/Cold Stop-valve in Turn-on & also to full-open position (adjust by Phillips screwdriver), see below (Picture 1)
3. Turn on the Main-valve with Spout function, if the shower still dripping then, use screw driver to adjust both Hot & Cold Stop-valve (Clockwise) half turn, see below (Picture 2)
4. If the Shower keep dripping, try another half turn for both Hot & Cold side Stop-valve by Clockwise position.

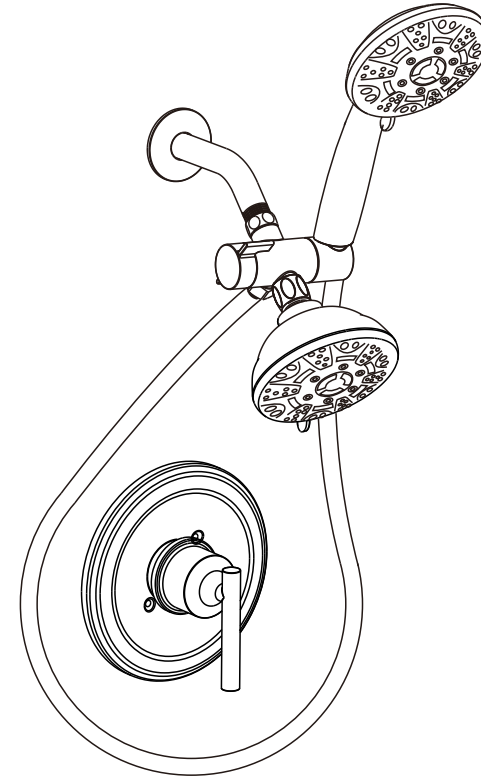

B ↔ B

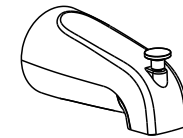
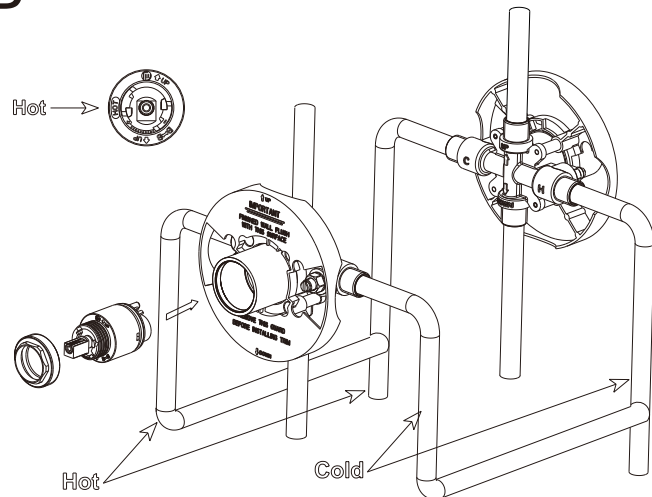

You may need to purchase:
 1/2" Female Threaded to
 1/2" PEX adapters
 1/2" PEX and Copper Couplings
 Crimp Rings
 1/2" Copper and PEX Tubing
 Torch and Lead-free Solder Kit

Safety tips

To avoid crushing and cutting injuries during assembly , gloves must be worn.
 This product is only allowed for bath , hygiene and cleansing purposes.
 Excessive pressure differences between hot and cold water pipes must be balanced.

Installation tips

Before installation , the product must be inspected for transportation damage.
 After installation , transportation damage or surface scratches will not be recognized.
 Pipes and valves must be installed , flushed , and inspected in accordance with common standards.
 Please observe the current installation regulations in your country.
 Use the relief valve only as specified .
 Do not fix semi-dew columns and other components to the relief valve.
 Do not use silica gel containing acetic acid during installation!

Technical parameters

Working pressure : max.1 Mpa
 Recommended working pressure:0.1-0.5 Mpa
 Test pressure:1.6 Mpa (1Mpa=10bar=145 PSI)
 Hot water temperature : up to 70°C
 Recommended temperature:upto65°C
 Thermal disinfection:max70°C/4minutes

Tips

- 1.Before installing the faucet , the debris in the pipeline must be washed away to avoid the pipeline being blocked.
- 2.Make sure that the pipes are left hot and right cold.

As mandated by U.S. federal law , this hand shower and showerhand is equipped with water flow regulator that limits maximum water flow to 1.8 GPM (6.8 liters) per minute at 80 psi water pressure .
 In areas with extremely low water pressure causing the shower water flow to be unsatisfactory , the flow regulator may be removed to improve the water flow in the shower head.
 Using screwdriver point or long nose pliers, pull out Water Regulator located inside Shower Handle

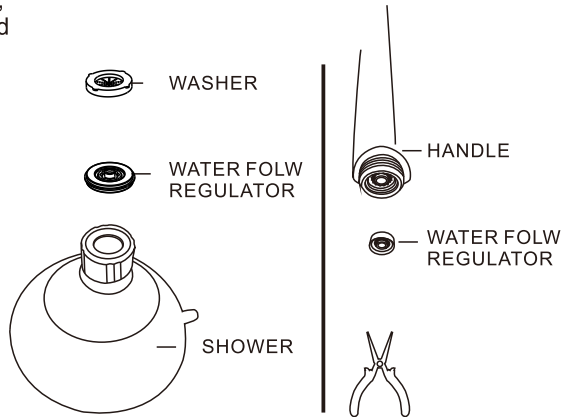

Washer must stay **FLAT** and **STRAIGHT** inside Connection Nut .
 Turn on water to check for leakage.



Notes:

It is normal to hear some voice when you shake it as there is an impeller in the shower head which helps produce massage water better.

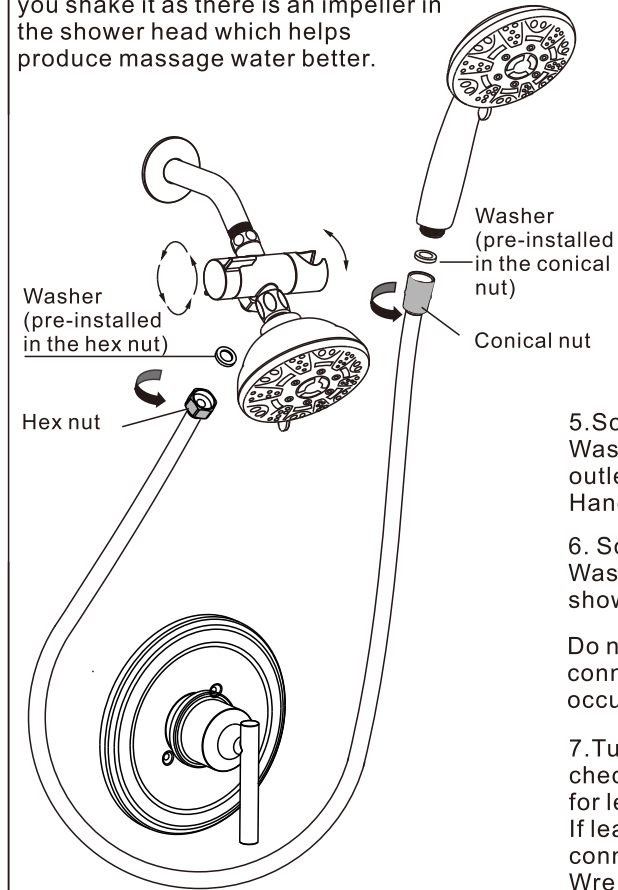

5.Screw hex nut with Hose Washer in place onto bottom outlet of Diverter .
 Hand tighten connection

6. Screw Conical nut with Hose Washer in place onto handheld shower. Hand tighten connection.

Do not overtighten any connections or damage may be occurred.

7. Turn on water supply and check all threaded connections for leaks.
 If leaks occur ,tighten connection with an Adjustable Wrench or by hand.
 Check Diverter for proper operation by turning the side handle backward and forward to activate the Fixed and/or Hand Showers.

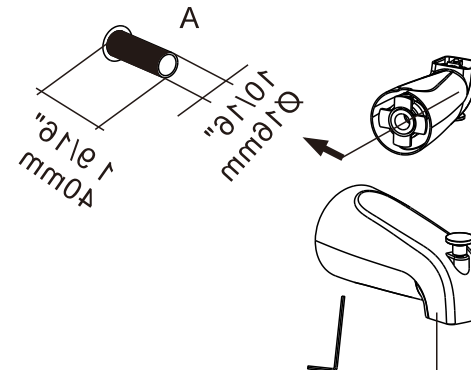

Install the bathtub spout on the water pipe as the picture.

Notice:
 Before install the bathtub spout please be sure to polish the edge (Location A) of the copper pipe with sand paper, lest the copper pipe is too sharp to damage the inner sealing ring of the bathtub outlet.

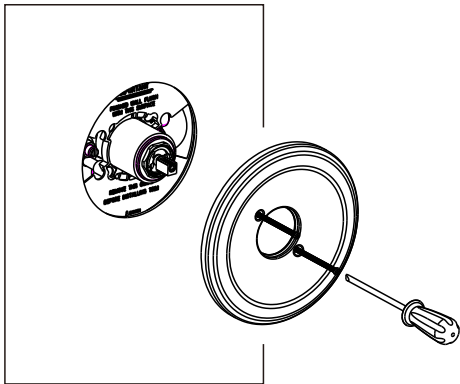

A. Reinstall the cartridge ,
then install the panel on the valve.
B. install the valve trim by screwdriver.

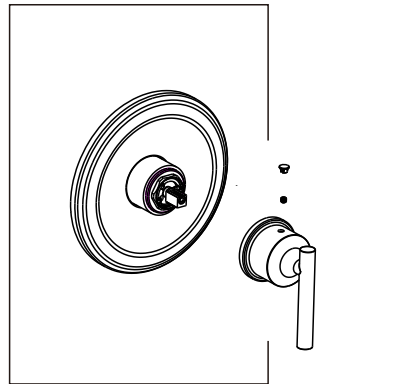

C. Install the handle with Allen key as
below picture

As shown in the figure, please close the main valve of
Entrance water pipe.

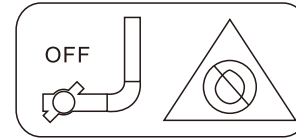

Drill three holes in the wall

according to the drawing:

A: Pressure balance valve hole

B: Top spray hole

C: Bathtub spout hole

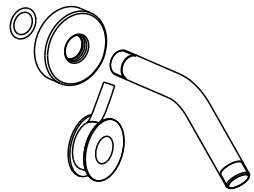

1. Install the cover, shower arm
and shower head as below
Apply teflon tape in a clockwise
direction to all threaded connections.

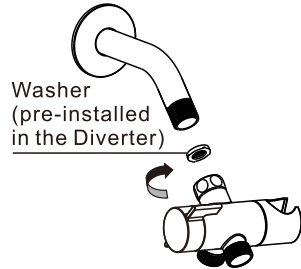

2. NOTE: Inspect Diverter to be sure
Sealing Washer is in place within
Coupling Nut.
Thread Coupling Nut of Diverter onto
Shower Arm.
Tighten with Adjustable Wrench.
WARNING: DO NOT OVERTIGHTEN.

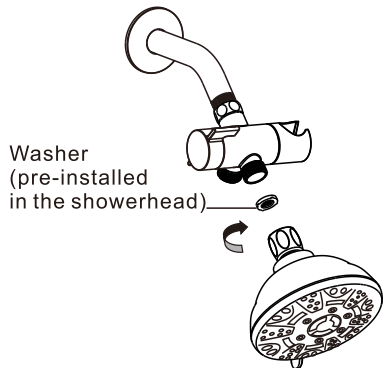

3. Thread Fixed Showerhead onto front
outlet of Diverter. Tighten with hand.
WARNING: DO NOT OVERTIGHTEN.



4. Check Diverter for proper operation.
Turn on water to check for leakage.

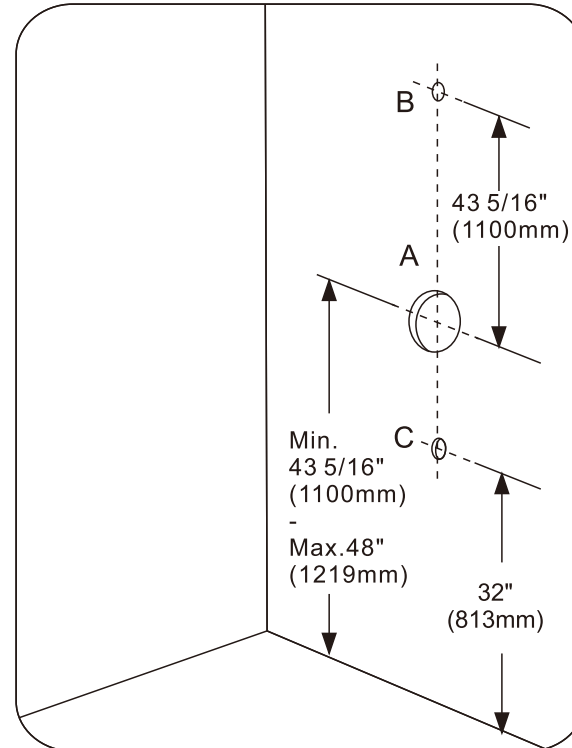

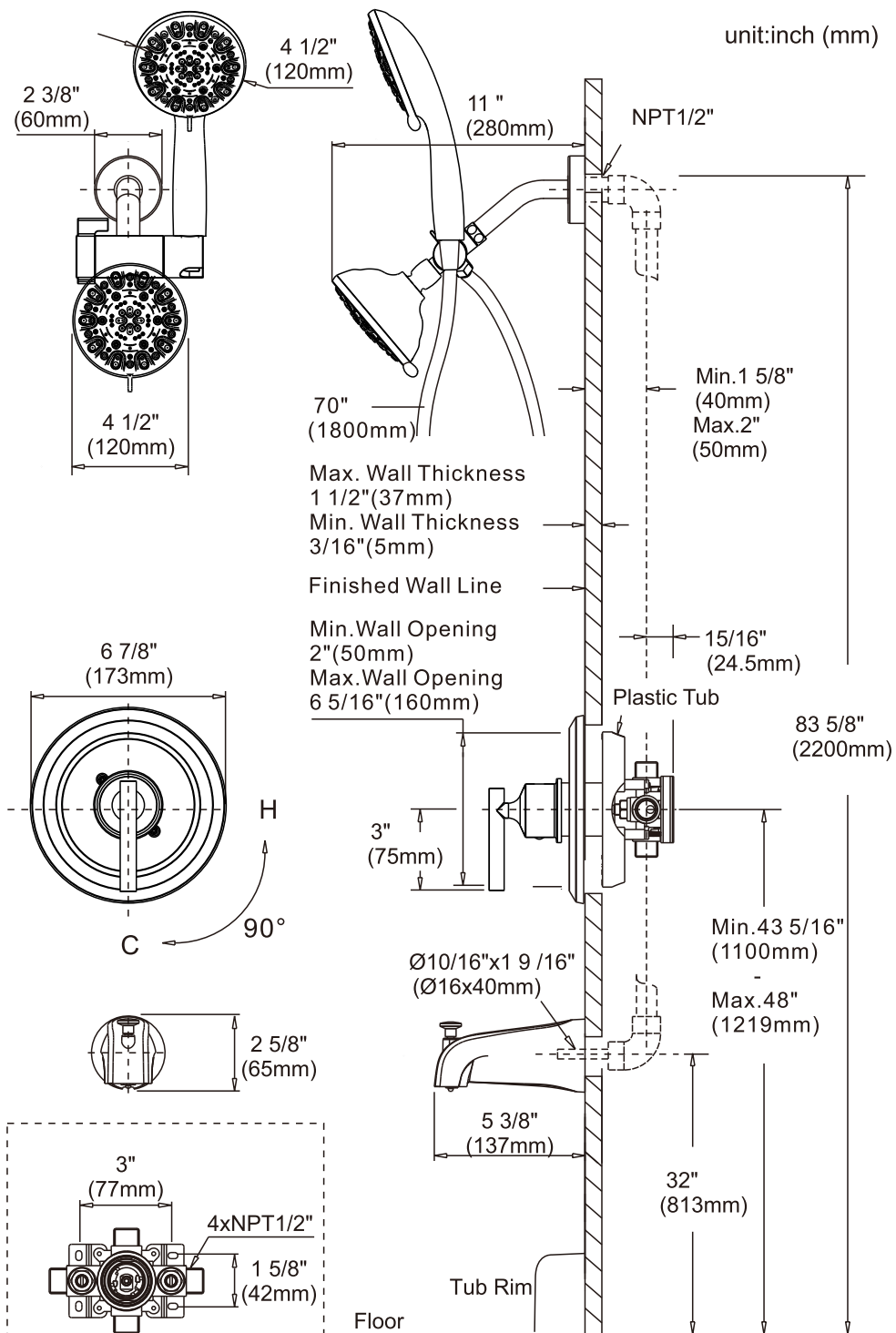

Connect the valve to the pipes as the right picture
Identify the markings on the back of valve body.

UP marking :
Connect the top spray pipe in the wall.

DOWN marking :
Connect the bathtub spout pipe in the wall.

H marking :
Connect the hot water pipe in the wall.

C marking :
Connect the cold water pipe in the wall.

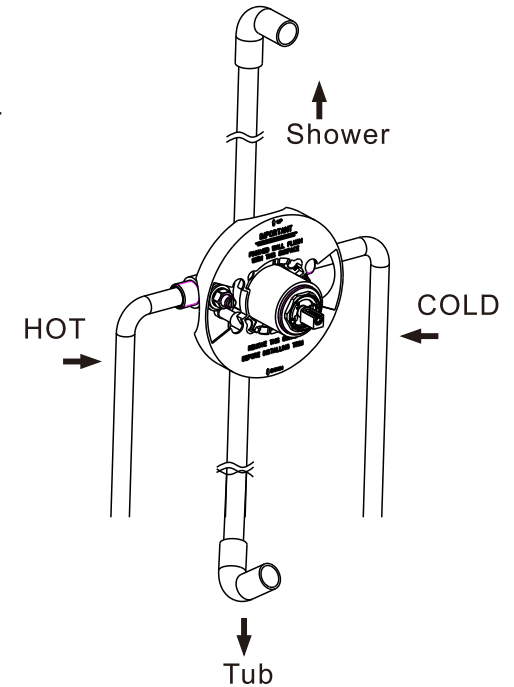
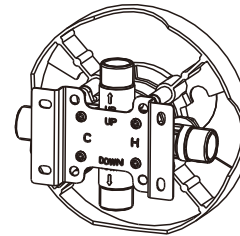

- 1.Remove the valve gland (part A) by adjustable wrench
- 2.Remove the cartridge (part B) and open the inlet valve to rush the silt in the pipe
- 3.Keep the water flowing for one minute to check the pipe connection position is leaking.

