

# INSTRUCTION MANUAL

---

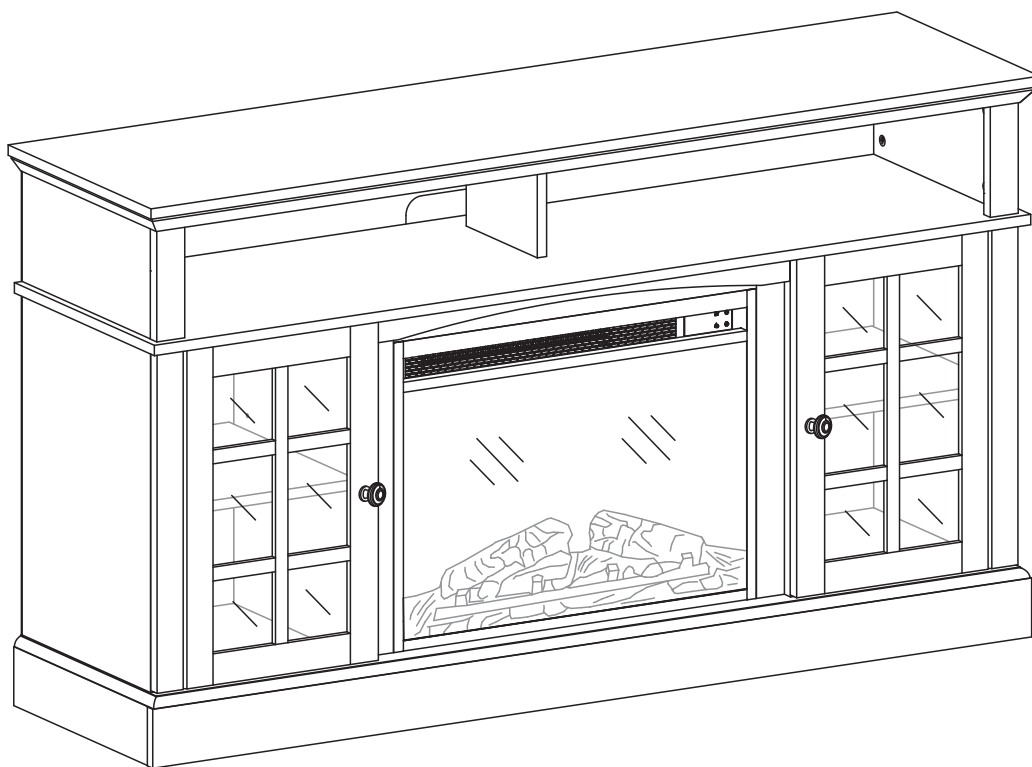

## TV Console

---

---

## Important Safety Information

- Please carefully read all instructions before attempting installation. If you DO NOT understand the instructions or have any questions or concerns, please email customer service.

**CAUTION:** Avoid potential injuries and property damage!

- DO NOT use this product for any purpose that is NOT explicitly specified in this manual. We are NOT liable for damage or injury caused by improper mounting, incorrect assembly or inappropriate use.

**WARNING:** This product contains small parts that may pose a choking hazard.

- Before starting assembly, verify all parts are included and undamaged. DO NOT use damaged or defective parts. If you require replacement parts, please email customer service.

- To prevent the stand from tipping over, use the wall attachment device provided with this product.



**Top Shelf Weight Capacity:**  
200 lbs (90kg)

Fits up to most 65" / 165.1cm diagonal flat panel TVs

**Middle Shelf Weight Capacity:**  
50 lbs (22.7kg)

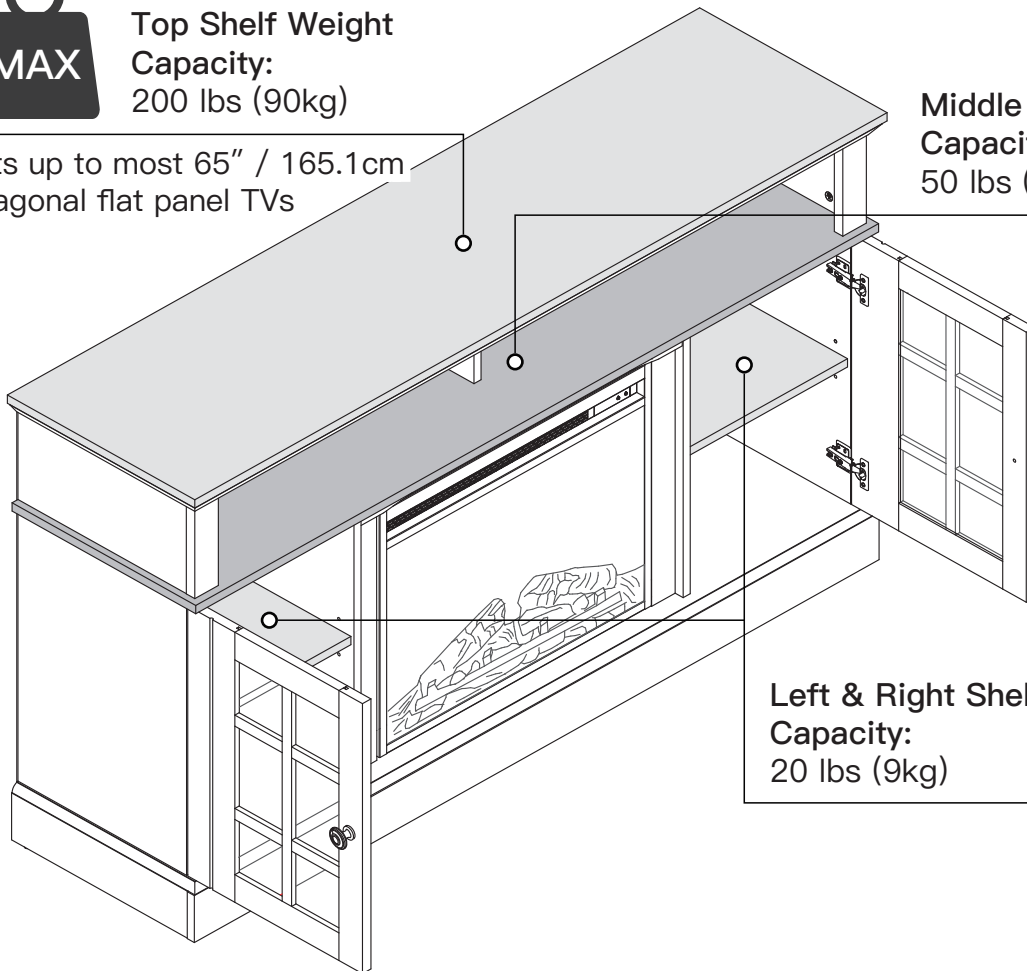

**Left & Right Shelf Weight Capacity:**  
20 lbs (9kg)



## Tools Needed (Not Included)

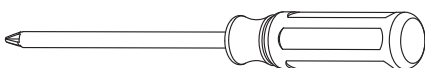

Phillips Screwdriver

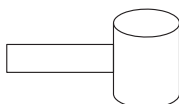

Rubber Mallet

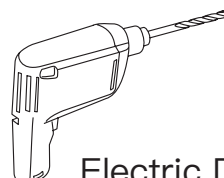

Electric Drill



Hammer

## How the Assembly System Works

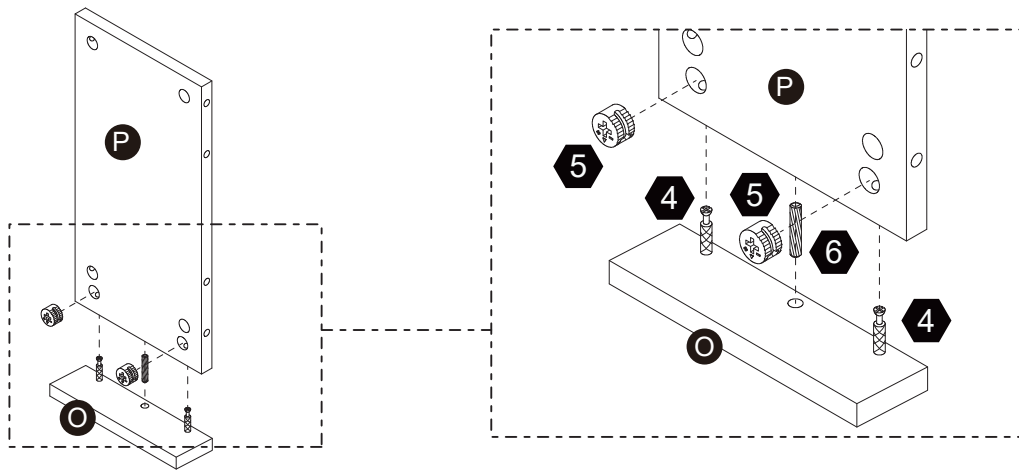

## How to Install Wood Dowel

Insert the wood dowel [6] at least half-way. IF NECESSARY, lightly tap the wood dowel with a self-supplied rubber mallet.

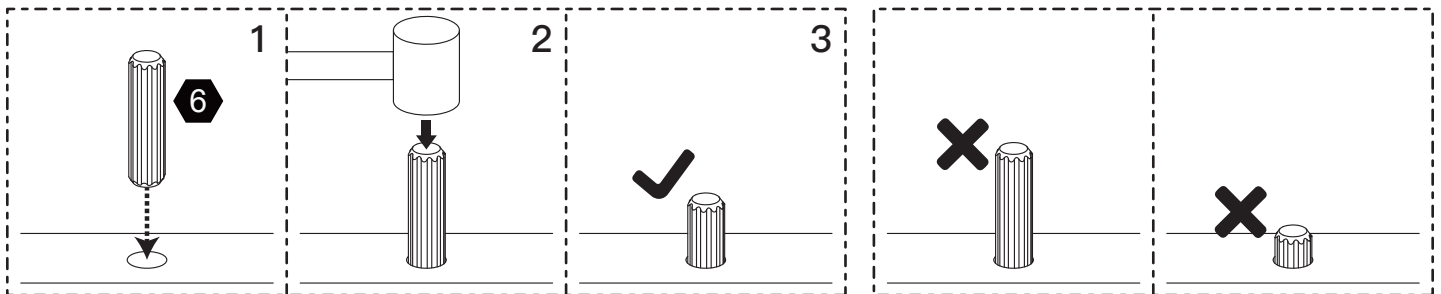

## Using the Cam Lock System

1. Screw cam bolt [4] into the threaded hole on the panel.
2. Connect both panels together. Make sure cam bolt [4] goes into the pre-drilled hole on the end of the panel for cam lock [5].
3. Insert cam lock [5] into the large hole on the panel. Make sure the open slot faces the head of the cam bolt [4].
4. Rotate cam lock [5] clockwise with a Phillips screwdriver to lock the cam bolt [4] in place.

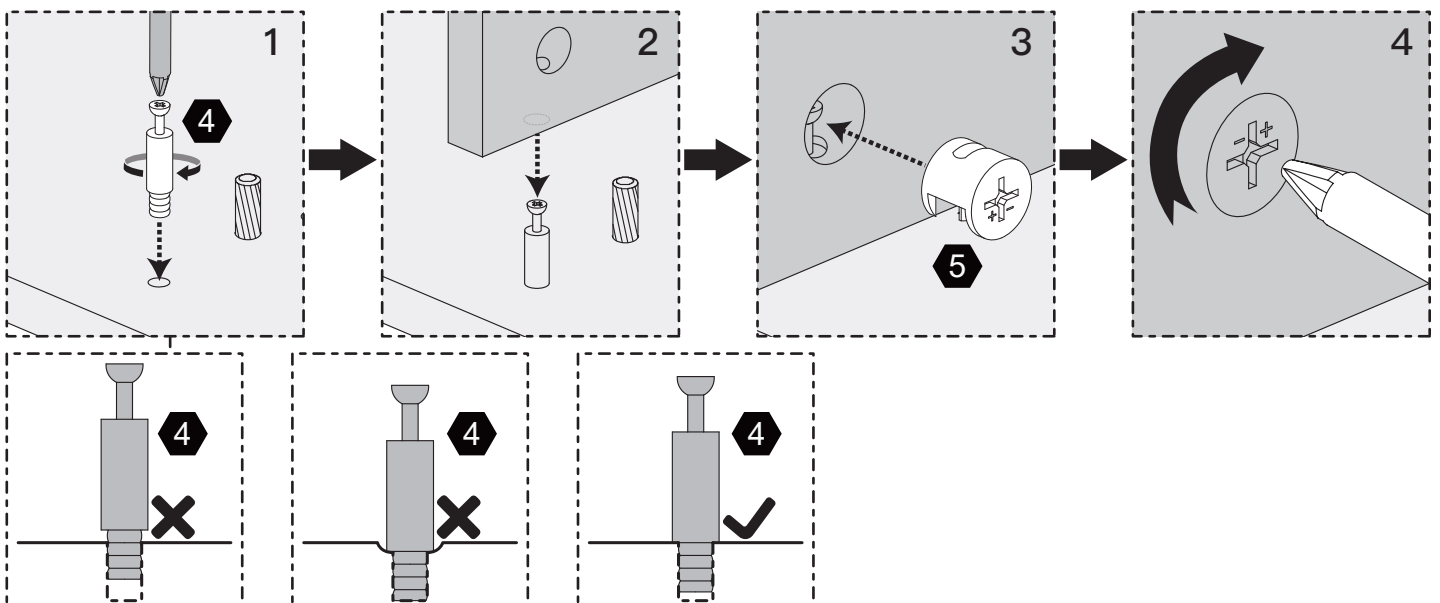

You are now ready to assemble the TV console.

# Exploded Drawing

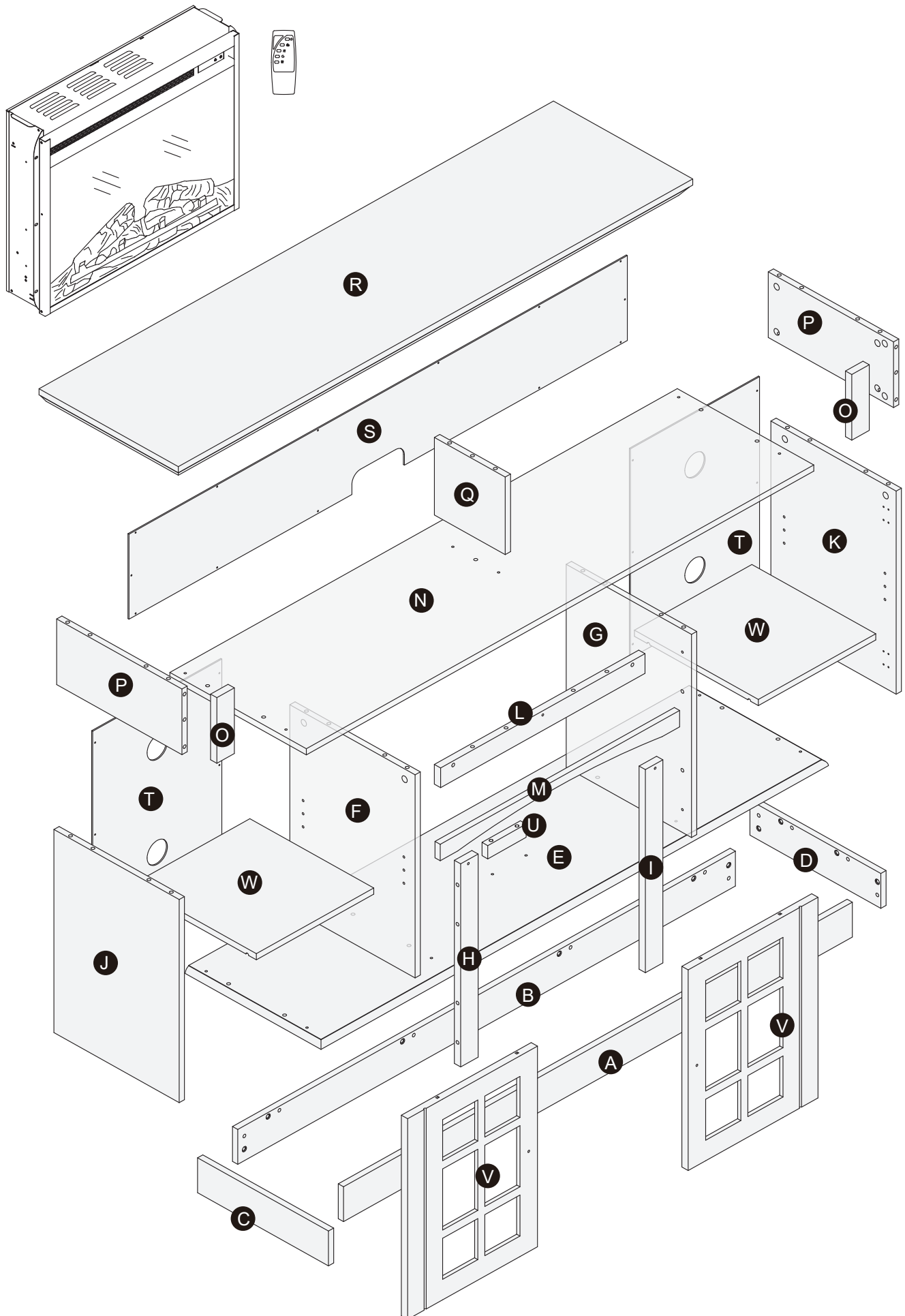



# Supplied Parts and Hardware

A

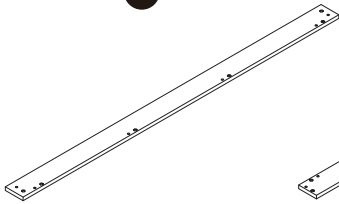

Bottom Front Rail  
x 1

B

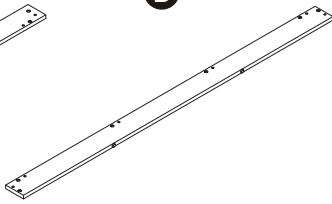

Bottom Back Rail  
x 1

C

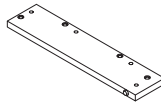

Left Bottom  
End Panel  
x 1

D

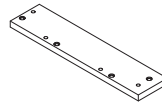

Right Bottom  
End Panel  
x 1

E

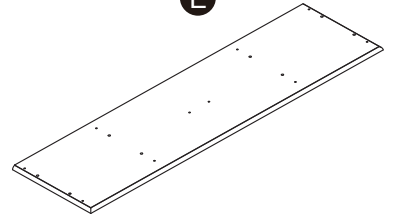

Bottom Panel  
x 1

F

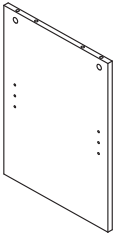

Left Inside Panel  
x 1

G

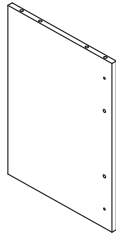

Right Inside Panel  
x 1

H



Left Rail  
x 1

I



Right Rail  
x 1

J

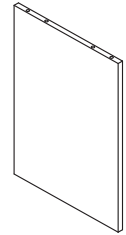

Left Middle End Panel  
x 1

K

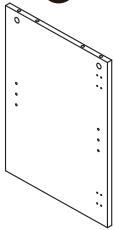

Right Middle End Panel  
x 1

L

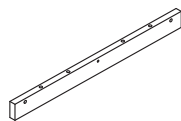

Center Rail  
x 1

M

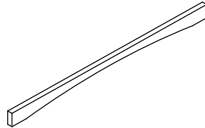

Front Trim  
x 1

N

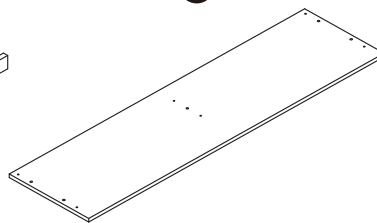

Middle Panel  
x 1

O



Panel Connector  
x 2

P

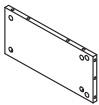

Upper End Panel  
x 2

Q



Divider  
x 1

R

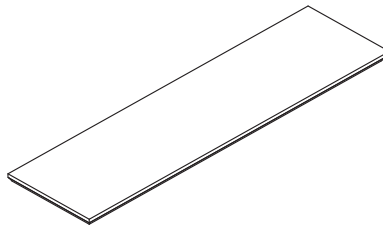

Top Panel  
x 1

S

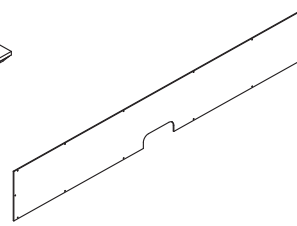

Back Center Panel  
x 1

T

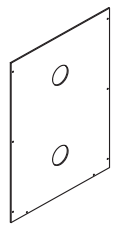

Back Panel  
x 2

U



Wood Stopper  
x 1

V

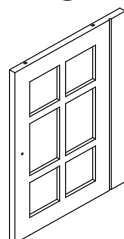

Door  
x 2

W

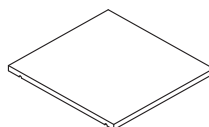

Shelf  
x 2

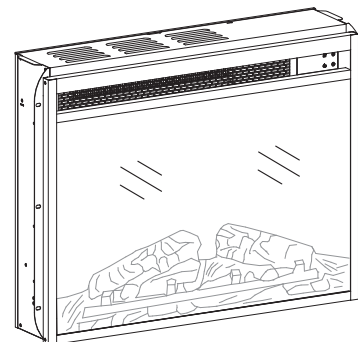

Fireplace



# Supplied Parts and Hardware

1

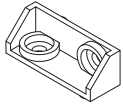

Connector  
x 16

2



M6 x 12mm

Bolt  
x 32

3



4mm

Allen Key  
x 1

4



M6 x 35mm

Cam Bolt  
x 30

5



Ø15 x 12mm

Cam Lock  
x 30

6

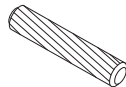

Ø8 x 30mm

Wood Dowel  
x 34

7

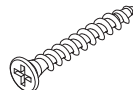

M5 x 35mm

Screw  
x 8

8

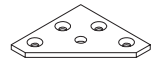

Washer  
x 2

9



M3 x 15mm

Screw  
x 8

10



1/4-20 x 5/8"

Foot Pad  
x 2

11



Ø8 x 20mm

Wood Dowel  
x 2

12



M4 x 28mm

Screw  
x 3

13



M3 x 15mm

Screw  
x 30

14

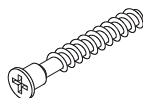

M6 x 50mm

Bolt  
x 2

15



Hinge  
x 4

16



M3.5 x 12mm

Screw  
x 24

17



Door Handle  
x 2

18



M4 x 28mm

Bolt  
x 2

19



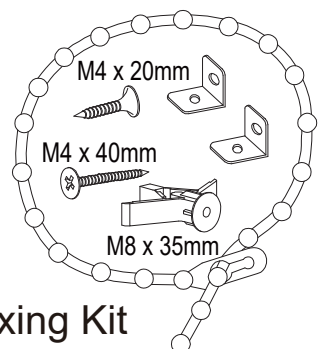

Ø5 x 16mm

Shelf Pin  
x 8



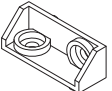

Fixing Kit  
2 Set

## Step 1

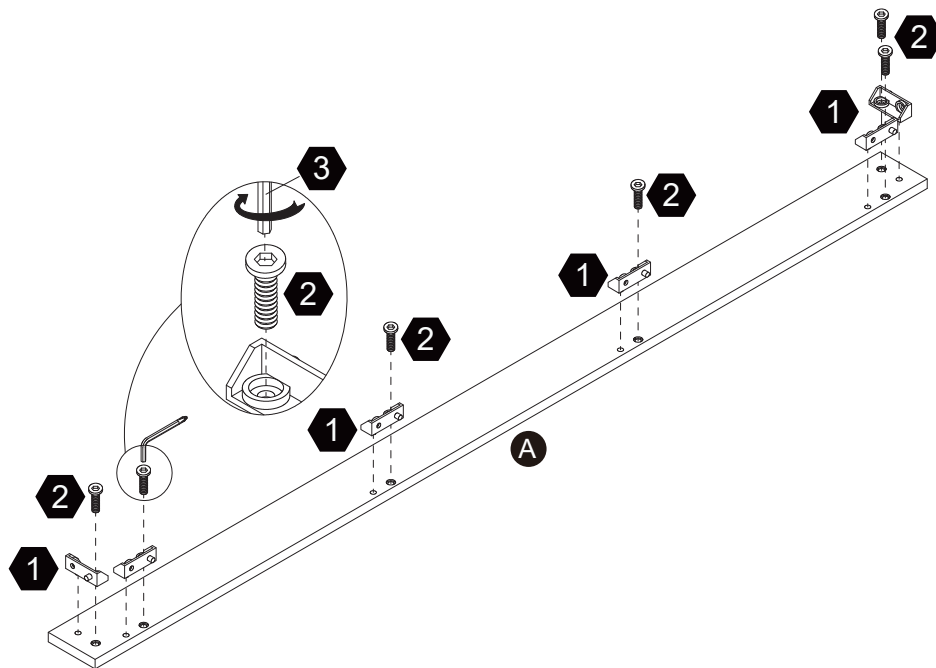
- 1**  x 6   
 **2**  x 6   
 **3**  x 1

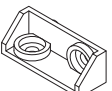
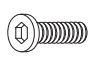

## Step 2

- 1**  x 6   
 **2**  x 6   
 **3**  x 1

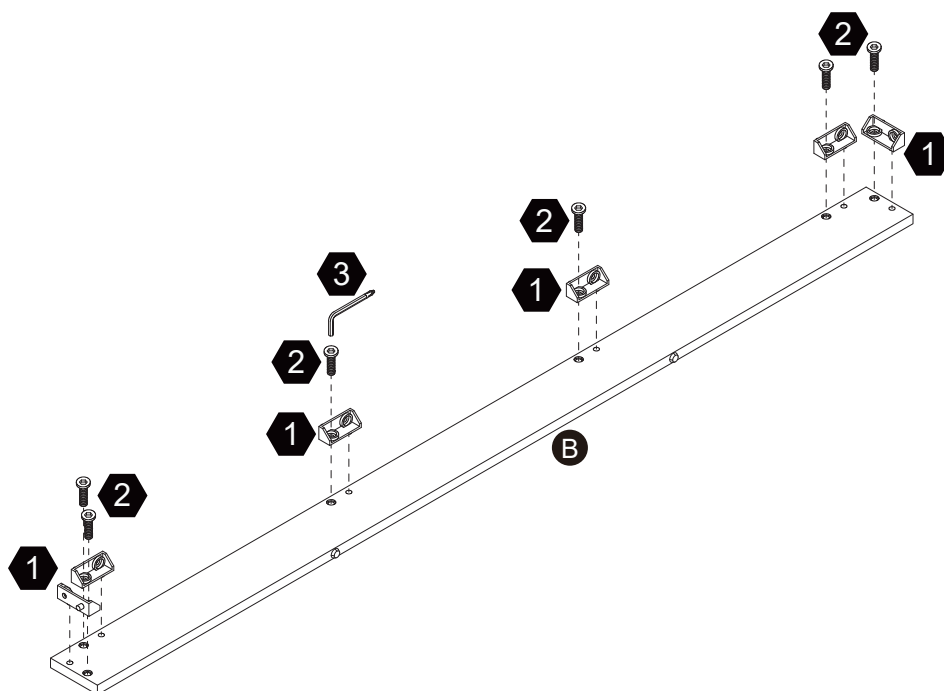

## Step 3

- 1**  x 4   
 **2**  M6 x 12mm x 4   
 **3**  4mm x 1

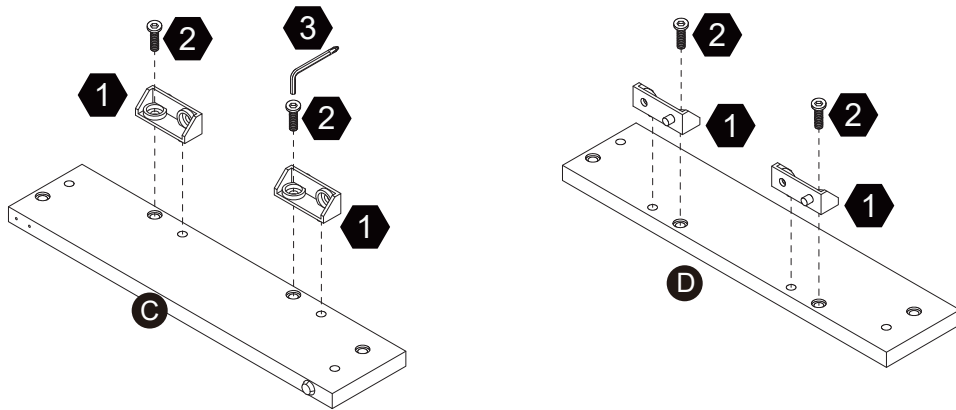

## Step 4

- 2**  M6 x 12mm x 4   
 **3**  4mm x 1

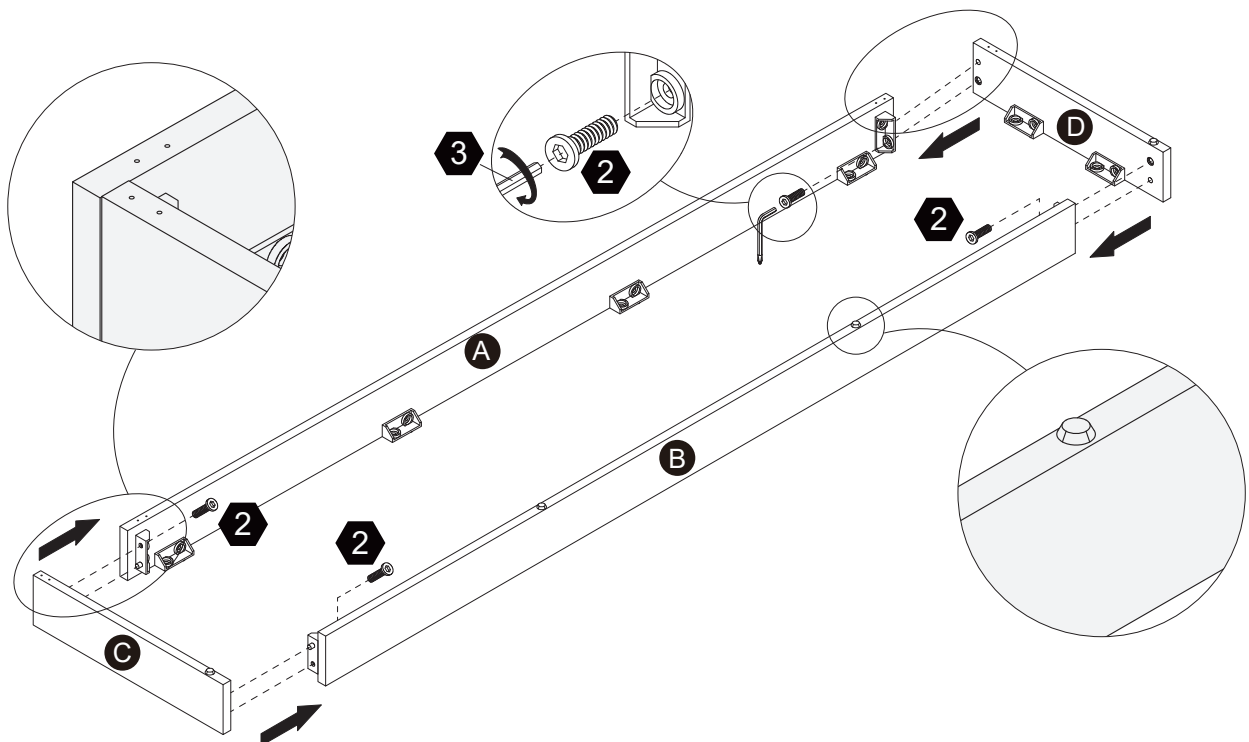

## Step 5

**2**  x 12    **3**  x 1

NOTE: The panel [A] and the round edge of the panel [E] should at the same side.

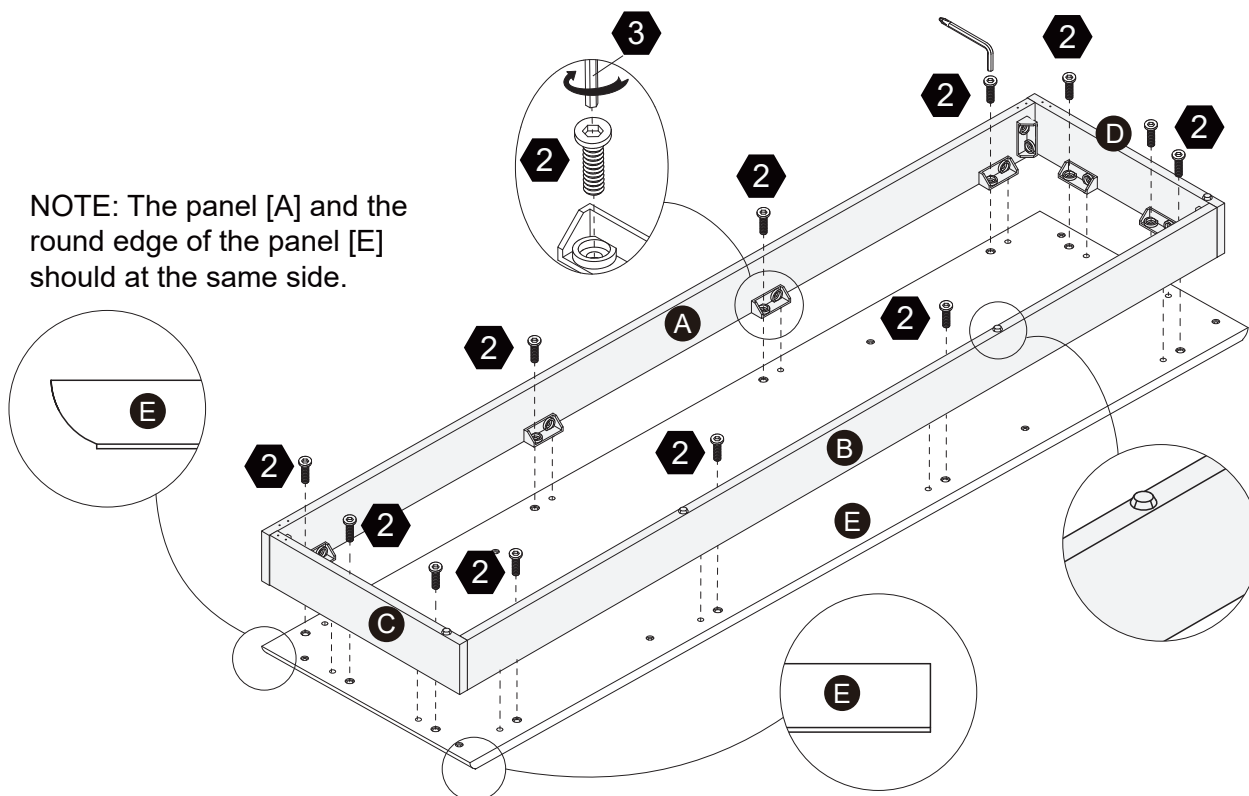

## Step 6

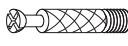
**4**  x 4

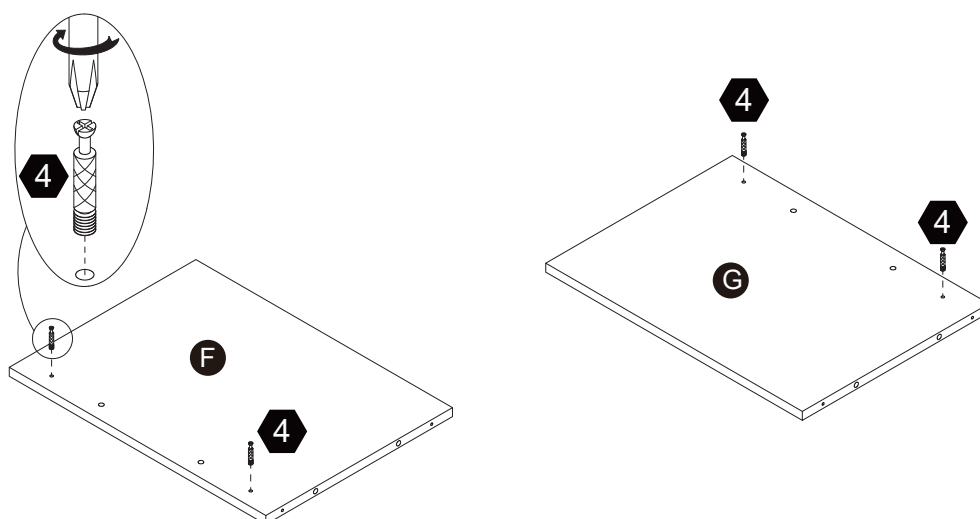

## Step 7

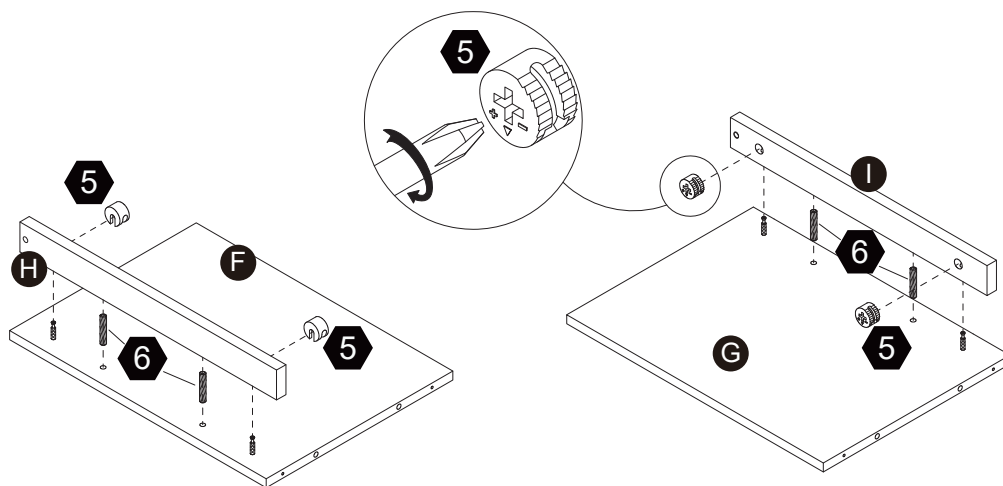

## Step 8



NOTE: The side with cam lock holes of the panel [J] and [F] should face each other. It is the same for the panel [G] and [K].

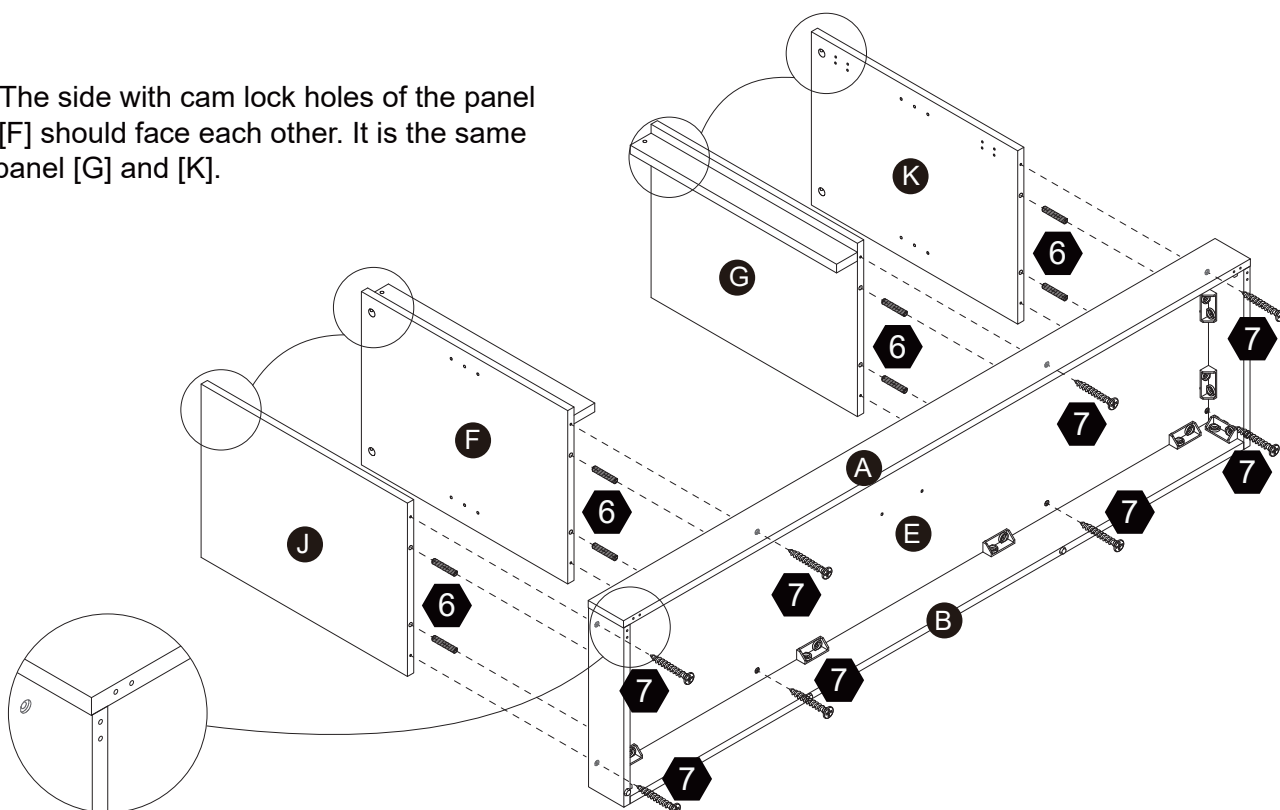

## Step 9

8  x 2    9  M3 x 15mm x 8

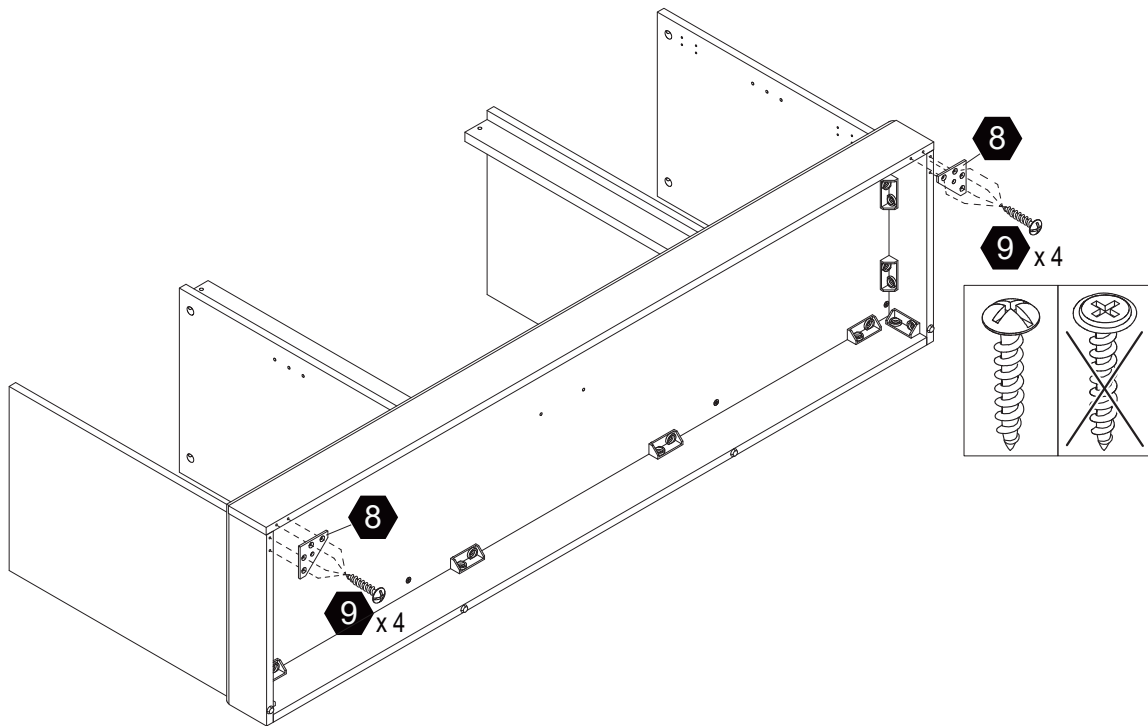

## Step 10

10  1/4-20 x 5/8" x 2

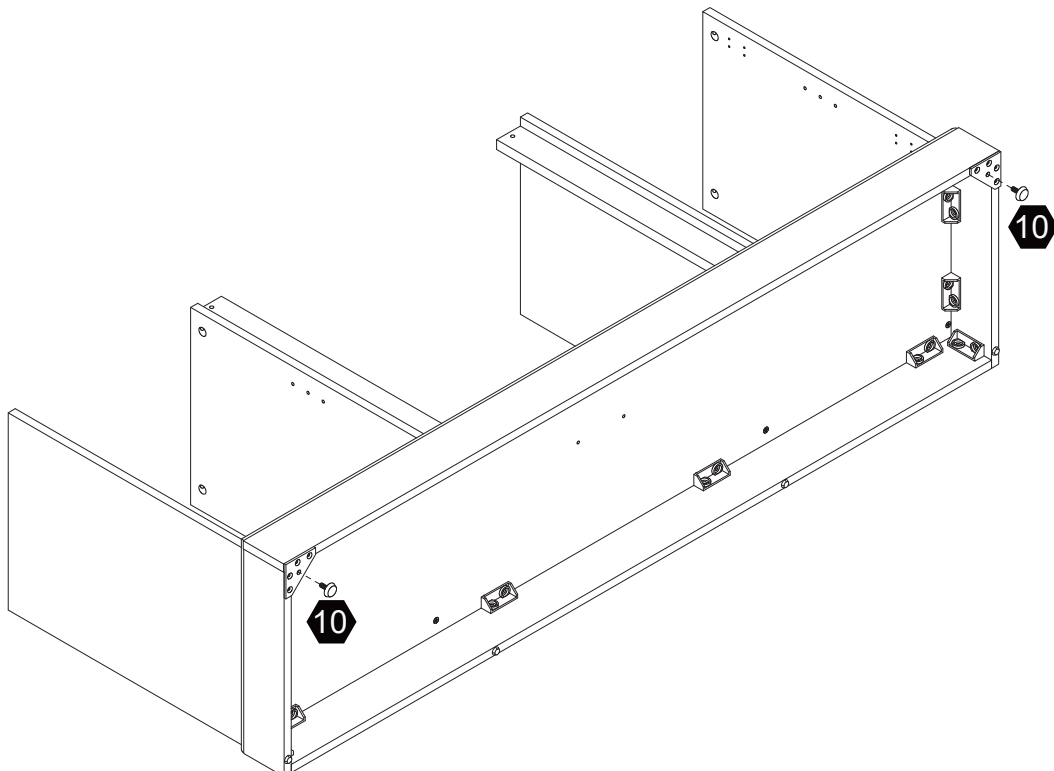

## Step 11

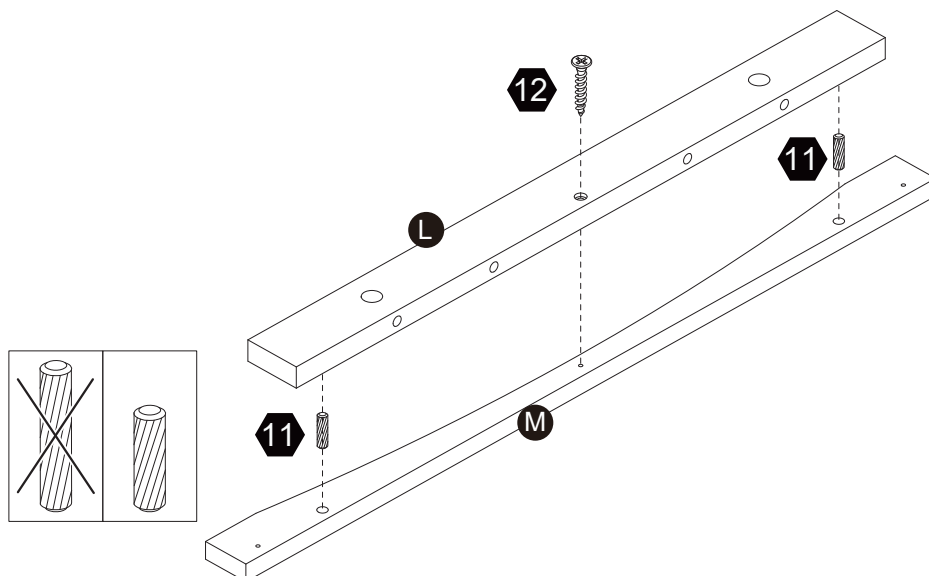

## Step 12

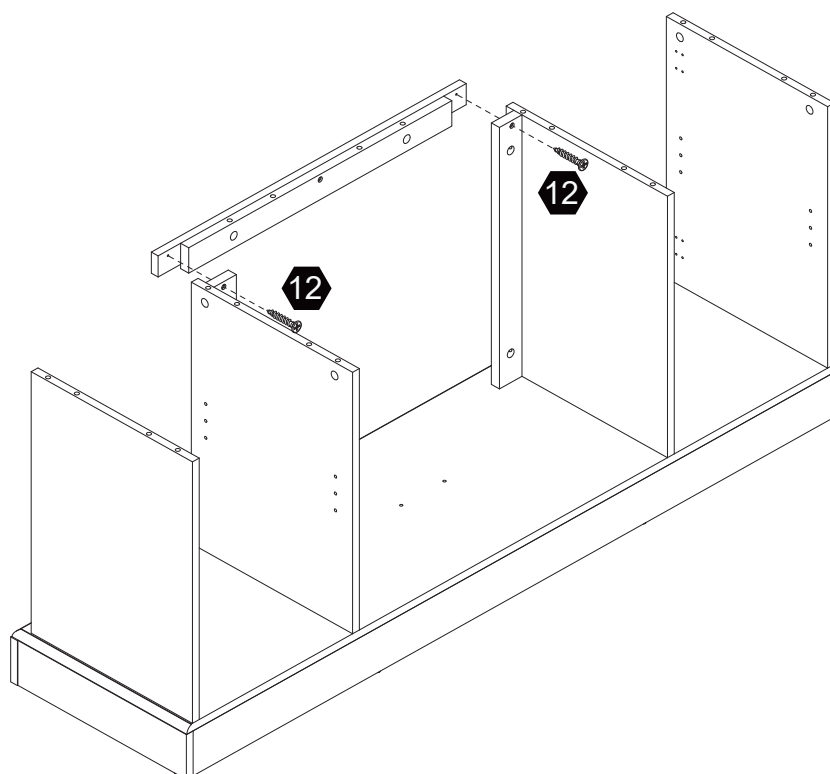



## Step 13

**4**  **M6 x 35mm x 10**

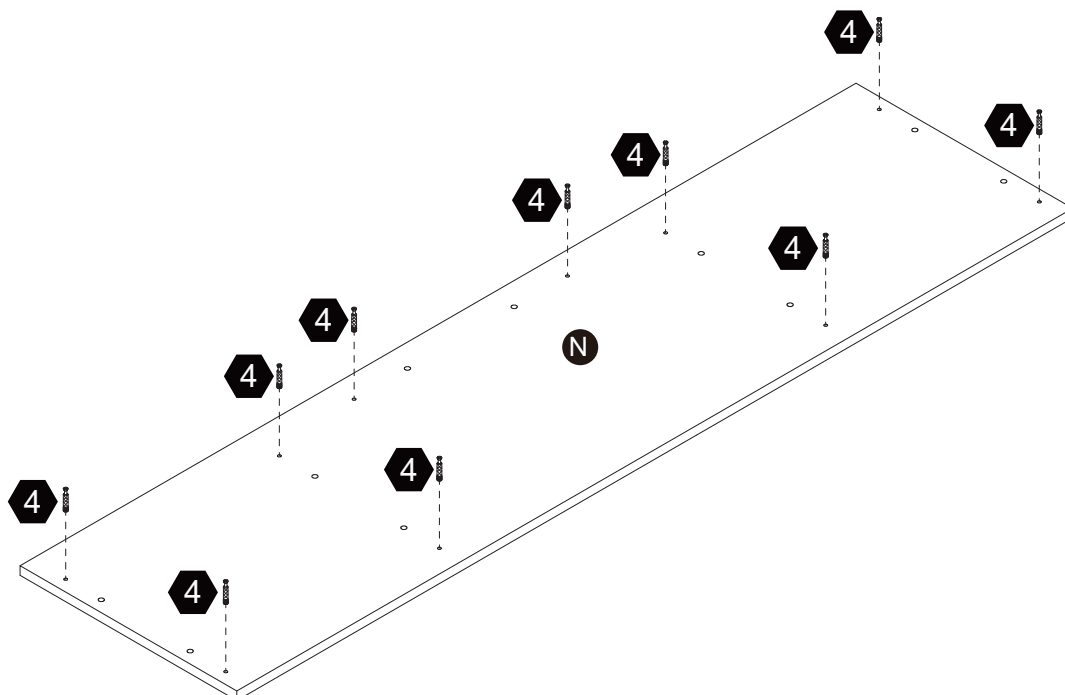

## Step 14

**5**  **Ø15 x 12mm x 10**

**6**  **Ø8 x 30mm x 10**

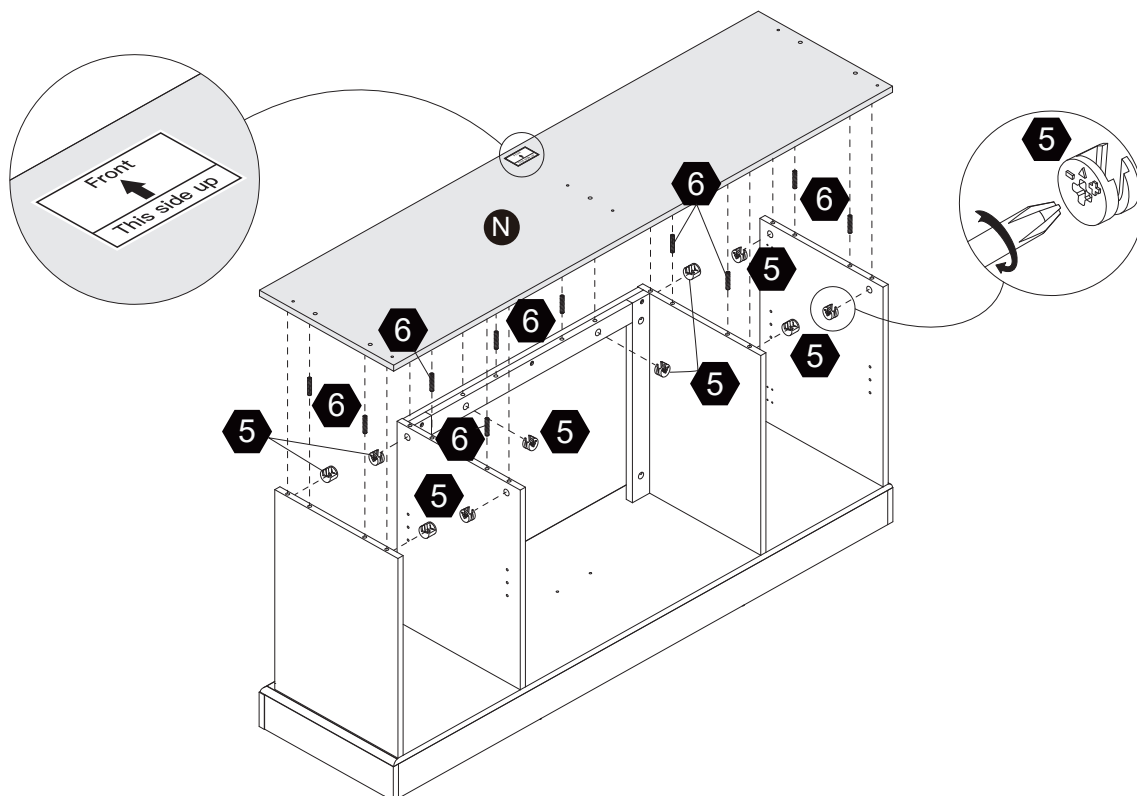

## Step 15

-   M6 x 35mm x 6
   Ø8 x 30mm x 5

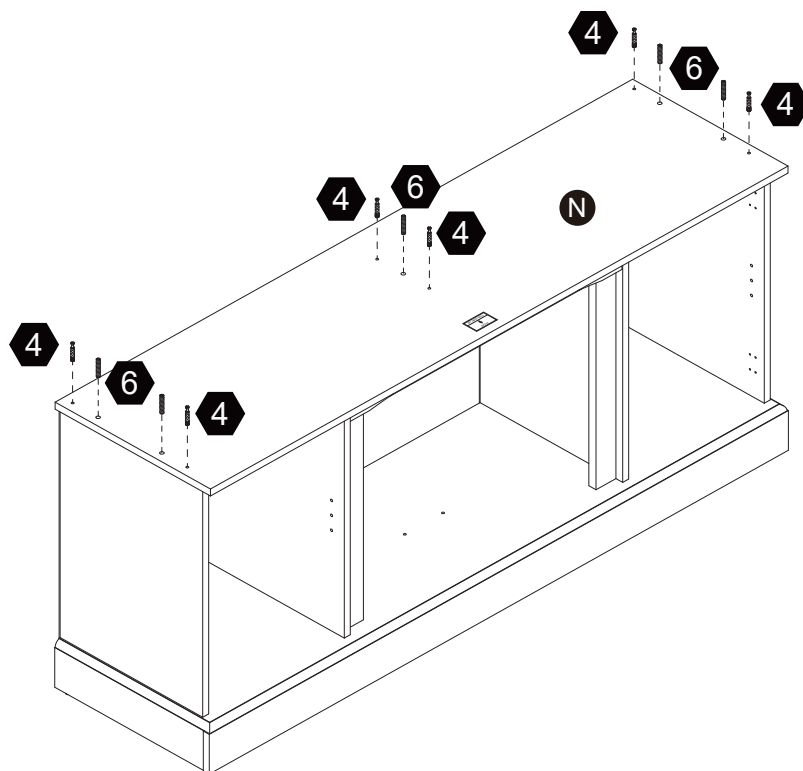

## Step 16

-   M6 x 35mm x 4

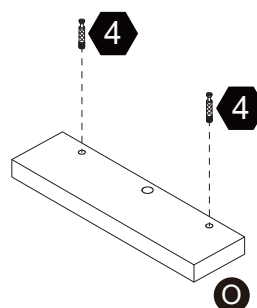
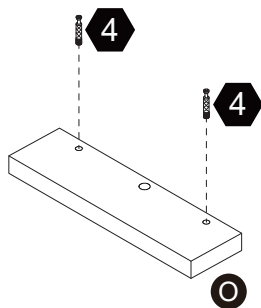

## Step 17

**5**  x 4  
Ø15 x 12mm

**6**  x 2  
Ø8 x 30mm

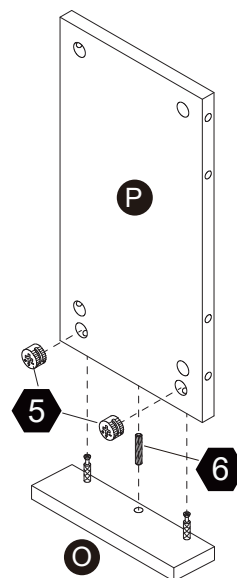
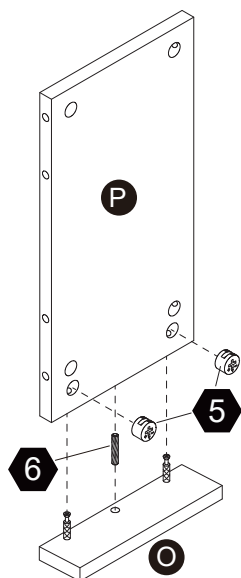

## Step 18

**5**  x 6  
Ø15 x 12mm

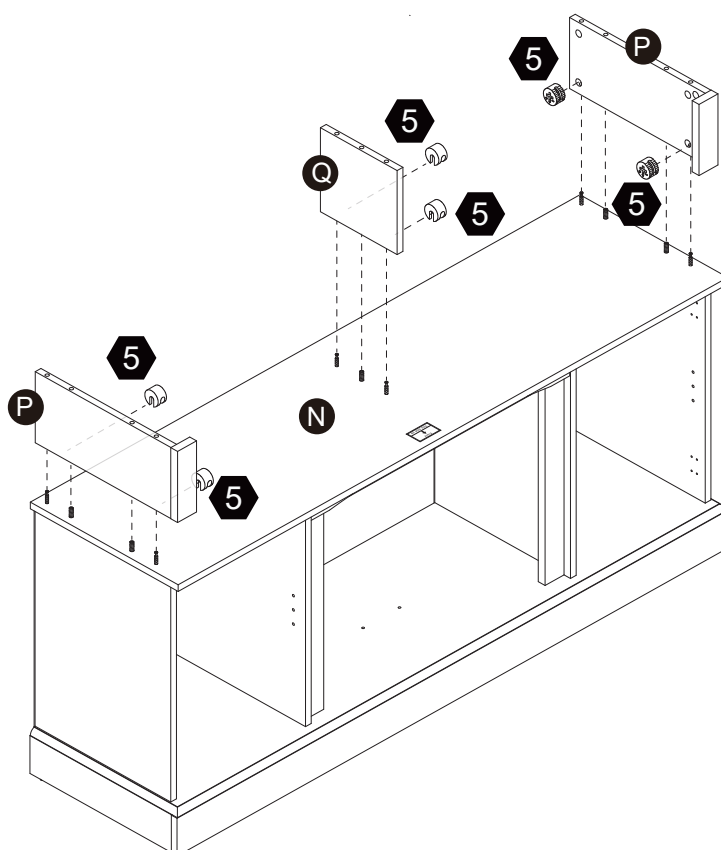

## Step 19

**4**  **x 6**  
M6 x 35mm

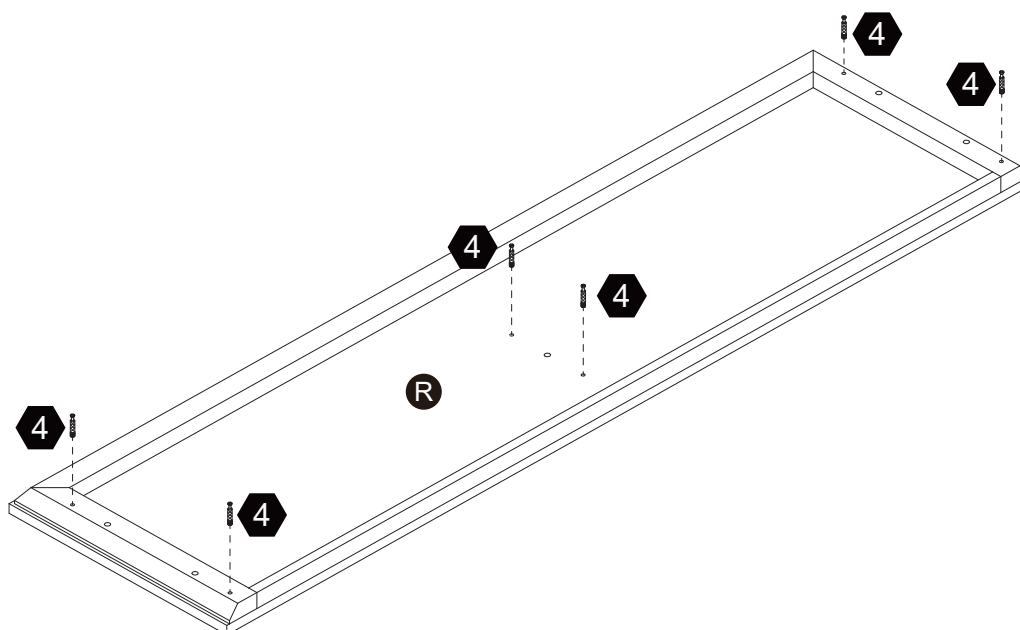

## Step 20

**5**  **x 6**  
Ø15 x 12mm

**6**  **x 5**  
Ø8 x 30mm

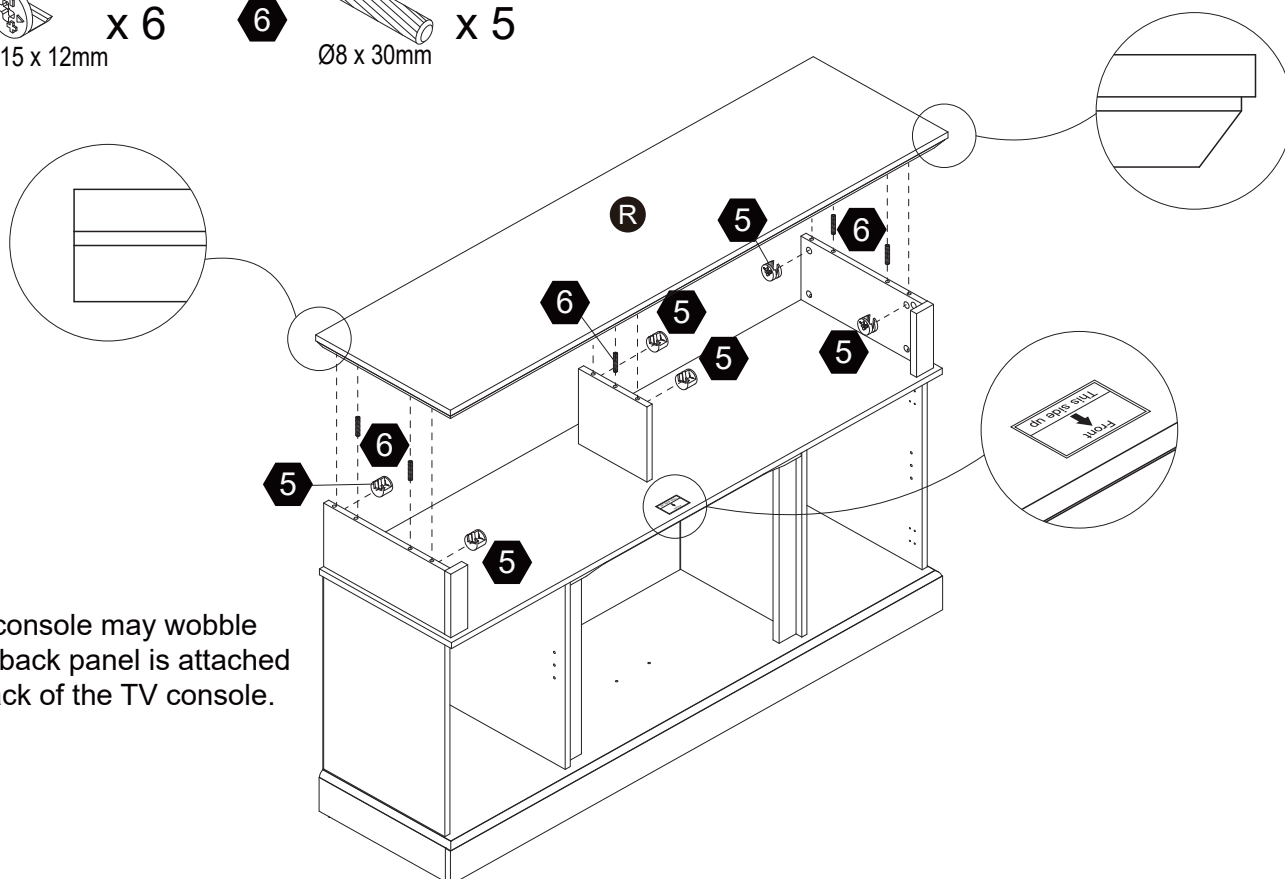

The TV console may wobble until the back panel is attached to the back of the TV console.

## Step 21

**13**  x 14  
M3 x 15mm

**Helpful Tip:** There are only 2 pilot holes on the top panel for locating the back panel on the back of the TV console. We do not pre-drill pilot holes on the sides and bottom. It is recommended to attach the back panel [S] at the top panel [R] first, then use a Phillips screwdriver to screw the screws into the TV console. Do not fully tighten all the screws [13] until all of them are in correct position.

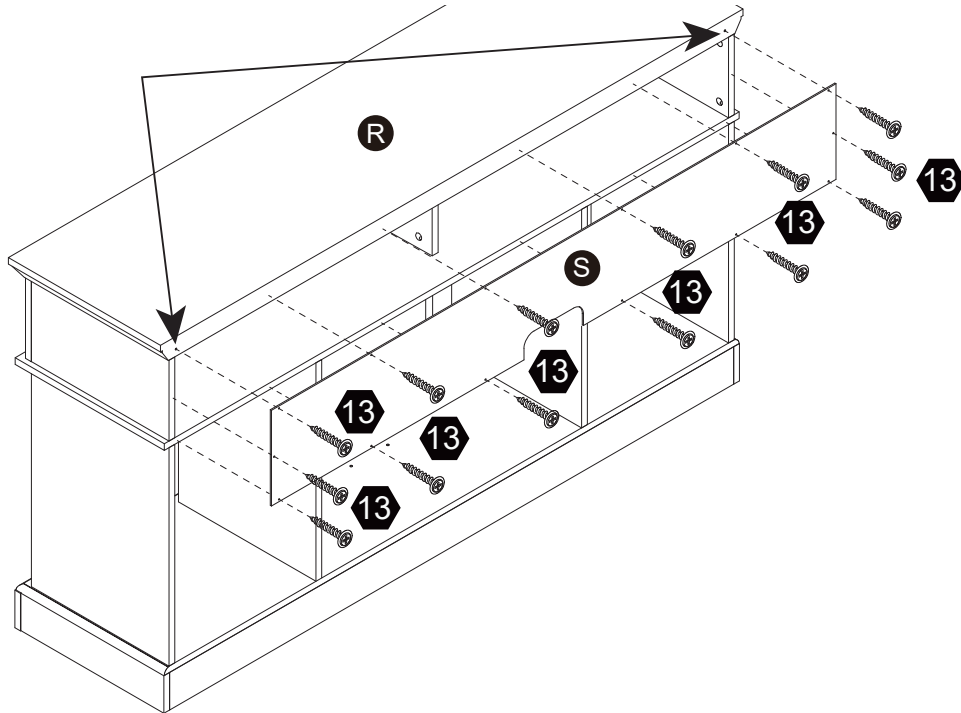

## Step 22

**13**  x 16  
M3 x 15mm

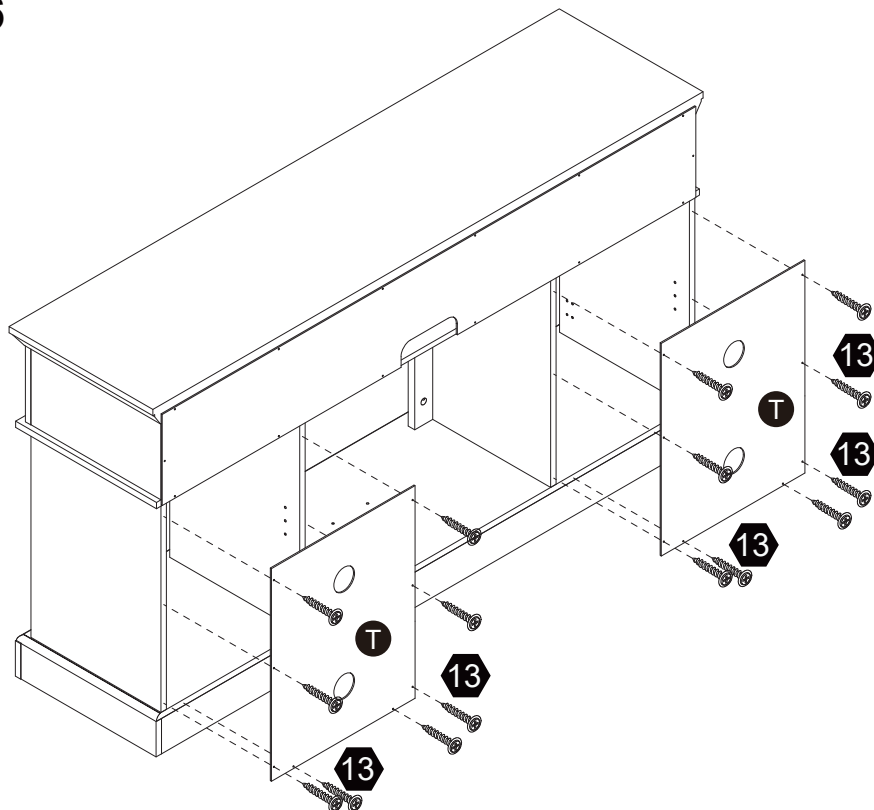

## Step 23

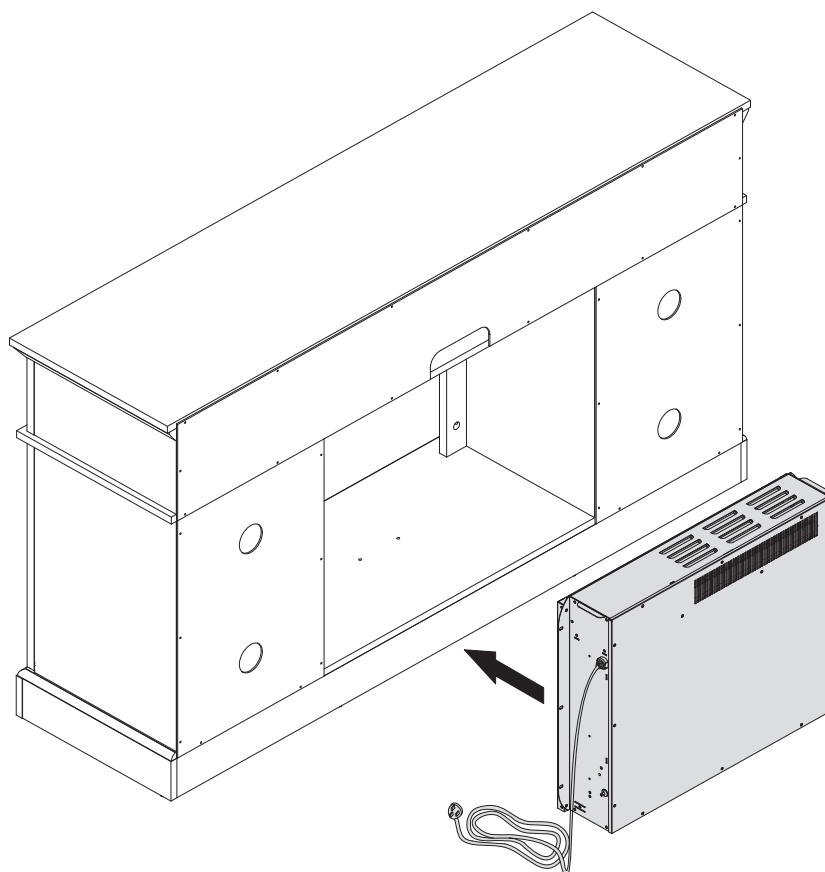

## Step 24

**14**  x 2  
M6 x 50mm

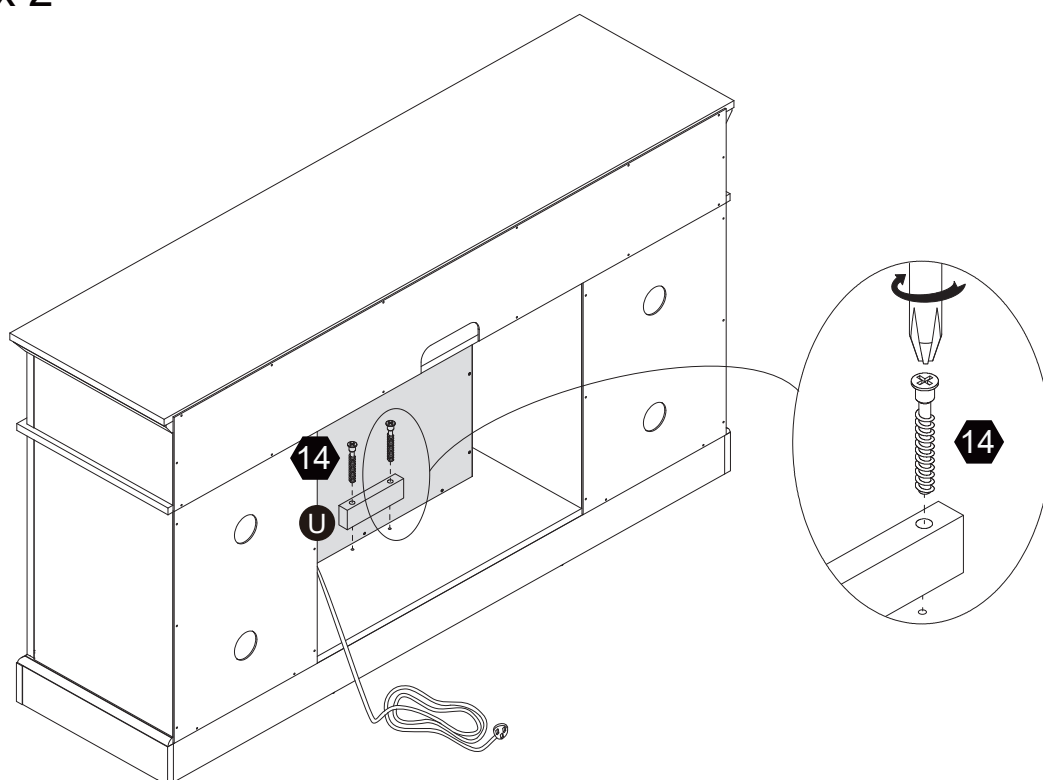

## Step 25

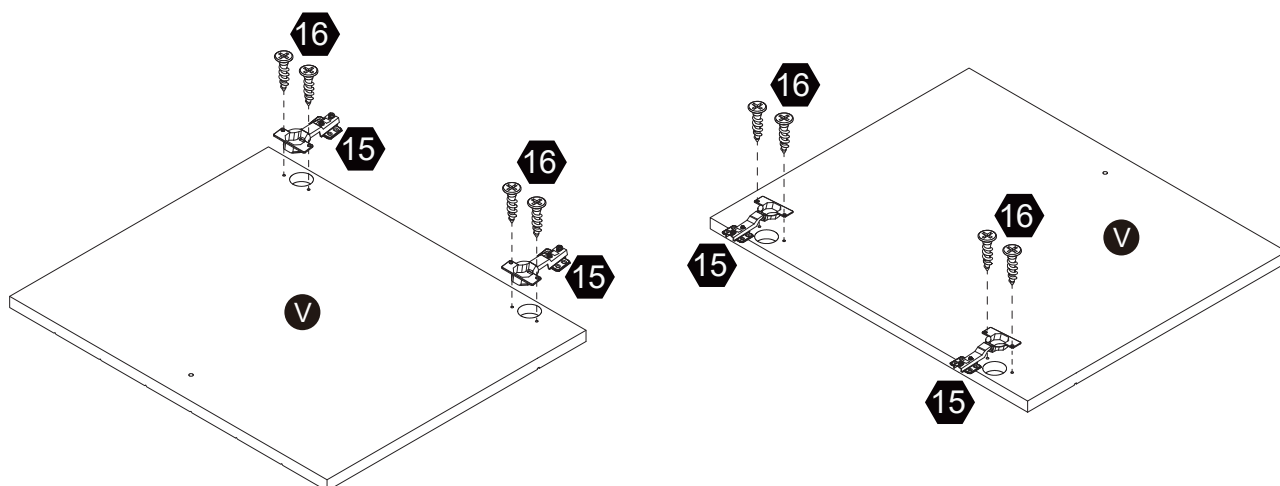

## Step 26

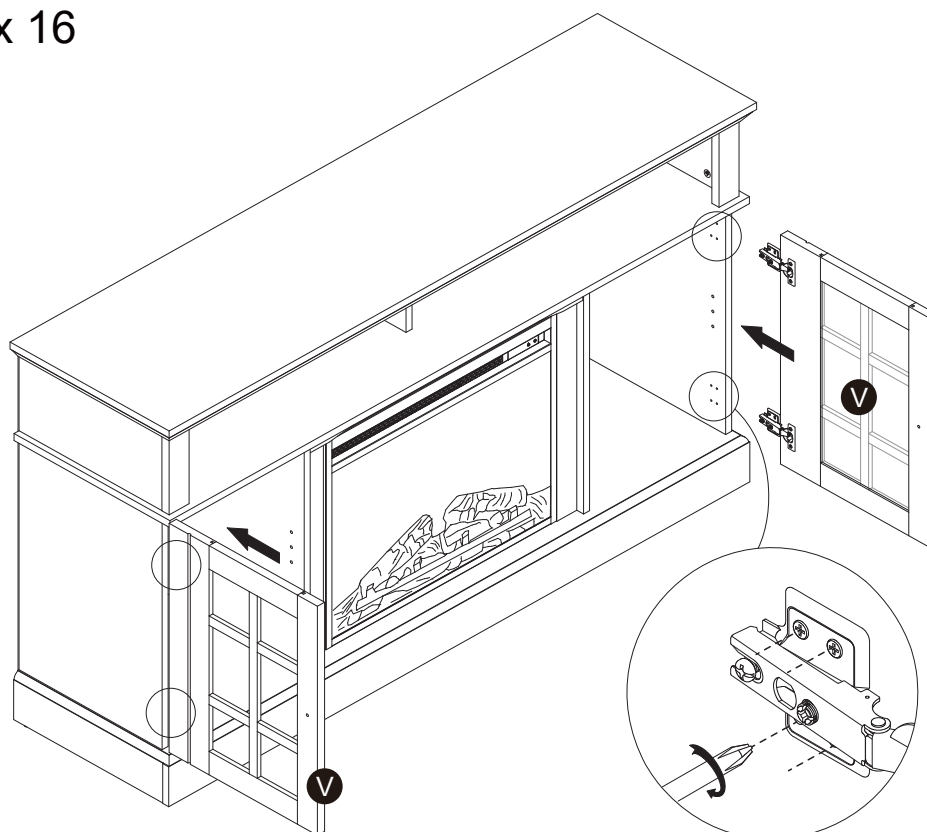

## Step 27

The door may go out of alignment during shipping. Open and close the doors to make sure they are aligned and shut correctly. If you find that the doors need to be adjusted, turn the appropriate screw, as illustrated.

Three-way adjustable hinge for perfectly aligned doors:

1. To adjust door up or down.
2. To adjust door forward or backward.
3. To adjust door right or left.

Turn the set screw [X] clockwise to narrow the gap between the door and the side panel.

Turn the set screw [X] counter-clockwise to enlarge the gap between the door and the side panel.

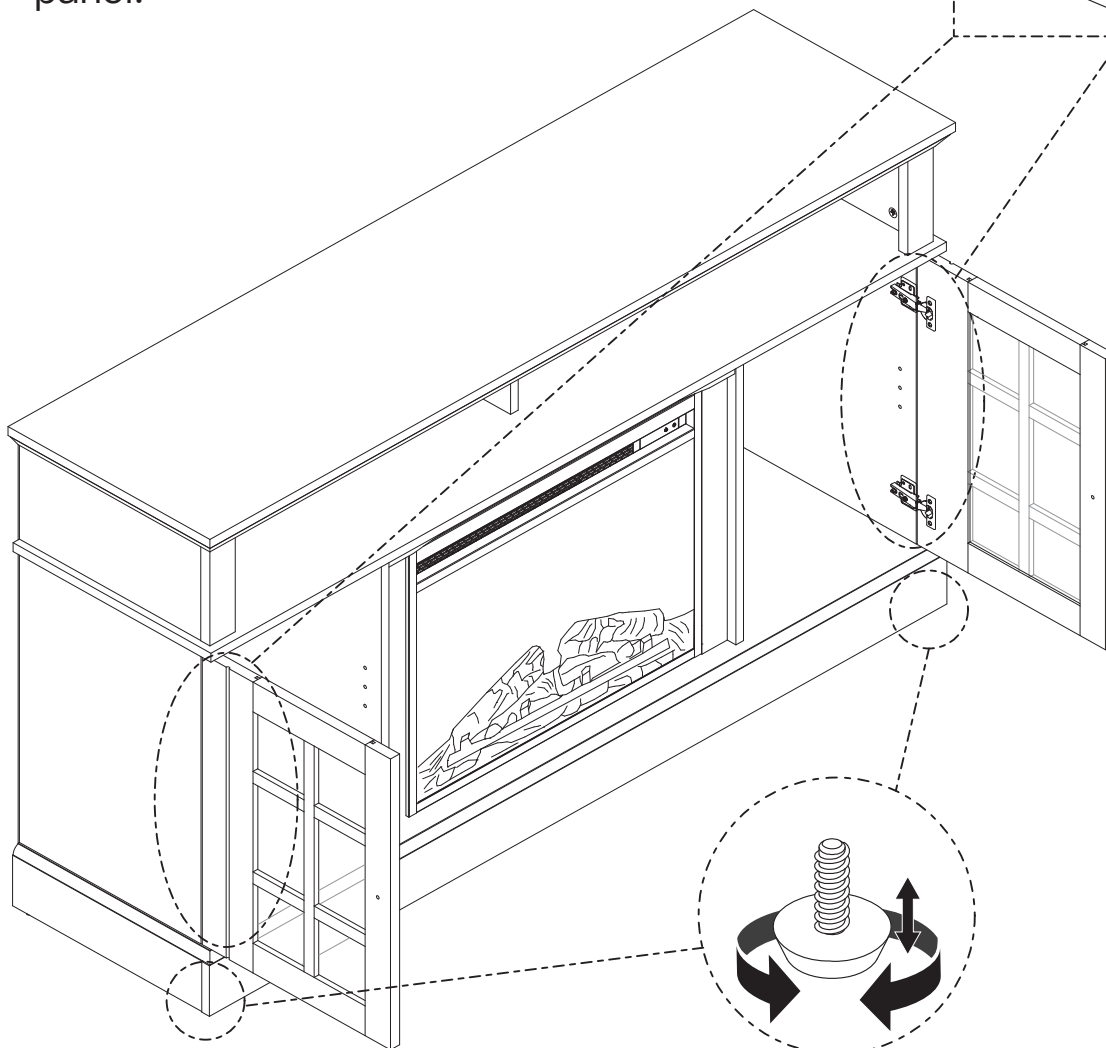
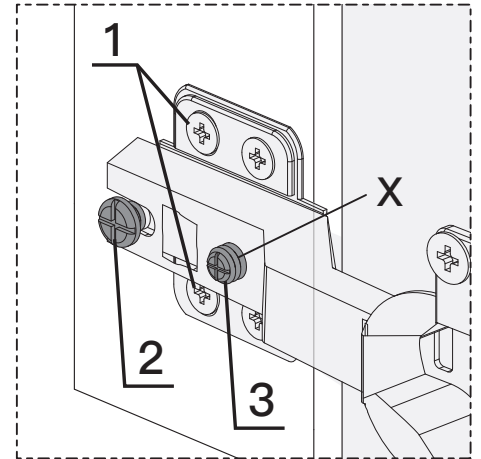

**NOTE:** It helps to prevent your TV from tipping over if you turn the two feet to raise the front corners.



## Step 28

- 17 x 2    18 M4 x 28mm x 2    19 Ø5 x 16mm x 8

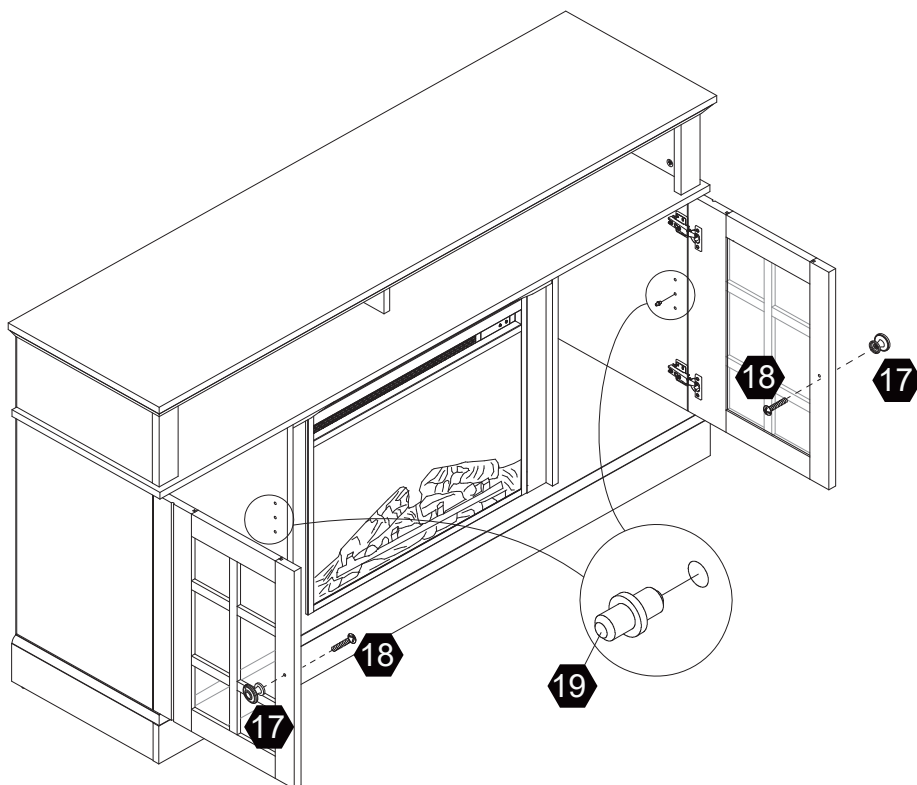

## Step 29

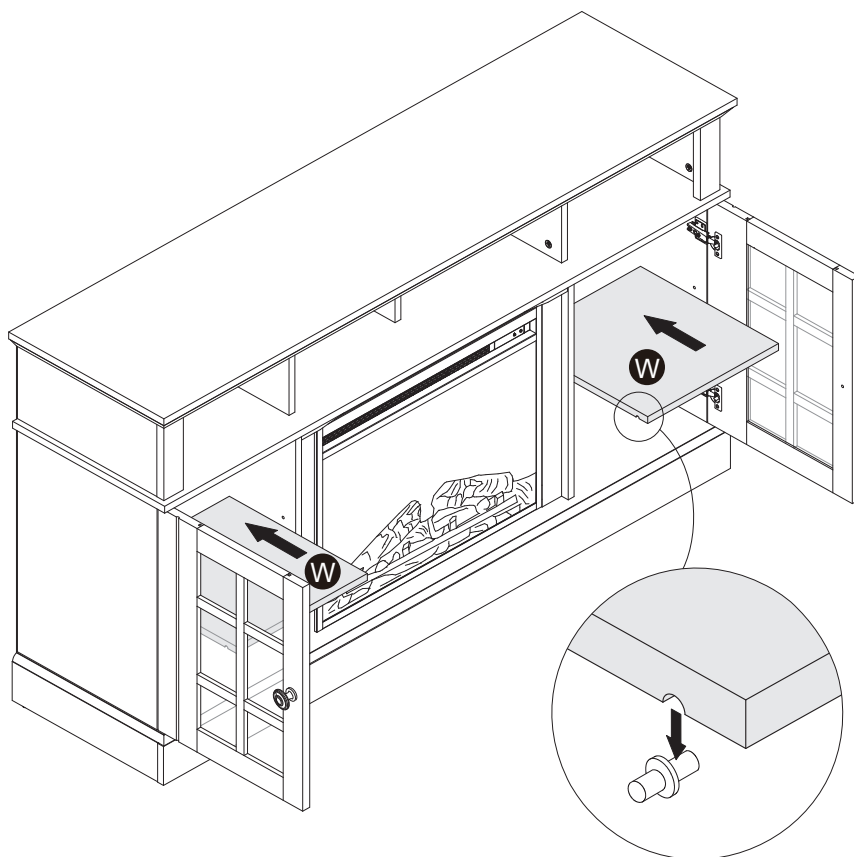

# Step 30

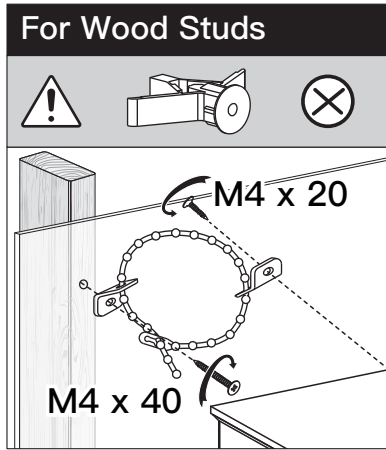

1 37/64" (40mm)

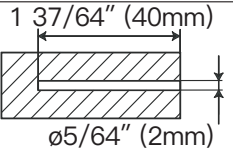
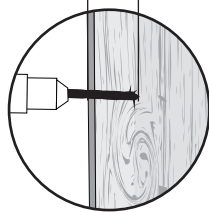

**For Solid Concrete or Brick Wall**

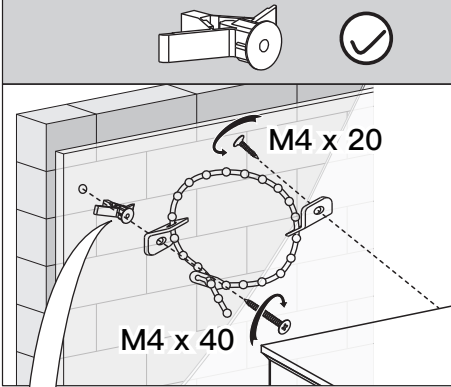

1 3/4" (45mm)

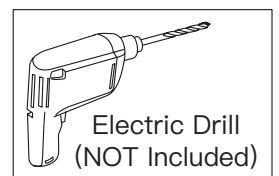
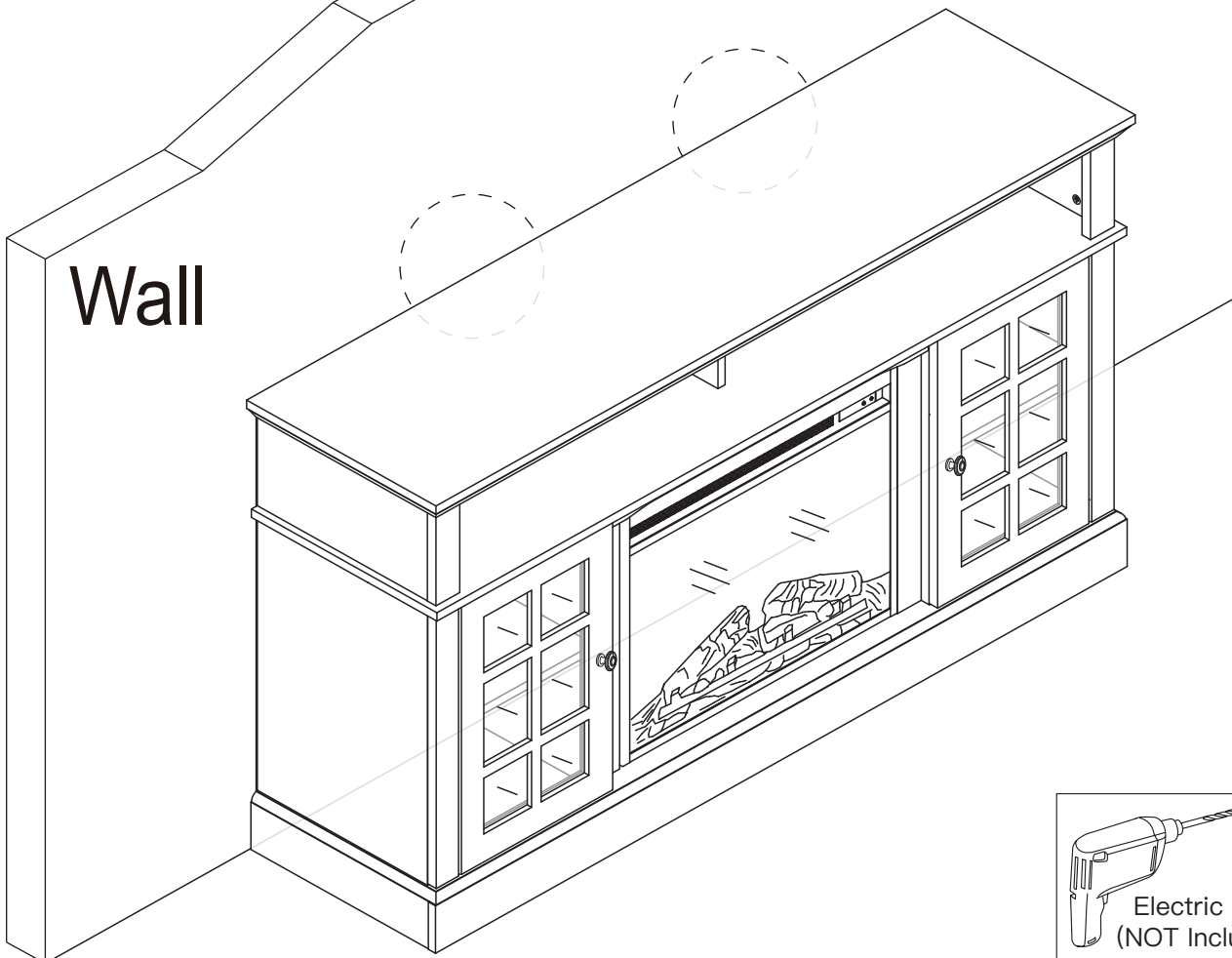
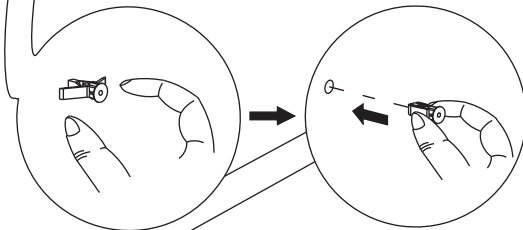
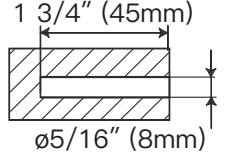
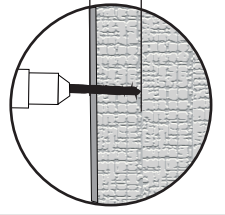

# Thank You

## For Choosing Our Product!

All of us do appreciate your product purchase. We hope that you are as happy with your product as we were designing and manufacturing it for you. We strive to provide you with the best quality products and services in the industry.