

# ASSEMBLY INSTRUCTIONS

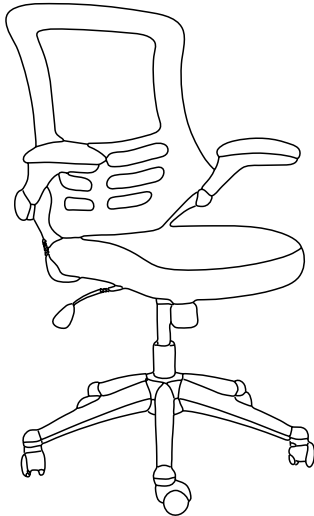

Thank you for purchasing our product!

HARDWARE			
No.	Item		Qty.
H	M6x25		4 Pcs
I	M6x20		4 Pcs
J	M6x40 + Washer		4 Pcs
K	Hole covers		4 Pcs

Tools (Included)	
Allen Wrench	

MAIN PARTS LIST		
<b>A</b> Backrest 	<b>B</b> Seat 	<b>C</b> Nylon star base 
<b>D</b> Mechanism 	<b>E</b> Lift cylinder 	<b>F</b> Casters x5 
<b>G-L</b> Left armrest 		<b>G-R</b> Right armrest 
* Right and Left defined as sitting on the chair, not by looking at it.		



For Support, Assembly Questions & Replacement Parts Within the 48 Contiguous United States



Replacement Parts for International Customers & **AK-HI-PR** orders:  
 RTA Products will replace the part free of charge, while the customer is responsible for shipping costs plus any International local taxes or duties.

**ASSEMBLY STEPS**

**STEP 1** Attach F to C, then insert E into C.

F enters into C by pressure

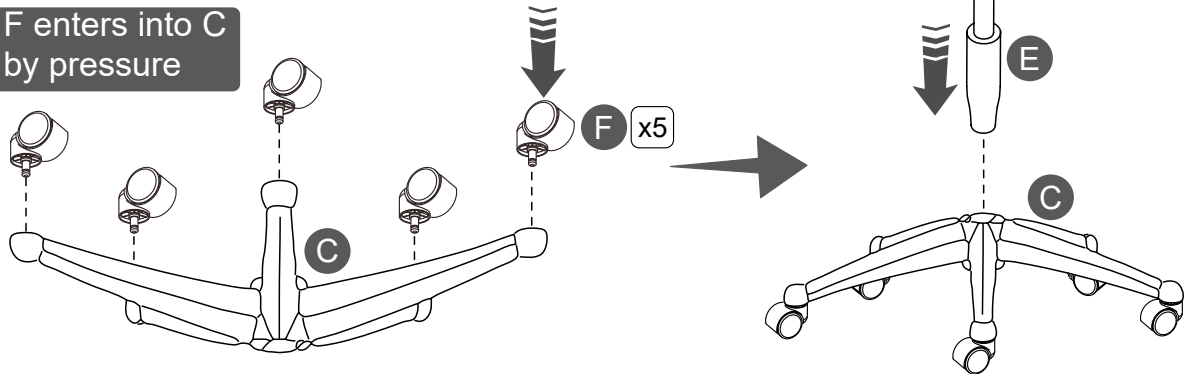

**STEP 2** Assemble D to B with I.

⚠ PAY ATTENTION TO THE ORIENTATION!

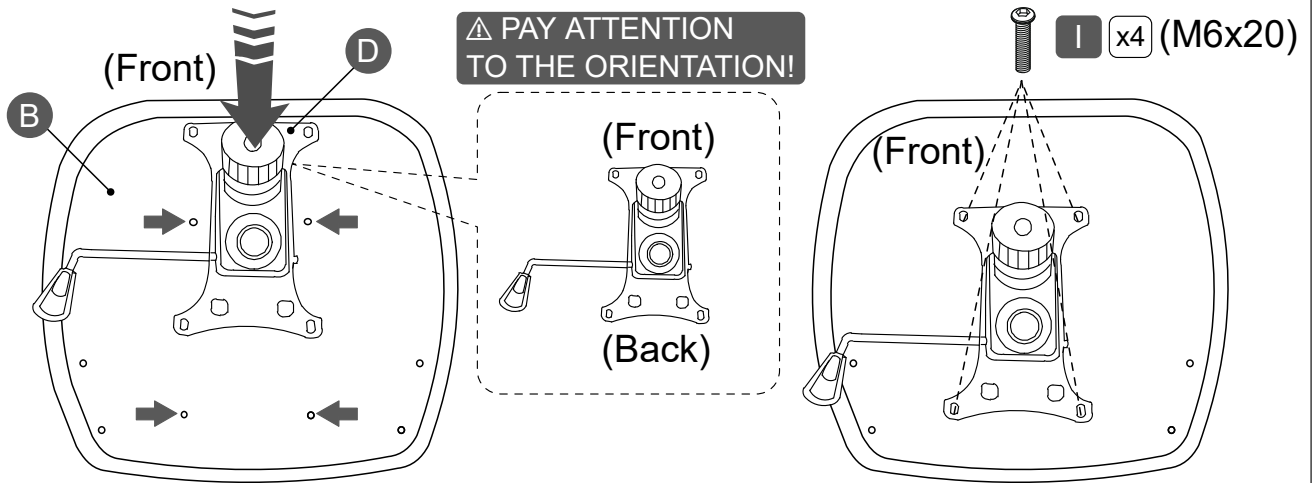

**STEP 3** Assemble G-L and G-R to B with J.

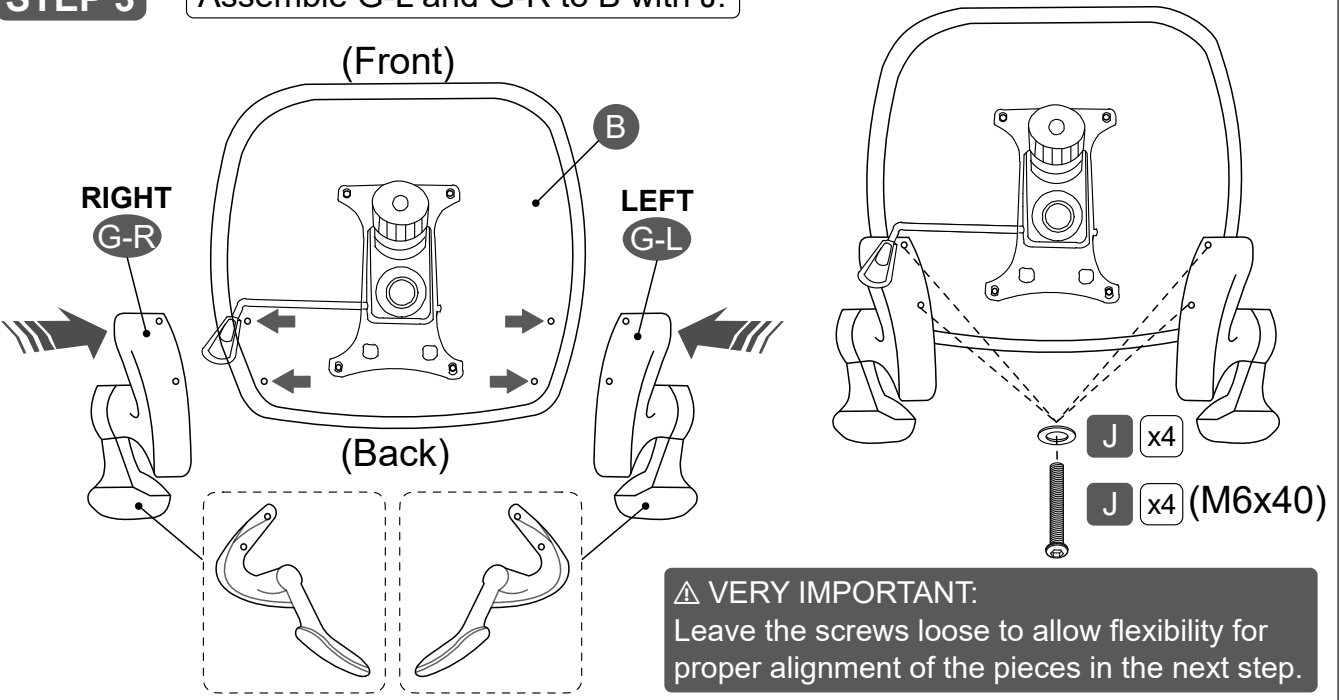

### ASSEMBLY STEPS

**STEP 4** Join the seat to the base.

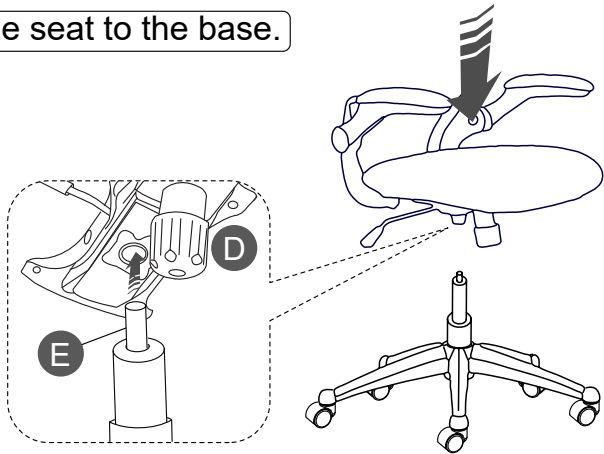

**STEP 5** Assemble A to G-L and G-R with H.

**⚠ VERY IMPORTANT:**  
Screw loosely to allow flexibility and proper alignment of the pieces.

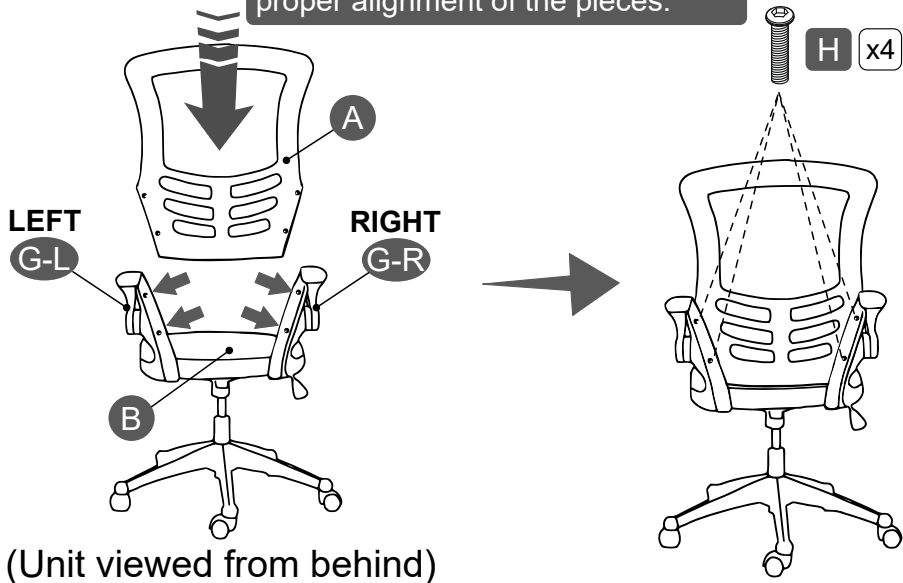

(Unit viewed from behind)

**STEP 6** Finally, cover the armrest holes with K.

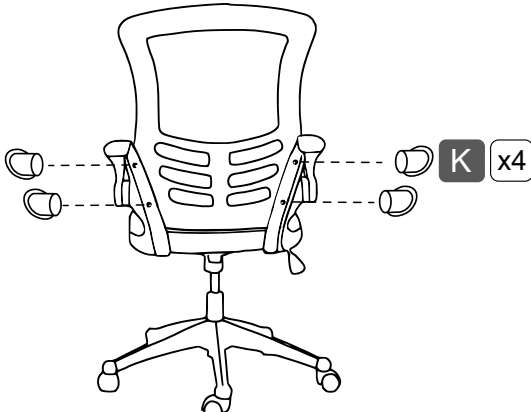

### CHAIR'S FUNCTIONS

Pull Handle OUT to UNLOCK; Push Handle IN to LOCK.

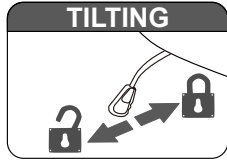

Pull Handle UP.

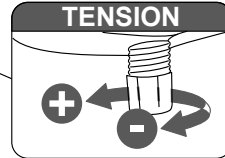
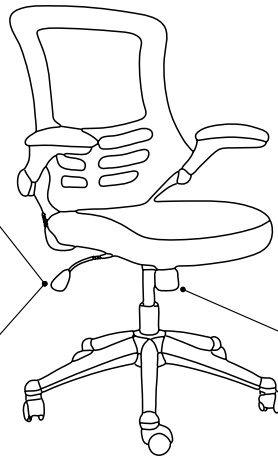
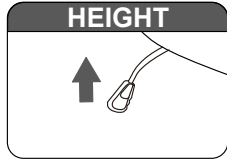

Turn the knob (+) for more tension, and (-) for less tension. Less tensions means easier tilting.

### WARNINGS - Not paying attention to the following warnings could result in injuries.

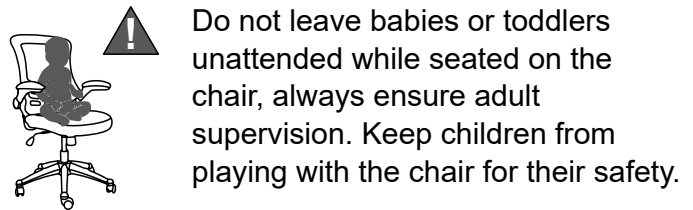
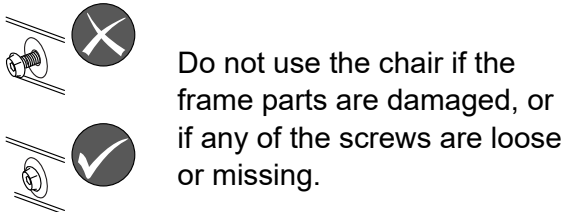
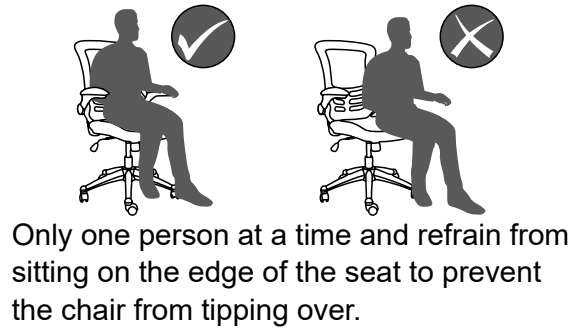
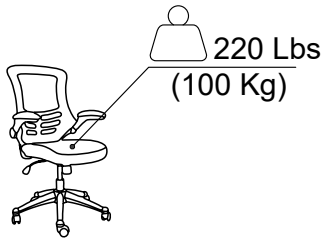

### CARE AND MAINTENANCE

Clean with a soft cloth lightly dampened in a solution of smooth soap and water.

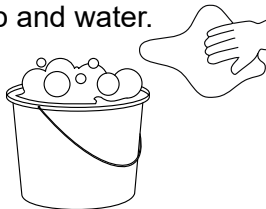

Do not use solvents or abrasive materials.



Do not expose to direct sunlight or to extreme environmental conditions.

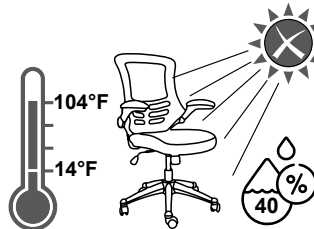

Inspect the chair thoroughly every 4 months and re-tighten the screws.

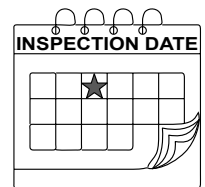

### LIMITED WARRANTY