

WARNING!!

NEVER allow children to climb or hang on furniture , including drawers or cabinet doors.

In addition to installing the restrains. To help prevent tip-over
1. **NEVER** put a **TV** or other heavy objects on top of this product”.
2. Do not stand on the products.

⚠ WARNING	
	<p>Children have died from furniture tipover. To reduce the risk of furniture tipover:</p> <ul style="list-style-type: none">• ALWAYS install tipover restraint provided.• NEVER put a TV on this product.• NEVER allow children to stand, climb or hang on drawers, doors, or shelves.• NEVER open more than one drawer at a time.• Place heaviest items in the lowest drawers.• Do not defeat or remove the drawer interlock system.
	<p><i>This is a permanent label. Do not remove!</i></p>

Assembly Instructions

Caution : You must read this before you proceed

BEDSIDE

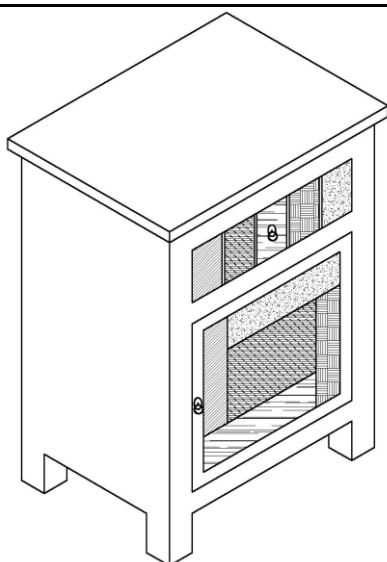

Hardware

Label	Picture	Description	QTY
①		Screwdriver (Not Provided)	1
②		Hammer (Not Provided)	1
③		Power Drill (Not Provided)	1
④		Bracket (45mmx20mm)	2
⑤		Wall Plug Screw	4
⑥		Wall Plug	4
⑦		Restraint Strap	2

Assembly Preparation

Before
Beginning
Assembly:

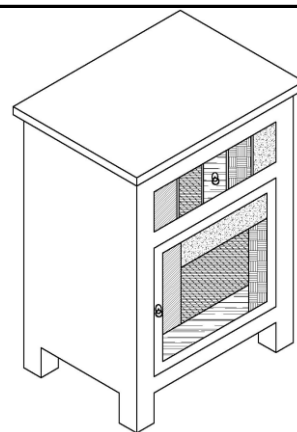
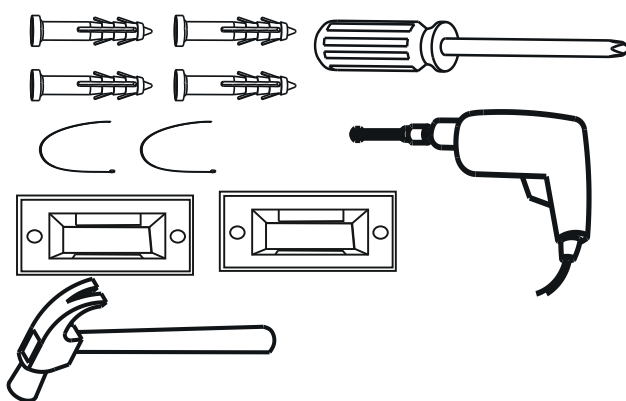

- Read instructions, cover to cover-



- Have 2 adults on hand for assembly-



- Do not assemble on flooring or carpet-

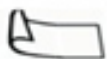

- Assemble on a clean non-marring surface (packing foam)-



- Save all packaging until finished-

Tipover Restraint Device Installation Instruction

WARNING

Serious or fatal crushing injuries can occur from tripping furniture.

To help prevent tip-over : ALWAYS secure this furniture to the wall using tipover device.

See products instruction for more ways to help prevent furniture tip-over.

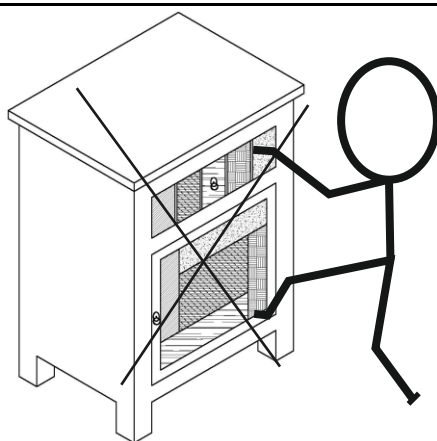

Usage For Tipover Restraint Device:

To secure Bedside against wall, attach two Brackets (④) on wall and 2 are already attached to the products, use restraint strap(⑦)to connect the brackets (④)

Step 1

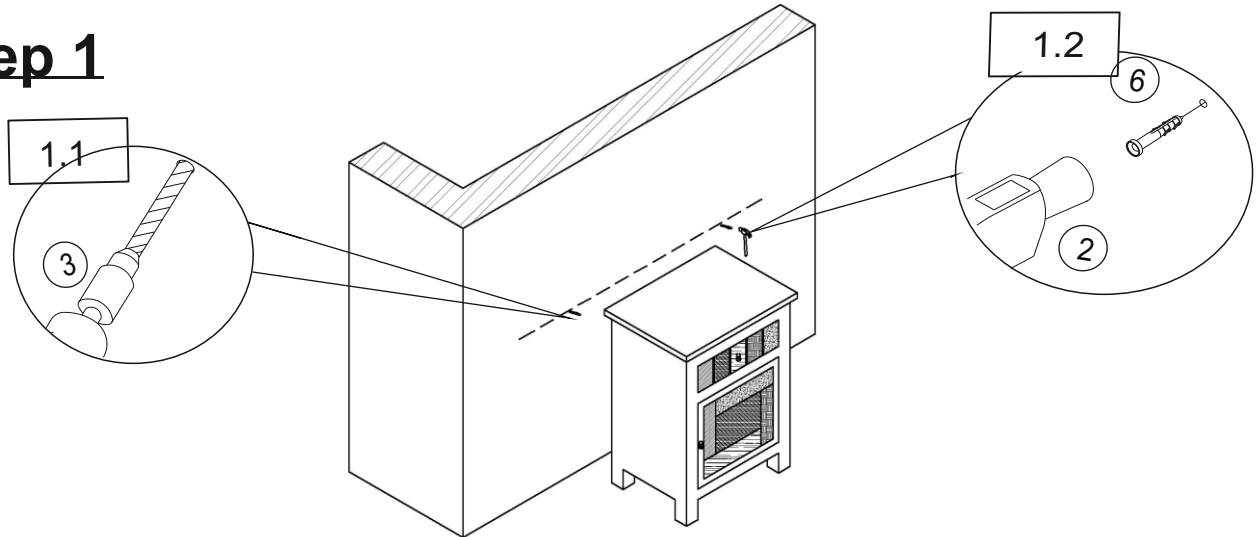

1.1) Drill two holes on wall at same height as Bracket (④) on Bedside with Power Drill (③).

You can mark these points in the ways as below:

1) Move the Bedside back to the wall. Mark two point same height as Bedside on the wall.

Note : The brackets need to be secured to solid ,load bearing surface. Please use a stud finder (not supplied) if needed to locate the wall frame.

2) Measure the height of the Brackets (④) with ruler/measuring tape and mark on wall to keep them accurate and same height.

2.2) Insert wall plugs (⑥) into drilled holes on wall with Hammer (②).

Step 2

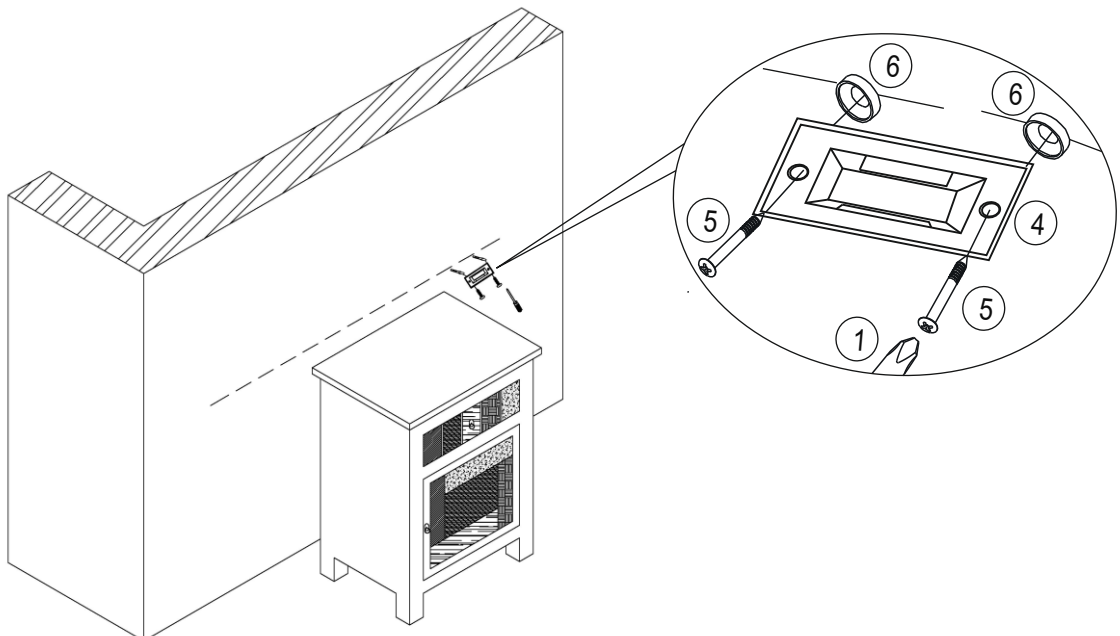

Attach Brackets (④) to Wall Plugs (⑥) using Wall Plug Screws (⑤) with Screwdrivers (①)

Step 3

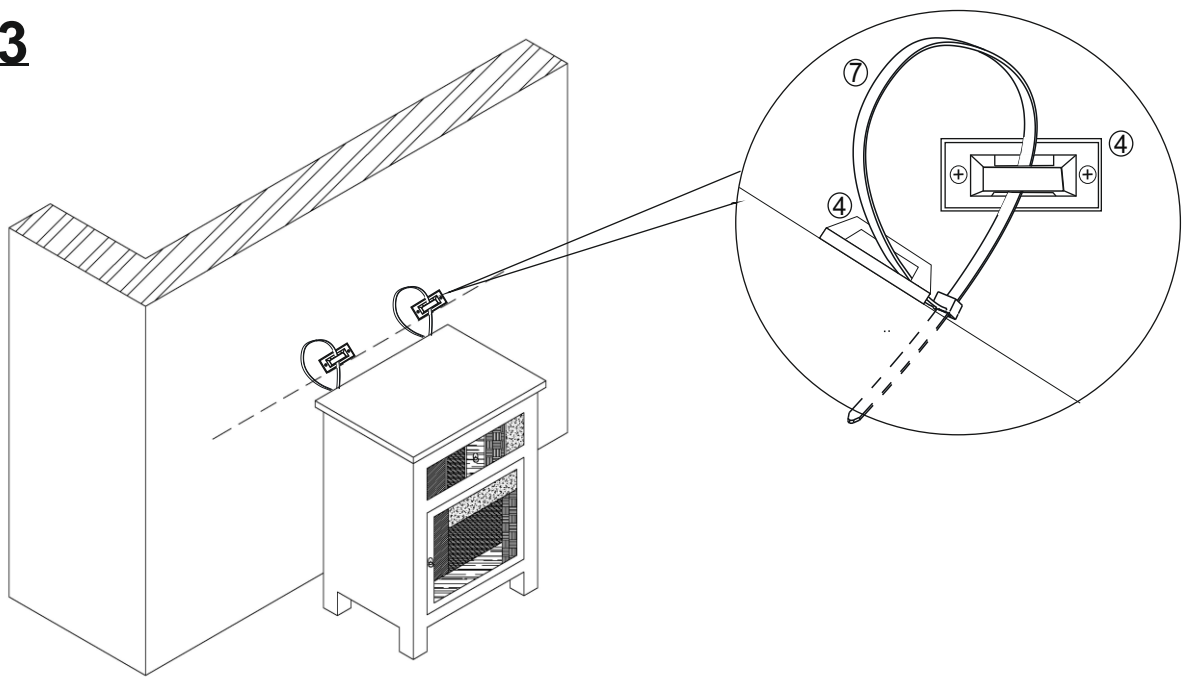











Move Bedside to the wall. Pull the Restraint Straps (⑦) through the Brackets (④) on the wall and Bedside one by one , and pull the Restraint Straps (⑦) tight.

This Bedside is now ready to use.

Caution: This Bedside can only be used on flat , level surface.

Care And Maintenance

- ✓  Furniture may scratch floors. We recommend using furniture pads to protect your floors.
- ⊘  Do not put hot items directly on furniture surface.
- ⊘  Do not clean furniture with harsh cleansers or polish.
- ⊘  Do not place furniture under direct sunlight.
- ⊘  Do not place furniture near heating or cooling vents.
- ⊘  Do not write on furniture without a padded barrier to protect the surface.
- ⊘  Do not place furniture outside . For indoor use only.
- ⊘  Not for commercial use . For residential use only.
- ⊘  Stains may be removed with mild soap solution and damp cloth.
- ⊘  Children should not climb or jump on the furniture.
- ✓  Dust and pick-up spills using a clean, non-colored lint-free cloth.