

Parts List For Cordova Snap Bed

BED CARTON

- | | |
|-----------------------|-----------------------|
| (1) HEADBOARD PANEL-1 | (5) FOOTBOARD PANEL-1 |
| (2) EXTENSION LEG-2 | (6) CROSS RAILS-4 |
| (3) PILLOW BAR-1 | (7) SUPPORT LEGS-6 |
| (4) SIDE RAILS-2 | |

HARDWARE BAG (BLACK FINISH)

- | |
|--|
| (8) 1/4-20 X 2" COUNTERSUNK ALLEN HEAD SCREW-4 |
| (9) 4MM ALLEN WRENCH-1 |

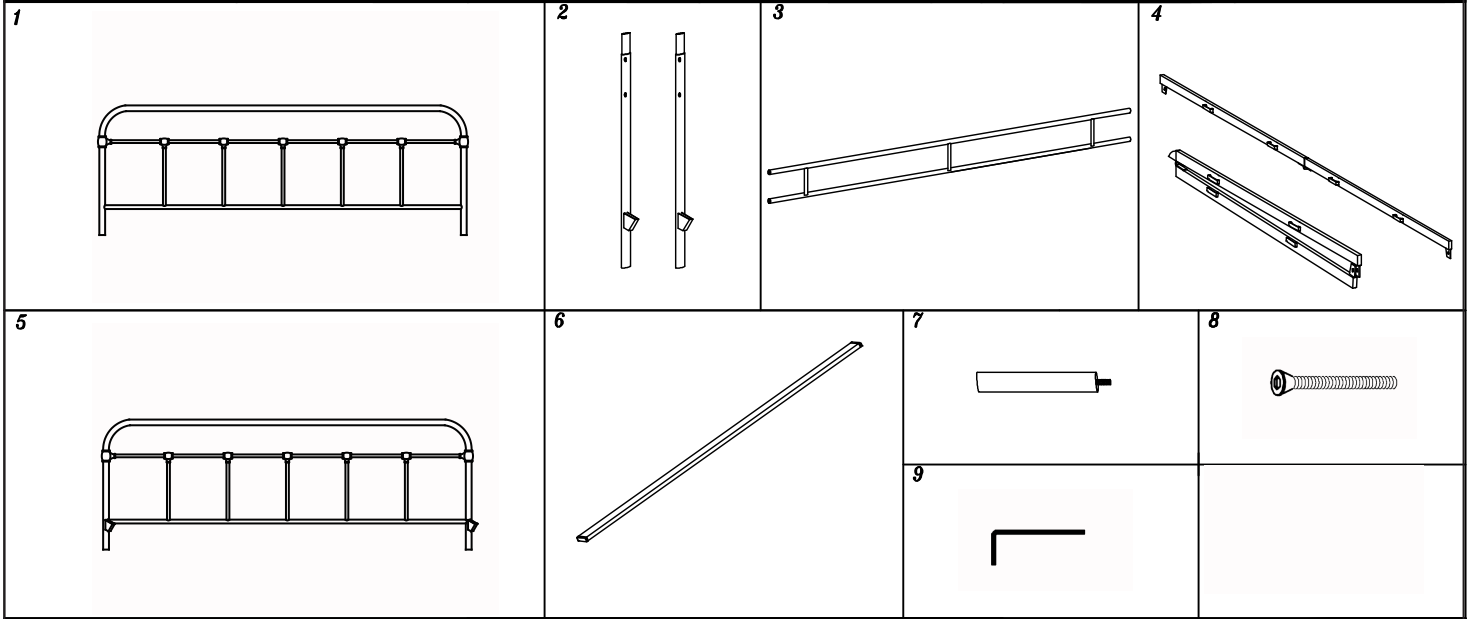

SAVE ALL PACKAGING MATERIALS UNTIL PRODUCT IS FULLY ASSEMBLED. HARDWARE AND SMALL PIECES MAY NOT BE SEEN AND COULD BE ACCIDENTALLY DISCARDED WITH PACKAGING MATERIALS.

Instruction Sheet

Step 1- Assembly of Headboard Panel .

- Align pilot holes on extension legs (2) with threaded inserts on Pillow bar (3) rails make sure welded pocket facing same direction. SEE FIGURE 1
- Secure pillow bar (3) with screw (8). Use Allen wrench (9).
DO NOT TIGHTEN SCREWS COMPLETELY
- Now Carefully insert headboard panel (1) over extension legs (2). SEE FIGURE 2
- Now tighten screws (8) completely. Use Allen wrench (9).

FIGURE 1

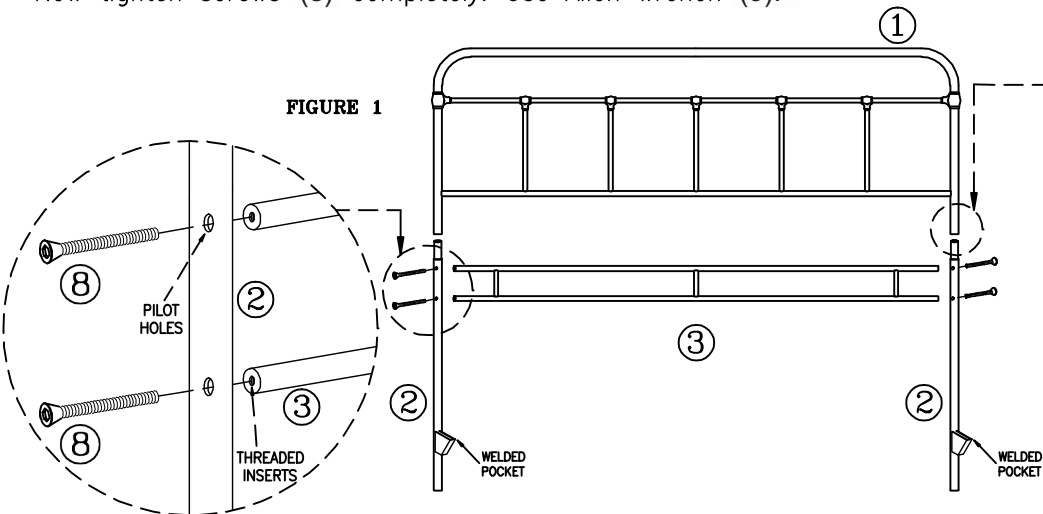
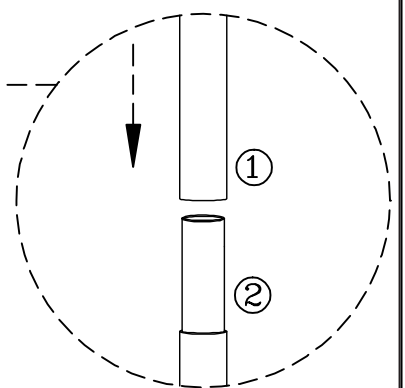

FIGURE 2



Instruction Sheet

NOTE: TO PREVENT SERIOUS INJURIES DO NOT PLACE HANDS OR FINGER BETWEEN MOVING PARTS.

Step 2- Assembly of Side Rails.

- Place headboard panel on desired location in room.
- Carefully un-fold side rail (4) . SEE FIGURE 3
- Insert wedge bracket of side rail (4) into welded pocket of extension leg (2). SEE FIGURE 4
- Repeat same steps with footboard panel (5).

Step 3- Assembly of Support leg / Cross Rails.

- Secure support leg (7) on cross rail (6). SEE FIGURE 5
- Insert welded bracket on cross rail (6) into welded pocket on side rail (4). SEE FIGURE 6

Step 4- Assembly of Finial. (IF NECESSARY)

- Secure finial on top of headboard and footboard post.

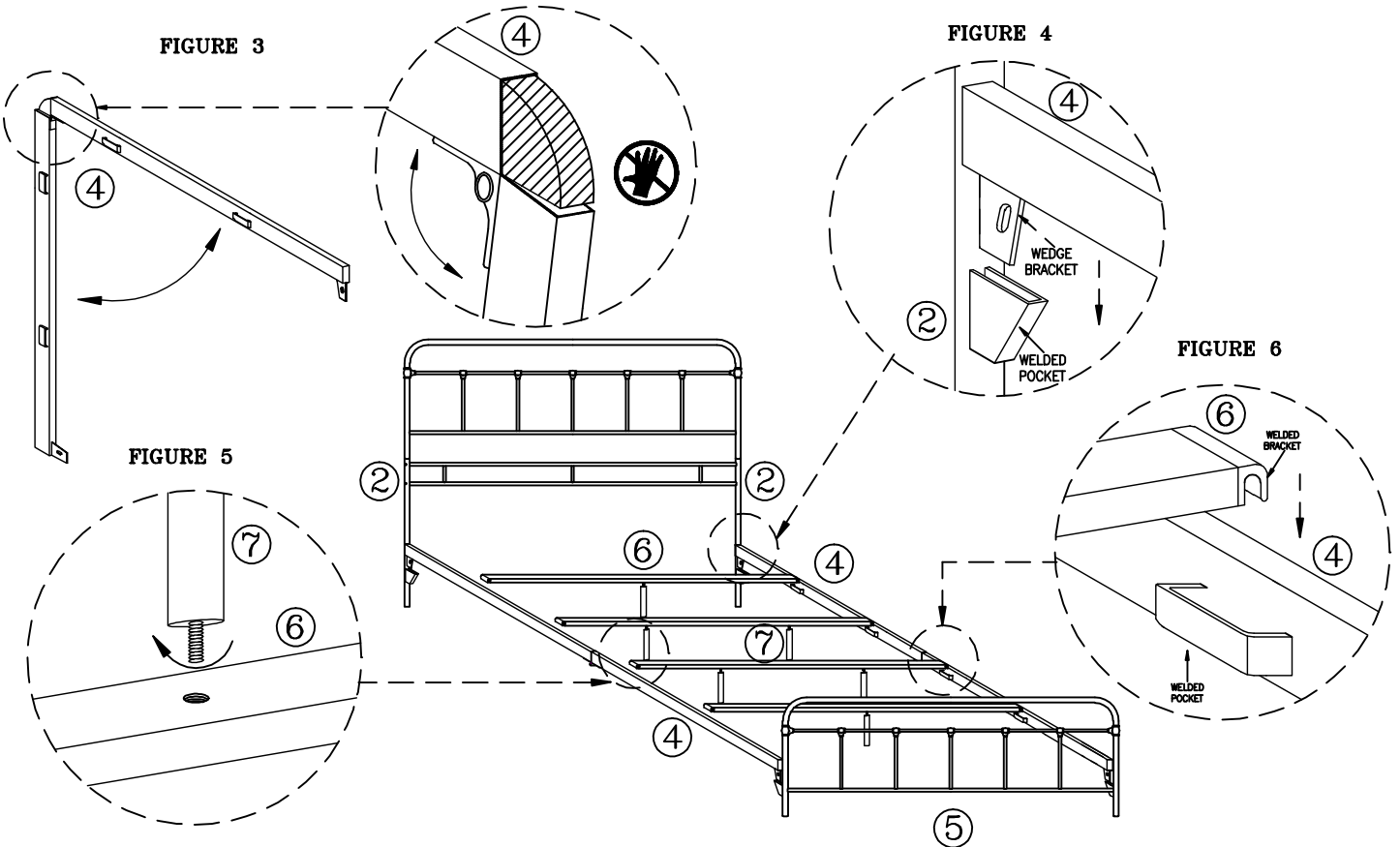

BED FULLY ASSEMBLED

