

**OPERATING MANUAL**

# Factory scale display

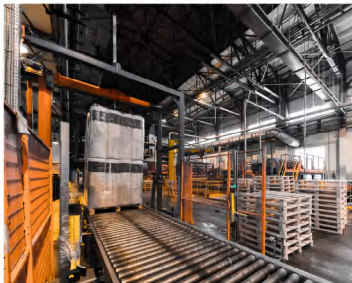

# How to install

## Package List:

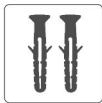

Expansion Tube X 2



Screws X 2



Cleaning Cloth X 1

Mirror x 1

## Tools Required (Not Provided):

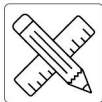

# Installation Method



Step1: Measure the distance between the sides of the mirror to find the correct location.



Step2: Use an electric drill to create a hole in the wall for the screw hardware you received.

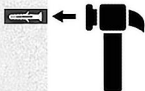

Step3: Use a hammer to drive the screws into the wall.



Step4: Push the screws into the wall from the outside.

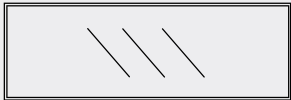

Step5: Hanging the mirror and adjusting it to the correct position.

# How to clean



1. Vinegar water or glass cleaner

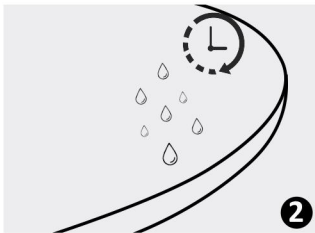

2. Wait a few seconds for the water to soften the stain

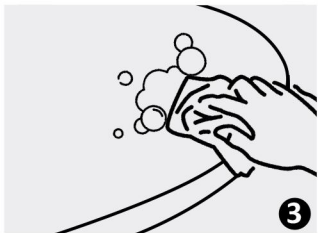

3. Microfiber cleaning cloths or newspaper



4. Make the glass bling bling!

# 20 years of experience as a mirror supplier - strictly control the quality and packaging of mirrors to ensure your purchase

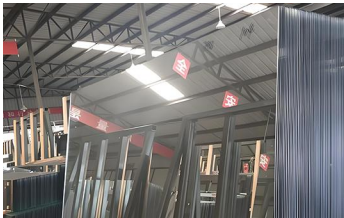

1. During the production process, there are dedicated personnel responsible for quality inspection, which can reasonably avoid some quality problems on the market



2. When cleaning the mirror and packaging, we will also pay attention to checking the details of the glass and frame



3. After packaging, a dedicated person will conduct a box drop test (using super-hard outer box EVA side strips and wooden foam for protection, 1.8m surface and 1.5-1.6m corners for multiple drop tests)



4. If other problems arise during the sales process, we will continue to improve and optimize the product