

Assembly Instructions for Model HL1235463

Package Contents

Part	Description	Quantity
A	Hanging Cord	1 pc.
B	Glass Shade	1 pc.
C	Mounting Bracket	1 pc.
D	Socket Ring	2 pcs.
E	Ceiling Canopy	1 pc.

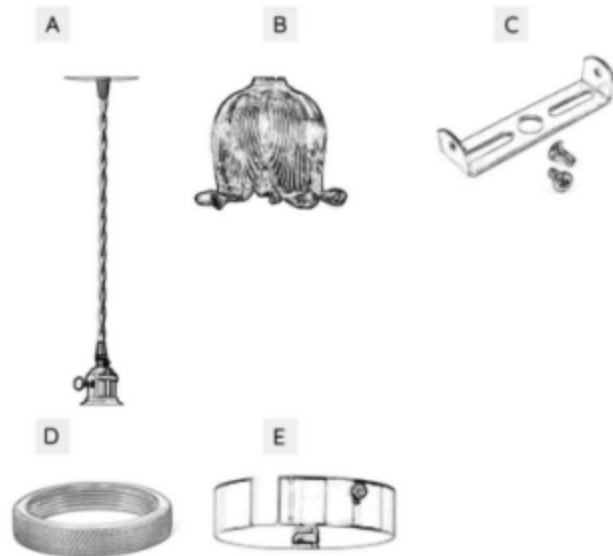

(This product can be installed by following similar steps. If you have any questions, please contact our customers for help.)



STEP 1

Remove the Mounting Bracket(C) from the Ceiling Canopy(E).



STEP 2

Mark the drilling position on ceiling with the help of the Mounting Bracket(C).

Drill holes on the marks and stick the hook-shaped expansion anchors into the holes.



Fix the Mounting Bracket(C) to the hook-shaped expansion anchors with self-tapping screws.



STEP 3

Thread the Hanging Cord(A) through the Ceiling Canopy(E), adjust the length as needed, and use the screws shown in the diagram to loosen or tighten for adjustment and fixation.



STEP 4

Hold the fixture close to ceiling.

Connect live line to wire color Black/Red from the Fixture.

Connect neutral line to wire color White/Blue from the Fixture.

If there are no color distinctions mentioned above, then: Connect live line to one of the two wires. Connect neutral line to the other wire.

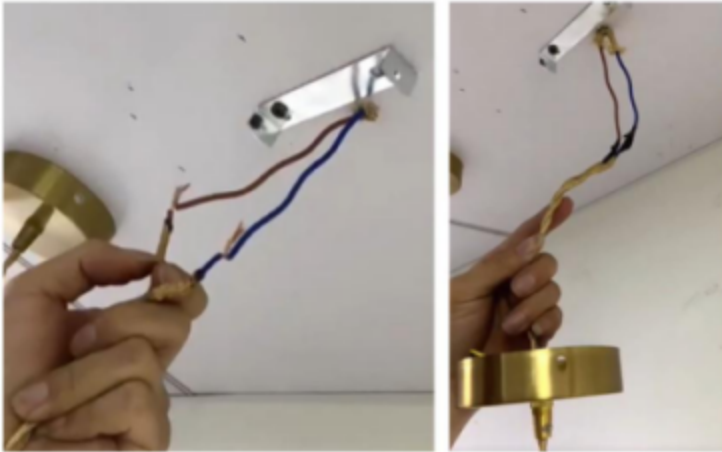

Note: You can either cut off the excess light cord or coil it inside the Ceiling Canopy(E). After connecting the wires, secure them with adhesive tape.

STEP 5

Attach the Ceiling Canopy(E) to the Mounting Bracket(C).



STEP 6

Remove one Socket Ring(D).



Secure the Glass Shade(B) by fastening it with a Socket Ring(D).



Installation reference video link:

http://m.youku.com/v_show/id_XNTE4OTY3NDEyNA==.html?pgcpgcid=UNjUzNjcxNzU0NA%3D%3D&sharekey=874c1cd81c7771984100e1b30686c6110